



US00D820884S

(12) **United States Design Patent**
Ohgaku

(10) **Patent No.:** **US D820,884 S**

(45) **Date of Patent:** **** Jun. 19, 2018**

(54) **ZIPPER PULL**

(71) Applicant: **YKK CORPORATION**, Tokyo (JP)

(72) Inventor: **Miyuki Ohgaku**, Shanghai (CN)

(73) Assignee: **YKK CORPORATION**, Chiyoda-Ku,
Tokyo (JP)

(**) Term: **15 Years**

(21) Appl. No.: **29/595,429**

(22) Filed: **Feb. 28, 2017**

(30) **Foreign Application Priority Data**

Aug. 31, 2016 (CN) 2016 3 0453845

(51) **LOC (11) Cl.** **02-07**

(52) **U.S. Cl.**
USPC **D15/7**

(58) **Field of Classification Search**
USPC D11/200, 201, 221; 24/381–383,
24/385–387, 414–431, 4, 412; D2/641;
294/3.6

CPC A44B 19/00; A44B 19/02; A44B 19/04;
A44B 19/10; A44B 19/24; A44B 19/26;
A44B 19/30; A44B 19/06

See application file for complete search history.

(56) **References Cited**

U.S. PATENT DOCUMENTS

4,984,338 A * 1/1991 Akashi A44B 19/262
24/419
D379,162 S * 5/1997 Melk D11/221

D499,668 S * 12/2004 Iwase D11/221
D556,633 S * 12/2007 Lobel D11/221
D559,147 S * 1/2008 Yang D11/221
D559,732 S * 1/2008 Ohgaku D11/221
D610,486 S * 2/2010 Yoshie D11/221
D656,865 S * 4/2012 Keyaki D11/221
D676,357 S * 2/2013 Phillips D11/221
D744,898 S * 12/2015 Morszeck D11/221
D754,029 S * 4/2016 Wierenga D11/221
D768,032 S * 10/2016 De Giglio D11/221

* cited by examiner

Primary Examiner — Ralf Seifert

(74) *Attorney, Agent, or Firm* — Global IP Services;
Tianhua Gu

(57) **CLAIM**

The ornamental design for a zipper pull, as shown and described.

DESCRIPTION

FIG. 1 is a front elevation view of a zipper pull showing my new design;

FIG. 2 is a rear elevation view thereof;

FIG. 3 is a left side elevation view thereof;

FIG. 4 is a right side elevation view thereof;

FIG. 5 is a top plan view thereof;

FIG. 6 is a bottom plan view thereof;

FIG. 7 is a top perspective view thereof;

FIG. 8 is a bottom perspective view thereof; and,

FIG. 9 is a using status perspective view for reference.

The broken lines are included for the purpose of illustrating portions of the zipper pull that form no part of the claimed design.

1 Claim, 7 Drawing Sheets



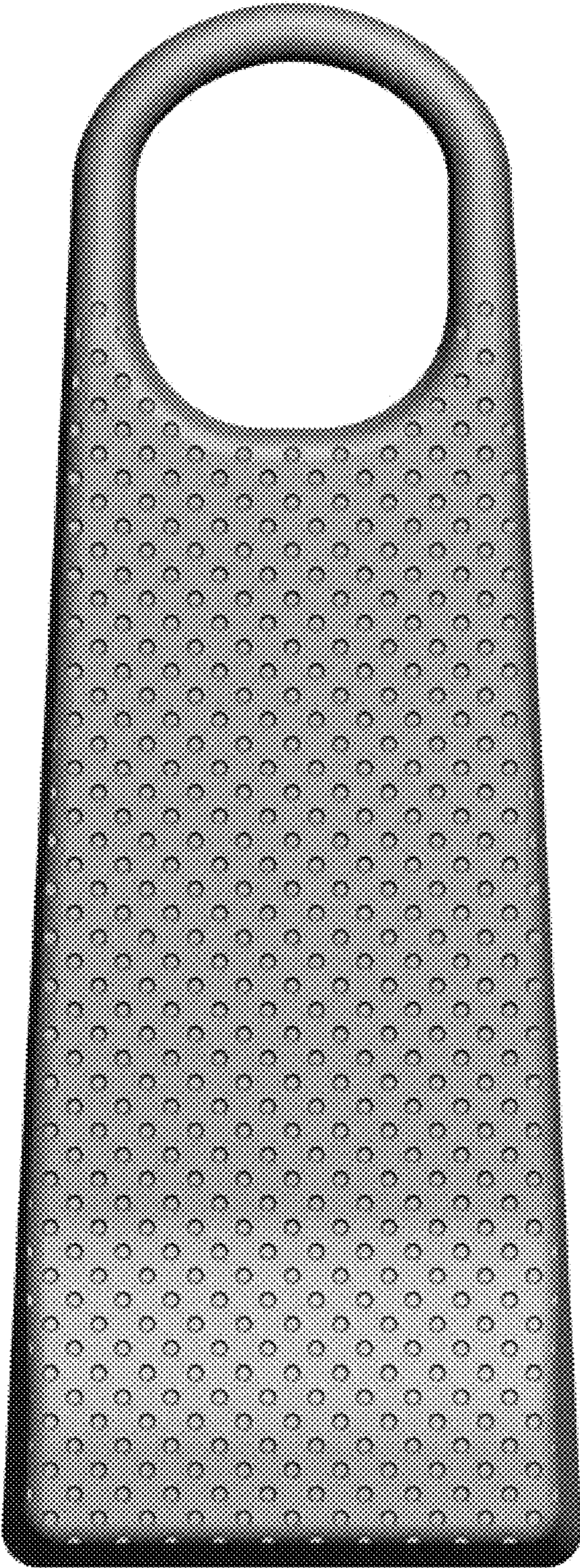

FIG. 1



FIG. 2

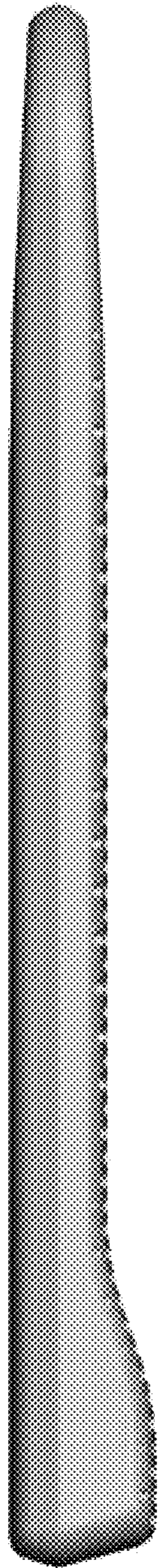

FIG. 3

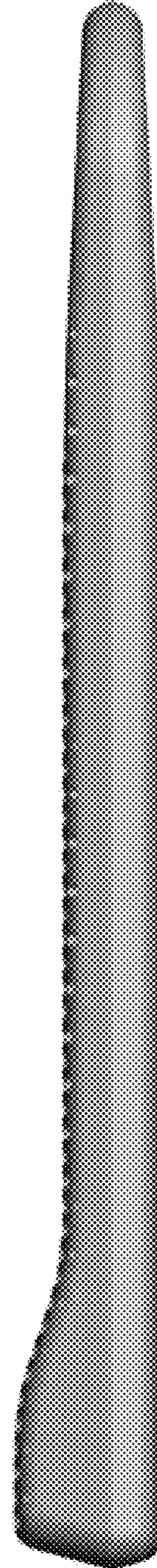

FIG. 4

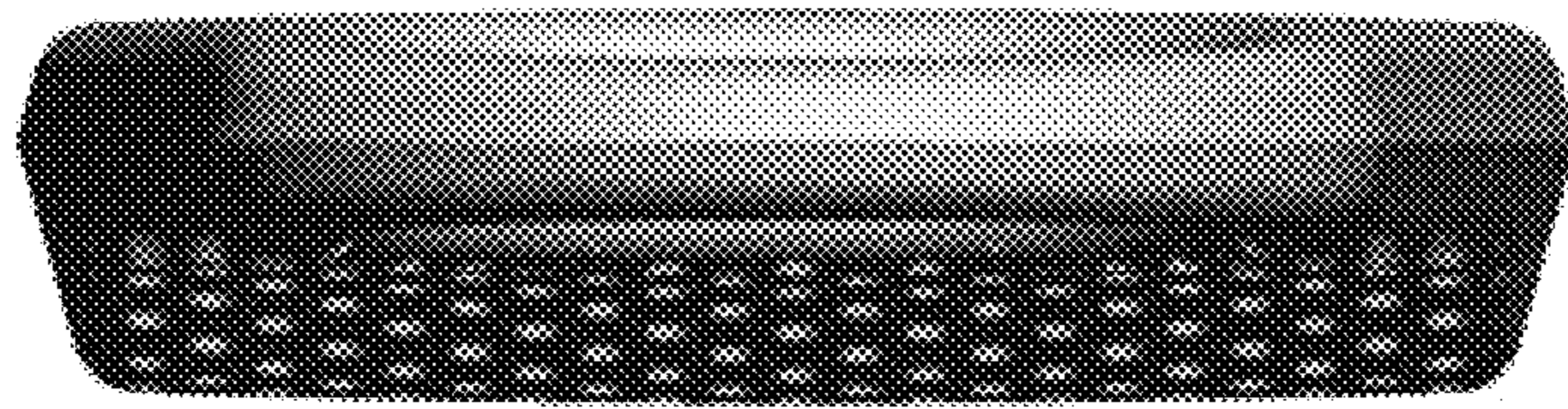

FIG. 5

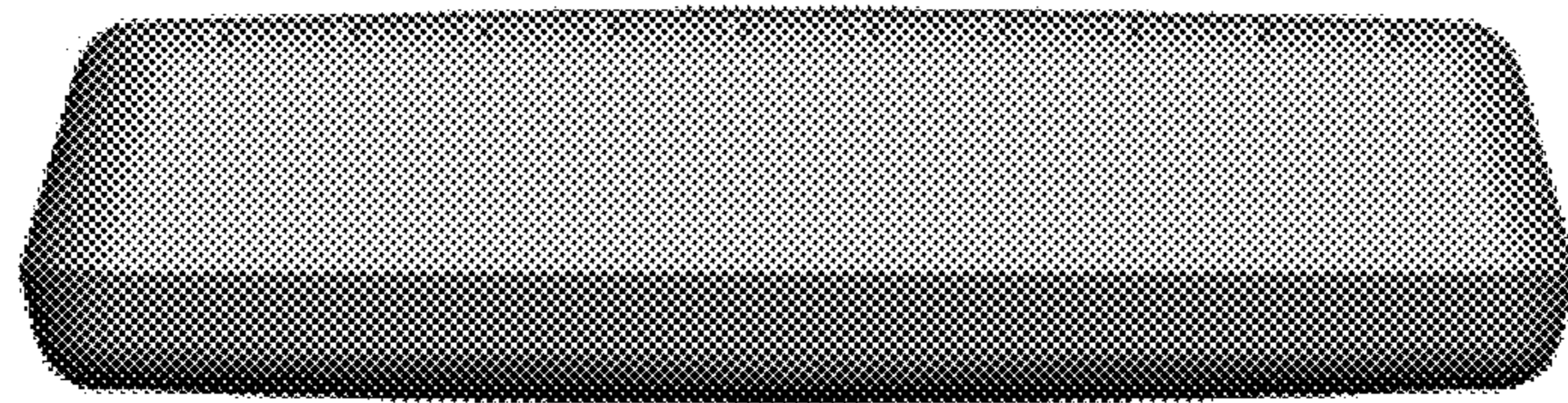

FIG. 6



FIG. 7



FIG. 8

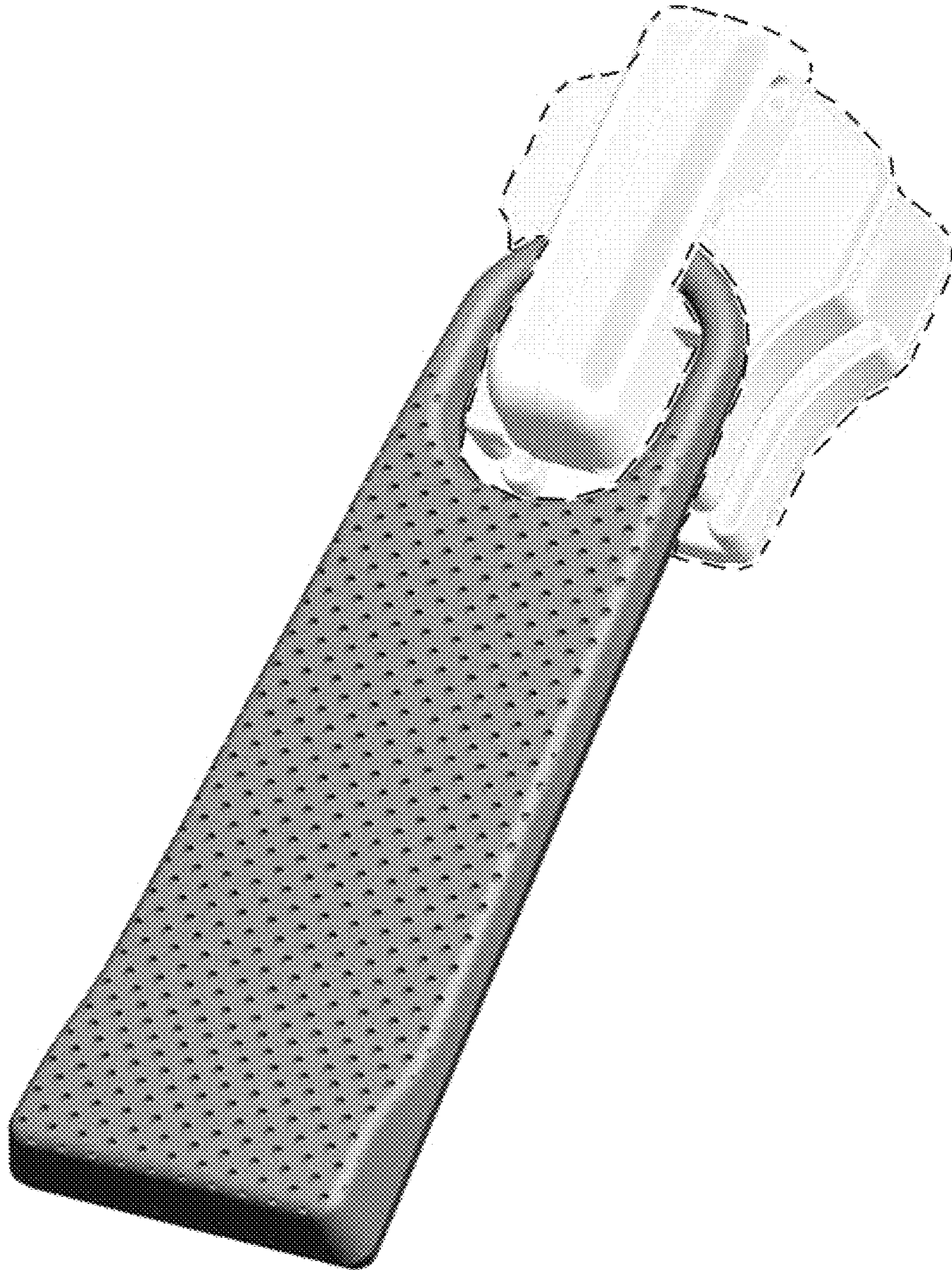

FIG. 9