



US00D820383S

(12) **United States Design Patent**
Okazaki et al.

(10) **Patent No.:** **US D820,383 S**
(45) **Date of Patent:** **** Jun. 12, 2018**

(54) **DEGASSING/AERATION MEMBRANE
MODULE**

D705,390 S * 5/2014 Okazaki D23/207
D705,391 S * 5/2014 Okazaki D23/207
8,876,945 B2 * 11/2014 Taylor B01D 19/0031
95/46

(71) Applicant: **Mitsubishi Rayon Co., Ltd.**, Tokyo
(JP)

D719,636 S * 12/2014 Reed D23/209
D776,786 S * 1/2017 Okazaki D23/209
D799,652 S * 10/2017 Takamatsu D23/333
D802,085 S * 11/2017 Kremerman D23/207
D806,206 S * 12/2017 Konagayoshi D23/207

(72) Inventors: **Hiroyuki Okazaki**, Tokyo (JP); **Yoshie
Tanizaki**, Tokyo (JP)

(73) Assignee: **Mitsubishi Chemical Corporation**,
Tokyo (JP)

FOREIGN PATENT DOCUMENTS

JP 1532657 2/2015

(**) Term: **15 Years**

OTHER PUBLICATIONS

(21) Appl. No.: **29/579,880**

Japanese Office Action for Japanese Design Application No. 2016-
007608, issued Dec. 8, 2016.

(22) Filed: **Oct. 4, 2016**

* cited by examiner

(30) **Foreign Application Priority Data**

Apr. 5, 2016 (JP) 2016-007608

(51) **LOC (11) Cl.** **23-01**

(52) **U.S. Cl.**
USPC **D23/207**

(58) **Field of Classification Search**
USPC D23/207, 209; 95/46; 96/4
CPC B01D 19/0031
See application file for complete search history.

Primary Examiner — Robin V Webster
Assistant Examiner — James C Thorn, Sr.
(74) *Attorney, Agent, or Firm* — Oblon, McClelland,
Maier & Neustadt, L.L.P.

(57) **CLAIM**

The ornamental design for a degassing/aeration membrane
module, as shown and described.

(56) **References Cited**

DESCRIPTION

U.S. PATENT DOCUMENTS

D265,227 S * 6/1982 Jolley D23/207
4,571,244 A * 2/1986 Knighton A61M 5/38
210/446
4,608,166 A * 8/1986 Cain B01D 29/111
210/232
D295,887 S * 5/1988 Hopkins D23/207
5,961,700 A * 10/1999 Oliver A61M 1/3627
210/188
D559,349 S * 1/2008 Brown D23/209
D654,558 S * 2/2012 Zeng D23/208
D685,451 S * 7/2013 Patera D23/209

FIG. 1 is a front, top, and left sideperspective view of a
degassing/aeration membrane module;
FIG. 2 is a front, top, and right side perspective view thereof;
FIG. 3 is a front elevational view thereof;
FIG. 4 is a rear elevational view thereof;
FIG. 5 is a top plan view thereof;
FIG. 6 is a bottom plan view thereof;
FIG. 7 is a left side elevational view thereof; and,
FIG. 8 is a right side elevational view thereof.

1 Claim, 8 Drawing Sheets

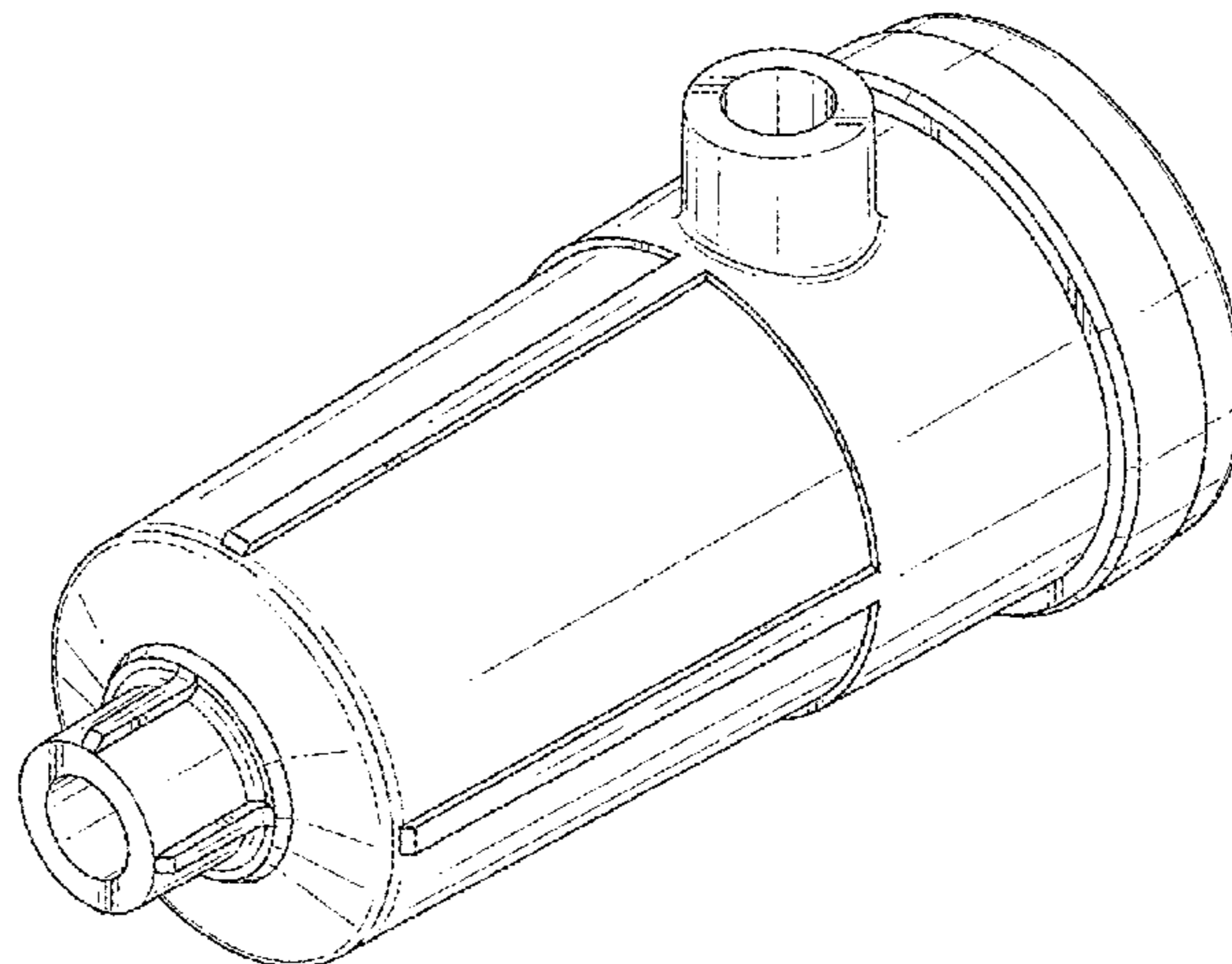

FIG. 1

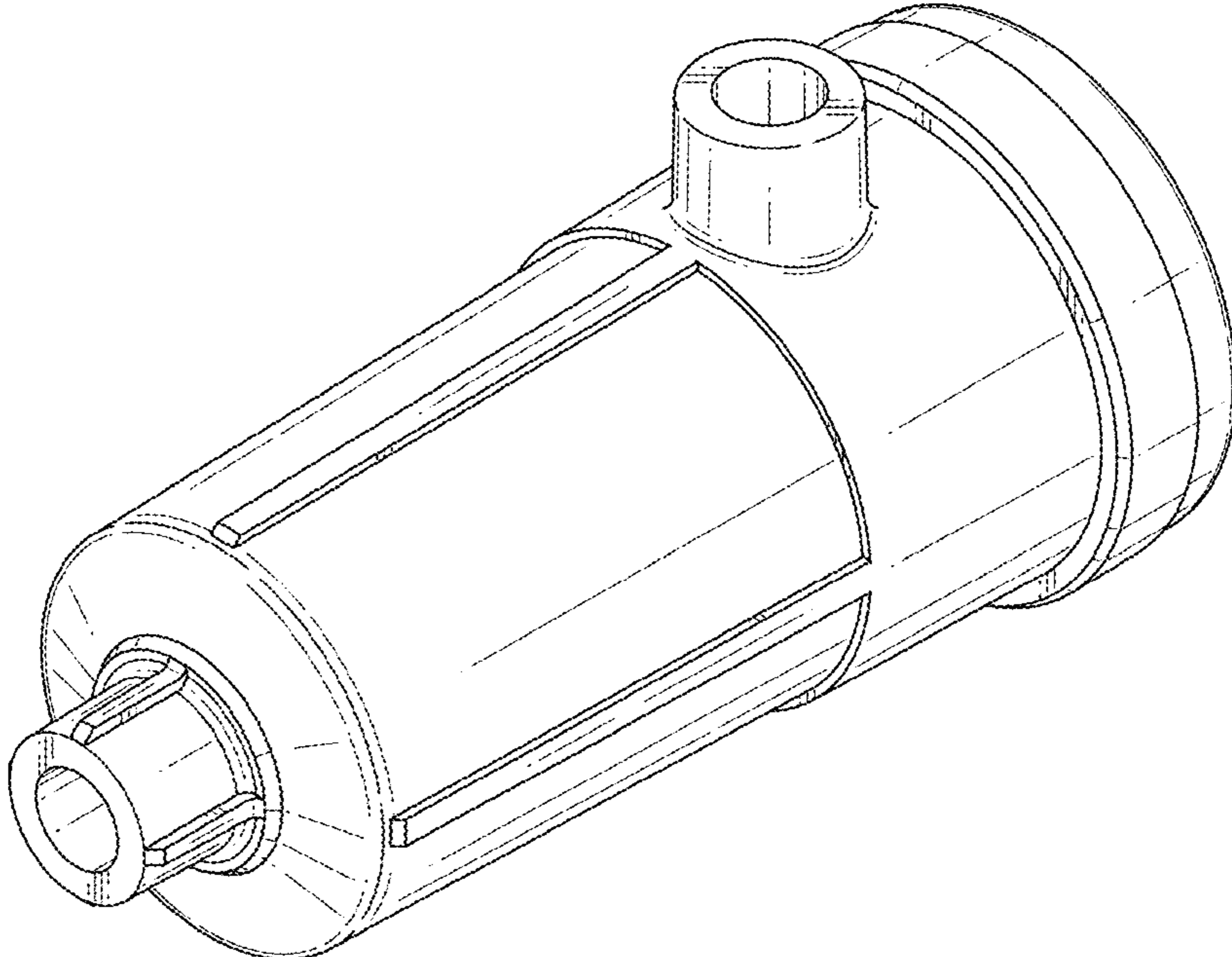

FIG. 2

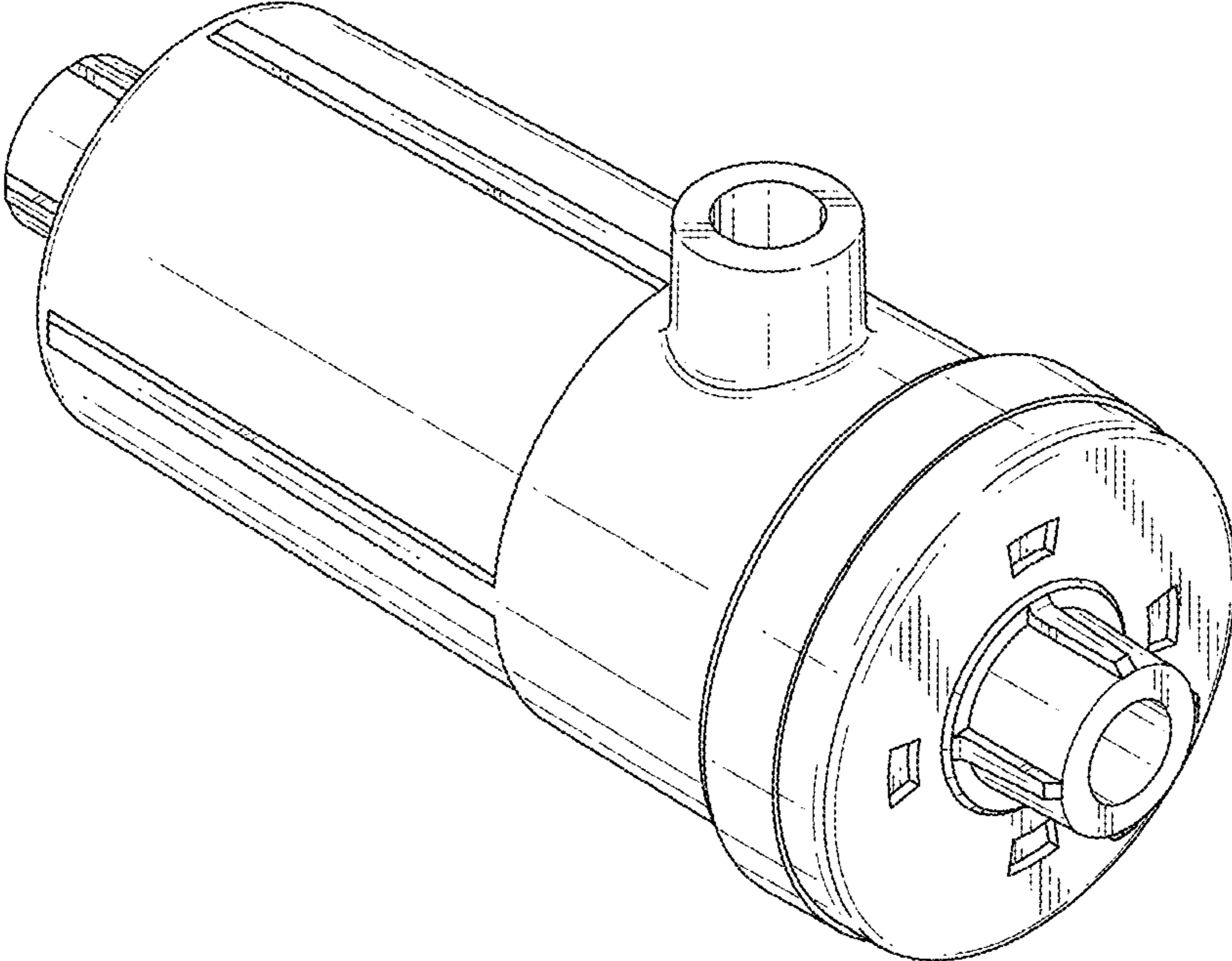

FIG. 3

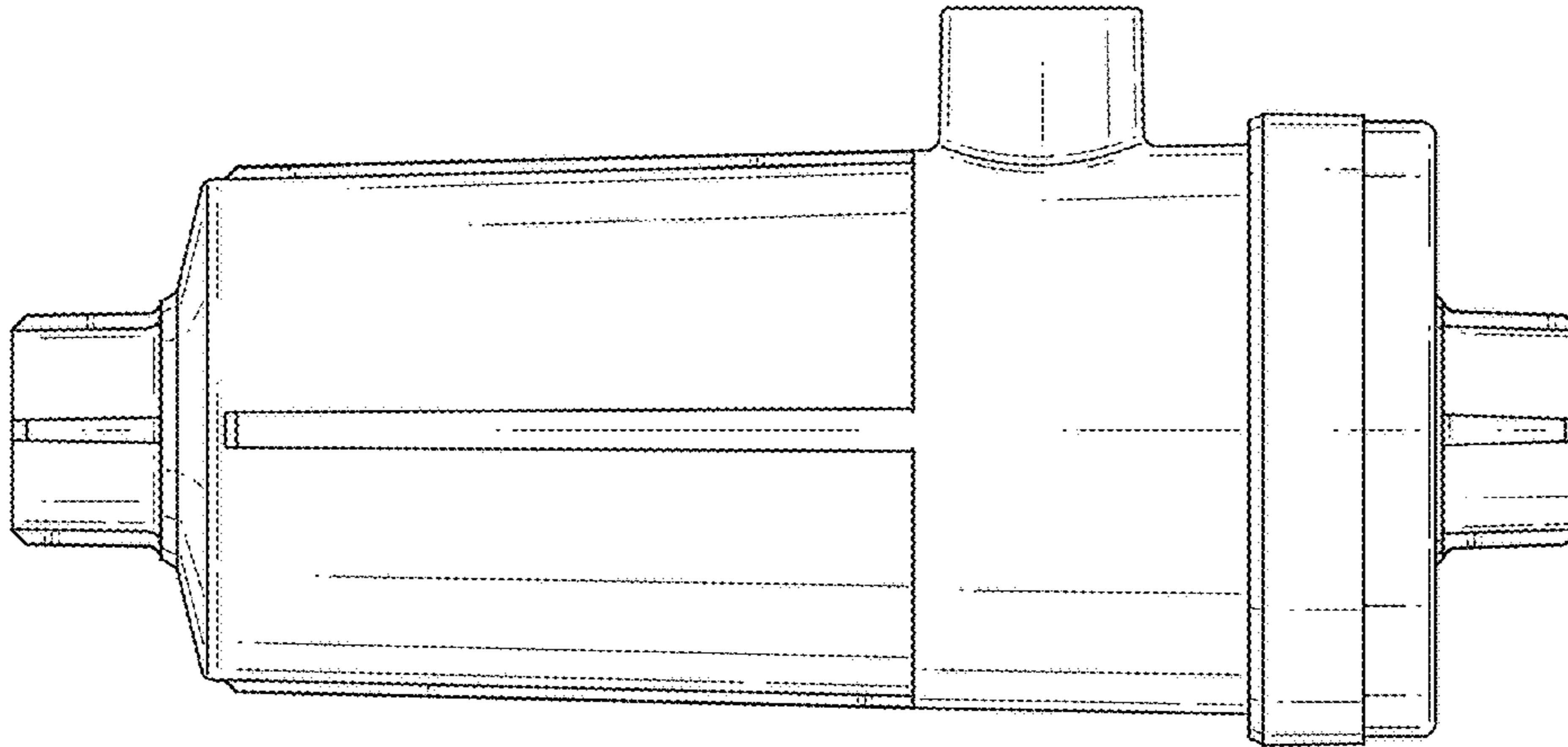

FIG. 4

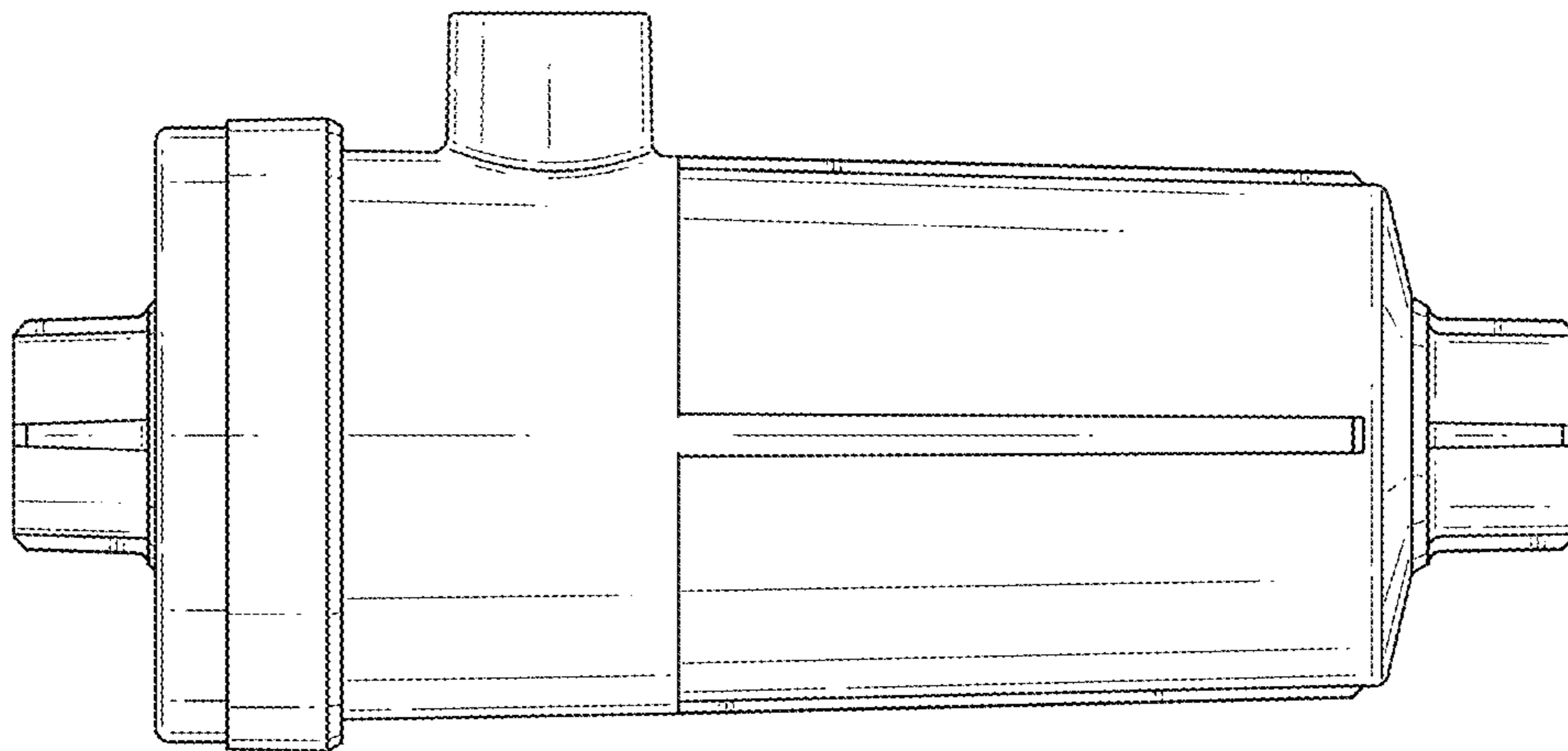

FIG. 5

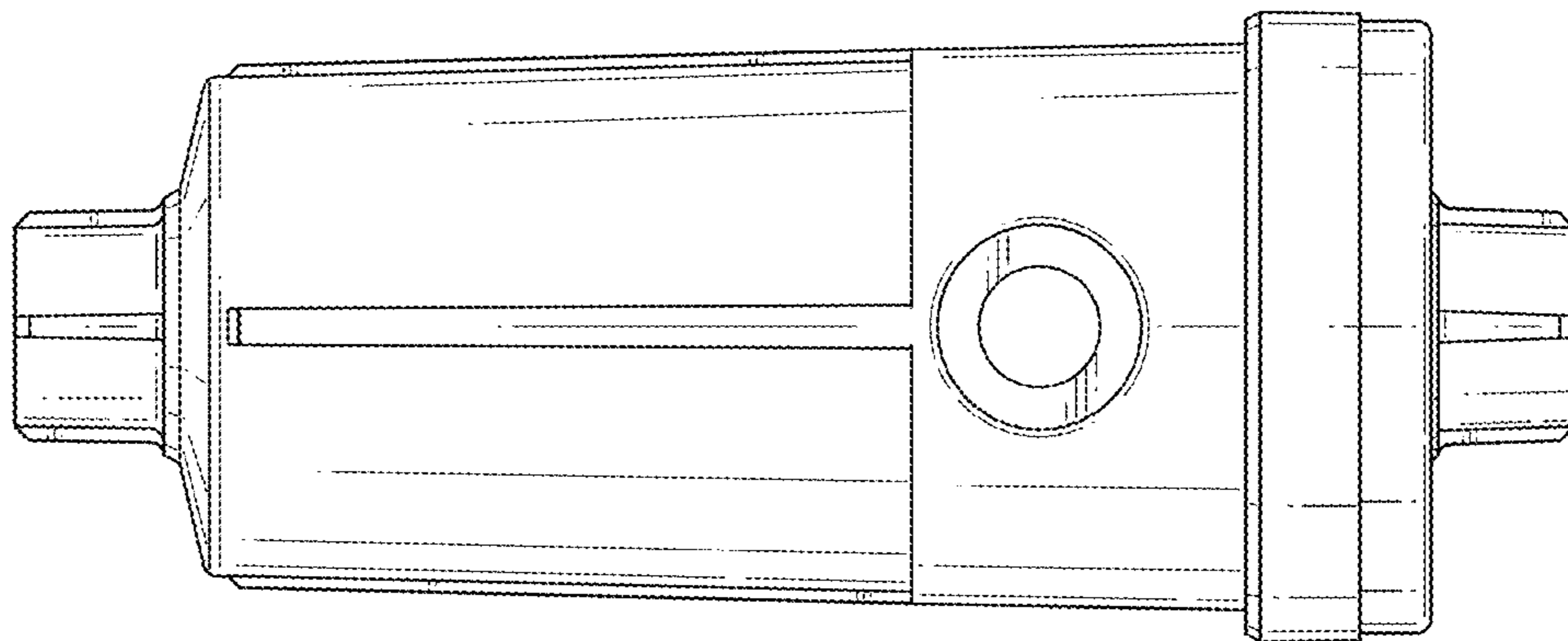

FIG. 6

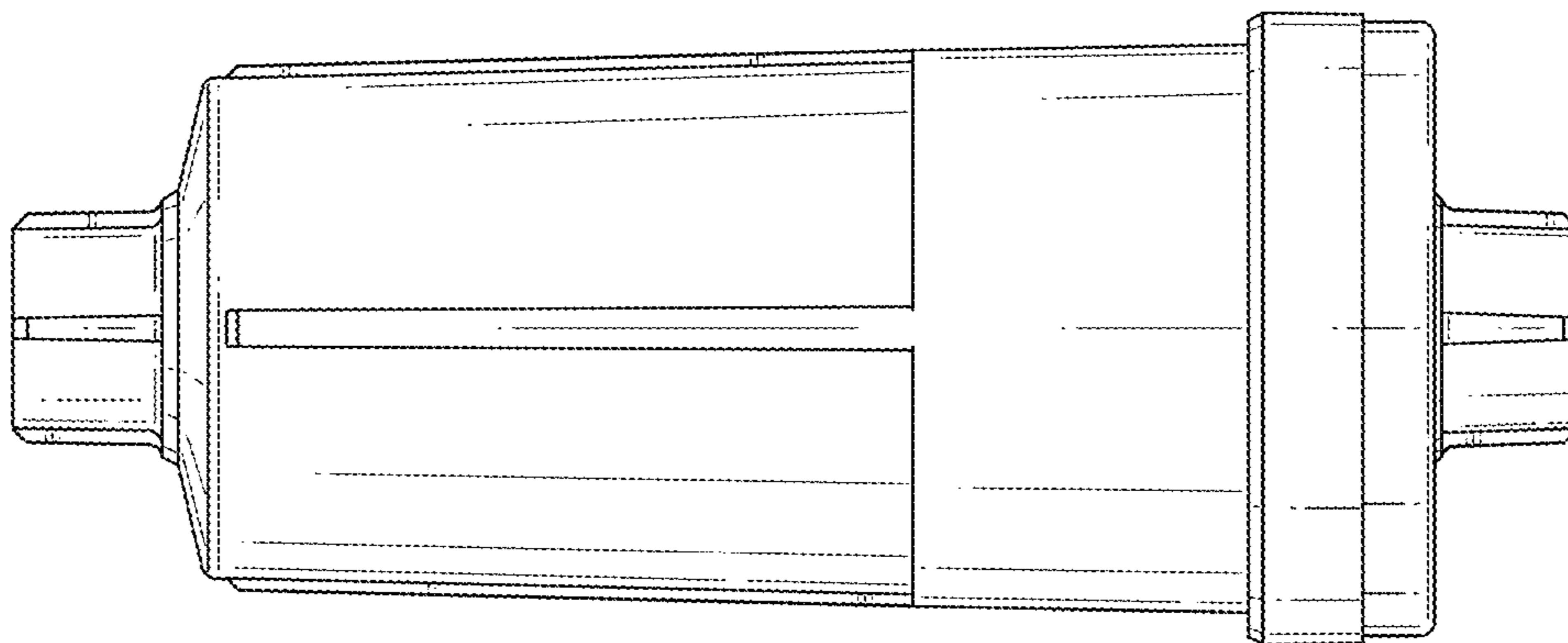

FIG. 7

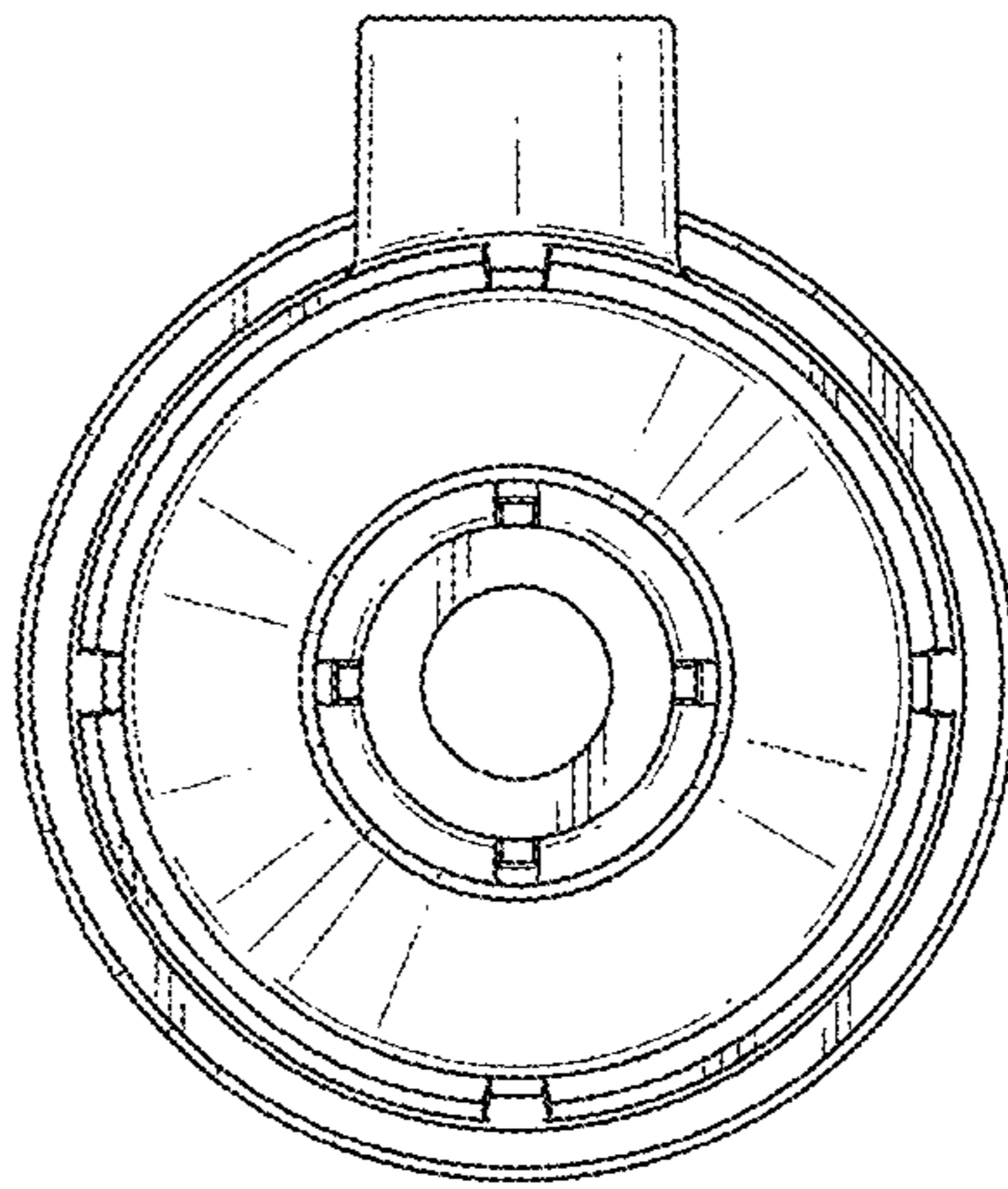

FIG. 8

