



US00D818885S

(12) **United States Design Patent** (10) **Patent No.:** **US D818,885 S**
Seo (45) **Date of Patent:** **** May 29, 2018**

(54) **RADIATOR GRILLE FOR AN AUTOMOBILE**

(71) Applicant: **Nissan Motor Co., Ltd.**, Yokohama, Kanagawa (JP)

(72) Inventor: **Kuniharu Seo**, Kanagawa (JP)

(73) Assignee: **Nissan Motor Co., Ltd.**, Yokohama (JP)

(**) Term: **15 Years**

(21) Appl. No.: **29/568,903**

(22) Filed: **Jun. 22, 2016**

(30) **Foreign Application Priority Data**

Dec. 23, 2015 (JP) 2015-028619

(51) **LOC (11) Cl.** **12-16**

(52) **U.S. Cl.**
USPC **D12/163**

(58) **Field of Classification Search**

USPC D12/86, 91, 93, 163, 164, 166, 167, 169, D12/171, 172, 173, 190, 216

CPC B62D 25/08; B62B 9/16; B60K 11/08; B60R 19/52

See application file for complete search history.

(56) **References Cited**

U.S. PATENT DOCUMENTS

D497,849 S	*	11/2004	Yanase	D12/163
D570,259 S	*	6/2008	Choi	D12/163
D592,111 S	*	5/2009	Janik	D12/163
D614,534 S	*	4/2010	Weaver	D12/90
D614,542 S	*	4/2010	Kasai	D12/163
D628,938 S	*	12/2010	Yamazaki	D12/91
D634,676 S	*	3/2011	Iida	D12/163
D637,113 S	*	5/2011	Yukawa	D12/92
D670,214 S	*	11/2012	Watanabe	D12/163

D682,752 S	*	5/2013	Yoshida	D12/163
D686,117 S	*	7/2013	Tase	D12/163
D695,645 S	*	12/2013	Tase	D12/91
D705,137 S	*	5/2014	Kawasaki	D12/163
D748,015 S	*	1/2016	Ino	D12/98
D766,782 S	*	9/2016	Arroba	D12/163
D773,341 S	*	12/2016	Liu	D12/92
D774,999 S	*	12/2016	Liu	D12/163
D783,465 S	*	4/2017	Choi	D12/163
D789,844 S	*	6/2017	Sakai	D12/163
D789,845 S	*	6/2017	Oohashi	D12/163
D792,814 S	*	7/2017	Kozub	D12/163
2017/0137954 A1	*	5/2017	Hashimoto	B60K 11/08

* cited by examiner

Primary Examiner — Susan Bennett Hattan

Assistant Examiner — Suzanne E Tisdell

(57) **CLAIM**

The ornamental design for a radiator grille for an automobile, as shown and described.

DESCRIPTION

FIG. 1 is a front elevational view of a radiator grille for an automobile in accordance with my new design;
FIG. 2 is a top plan view thereof;
FIG. 3 is a bottom plan view thereof;
FIG. 4 is a left side elevational view thereof;
FIG. 5 is a right side elevational view thereof;
FIG. 6 is a front-right-top side perspective view thereof;
FIG. 7 is a front-left-bottom side perspective view thereof;
and,

FIG. 8 is an enlarged cross-sectional view thereof, taken in the direction of a section line 8-8' in FIG. 1.

The broken line shown on the radiator grille is for purpose of illustrating environmental structure and forms no part of the claimed design. The rear view of the radiator grille forms no part of the claimed design.

1 Claim, 8 Drawing Sheets

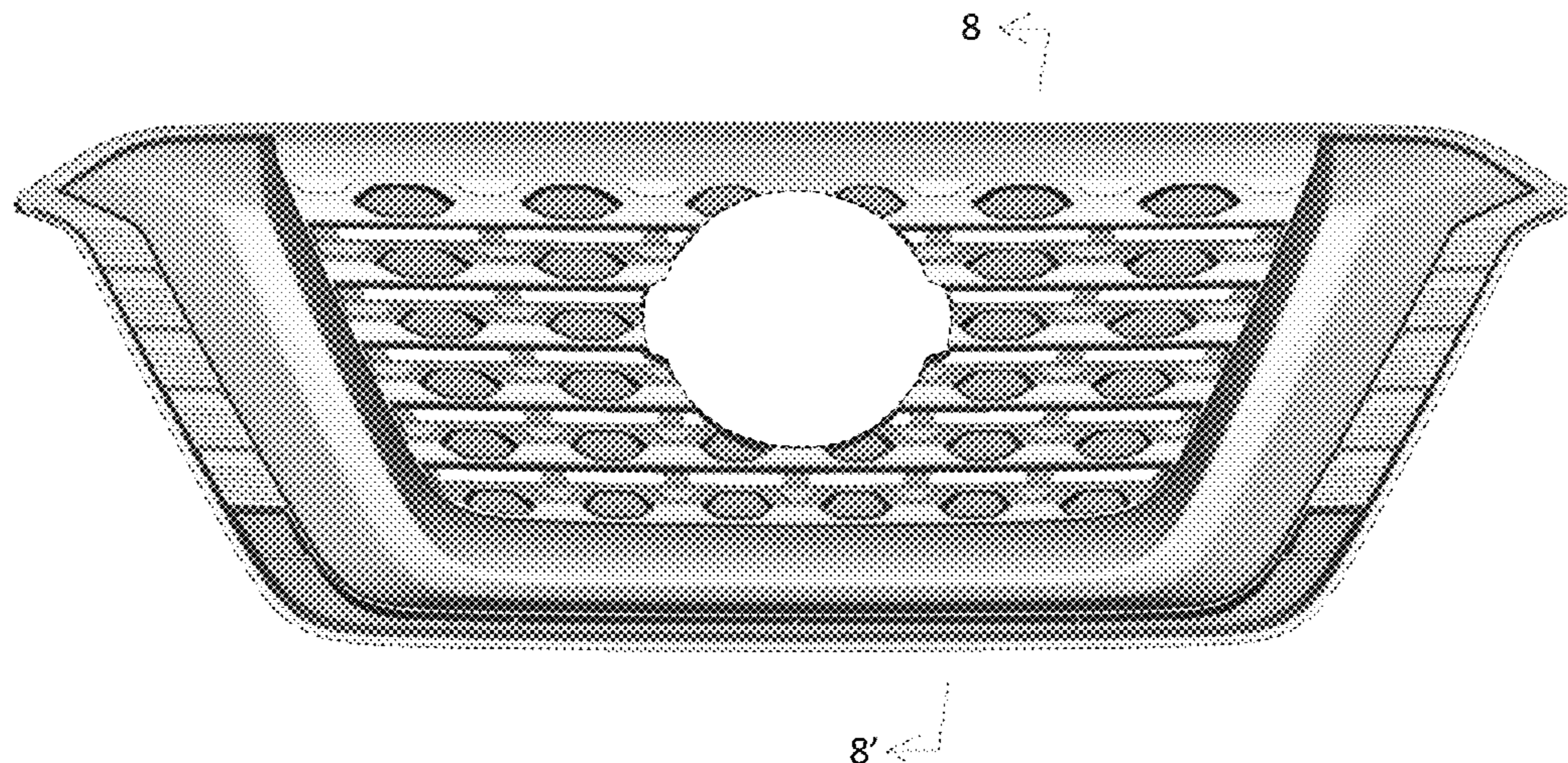

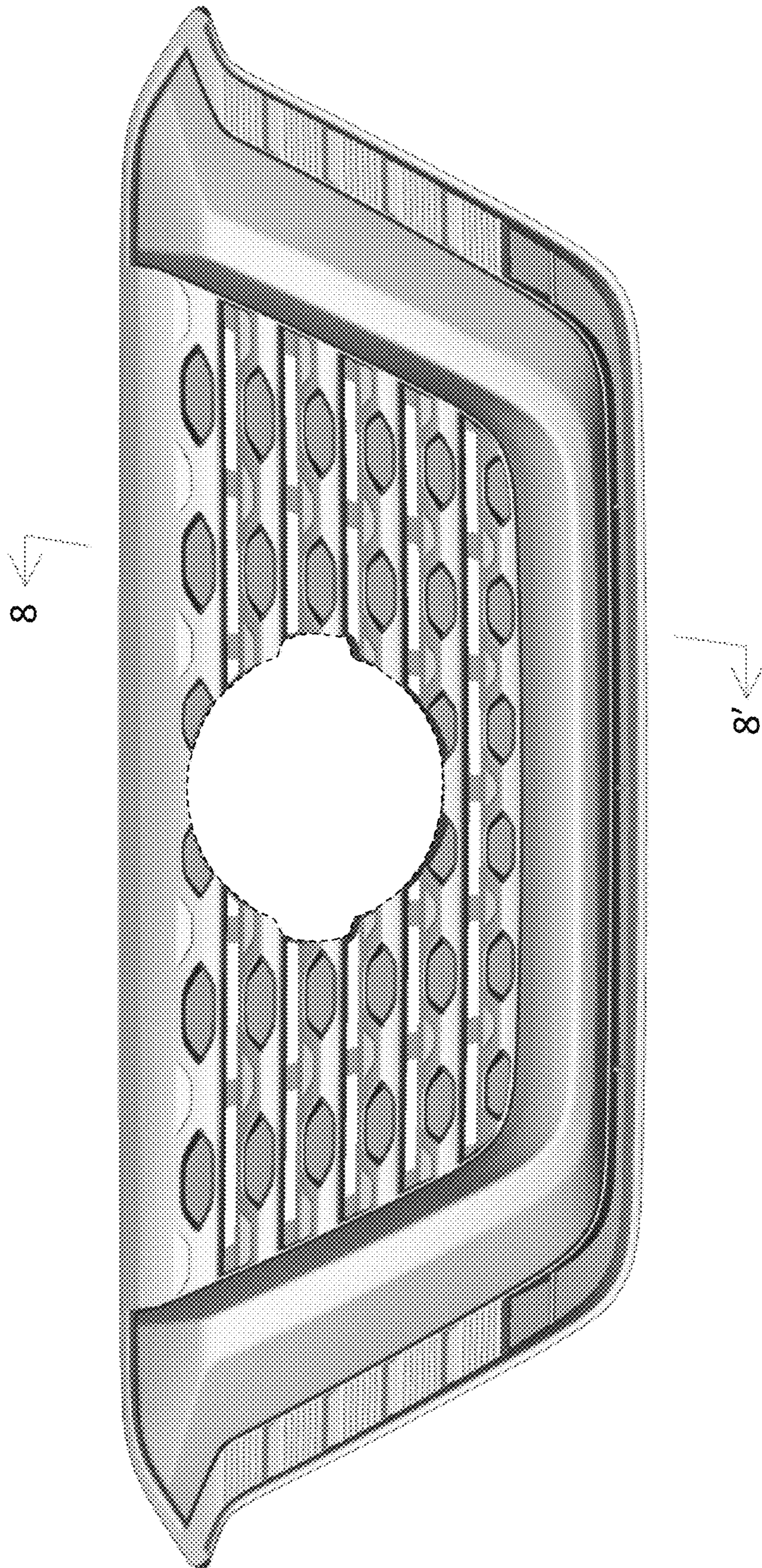

FIG. 1

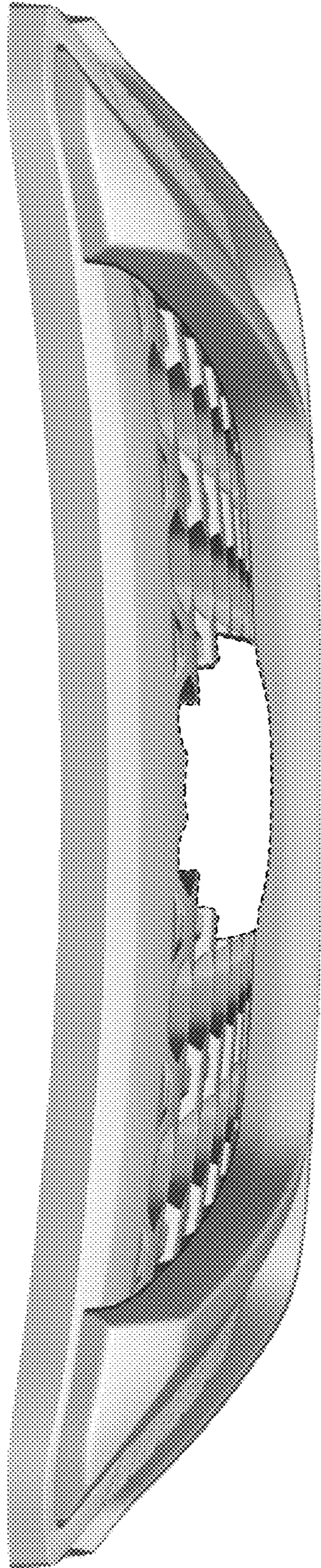

FIG. 2

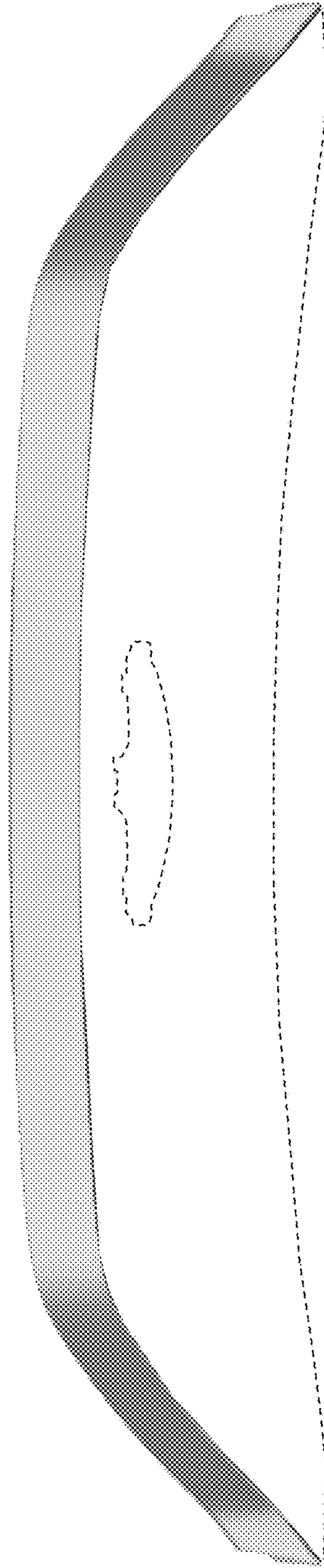

FIG. 3

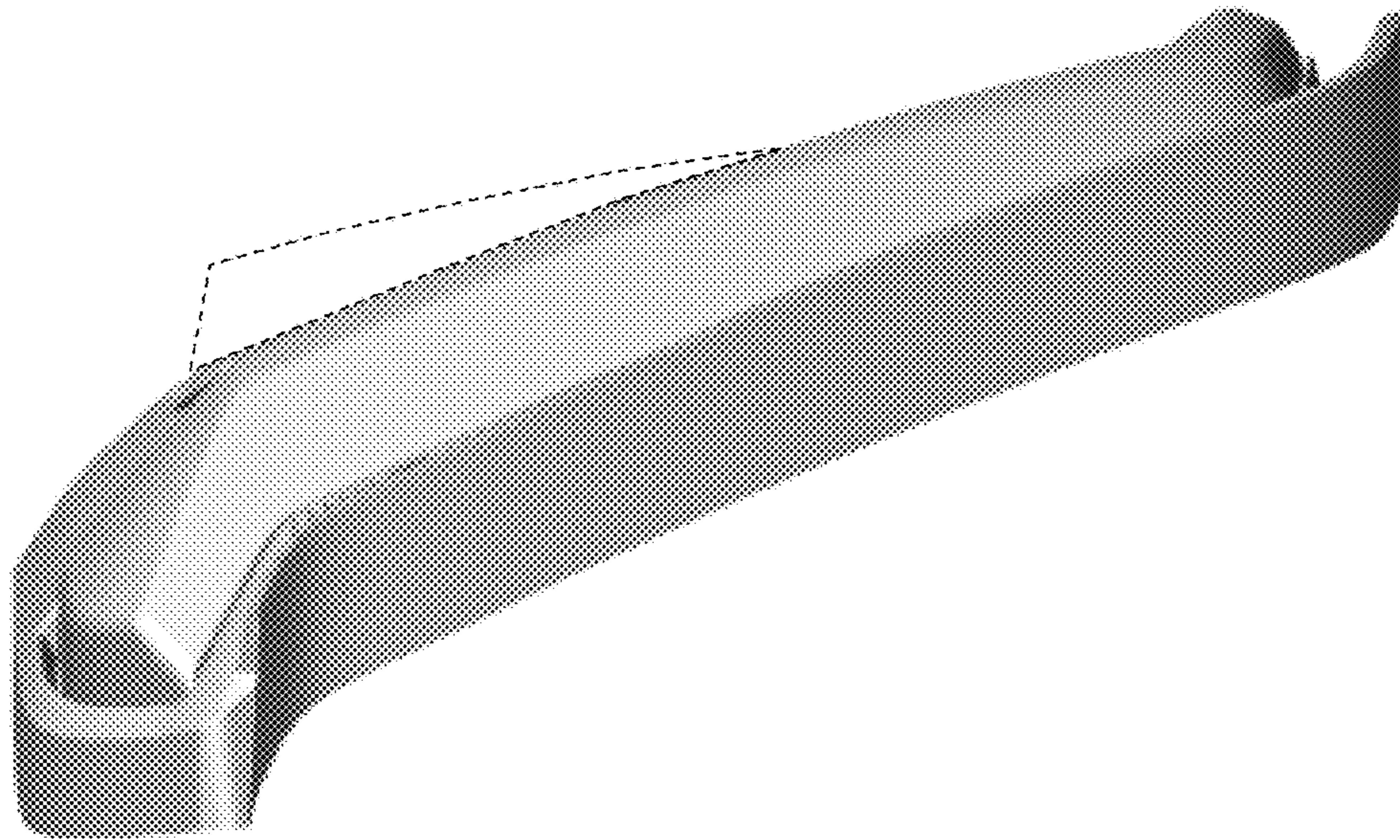

FIG. 4

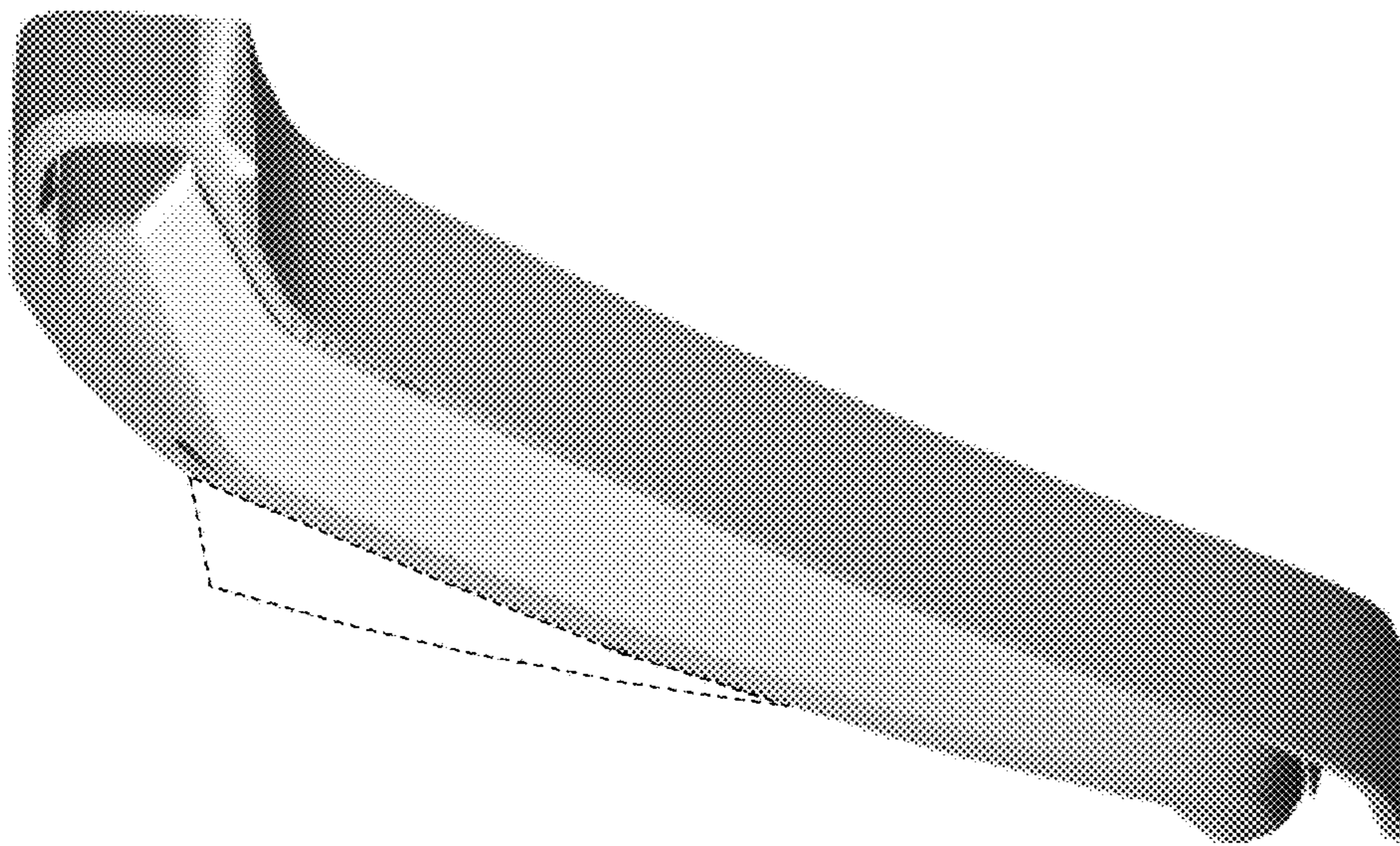

FIG. 5



FIG. 6

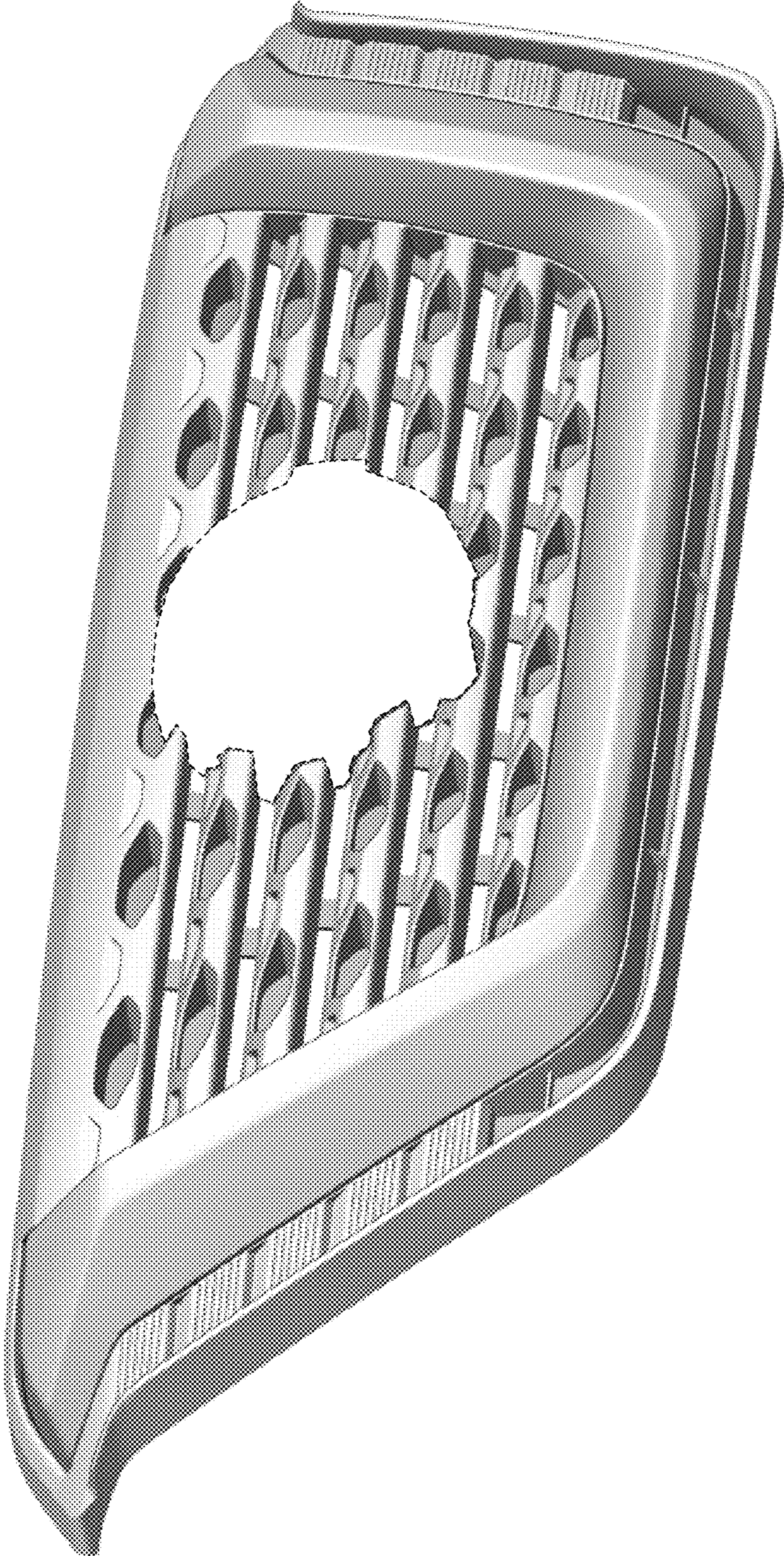

FIG. 7

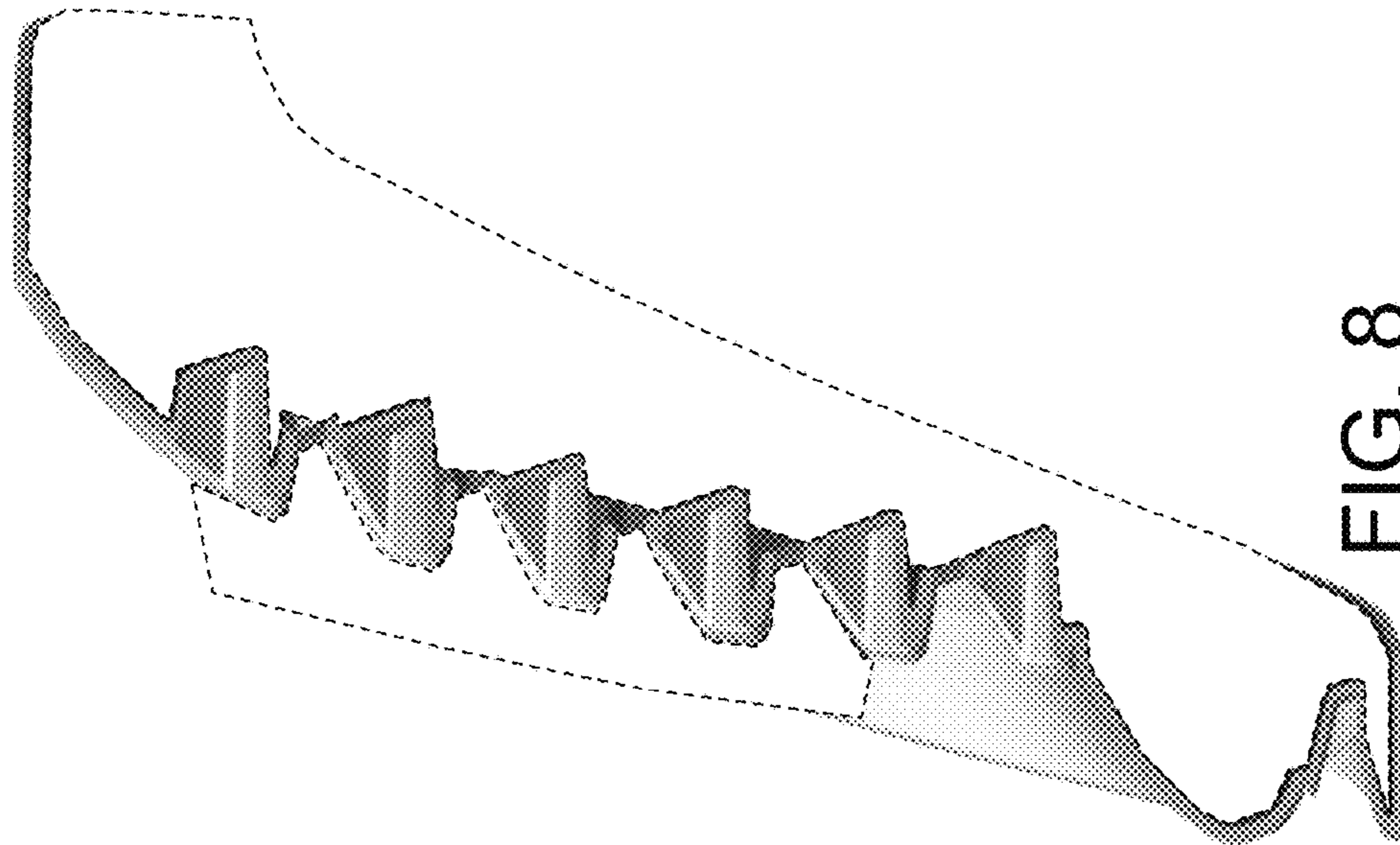

FIG. 8