



US00D818428S

(12) **United States Design Patent** (10) **Patent No.:** **US D818,428 S**  
**Mori** (45) **Date of Patent:** **\*\* May 22, 2018**

(54) **SPIKE PIN FOR AUTOMOBILE TIRE**  
(71) Applicant: **THE YOKOHAMA RUBBER CO., LTD.**, Minato-ku, Tokyo (JP)  
(72) Inventor: **Masakazu Mori**, Hiratsuka (JP)  
(73) Assignee: **THE YOKOHAMA RUBBER CO., LTD.**, Minato-ku, Tokyo (JP)

D775,586 S *	1/2017	Matsumoto	.....	D12/608
D776,047 S *	1/2017	Matsumoto	.....	D12/608
D776,048 S *	1/2017	Matsumoto	.....	D12/608
D776,049 S *	1/2017	Matsumoto	.....	D12/608
D777,097 S *	1/2017	Matsumoto	.....	D12/608
D790,448 S *	6/2017	Yoon	.....	D12/605
D790,449 S *	6/2017	Yoon	.....	D12/605
D792,841 S *	7/2017	Yoon	.....	D12/605
D800,053 S *	10/2017	Yoon	.....	D12/604
2013/0000807 A1 *	1/2013	Pons	.....	B60C 11/1643 152/210

(\*\*) Term: **15 Years**

\* cited by examiner

(21) Appl. No.: **29/595,458**

*Primary Examiner* — George D. Kirschbaum

*Assistant Examiner* — Clese Moore, Jr.

(22) Filed: **Feb. 28, 2017**

(74) *Attorney, Agent, or Firm* — Banner & Witcoff, Ltd.

(30) **Foreign Application Priority Data**

(57) **CLAIM**

Aug. 30, 2016 (JP) ..... 2016-018474

The ornamental design for a spike pin for automobile tire, as shown and described.

(51) **LOC (11) Cl.** ..... **12-15**

**DESCRIPTION**

(52) **U.S. Cl.**

USPC ..... **D12/608**; D12/604

(58) **Field of Classification Search**

USPC ..... D12/604–608, 501, 544, 579

CPC ... B60C 27/08; B60C 27/086; B60C 27/0223;

B60C 11/1675; B60C 11/14

See application file for complete search history.

FIG. 1 is a perspective view of a spike pin for an automobile tire showing my new design;

FIG. 2 is a front view thereof;

FIG. 3 is a right side view thereof;

FIG. 4 is a top view thereof;

FIG. 5 is a bottom view thereof;

FIG. 6 is a cross sectional view taken along lines 6-6 shown in FIG. 2; and,

FIG. 7 is a cross sectional view taken along lines 7-7 shown in FIG. 3.

A rear view appears to be identical to the front view and is omitted. A left side view appears to be identical to the right side view and is omitted. The thin lines shown in the views are for clarifying the shape of the three-dimensional surface.

(56) **References Cited**

**U.S. PATENT DOCUMENTS**

D584,979 S *	1/2009	Pirhonen	.....	D12/608
D608,233 S *	1/2010	Pirhonen	.....	D12/608
D609,127 S *	2/2010	Pirhonen	.....	D12/608
D706,709 S *	6/2014	Matsumoto	.....	D12/608
D708,567 S *	7/2014	Matsumoto	.....	D12/608
D774,449 S *	12/2016	Matsumoto	.....	D12/608
D775,585 S *	1/2017	Matsumoto	.....	D12/608

**1 Claim, 7 Drawing Sheets**

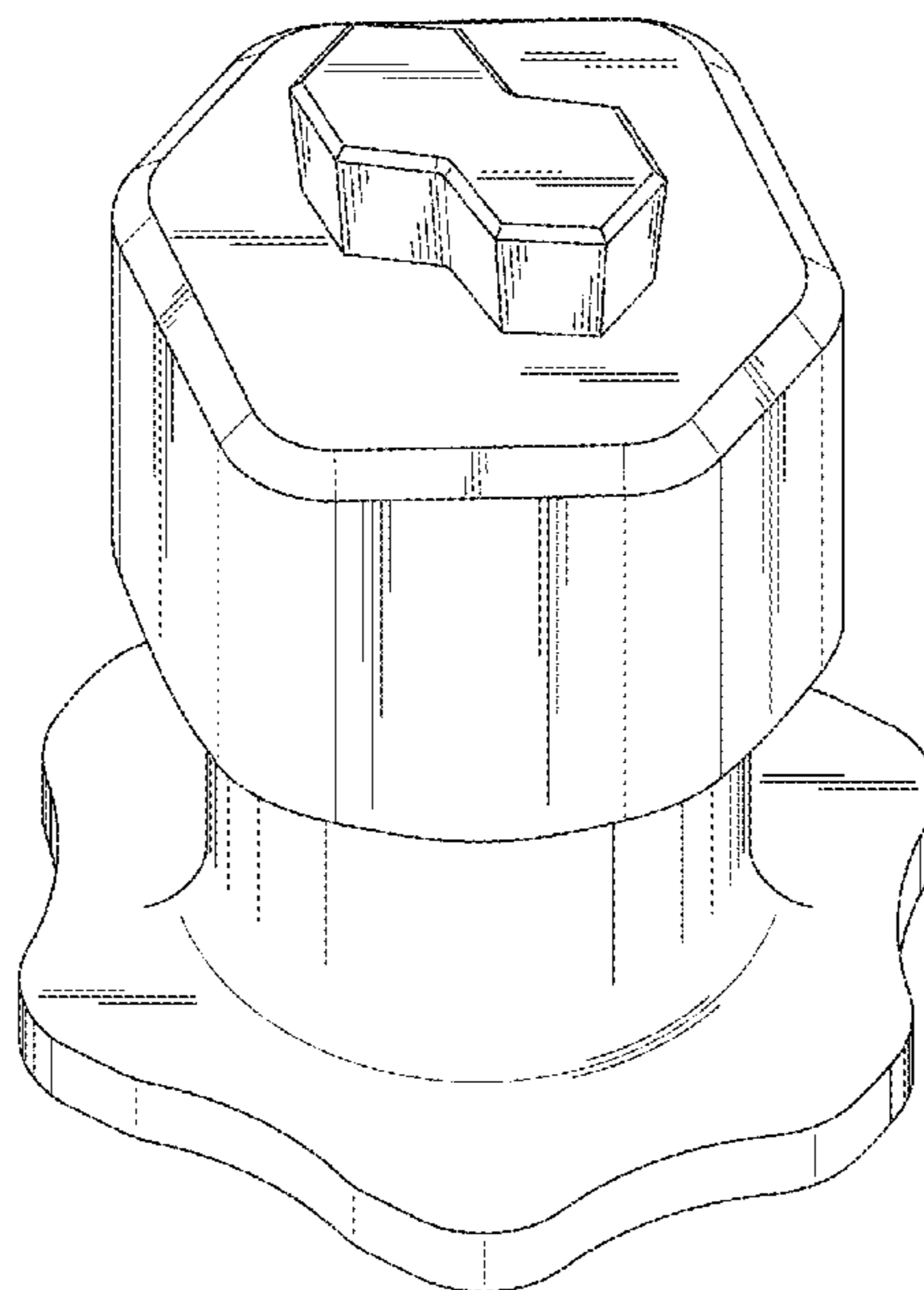

**FIG. 1**

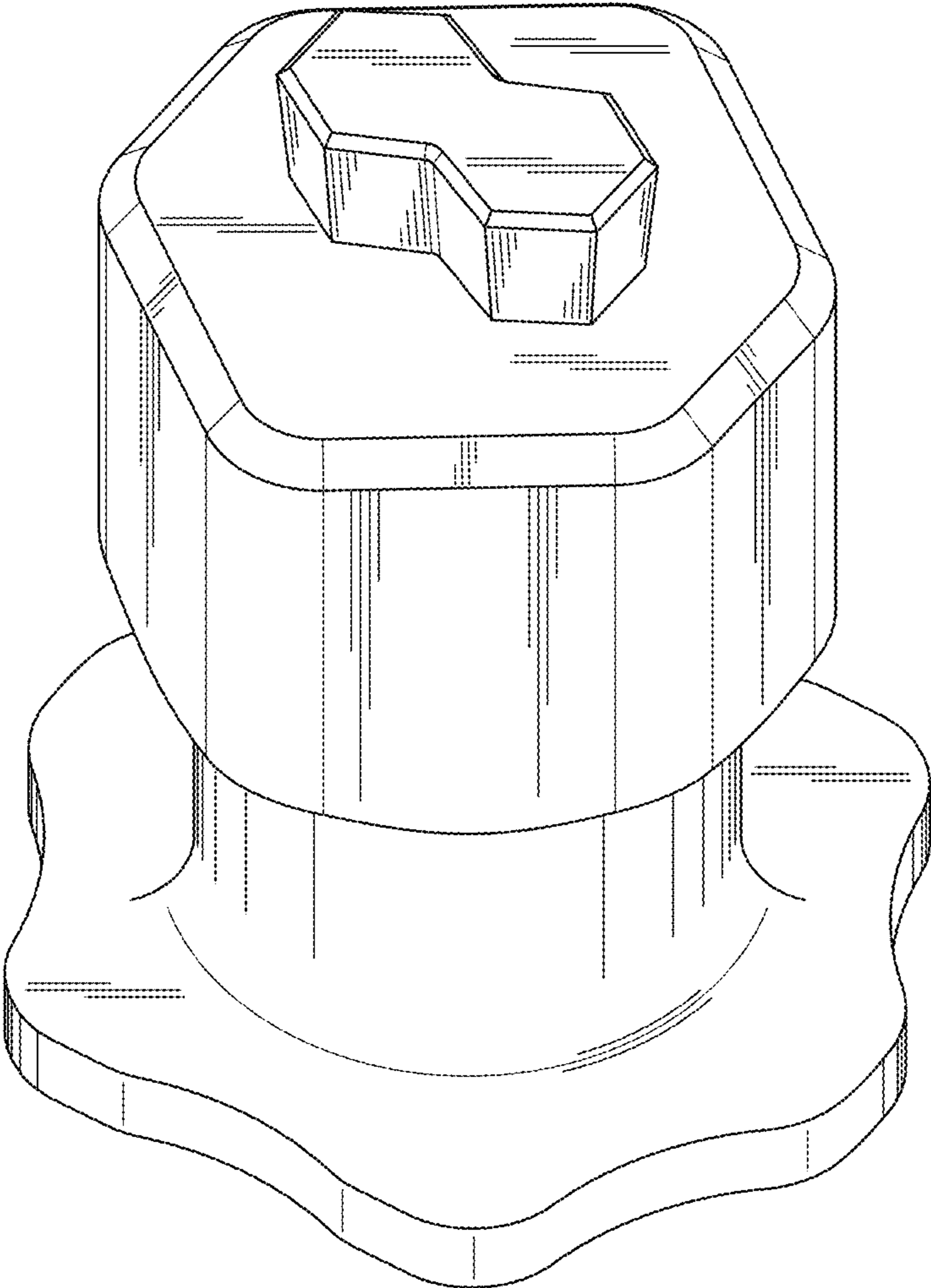

**FIG. 2**

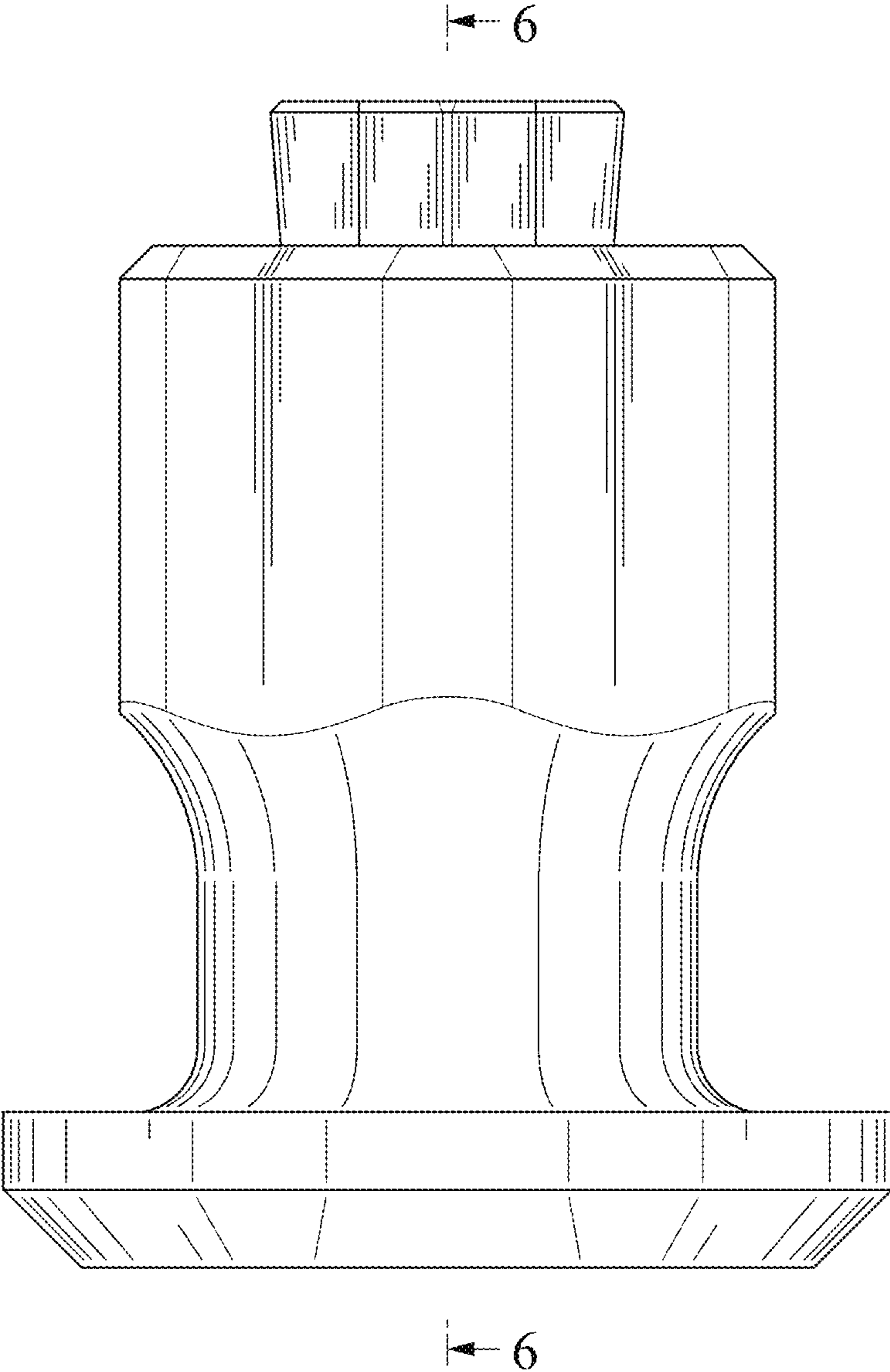

**FIG. 3**

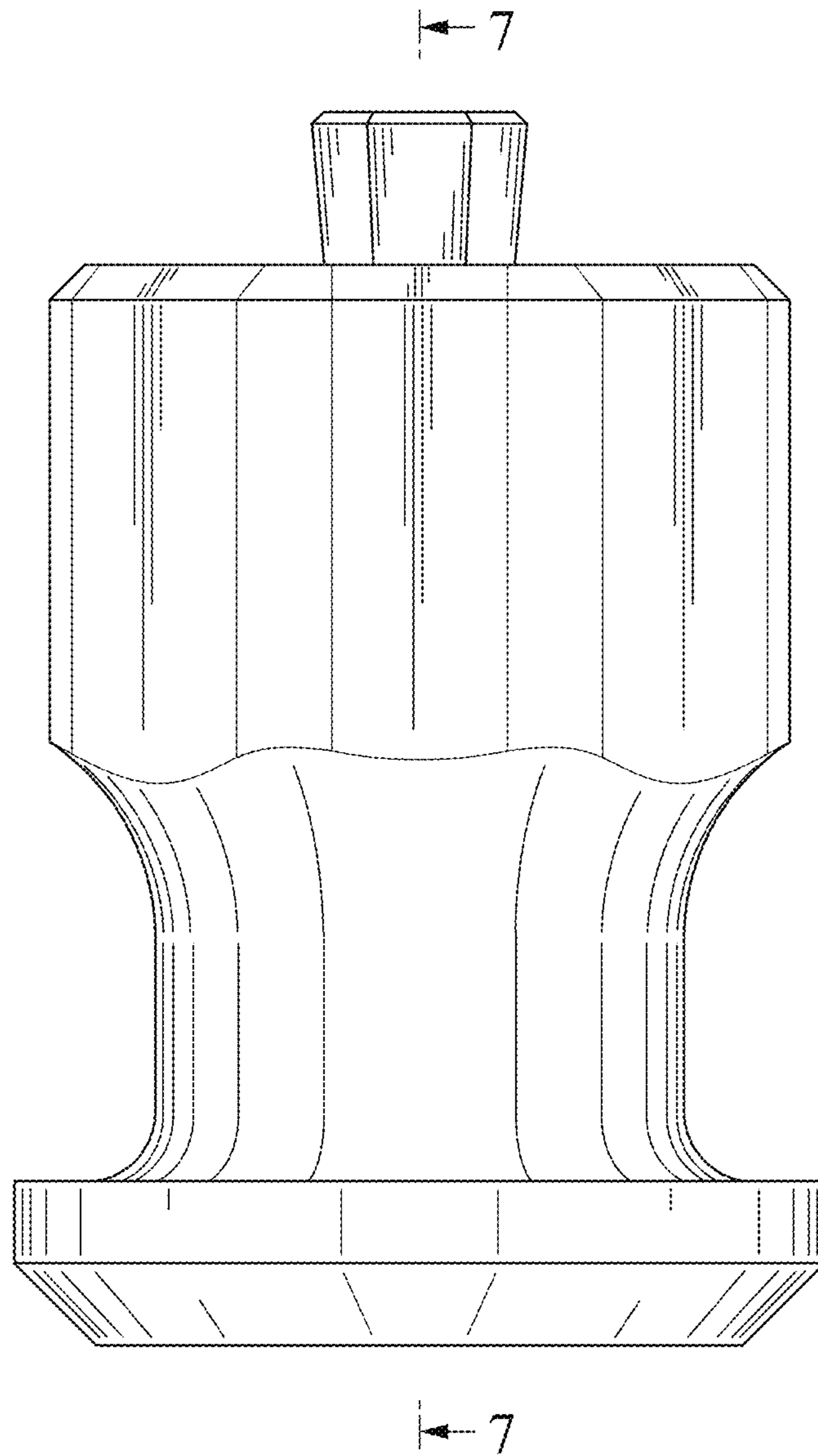

**FIG. 4**

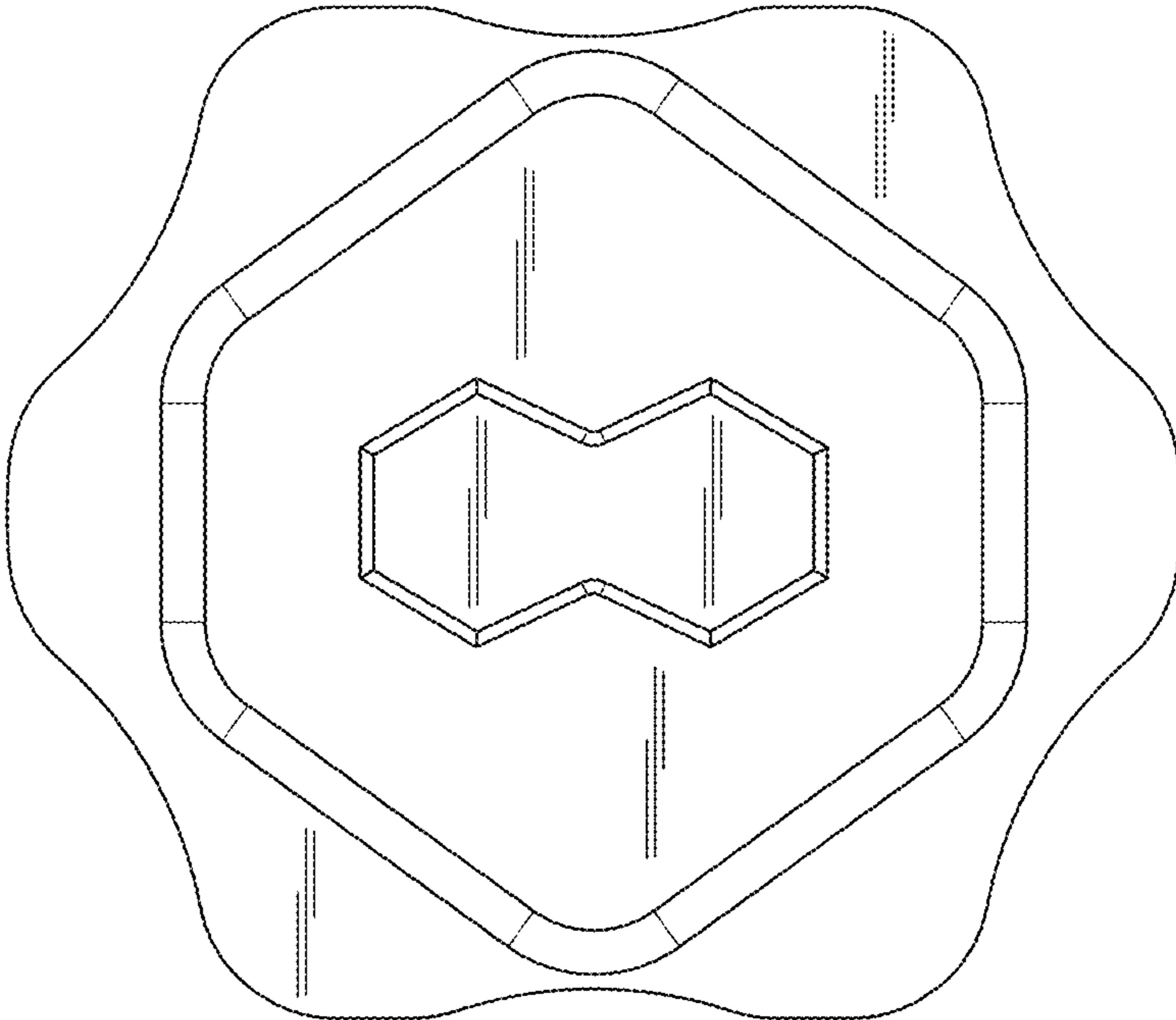

**FIG. 5**

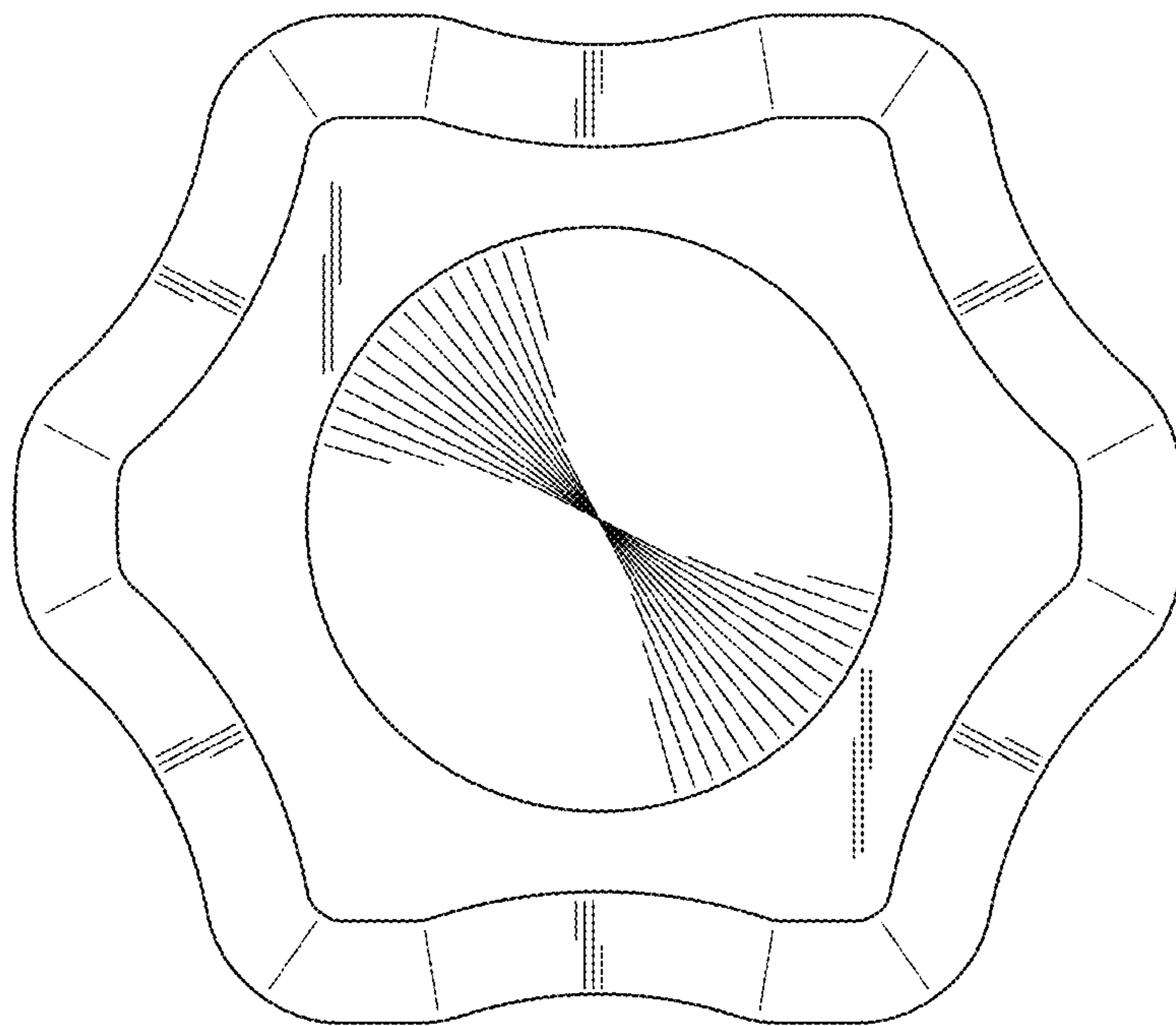

**FIG. 6**

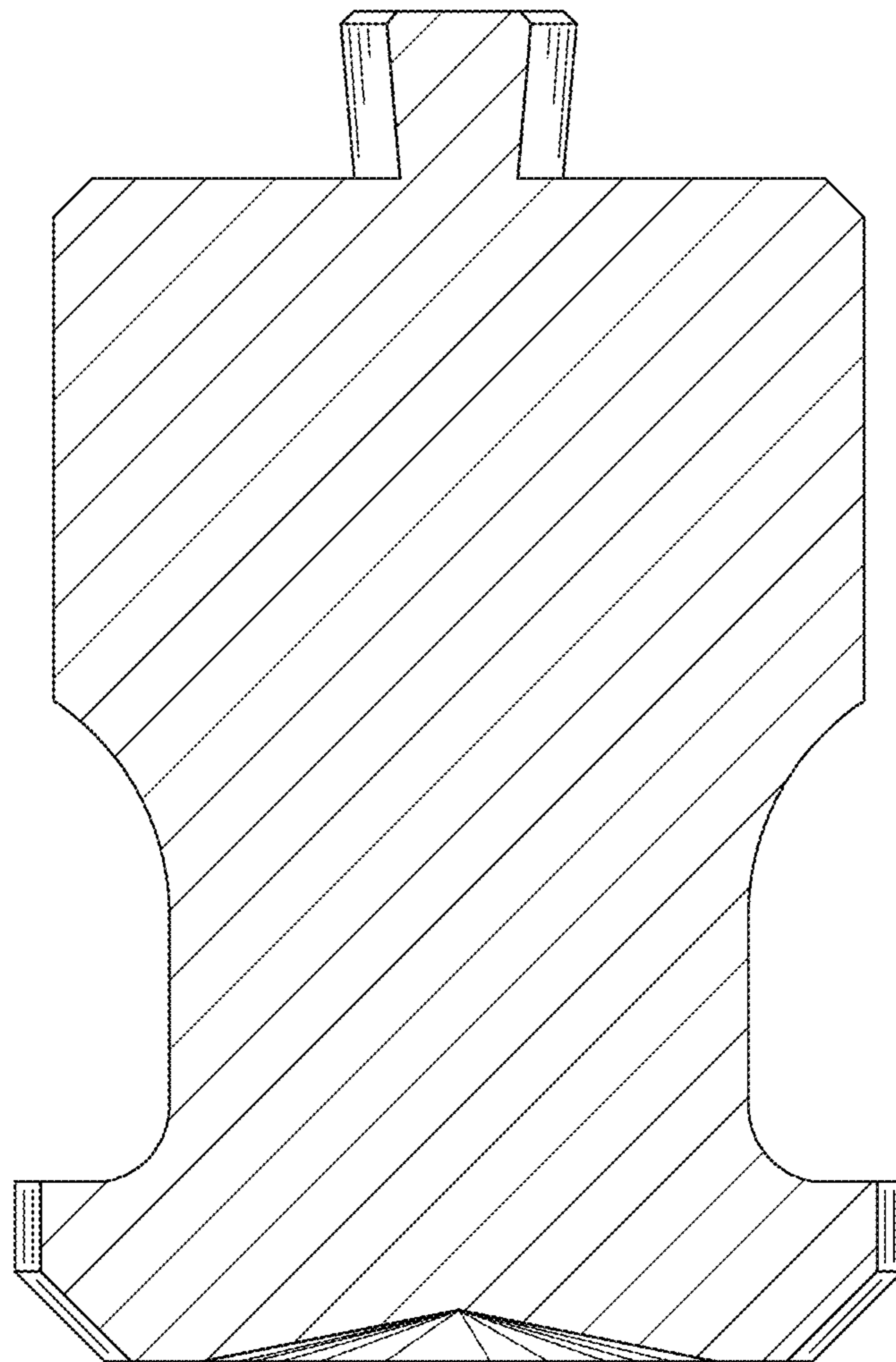

**FIG. 7**

