



US00D817461S

(12) **United States Design Patent**  
**Downey et al.**

(10) **Patent No.:** **US D817,461 S**

(45) **Date of Patent:** **\*\* May 8, 2018**

(54) **TUB SPOUT**

(71) Applicant: **Spectrum Brands, Inc.**, Middleton, WI (US)

(72) Inventors: **David Downey**, Mission Viejo, CA (US); **Tony Zhang**, Xiamen (CN)

(73) Assignee: **Spectrum Brands, Inc.**, Middleton, WI (US)

(\*\*) Term: **15 Years**

(21) Appl. No.: **29/590,066**

(22) Filed: **Jan. 6, 2017**

(51) **LOC (11) Cl.** ..... **23-01**

(52) **U.S. Cl.**  
USPC ..... **D23/255**

(58) **Field of Classification Search**  
USPC ..... D23/237, 238, 240-243, 249, 255, 257;  
D6/524  
CPC ..... E03C 1/0401; E03C 1/04; E03C 1/0402;  
E03C 1/0404; B25B 23/16; C02F 1/50;  
A47K 5/14; Y10T 137/9464  
See application file for complete search history.

(56) **References Cited**

**U.S. PATENT DOCUMENTS**

D462,750 S 9/2002 Lord  
D463,534 S \* 9/2002 Lord ..... D23/255

D463,536 S 9/2002 Lord  
D531,279 S \* 10/2006 Blomstrom ..... D23/255  
D531,705 S \* 11/2006 Green ..... D23/255  
D626,634 S 11/2010 Lammel et al.  
D710,975 S 8/2014 Huang  
D752,189 S \* 3/2016 Georgeson ..... D23/257  
D790,671 S \* 6/2017 Zhang ..... D23/257  
D791,284 S \* 7/2017 Zhang ..... D23/257

\* cited by examiner

*Primary Examiner* — Robert M. Spear

*Assistant Examiner* — John A Voytek

(74) *Attorney, Agent, or Firm* — Banner & Witcoff, Ltd.

(57) **CLAIM**

The ornamental design for a tub spout, as shown and described.

**DESCRIPTION**

FIG. 1 is a front perspective view of a tub spout showing our new design;

FIG. 2 is a right side view thereof;

FIG. 3 is a left side view thereof;

FIG. 4 is a top view thereof;

FIG. 5 is a bottom view thereof;

FIG. 6 is a front view thereof; and,

FIG. 7 is a rear view thereof.

The broken line showing of the various unshaded regions represents unclaimed subject matter and forms no part of the claimed design.

**1 Claim, 5 Drawing Sheets**

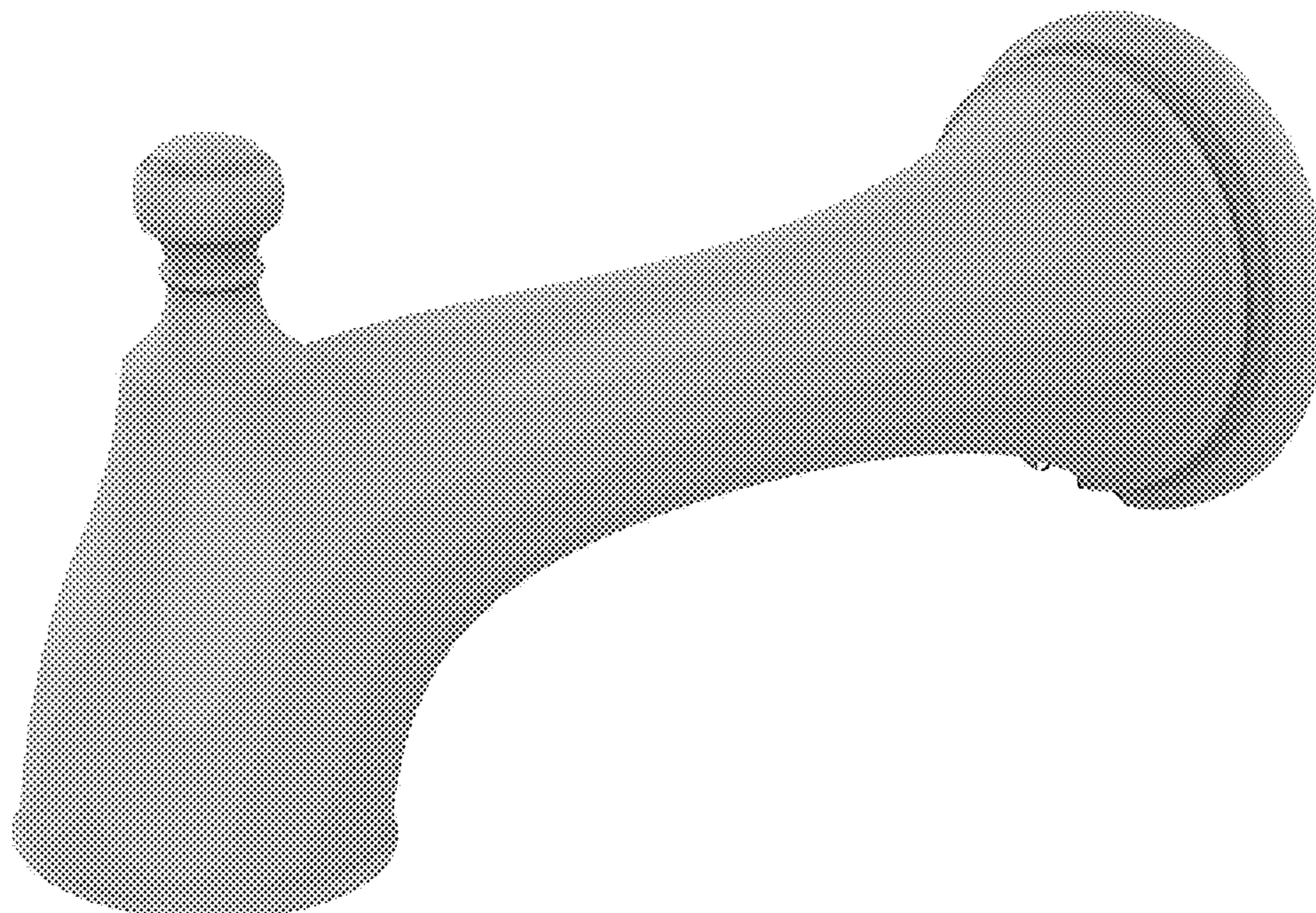



FIG. 1



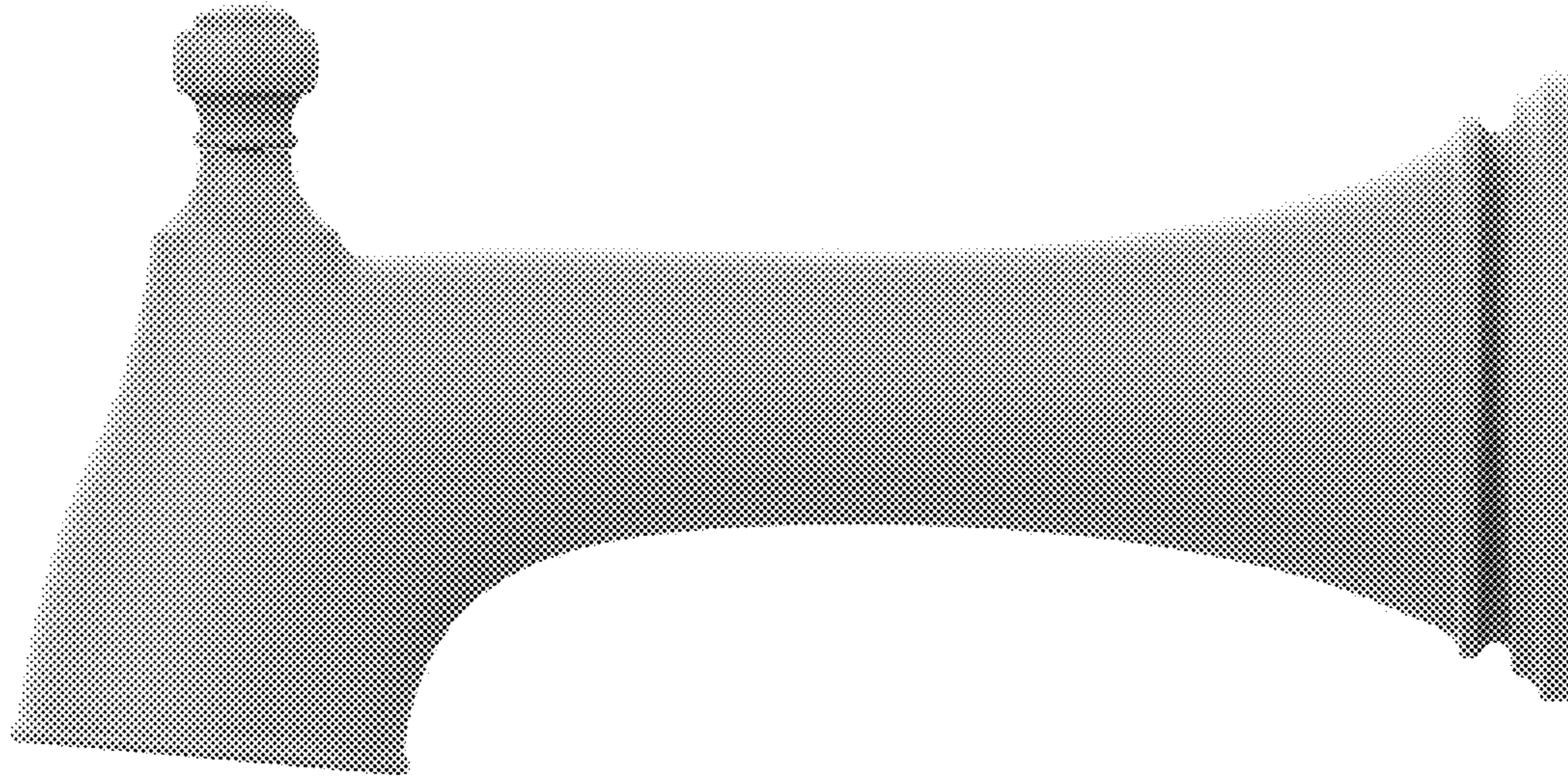

FIG. 2

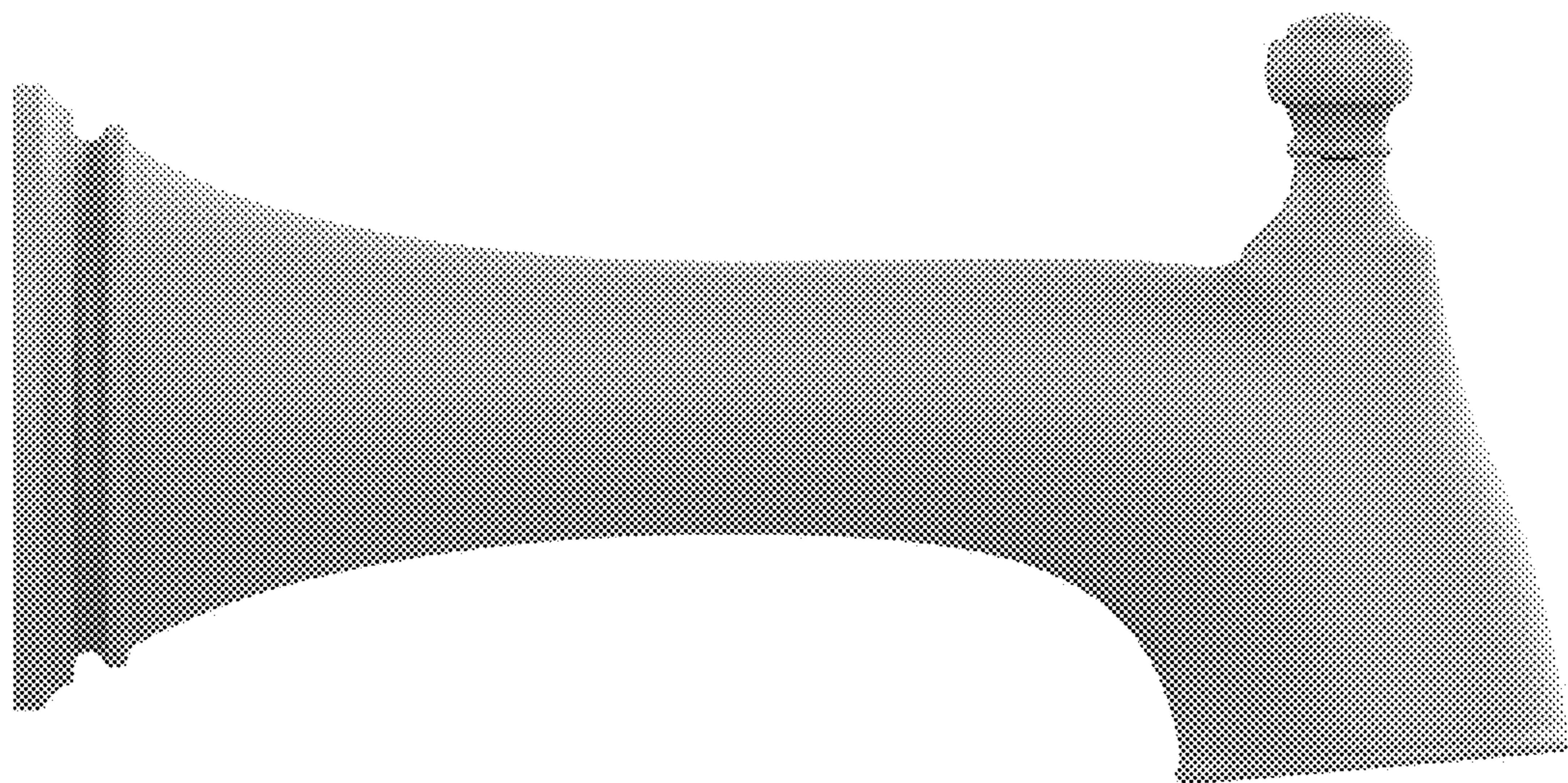

FIG. 3

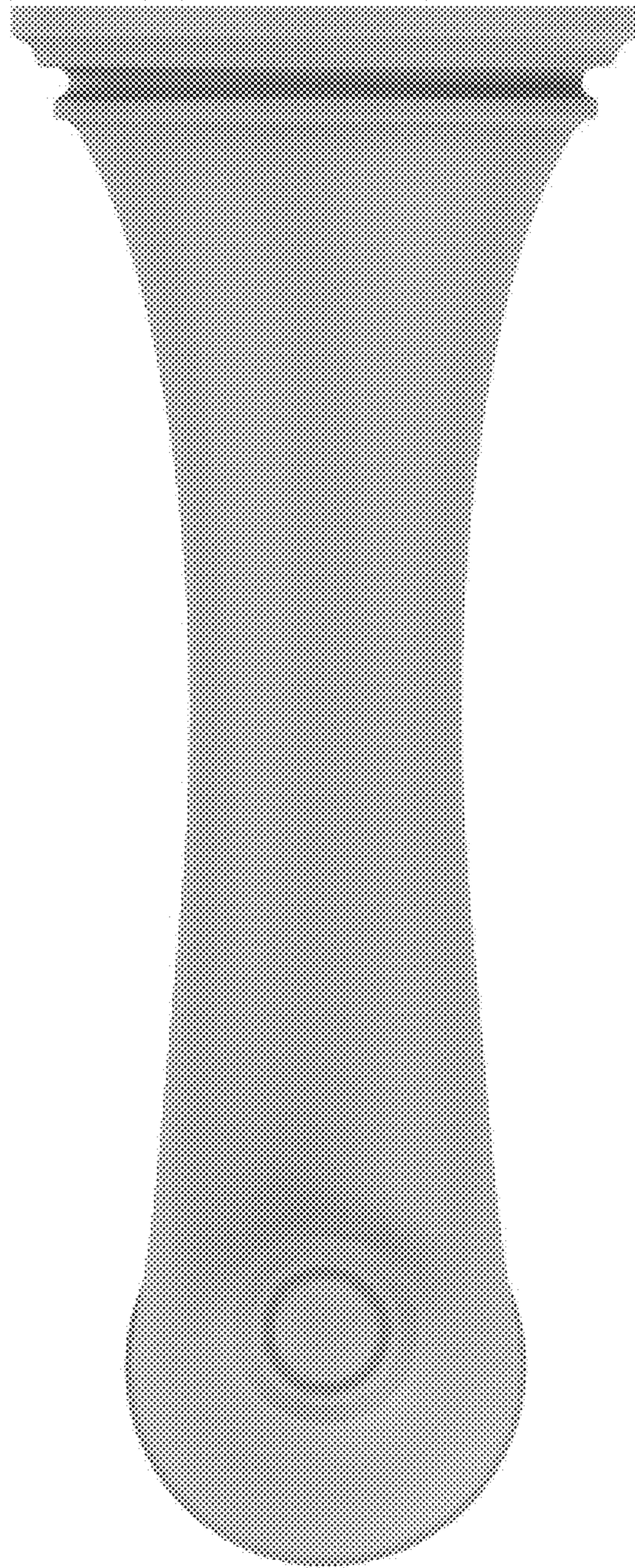

FIG. 4



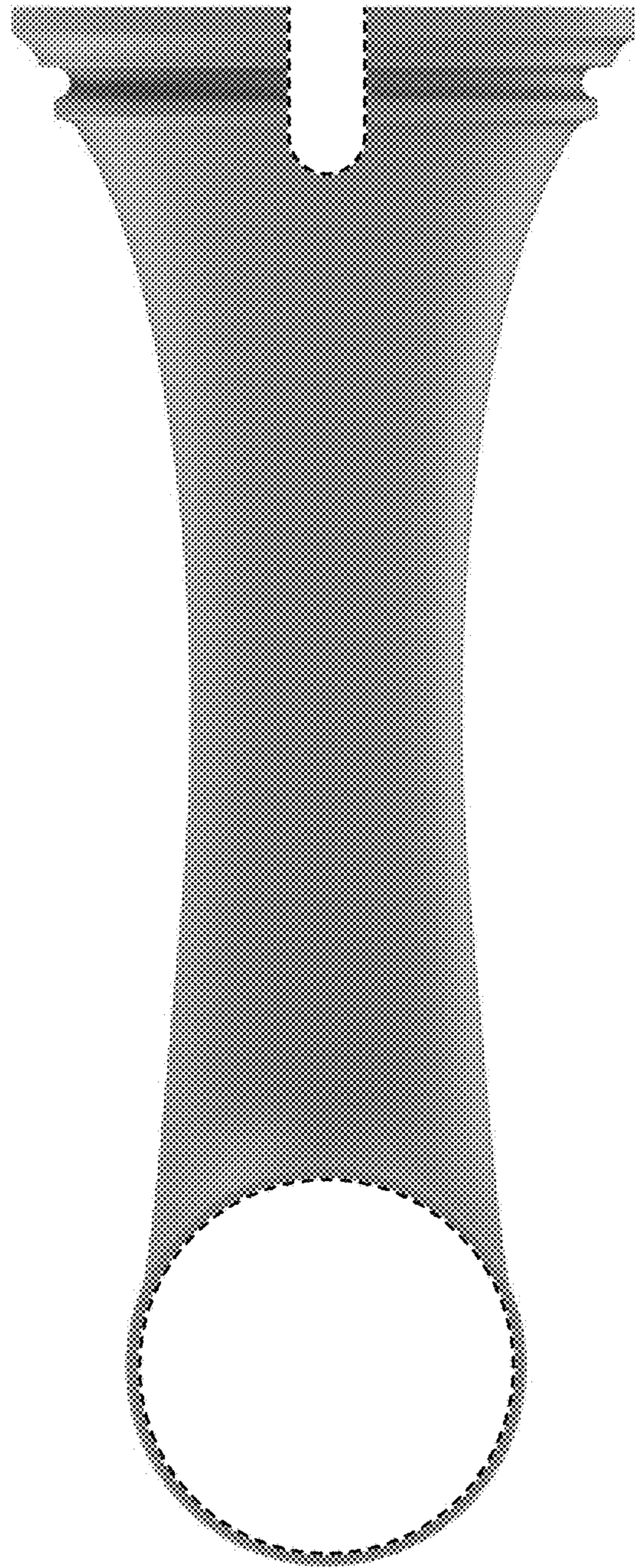

FIG. 5

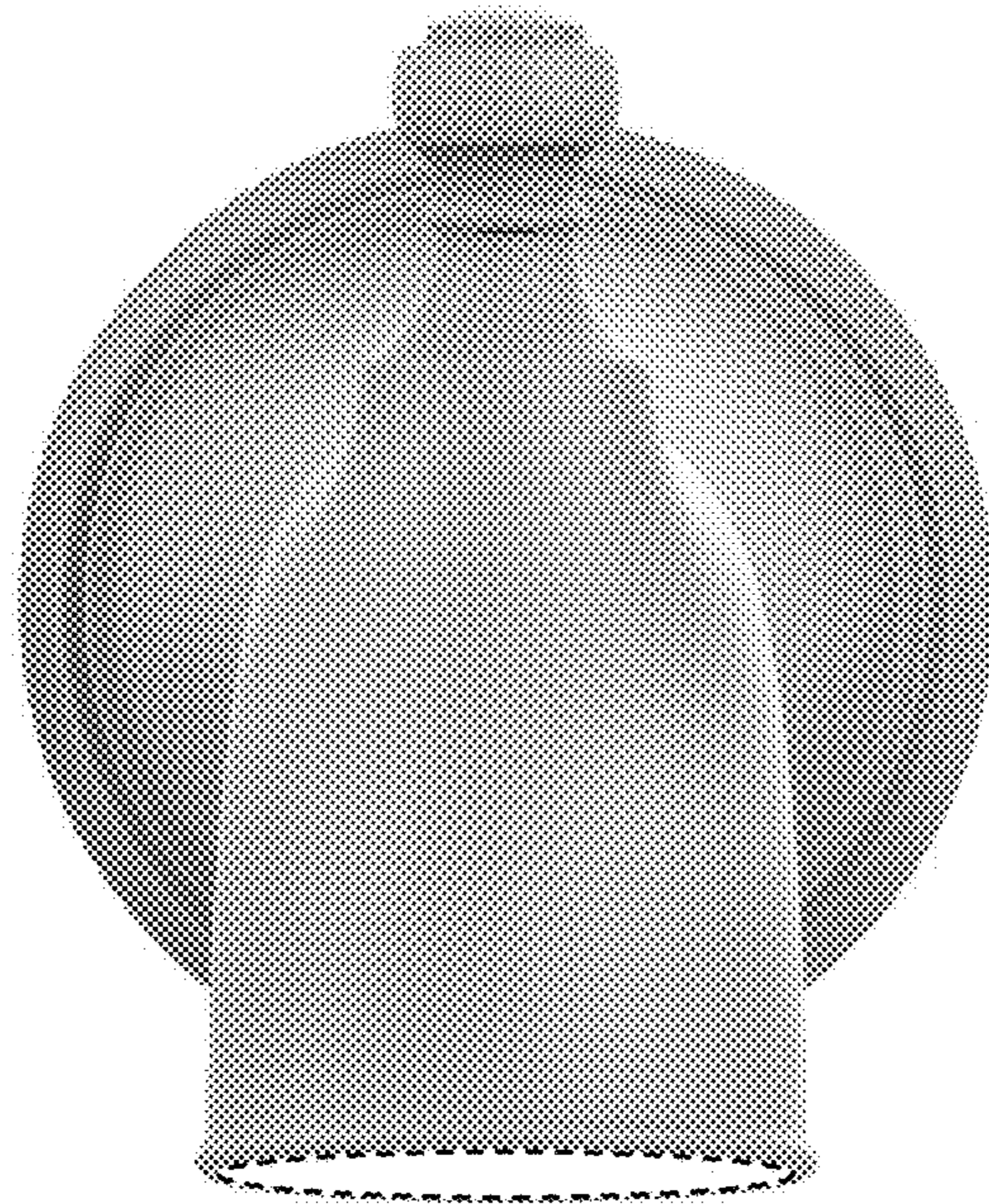

FIG. 6

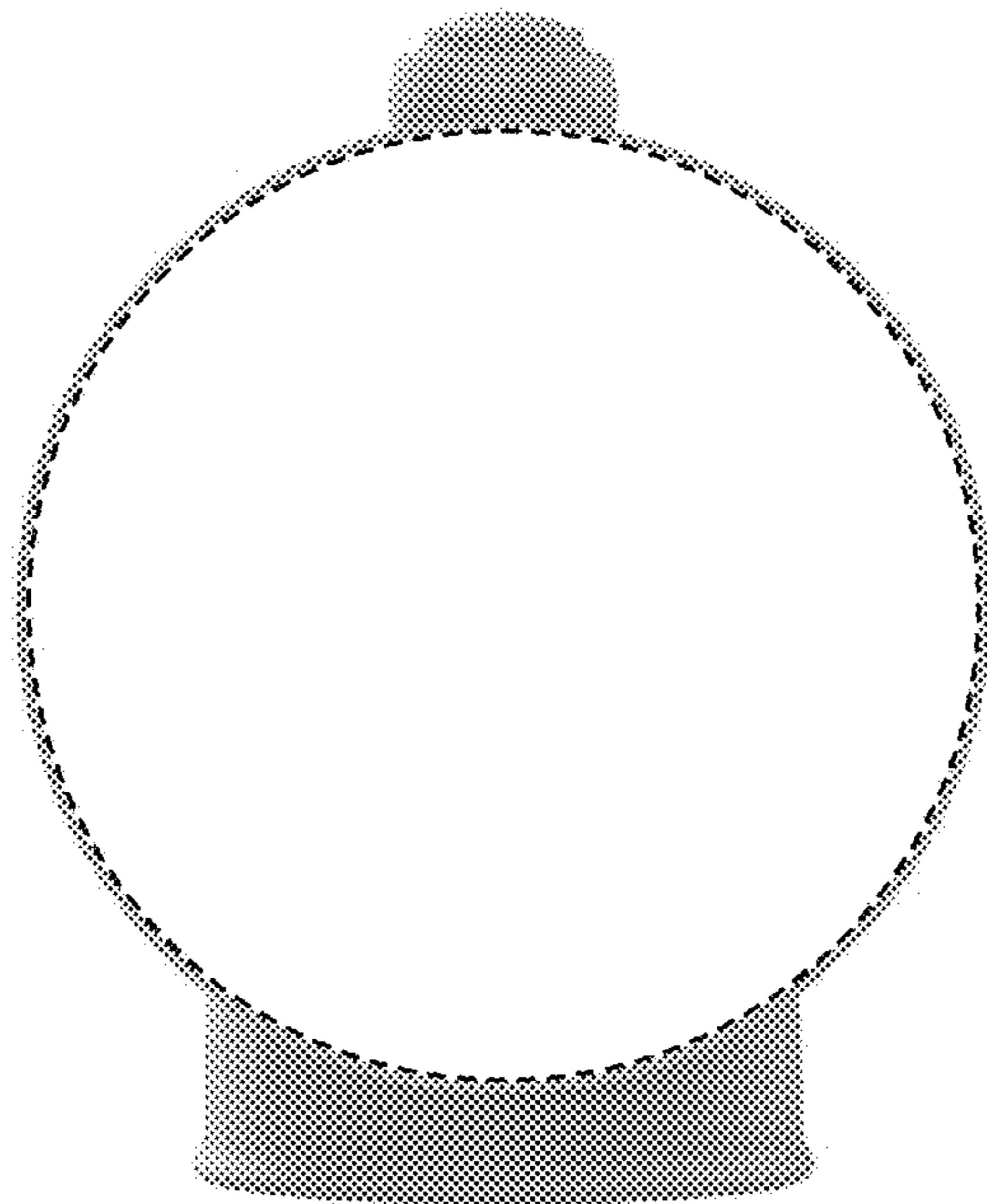

FIG. 7