



US00D816570S

(12) **United States Design Patent** (10) **Patent No.:** **US D816,570 S**  
**Akrapovic et al.** (45) **Date of Patent:** **\*\* May 1, 2018**

(54) **EXHAUST PIPE**  
(71) Applicant: **Igor Akrapovic**, Ljubljana (SI)  
(72) Inventors: **Igor Akrapovic**, Ljubljana (SI); **Ziga Zadnik**, Ljubljana (SI); **Tadej Zadel**, Pivka (SI); **Bostjan Veber**, Polzela (SI)  
(\*\*) Term: **15 Years**  
(21) Appl. No.: **35/501,290**  
(22) Filed: **Jan. 27, 2016**

D496,313 S \* 9/2004 Suzuki ..... D12/194  
D541,718 S \* 5/2007 Emler ..... D12/194  
D550,134 S \* 9/2007 Akrapovic ..... D12/194  
D578,050 S \* 10/2008 Hsu ..... D12/194  
D589,422 S \* 3/2009 Davis, Jr. .... D12/194  
D654,839 S \* 2/2012 Contreras ..... D12/194  
8,439,159 B1 \* 5/2013 Borla ..... F01N 1/083  
181/212  
D689,420 S \* 9/2013 Chou ..... D12/194  
D709,012 S \* 7/2014 Chou ..... D12/194  
D712,812 S \* 9/2014 Verlengiere ..... D12/194  
D762,540 S \* 8/2016 Yasuhara ..... D12/194  
D767,456 S \* 9/2016 Finnie ..... D12/194  
D773,970 S \* 12/2016 Kobayashi ..... D12/194  
2008/0121456 A1 \* 5/2008 Davis ..... F01N 13/20  
180/309

(80) **Hague Agreement Data**  
Int. Filing Date: **Jan. 27, 2016**  
Int. Reg. No.: **DM/089786**  
Int. Reg. Date: **Jan. 27, 2016**  
Int. Reg. Pub. Date: **Jul. 29, 2016**

\* cited by examiner

*Primary Examiner* — Darlington Ly  
(74) *Attorney, Agent, or Firm* — Olson & Cepuritis, Ltd.;  
Anita M. Cepuritis; William P. Oberhardt

(51) **LOC (11) Cl.** ..... **12-16**  
(52) **U.S. Cl.**  
USPC ..... **D12/194**  
(58) **Field of Classification Search**  
USPC ..... D12/194; D15/5  
CPC ... F01N 1/04; F01N 1/24; F01N 13/08; F01N  
13/082; F01N 13/085; F01N 13/087  
See application file for complete search history.

(57) **CLAIM**

The ornamental design for an exhaust pipe, as shown and described.

**DESCRIPTION**

- 1. Exhaust pipe
- 1.1 is a top, rear, and left side perspective view of an exhaust pipe showing my new design;
- 1.2 is a top, rear, and right side perspective view thereof;
- 1.3 is a rear elevation view thereof;
- 1.4 is a right side elevation view thereof;
- 1.5 is a top plan view thereof;
- 1.6 is a left side elevation view thereof;
- 1.7 is a bottom plan view thereof; and
- 1.8 is a top, front, and right side perspective view thereof.

(56) **References Cited**  
U.S. PATENT DOCUMENTS  
D246,038 S \* 10/1977 Moller ..... D12/194  
6,431,311 B1 \* 8/2002 Brown ..... F01N 13/082  
181/227  
D467,210 S \* 12/2002 Yu ..... D12/194  
D480,030 S \* 9/2003 Gilli ..... D12/194  
D490,036 S \* 5/2004 Cho ..... D12/194  
D495,642 S \* 9/2004 Luttig ..... D12/194

**1 Claim, 8 Drawing Sheets**

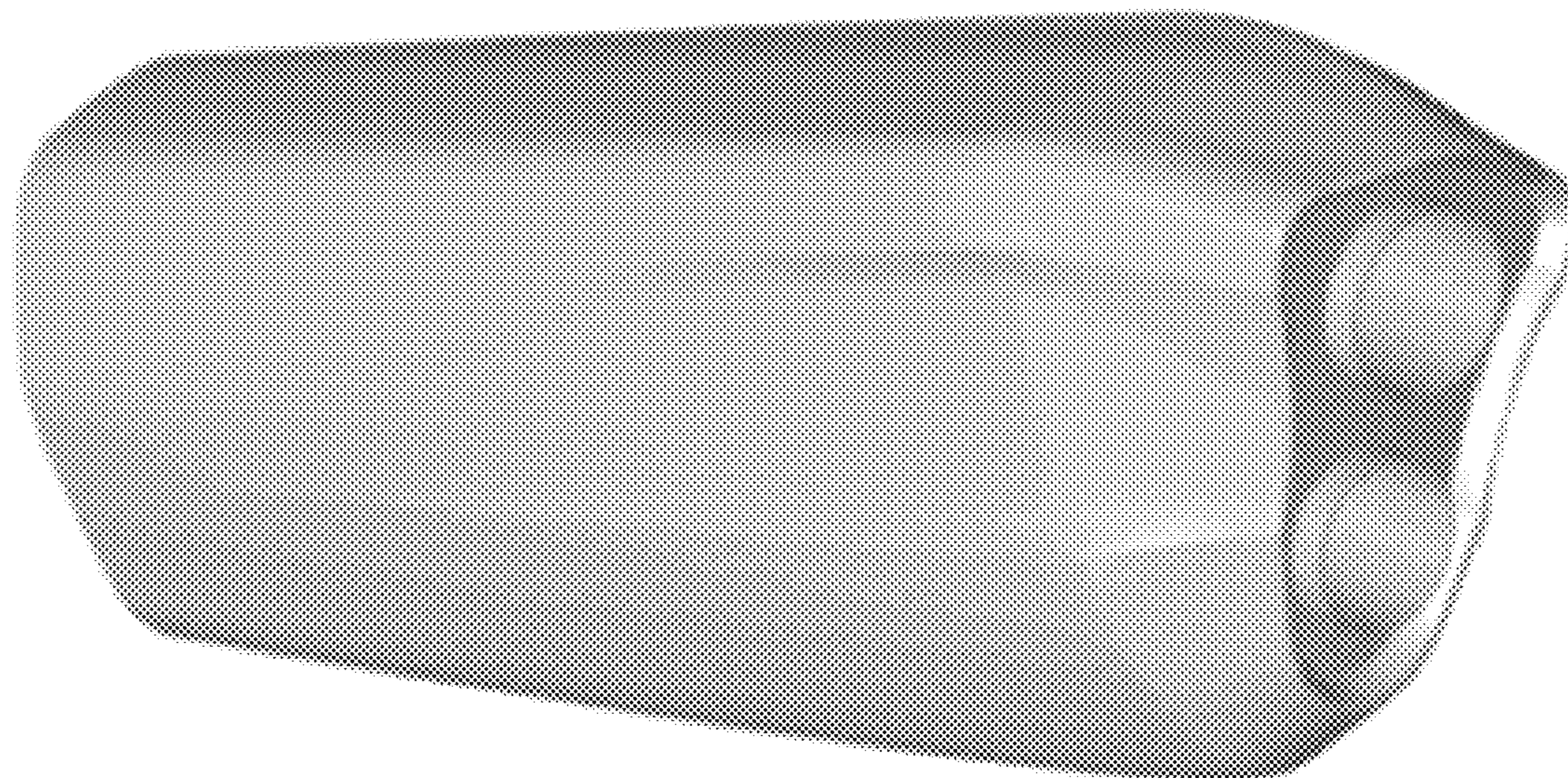

**1.1**

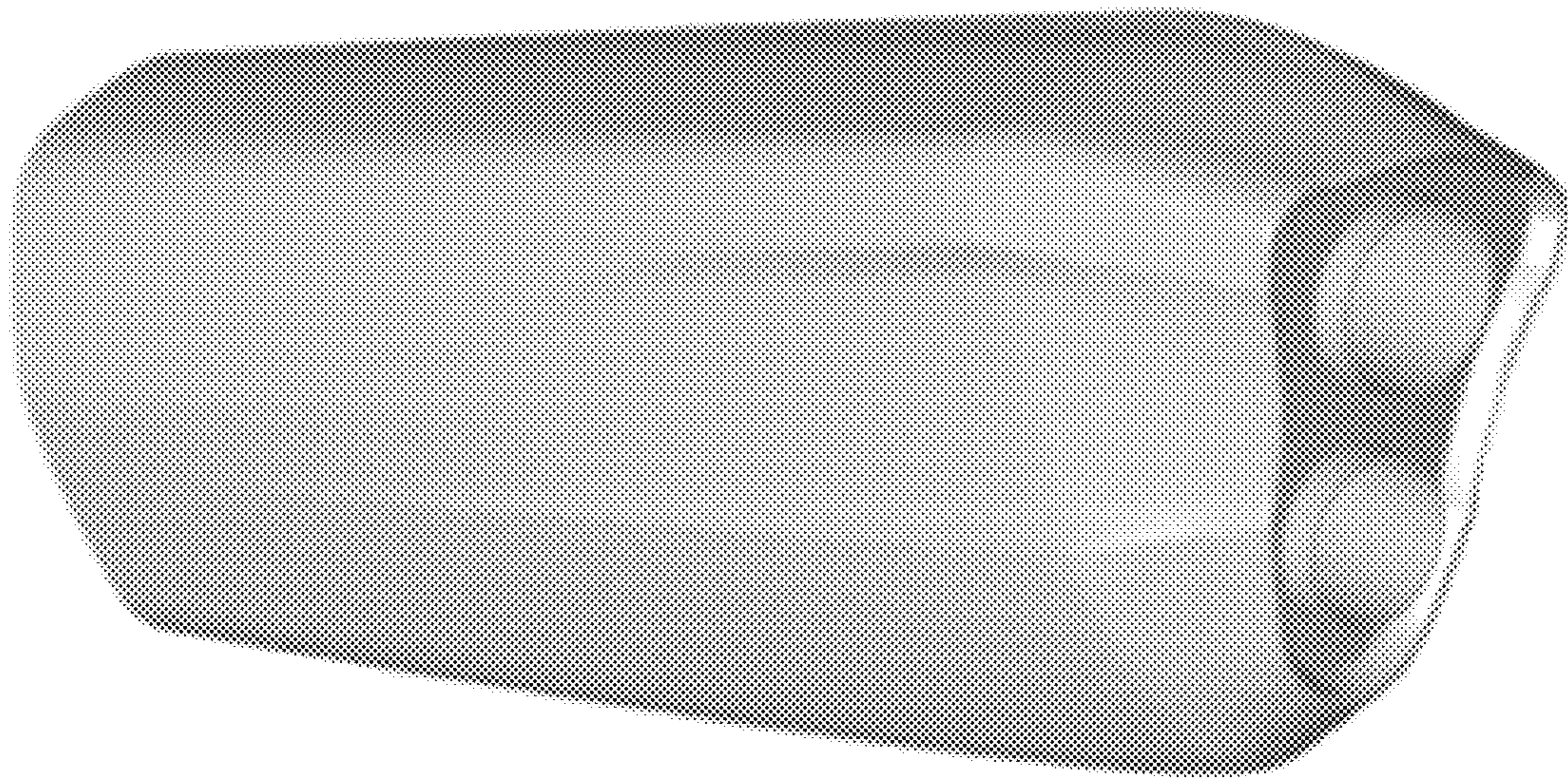

**1.2**

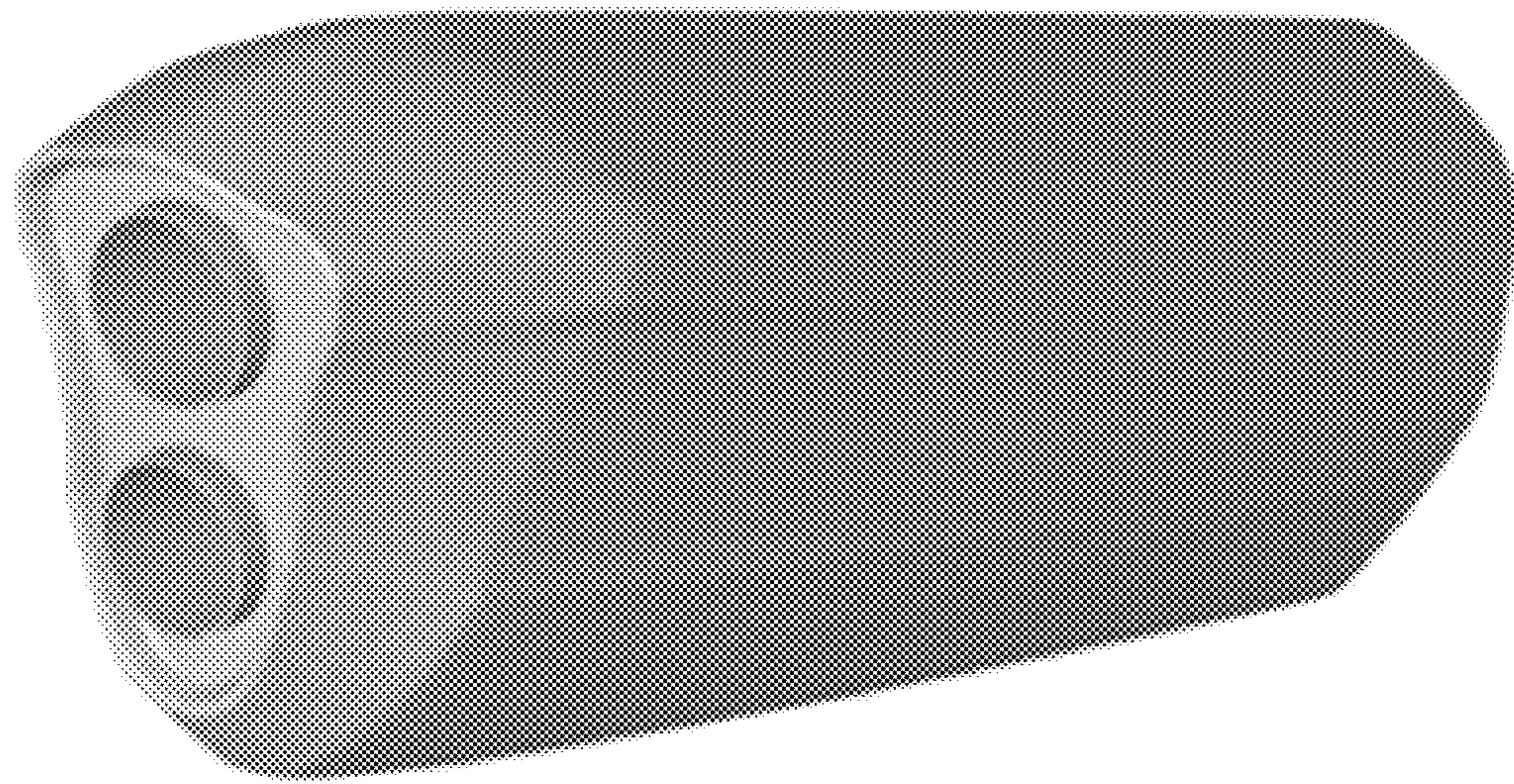

**1.3**

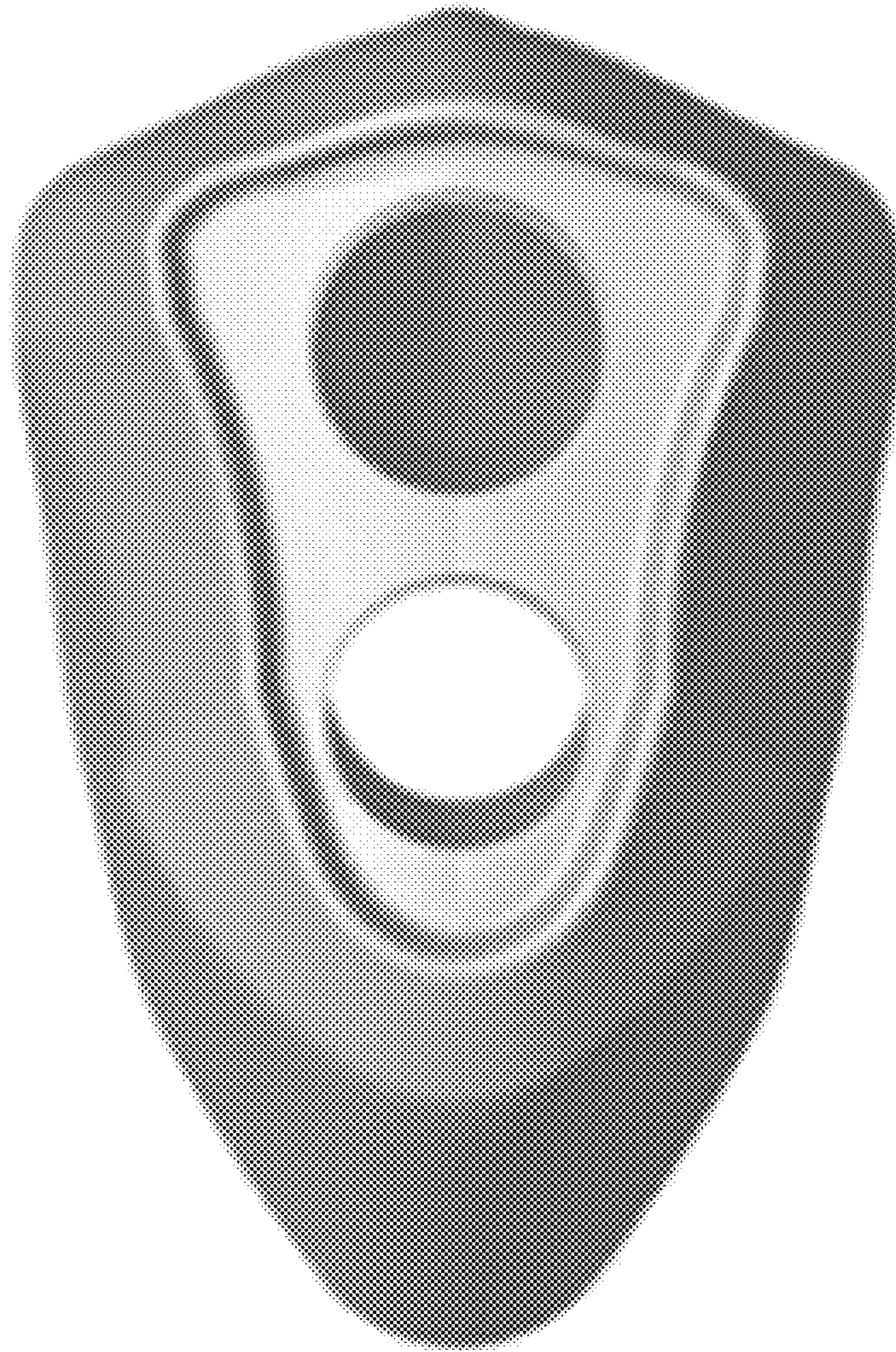

**1.4**

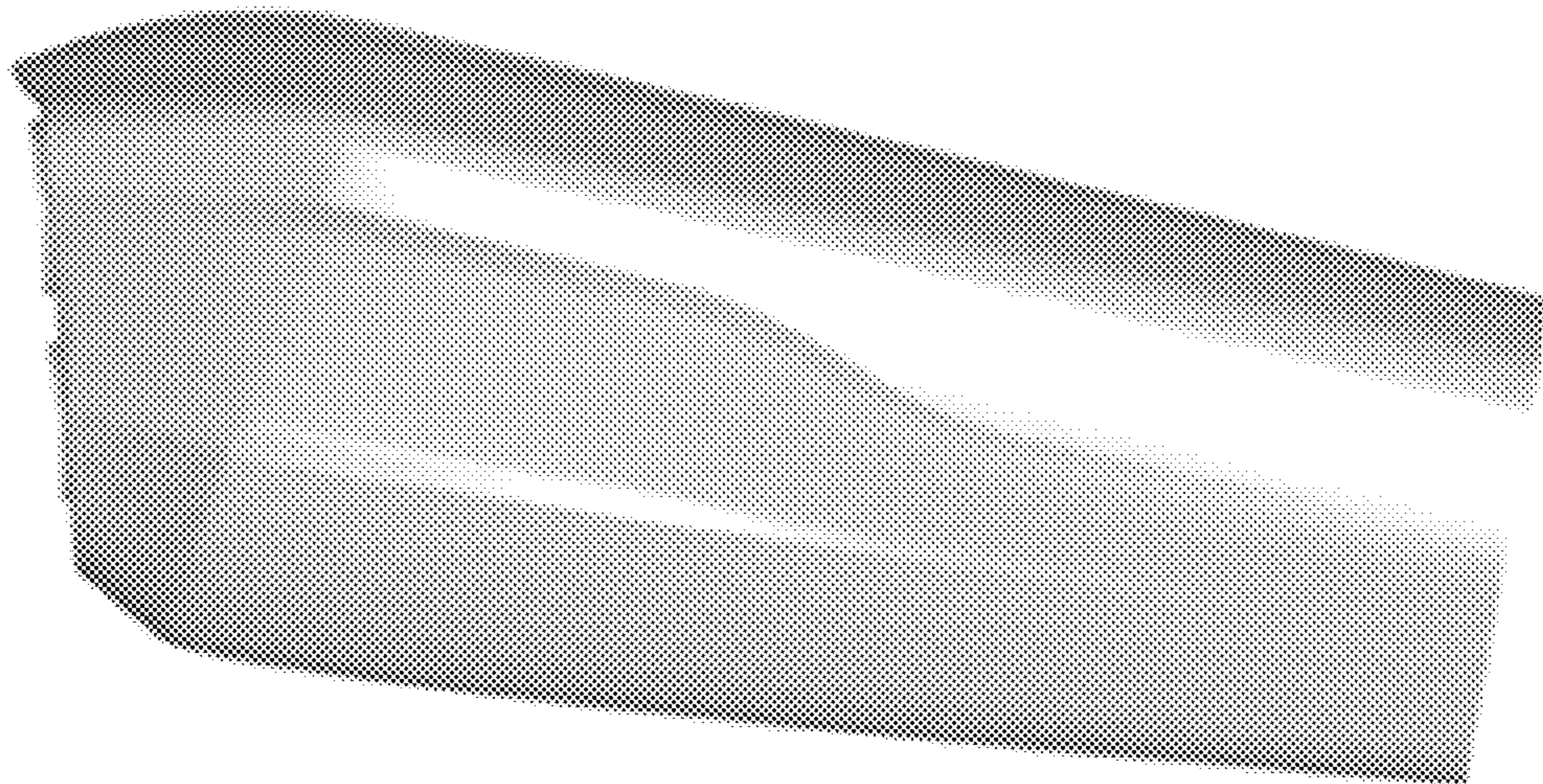

**1.5**

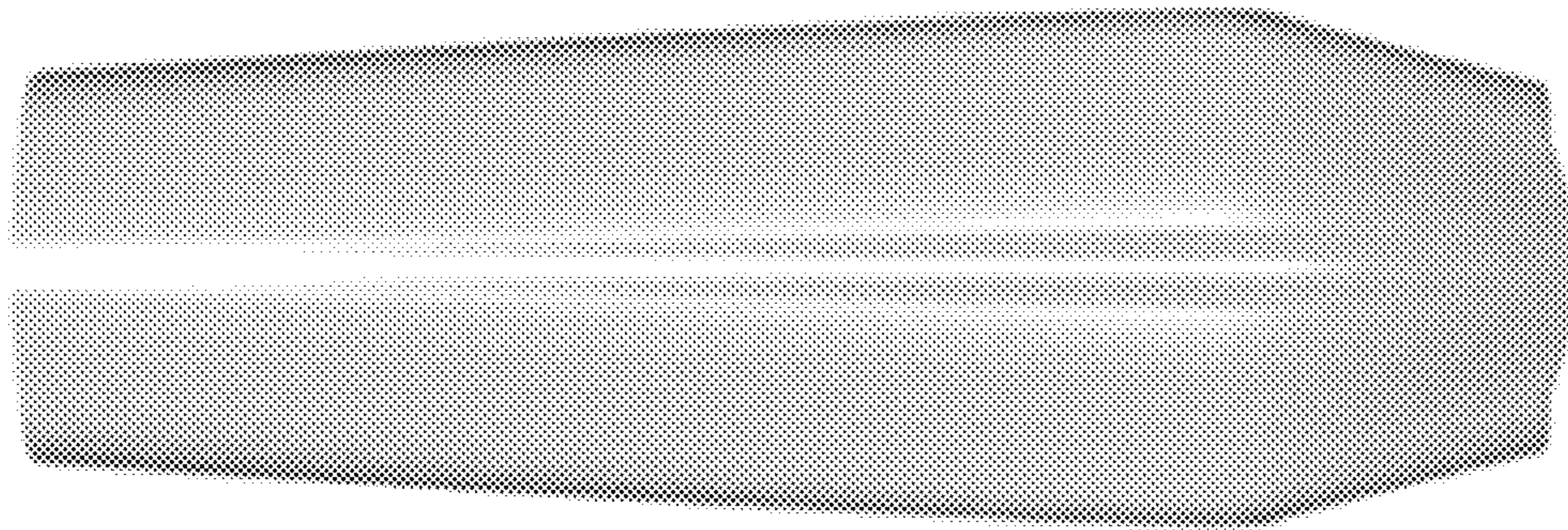

**1.6**

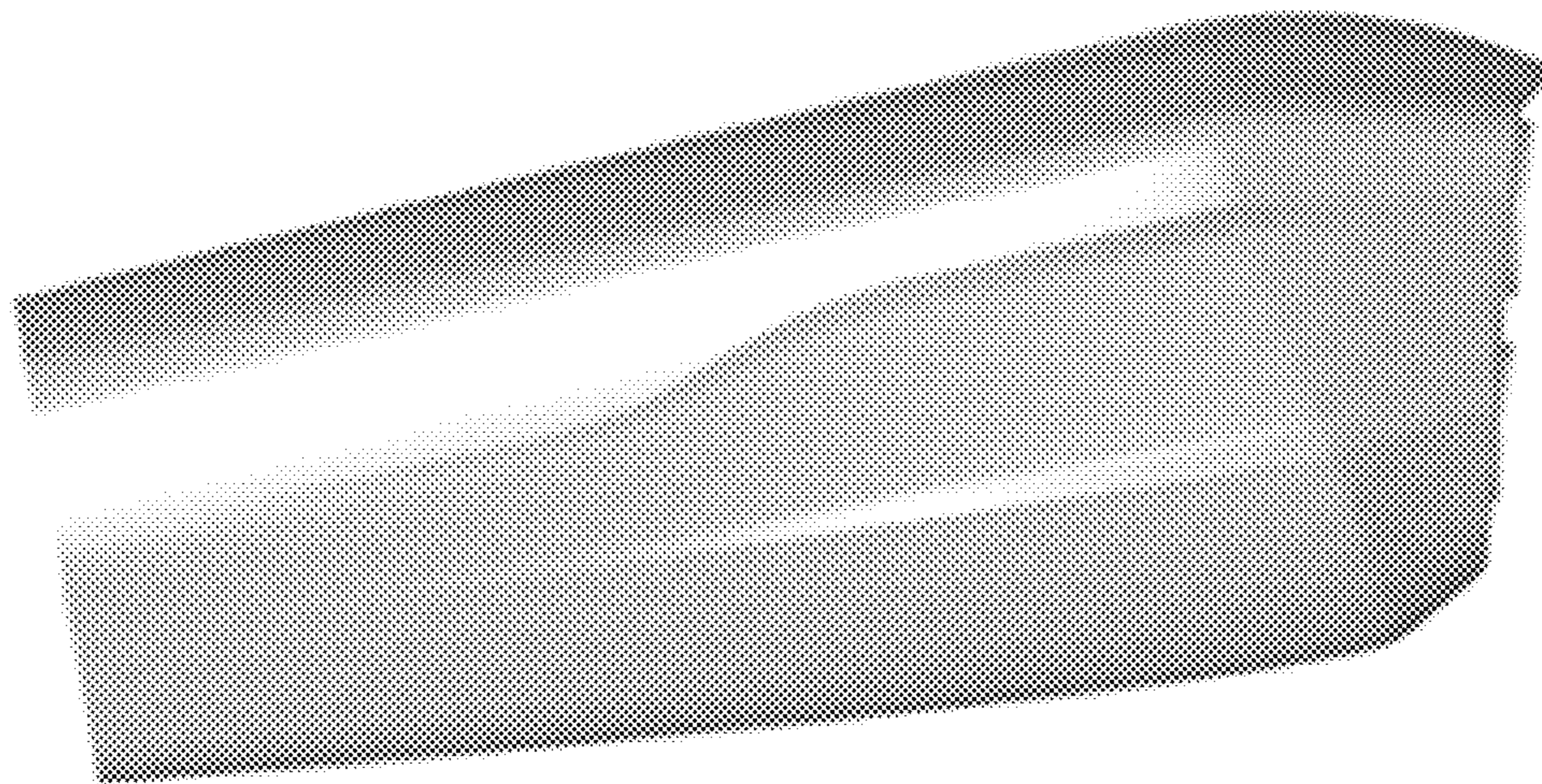

**1.7**

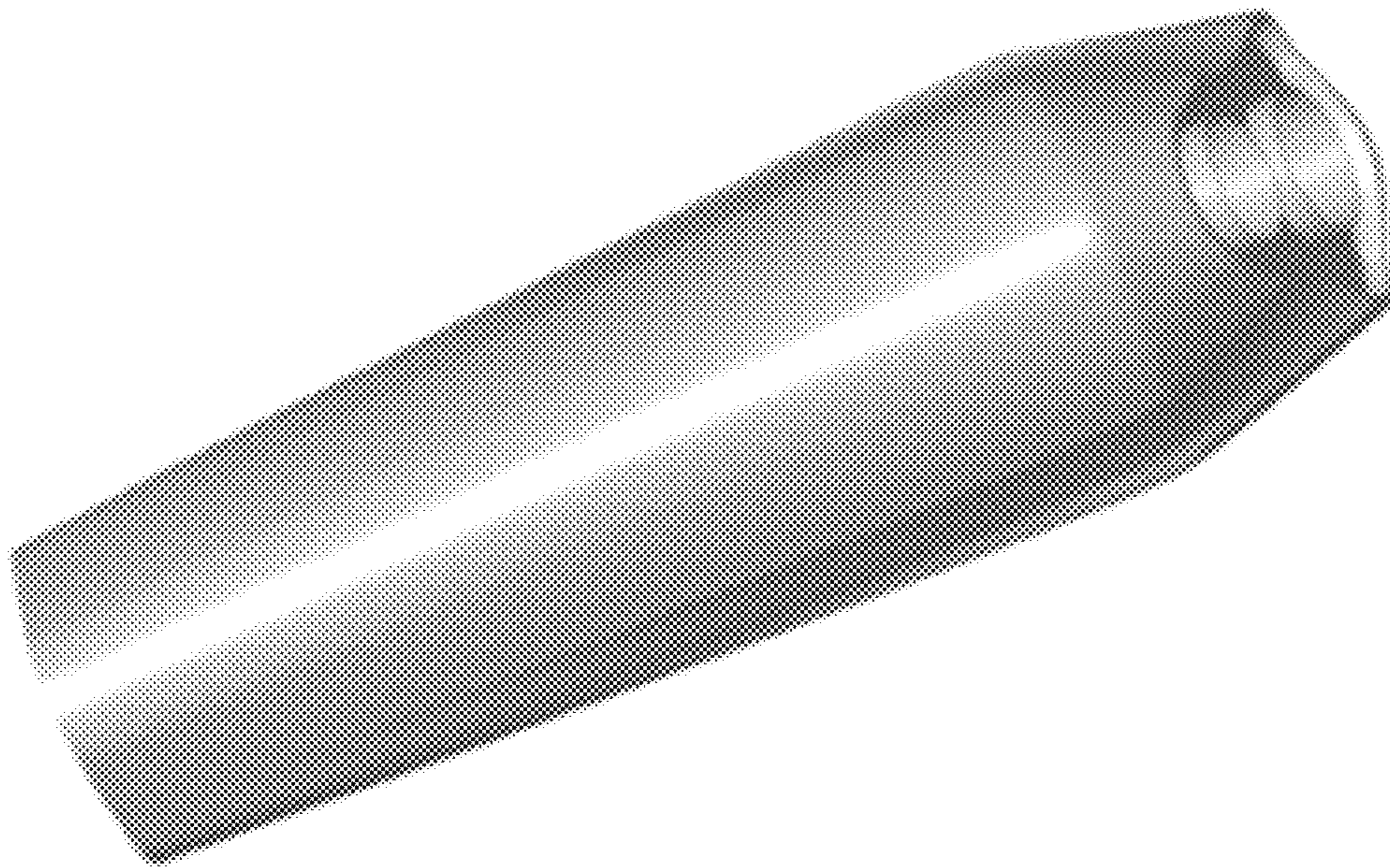



**1.8**

