



US00D816042S

(12) **United States Design Patent**  
**Yokoyama**

(10) **Patent No.:** **US D816,042 S**  
(45) **Date of Patent:** **\*\* Apr. 24, 2018**

(54) **ELECTRICAL CONNECTOR PART**

(71) Applicant: **Japan Aviation Electronics Industry, Limited, Tokyo (JP)**

(72) Inventor: **Yohei Yokoyama, Tokyo (JP)**

(73) Assignee: **JAPAN AVIATION ELECTRONICS INDUSTRY, LIMITED, Tokyo (JP)**

(\*\*) Term: **15 Years**

(21) Appl. No.: **29/570,651**

(22) Filed: **Jul. 11, 2016**

(30) **Foreign Application Priority Data**

Jan. 19, 2016 (JP) ..... 2016-000841

(51) **LOC (11) Cl.** ..... **13-03**

(52) **U.S. Cl.**  
USPC ..... **D13/147; D13/154**

(58) **Field of Classification Search**  
USPC ..... D13/133, 146, 147, 154, 184, 199  
CPC .... H01R 24/60; H01R 24/70; H01R 13/5205;  
H01R 13/5219; H01R 13/642; H01R  
13/6471; H01R 13/6581; H01R 13/6285;  
H01R 13/6591; H01R 13/6596  
See application file for complete search history.

(56) **References Cited**

**U.S. PATENT DOCUMENTS**

D433,665 S \* 11/2000 Huang ..... D13/147  
D533,835 S \* 12/2006 Lee ..... D13/133  
D537,791 S \* 3/2007 Yuan ..... D13/147  
D550,160 S \* 9/2007 Fujimoto ..... D13/147  
D583,758 S \* 12/2008 Cheng ..... D13/133

D596,577 S \* 7/2009 Asano ..... D13/147  
D597,489 S \* 8/2009 Duan ..... D13/147  
D637,958 S \* 5/2011 Asano ..... D13/147  
D767,497 S \* 9/2016 Su ..... D13/147  
D783,539 S \* 4/2017 Yokoyama ..... D13/147  
2016/0181743 A1\* 6/2016 Tsai ..... H01R 12/724  
439/587

\* cited by examiner

*Primary Examiner* — Daniel Bui

(74) *Attorney, Agent, or Firm* — Manabu Kanosaka

(57) **CLAIM**

The ornamental design for an electrical connector part, as shown and described.

**DESCRIPTION**

FIG. 1 is a front elevational view of an electrical connector part showing my new design;  
FIG. 2 is a rear elevational view thereof;  
FIG. 3 is a right side elevational view thereof;  
FIG. 4 is a left side elevational view thereof;  
FIG. 5 is a top plan view thereof;  
FIG. 6 is a bottom plan view thereof;  
FIG. 7 is a perspective view showing a front, top and right side thereof;  
FIG. 8 is a perspective view showing a rear, bottom and left side thereof;  
FIG. 9 is a perspective view showing a front, right side and bottom thereof; and,  
FIG. 10 is a perspective view showing a rear, left side and top thereof.  
The broken lines are shown for environmental purposes only and depict portions of the electrical connector part that form no part of claimed design, and the dash-dot lines represent boundaries of the claimed design.

**1 Claim, 10 Drawing Sheets**

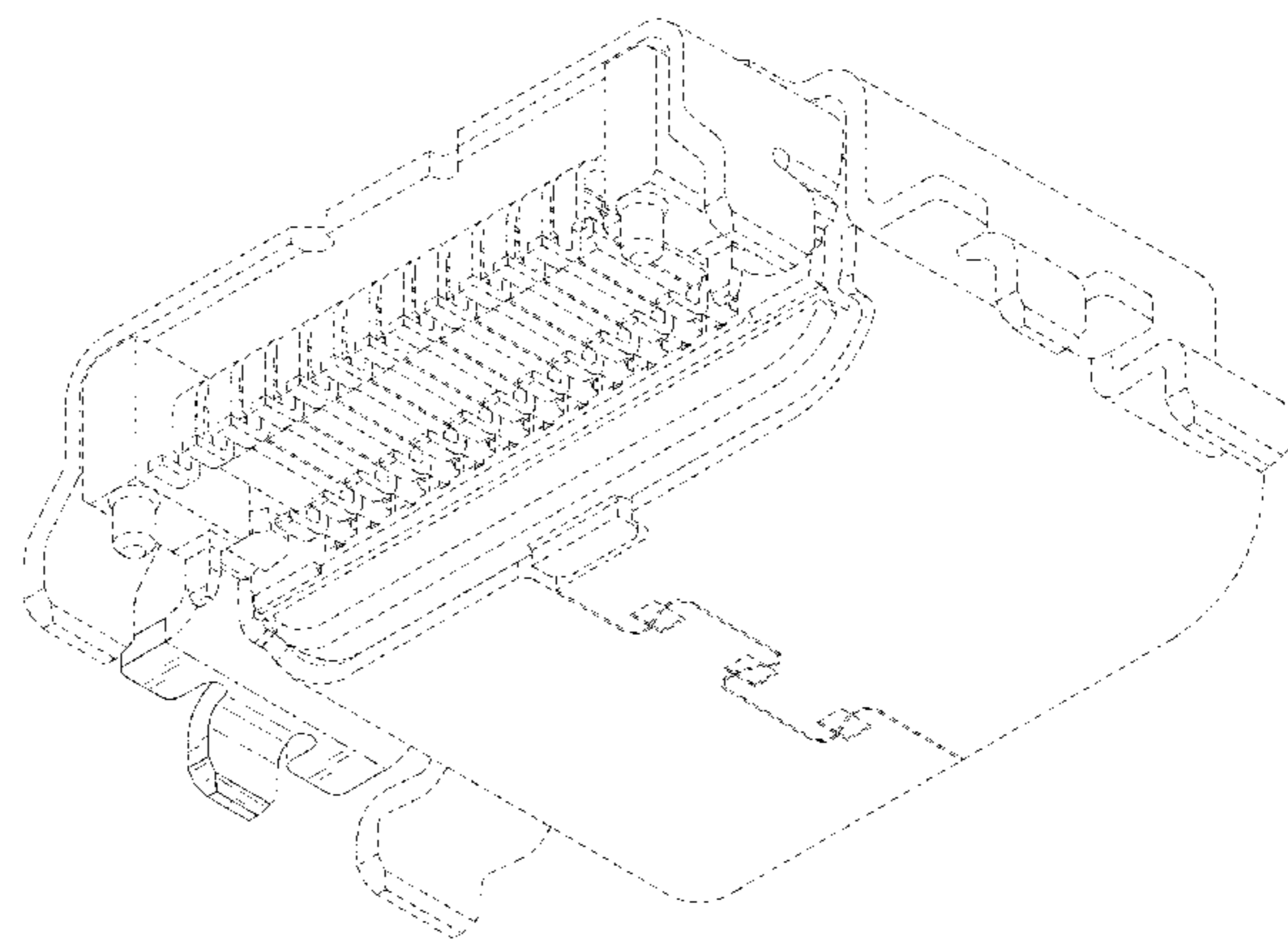
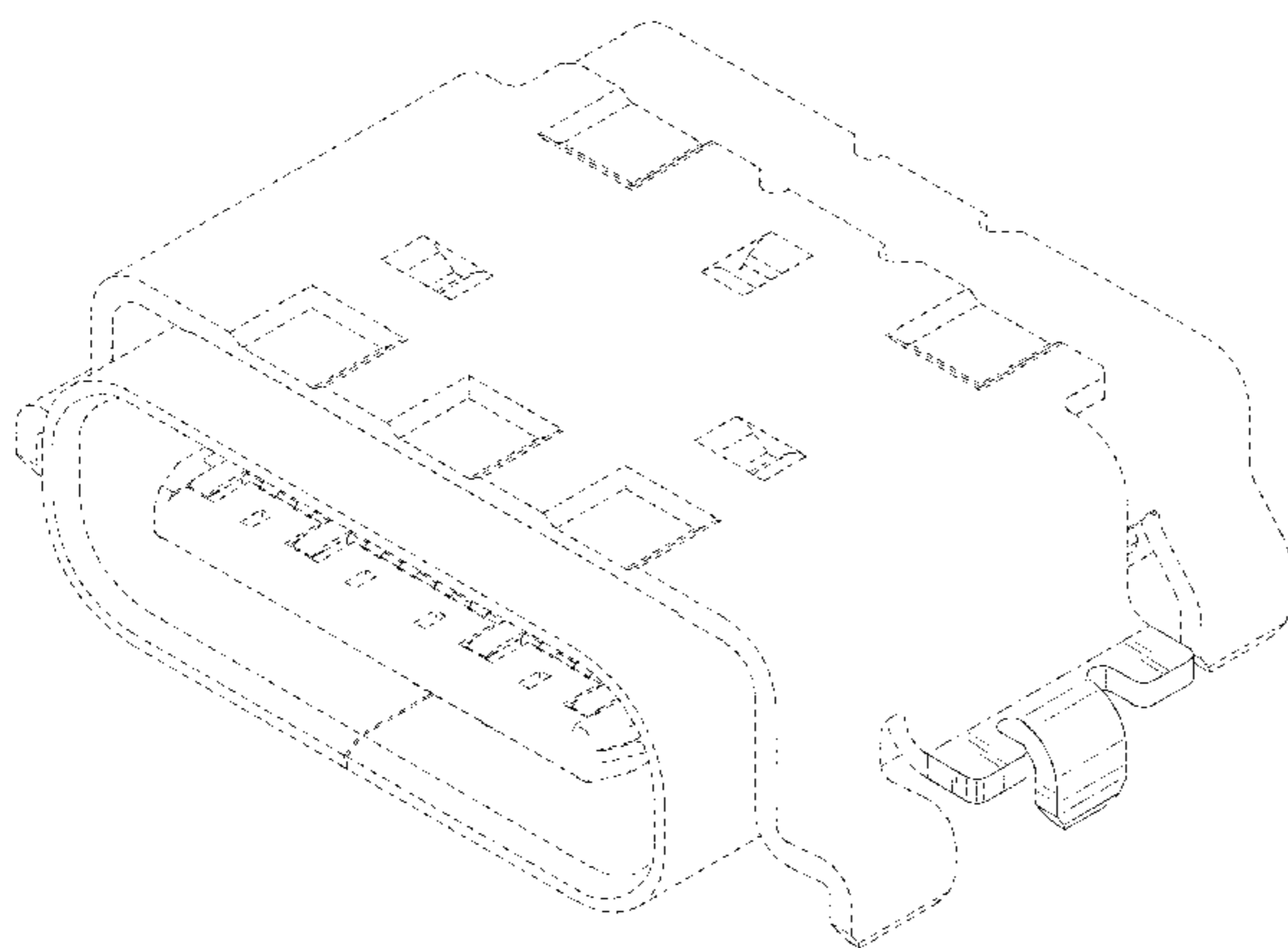

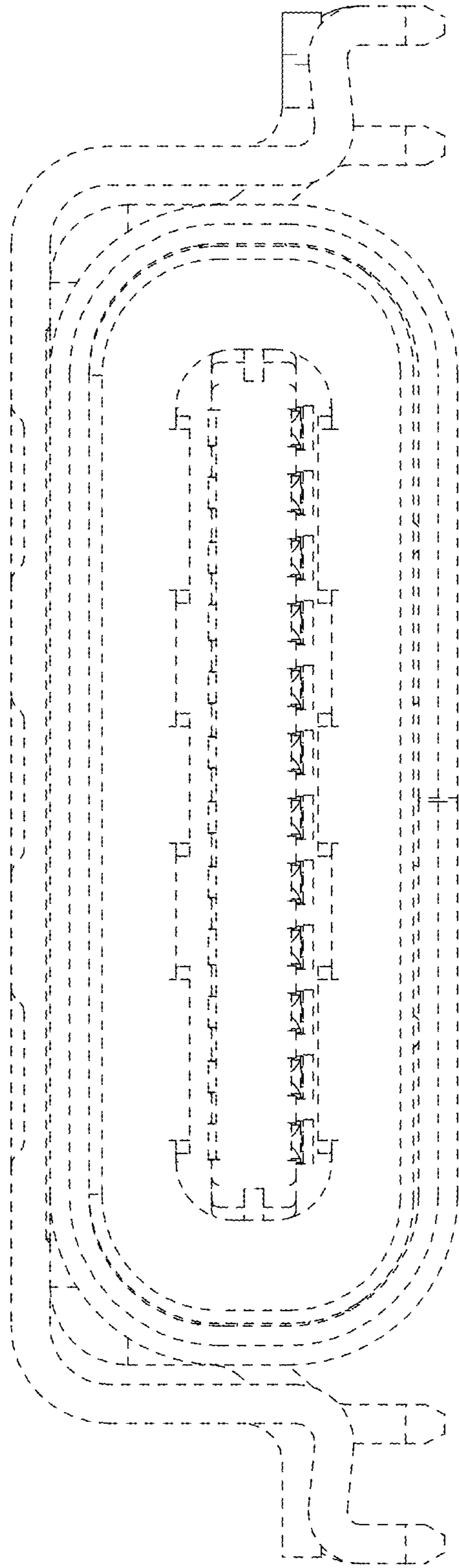

FIG. 1

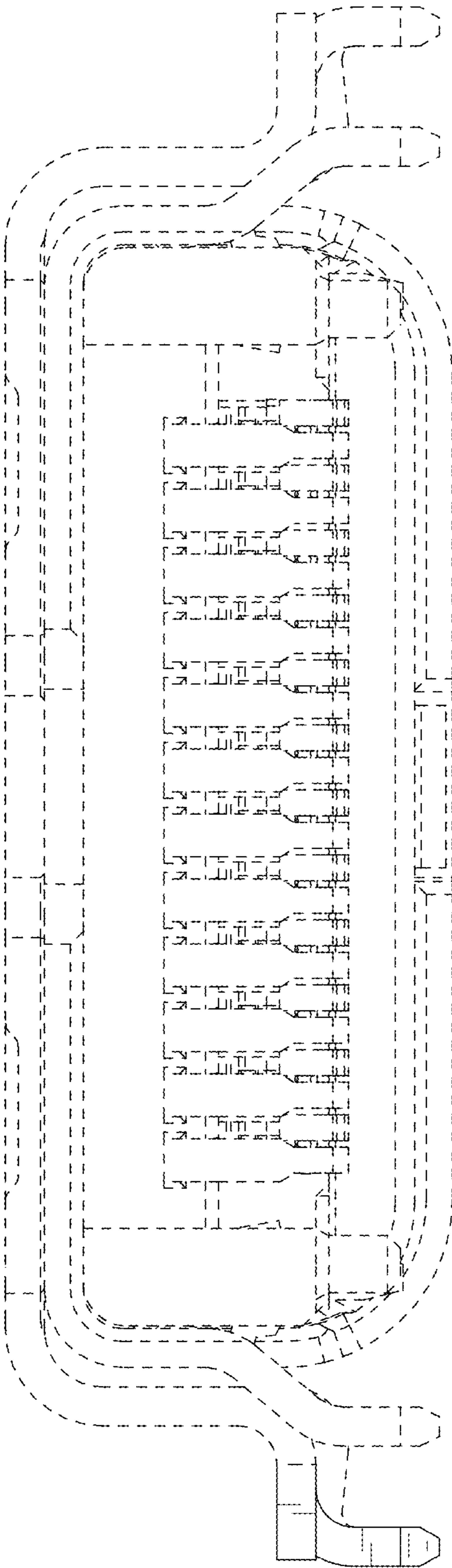

FIG. 2

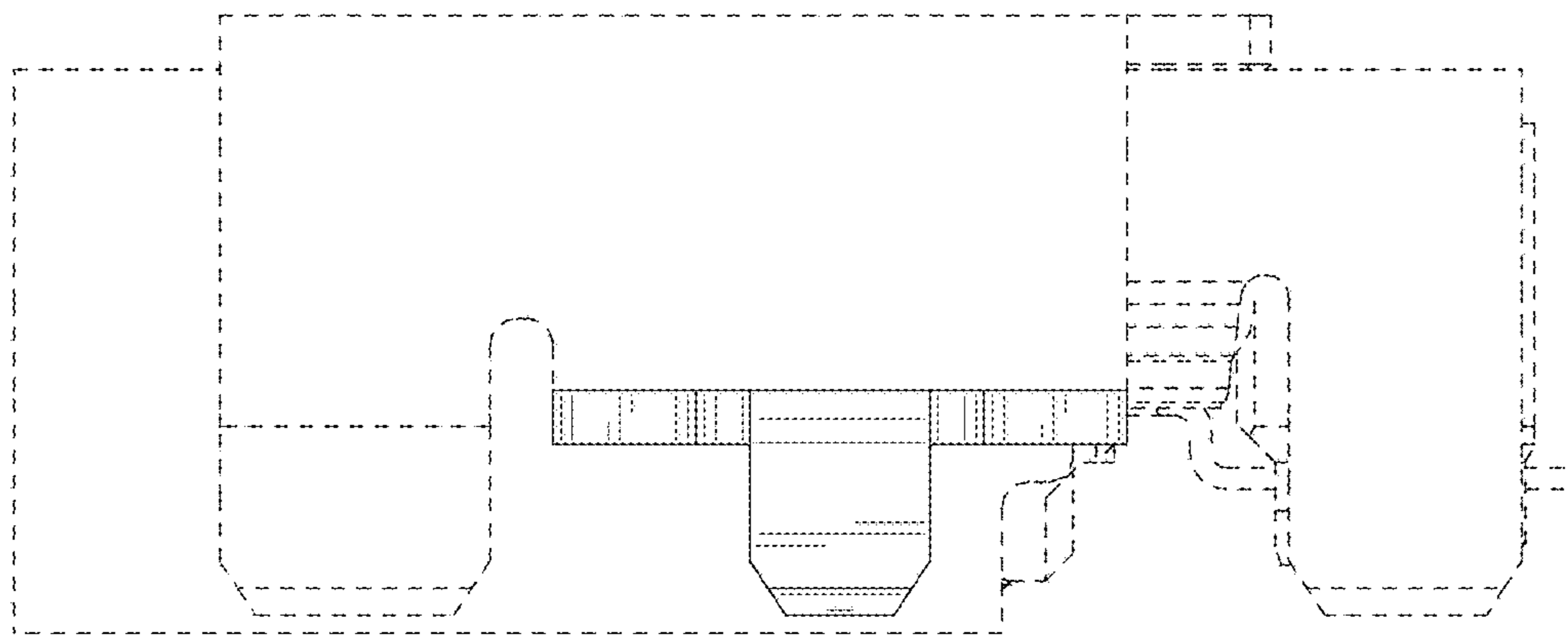

FIG. 3

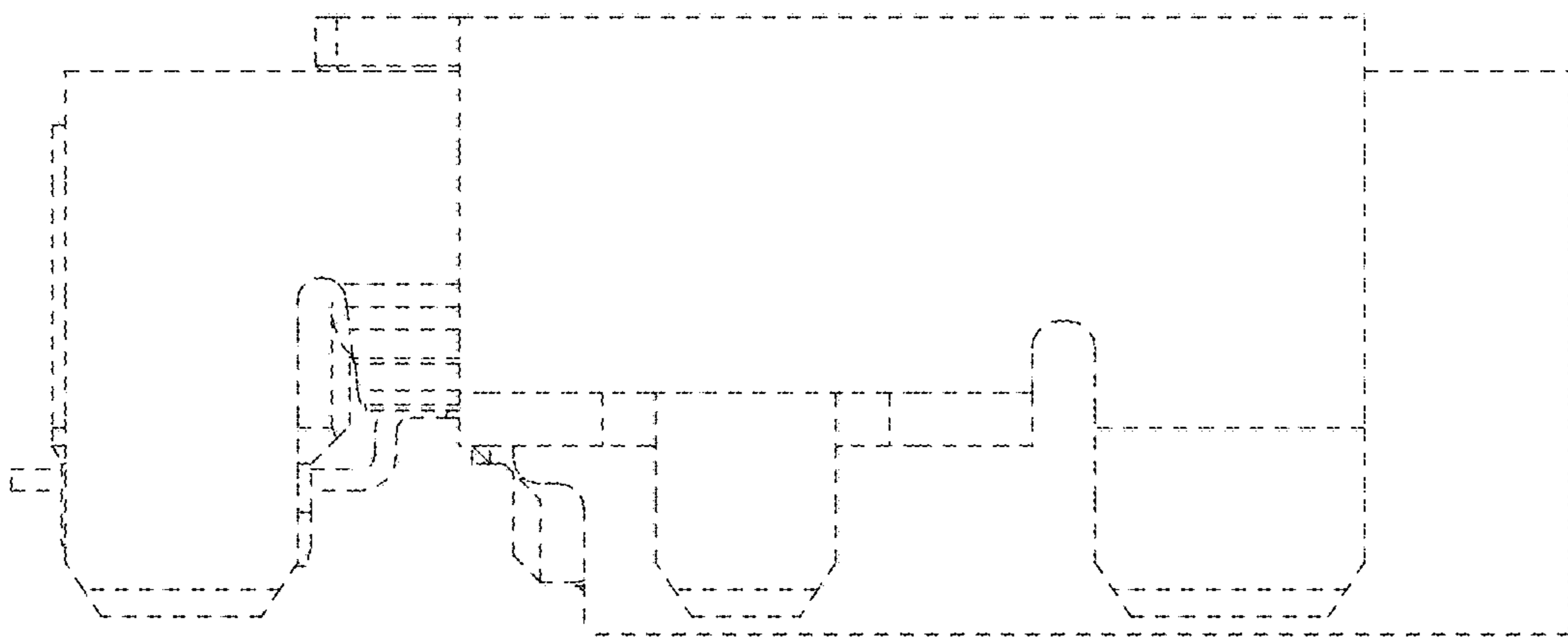

FIG. 4

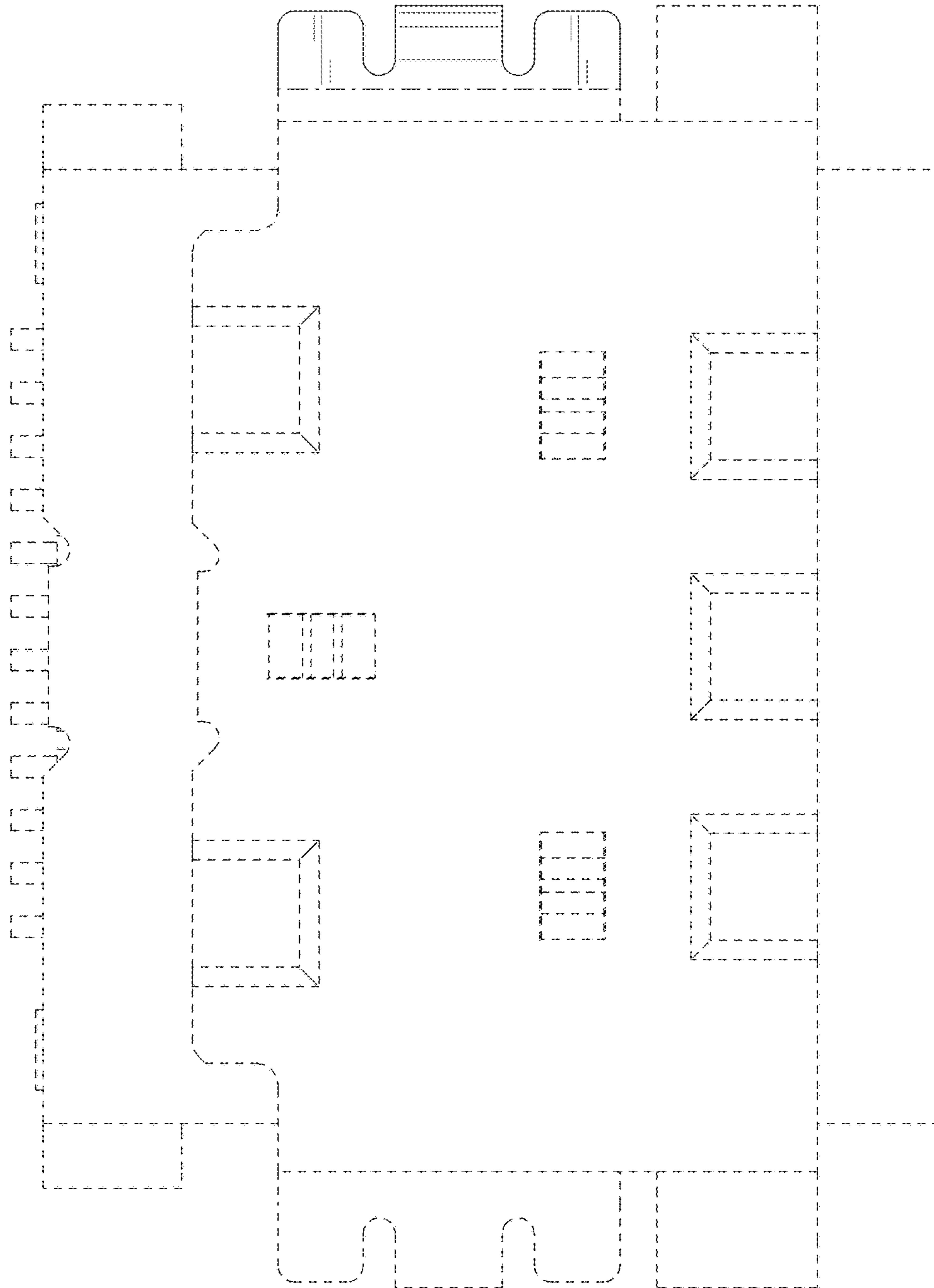

FIG. 5



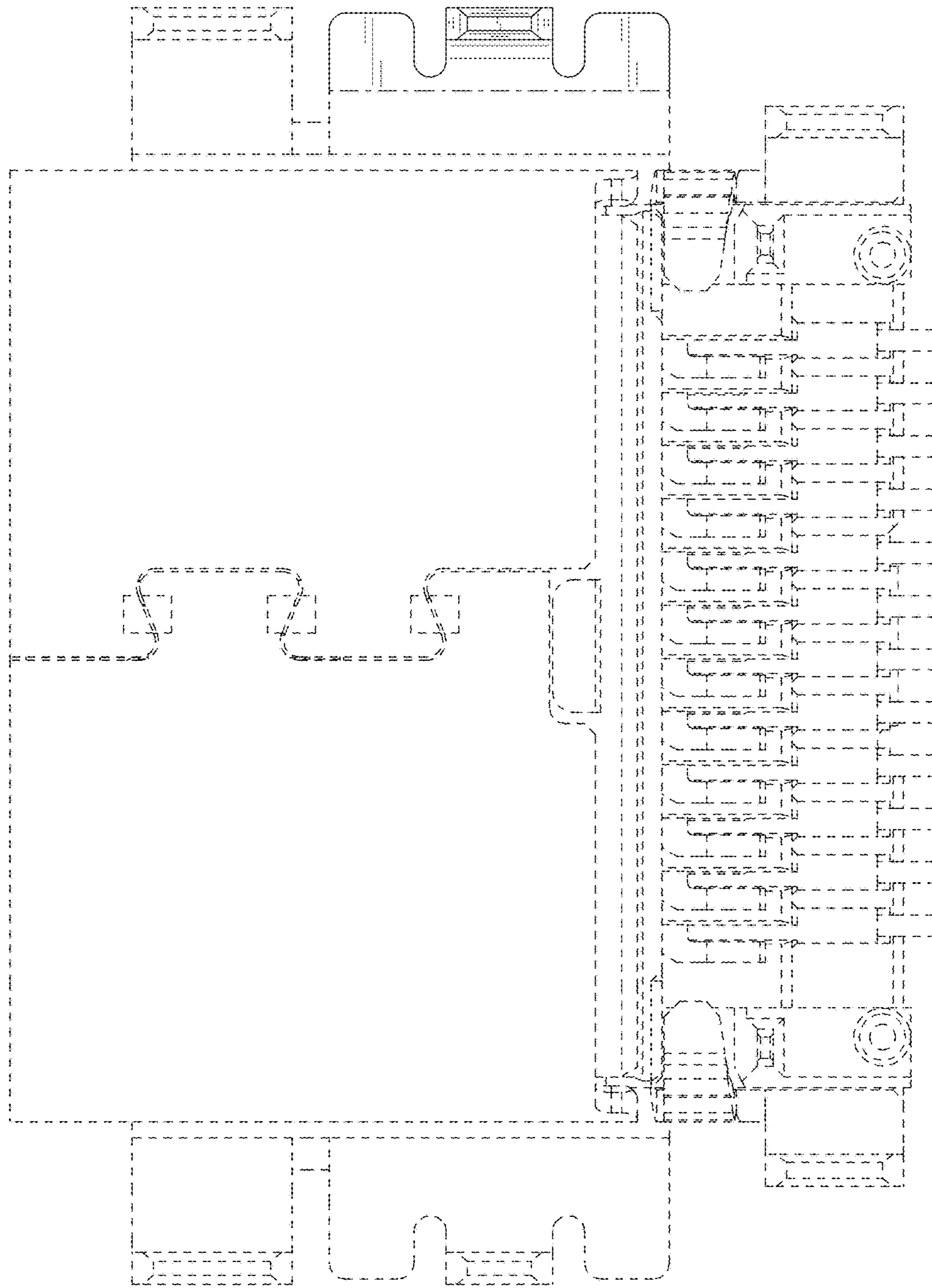

FIG. 6

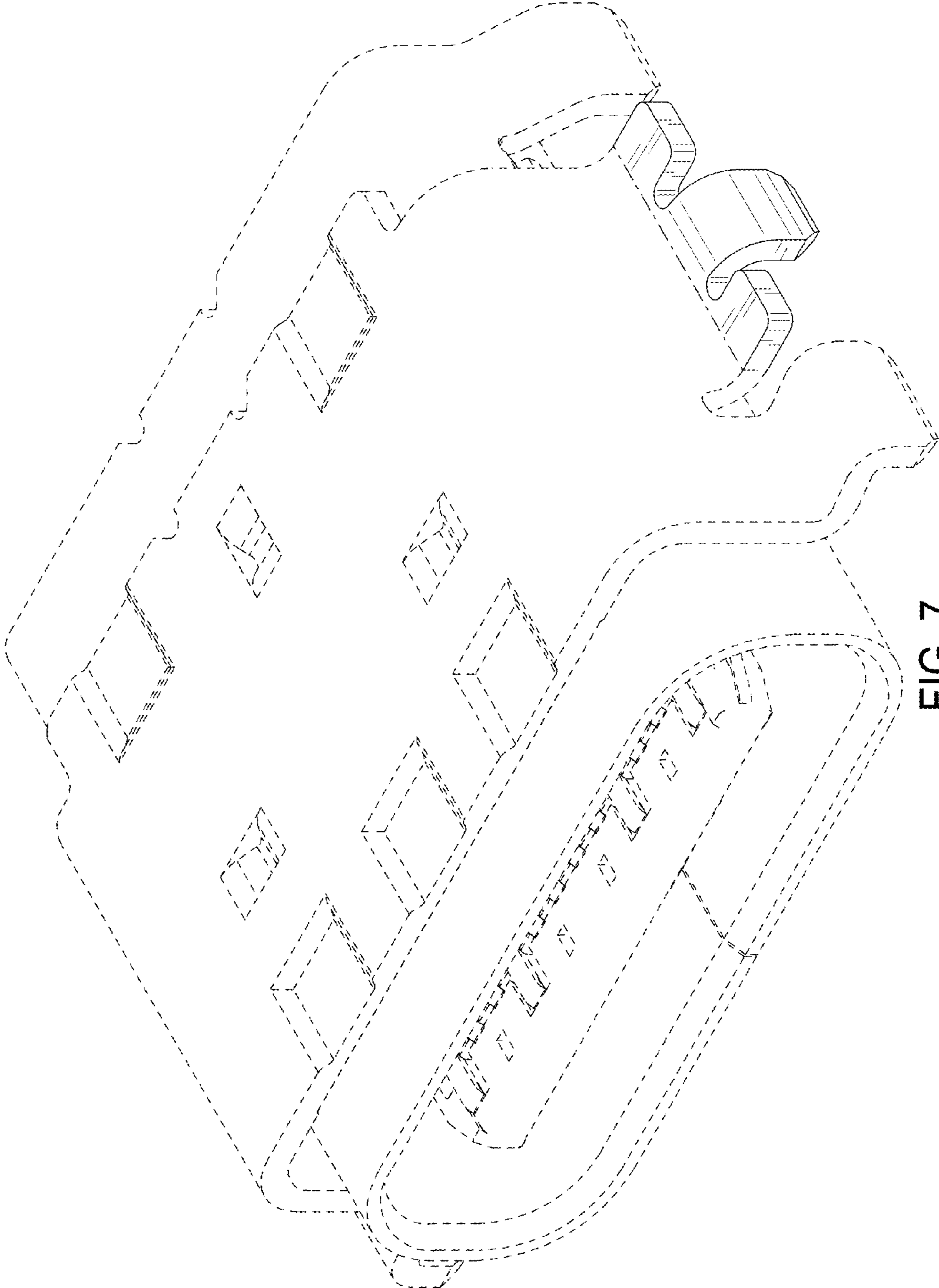

FIG. 7



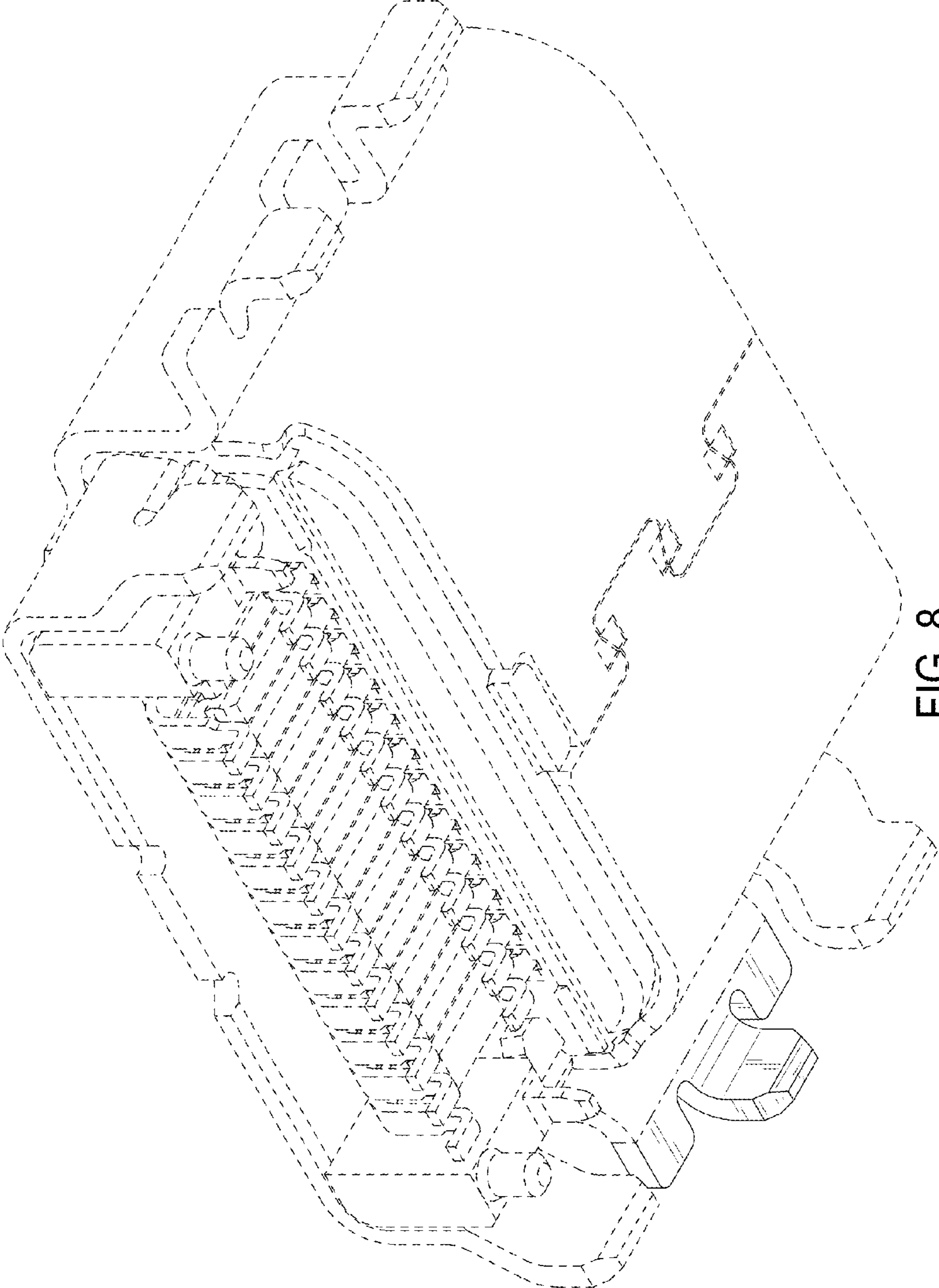

FIG. 8

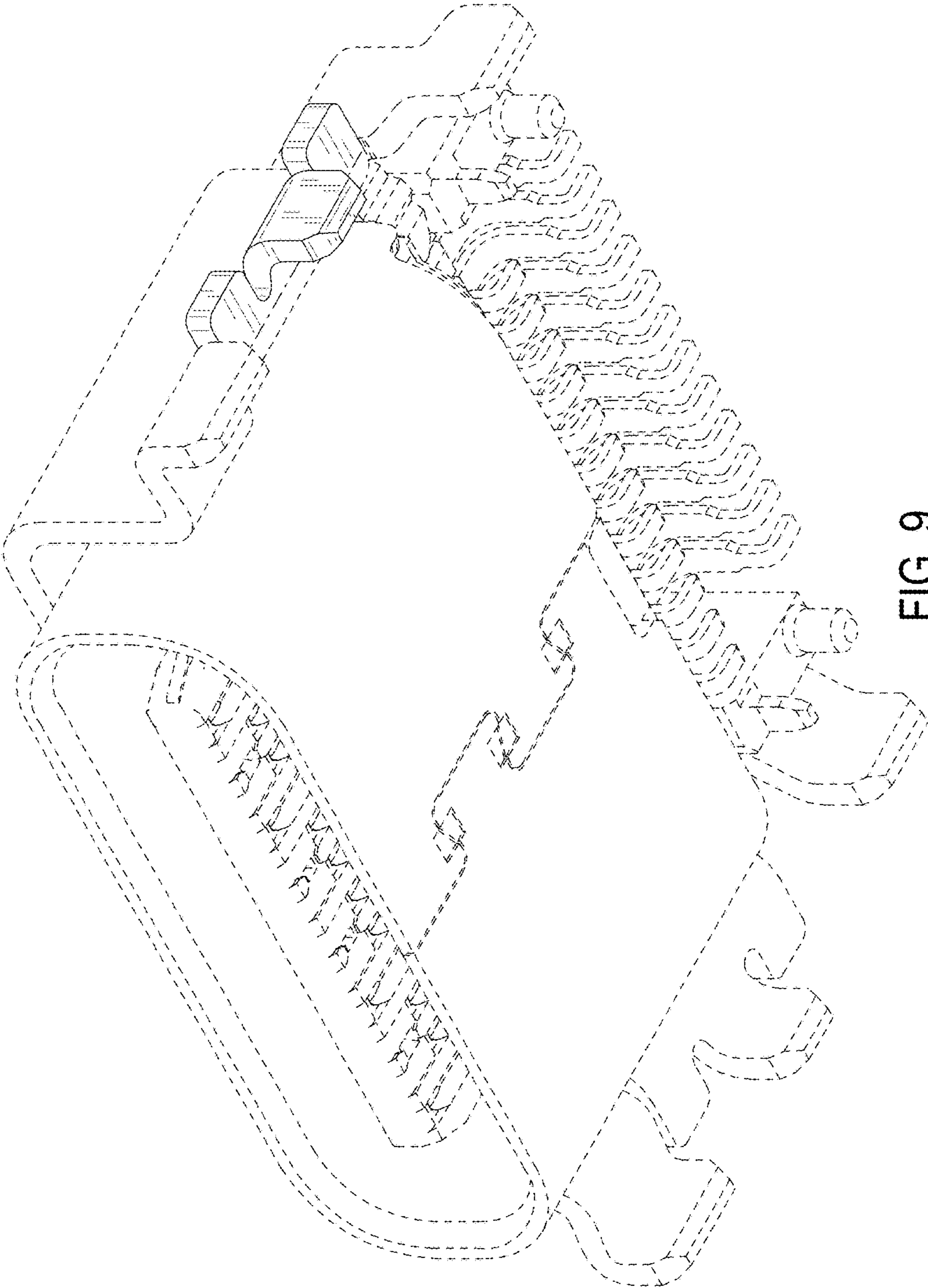

FIG. 9

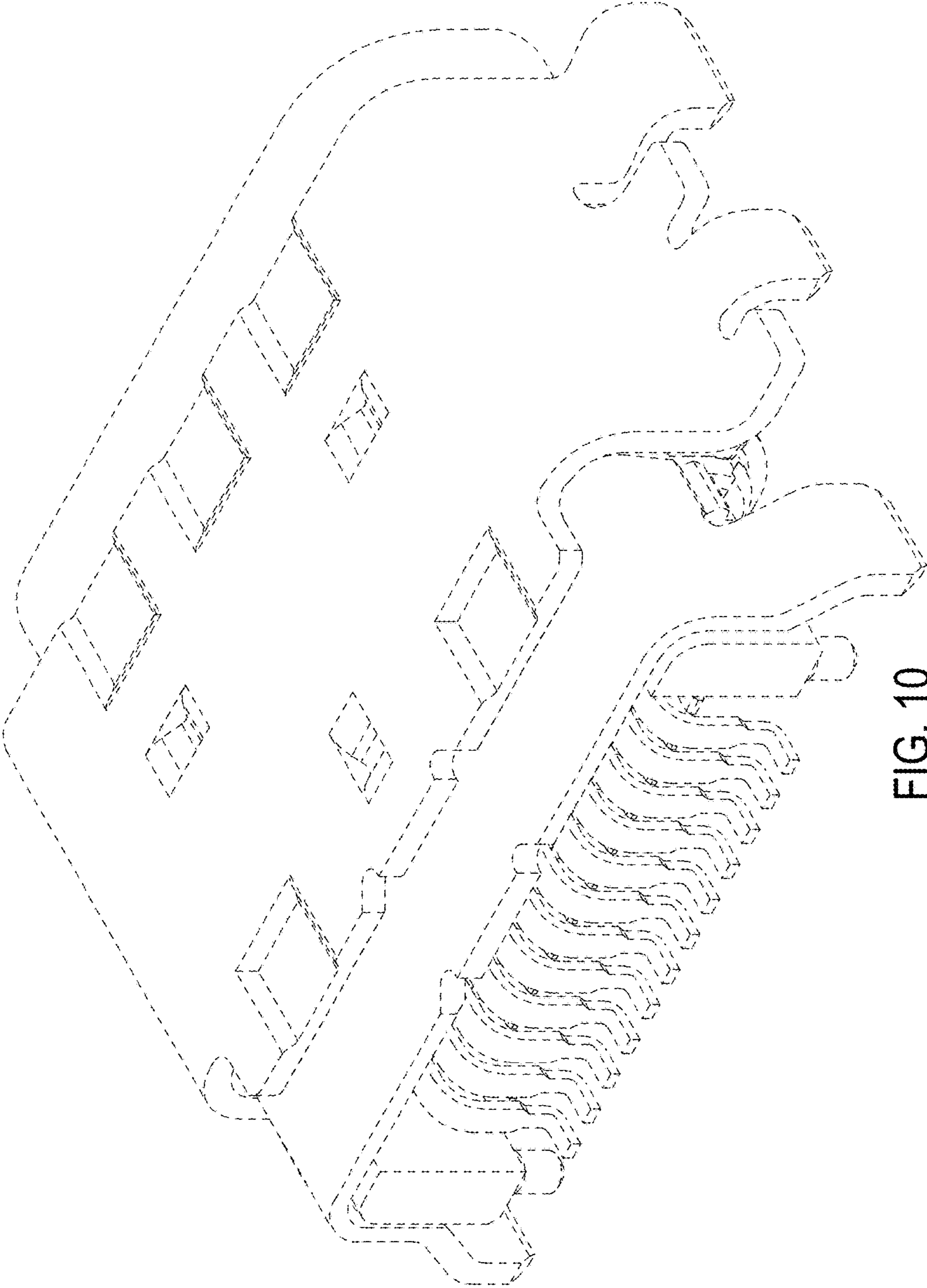

FIG. 10