



US00D815199S

(12) **United States Design Patent**  
**Kim et al.**

(10) **Patent No.:** **US D815,199 S**

(45) **Date of Patent:** **\*\* \*Apr. 10, 2018**

(54) **MULTI-FUNCTION PRINTER**

(56) **References Cited**

(71) Applicant: **S-Printing Solution Co., Ltd.**,  
Suwon-si (KR)

U.S. PATENT DOCUMENTS

D384,370 S \* 9/1997 Kobayashi ..... D18/55  
D502,210 S 2/2005 Katori et al.

(72) Inventors: **Kyong-Hwan Kim**, Seoul (KR); **Naoto Fukasawa**, Tokyo (JP); **Isogai Yoshitaka**, Seongnam-si (KR); **Min-Chul Kim**, Seoul (KR); **Seung-Wook Jeong**, Seoul (KR)

(Continued)

FOREIGN PATENT DOCUMENTS

CN 302619217 10/2013  
CN 304030191 \* 2/2017  
WO D087852-001 \* 1/2016

(73) Assignee: **S-Printing Solution Co., Ltd.**,  
Suwon-si (KR)

OTHER PUBLICATIONS

(\*) Notice: This patent is subject to a terminal disclaimer.

Amazon. <URL: [https://www.amazon.com/dp/B00IAUZVUG?ref=emc\\_b\\_5\\_i](https://www.amazon.com/dp/B00IAUZVUG?ref=emc_b_5_i)> Feb. 7, 2014. HP printer.\*

(Continued)

(\*\*) Term: **15 Years**

*Primary Examiner* — Bridget L Eland

*Assistant Examiner* — Lauren McVey

(21) Appl. No.: **29/570,166**

(74) *Attorney, Agent, or Firm* — NSIP Law

(22) Filed: **Jul. 6, 2016**

(57) **CLAIM**

We claim the ornamental design for a multi-function printer, as shown and described.

**Related U.S. Application Data**

**DESCRIPTION**

(63) Continuation of application No. 29/516,396, filed on Feb. 2, 2015, now Pat. No. Des. 763,958.

FIG. 1 is a front perspective view of a multi-function printer showing our new design;  
FIG. 2 is a front view thereof;  
FIG. 3 is a rear view thereof;  
FIG. 4 is a left-side view thereof;  
FIG. 5 is a right-side view thereof;  
FIG. 6 is a top view thereof; and,  
FIG. 7 is a bottom view thereof.

(30) **Foreign Application Priority Data**

Aug. 20, 2014 (KR) ..... 30-2014-0040562

(51) **LOC (11) Cl.** ..... **18-02**

(52) **U.S. Cl.**  
USPC ..... **D18/53**

(58) **Field of Classification Search**  
USPC ..... D18/53, 50, 54, 56, 59, 36, 38, 39, 40,  
D18/41, 45, 34.4, 34.5, 34.6; D14/301,  
D14/307

The broken lines that are immediately adjacent to the claim and define unshaded regions, represent the bounds of the claim and are not included in the claim, while all other broken lines are directed to environment; the broken lines form no part of the claimed design. In addition, the unshaded surface in the FIG. 7 view that directly adjoins the claimed solid line edge forms no part of the claimed design.

(Continued)

**1 Claim, 7 Drawing Sheets**

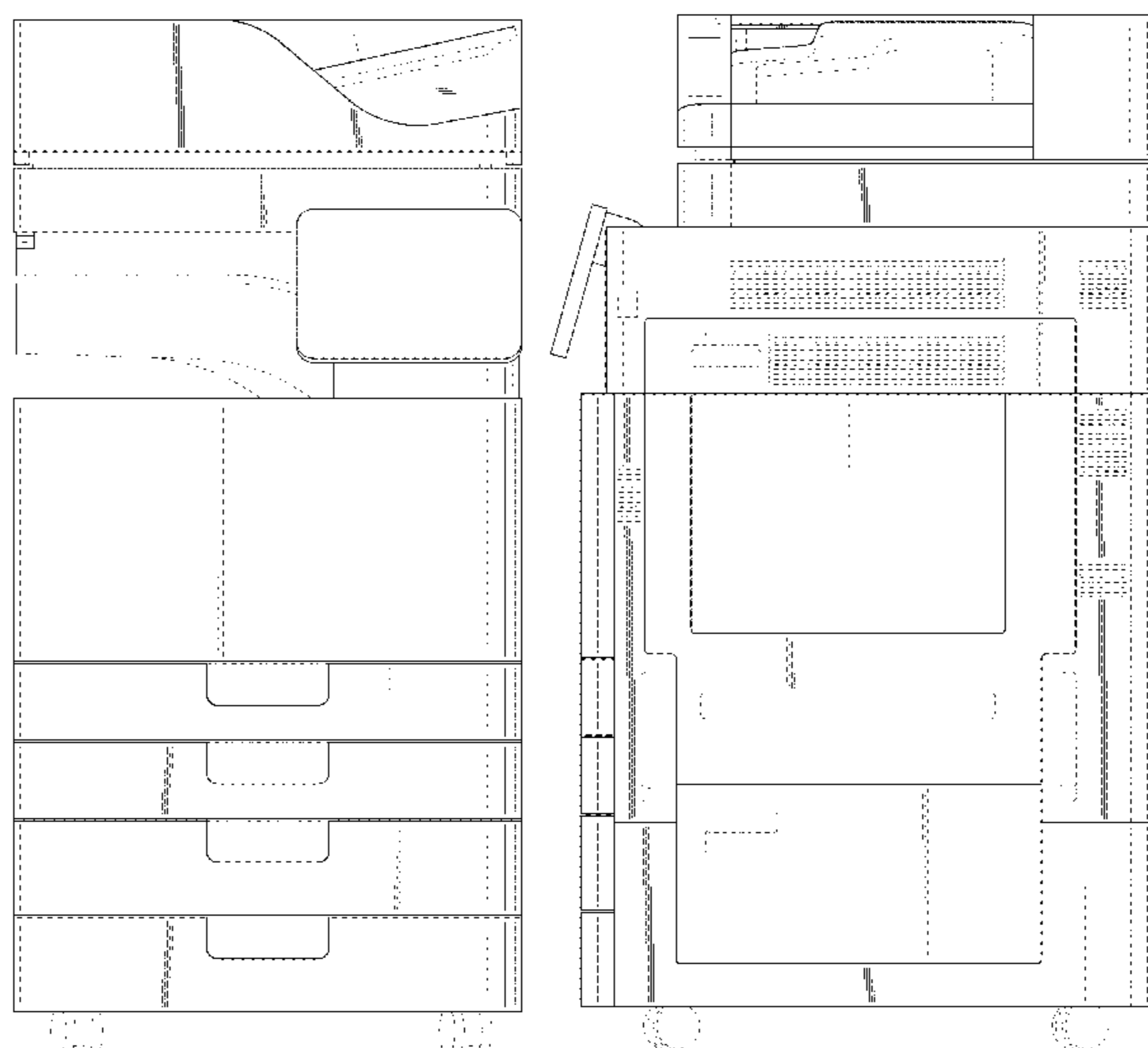

# US D815,199 S

Page 2

(58) **Field of Classification Search**

CPC .... G06K 15/12; G06K 15/14; H04N 1/00204;  
H04N 1/00249; H04N 1/00278; B41J  
3/00; B41J 3/28; B41J 3/445; B41J 3/46  
See application file for complete search history.

(56) **References Cited**

U.S. PATENT DOCUMENTS

D521,544 S 5/2006 Saito  
D573,177 S 7/2008 Isogai et al.  
D577,763 S 9/2008 Hidaka et al.  
D580,483 S \* 11/2008 Park ..... D18/39  
D626,588 S 11/2010 Kim et al.  
D685,414 S 7/2013 Jeong et al.  
D692,477 S 10/2013 Kim et al.  
D695,339 S 12/2013 Fukasawa et al.  
D701,563 S 3/2014 Kim et al.  
8,718,533 B2 5/2014 Yoon  
D724,140 S \* 3/2015 Nishimura ..... D18/50  
D726,249 S \* 4/2015 Kim ..... D18/53  
D727,410 S \* 4/2015 Saito ..... D18/36

D727,417 S \* 4/2015 Huang ..... D18/55  
D741,945 S 10/2015 Kawata  
D745,087 S \* 12/2015 Nagano ..... D18/36  
D745,600 S \* 12/2015 Nagano ..... D18/36  
D755,286 S \* 5/2016 Kim ..... D18/55  
D763,958 S \* 8/2016 Kim ..... D18/53  
D777,833 S \* 1/2017 Kim ..... D18/53  
D778,983 S \* 2/2017 Kim ..... D18/53  
D780,840 S \* 3/2017 Kim ..... D18/55  
2003/0228168 A1 12/2003 Okuda  
2008/0003010 A1 1/2008 Isogai et al.

OTHER PUBLICATIONS

Amazon. <URL: <http://a.co/6AteL8A>.> Sep. 13, 2016. Duplex Laser Printer.\*  
Samsung [brochure], <URL: [http://www.samsung.com/global/printingmsp/pdf/\[Brochure\]Smart%20MultiXpress%20K4350%20K4300%20K4250%20Series.pdf](http://www.samsung.com/global/printingmsp/pdf/[Brochure]Smart%20MultiXpress%20K4350%20K4300%20K4250%20Series.pdf)>. Sep. 27, 2014. Samsung A3 Multifunction Smart MultiXpress K4250RX printer.

\* cited by examiner

FIG. 1

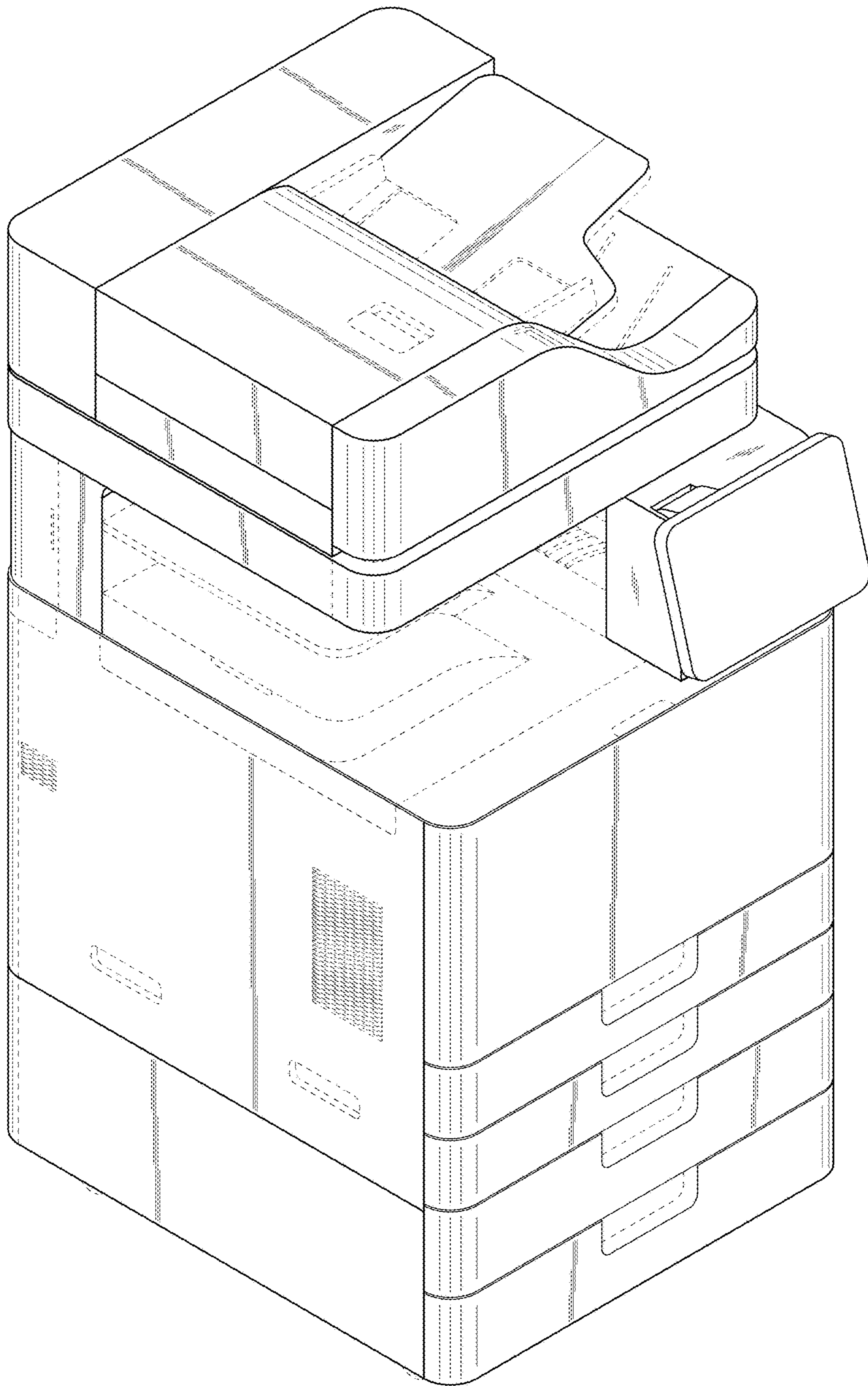

FIG.2

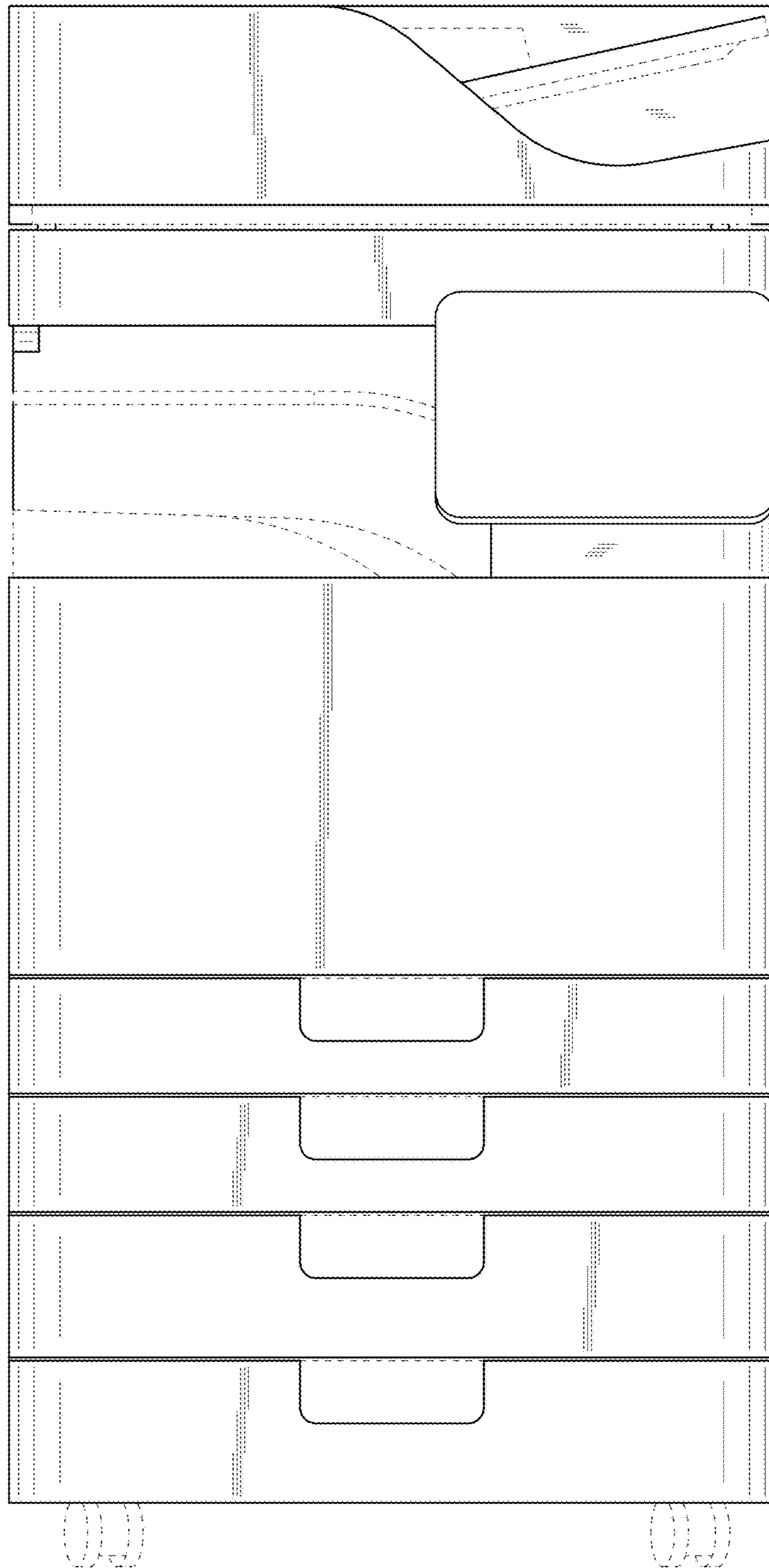

FIG.3

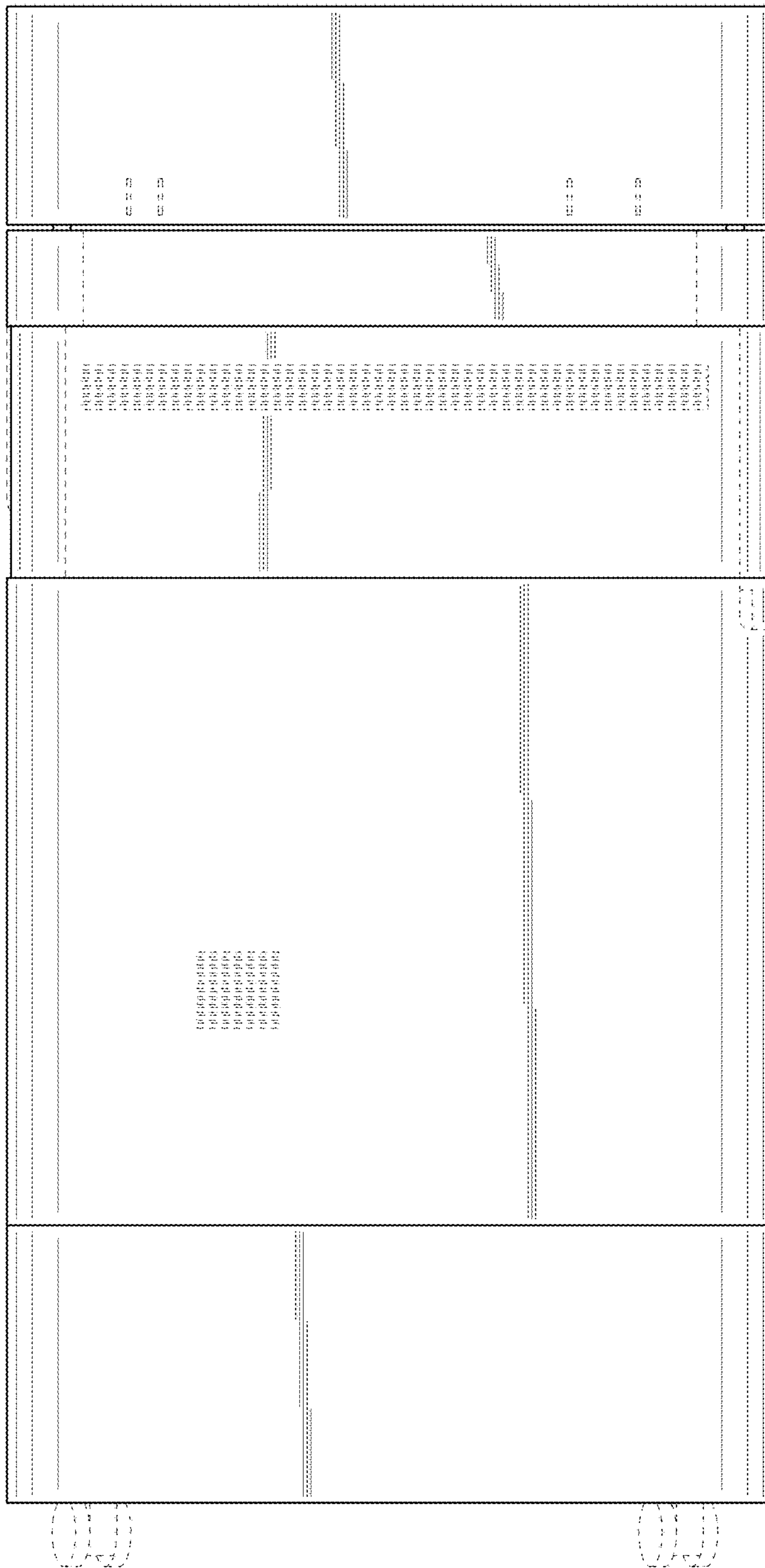

FIG.4

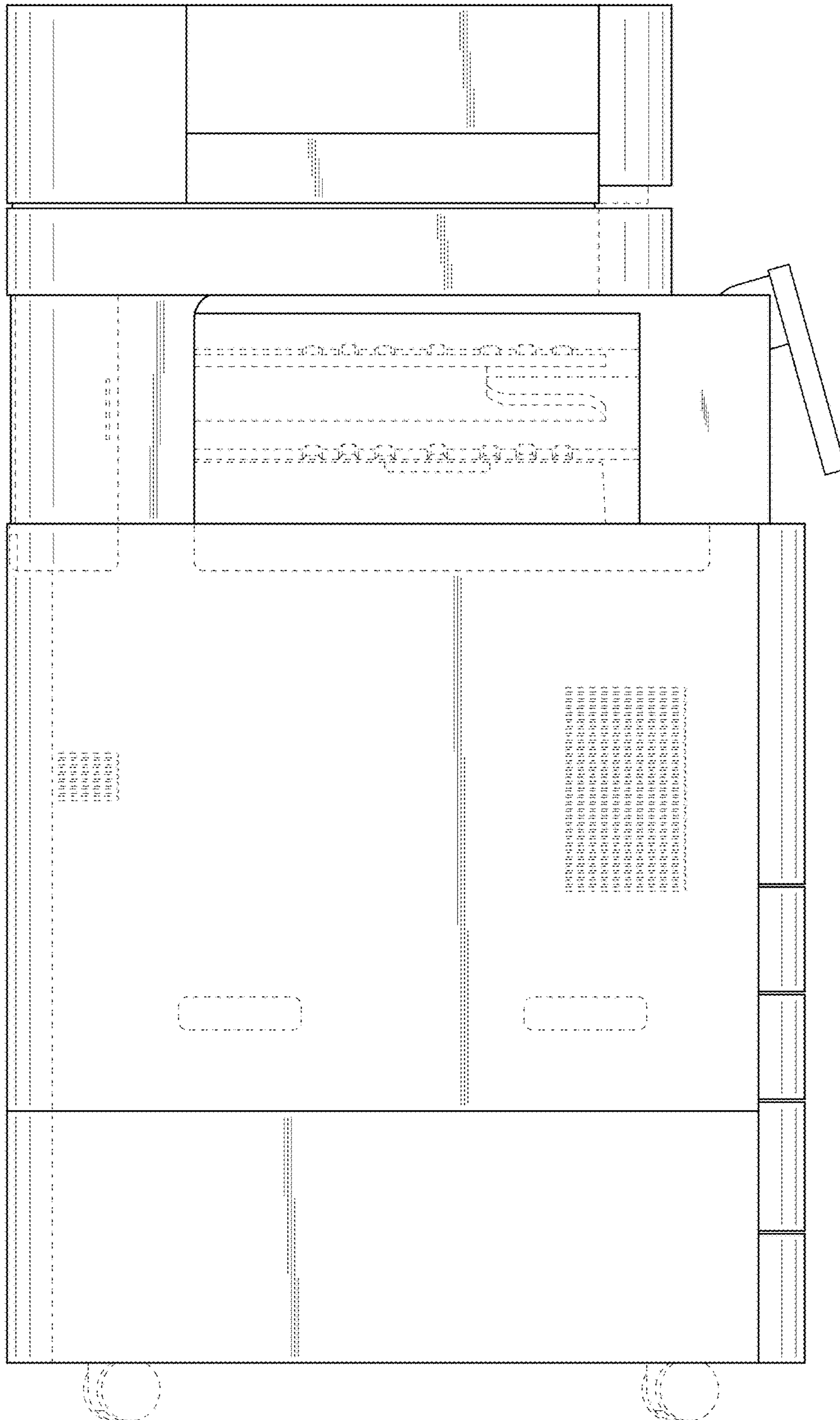

FIG.5

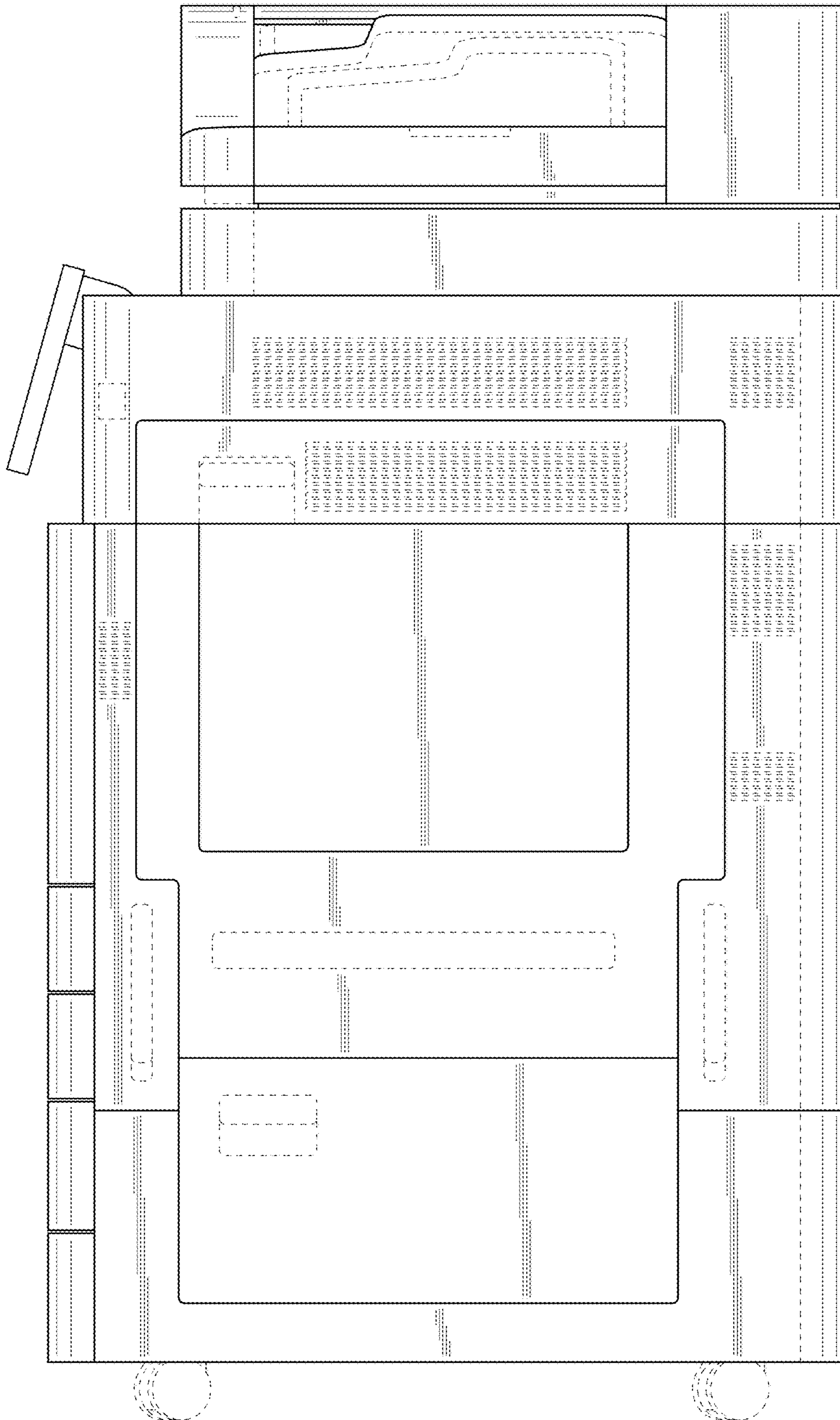

FIG.6

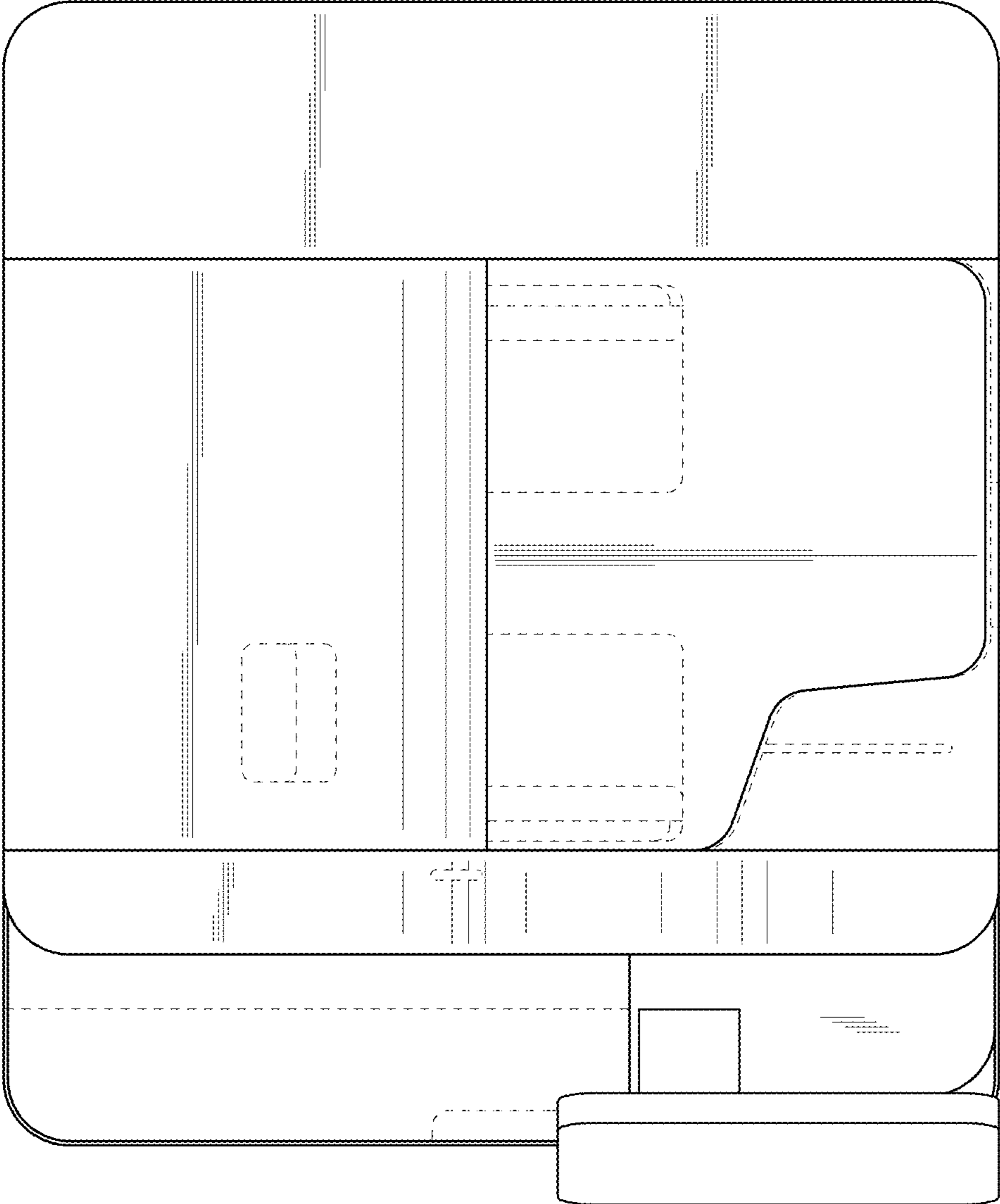



FIG.7

