



US00D813638S

(12) **United States Design Patent**
Hsieh

(10) **Patent No.:** **US D813,638 S**

(45) **Date of Patent:** **** Mar. 27, 2018**

(54) **TOOL RACK**

(71) Applicant: **Chih-Chien Hsieh**, Taichung (TW)

(72) Inventor: **Chih-Chien Hsieh**, Taichung (TW)

(**) Term: **15 Years**

(21) Appl. No.: **29/594,761**

(22) Filed: **Feb. 22, 2017**

(51) **LOC (11) Cl.** **08-05**

(52) **U.S. Cl.**
USPC **D8/71**

(58) **Field of Classification Search**
USPC D8/71, 72, 73, 74, 373; D6/400, 553,
D6/569; D15/133, 140; 248/218.4, 219.2
See application file for complete search history.

(56) **References Cited**

U.S. PATENT DOCUMENTS

| | | | | |
|-------------------|---------|----------|-------|-------------|
| D665,195 S * | 8/2012 | Hsieh | | D8/71 |
| D706,516 S * | 6/2014 | Caglia | | D1/105 |
| D709,806 S * | 7/2014 | Musgrove | | D12/167 |
| D756,022 S * | 5/2016 | Shipman | | D26/113 |
| D756,028 S * | 5/2016 | Shipman | | D26/113 |
| 9,597,792 B1 * | 3/2017 | Kao | | A47F 7/0028 |
| 9,656,385 B1 * | 5/2017 | Kao | | B25H 3/04 |
| D799,067 S * | 10/2017 | Forsberg | | D25/119 |
| 2010/0295748 A1 * | 11/2010 | Bradley | | H01Q 1/42 |
| | | | | 343/872 |
| 2010/0300996 A1 * | 12/2010 | Kao | | A47F 5/0846 |
| | | | | 211/70.6 |

| | | | | |
|-------------------|---------|-------|-------|--------------|
| 2011/0049069 A1 * | 3/2011 | Kao | | B25H 3/04 |
| | | | | 211/70.6 |
| 2011/0056897 A1 * | 3/2011 | Kao | | A47F 7/0028 |
| | | | | 211/70.6 |
| 2016/0221178 A1 * | 8/2016 | Hsieh | | B25H 3/04 |
| 2016/0271788 A1 * | 9/2016 | Hsieh | | B25H 3/04 |
| 2017/0305626 A1 * | 10/2017 | Jhu | | B65D 73/0064 |

* cited by examiner

Primary Examiner — Lakiya G Rogers

Assistant Examiner — Harold E Blackwell, II

(74) *Attorney, Agent, or Firm* — Egbert Law Offices, PLLC

(57) **CLAIM**

The ornamental design for a tool rack, as shown and described.

DESCRIPTION

FIG. 1 is a perspective view of a tool rack showing my new design;
FIG. 2 is a front elevational view thereof;
FIG. 3 is a rear elevational view thereof;
FIG. 4 is a left side view thereof;
FIG. 5 is a right side view thereof;
FIG. 6 is a top plan view thereof;
FIG. 7 is a bottom plan view thereof; and,
FIG. 8 is a perspective view showing the application thereof.
The broken line showing of the tool rack in FIG. 8 illustrates the environment of the claimed design and forms no part thereof.

1 Claim, 8 Drawing Sheets

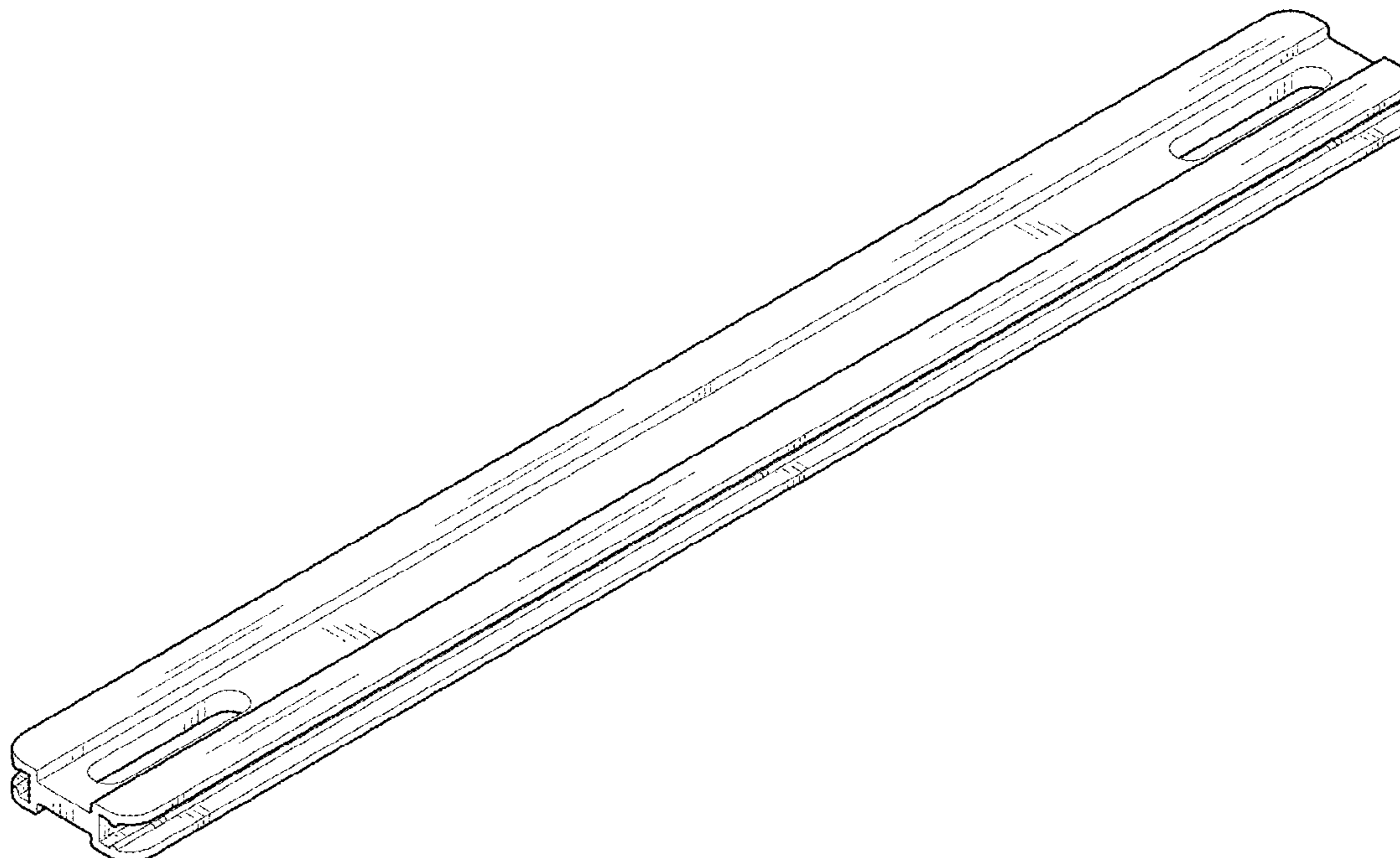

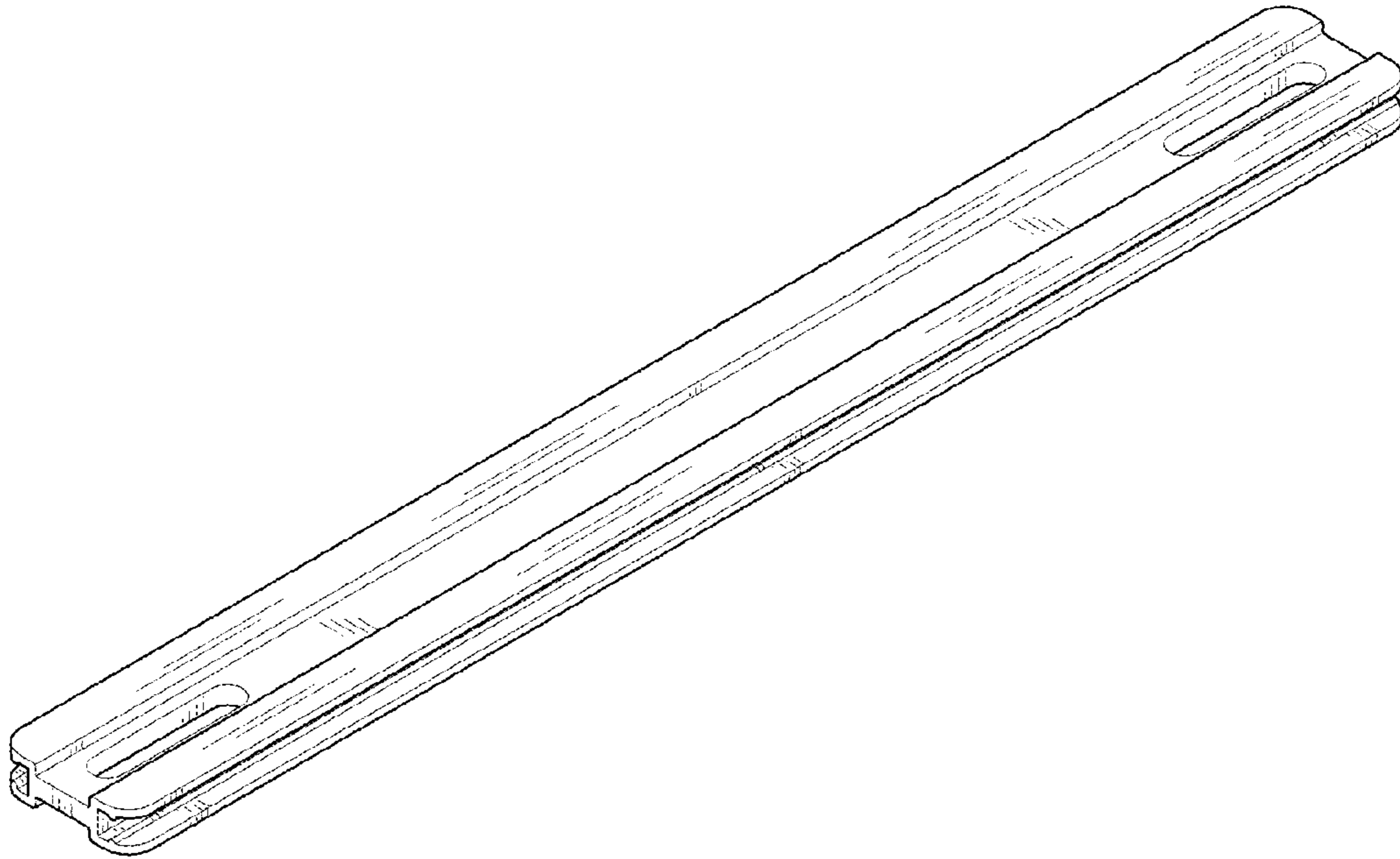

FIG.1

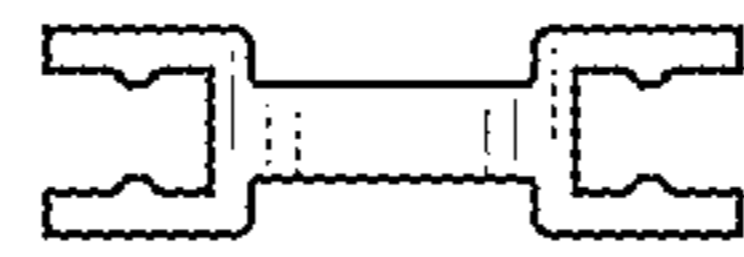

FIG.2

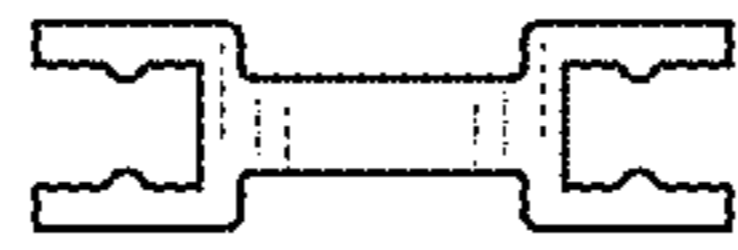

FIG. 3

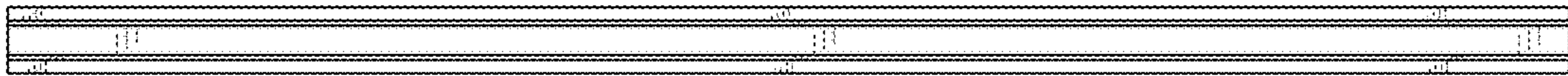

FIG. 4



FIG.5

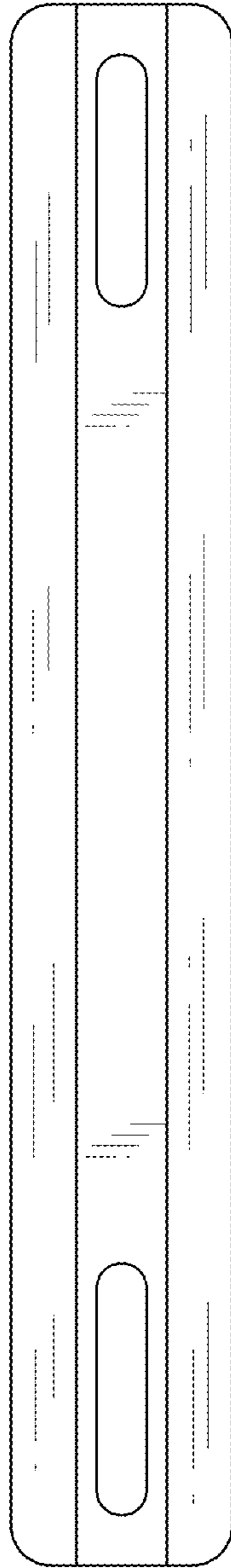

FIG.6

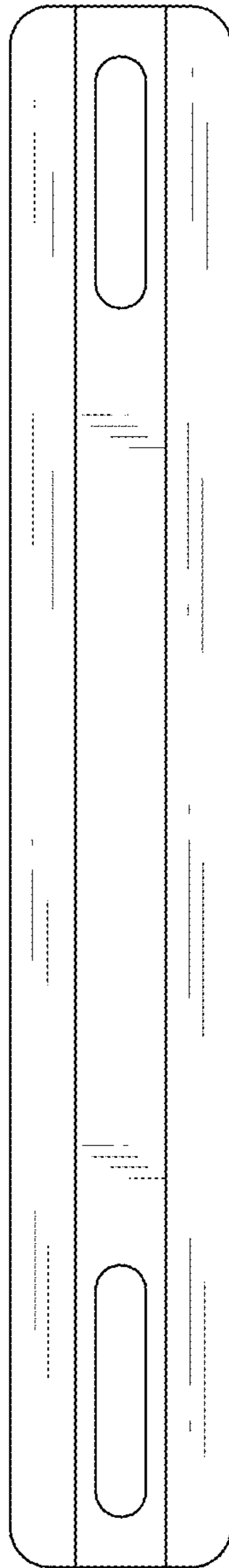

FIG. 7

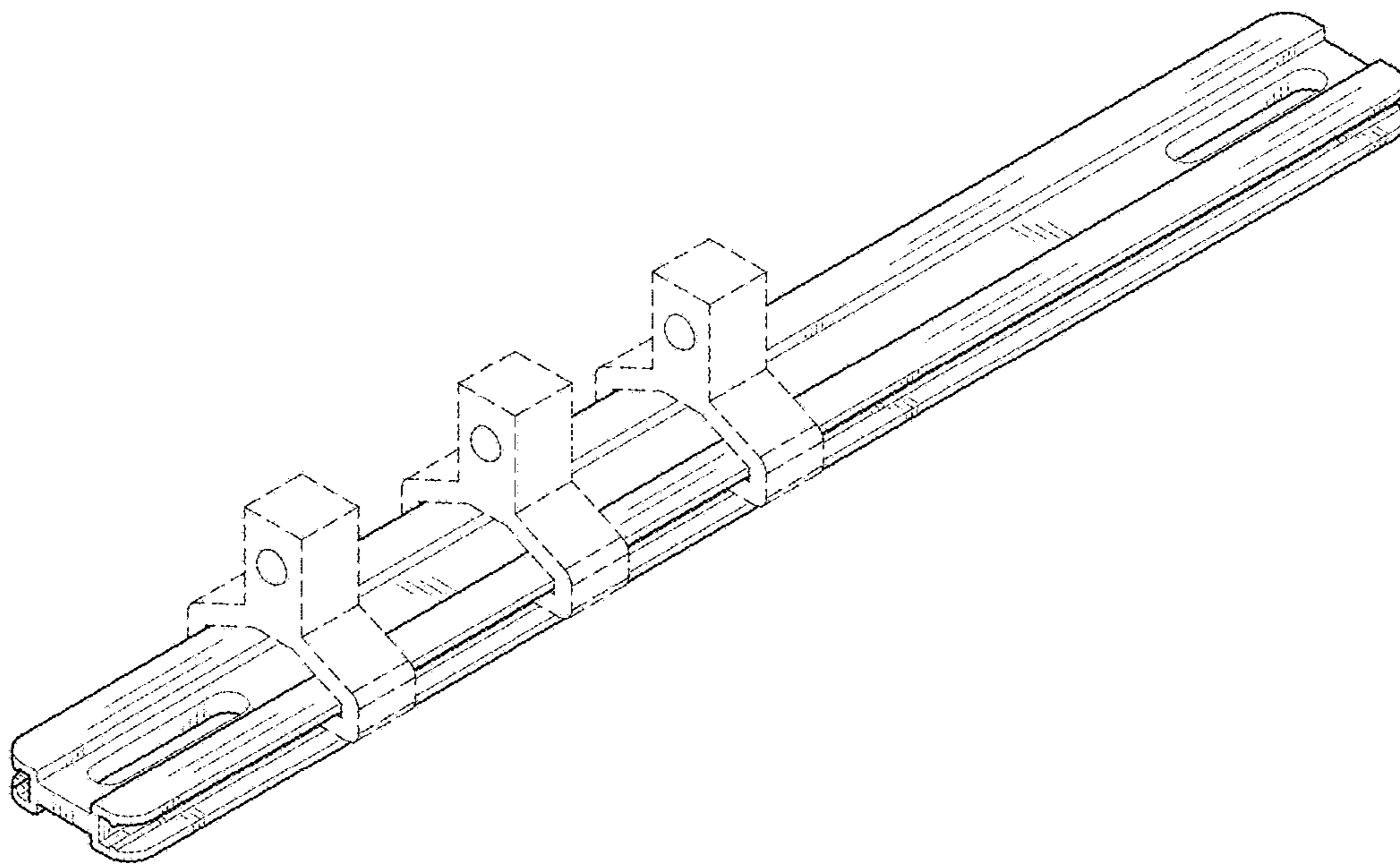

FIG. 8