



US00D811369S

(12) **United States Design Patent** (10) **Patent No.:** **US D811,369 S**
Pat et al. (45) **Date of Patent:** **** Feb. 27, 2018**

(54) **AUDIO COMPONENT**
(71) Applicant: **Harman International Industries, Incorporated**, Northridge, CA (US)
(72) Inventors: **Andrew Pat**, Potters Bar (GB); **Richard Morson**, Potters Bar (GB)
(73) Assignee: **Harman International Industries, Incorporated**, Northridge, CA (US)
(**) Term: **15 Years**

D357,255 S 4/1995 Ito et al.
D399,208 S 10/1998 Mackie et al.
D408,820 S 4/1999 Ito et al.
D424,056 S 5/2000 Ito et al.
D426,231 S 6/2000 Mackie
D434,407 S 11/2000 Mackie
D435,250 S 12/2000 Mackie et al.
D453,327 S 2/2002 Takita et al.
D455,731 S 4/2002 Mackie et al.
D490,800 S 6/2004 Kitazawa
D491,554 S 6/2004 Amiya
D499,394 S 12/2004 Suzuki

(Continued)

(21) Appl. No.: **29/556,244**
(22) Filed: **Feb. 29, 2016**

OTHER PUBLICATIONS

Design U.S. Appl. No. 29/599,310, filed Mar. 31, 2017.

Related U.S. Application Data

Primary Examiner — Ian Simmons

(63) Continuation of application No. 29/538,904, filed on Sep. 9, 2015, now abandoned.

Assistant Examiner — Khawaja Anwar

(51) **LOC (11) Cl.** **14-03**

(74) *Attorney, Agent, or Firm* — Plumsea Law Group, LLP

(52) **U.S. Cl.**

USPC **D14/217**

(58) **Field of Classification Search**

(57) **CLAIM**

USPC D14/217, 257, 258, 434, 496, 162, 167, D14/175, 188, 196-198

The ornamental design for an audio component, as shown and described.

CPC .. H03F 2200/451; H03F 3/19; H03F 2200/18; H03F 3/193; H03F 1/0205; H03F 1/0261; H03F 1/0277; H03F 1/223; H03F 1/3247; H03F 1/342; H03F 1/42; H03F 1/56; H03F 2200/129; H03F 2200/156; H03F 2200/294; H03F 2200/333; H03F 2200/408; H03F 2200/63; H03F 2200/93; H03F 2201/3215; H03F 2203/7236; H03F 3/21; H03F 3/211; H03F 3/24; H03F 3/245; H03F 3/3435; H03F 3/345; H03F 3/3455; H03F 3/72

DESCRIPTION

See application file for complete search history.

FIG. 1 is a perspective view of an audio component, specifically an audio mixing console, showing our new design;

FIG. 2 is top plan view thereof;

FIG. 3 is a side elevational view thereof;

FIG. 4 is a rear elevational view thereof;

FIG. 5 is a front elevational view thereof; and,

FIG. 6 is a bottom plan view thereof.

The heavy uneven broken line depicts a boundary of the claim and does not form part of the claimed design. The broken line showings depict environmental features which form no part of the claimed design.

(56) **References Cited**

U.S. PATENT DOCUMENTS

D325,383 S 4/1992 Ito et al.
D325,737 S 4/1992 Ito et al.

1 Claim, 6 Drawing Sheets

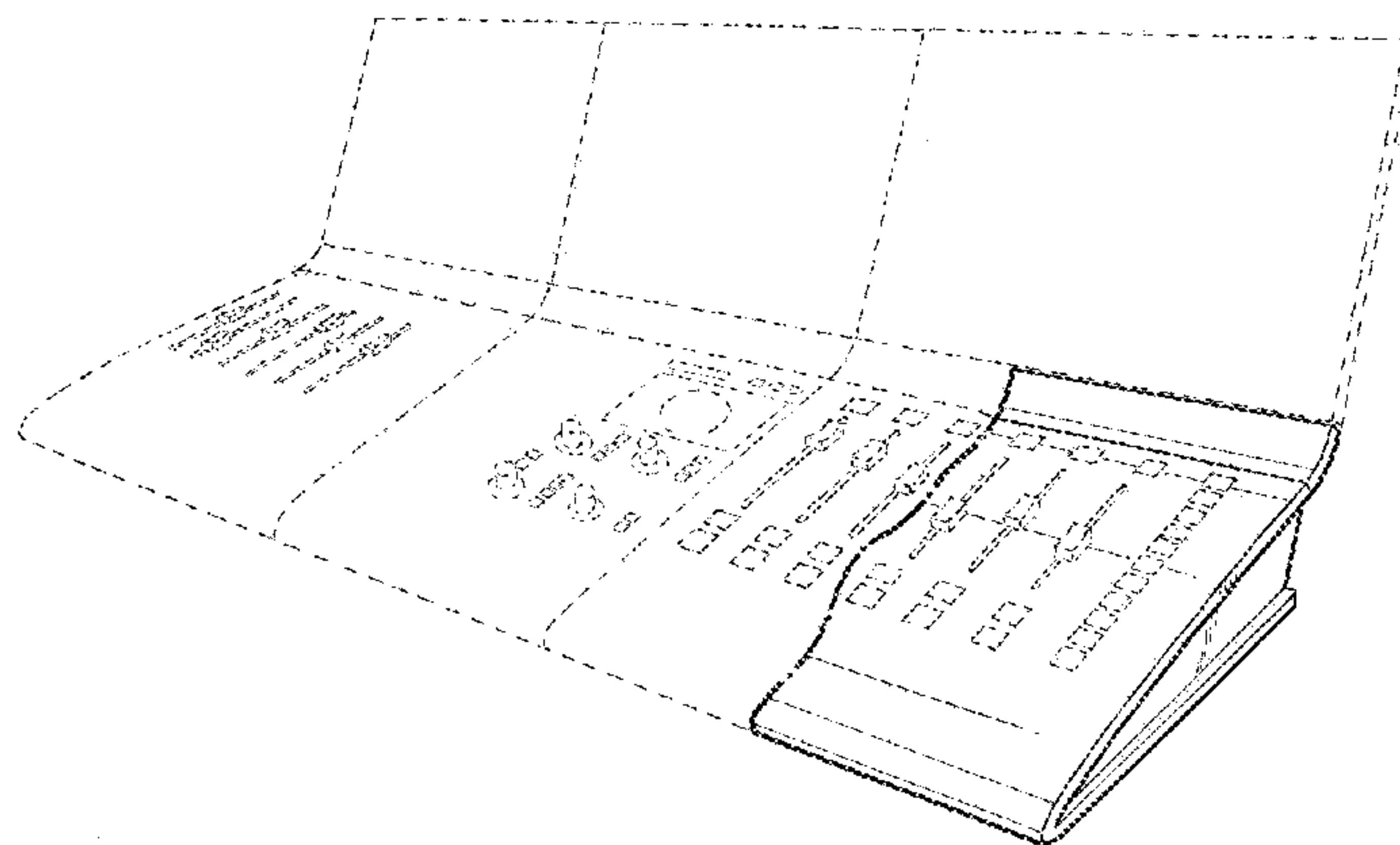

(56)

References Cited

U.S. PATENT DOCUMENTS

D593,544 S	6/2009	Iijima et al.	
D630,617 S	1/2011	Ayres et al.	
D643,410 S	8/2011	Blyth et al.	
D643,411 S	8/2011	Siegrist et al.	
D647,880 S	11/2011	Huber et al.	
D685,766 S	7/2013	Olswang et al.	
D690,683 S	10/2013	Olswang et al.	
D691,986 S	10/2013	Amiya	
D715,266 S	10/2014	Olswang et al.	
D717,278 S	11/2014	Amiya	
D721,353 S	1/2015	Money et al.	
D723,006 S	2/2015	Pat	
D730,324 S *	5/2015	Ito	D14/217
D743,942 S *	11/2015	Tschetter	D14/217
D747,699 S	1/2016	Mattioli	
D748,607 S *	2/2016	Ito	D14/217
D763,827 S *	8/2016	McMillen	D14/217
D769,226 S *	10/2016	Ito	D14/217
D772,200 S *	11/2016	Tschetter	D14/217
D776,088 S	1/2017	Karpowicz et al.	
D776,190 S *	1/2017	Kimura	D14/217
D778,261 S *	2/2017	Ito	D14/217
D778,262 S *	2/2017	Ito	D14/217
D780,718 S *	3/2017	Jackson	D14/217
D783,001 S *	4/2017	Tschetter	D14/217

* cited by examiner

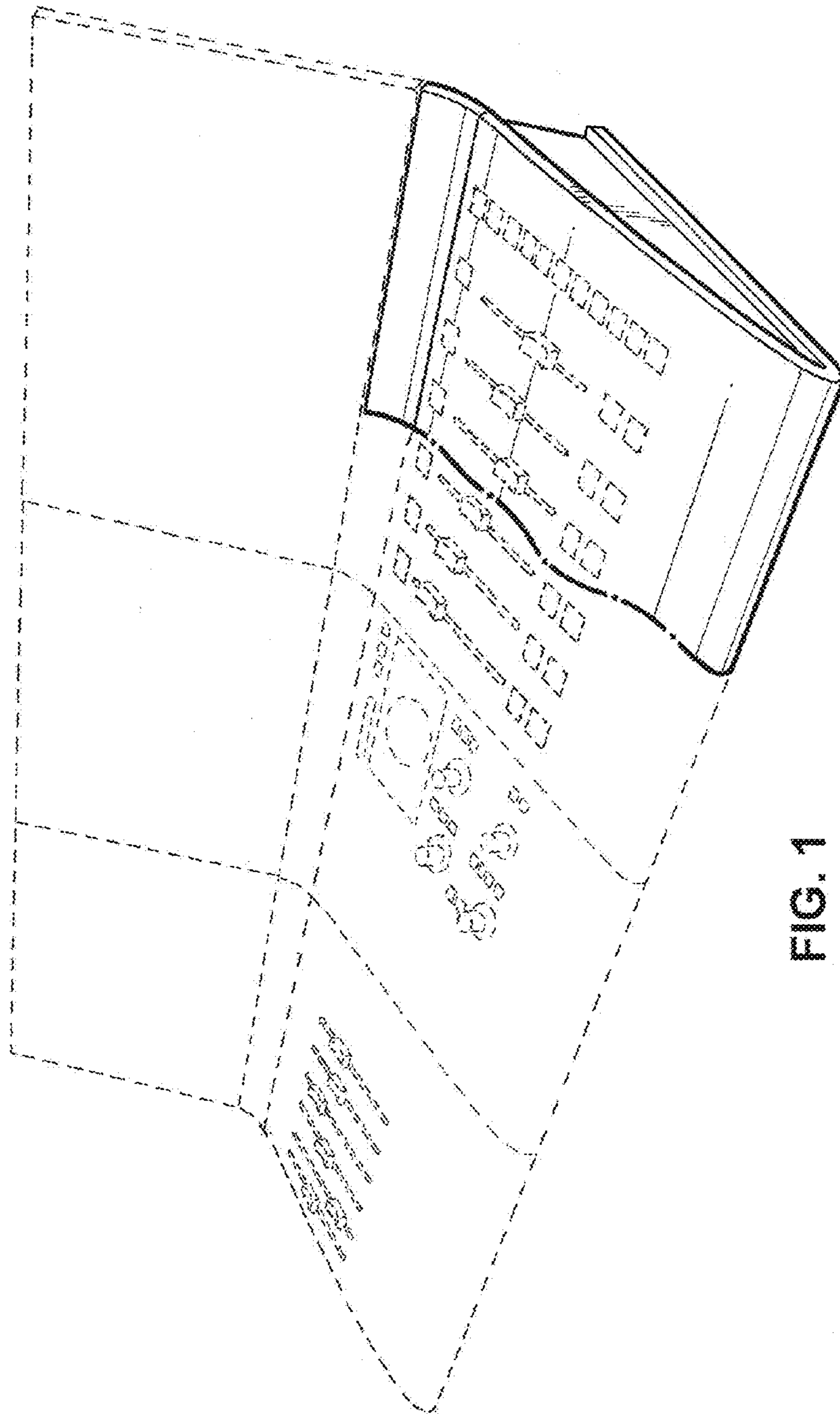

FIG. 1

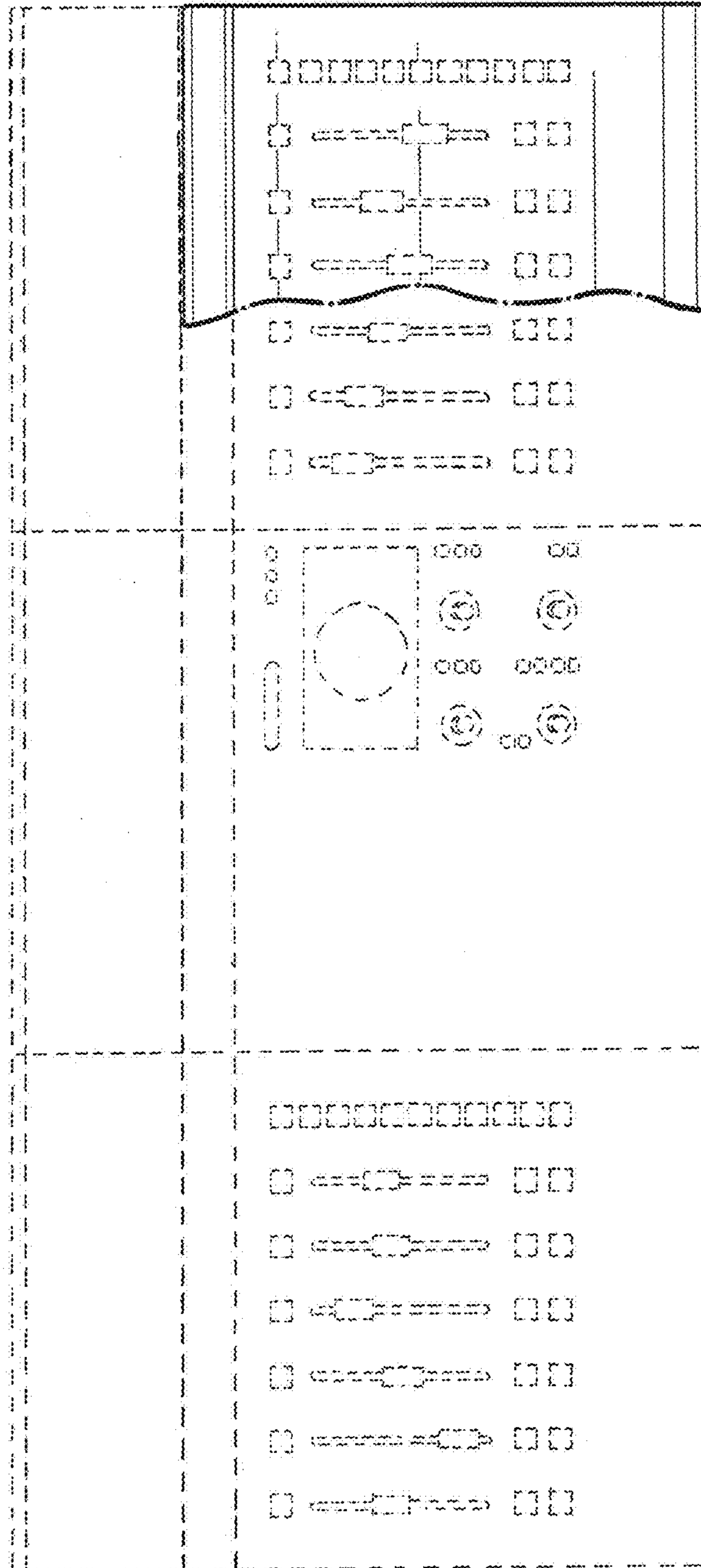

FIG. 2

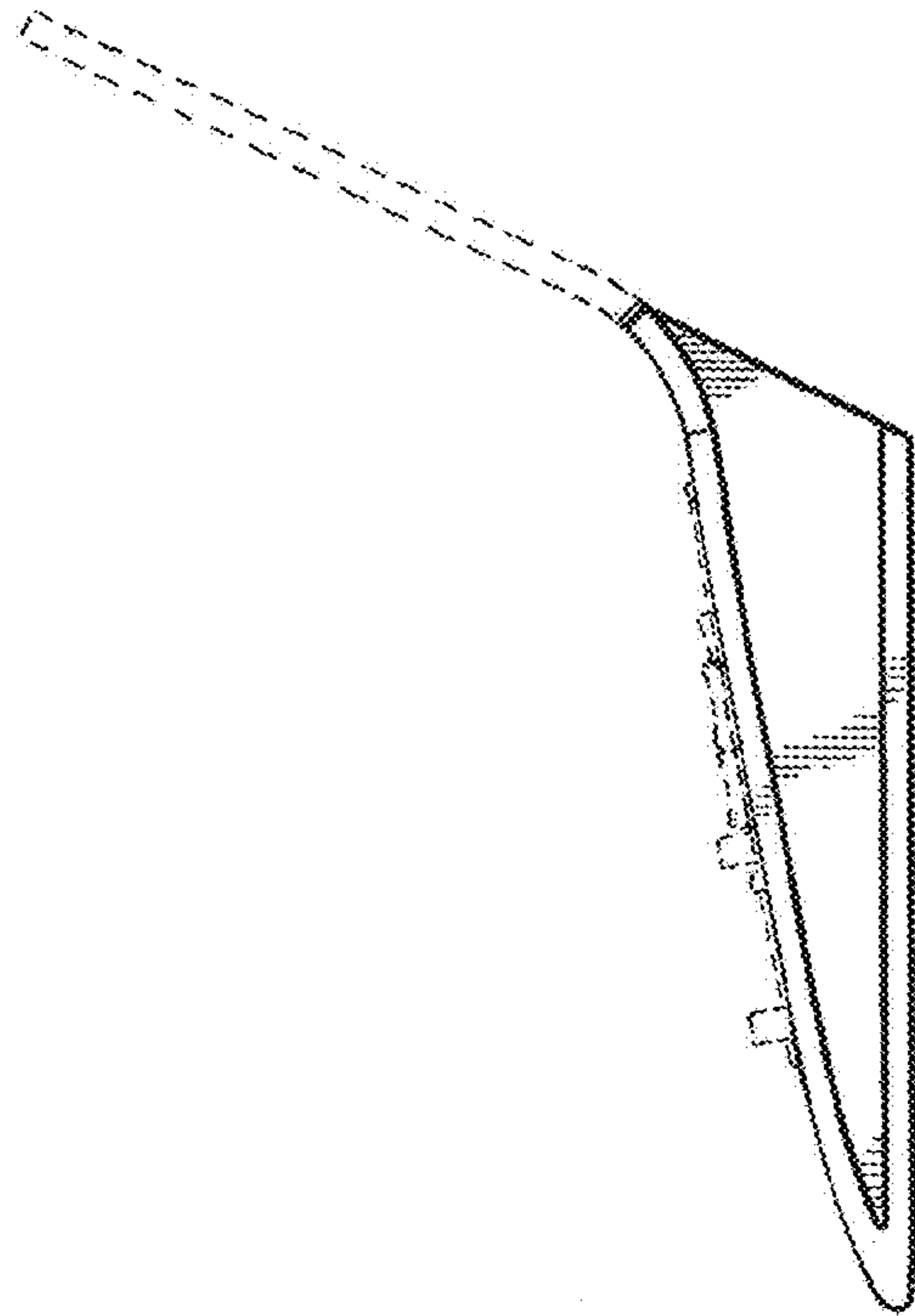

FIG. 3

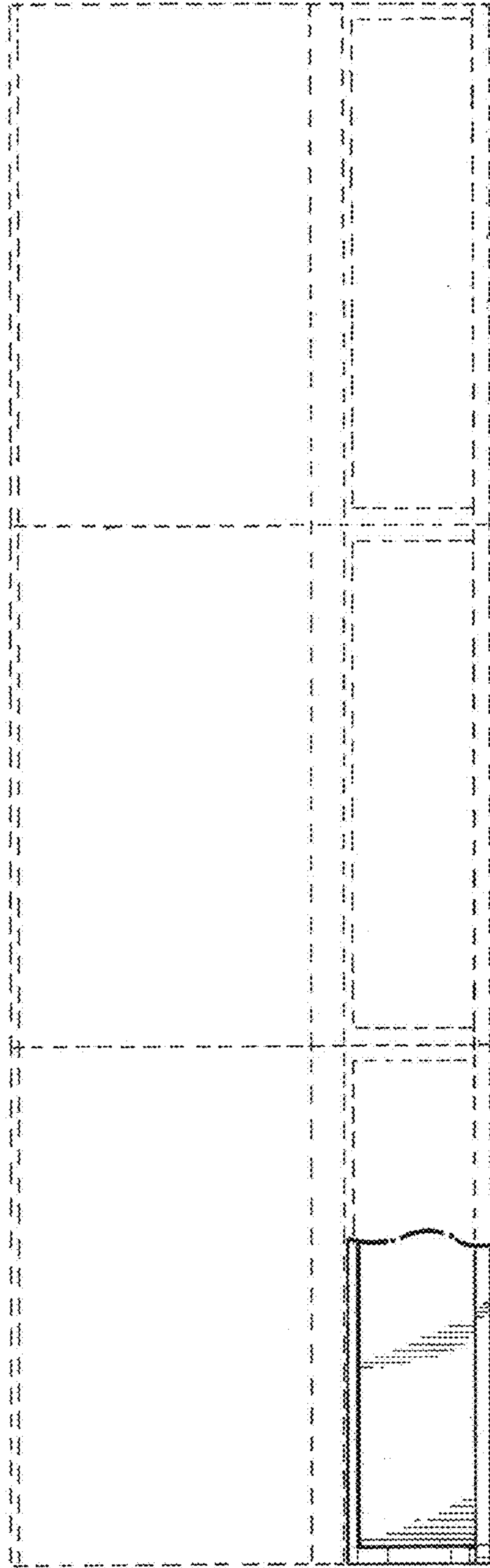

FIG. 4

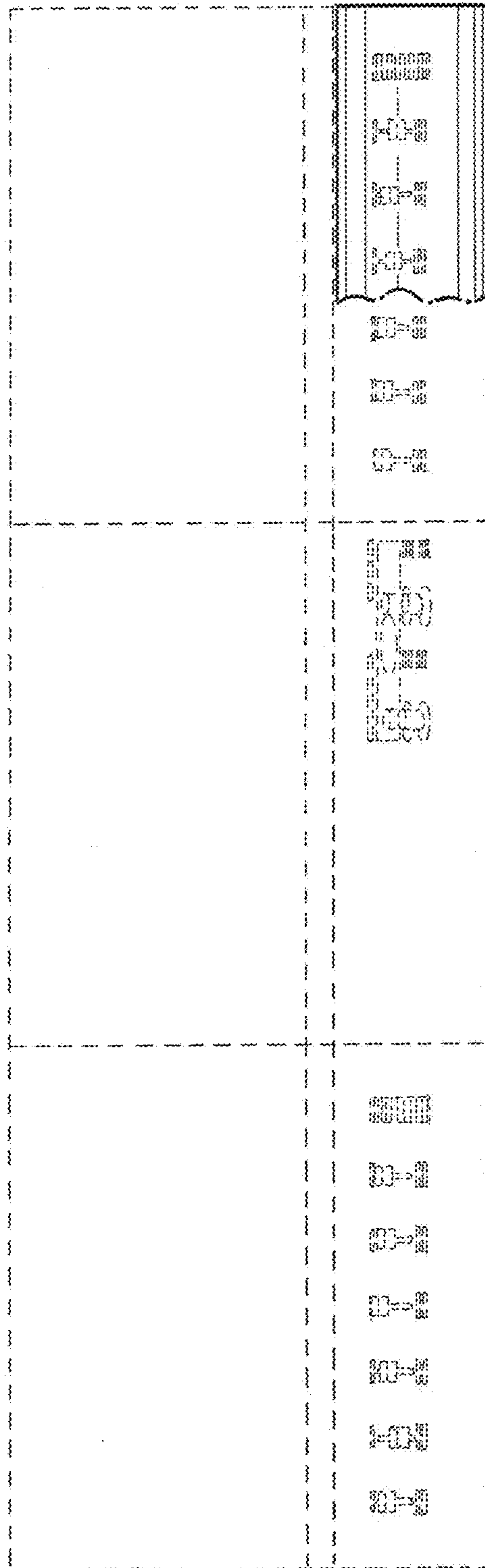

FIG. 5

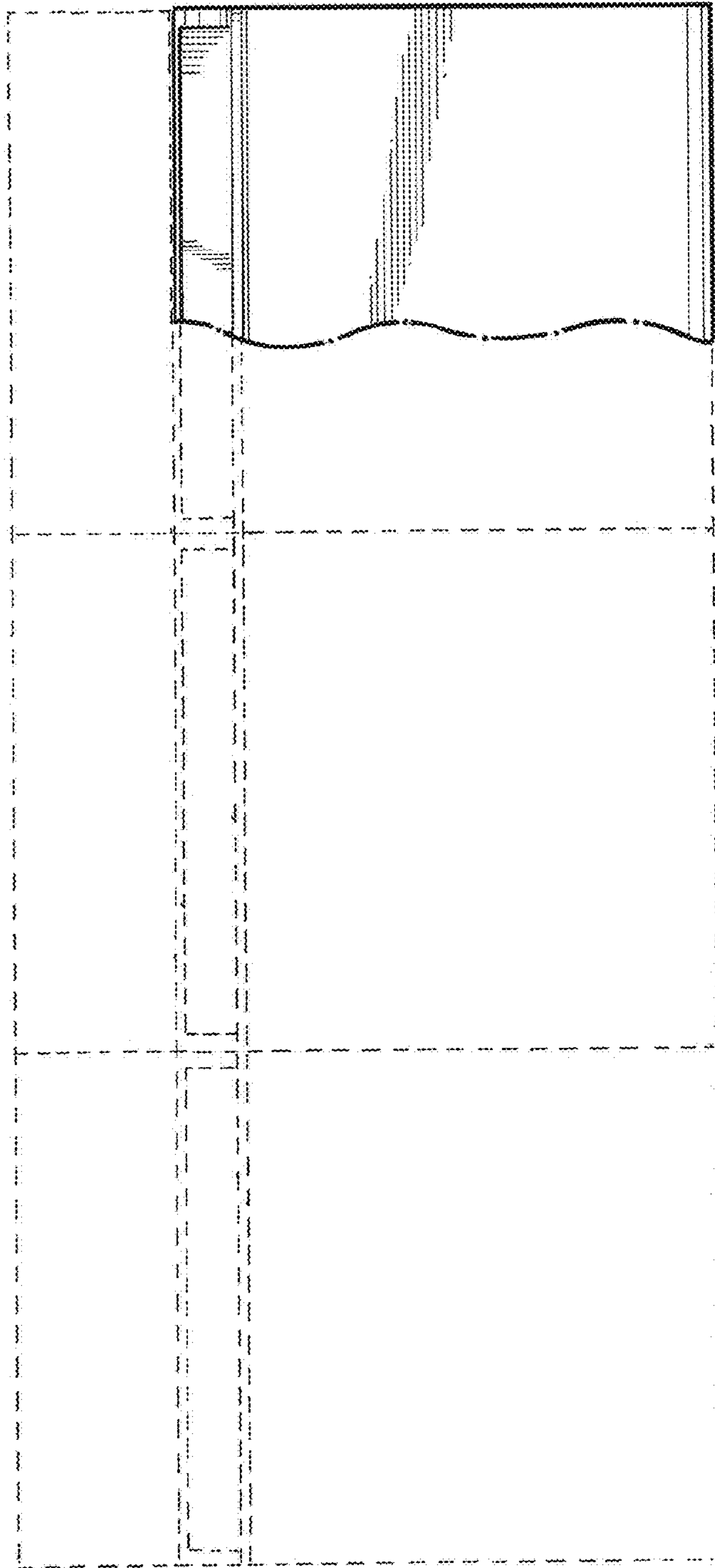

FIG. 6