



US00D810302S

(12) **United States Design Patent** (10) **Patent No.:** **US D810,302 S**
Park et al. (45) **Date of Patent:** **** Feb. 13, 2018**

(54) **ANCHOR FOR FIXING LIGAMENT** 6,440,134 B1 * 8/2002 Zaccherotti A61F 2/0811
606/232
(71) Applicants: **TDM., Co. Ltd.**, Gwangju (KR); **Seoul National University R&DB Foundation**, Seoul (KR) D531,486 S * 11/2006 Ferris D6/550
D658,482 S * 5/2012 Pratt D8/349
2013/0023929 A1 * 1/2013 Sullivan A61B 17/0401
606/232
(72) Inventors: **Sang-Soo Park**, Seoul (KR); **Tae Kyun Kim**, Seongnam-si (KR) 2016/0228117 A1 * 8/2016 Borden A61B 17/0401

FOREIGN PATENT DOCUMENTS

(73) Assignees: **TDM., CO. LTD.**, Gwangju-si (KR); **SEOUL NATIONAL UNIVERSITY R&DB FOUNDATION**, Seoul (KR) EP 1813225 A2 * 8/2007 A61F 2/0811
EP 1813226 A1 * 8/2007 A61F 2/0811
GB WO-9216167 A1 * 10/1992 A61F 2/0811

(**) Term: **15 Years**

* cited by examiner

(21) Appl. No.: **29/570,288**

Primary Examiner — Sheryl Lane

(22) Filed: **Jul. 7, 2016**

Assistant Examiner — Calvin E Vansant

(30) **Foreign Application Priority Data**

(74) *Attorney, Agent, or Firm* — Lex IP Meister, PLLC

Feb. 11, 2016 (KR) 30-2016-0006142

(51) **LOC (11) Cl.** **24-02**

(52) **U.S. Cl.**
USPC **D24/171**

(58) **Field of Classification Search**
USPC D24/145, 155, 171, 190, 192;
D29/120.1, 121.1; D8/367, 385
CPC A61F 2002/0852; A61B 2017/0404; A61B
17/0401; A61B 17/0414
See application file for complete search history.

(57) **CLAIM**

The ornamental design for an anchor for fixing ligament, as shown and described.

(56) **References Cited**

U.S. PATENT DOCUMENTS

4,590,928 A * 5/1986 Hunt A61B 17/686
606/327
6,245,073 B1 * 6/2001 Conteduca A61F 2/0811
606/232

DESCRIPTION

FIG. 1 is a perspective view of anchor for fixing ligament showing my new design;
FIG. 2 is a front elevational view thereof;
FIG. 3 is a rear elevational view thereof;
FIG. 4 is a left side elevational view thereof;
FIG. 5 is a right side elevational view thereof;
FIG. 6 is a top plan view thereof; and,
FIG. 7 is a bottom plan view thereof.
The broken lines depict unclaimed subject matter only and form no part of the claimed design.

1 Claim, 4 Drawing Sheets

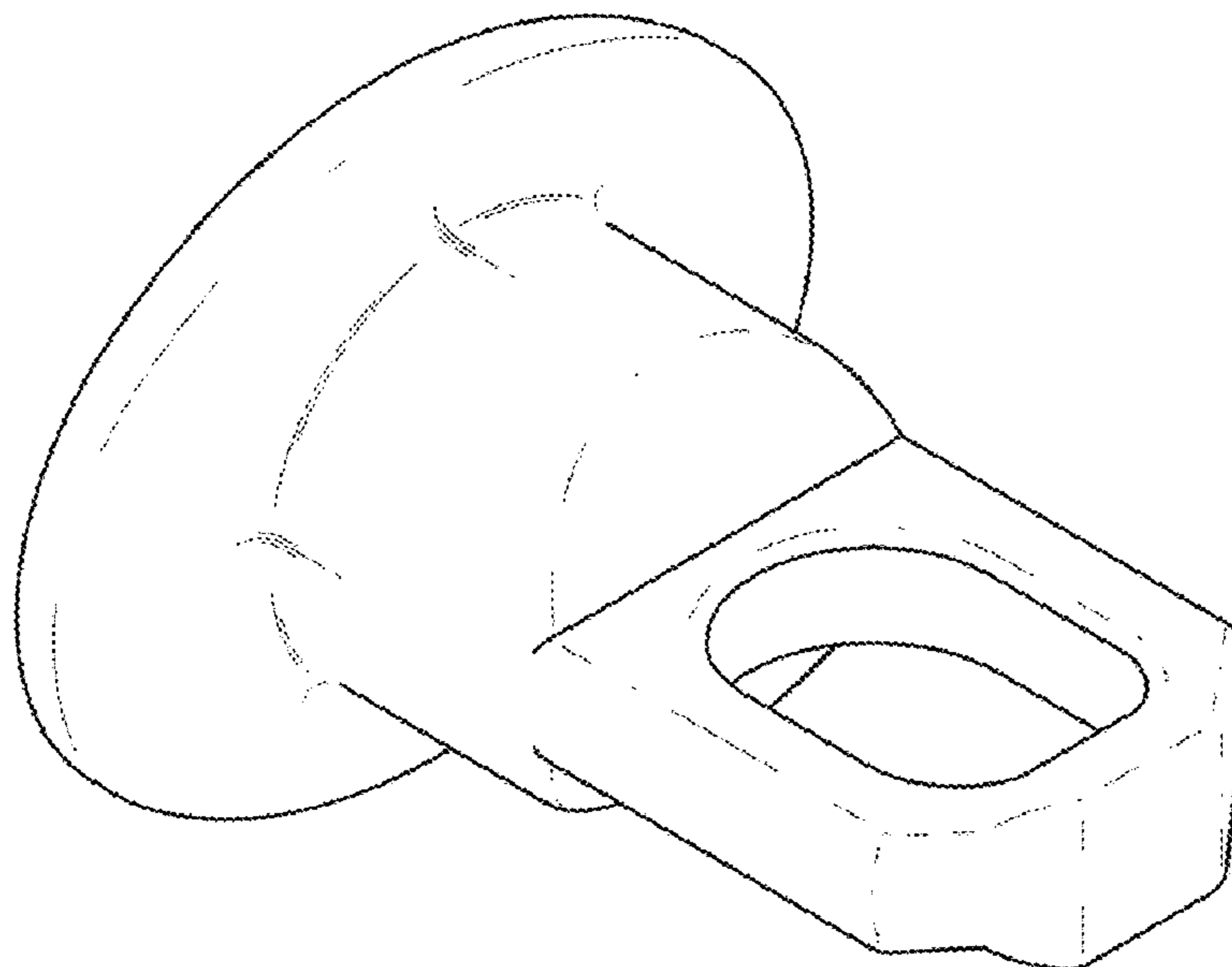

FIG. 1

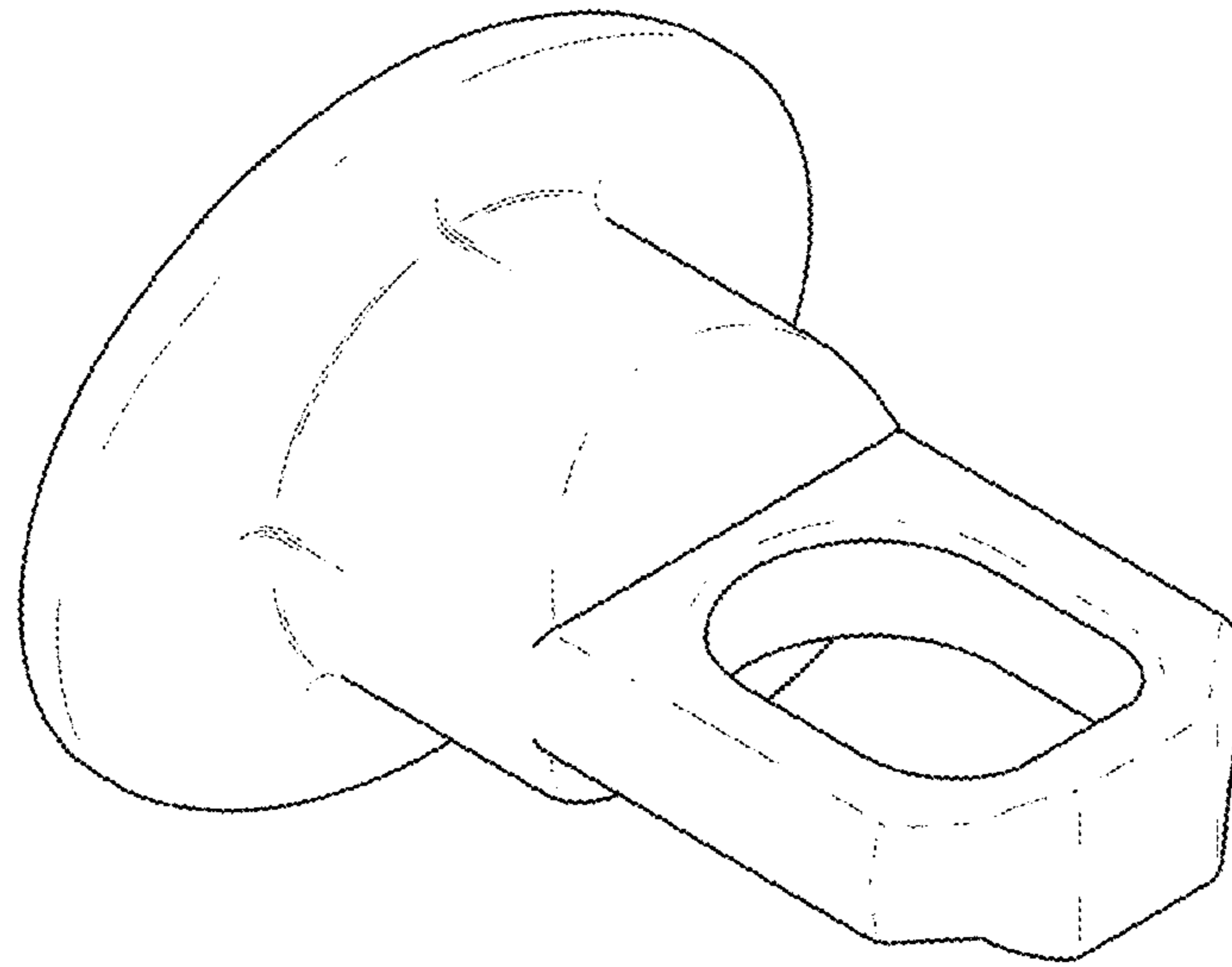

FIG. 2

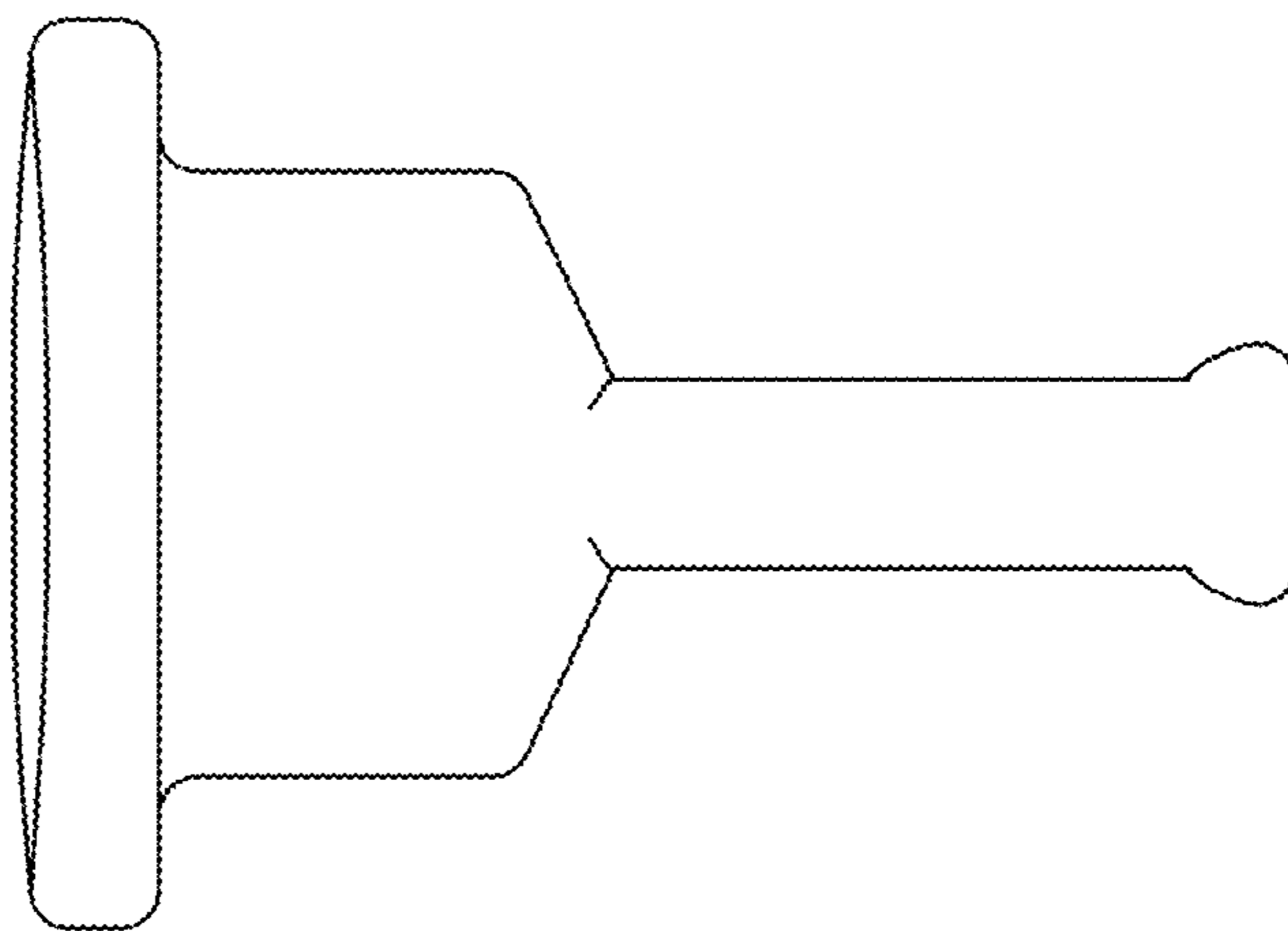

FIG. 3

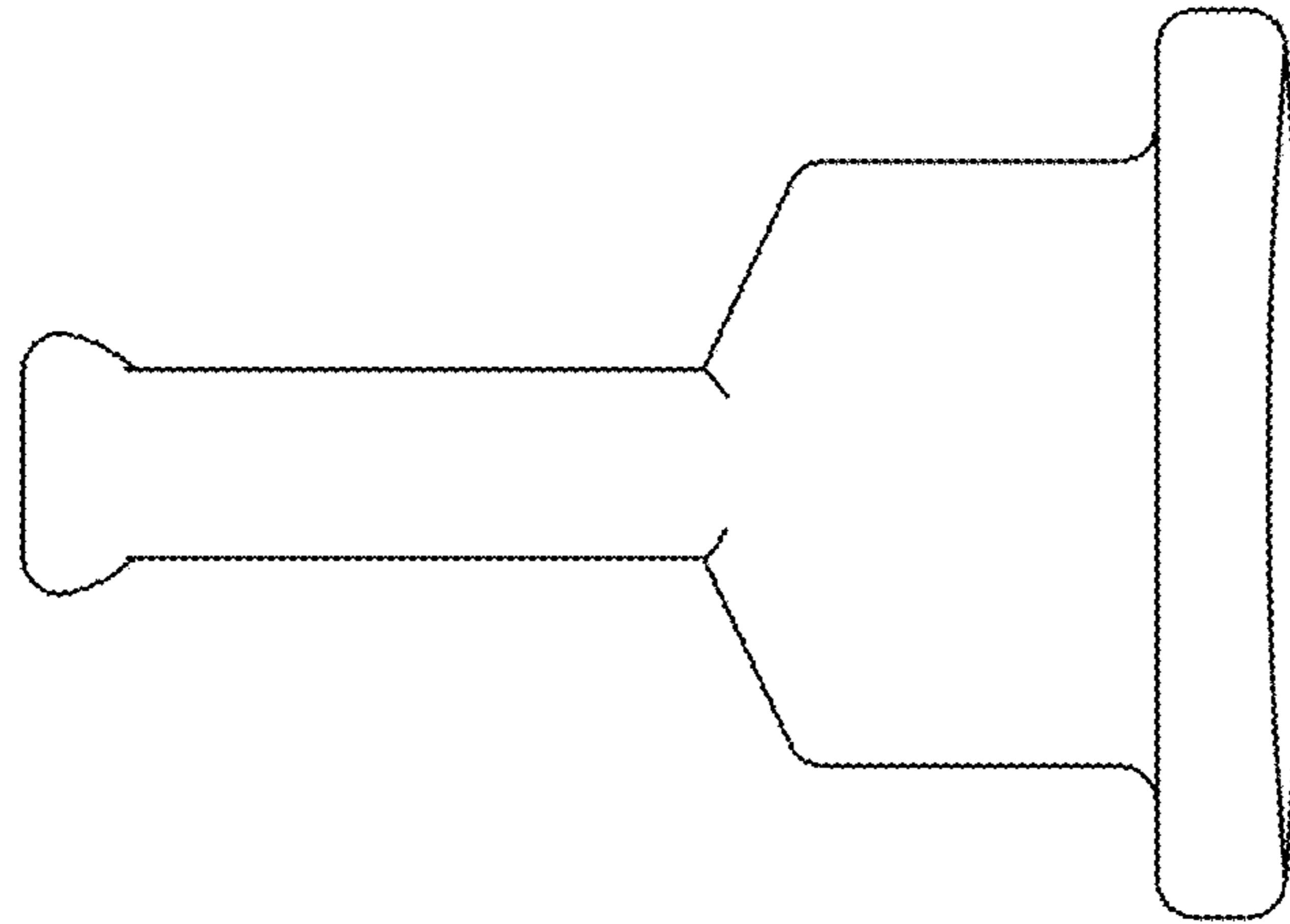

FIG. 4

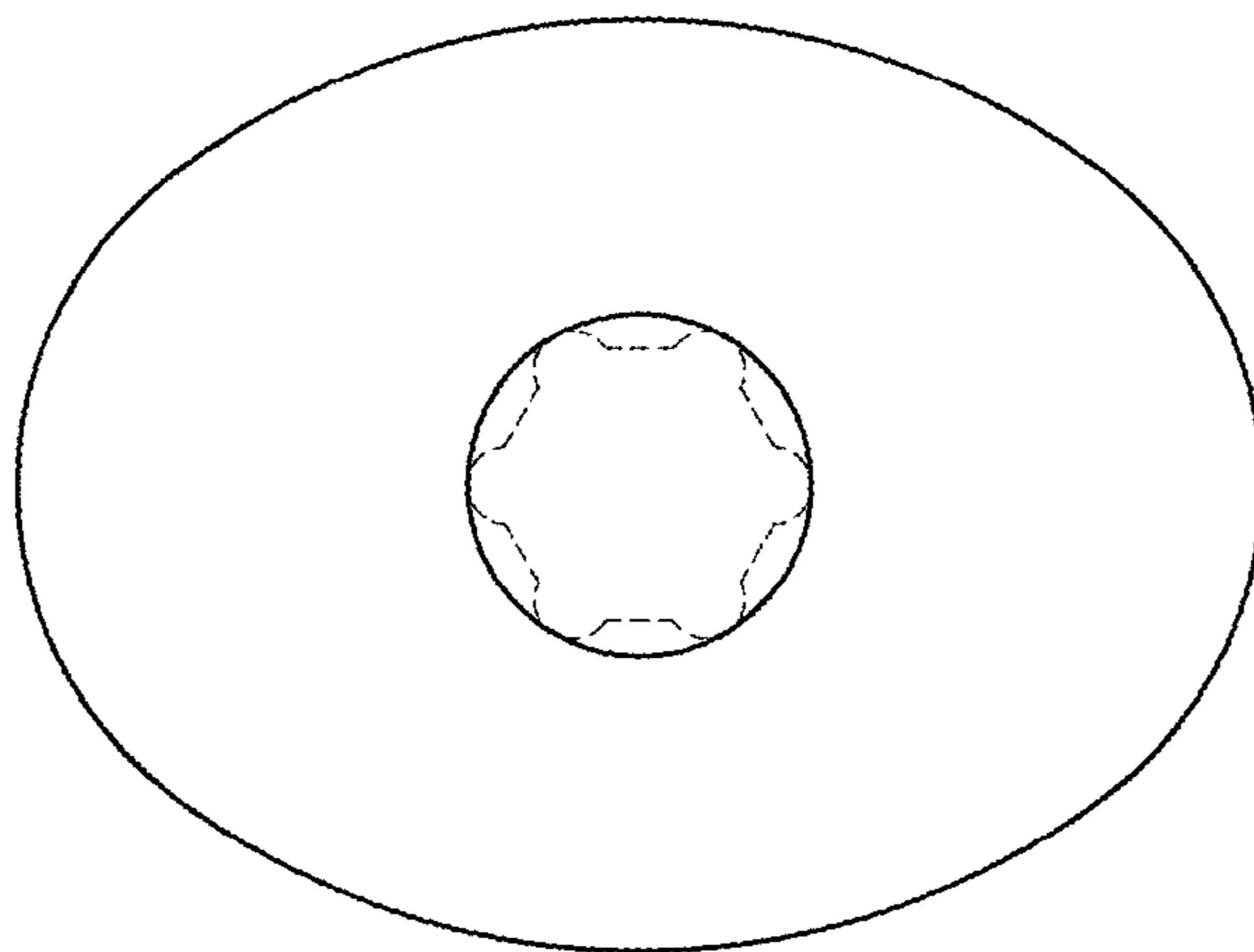

FIG. 5

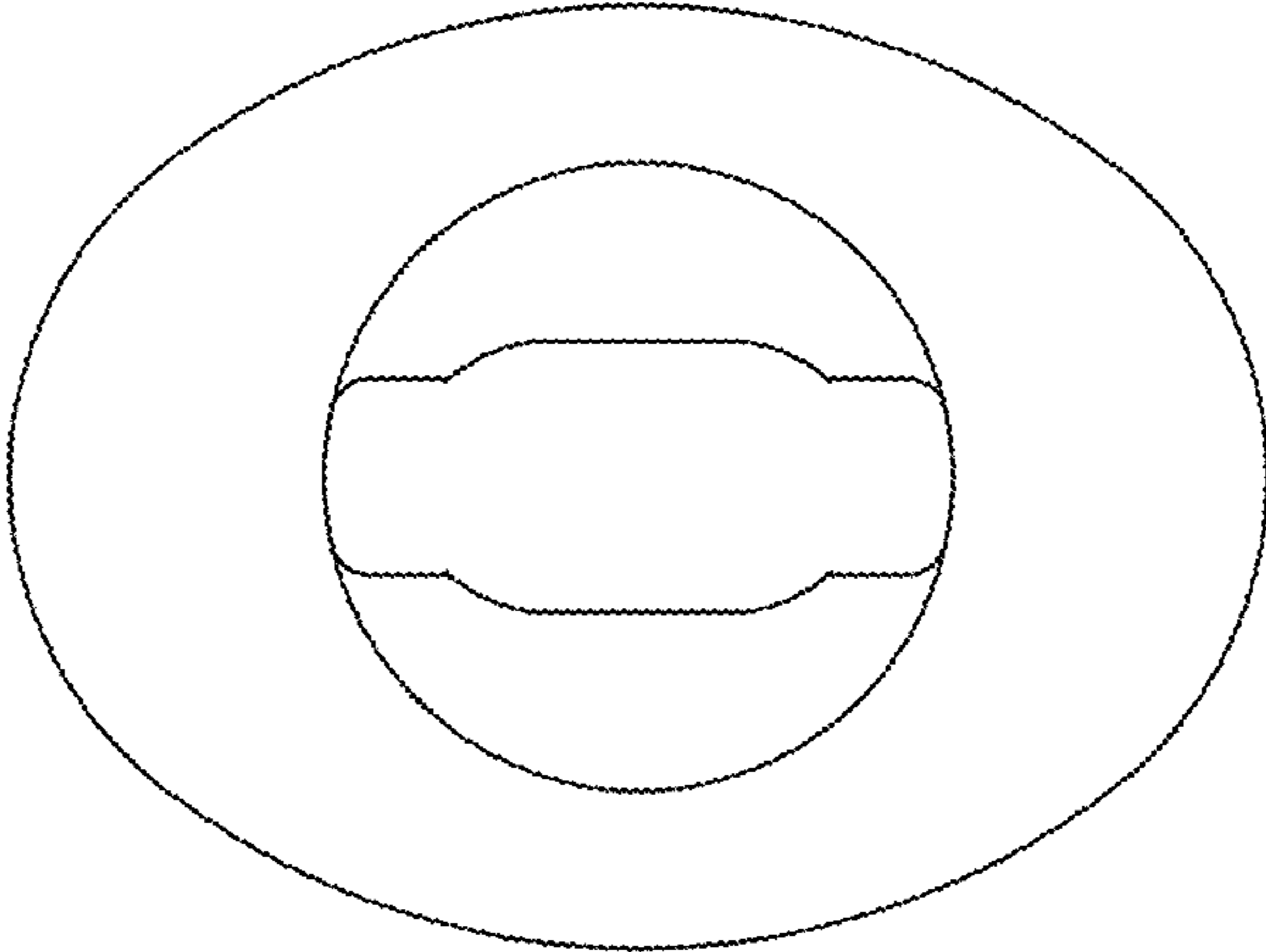

FIG. 6

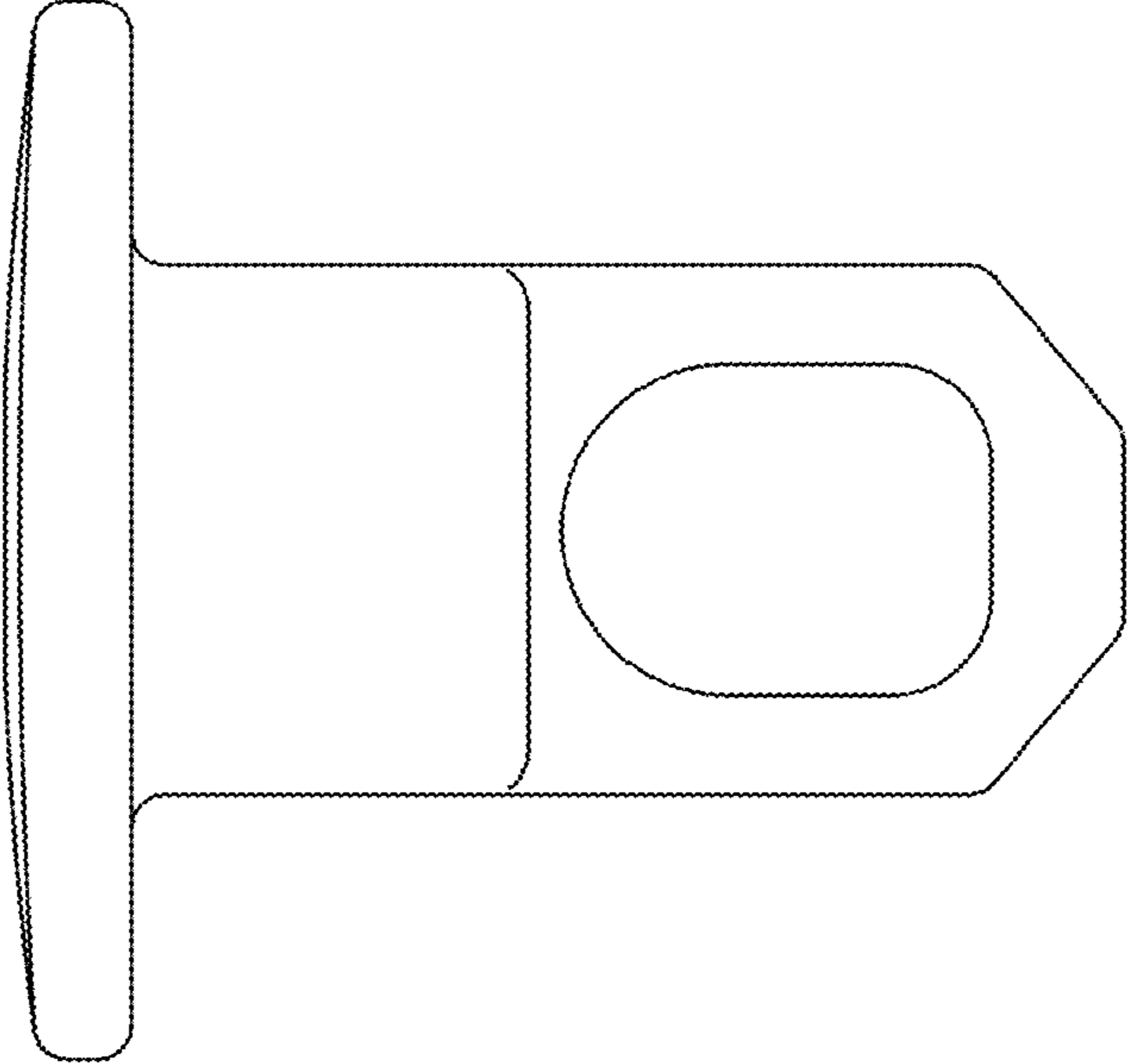

FIG. 7

