



US00D810033S

(12) **United States Design Patent**  
**Otsuka et al.**

(10) **Patent No.:** **US D810,033 S**  
(45) **Date of Patent:** **\*\* Feb. 13, 2018**

(54) **MAIN BODY OF PUSH SWITCH**  
(71) Applicant: **OMRON Corporation**, Kyoto-shi,  
Kyoto (JP)  
(72) Inventors: **Hiroyuki Otsuka**, Okayama (JP);  
**Kazuaki Morita**, Izumo (JP); **Shinya**  
**Katsube**, Okayama (JP)  
(73) Assignee: **OMRON Corporation**, Kyoto-shi (JP)  
(\*\*) Term: **15 Years**

2011/0315533 A1\* 12/2011 Chu ..... H01H 13/023  
200/345  
2012/0048707 A1\* 3/2012 Nakamura ..... H01H 13/14  
200/517  
2013/0126322 A1\* 5/2013 Heiskanen ..... H01H 13/14  
200/341  
2014/0097073 A1\* 4/2014 Kikuchi ..... H01H 13/14  
200/512  
2016/0064158 A1\* 3/2016 Nakase ..... H01H 13/14  
200/275  
2016/0064163 A1\* 3/2016 Chu ..... H01H 13/023  
200/314  
2016/0111231 A1\* 4/2016 Choi ..... H01H 13/14  
200/344

(21) Appl. No.: **29/586,518**

\* cited by examiner

(22) Filed: **Dec. 5, 2016**

*Primary Examiner* — Selina Sikder

(30) **Foreign Application Priority Data**

(74) *Attorney, Agent, or Firm* — Sterne, Kessler,  
Goldstein & Fox P.L.L.C.

Jun. 14, 2016 (JP) ..... 2016-012731

(51) **LOC (11) Cl.** ..... **13-03**

(52) **U.S. Cl.**  
USPC ..... **D13/173; D13/158**

(58) **Field of Classification Search**  
USPC ..... D13/158, 162, 171, 173, 184  
CPC ..... H01H 1/20; H01H 3/3042; H01H 13/04;  
H01H 13/14

See application file for complete search history.

(57) **CLAIM**

The ornamental design for a main body of push switch, as shown and described.

**DESCRIPTION**

FIG. 1 is a perspective view of a main body of push switch showing the claimed design;  
FIG. 2 is a front view thereof;  
FIG. 3 is a rear view thereof;  
FIG. 4 is a left side view thereof;  
FIG. 5 is a right side view thereof;  
FIG. 6 is a top view thereof; and,  
FIG. 7 is a bottom view thereof.

The dashed broken lines in the figures show portions of the main body of push switch that form no part of the claimed design.

(56) **References Cited**

**U.S. PATENT DOCUMENTS**

D387,453 S \* 12/1997 Protzek ..... D26/39  
D493,907 S \* 8/2004 Benensohn ..... D26/89  
D650,760 S \* 12/2011 Hussell ..... D13/180  
D658,603 S \* 5/2012 Egawa ..... D13/180  
D689,451 S \* 9/2013 Shimonishi ..... D13/180  
D724,462 S \* 3/2015 Bould ..... D10/106.2

**1 Claim, 5 Drawing Sheets**

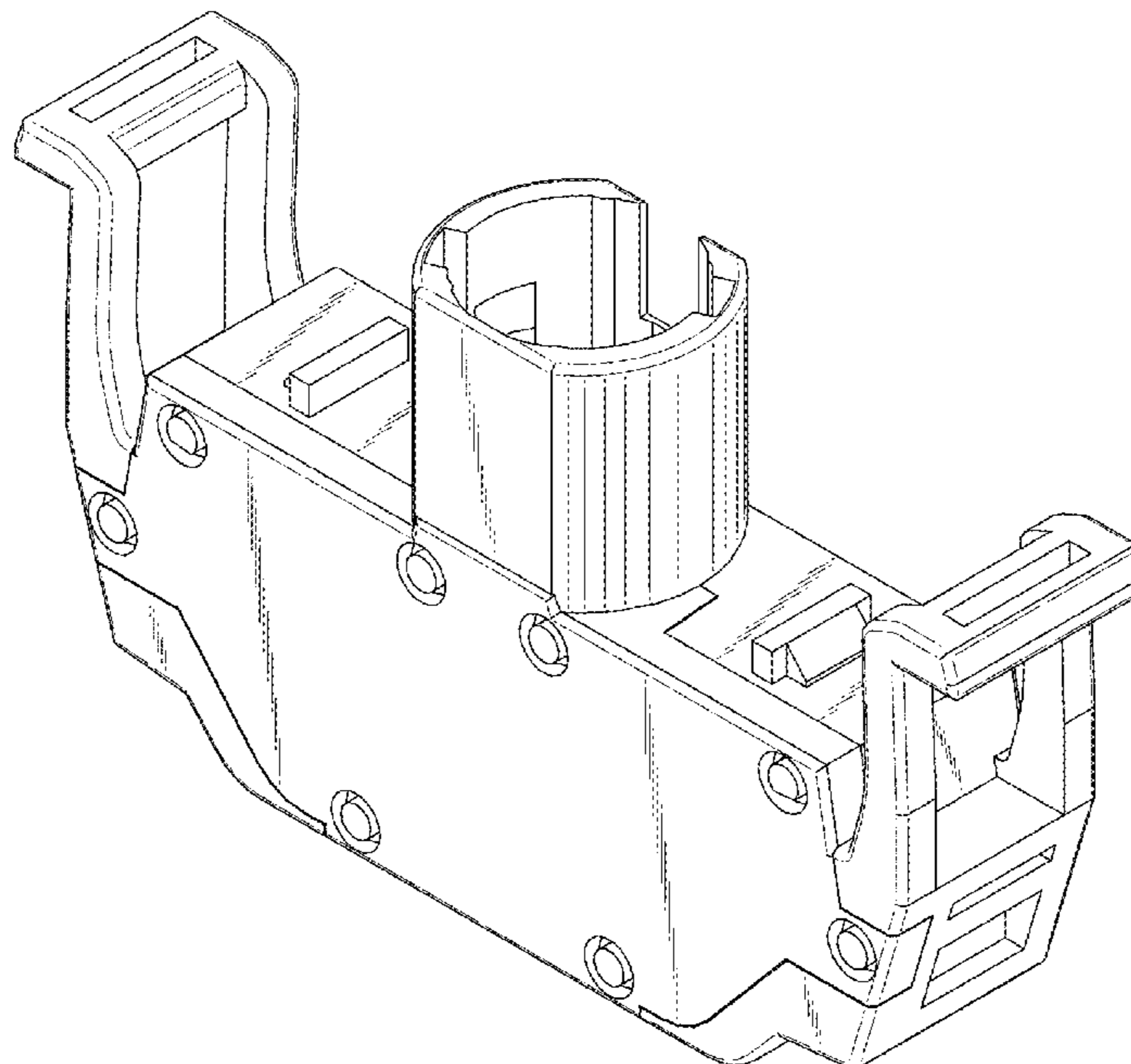

Fig. 1

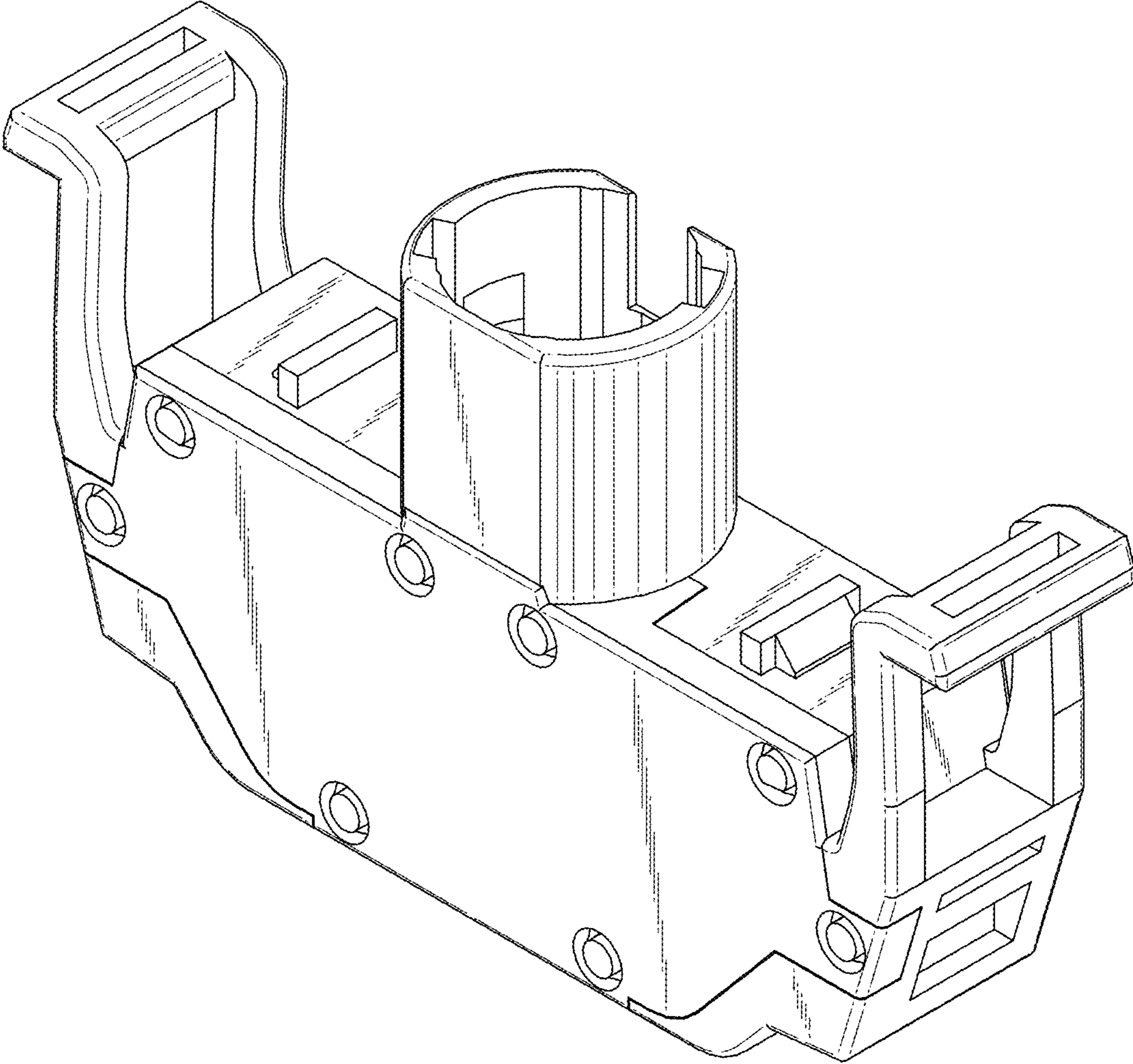

Fig. 2

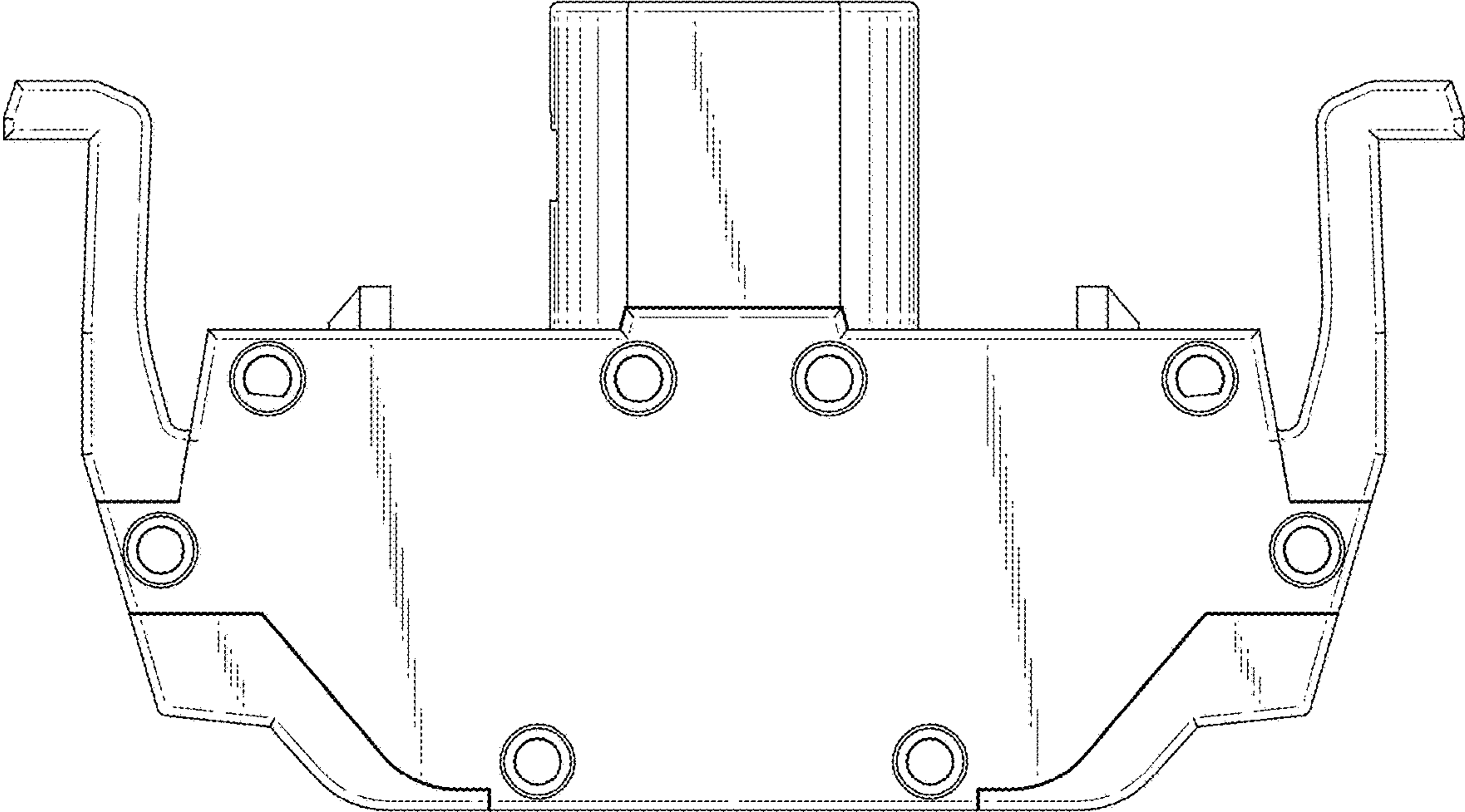

Fig. 3

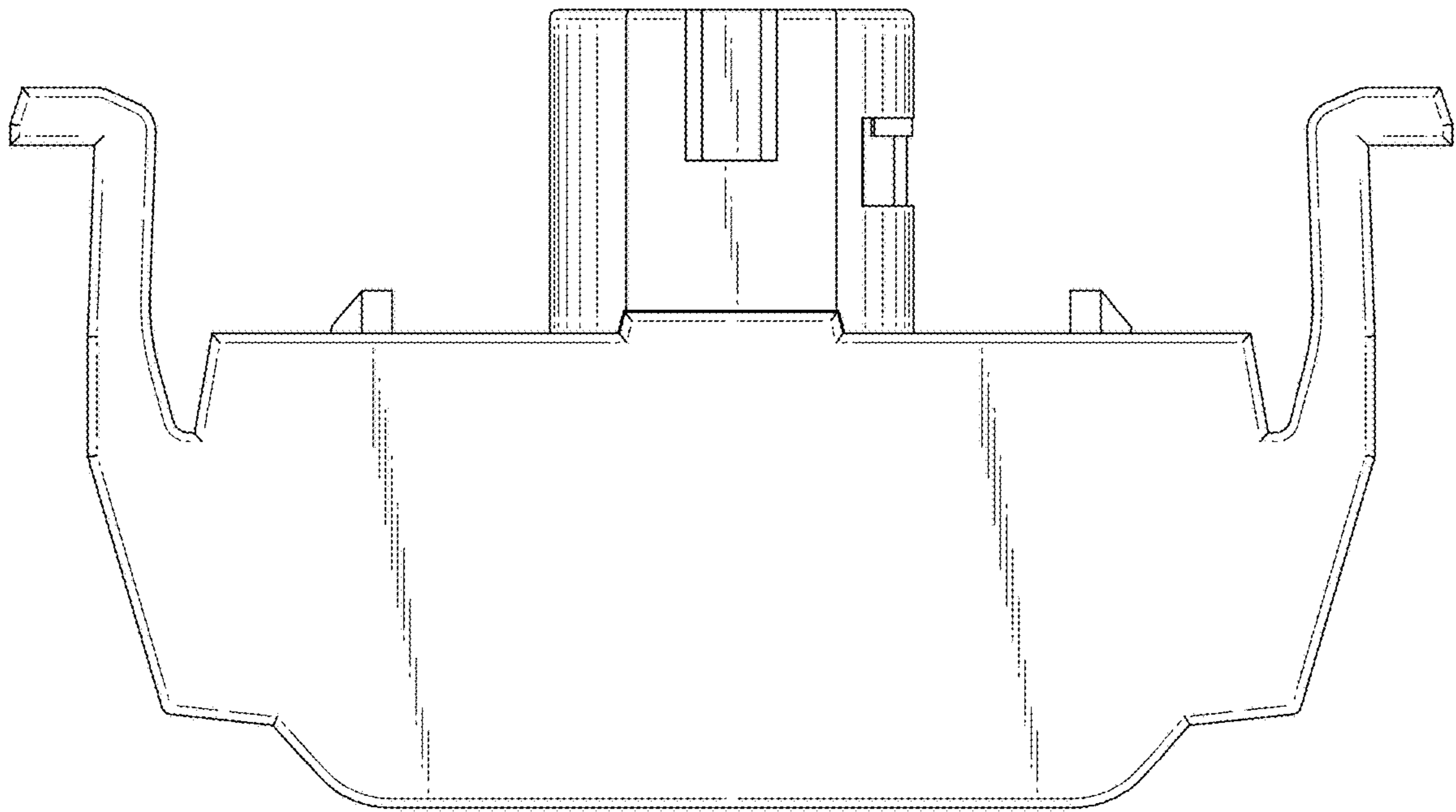

Fig. 4

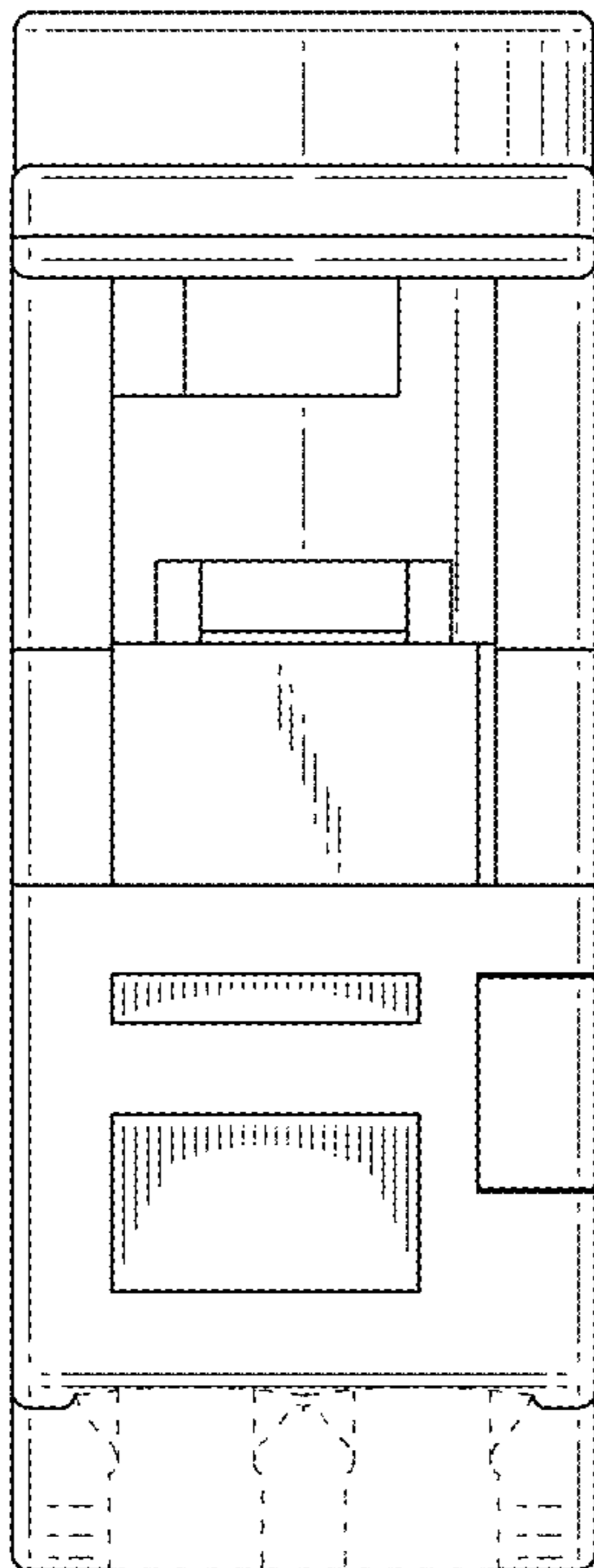

Fig. 5

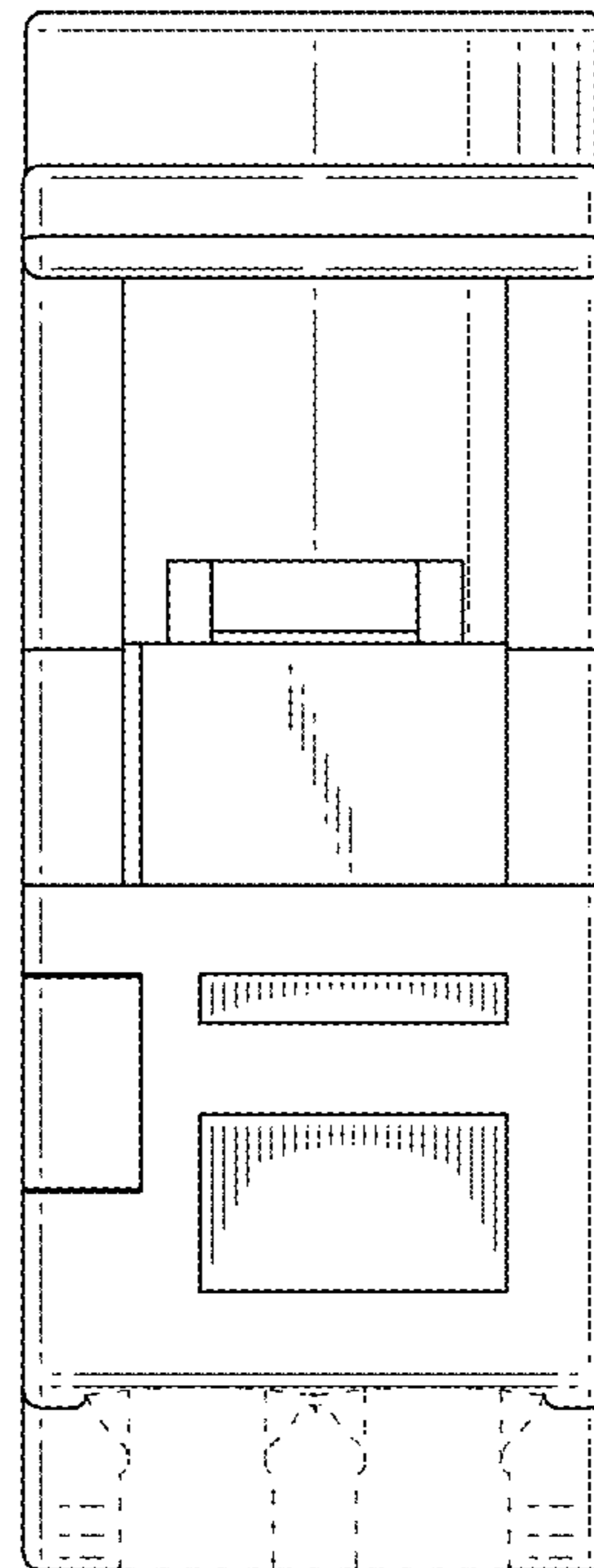

Fig. 6

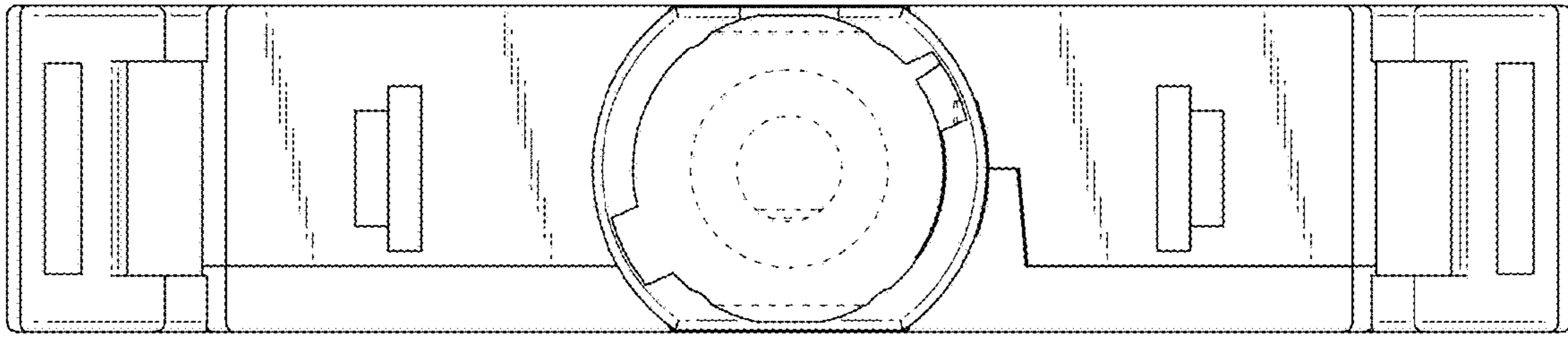

Fig. 7

