



US00D808896S

(12) **United States Design Patent**
Tsionidis et al.

(10) **Patent No.:** **US D808,896 S**
(45) **Date of Patent:** **** Jan. 30, 2018**

(54) **VALVE REGULATOR**

(71) Applicant: **The Goodyear Tire & Rubber Company, Akron, OH (US)**

(72) Inventors: **Christos Tsionidis, Stuttgart (DE); Frank Herrigel, Mühlacker (DE); Marcus Boertje, Port Washington, NY (US)**

(73) Assignee: **The Goodyear Tire & Rubber Company, Akron, OH (US)**

(**) Term: **15 Years**

(21) Appl. No.: **29/541,701**

(22) Filed: **Oct. 7, 2015**

(51) **LOC (11) Cl.** **12-15**

(52) **U.S. Cl.**
USPC **D12/606**

(58) **Field of Classification Search**
USPC D12/606, 604; 137/224, 226, 12, 223; 152/450, 415, 430; D23/233, 235, 248, D23/249; D10/86; 73/732
CPC B60C 29/06; B60C 29/005; B60C 29/04; B60C 29/066; B60C 23/00; B60C 23/0494; B60C 29/068; B60C 23/0496; B60C 29/00; F16K 15/20
See application file for complete search history.

(56) **References Cited**

U.S. PATENT DOCUMENTS

1,901,637 A * 3/1933 Eger B60C 29/04
152/430
1,918,689 A * 7/1933 Crowley F16L 37/40
137/223

D268,924 S * 5/1983 Winther D12/606
D304,817 S * 11/1989 Earley D12/606
D624,010 S * 9/2010 Tournier D12/606
2007/0137304 A1 * 6/2007 Rutherford B60C 23/0496
73/732
2016/0046157 A1 * 2/2016 Lin B60C 23/004
152/450
2017/0144492 A1 * 5/2017 Lamgaday B60C 23/004
2017/0144493 A1 * 5/2017 Lamgaday B60C 23/004

* cited by examiner

Primary Examiner — Cynthia Ramirez

Assistant Examiner — Gino Colan

(74) *Attorney, Agent, or Firm* — Robert N. Lipsik

(57) **CLAIM**

The ornamental design for a valve regulator, as shown and described.

DESCRIPTION

FIG. 1 is a top left front perspective view of a valve regulator showing our new design;
FIG. 2 top bottom right rear perspective view thereof;
FIG. 3 is a left side elevational view thereof;
FIG. 4 is a right side elevational view thereof;
FIG. 5 is a top plan view thereof;
FIG. 6 is a bottom plan view thereof;
FIG. 7 is a front elevational view thereof; and,
FIG. 8 is a rear elevational view thereof.
In the drawings, the broken lines showing of the inlet and outlet tubes depict environmental subject matter only and form no part of the claimed design.

1 Claim, 3 Drawing Sheets

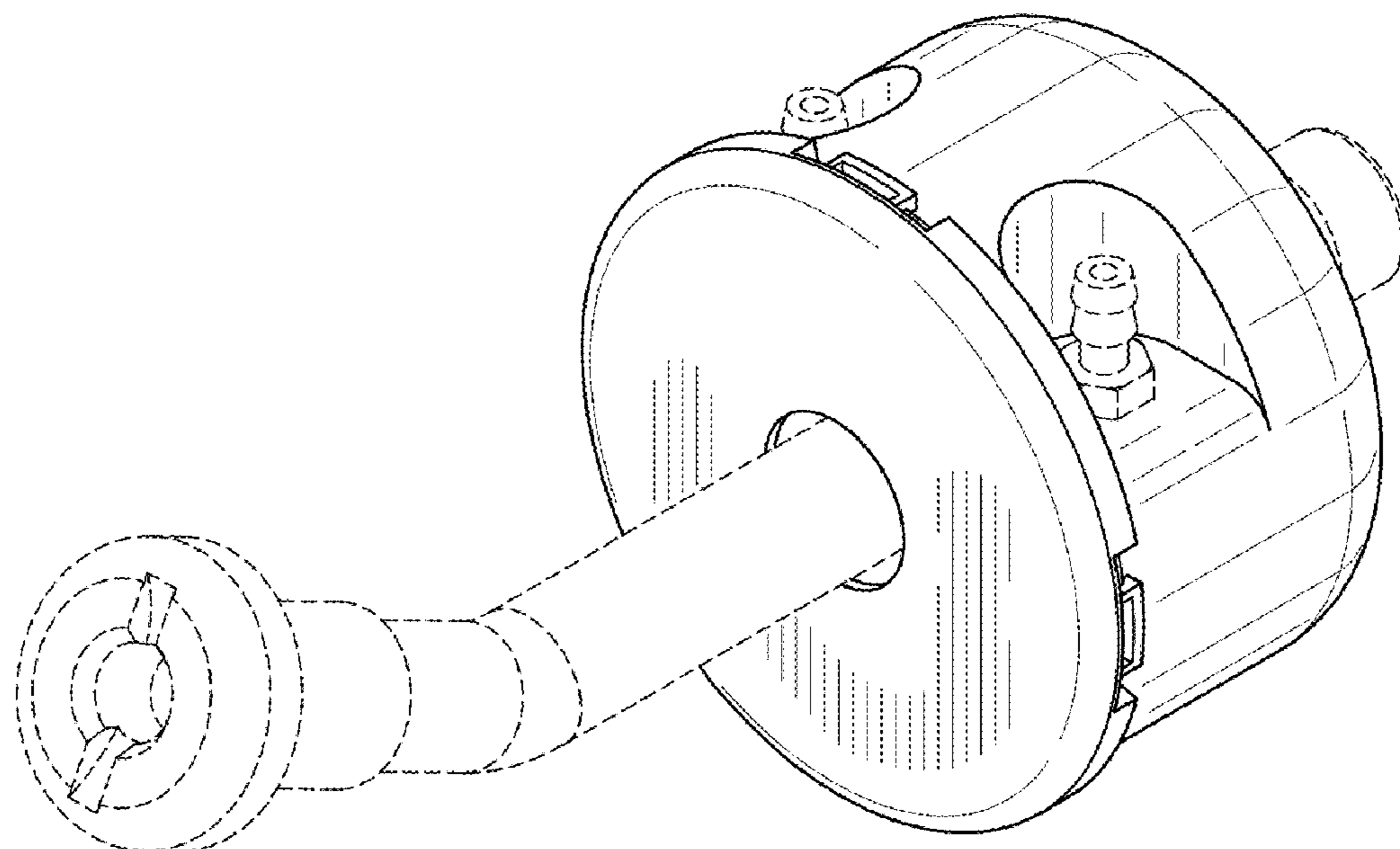

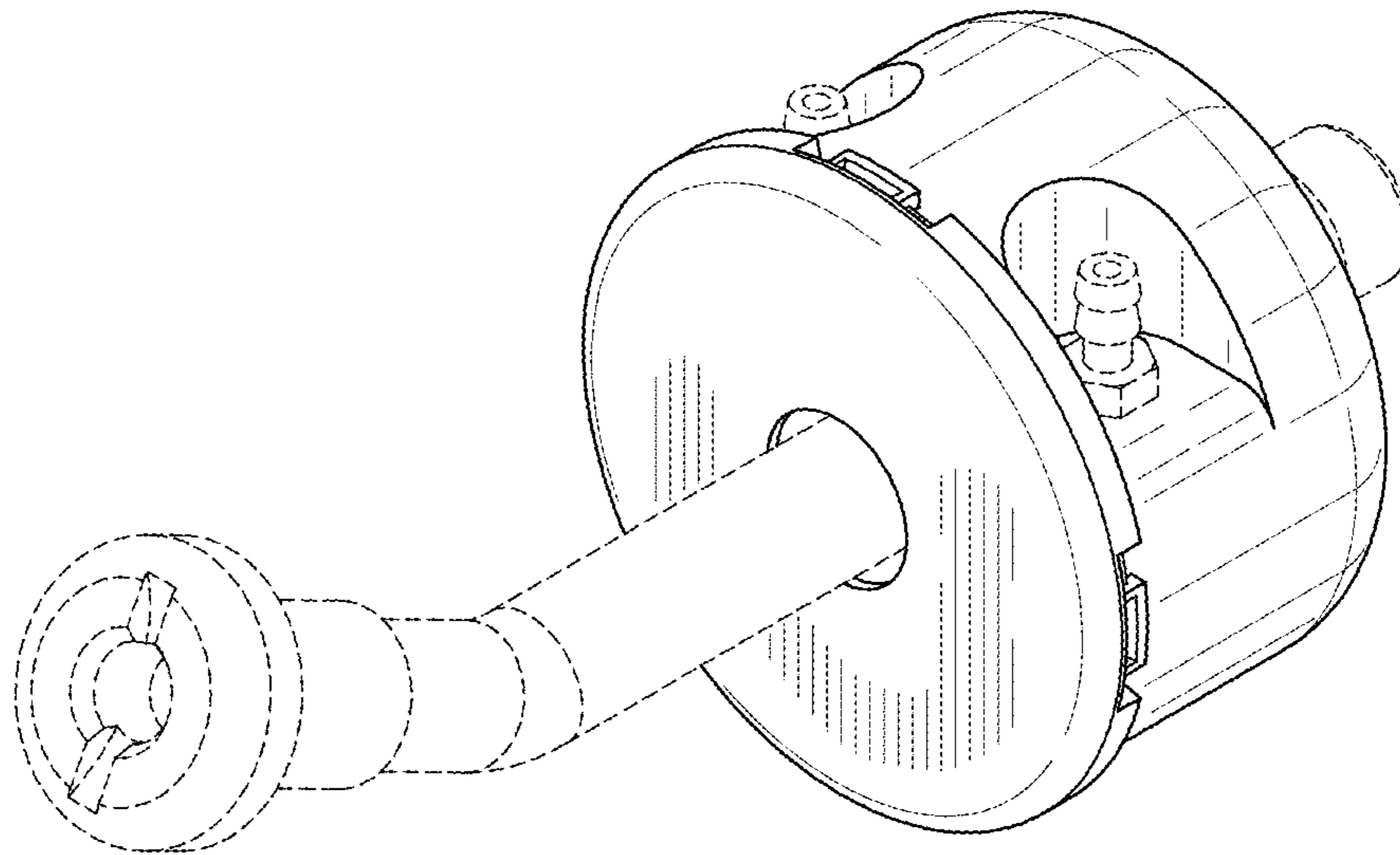

FIG. 1

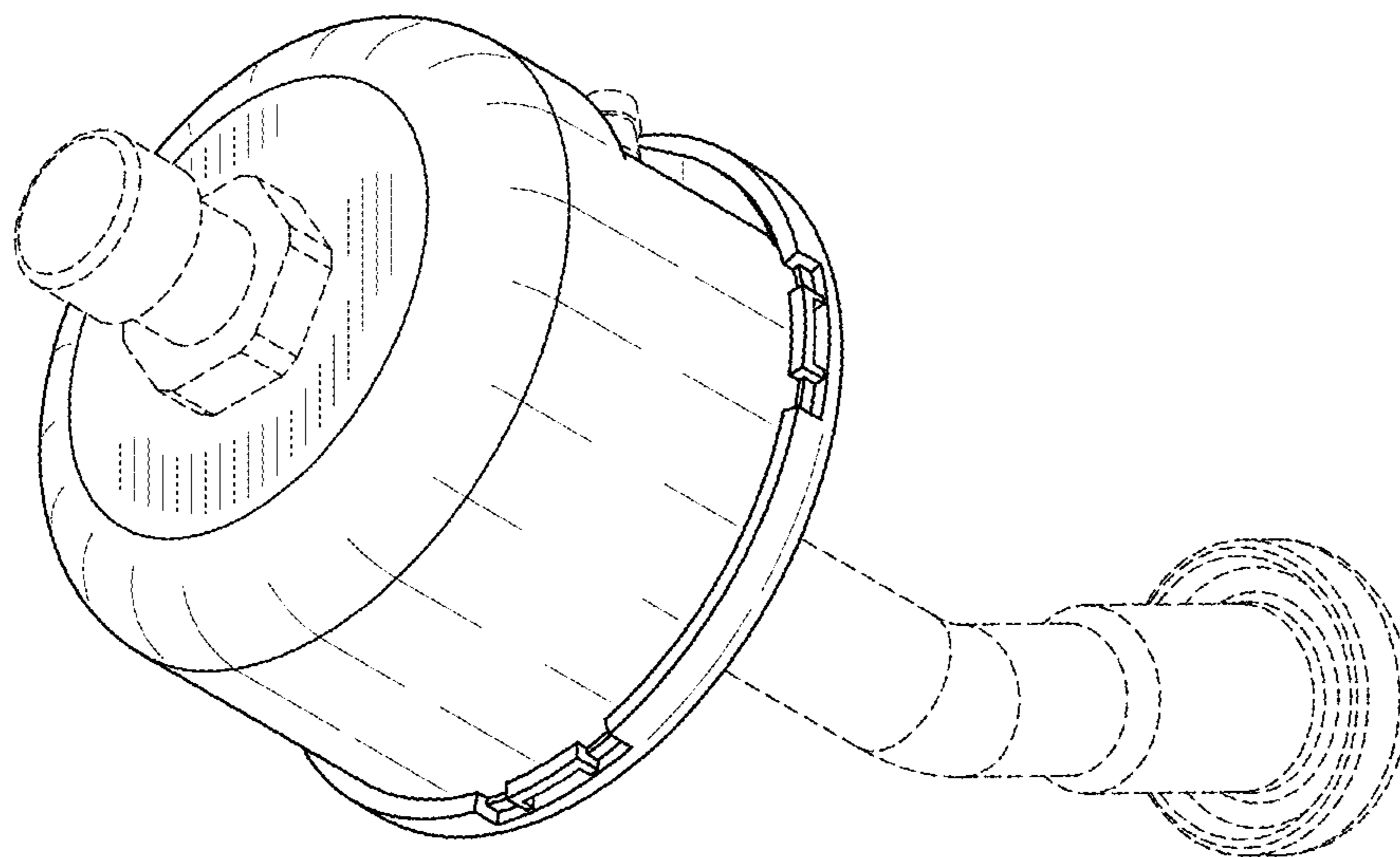

FIG. 2

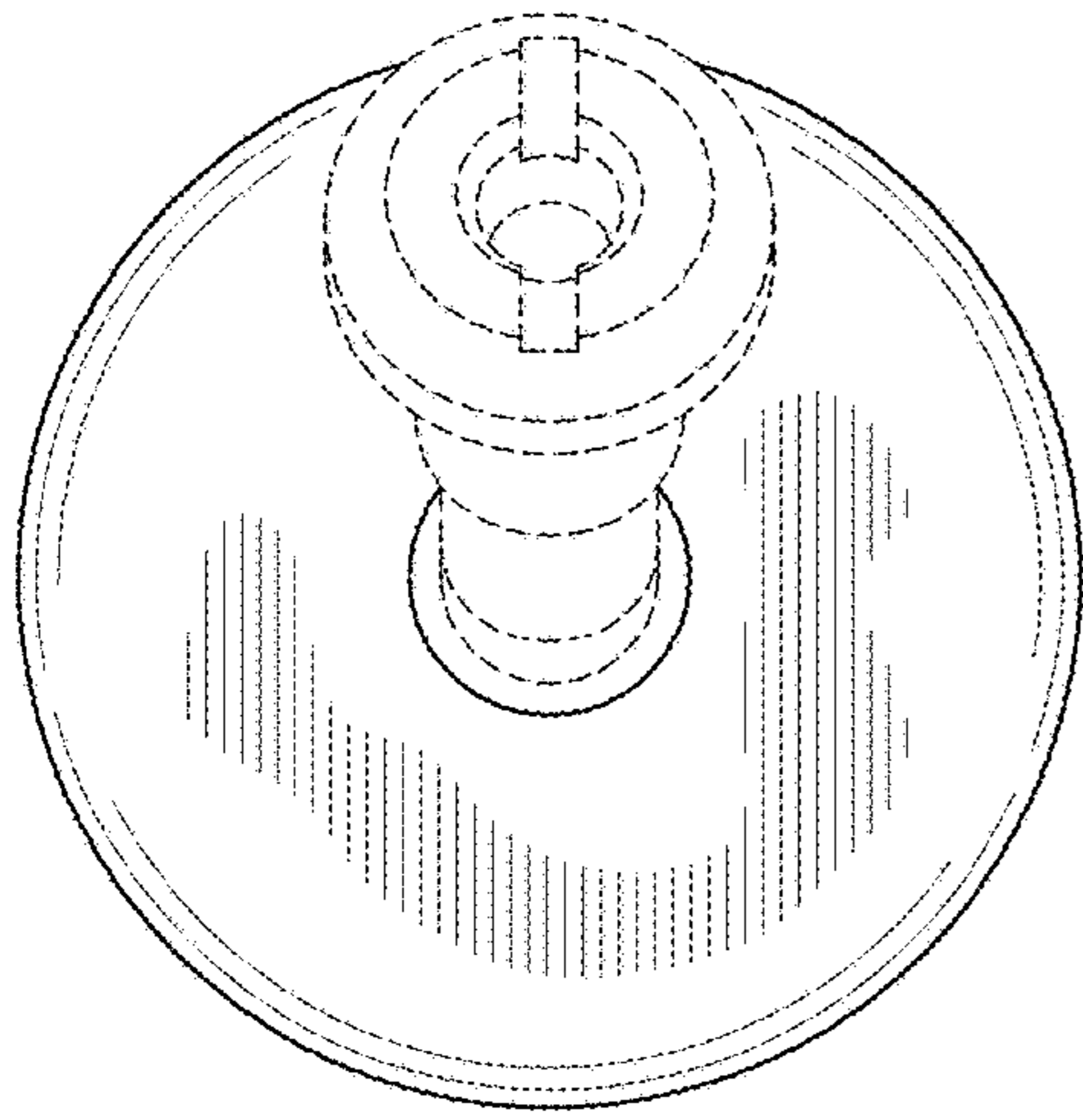

FIG. 3

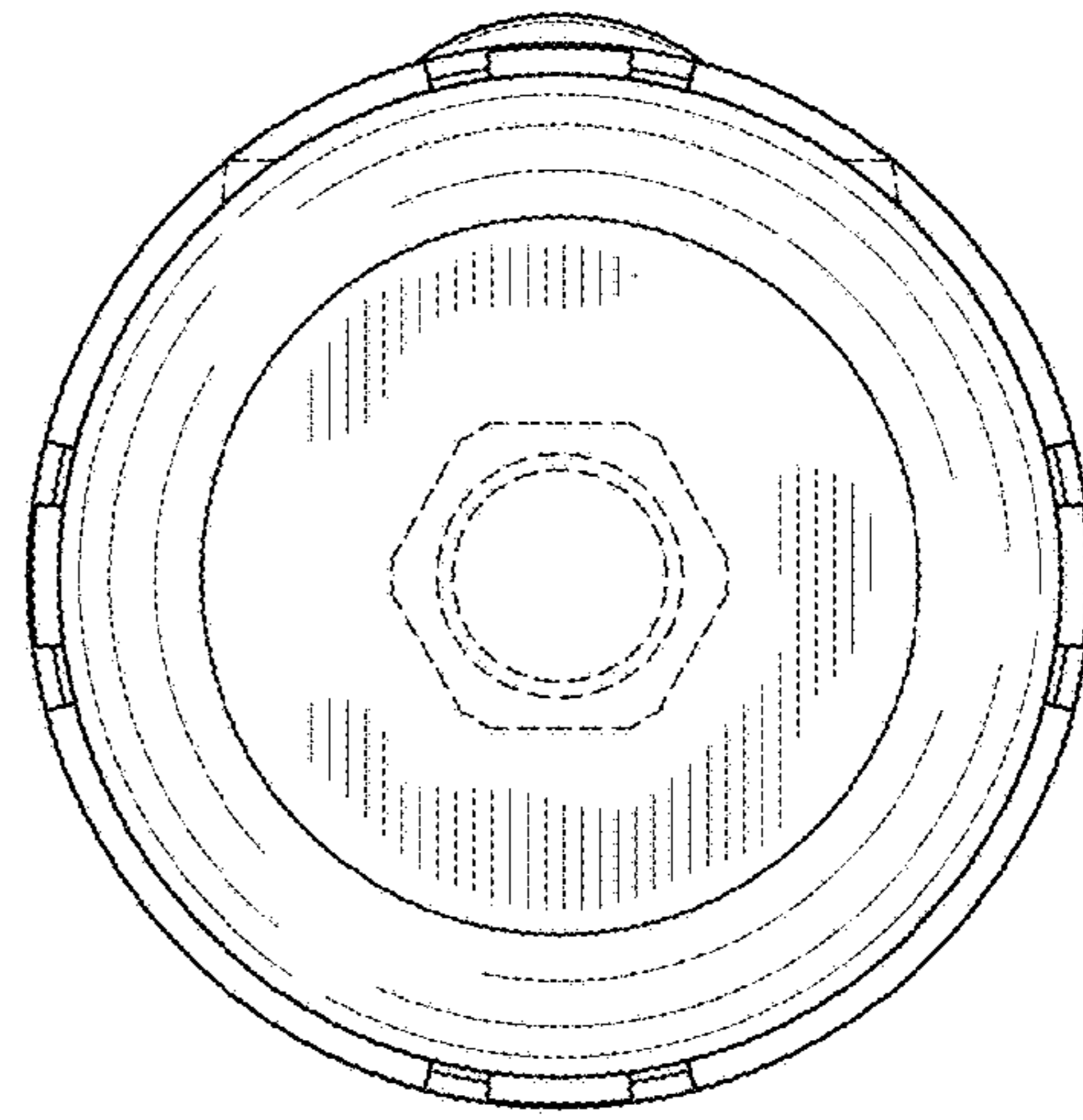

FIG. 4

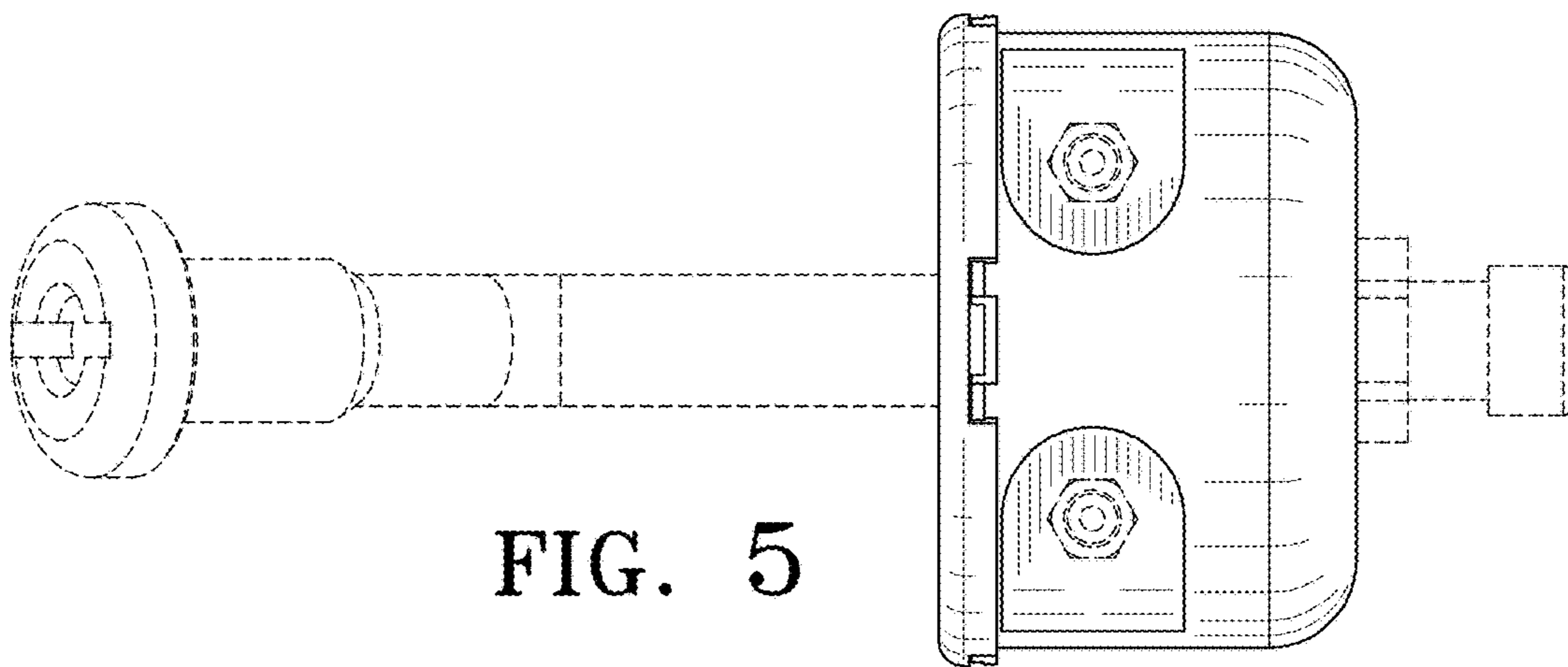

FIG. 5

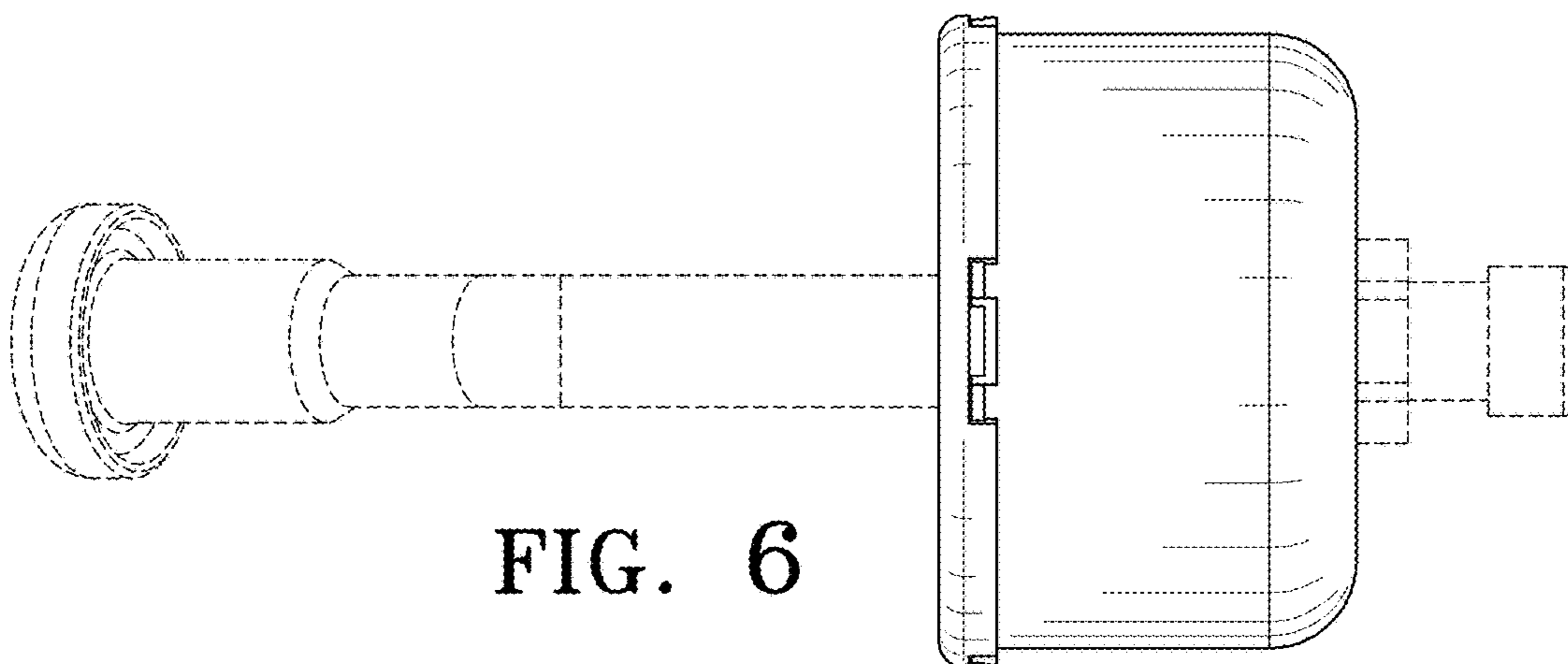

FIG. 6

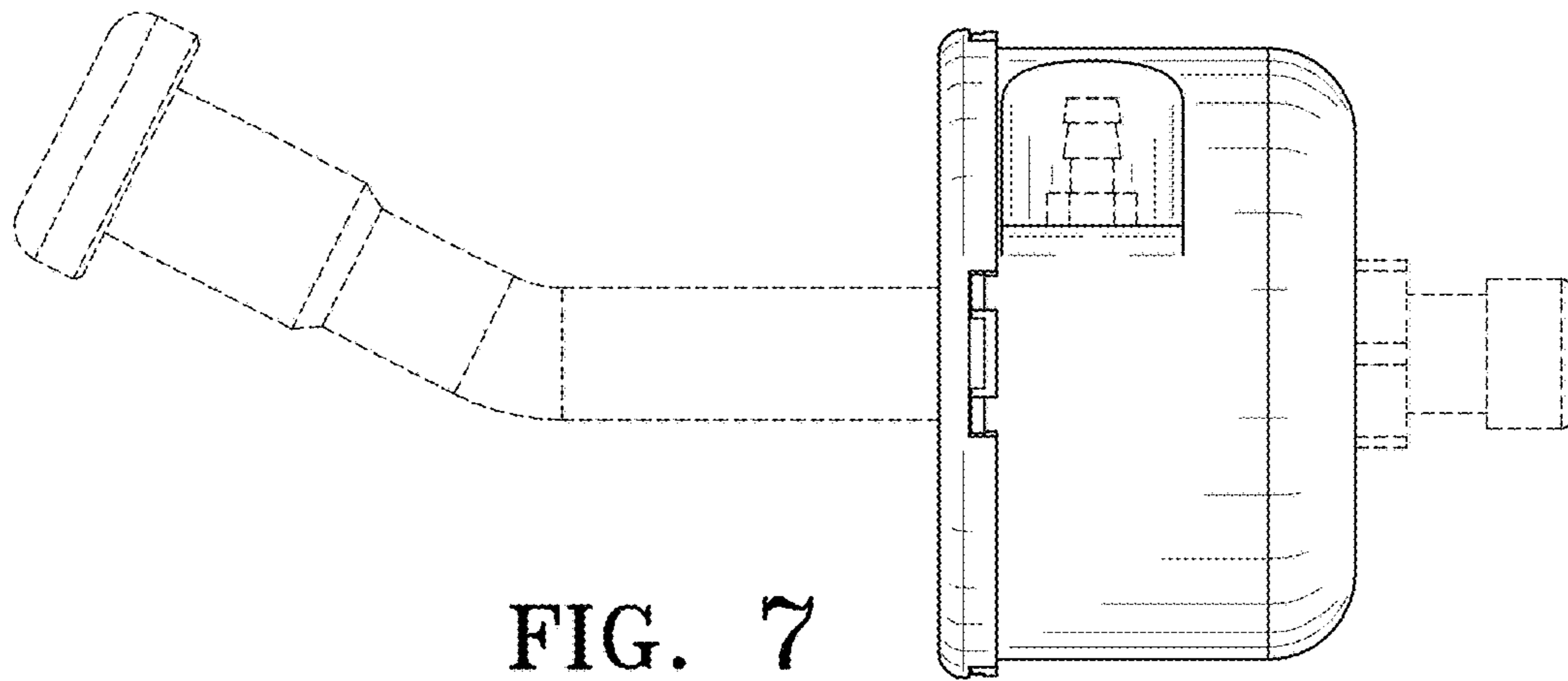

FIG. 7

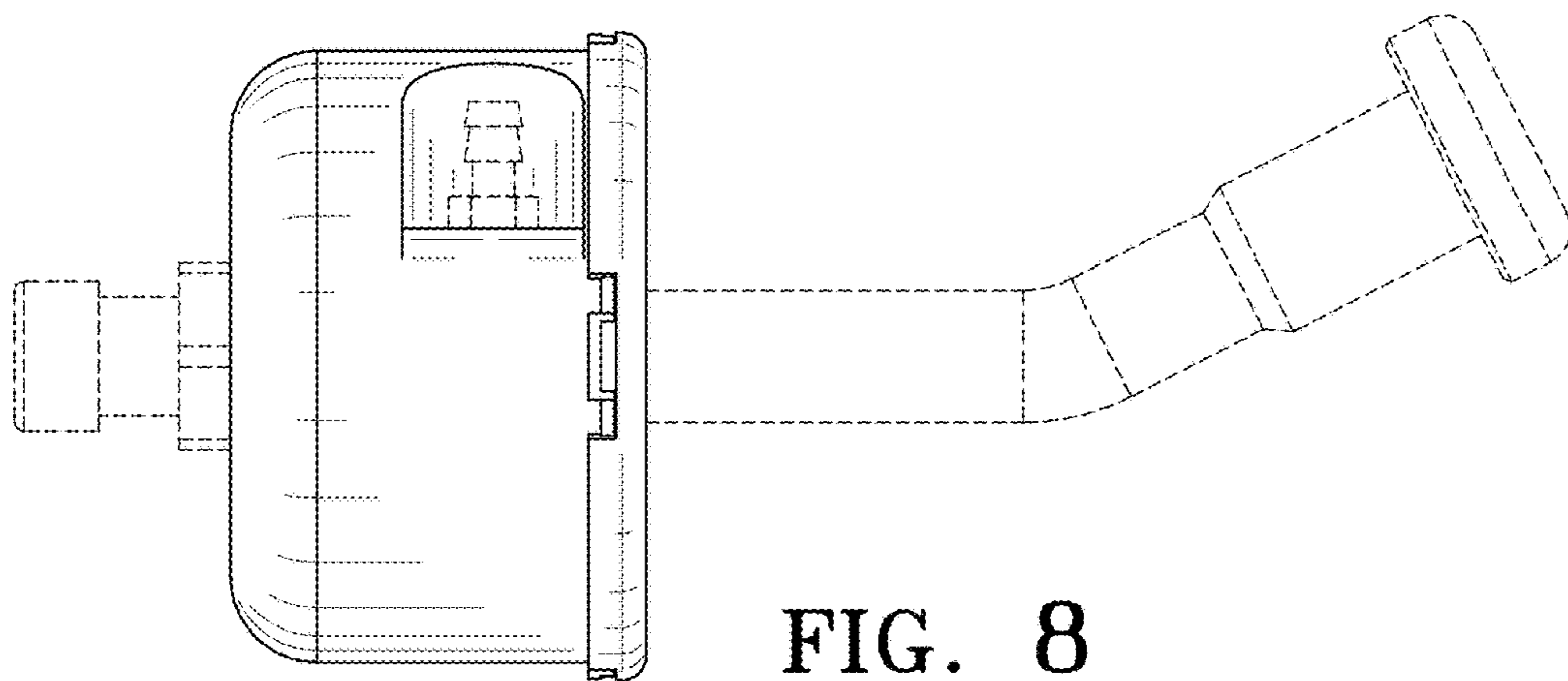

FIG. 8