



US00D808445S

(12) **United States Design Patent**
Burke et al.

(10) **Patent No.:** **US D808,445 S**
(45) **Date of Patent:** **** Jan. 23, 2018**

(54) **REFRIGERATOR SHELF**

(71) Applicant: **Whirlpool Corporation**, Benton Harbor, MI (US)

(72) Inventors: **Julia B. Burke**, Chicago, IL (US);
Daniel Chow, St. Joseph, MI (US);
Todd Tunzi, St. Joseph, MI (US)

(73) Assignee: **Whirlpool Corporation**, Benton Harbor, MI (US)

(**) Term: **14 Years**

(21) Appl. No.: **29/520,674**

(22) Filed: **Mar. 17, 2015**

(51) **LOC (11) Cl.** **15-07**

(52) **U.S. Cl.**
USPC **D15/89**

(58) **Field of Classification Search**
USPC D15/79-91

(Continued)

(56) **References Cited**

U.S. PATENT DOCUMENTS

5,735,589 A 4/1998 Herrmann et al.
D516,100 S * 2/2006 Vardon D15/89
(Continued)

FOREIGN PATENT DOCUMENTS

CN 101611281 A 12/2009
CN 201779952 U 3/2011
(Continued)

OTHER PUBLICATIONS

“Refrigerator Capacity & Organization: Making Room for More,”
GE Appliances, website, date unknown, <http://www.geappliances.com>.

ca/en/shopping-guides-and-design-ideas/shopping-guides/refrigerators/make-room-for-more-in-the-refrigerator.

(Continued)

Primary Examiner — Ian Simmons

Assistant Examiner — Khawaja Anwar

(74) *Attorney, Agent, or Firm* — Price Heneveld LLP

(57) **CLAIM**

The ornamental design for a refrigerator shelf, as shown and described.

DESCRIPTION

FIG. 1 is a front view of a refrigerator shelf according to our design shown in place within an unclaimed refrigerator, back, right side, left side, top and bottom views of the design showing no claimed portion of the design when in place within the unclaimed refrigerator;

FIG. 2 is a front-perspective view of the refrigerator shelf of FIG. 1 with portions of the unclaimed refrigerator removed;

FIG. 3 is a front view thereof;

FIG. 4 is a back view thereof;

FIG. 5 is a right side view thereof;

FIG. 6 is a left side view thereof;

FIG. 7 is a top view thereof; and,

FIG. 8 is a bottom view thereof.

Broken lines are environmental only and form no part of the claimed design.

The pairs of closely adjacent, spaced jagged broken lines in the drawings disclose indeterminate length and form no part of the claimed design.

Dash-dot lines adjacent un-shaded areas represent bounds of the claimed design and form no part of the claimed design themselves.

The diagonal shading indicates transparency.

The dash-dot depiction of a rectangular prism in FIGS. 2-8 that enclose the refrigerator shelf with portions of the unclaimed refrigerator, depicted in FIG. 1 removed is similarly unclaimed and represents a space within an interior of the refrigerator in which the shelf is present.

1 Claim, 8 Drawing Sheets

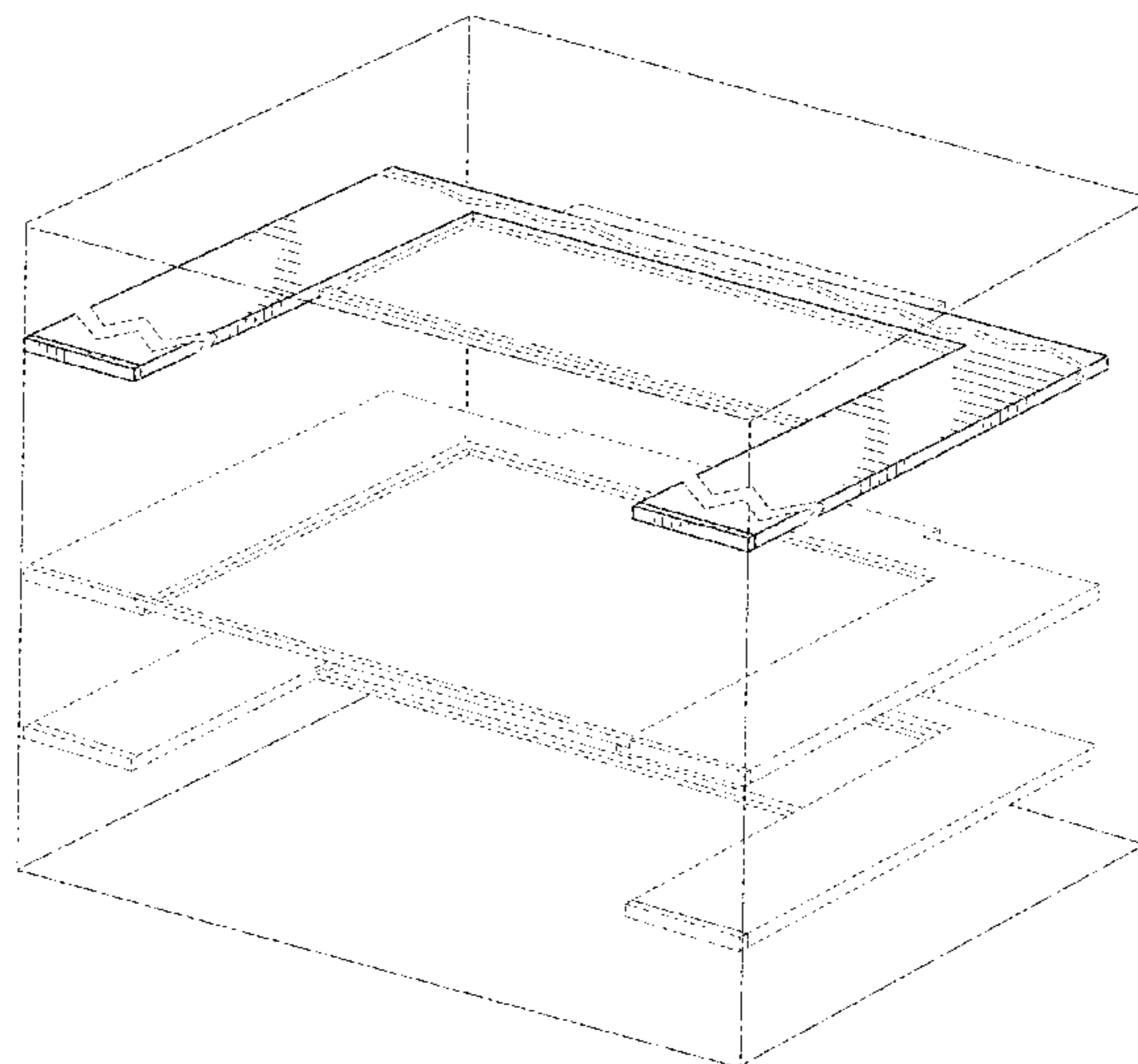

US D808,445 S

Page 2

(58) **Field of Classification Search**

CPC F25D 11/00; F25D 11/02; F25D 13/00;
F25D 19/00; F25D 21/00; F25D 23/00;
F25D 2321/1441; F25D 2325/021; F25D
2325/022; F25D 2325/023

See application file for complete search history.

D754,759 S *	4/2016	McConnell	D15/89
D756,551 S *	5/2016	Handt	D26/28
D761,884 S *	7/2016	Austin	D15/89
2003/0020387 A1	1/2003	Wing et al.	
2011/0115356 A1	5/2011	Nash et al.	
2012/0091084 A1	4/2012	Amaral et al.	
2013/0020922 A1	1/2013	Jang	

(56)

References Cited

U.S. PATENT DOCUMENTS

D516,102 S *	2/2006	Vardon	D15/89
D523,034 S *	6/2006	Vardon	D15/89
D525,633 S *	7/2006	Vardon	D15/89
D551,262 S *	9/2007	Becke	D15/89
7,878,344 B2	2/2011	Martin et al.	
D656,970 S *	4/2012	Merritt	D15/90
8,403,438 B2	3/2013	Park et al.	
D694,289 S *	11/2013	Hottmann	D15/89
D707,267 S *	6/2014	Choi	D15/89
D709,927 S *	7/2014	Park	D15/89
8,777,341 B2	7/2014	Amaral et al.	
D710,405 S *	8/2014	Seo	D15/89
D734,784 S *	7/2015	Kim	D15/89
D745,581 S *	12/2015	Jeon	D15/89
D747,369 S *	1/2016	McConnell	D15/89
D747,370 S *	1/2016	Kim	D15/89
D747,371 S *	1/2016	Lee	D15/89
D747,373 S *	1/2016	Lee	D15/89

FOREIGN PATENT DOCUMENTS

CN	102395849 A	3/2012
CN	102494496 A	6/2012
CN	102135363 B	12/2012
CN	102829604 A	12/2012
CN	102889744 A	1/2013
EP	577939 A1	1/1994
JP	2002090054 A	3/2002
KR	10431346 B1	5/2004
KR	10756887 B1	9/2007
WO	2008015180 A2	2/2008
WO	2009155679 A2	12/2009

OTHER PUBLICATIONS

“GE Profile Side by Side Refrigerators”, Abt, website, date unknown, http://www.abt.com/ge/GE_Profile_SidebySide.

* cited by examiner

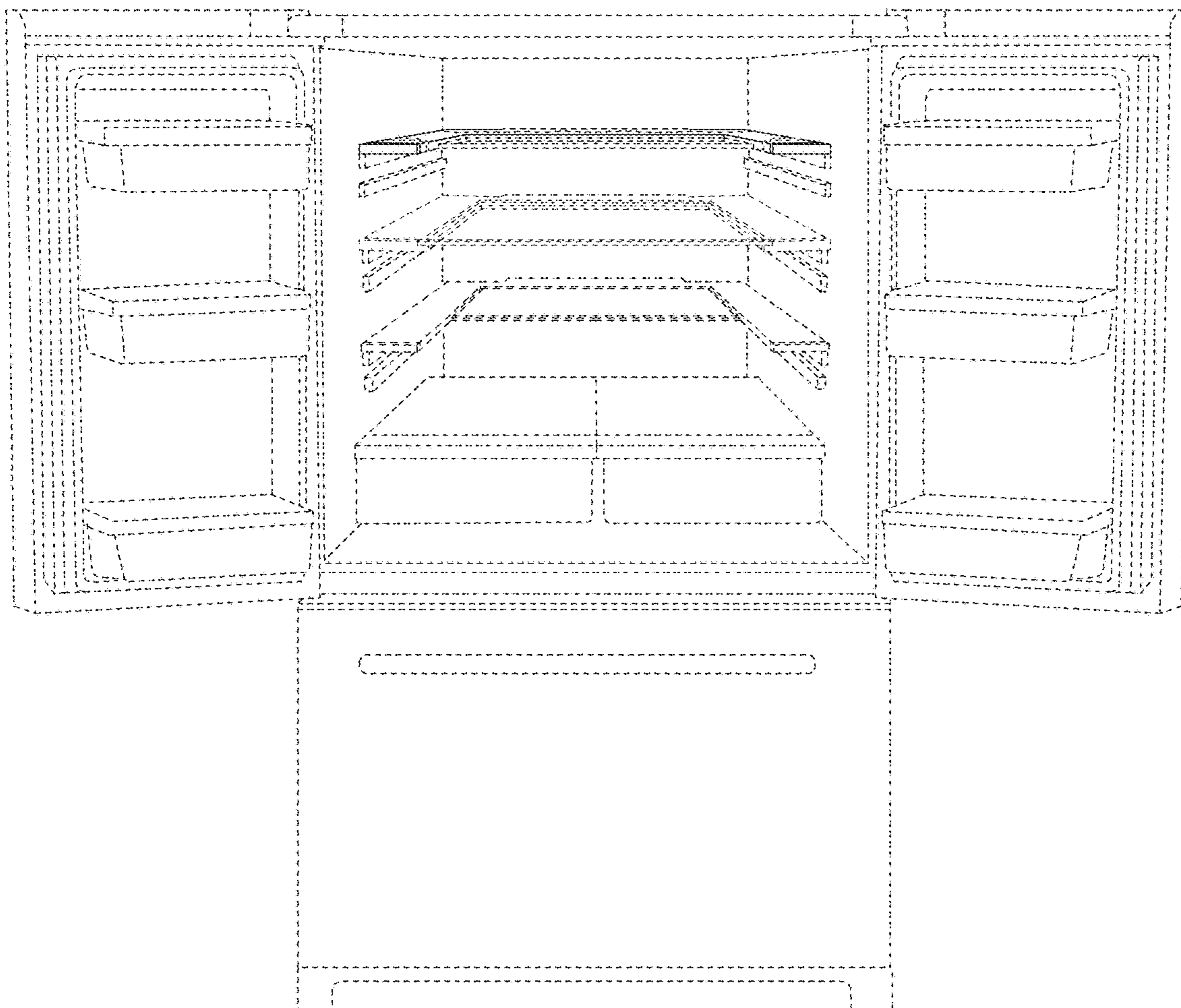

FIG. 1

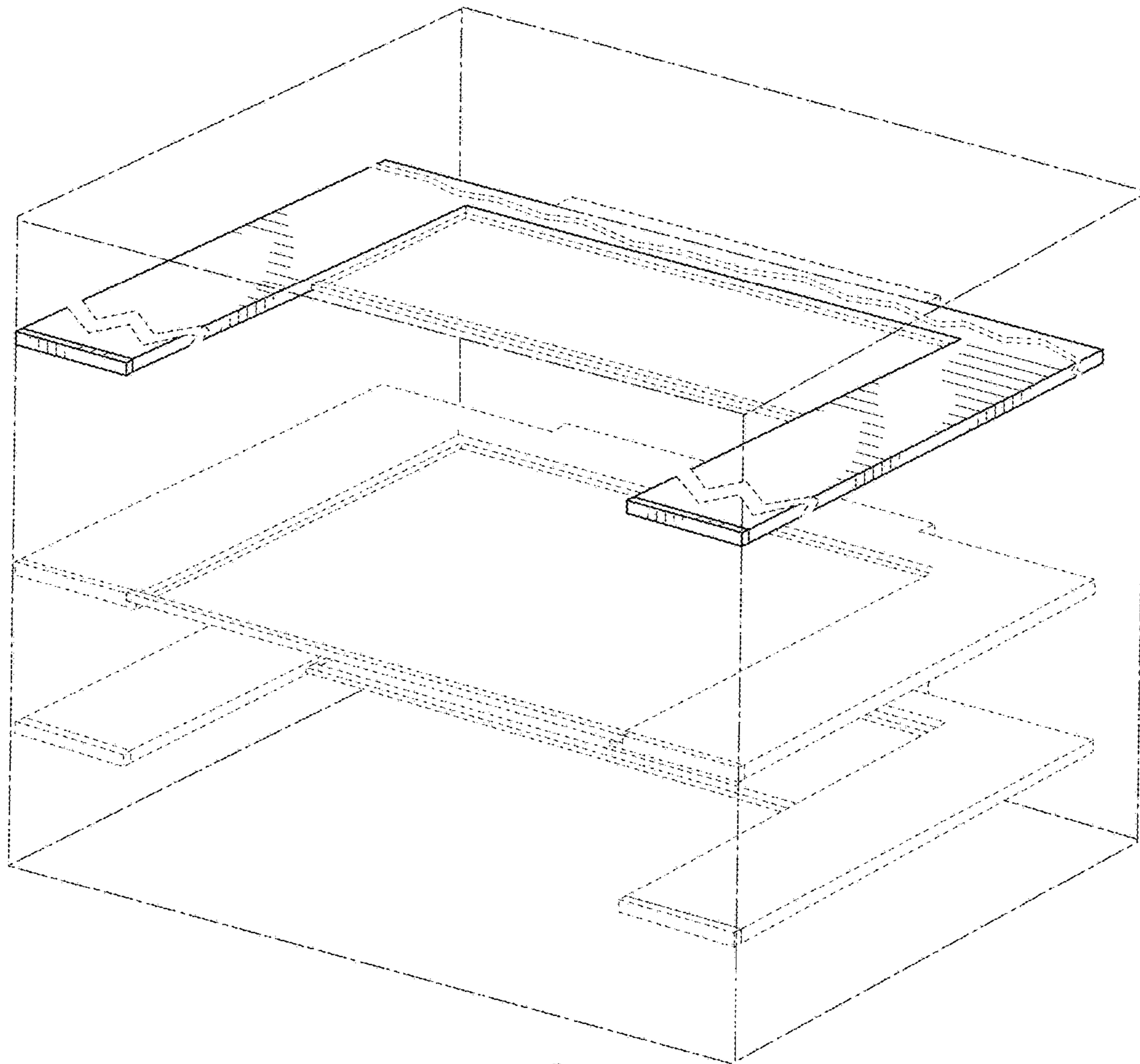

FIG. 2

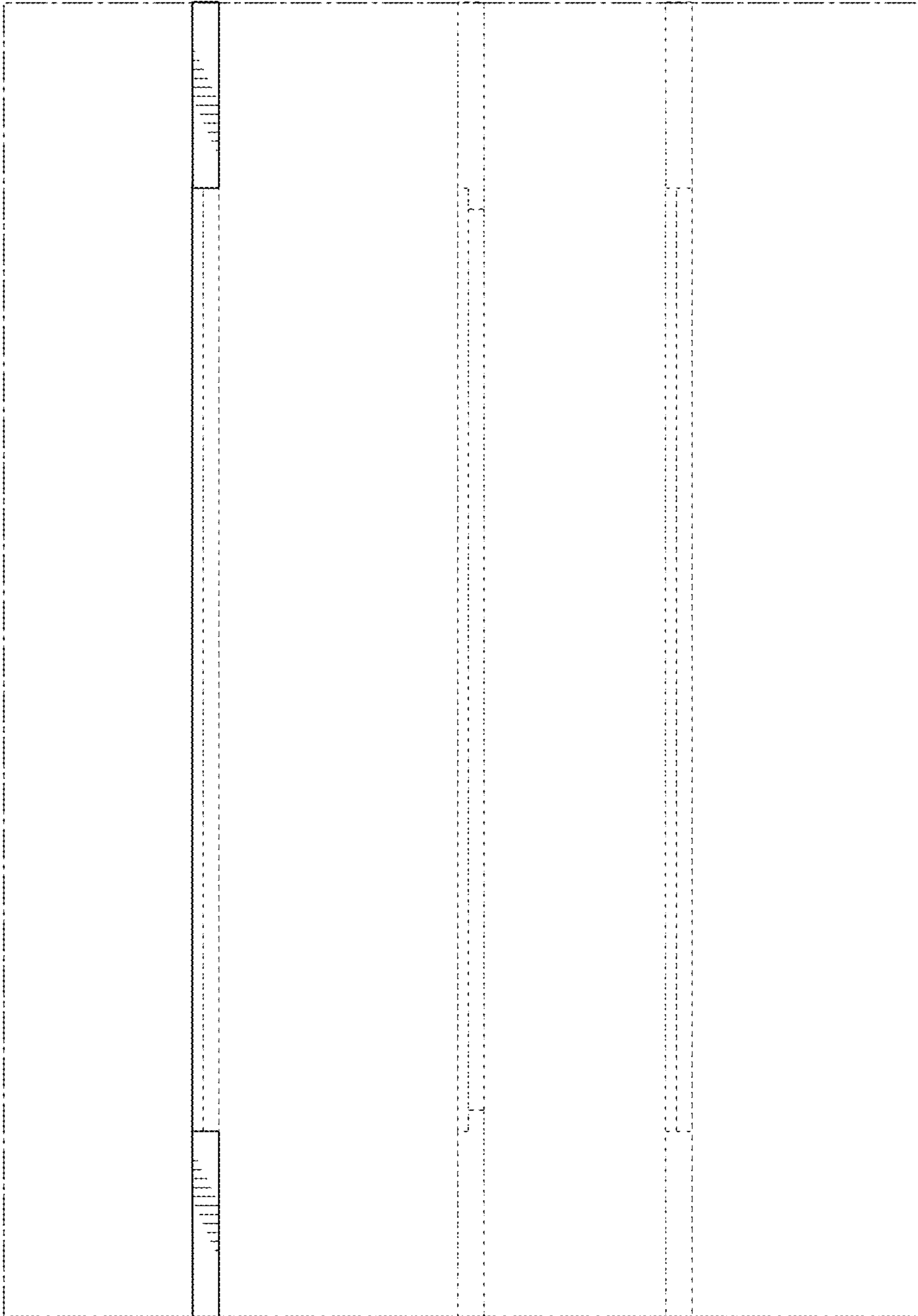

FIG. 3

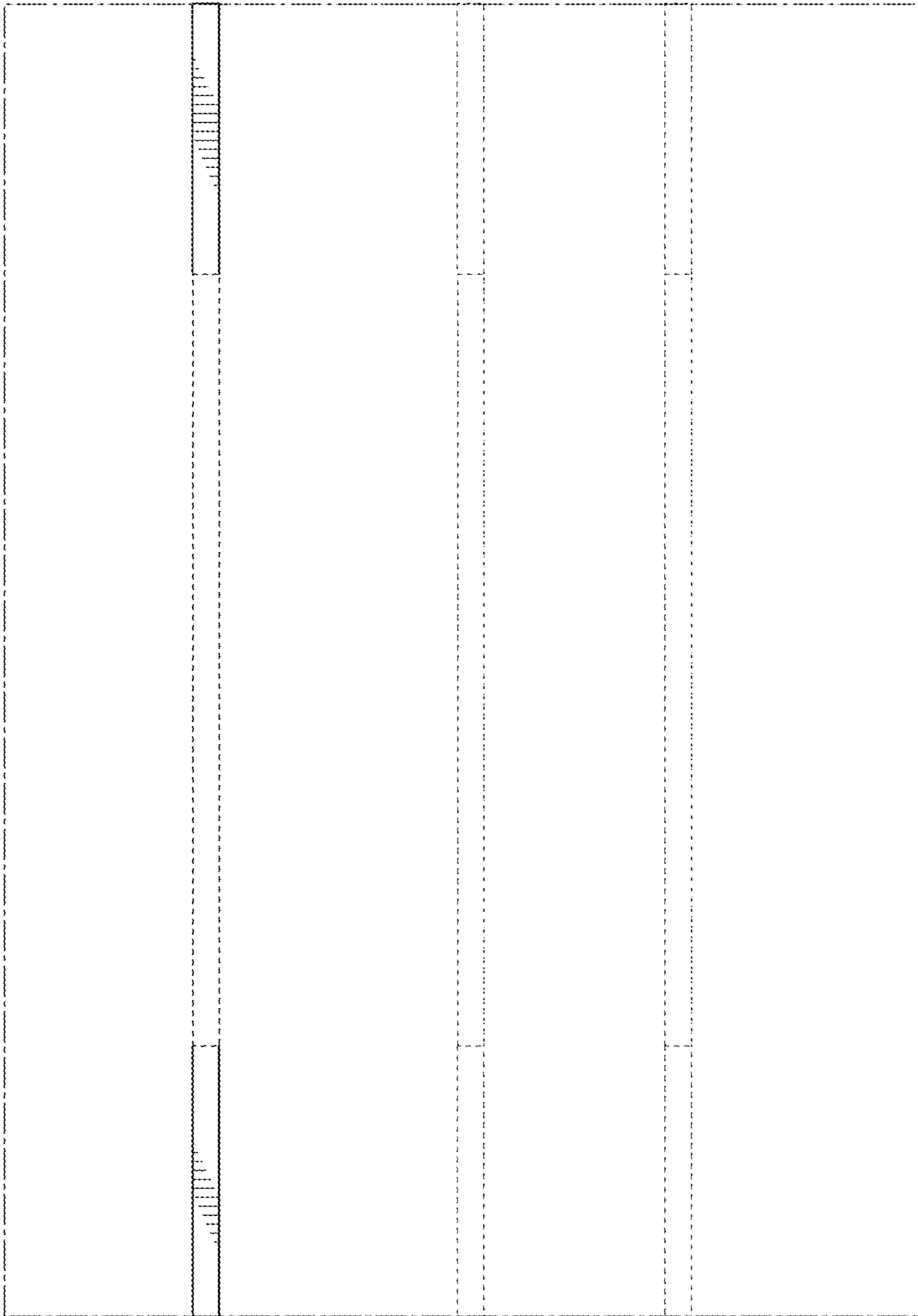

FIG. 4

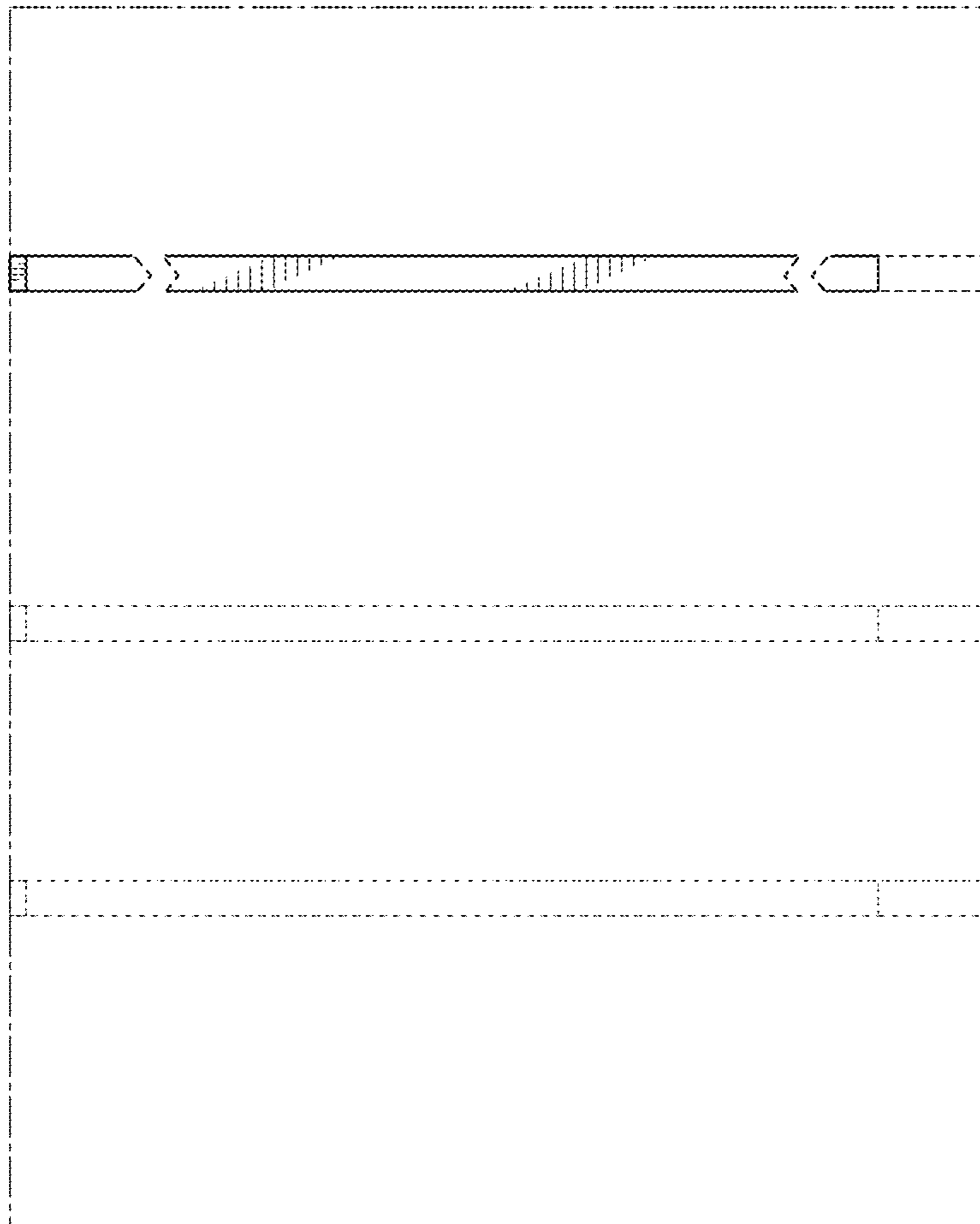

FIG. 5

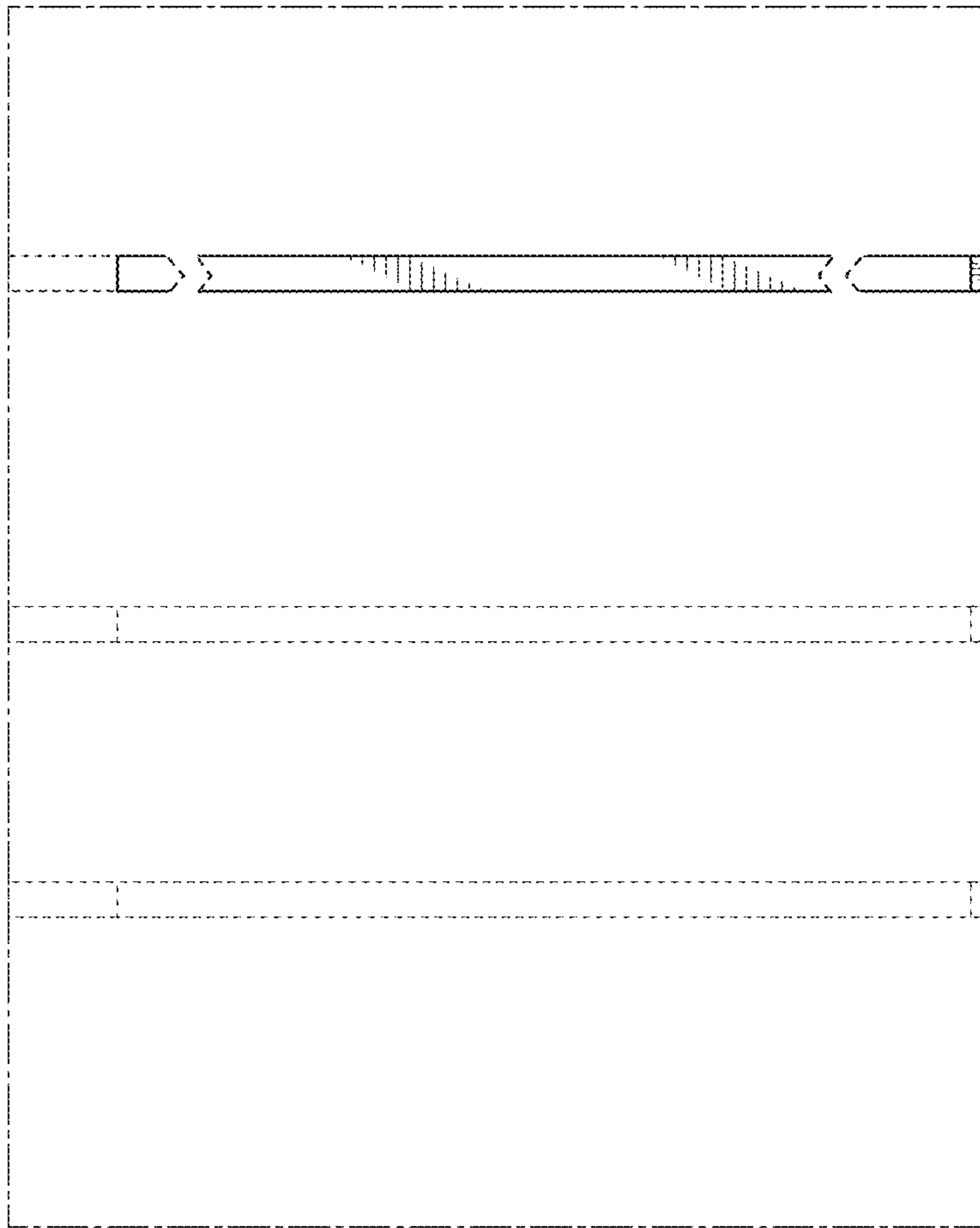

FIG. 6

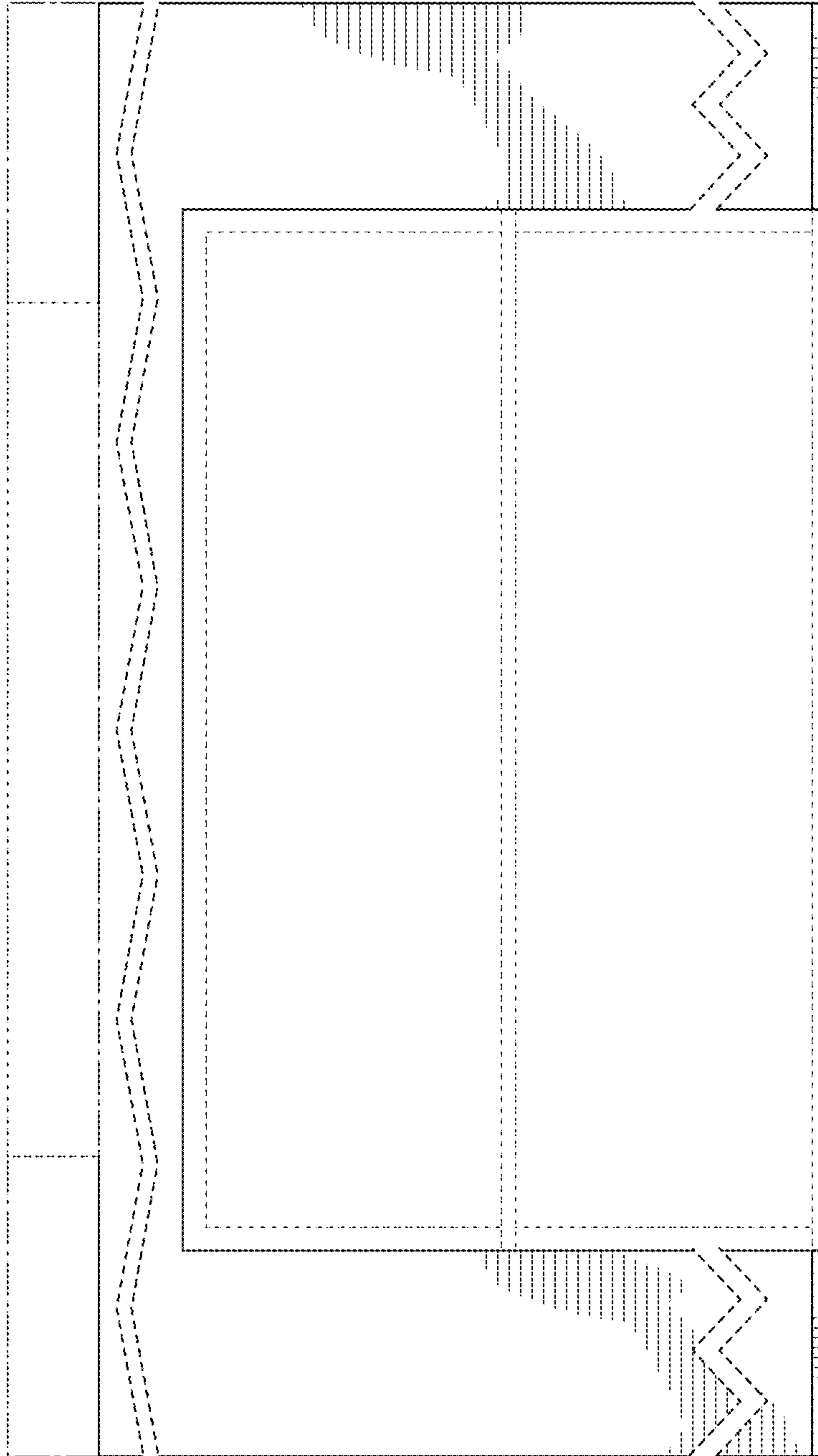

FIG. 7

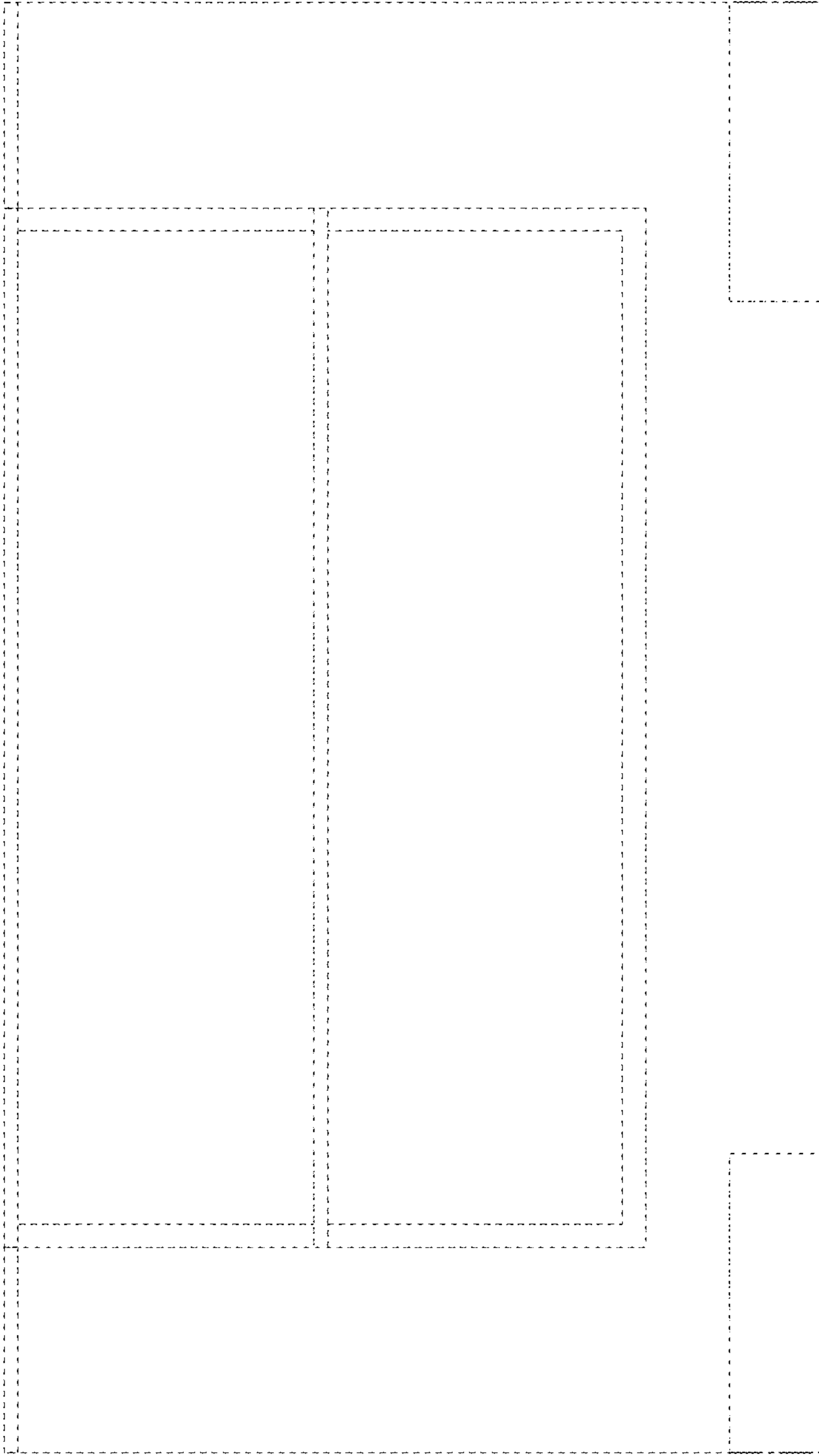

FIG. 8