



US00D808257S

(12) **United States Design Patent**
Ito et al.

(10) **Patent No.:** **US D808,257 S**
(45) **Date of Patent:** **** Jan. 23, 2018**

(54) **PACKAGING BOX**

- (71) Applicant: **Nikon Corporation**, Tokyo (JP)
- (72) Inventors: **Hideki Ito**, Yokohama (JP); **Yuri Manabe**, Tokyo (JP); **Chiori Saito**, Tokyo (JP); **Suzuka Fujita**, Yokohama (JP); **Toshimitsu Nojima**, Tokyo (JP); **Seina Takahashi**, Tokyo (JP); **Maki Shimizu**, Yokohama (JP); **Yuki Nomura**, Tokyo (JP); **Keiji Gohara**, Yokohama (JP)
- (73) Assignee: **Nikon Corporation**, Tokyo (JP)

(**) Term: **15 Years**

(21) Appl. No.: **29/548,398**

(22) Filed: **Dec. 14, 2015**

Related U.S. Application Data

(62) Division of application No. 29/511,450, filed on Dec. 10, 2014, now Pat. No. Des. 756,214.

(51) **LOC (11) Cl.** **09-03**

(52) **U.S. Cl.**
USPC **D9/414; D9/432**

(58) **Field of Classification Search**
USPC D3/201, 203.1, 203.5, 203.6; D7/601, D7/602, 609; D9/414-416, 418-423, D9/425, 426, 430-436, 444, 455-457, D9/499
CPC B65D 2571/00185
See application file for complete search history.

(56) **References Cited**

U.S. PATENT DOCUMENTS

- D71,513 S 11/1926 Austin
- 3,204,853 A 9/1965 Hoyne et al.
- D257,718 S 12/1980 Dutcher
- D261,358 S 10/1981 Faller

(Continued)

OTHER PUBLICATIONS

Dinverno Design. Nikon D5200 Packaging Redesign. 2015 [earliest online date], [site visited Aug. 8, 2017]. Available from Internet, URL: <http://dinvernodesign.com/portfolio/nikon-d5200-packaging-redesign/>.*

(Continued)

Primary Examiner — Robert M Spear
Assistant Examiner — Darcey E Heflin
(74) *Attorney, Agent, or Firm* — Wolf, Greenfield & Sacks, P.C.

(57) **CLAIM**

The ornamental design for a packaging box, as shown and described.

DESCRIPTION

FIG. 1 is a front view of a first embodiment of a packaging box showing our new design;
FIG. 2 is a rear view thereof;
FIG. 3 is a top plan view thereof;
FIG. 4 is a bottom plan view thereof;
FIG. 5 is a right side view thereof;
FIG. 6 is a left side view thereof;
FIG. 7 is a front view of a second embodiment of a packaging box showing our new design;
FIG. 8 is a rear view thereof;
FIG. 9 is a top plan view thereof;
FIG. 10 is a bottom plan view thereof;
FIG. 11 is a right side view thereof; and,
FIG. 12 is a left side view thereof.

The features shown in broken lines in the drawings depict environmental subject matter only and form no part of the claimed design. The dot-dash lines denote the boundary of the claim and form no part of the claimed design. The gray shading in the drawings indicates a contrast in appearance.

1 Claim, 12 Drawing Sheets

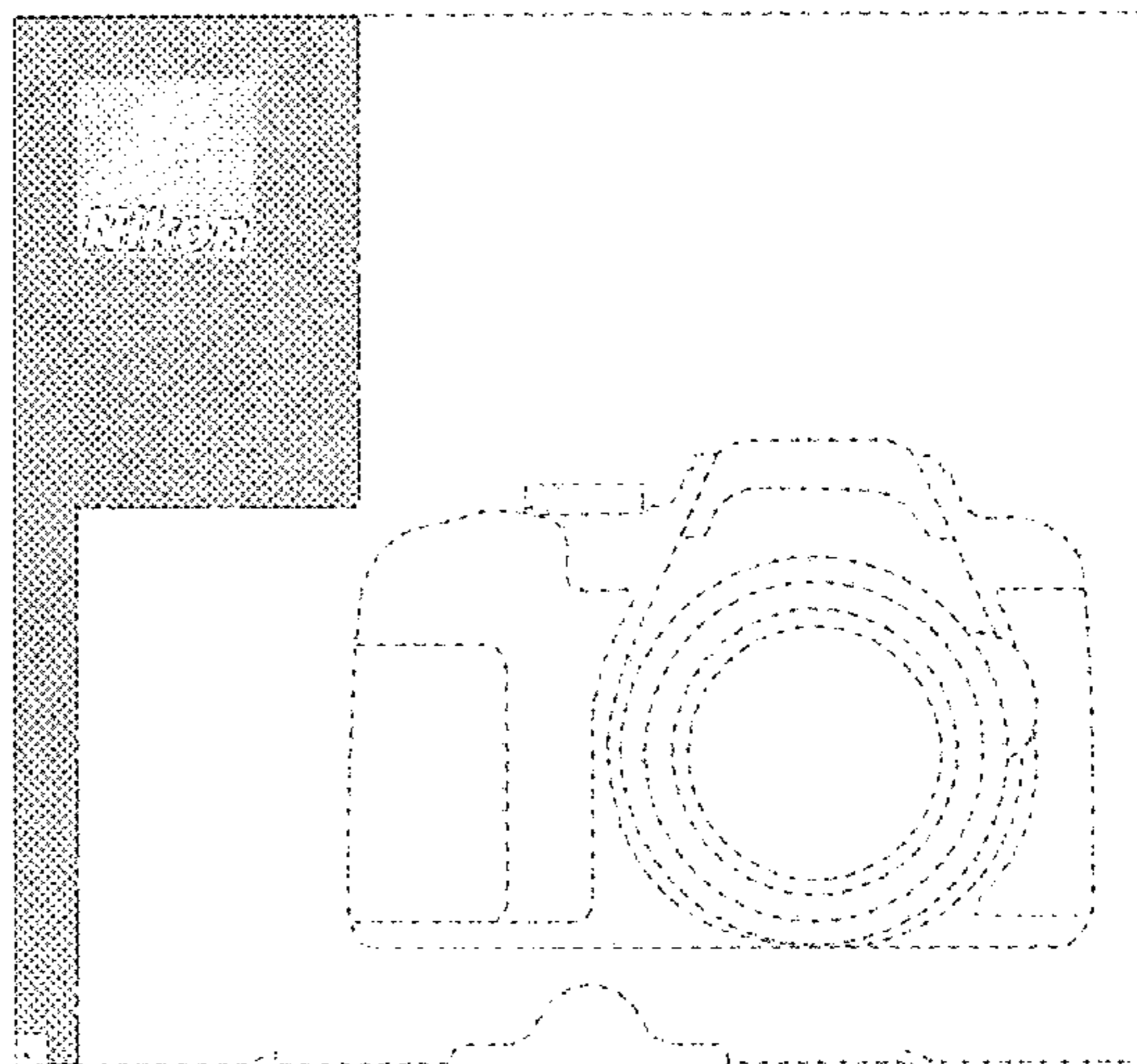
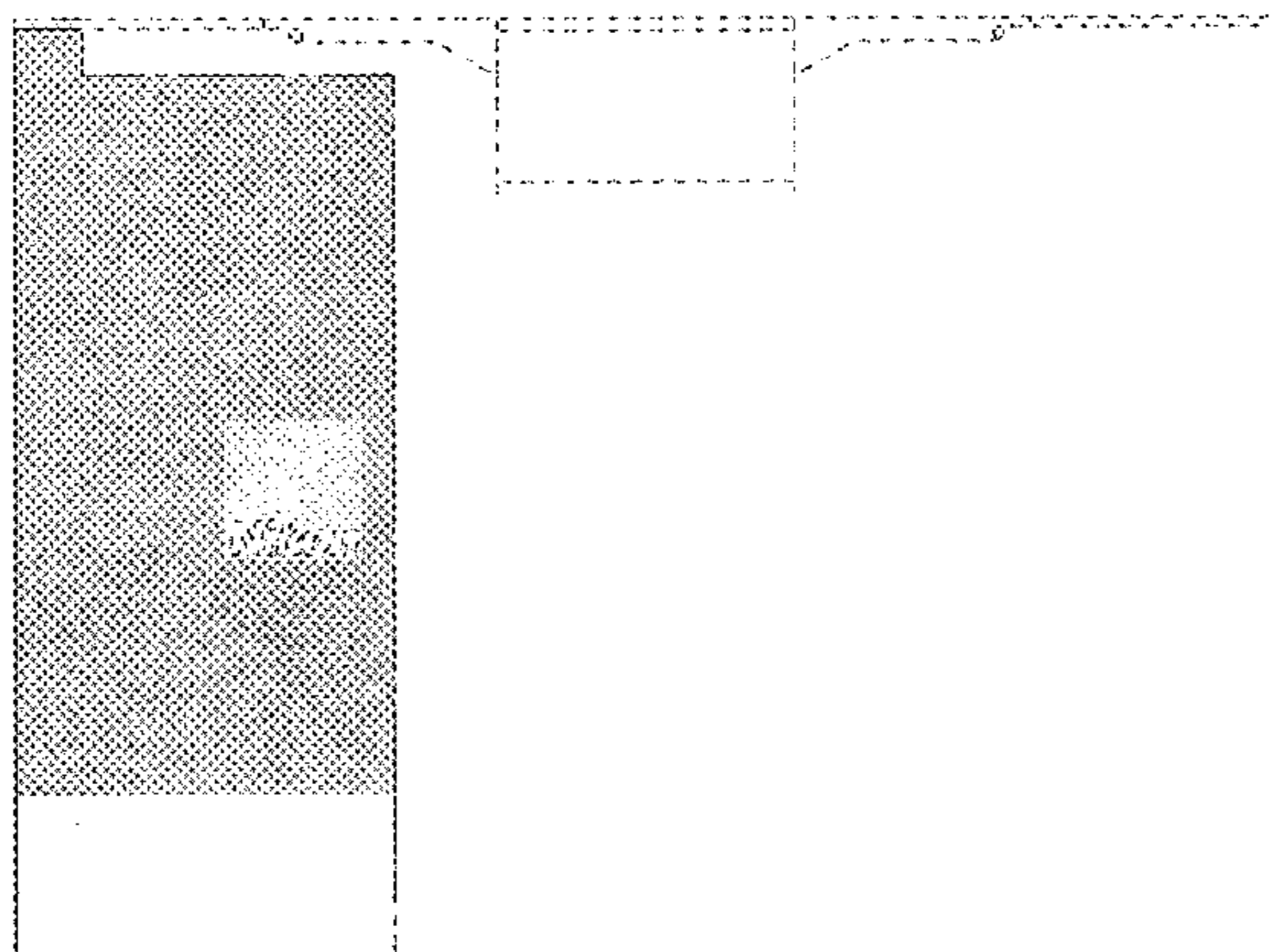

FIG. 1

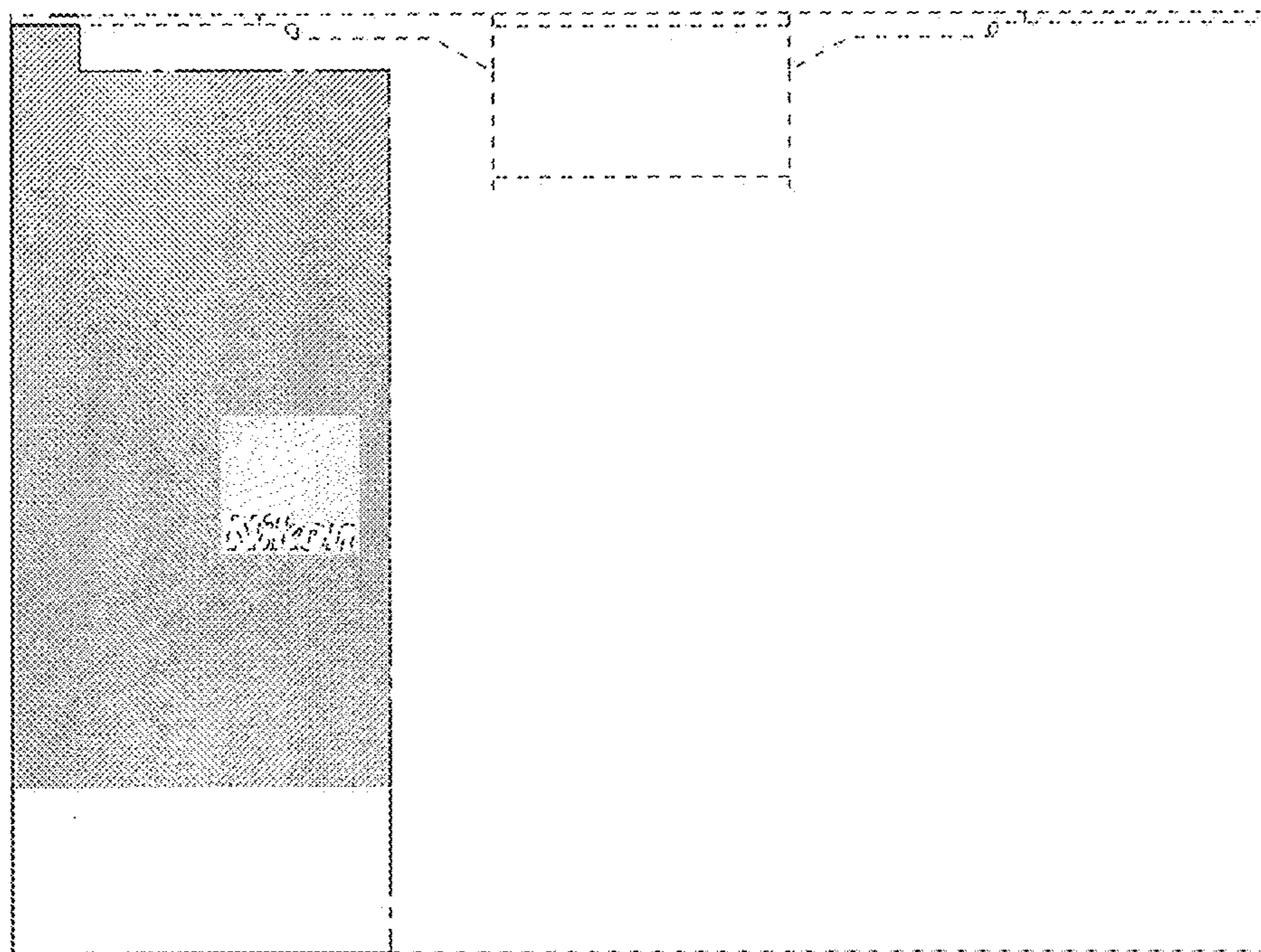

FIG. 2

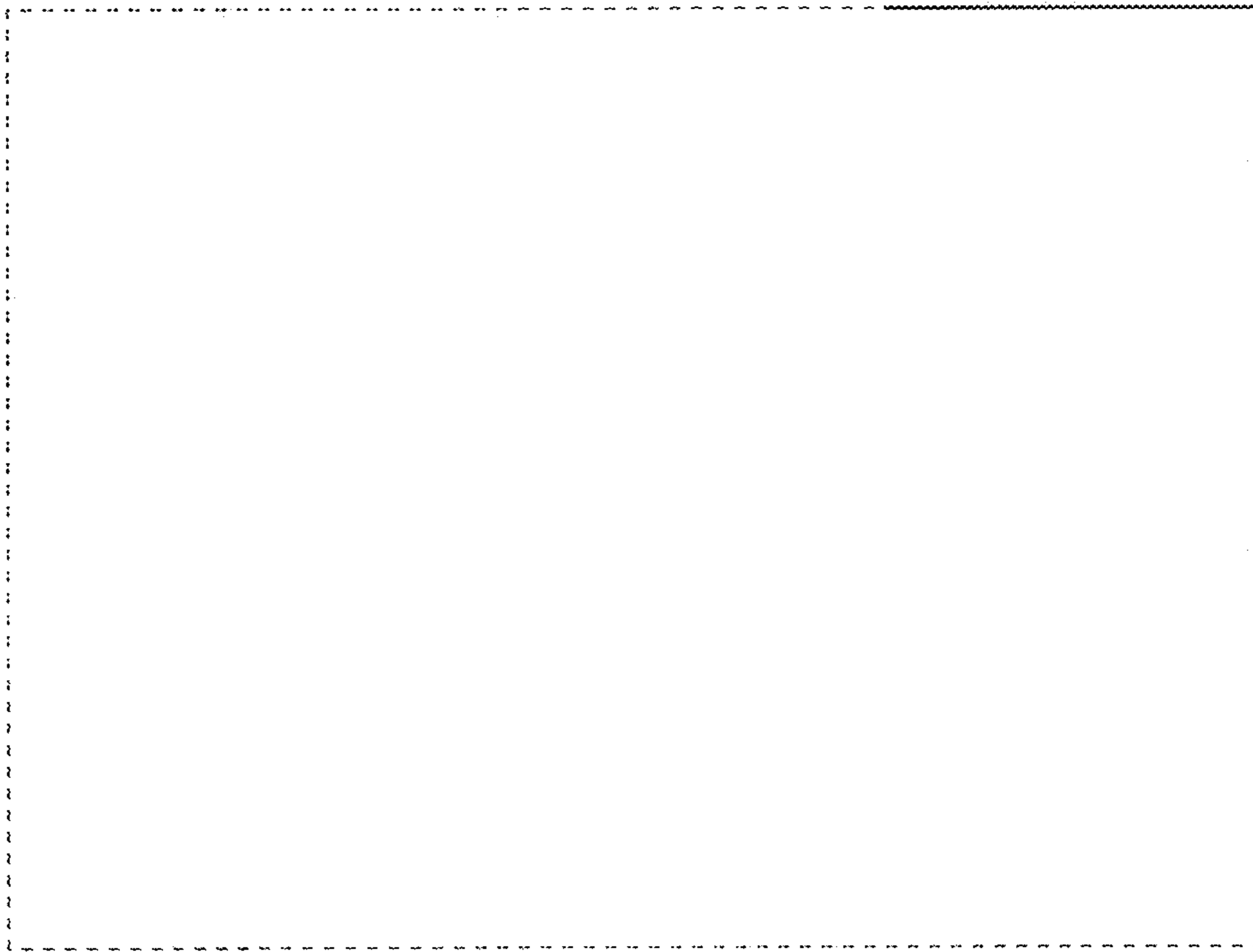

FIG. 3

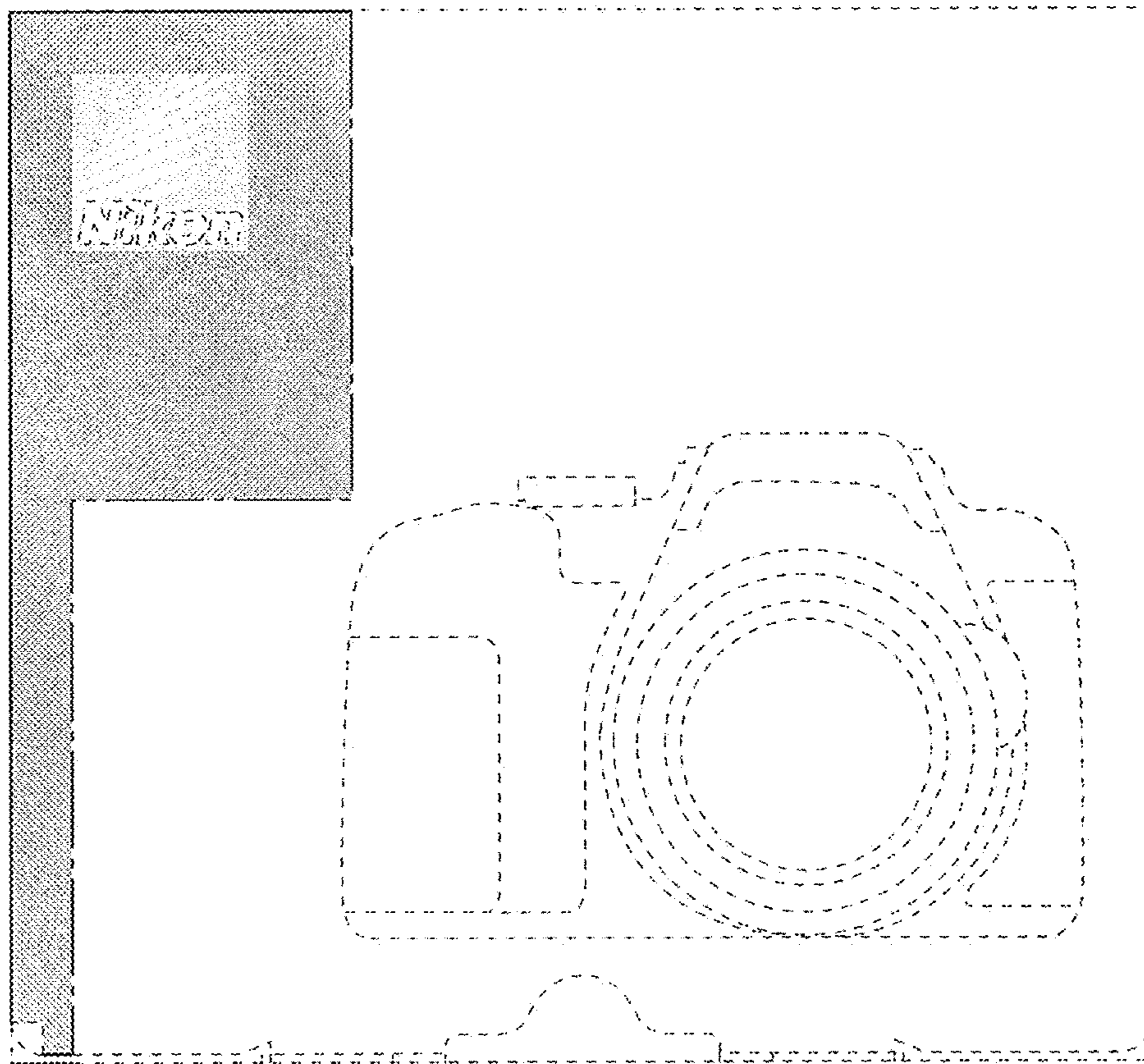

FIG. 4



FIG. 5



FIG. 6

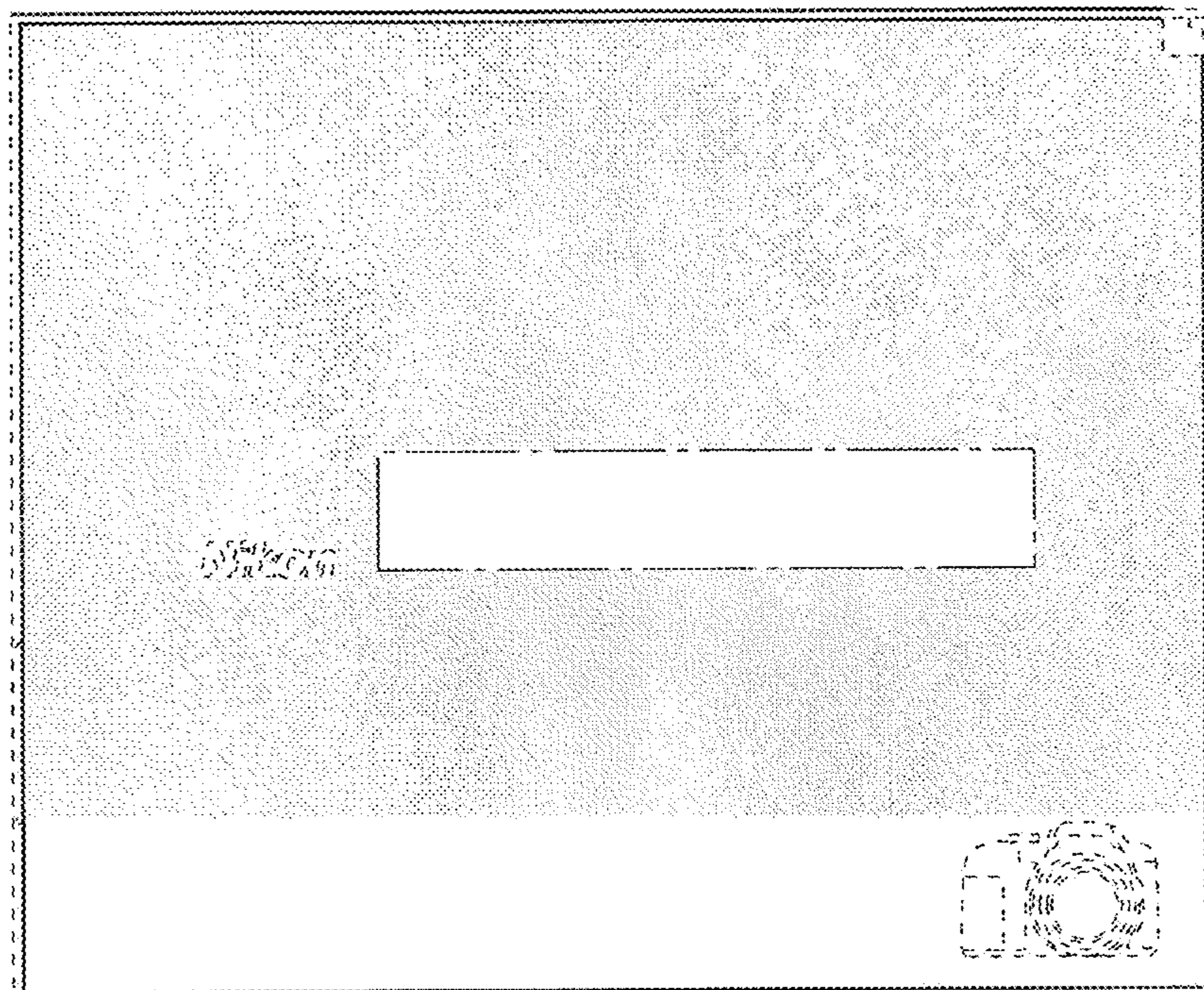

FIG. 7

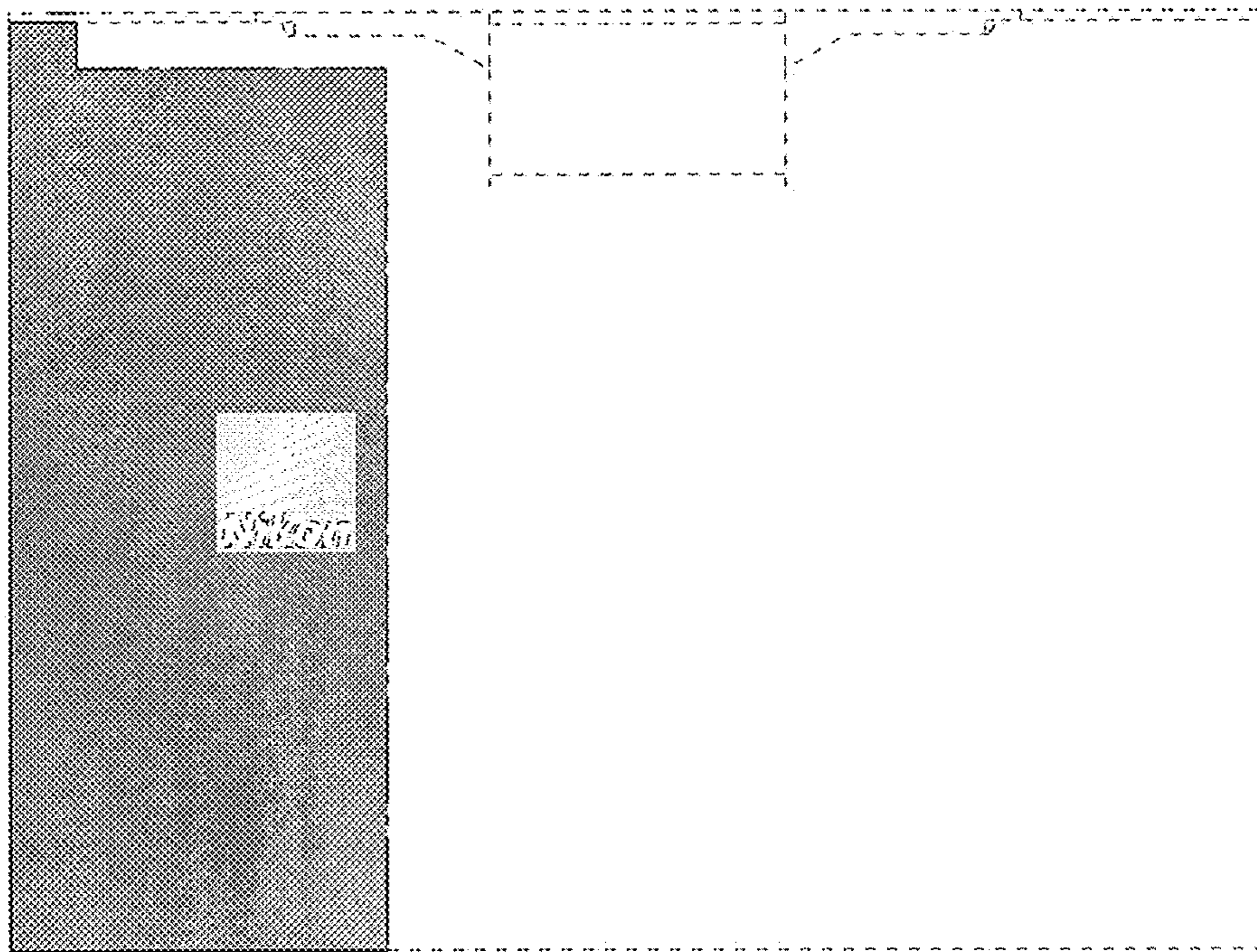

FIG. 8

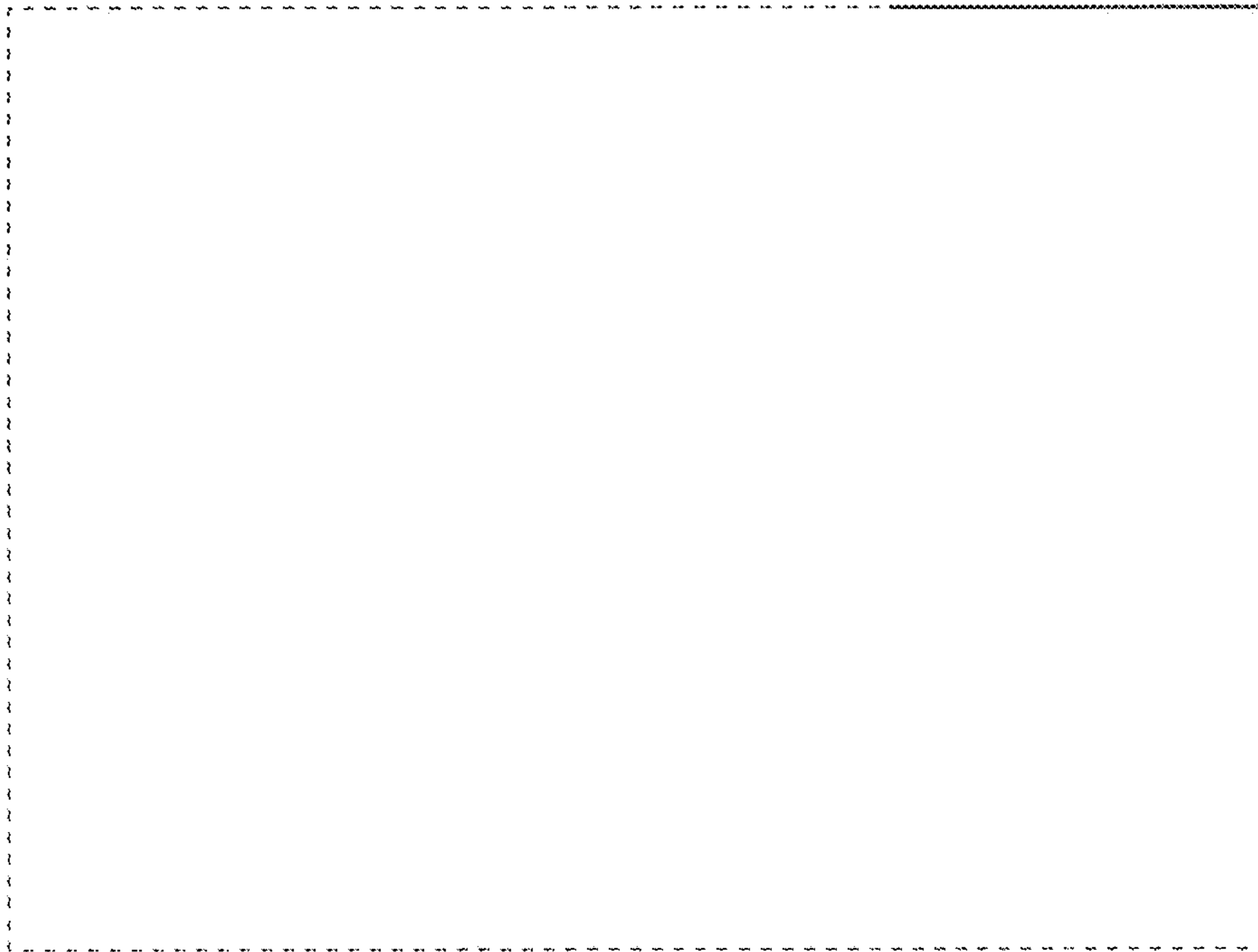

FIG. 9

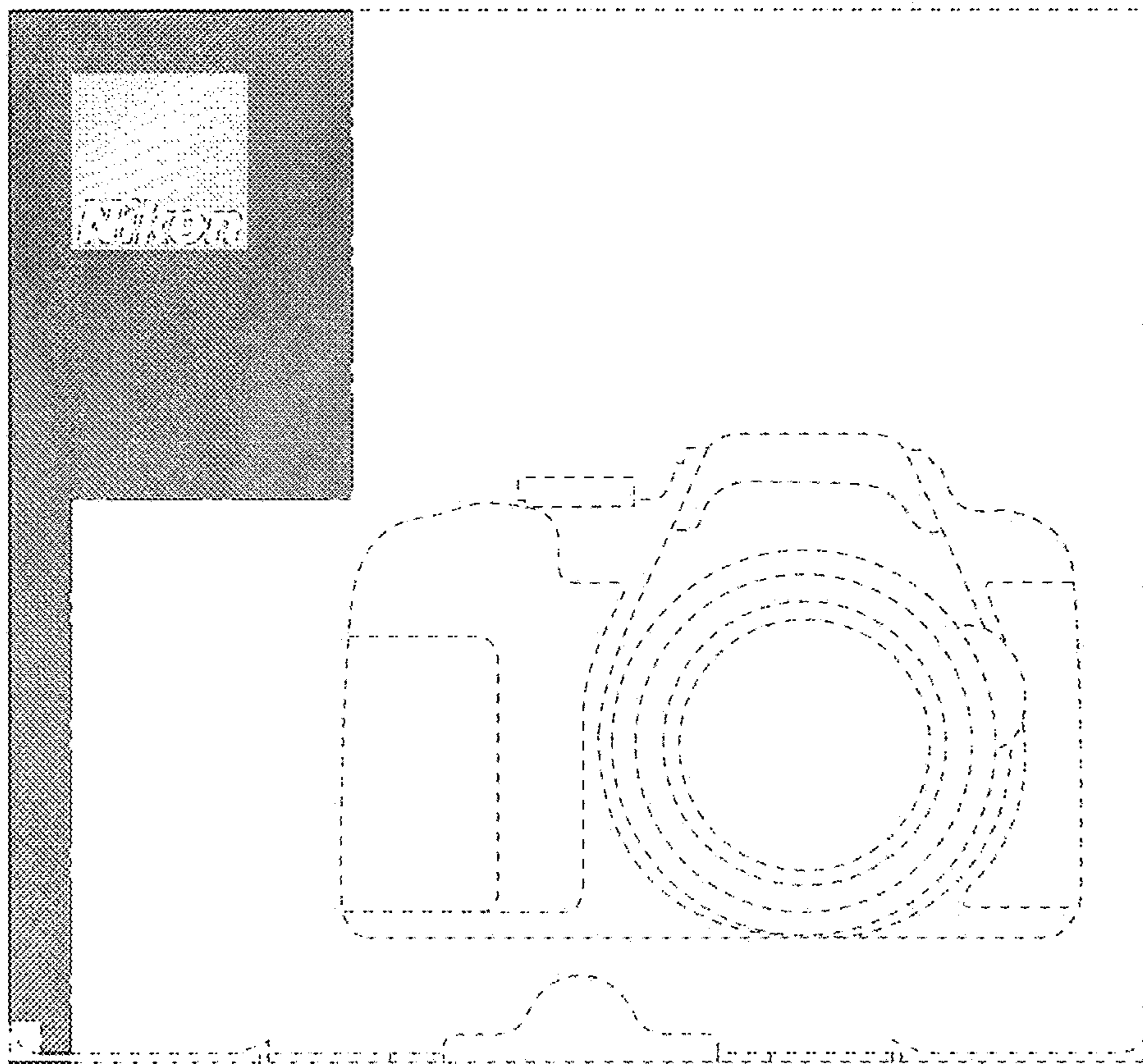

FIG. 10



FIG. 11

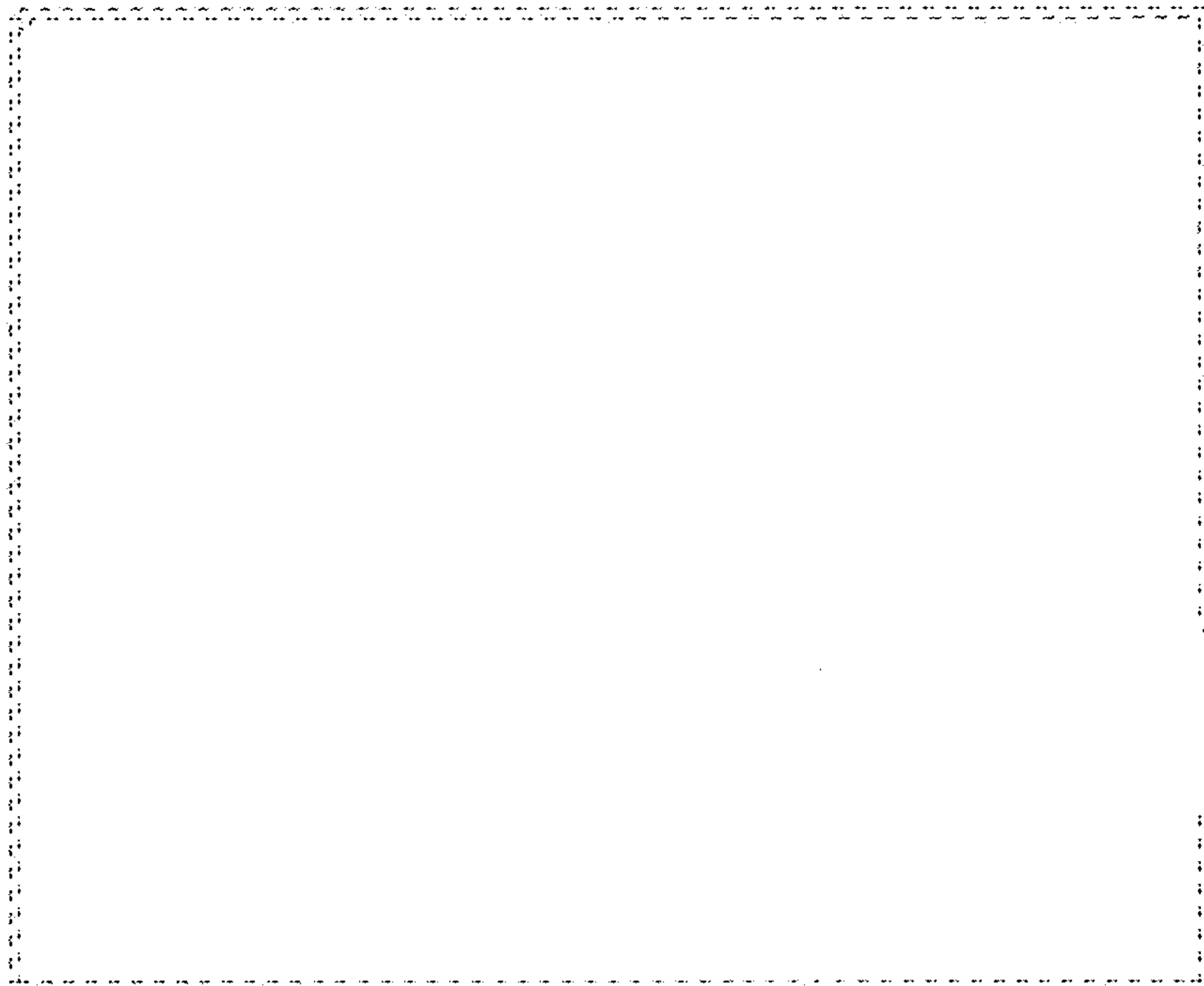

FIG. 12

