



US00D807821S

(12) **United States Design Patent**  
**Molnar**

(10) **Patent No.:** **US D807,821 S**  
(45) **Date of Patent:** **\*\* Jan. 16, 2018**

- (54) **I/O MODULE**
- (71) Applicant: **Rockwell Automation Technologies, Inc.**, Mayfield Heights, OH (US)
- (72) Inventor: **Nathan J. Molnar**, Shaker Heights, OH (US)
- (73) Assignee: **Rockwell Automation Technologies, Inc.**, Mayfield Heights, OH (US)
- (\*\*) Term: **14 Years**
- (21) Appl. No.: **29/521,353**
- (22) Filed: **Mar. 23, 2015**
- (51) **LOC (11) Cl.** ..... **13-02**
- (52) **U.S. Cl.**  
USPC ..... **D13/110**
- (58) **Field of Classification Search**  
USPC ..... D13/101, 110, 118, 120, 121, 123, 133, D13/139.2, 155, 162, 162.1, 163, 164, D13/184, 199; D14/311, 312, 313, 357, D14/358, 432, 433; D8/330, 343, 349, D8/353, 377, 382, 499  
CPC .. H05K 5/0017; H05K 5/0026; H05K 5/0221; H05K 7/1468; H05K 7/1469; H05K 7/1478; H05K 7/1481; H01R 9/26; Y10S 439/928  
See application file for complete search history.

- D638,687 S \* 5/2011 Minkley ..... D8/349
- 7,980,891 B2 7/2011 Molnar
- 8,066,239 B2 11/2011 Molnar et al.
- D684,534 S \* 6/2013 Nakahira ..... D13/110
- 9,032,593 B2 \* 5/2015 Rayos ..... F16B 17/00 224/321
- D746,124 S \* 12/2015 Toye ..... D8/349
- 2009/0125156 A1 5/2009 Killian et al.

(Continued)

*Primary Examiner* — Derrick Holland  
(74) *Attorney, Agent, or Firm* — Fay Sharpe LLP

(57) **CLAIM**

The ornamental design for an I/O module, as shown and described.

**DESCRIPTION**

FIG. 1 is a front isometric view of an I/O module showing the new design;  
 FIG. 2 is a rear isometric view of the I/O module showing the new design;  
 FIG. 3 is a left side view of the I/O module showing the new design;  
 FIG. 4 is a top view of the I/O module showing the new design;  
 FIG. 5 is a bottom view of the I/O module showing the new design;  
 FIG. 6 is a front view of the I/O module showing the new design;  
 FIG. 7 is a right side view of the I/O module showing the new design; and,  
 FIG. 8 is a rear view of the I/O module showing the new design.

The broken lines in the drawings are used to depict environment and form no part of the claim design. Where broken lines abut a claimed surface it is understood that those broken lines represent an unclaimed boundary between claimed and unclaimed surfaces. None of the broken lines form any part of the claimed design.

**1 Claim, 4 Drawing Sheets**

(56) **References Cited**

**U.S. PATENT DOCUMENTS**

- D368,252 S \* 3/1996 Nakai ..... D13/162.1
- D400,986 S \* 11/1998 Kanta ..... D25/199
- D402,965 S \* 12/1998 Bender ..... D13/162
- 5,904,592 A 5/1999 Baran et al.
- D427,147 S \* 6/2000 Wei ..... D13/110
- 6,418,027 B1 7/2002 Suzuki et al.
- 6,431,909 B1 8/2002 Nolden et al.
- 7,059,898 B2 6/2006 Barile
- D550,617 S \* 9/2007 Wang ..... D13/101

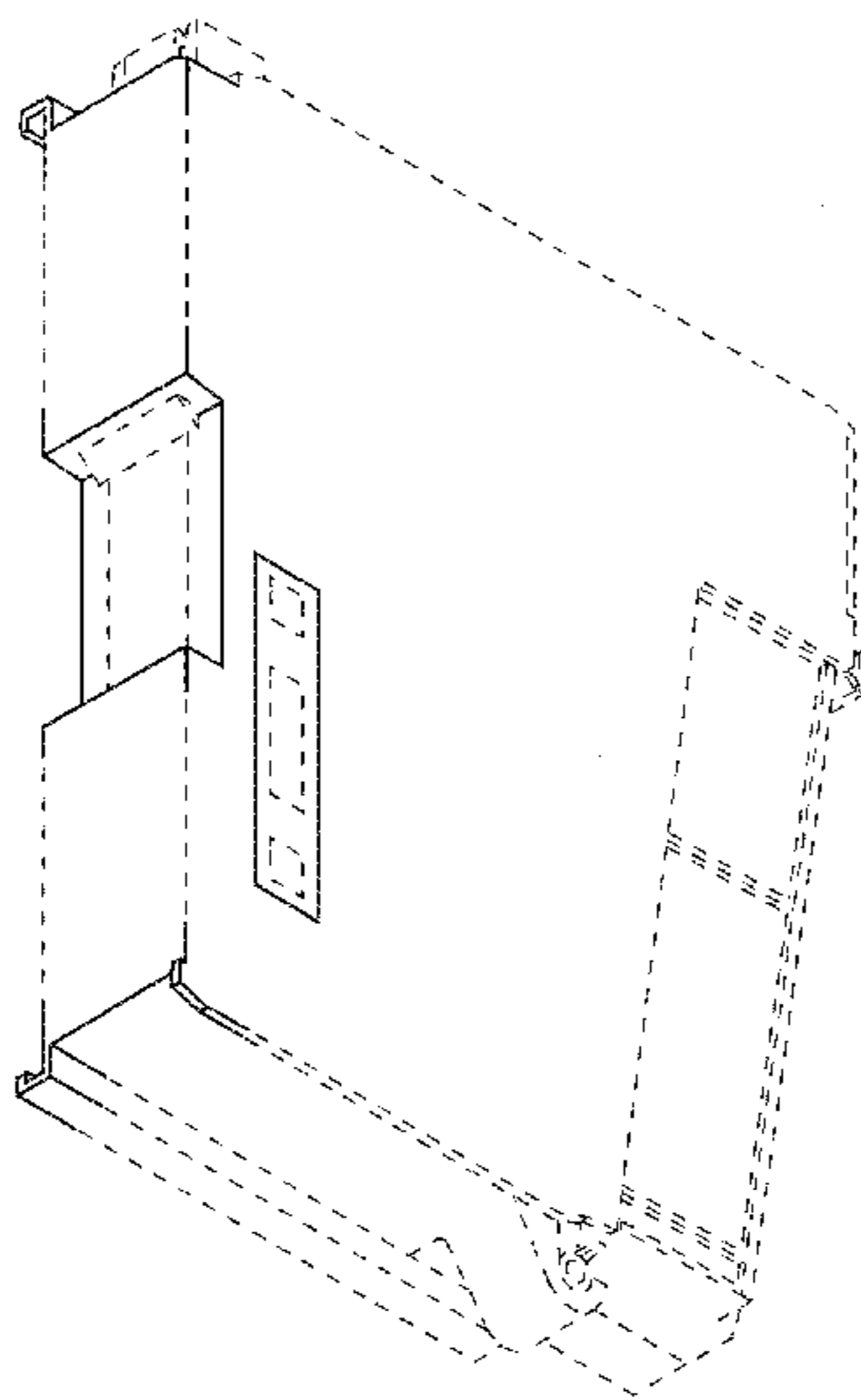

(56)

**References Cited**

U.S. PATENT DOCUMENTS

2014/0017917 A1 1/2014 Molnar  
2014/0226287 A1\* 8/2014 V ..... H02B 1/052  
361/747

\* cited by examiner

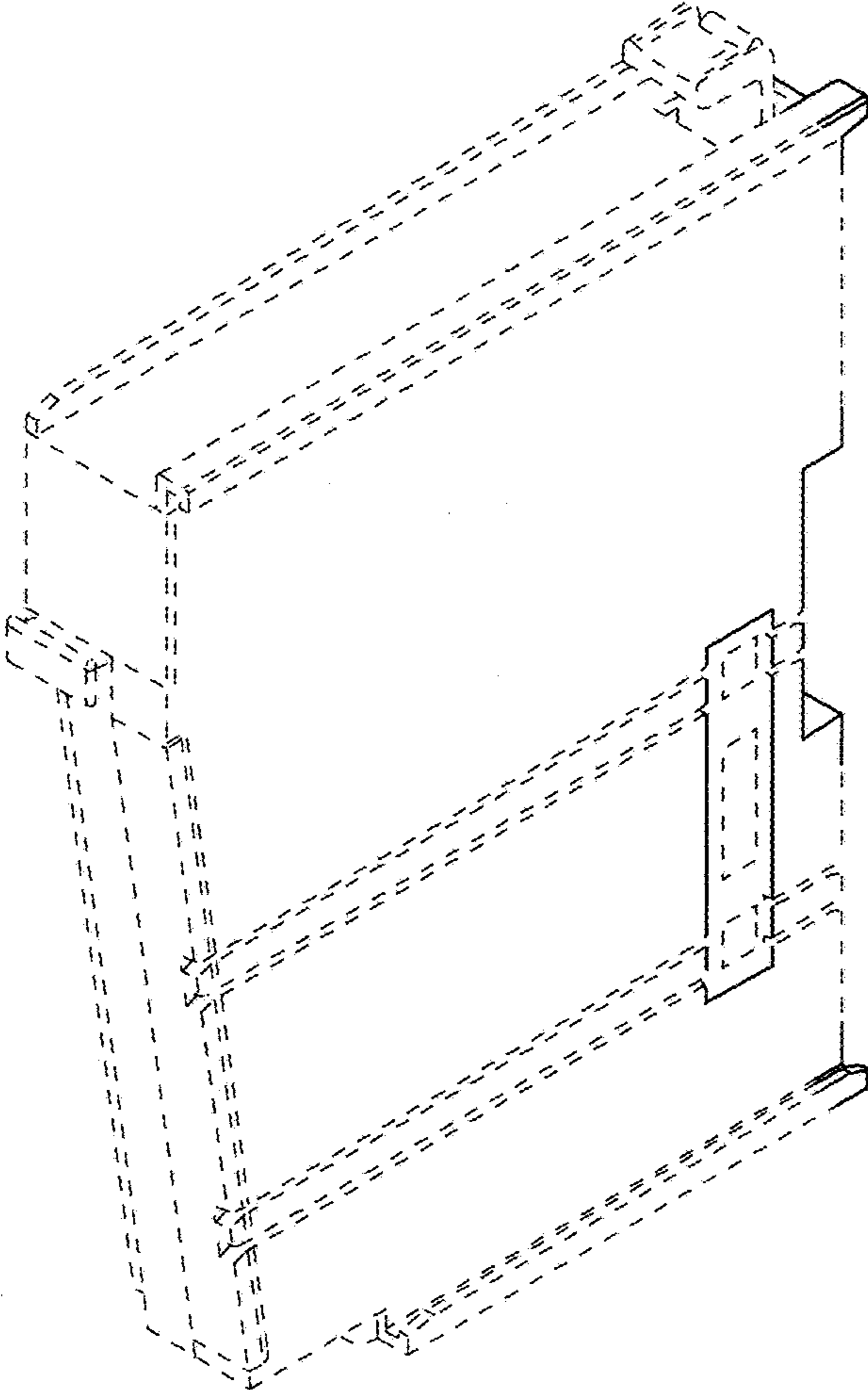

FIG. 1

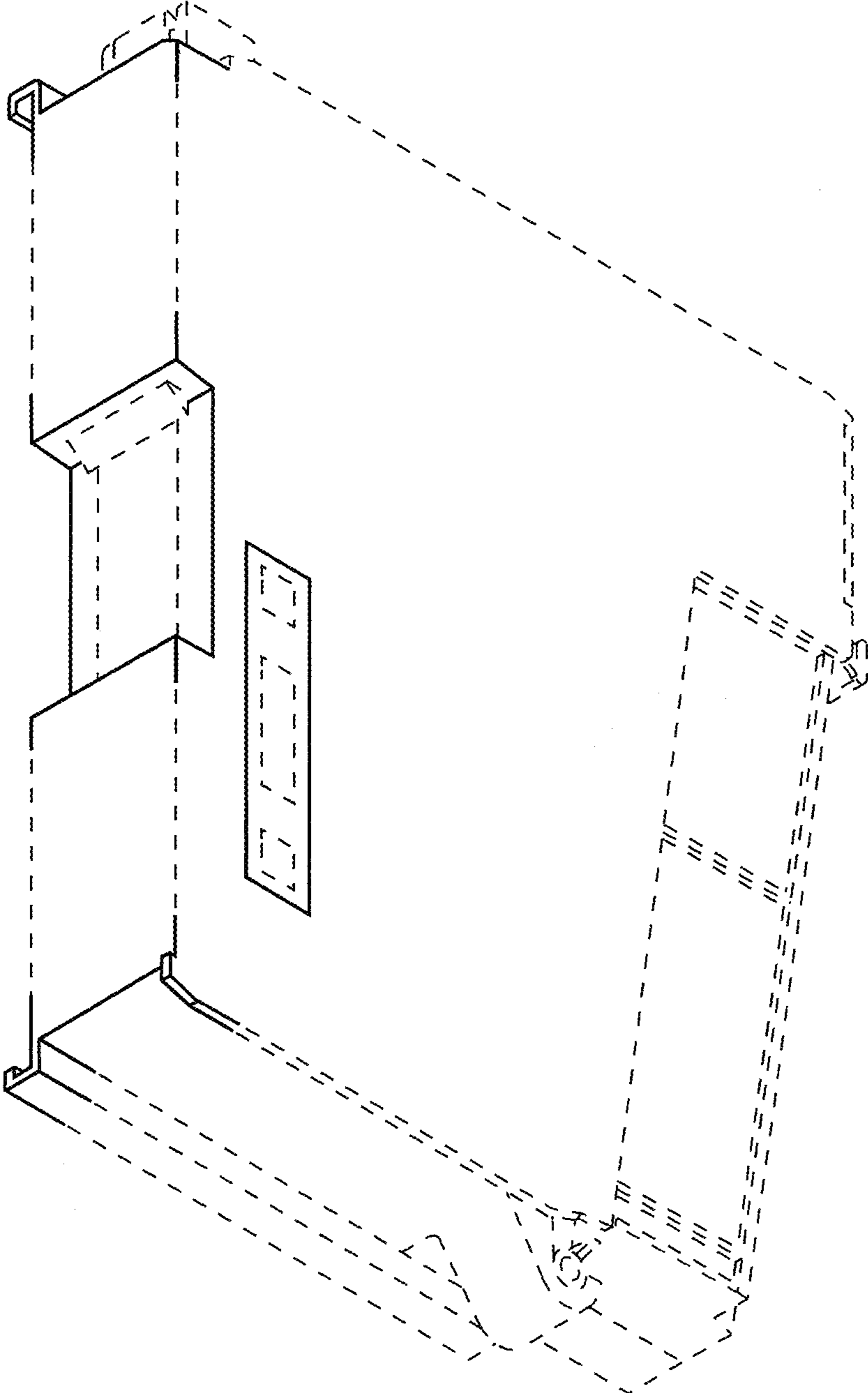

FIG. 2

FIG. 4

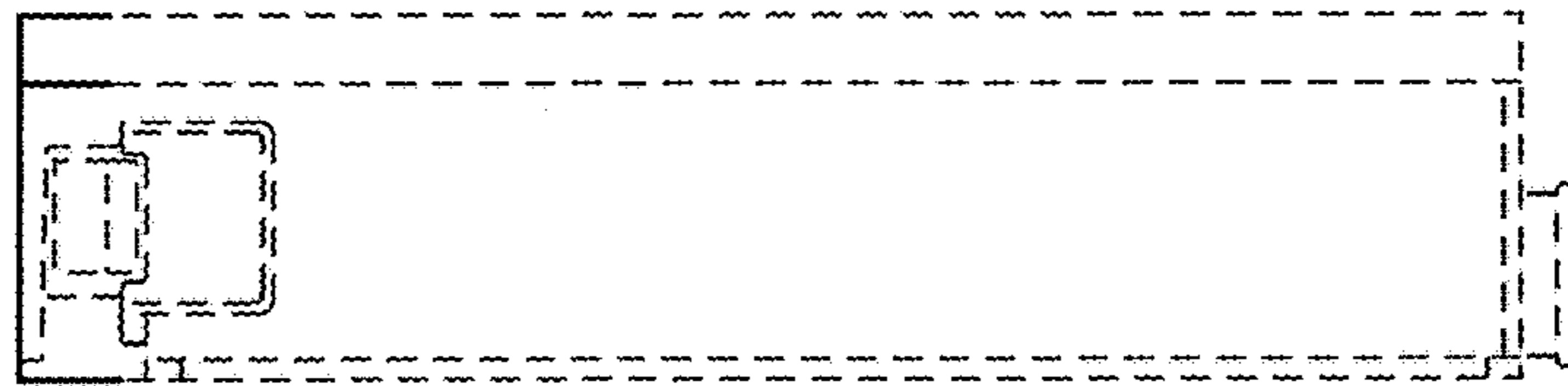

FIG. 3

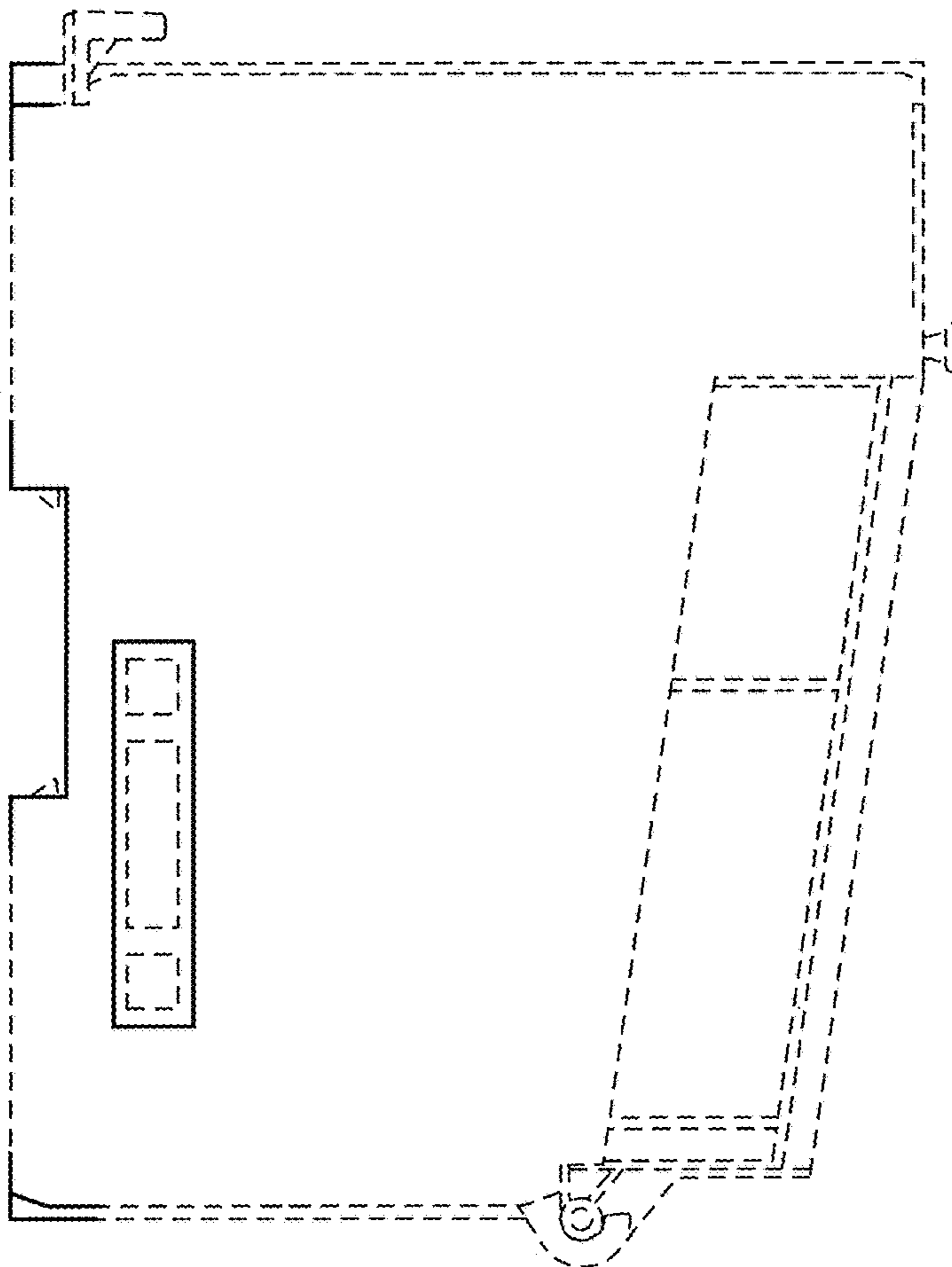
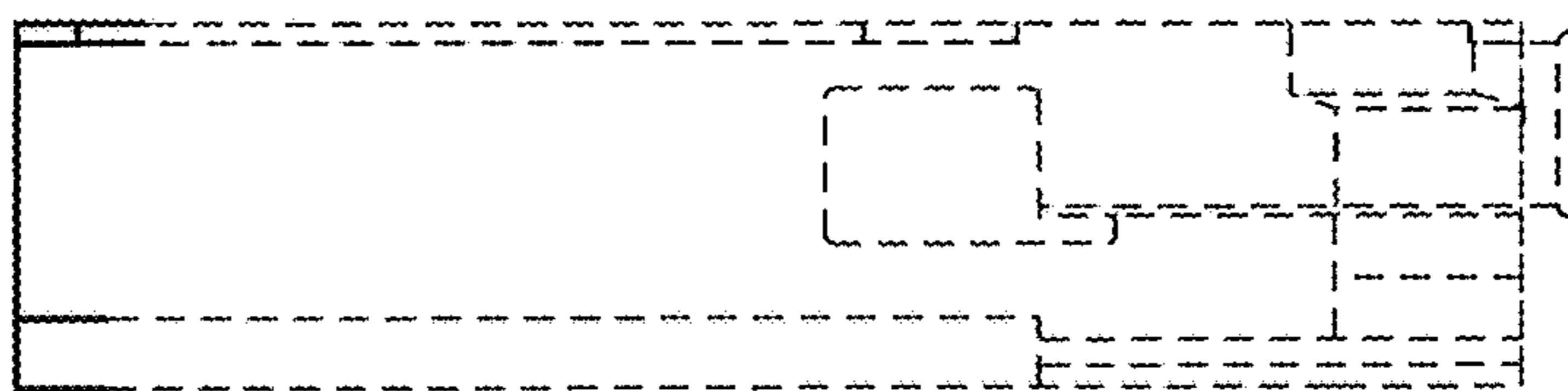

FIG. 5



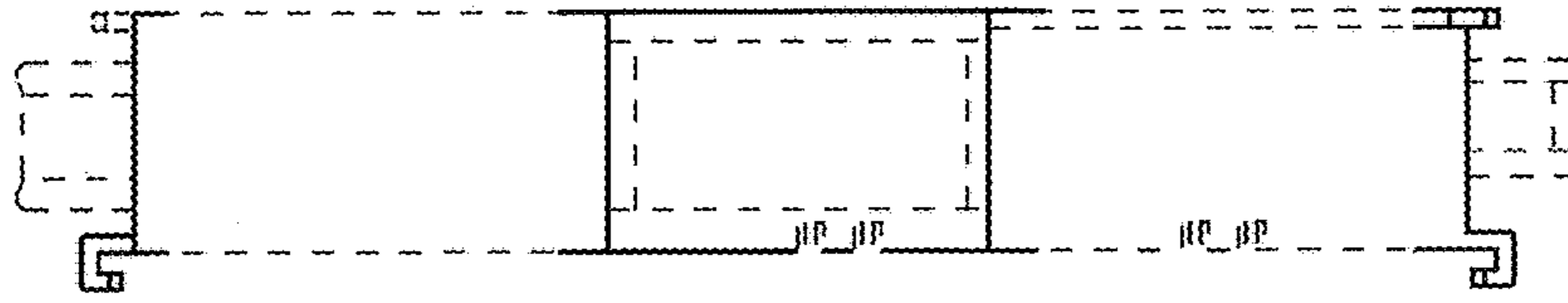

FIG. 6

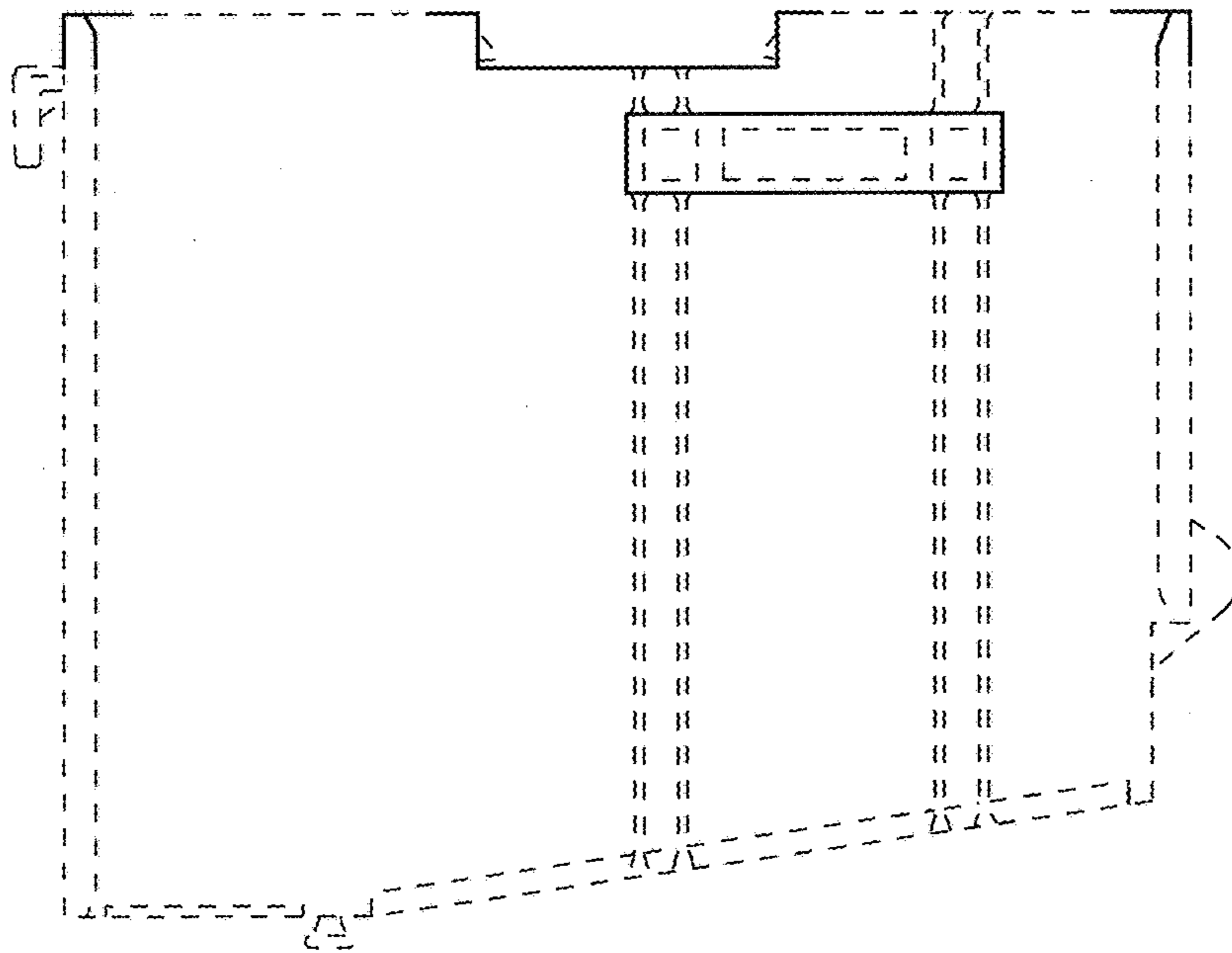

FIG. 7

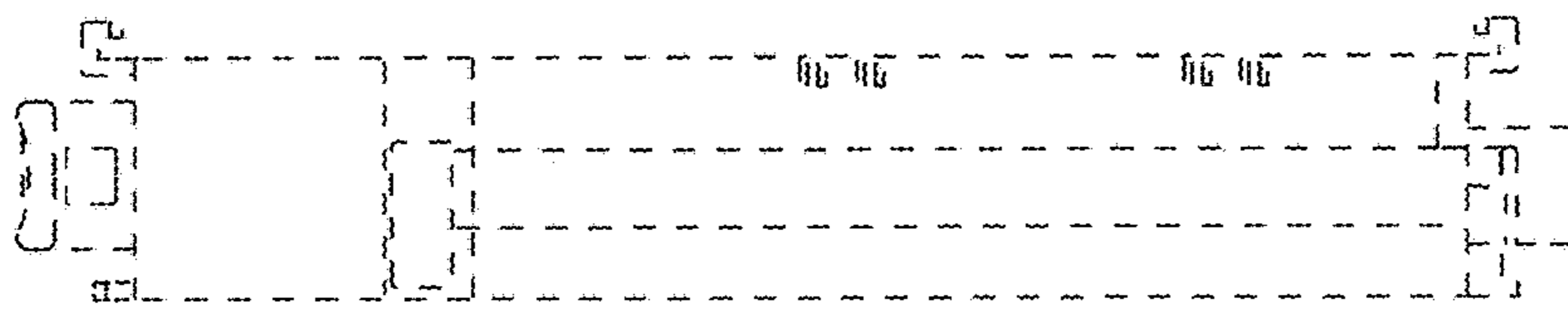

FIG. 8