



US00D807426S

(12) **United States Design Patent** (10) **Patent No.:** **US D807,426 S**
Brown et al. (45) **Date of Patent:** **** Jan. 9, 2018**

(54) **PRINTING MACHINE**
(71) Applicant: **XEROX CORPORATION**, Norwalk, CT (US)
(72) Inventors: **Donald A Brown**, Honeoye Falls, NY (US); **Hiroko Saito**, Kanagawa (JP); **Megumi Okubo**, Kanagawa (JP); **Ko Takeuchi**, Yokohama (JP); **Ohgi Kazuyuki**, Kanagawa (JP); **William T Clark, III**, Pittsford, NY (US)
(73) Assignee: **Xerox Corporation**, Norwalk, CT (US)
(**) Term: **15 Years**
(21) Appl. No.: **29/575,292**
(22) Filed: **Aug. 24, 2016**
(51) **LOC (11) Cl.** **18-02**
(52) **U.S. Cl.**
USPC **D18/50; D18/55**
(58) **Field of Classification Search**
USPC D18/50, 55, 36-37, 39; D14/520-525; 347/3
CPC G06K 15/12; G06K 15/14; B41J 15/12; B41J 15/042; B41J 11/58
See application file for complete search history.

D581,976 S * 12/2008 Park D18/55
D584,349 S * 1/2009 Tani D18/55
D584,766 S * 1/2009 Tani D18/55
D586,385 S * 2/2009 Kim D18/55
D616,927 S * 6/2010 Suzuki D18/55
D639,851 S * 6/2011 Penke D18/55
D641,778 S * 7/2011 Lee D14/421
D662,974 S * 7/2012 Suzuki D18/55
D667,488 S * 9/2012 Inoue D18/55
D674,435 S * 1/2013 Inoue D18/55
D686,277 S * 7/2013 Gilbert D18/55
D688,742 S * 8/2013 Kim D18/55
D697,967 S * 1/2014 Fukasawa D18/55
D702,285 S * 4/2014 Gilbert D18/39
D724,142 S * 3/2015 Kim D18/55
D726,251 S * 4/2015 Kim D18/55
D727,410 S * 4/2015 Saito D18/36
D727,417 S * 4/2015 Huang D18/55
D749,168 S * 2/2016 Nakagawa D18/50
D752,135 S * 3/2016 Uchikawa D18/39

(Continued)

Primary Examiner — Robin V Webster
Assistant Examiner — James C Thorn, Sr.

(57) **CLAIM**

The ornamental design for a printing machine, as shown and described.

DESCRIPTION

FIG. 1 is a perspective view of a printing machine in accordance with the present invention;
FIG. 2 is a front view thereof;
FIG. 3 is a right side view thereof;
FIG. 4 is a rear view thereof;
FIG. 5 is a left side view thereof;
FIG. 6 is a top plan view thereof; and,
FIG. 7 is a bottom plan view thereof.
The broken lines shown in the drawings are included for the purpose of illustrating environmental structure and form no part of the claimed design.

1 Claim, 7 Drawing Sheets

(56) **References Cited**
U.S. PATENT DOCUMENTS
D423,040 S * 4/2000 Ohta D18/36
D494,211 S * 8/2004 Yoshida D18/39
D523,068 S * 6/2006 Hoshiya D18/36
D544,532 S * 6/2007 Matsumoto D18/49
D548,776 S * 8/2007 Egami D18/50
D550,279 S * 9/2007 Tani D18/50
D552,168 S * 10/2007 Egami D18/50
D555,194 S * 11/2007 Smith D18/55
D561,251 S * 2/2008 Tjin Wong Joe D18/55
D567,848 S * 4/2008 Kawamura D18/39

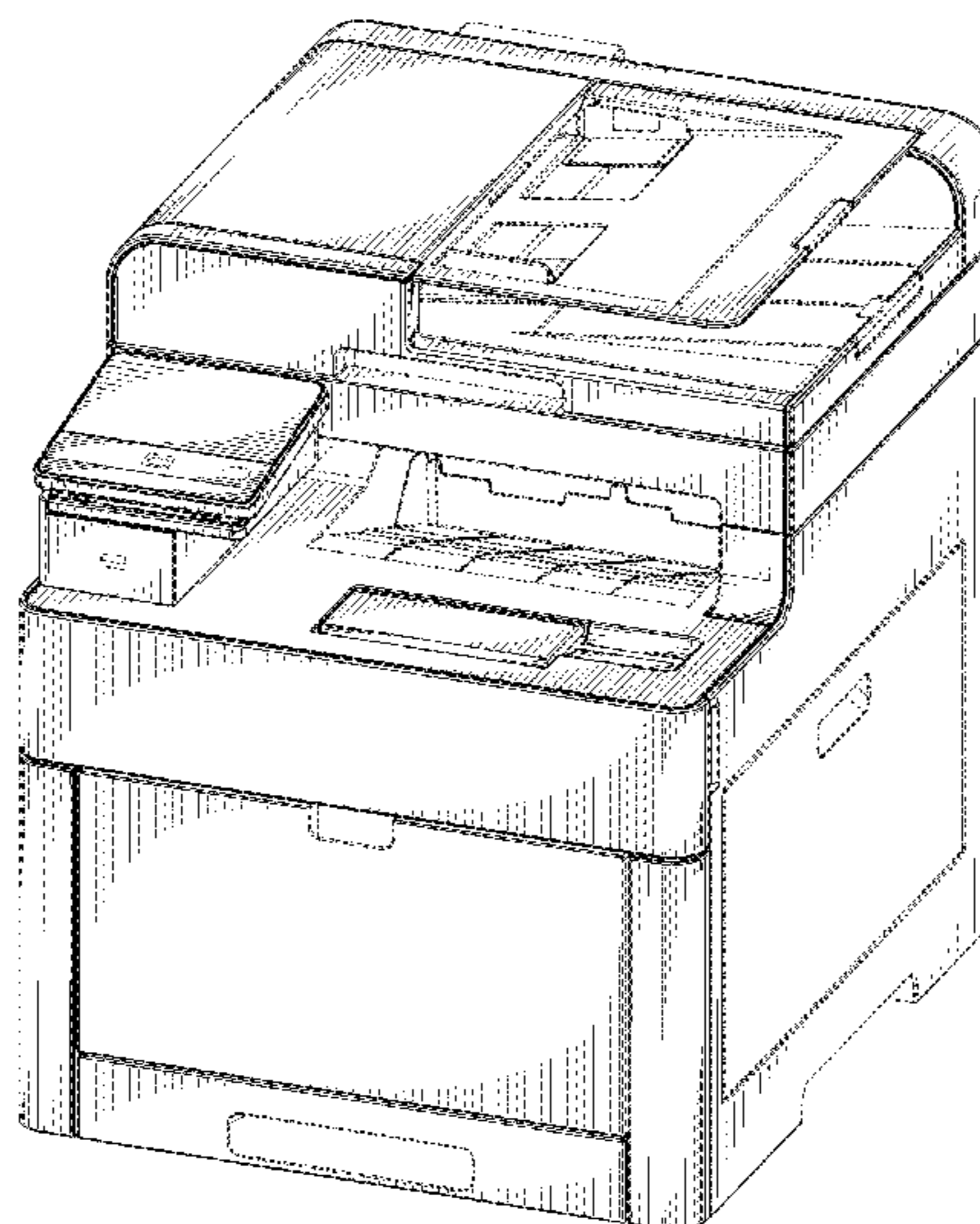

(56)

References Cited

U.S. PATENT DOCUMENTS

D755,284 S * 5/2016 Terenzio D18/50
D758,486 S * 6/2016 Nakagawa D18/55
D765,080 S * 8/2016 Su D14/421
D769,965 S * 10/2016 Clark, III D18/55
D780,840 S * 3/2017 Kim D18/55
D782,568 S * 3/2017 Nishimura D18/55
D800,123 S * 10/2017 Tashima D14/421
D800,214 S * 10/2017 Sato D18/50
D800,216 S * 10/2017 Sato D18/55
2017/0217699 A1* 8/2017 Washino B65H 1/30
2017/0217702 A1* 8/2017 Ozeki B65H 1/04

* cited by examiner

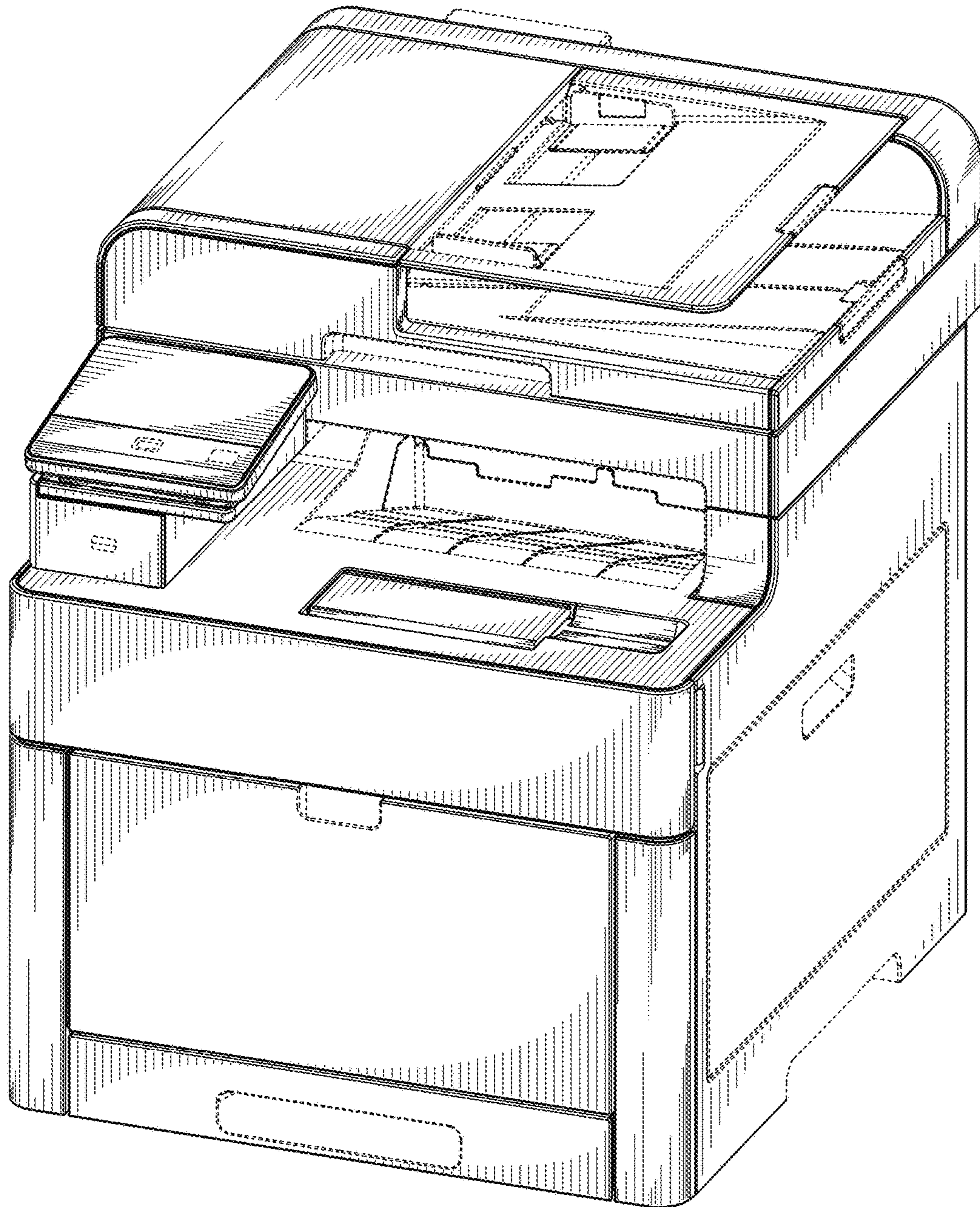

FIG. 1

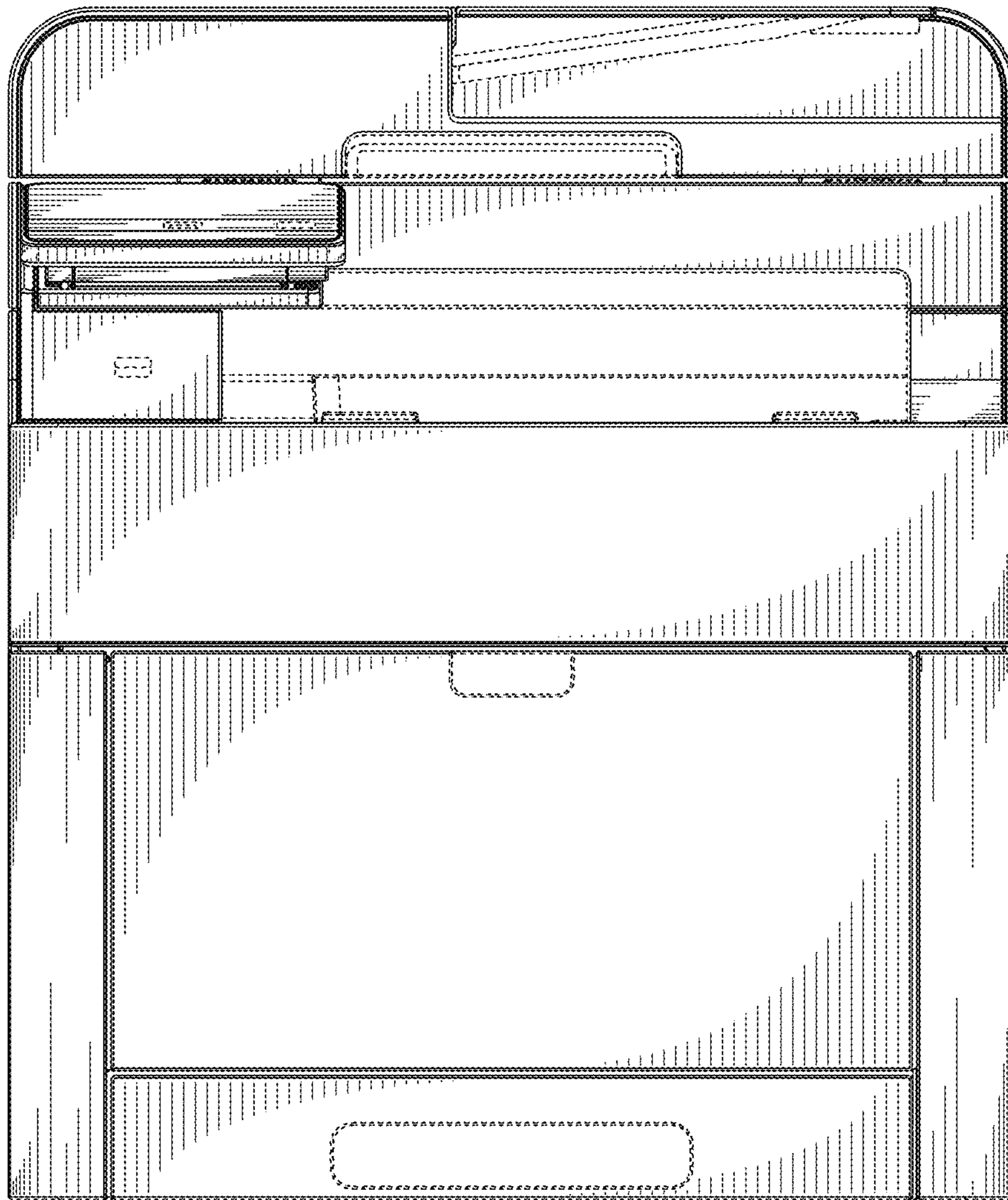

FIG. 2

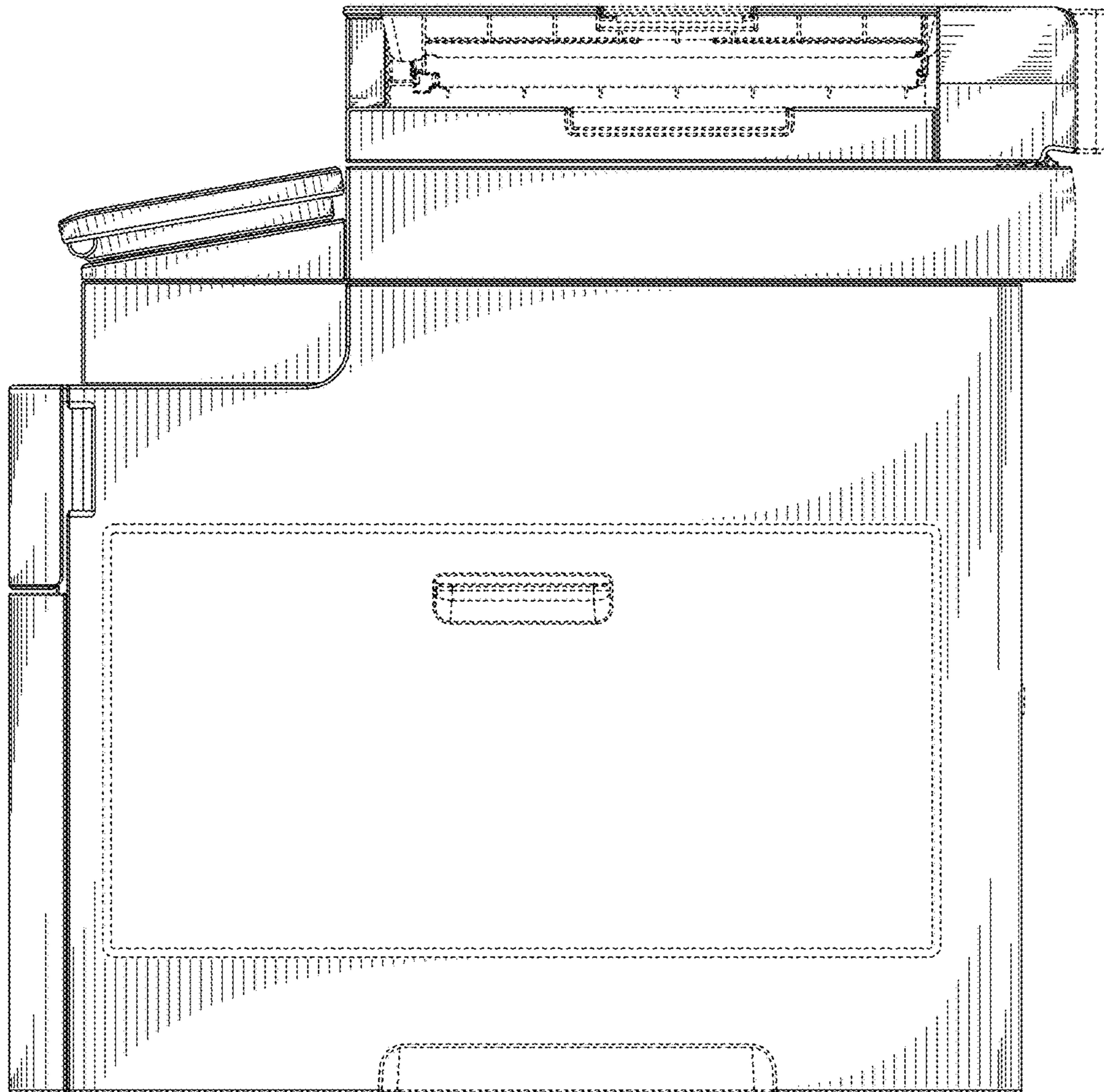

FIG. 3

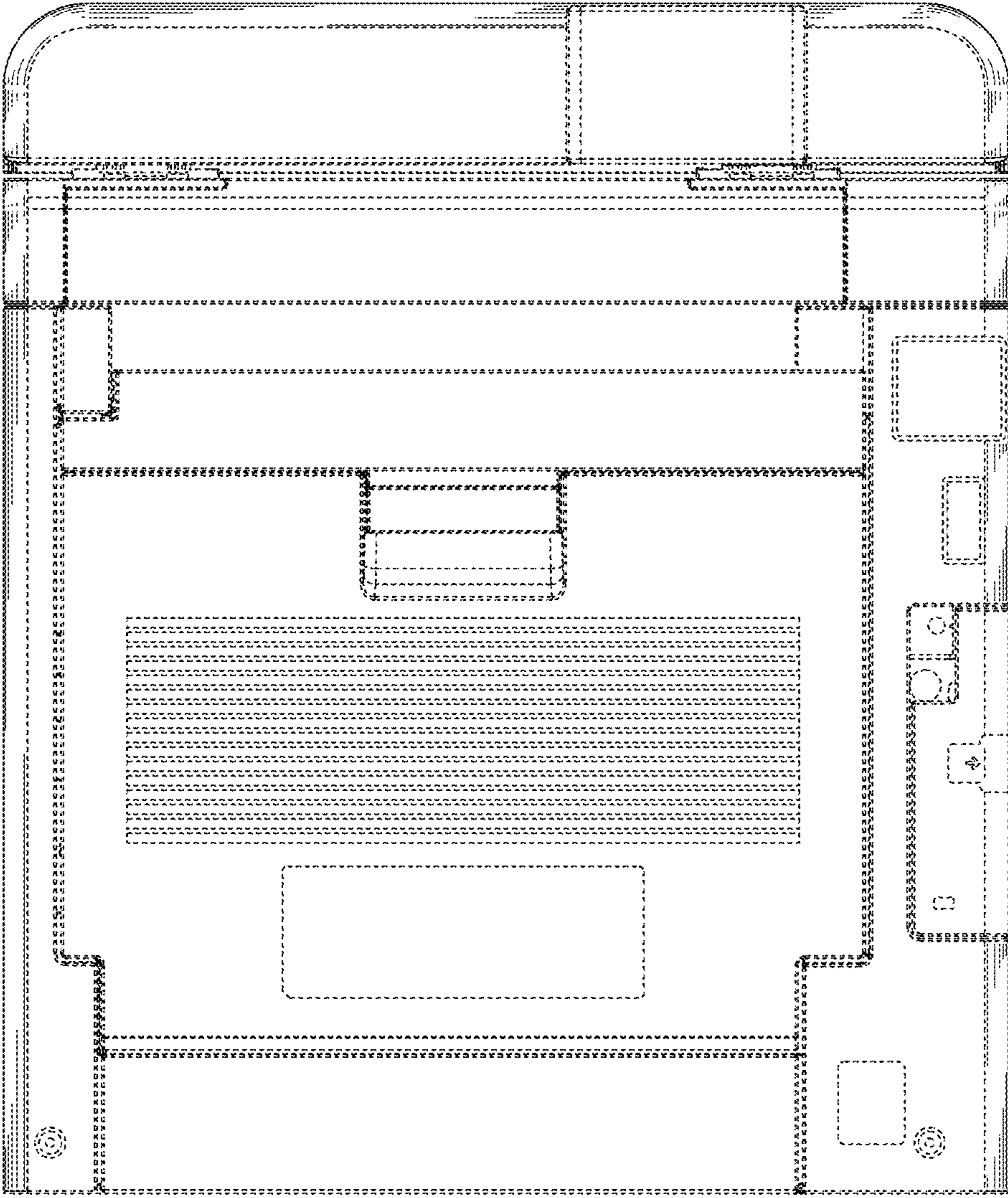

FIG. 4

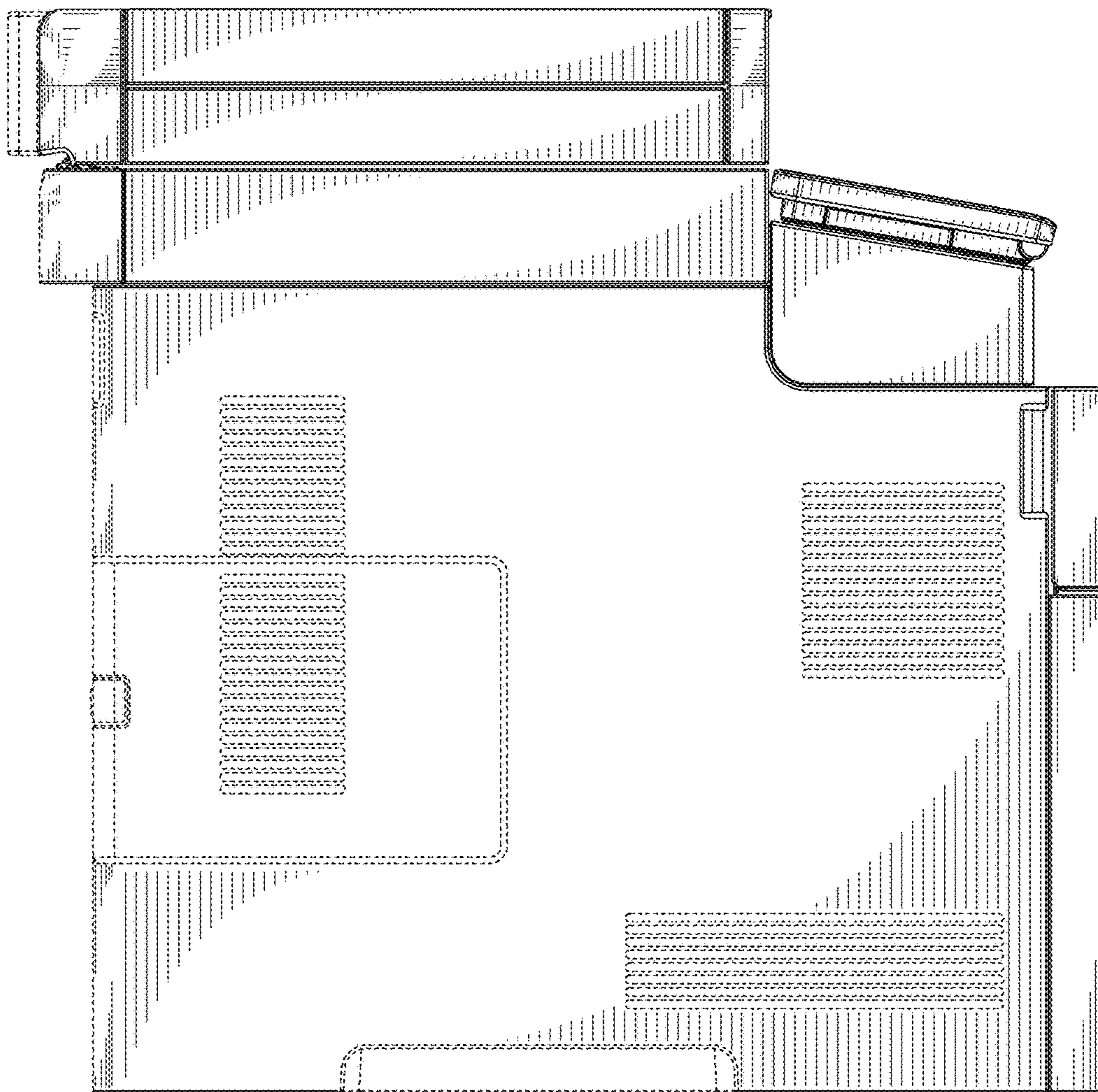

FIG. 5

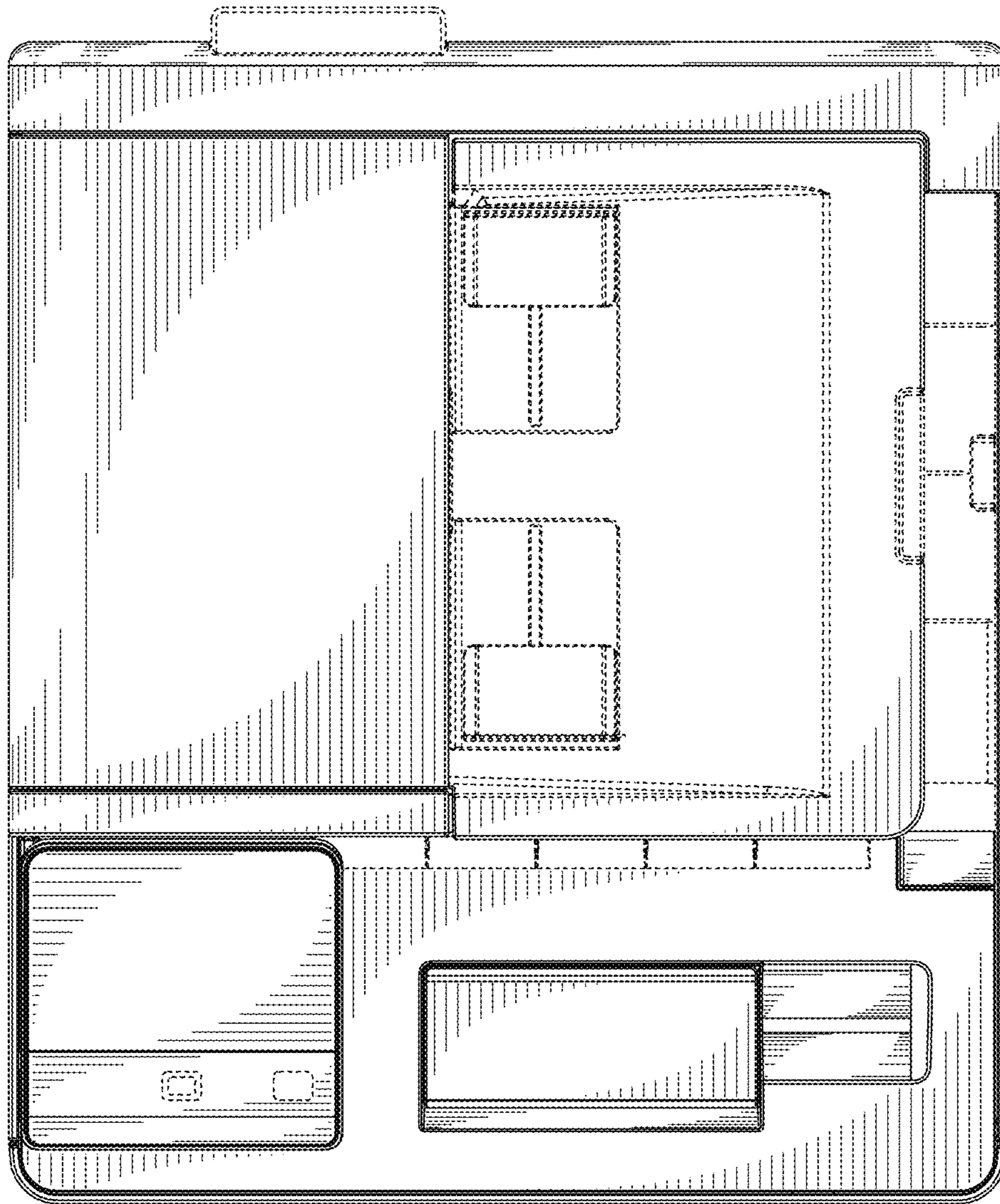

FIG. 6

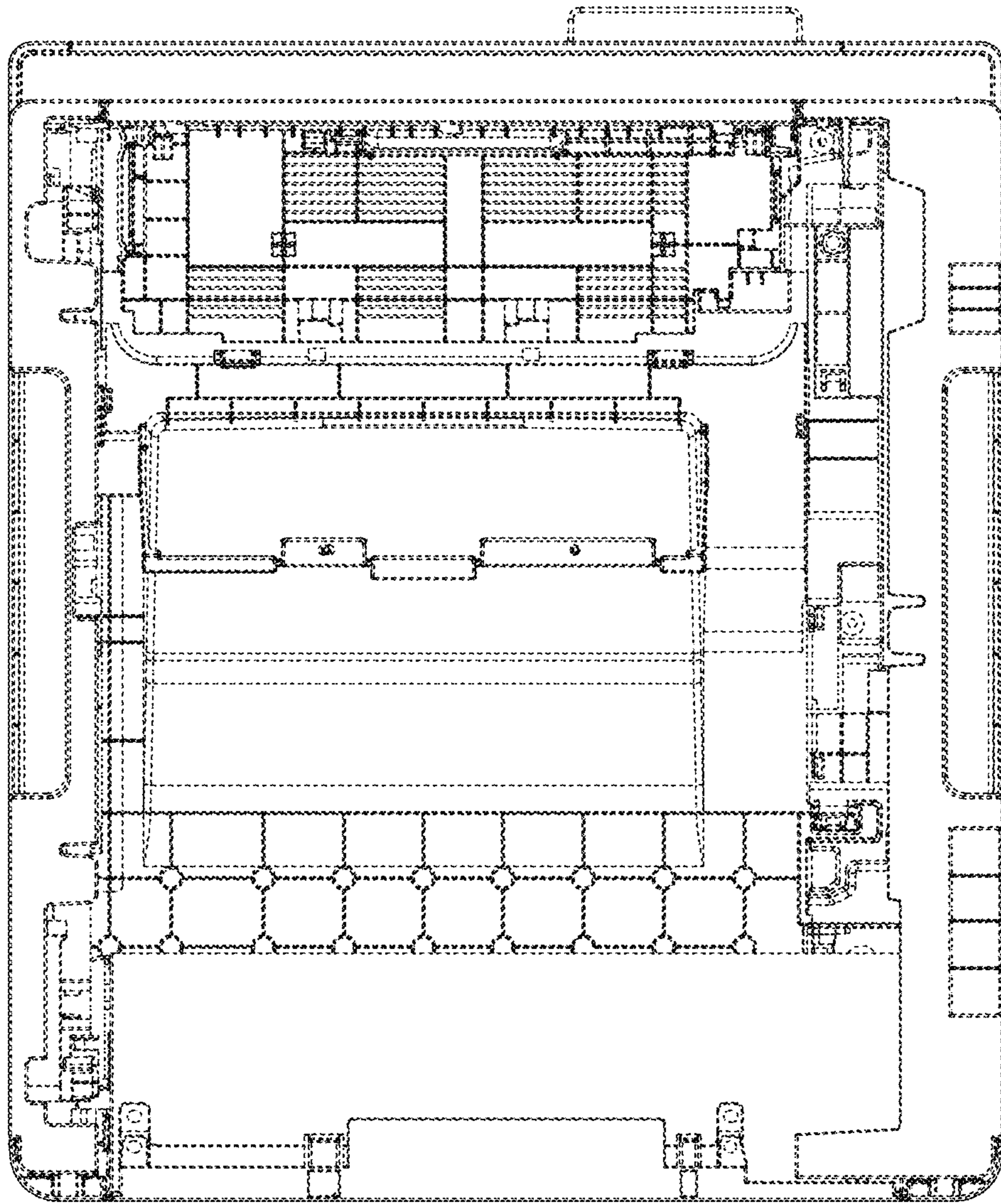

FIG. 7