



US00D807305S

(12) **United States Design Patent** (10) **Patent No.:** **US D807,305 S**
Suwa et al. (45) **Date of Patent:** **** Jan. 9, 2018**

(54) **KEYBOARD FOR CONTROLLING MACHINE TOOLS**
(71) Applicant: **FANUC CORPORATION**, Yamanashi (JP)
(72) Inventors: **Hiroyuki Suwa**, Yamanashi (JP); **Yoshiaki Kurobe**, Yamanashi (JP)
(73) Assignee: **FANUC CORPORATION**, Yamanashi (JP)

5,015,829 A * 5/1991 Eilert H01H 13/702
200/308
D334,542 S * 4/1993 Lowe D10/104.1
D465,216 S * 11/2002 Zdinak D13/164
6,564,111 B1 * 5/2003 Gottschald B24B 9/148
409/138
D573,108 S * 7/2008 Pan D13/164
D642,542 S * 8/2011 Berning D13/164
D712,362 S * 9/2014 Rodriguez D13/164
D740,083 S * 10/2015 Wasserman D7/689
9,513,862 B2 * 12/2016 Sakai G06F 3/041
D776,627 S * 1/2017 Shimohama D13/164
2002/0054676 A1 * 5/2002 Zhao H04M 1/6066
379/354

(**) Term: **15 Years**

(Continued)

(21) Appl. No.: **29/580,056**

(22) Filed: **Oct. 5, 2016**

(30) **Foreign Application Priority Data**

Apr. 8, 2016 (JP) 2016-007906

(51) **LOC (11) Cl.** **13-02**

(52) **U.S. Cl.**
USPC **D13/164; D14/455; D14/396**

(58) **Field of Classification Search**
USPC D13/162, 162.1, 164; D10/49, 50;
D14/338, 390, 391, 392, 396, 443, 455,
D14/456
CPC G05B 19/0425; G05B 19/0426;
G05B 19/05; G05B 19/401; G05B
19/409; G06F 3/0219; G06F 3/0484;
G06F 3/0489; G06F 1/1601

See application file for complete search history.

(56) **References Cited**

U.S. PATENT DOCUMENTS

D256,230 S * 8/1980 Beale D13/164
D278,807 S * 5/1985 Perna D13/164
D280,406 S * 9/1985 Walker D13/164
D294,566 S * 3/1988 Boytor D13/164
D297,652 S * 9/1988 Columbus D13/164
D299,125 S * 12/1988 Anderson D13/164

OTHER PUBLICATIONS

Design U.S. Appl. No. 29/580,200, by Kinoshita et al., filed Oct. 6, 2016.

Primary Examiner — Selina Sikder
(74) *Attorney, Agent, or Firm* — RatnerPrestia

(57) **CLAIM**

The ornamental design for a keyboard for controlling machine tools, as shown and described.

DESCRIPTION

FIG. 1 is a perspective view of a keyboard for controlling machine tools showing our new design;
FIG. 2 is a front view thereof;
FIG. 3 is a left side elevational view thereof;
FIG. 4 is a right side elevational view thereof;
FIG. 5 is a top plan view thereof;
FIG. 6 is a bottom plan view thereof; and,
FIG. 7 is a rear view thereof.

The broken line showing is included for the purpose of illustrating portions of the article and forms no part of the claimed design. The dot-dashed lines show unclaimed boundaries.

1 Claim, 5 Drawing Sheets

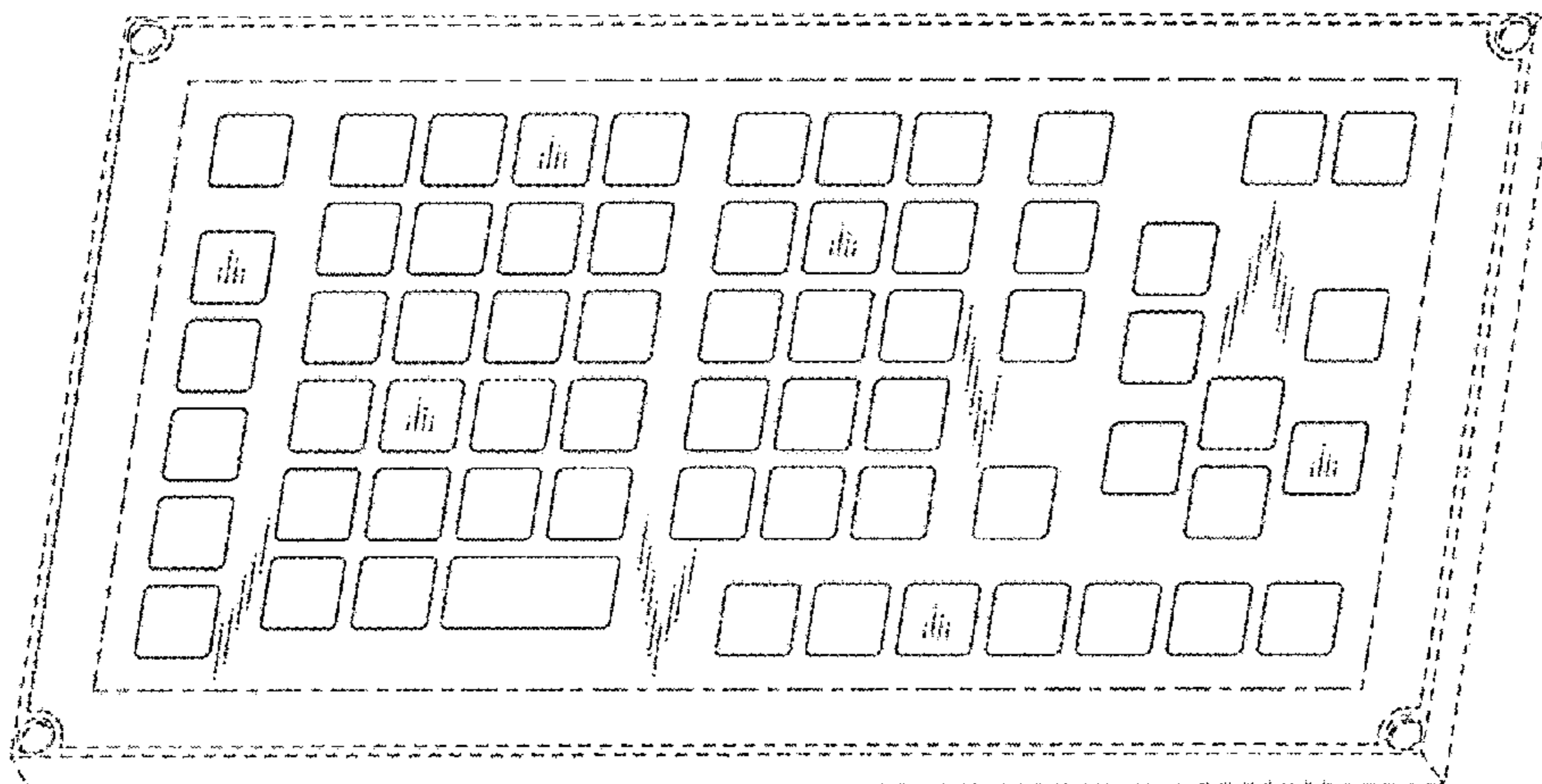

(56)

References Cited

U.S. PATENT DOCUMENTS

2003/0040884 A1* 2/2003 Walther G05B 19/409
702/150
2009/0168315 A1* 7/2009 Hu G06F 1/1607
361/679.08
2009/0187373 A1* 7/2009 Atwell B25J 9/1692
702/152
2013/0335327 A1* 12/2013 Solomon G06F 1/1662
345/168
2016/0048121 A1* 2/2016 Shinohara G05B 19/409
700/179
2016/0305777 A1* 10/2016 Racine G01B 21/00

* cited by examiner

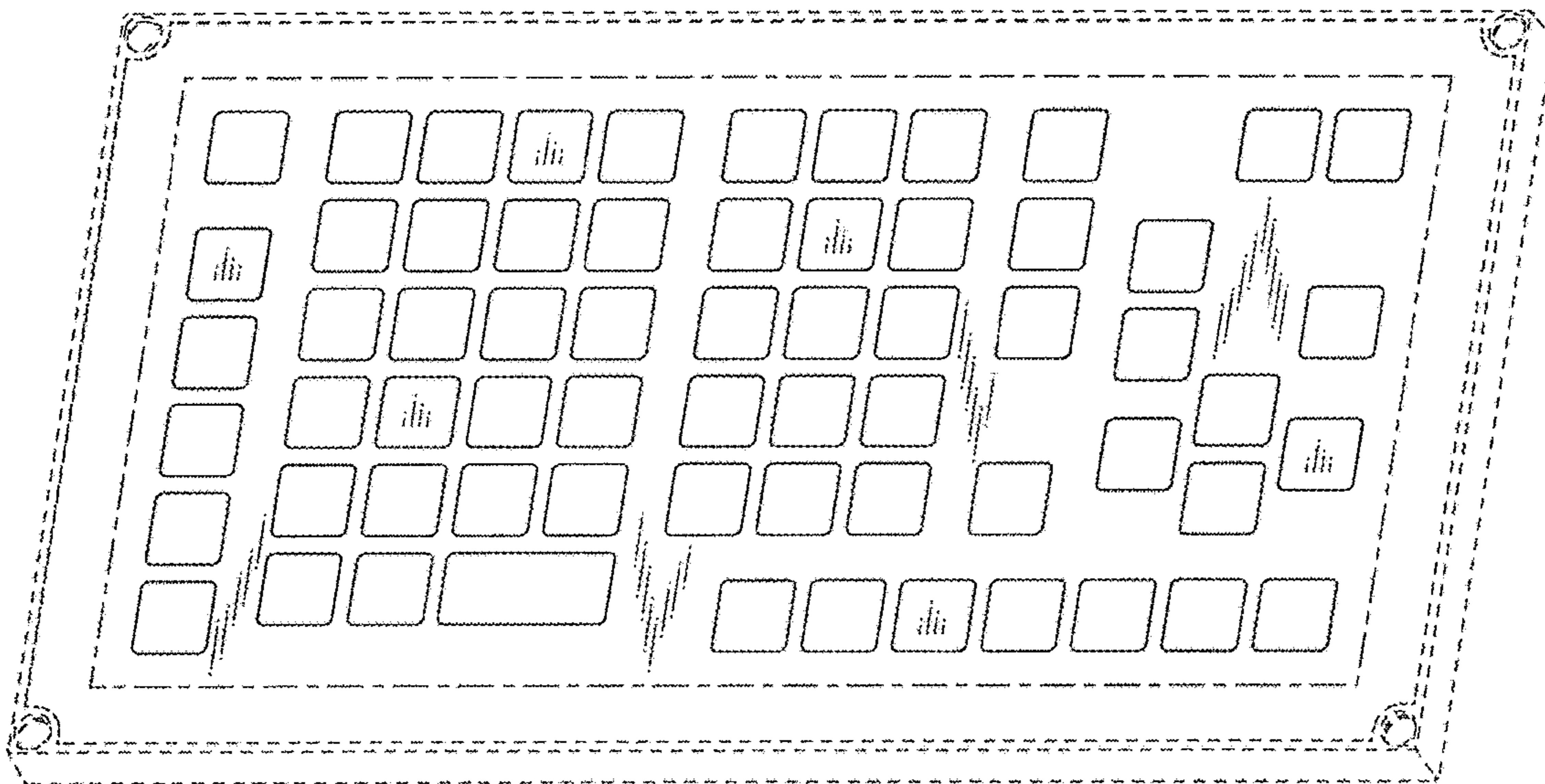

FIG. 1

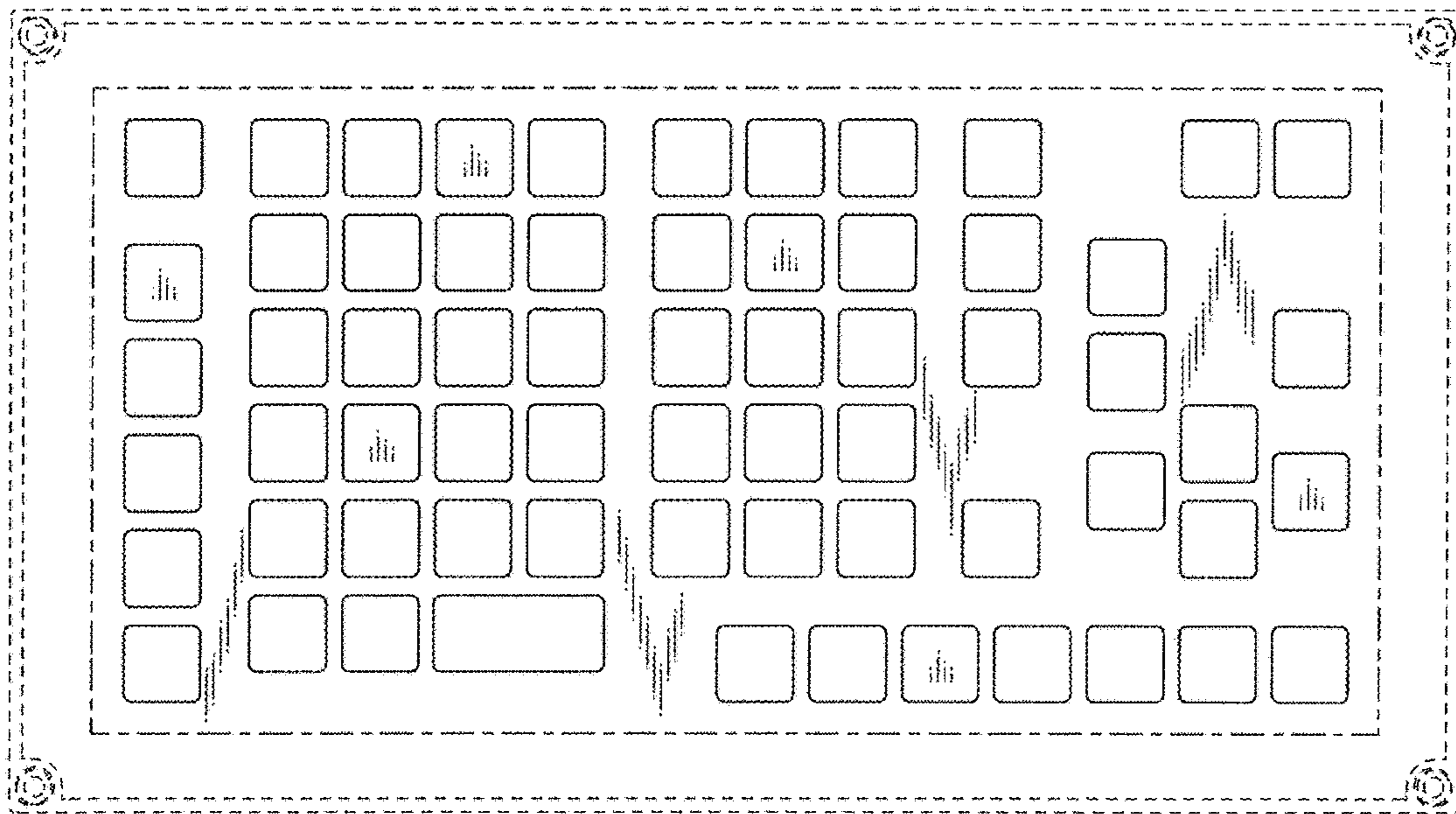

FIG. 2

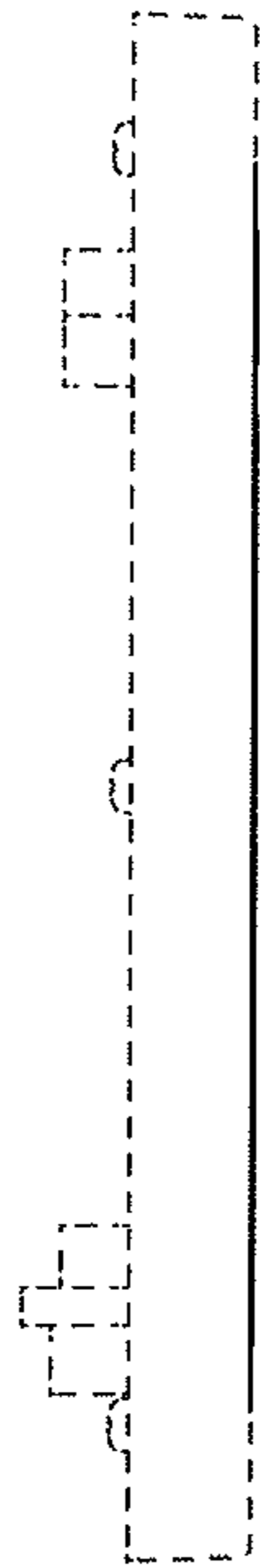

FIG. 3

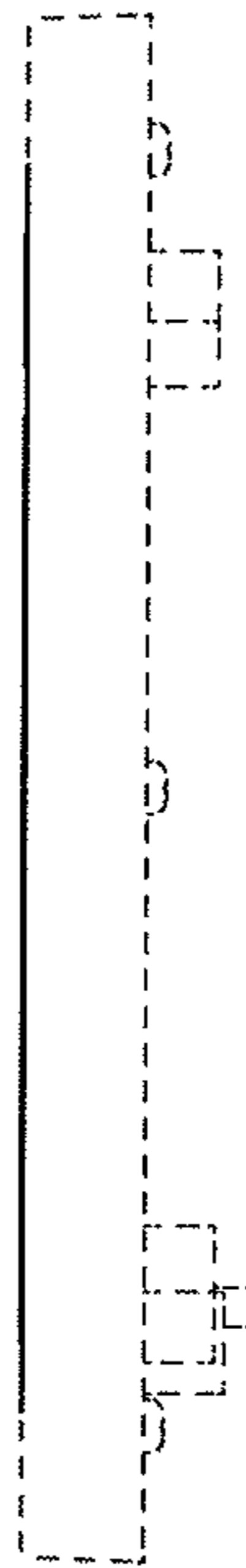

FIG. 4

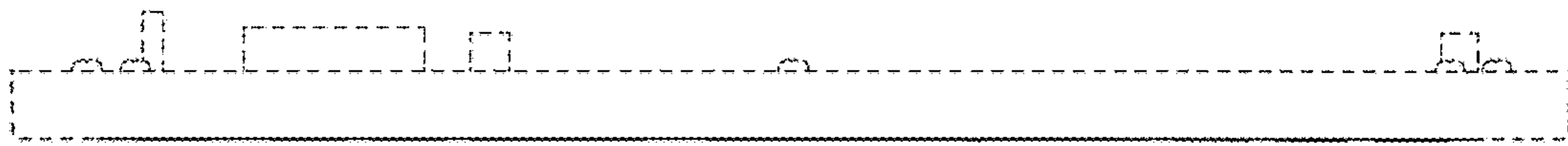

FIG. 5

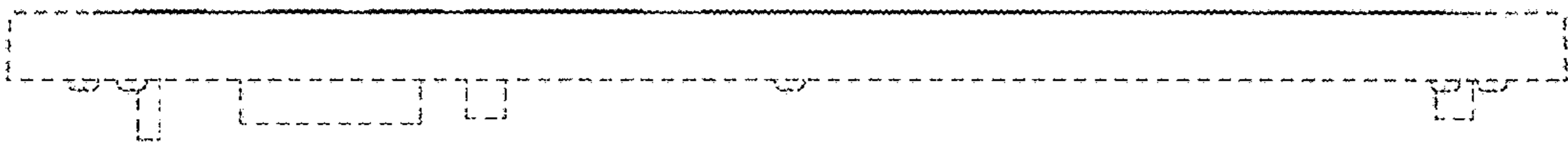

FIG. 6

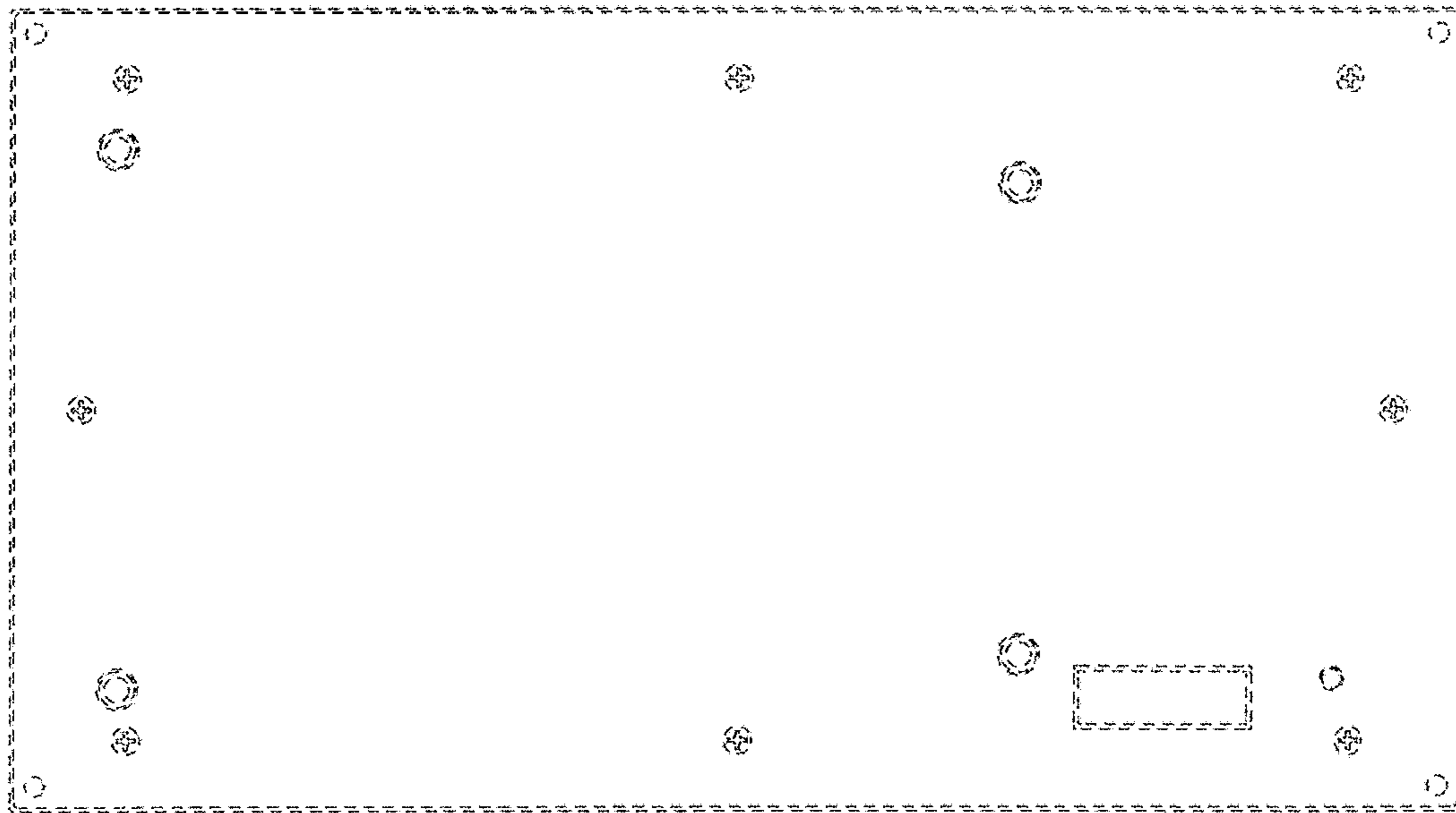

FIG. 7