



US00D807136S

(12) **United States Design Patent**  
**Naksen et al.**

(10) **Patent No.:** **US D807,136 S**  
(45) **Date of Patent:** **\*\* Jan. 9, 2018**

(54) **CORDLESS 12V RECIPROCATING SAW**

(71) Applicant: **INGERSOLL-RAND COMPANY**,  
Davidson, NC (US)

(72) Inventors: **Dennis Naksen**, Summit, NJ (US);  
**Scott David Price**, Lebanon, NJ (US);  
**Joshua O. Johnson**, Allentown, PA  
(US)

(73) Assignee: **Ingersoll-Rand Company**, Davidson,  
NC (US)

(\*\*) Term: **15 Years**

(21) Appl. No.: **29/589,447**

(22) Filed: **Dec. 30, 2016**

(51) **LOC (11) Cl.** ..... **08-03**

(52) **U.S. Cl.**  
USPC ..... **D8/64**

(58) **Field of Classification Search**  
USPC .... D8/69, 68, 67, 66, 65, 64, 62, 61; 30/92,  
30/394, 393, 392, 377, 376, 371; 74/50,  
74/49; 173/217, 216; 83/699.21;  
446/145

CPC ..... B26B 7/00; B23D 51/16; B23D 51/10;  
B25F 5/02

See application file for complete search history.

(56) **References Cited**

**U.S. PATENT DOCUMENTS**

D408,699 S \* 4/1999 Zurwelle ..... D8/64  
D524,130 S \* 7/2006 Wolf ..... D8/64

D591,574 S \* 5/2009 DiPasquale ..... D8/64  
D679,565 S \* 4/2013 Aglassinger ..... D8/64  
D685,242 S \* 7/2013 Vitantonio ..... D8/64  
D705,627 S \* 5/2014 Schoch ..... D8/64  
D752,406 S \* 3/2016 Kanda ..... D8/64  
D790,939 S \* 7/2017 Elder ..... D8/64

\* cited by examiner

*Primary Examiner* — Austin Murphy

(74) *Attorney, Agent, or Firm* — Sunstone IP

(57) **CLAIM**

The ornamental design for a cordless 12V reciprocating saw,  
as shown and described.

**DESCRIPTION**

FIG. 1 is a front perspective view of a reciprocating saw of  
the present invention;  
FIG. 2 is a rear perspective view of the reciprocating saw;  
FIG. 3 is a front elevation view thereof;  
FIG. 4 is a rear elevation view thereof;  
FIG. 5 is a side elevation view thereof;  
FIG. 6 is an opposite side elevation view thereof;  
FIG. 7 is a top plan view thereof; and,  
FIG. 8 is a bottom plan view thereof.  
The broken lines are for illustrative purposes only and form  
no part of the claimed design.

**1 Claim, 7 Drawing Sheets**

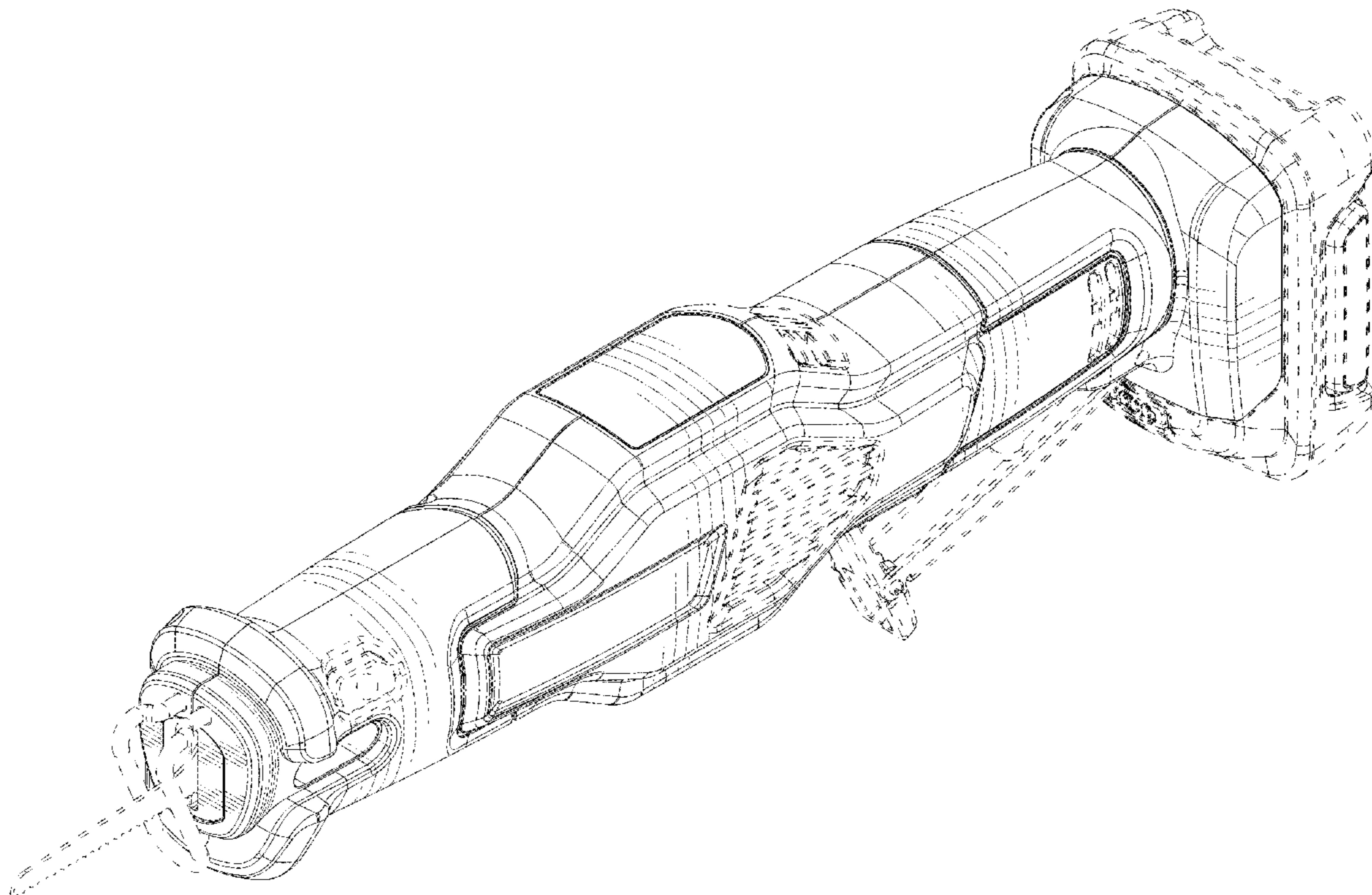

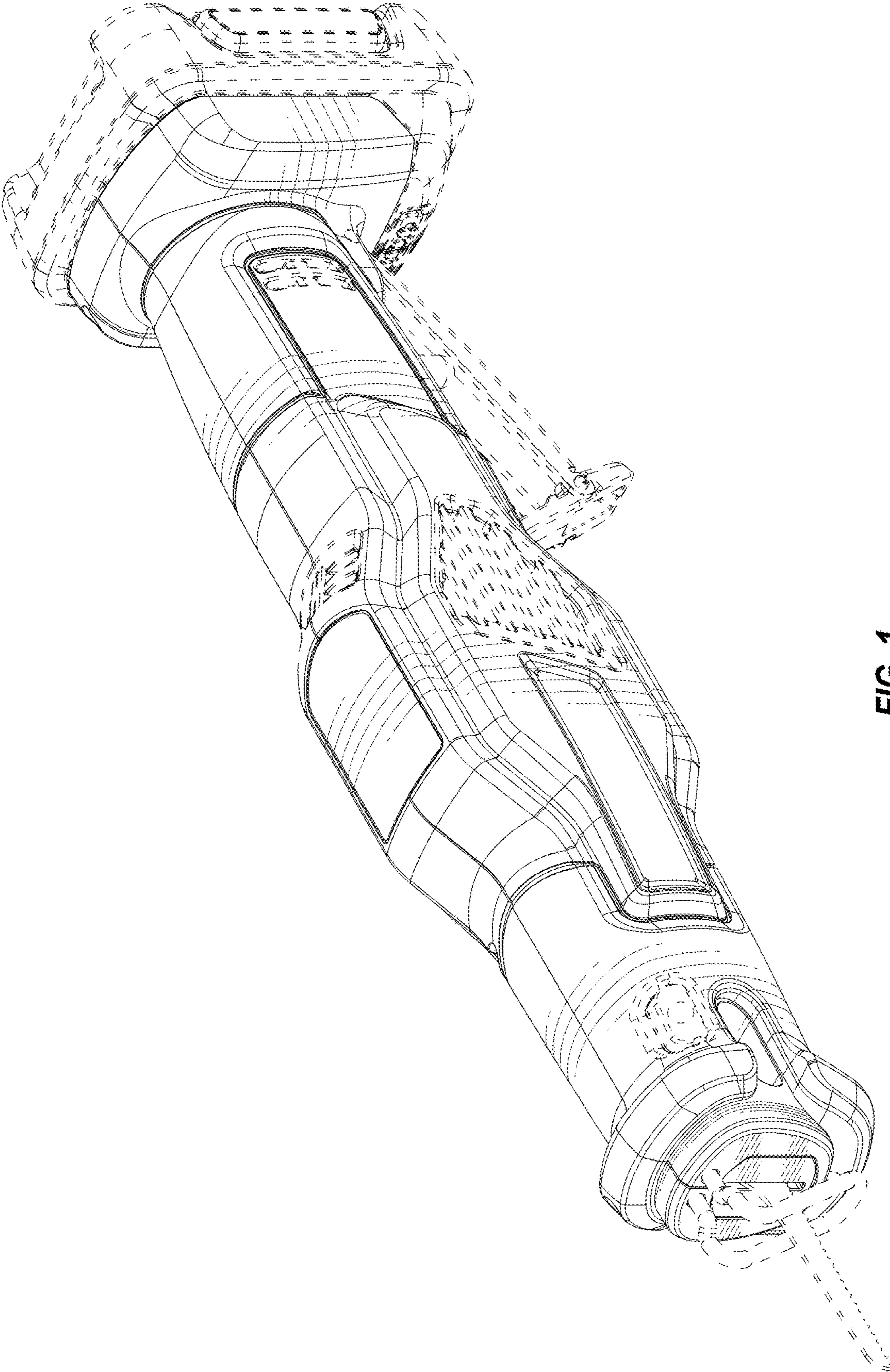

FIG. 1

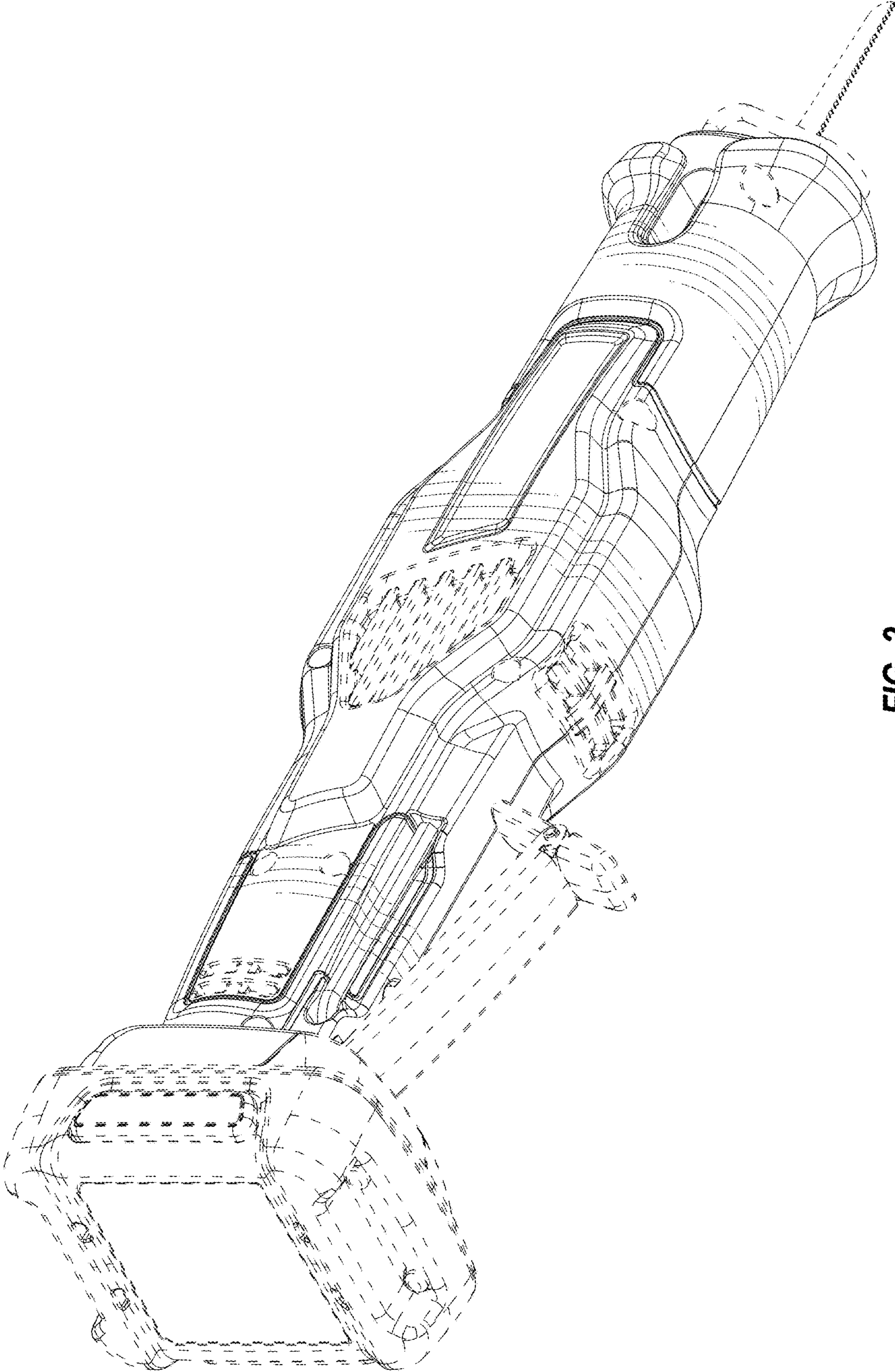

FIG. 2

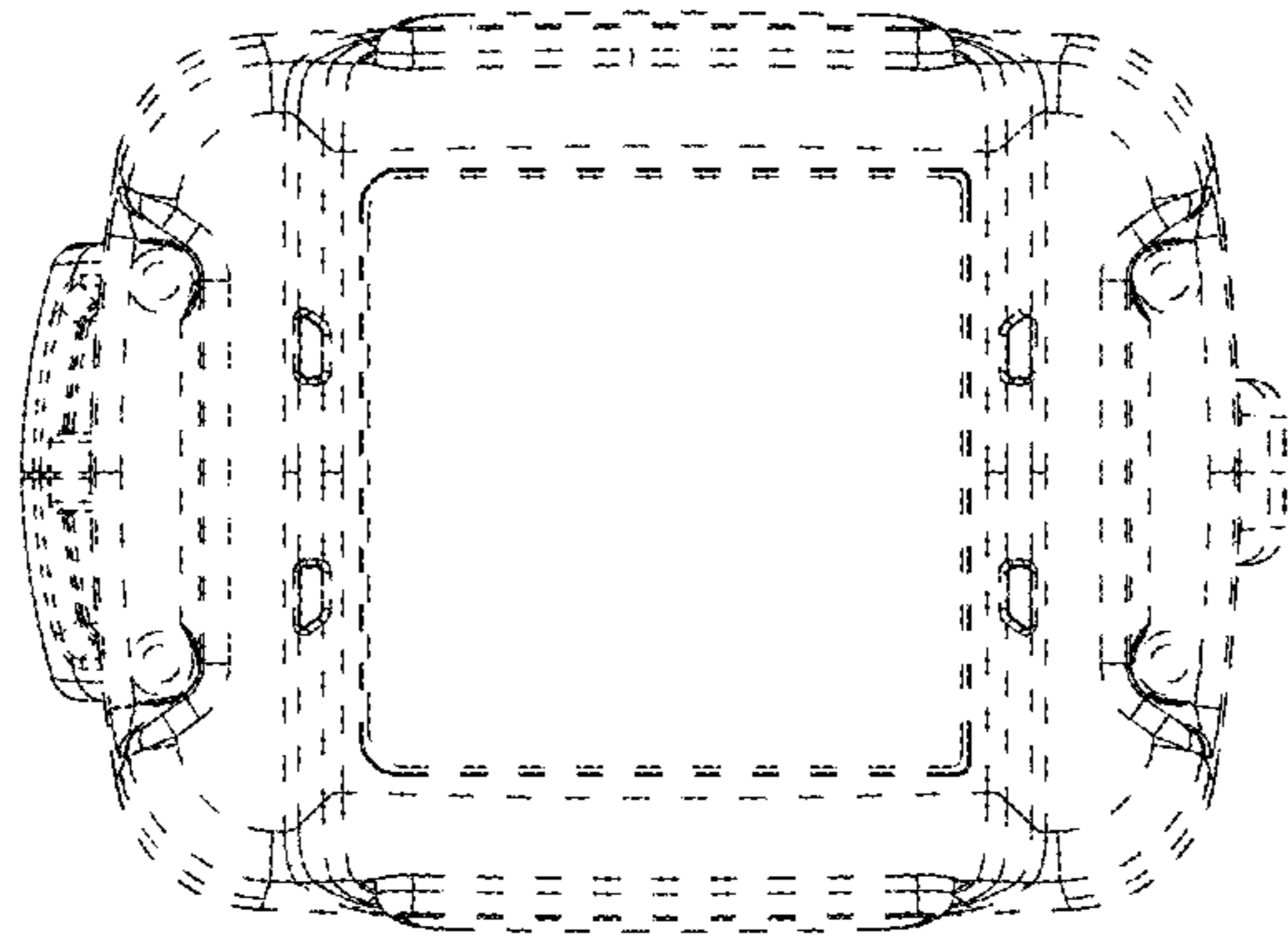

FIG. 4

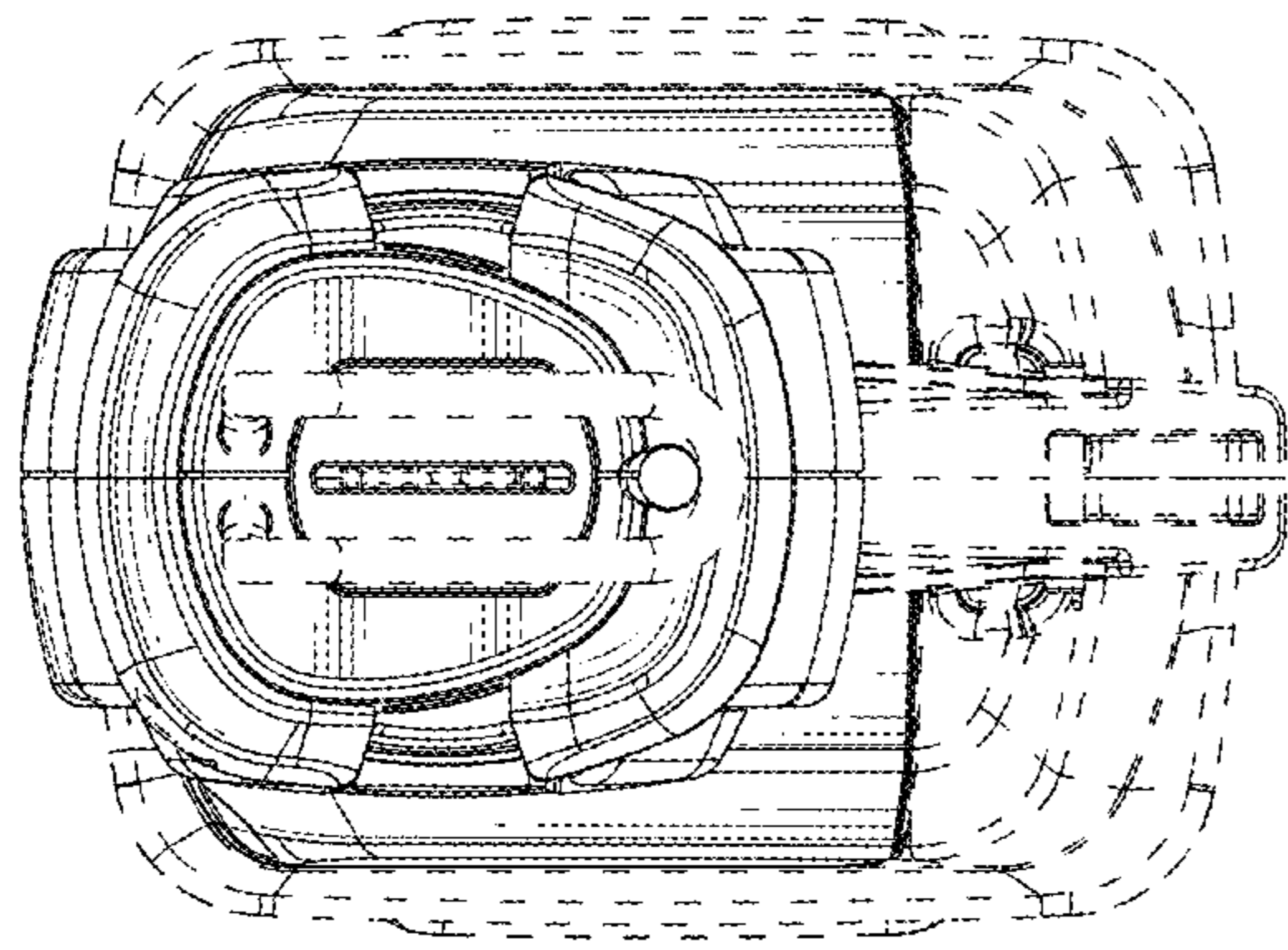

FIG. 3

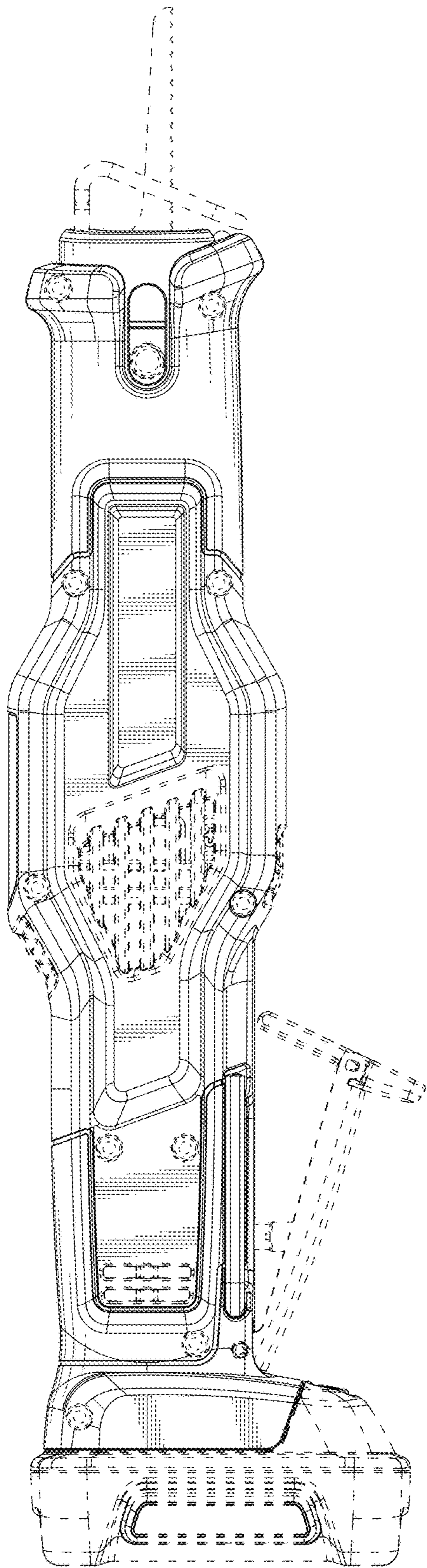

FIG. 5

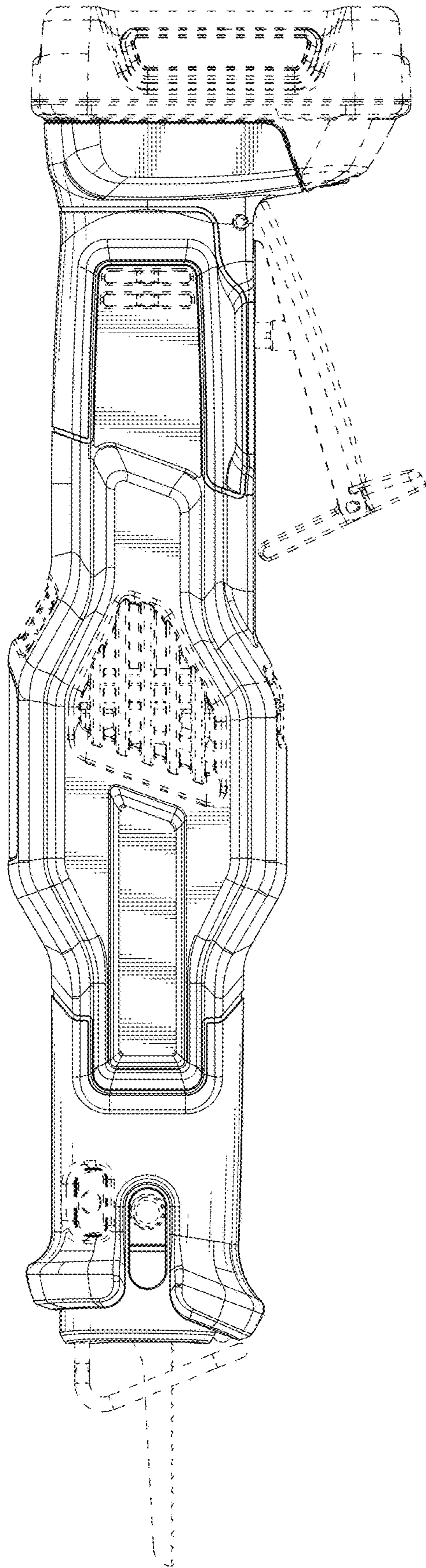

FIG. 6

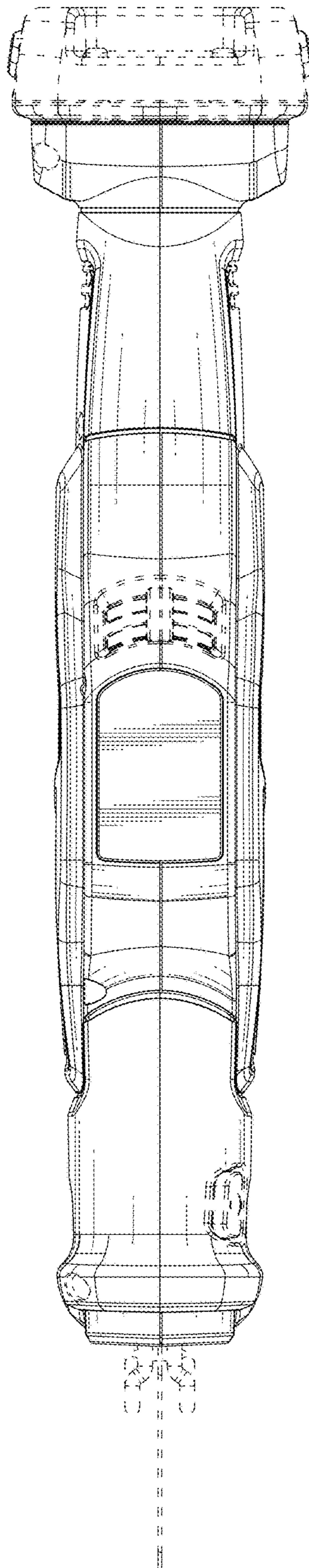

FIG. 7

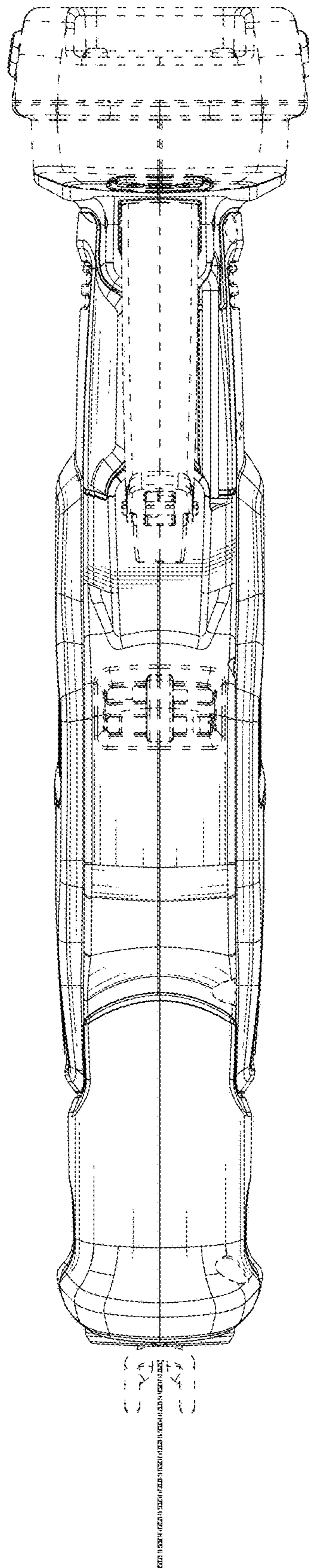

FIG. 8