



US00D806470S

(12) **United States Design Patent**
Hume

(10) **Patent No.:** **US D806,470 S**

(45) **Date of Patent:** **** Jan. 2, 2018**

(54) **BOTTLE CHARM**

(71) Applicant: **True Fabrications, Inc.**, Seattle, WA (US)

(72) Inventor: **Ryan William Hume**, Seattle, WA (US)

(73) Assignee: **TRUE FABRICATIONS, INC.**, Seattle, WA (US)

(**) Term: **15 Years**

(21) Appl. No.: **29/586,262**

(22) Filed: **Dec. 1, 2016**

(51) **LOC (11) Cl.** **07-99**

(52) **U.S. Cl.**

USPC **D7/396.1**; D7/387; D7/213; D16/303

(58) **Field of Classification Search**

USPC D7/392.1, 396.2, 396.3, 396.6, 397, 398, D7/399, 400, 402, 387, 213, 388, 510, D7/511, 507, 624.1, 624.2, 506, 505, 406, D7/708.1, 619.1, 622, 633, 635; D9/435, D9/436, 440, 453, 455, 499, 454, 415, D9/434; 220/200, 703, 592.16, 592.17; D20/22, 23, 24, 26, 27, 28, 29, 43, 32, D20/19, 10, 4; D11/4; D16/311, 303, D16/300, 306; D21/658, 659, 660, 643, D21/644, 420, 385, 386
CPC B65D 41/04; B65D 41/0414; B65D 43/02; B65D 41/56; Y10S 330/903; A47G 19/2288; A47G 2019/2277; A47G 19/2227; G09F 3/00

See application file for complete search history.

(56) **References Cited**

U.S. PATENT DOCUMENTS

2,066,838 A * 1/1937 Kimball A61F 9/027
2/452
D114,994 S * 5/1939 McGlynn D16/303

D230,664 S * 3/1974 Burer D16/311
D328,752 S * 8/1992 Blake D16/303
D367,491 S * 2/1996 Warner D16/311
D416,036 S * 11/1999 Wang D16/307
D472,263 S * 3/2003 Jones D16/303
D583,850 S * 12/2008 Jabali D16/309
D600,115 S * 9/2009 Trayser D9/434
D610,398 S * 2/2010 Bathey D7/387
D683,579 S * 6/2013 Black D7/387
D702,200 S * 4/2014 Teppema D14/126

(Continued)

OTHER PUBLICATIONS

<https://www.amazon.co.uk/GamaGoEA1312GAMAGOGoggles/dp/B00AOJWVUO> Mar. 20, 2013 Beer Goggles.*

Primary Examiner — Marianne Pandozzi

Assistant Examiner — Jae Liang

(74) *Attorney, Agent, or Firm* — Vicky Kaur Bajwa

(57) **CLAIM**

The ornamental design for a bottle charm, as shown and described.

DESCRIPTION

FIG. 1 is an environmental front elevational view of a bottle charm showing my new design;

FIG. 2 is a rear view of the bottle charm of FIG. 1;

FIG. 3 is an environmental left side elevational view of the bottle charm of FIG. 1; the environmental right side elevational view being a mirror image thereof;

FIG. 4 is a top view of the bottle charm of FIG. 1;

FIG. 5 is a bottom plan view of the bottle charm of FIG. 1;

FIG. 6 is a top perspective view of the bottle charm of FIG. 1; and,

FIG. 7 is a bottom perspective view of the bottle charm of FIG. 1.

The broken lines in the drawing depict environmental subject matter only and form no part of the claimed design.

1 Claim, 3 Drawing Sheets

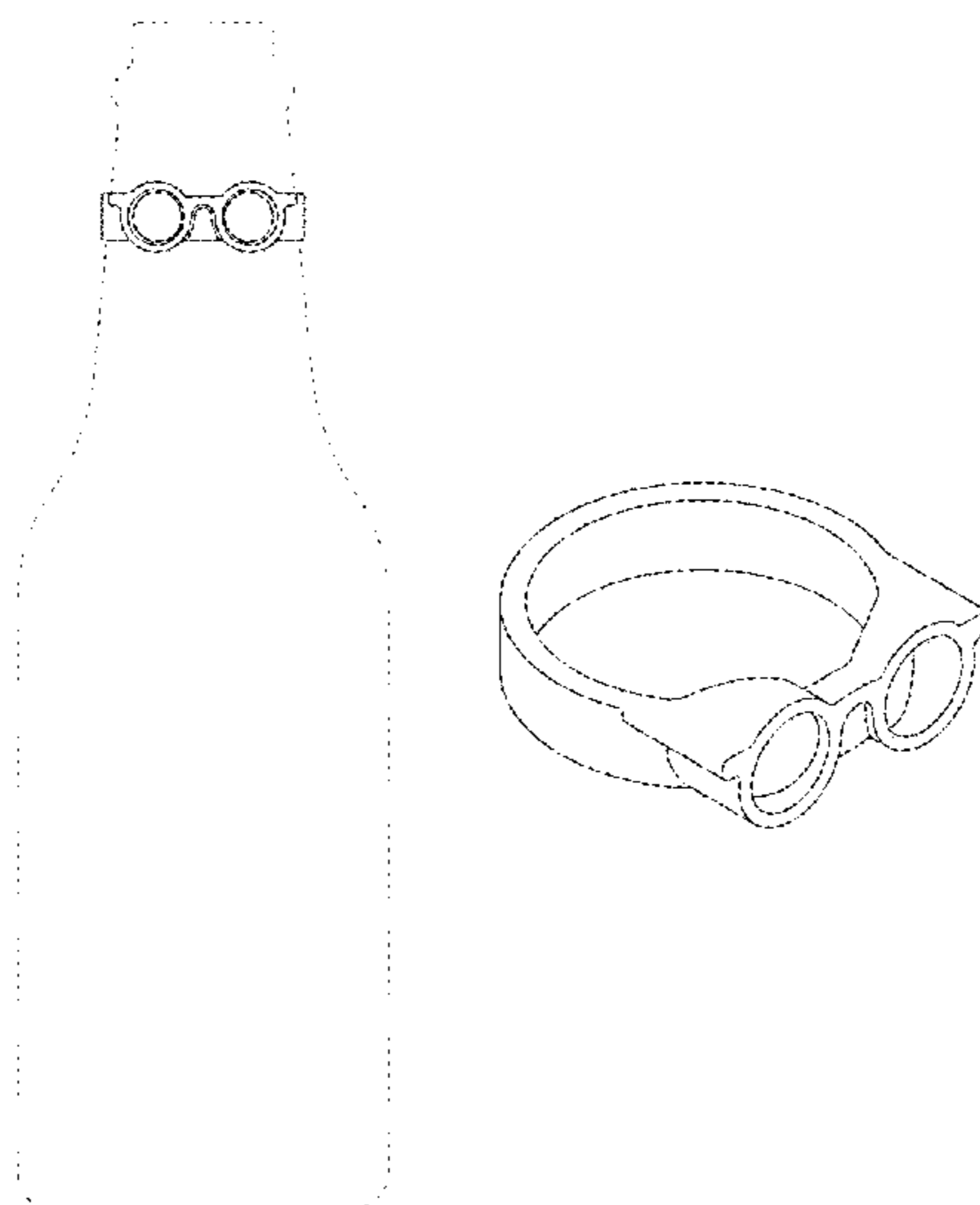

(56)

References Cited

U.S. PATENT DOCUMENTS

D711,762 S *	8/2014	Murphy	D11/4
D711,959 S *	8/2014	Javh	D16/300
D723,611 S *	3/2015	Chiang	D16/303
D733,225 S *	6/2015	Hoeting	D21/659
D739,074 S *	9/2015	Bennett	D27/136
D742,957 S *	11/2015	Johnson-Stewart	D16/300
D753,958 S *	4/2016	Essenberg	D7/624.2
D772,343 S *	11/2016	Ford	D21/385
D781,099 S *	3/2017	Beller	D7/387
D781,100 S *	3/2017	Beller	D7/387
D784,177 S *	4/2017	Kaiser	D11/2

* cited by examiner

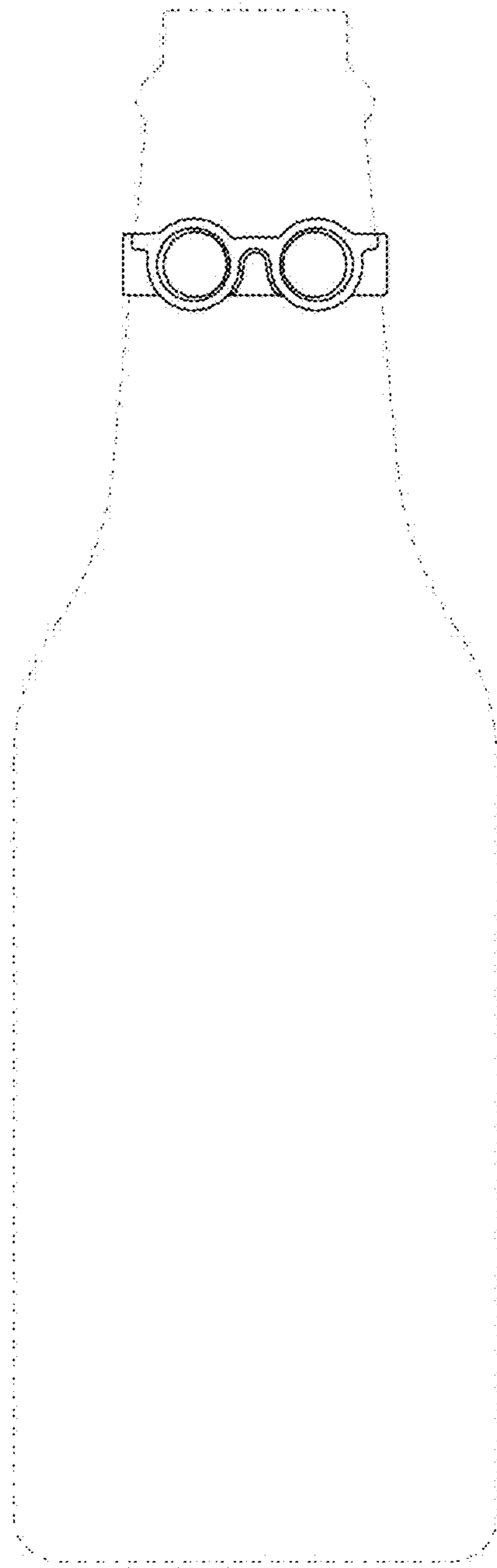

FIG. 1

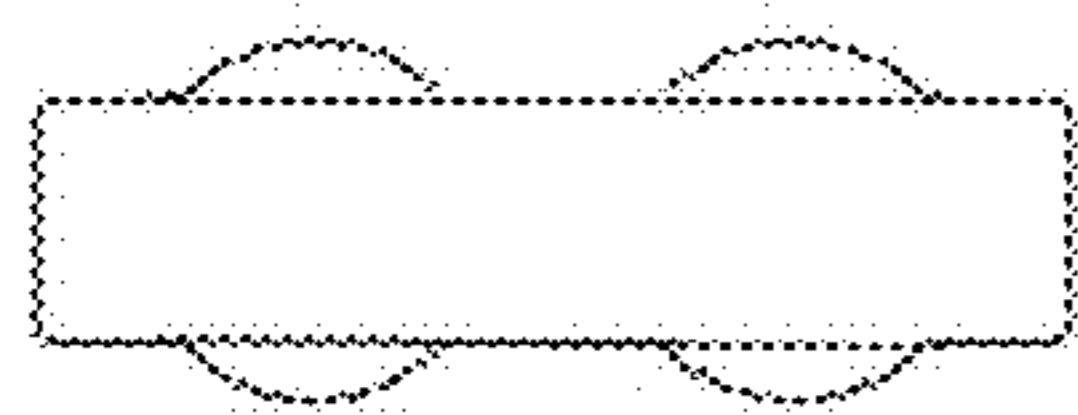

FIG. 2

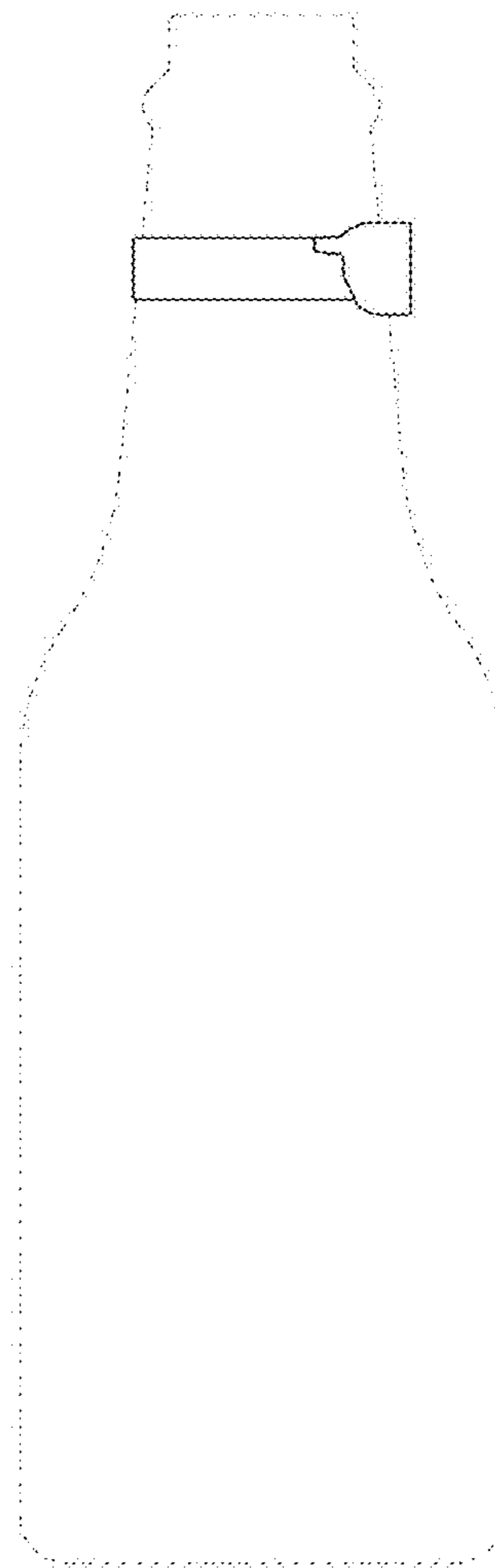

FIG. 3

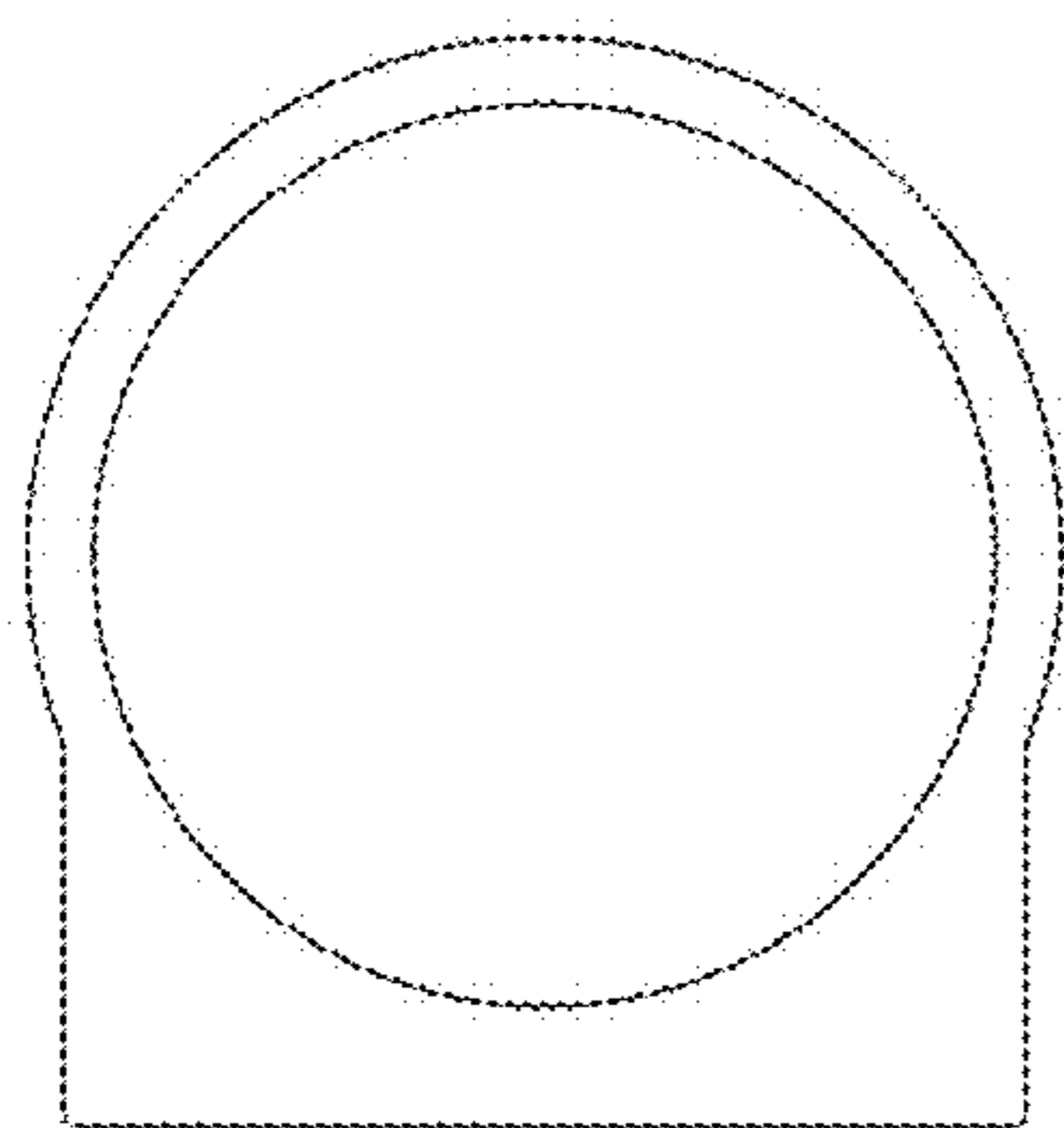

FIG. 4

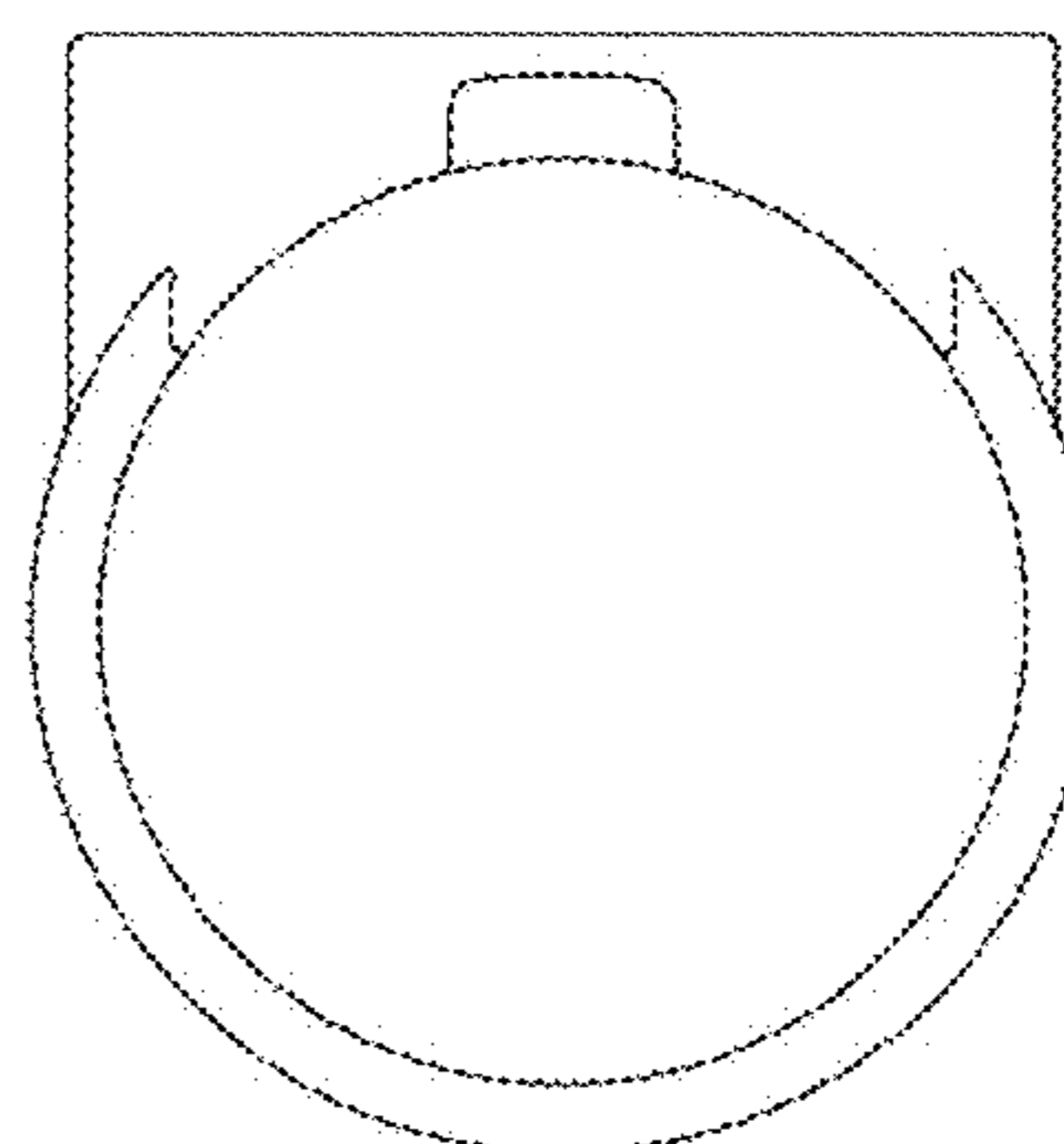

FIG. 5

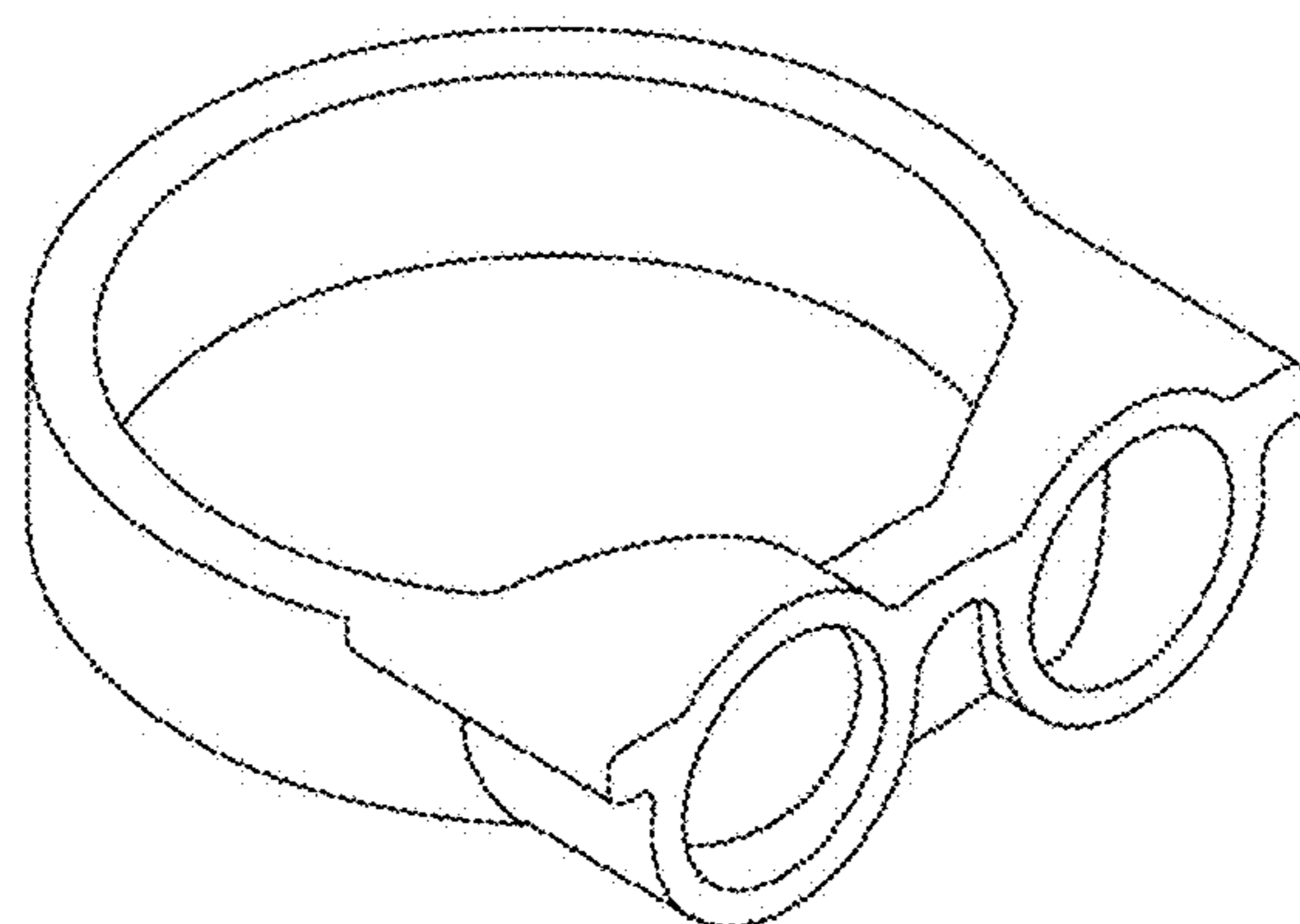

FIG. 6

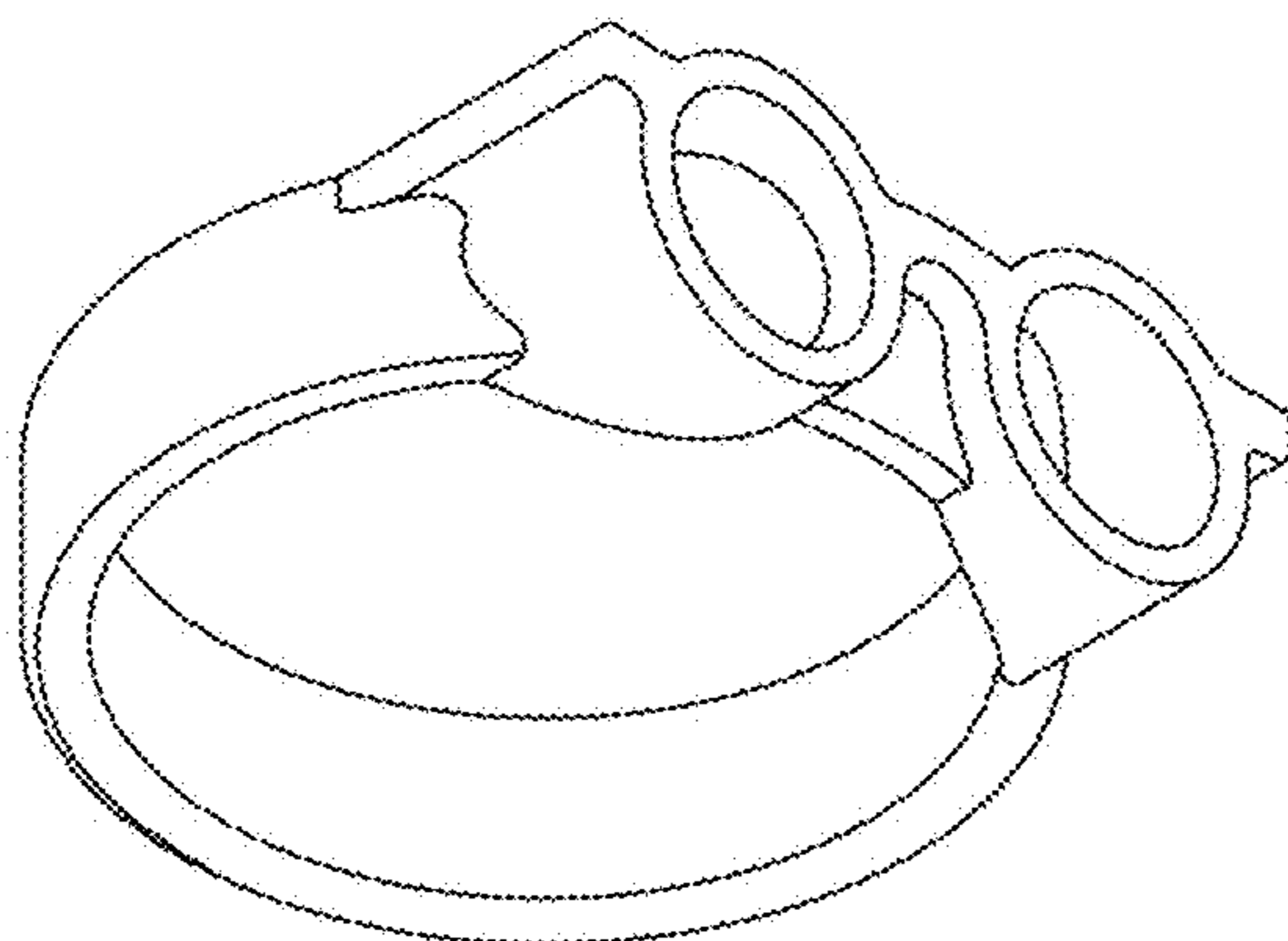

FIG. 7