



US00D805957S

(12) **United States Design Patent** (10) **Patent No.:** **US D805,957 S**
Seo et al. (45) **Date of Patent:** **** Dec. 26, 2017**

(54) **AUTOMOBILE AND/OR TOY REPLICA THEREOF**

(71) Applicant: **Nissan Motor Co., Ltd.**, Yokohama, Kanagawa (JP)

(72) Inventors: **Kuniharu Seo**, Kanagawa (JP); **Hiren Patel**, San Diego, CA (US)

(73) Assignee: **Nissan Motor Co., Ltd.**, Yokohama (JP)

(**) Term: **15 Years**

(21) Appl. No.: **29/568,902**

(22) Filed: **Jun. 22, 2016**

(30) **Foreign Application Priority Data**

Dec. 23, 2015 (JP) 2015-028620

(51) **LOC (10) Cl.** **12-08**

(52) **U.S. Cl.**
USPC **D12/91**

(58) **Field of Classification Search**
USPC D12/86, 90-92, 88; D21/421, 433, 434;
296/181.1, 181.5
CPC B62D 35/00; B62D 25/00; B62D 25/06;
B62D 33/00
See application file for complete search history.

(56) **References Cited**

U.S. PATENT DOCUMENTS

D602,399 S 10/2009 Sakae et al.
D619,500 S 7/2010 Hsu et al.
D619,502 S 7/2010 Cha
D630,131 S 1/2011 Dyson
D630,132 S 1/2011 Jang
D638,752 S 5/2011 Date et al.
D647,820 S 11/2011 Jang
D647,821 S 11/2011 Bischoff et al.

D678,820 S * 3/2013 Song D12/91
D684,092 S 6/2013 Lee
D686,532 S * 7/2013 Lamm D12/91
D689,399 S 9/2013 Kim et al.
D706,170 S 6/2014 Girard et al.
D706,171 S 6/2014 Bischoff et al.
D718,187 S * 11/2014 Hou D12/91
D728,423 S * 5/2015 Rupa D12/91
D731,922 S 6/2015 Beaven

(Continued)

FOREIGN PATENT DOCUMENTS

JP D1433224 S 2/2012
JP D1433372 S 2/2012

(Continued)

Primary Examiner — Melody N Brown

(74) *Attorney, Agent, or Firm* — Global IP Counselors, LLP

(57) **CLAIM**

The ornamental design for an automobile and/or toy replica thereof, as shown and described.

DESCRIPTION

FIG. 1 is a front elevational view of an automobile and/or replica thereof showing our new design;
FIG. 2 is a top plan view thereof;
FIG. 3 is a left side elevational view thereof;
FIG. 4 is a right side elevational view thereof;
FIG. 5 is a front and left side perspective view thereof;
FIG. 6 is a rear and right side perspective view thereof; and,
FIG. 7 is a rear elevational view thereof.

The hidden surfaces from the bottom, obscured by a rear bumper, the wheels, and inside the wheel wells, but visible in the figures form no part of the claimed design. The broken line showings on the automobile and/or toy replica thereof is for the purpose of illustrating environmental structure and form no part of the claimed design.

1 Claim, 7 Drawing Sheets

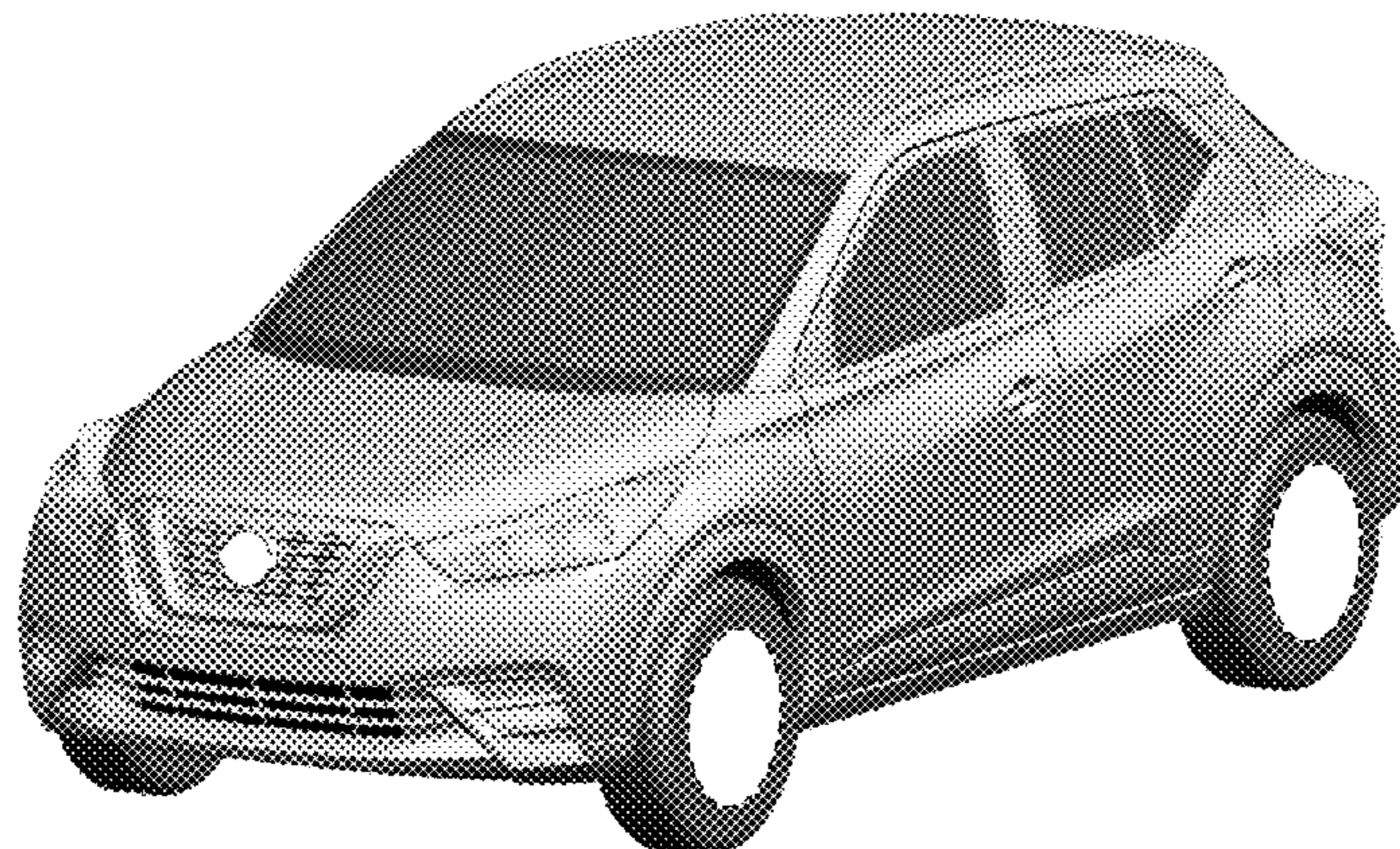

(56)

References Cited

U.S. PATENT DOCUMENTS

D732,433 S * 6/2015 Aengenheyster D12/91
D735,611 S * 8/2015 Aengenheyster D12/91
D736,119 S * 8/2015 Kaoud D12/91
D739,305 S 9/2015 Gunnarson et al.
D741,752 S * 10/2015 Messale D12/91
D759,540 S * 6/2016 Davidson D12/91

FOREIGN PATENT DOCUMENTS

JP D1478991 S 9/2014
JP D1517215 S 2/2015
JP D1501258 S 6/2015
JP D1475952 S 7/2015
JP D1550786 S 6/2016
JP D1554579 S 7/2016
JP D1567581 S 1/2017
JP D1568234 S 1/2017

* cited by examiner

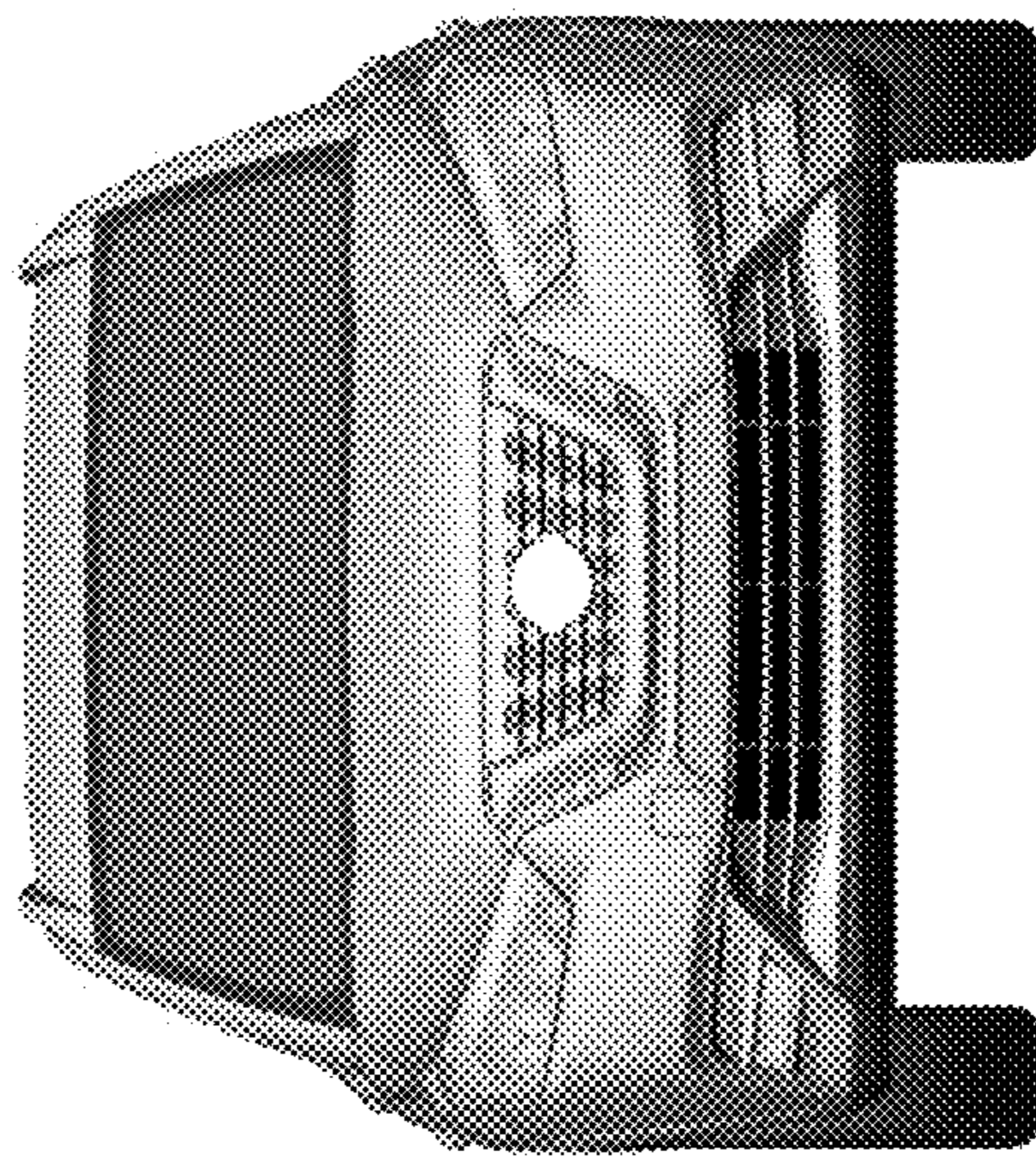

FIG. 1

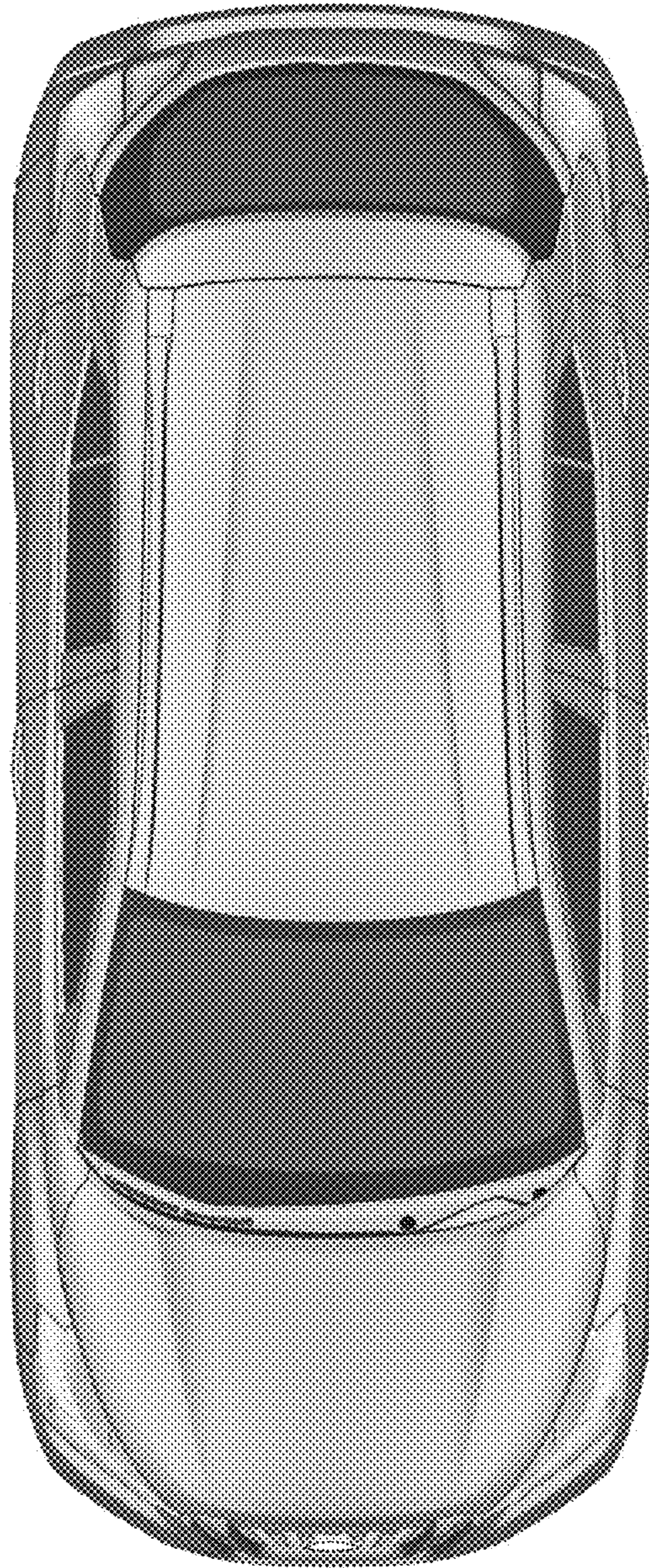

FIG. 2

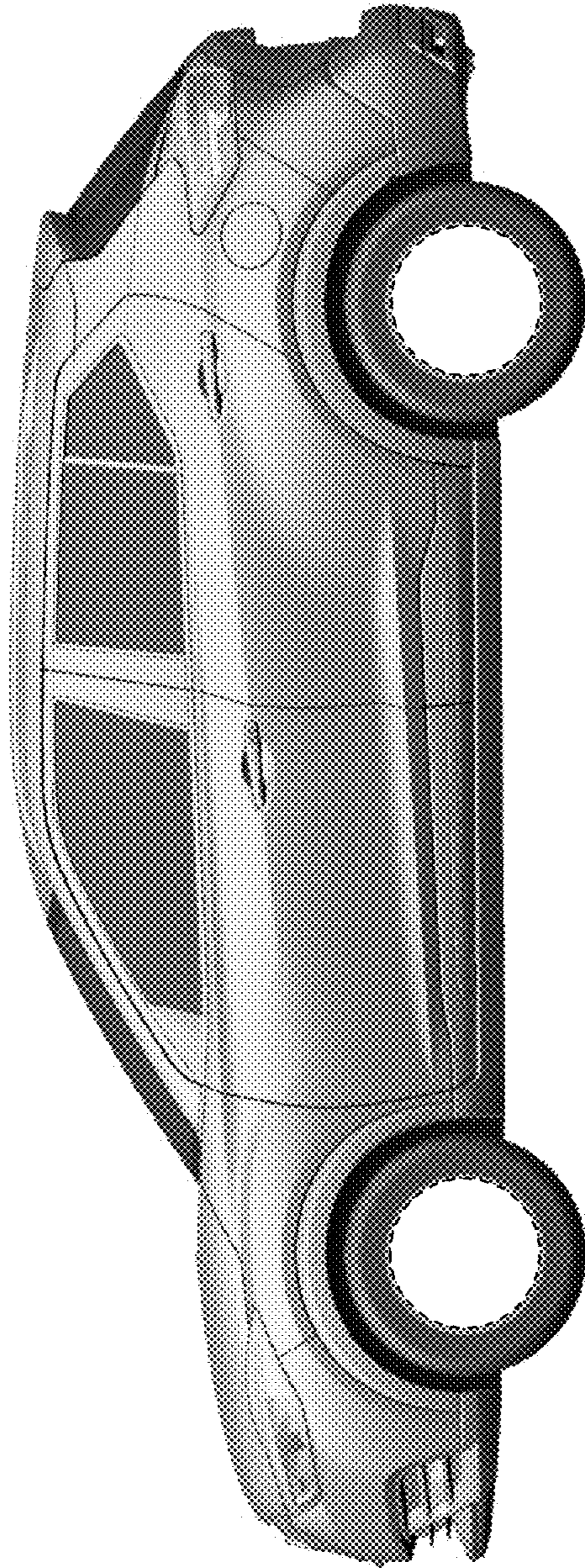

FIG. 3

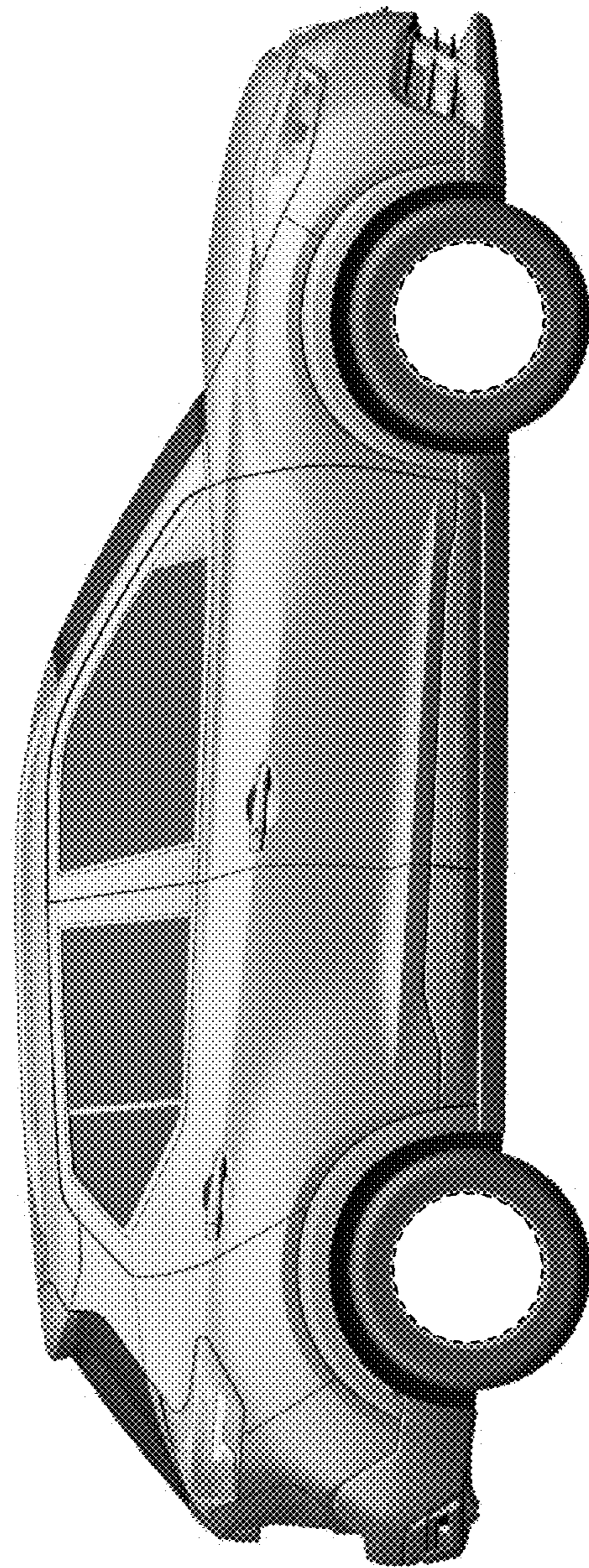

FIG. 4

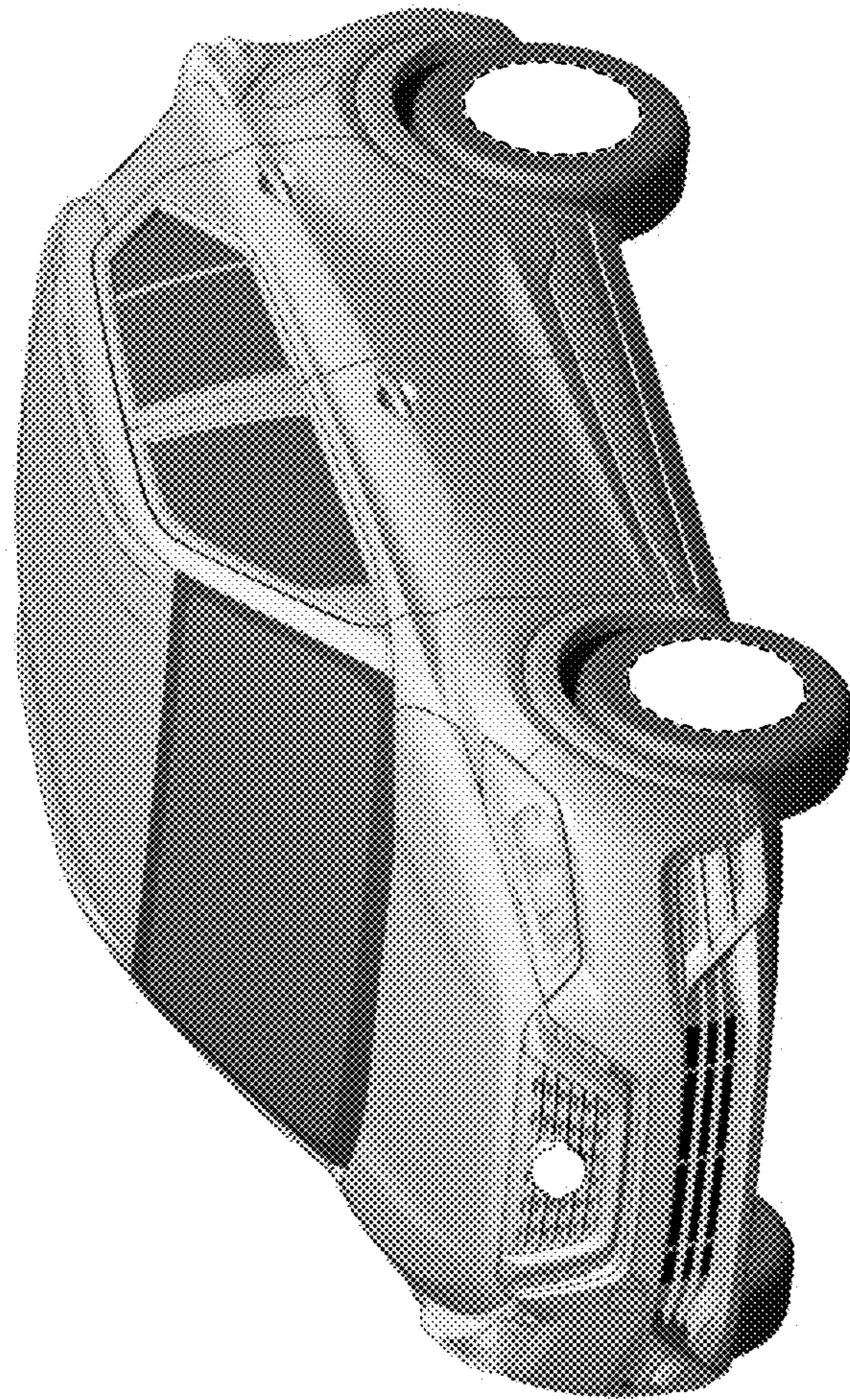

FIG. 5

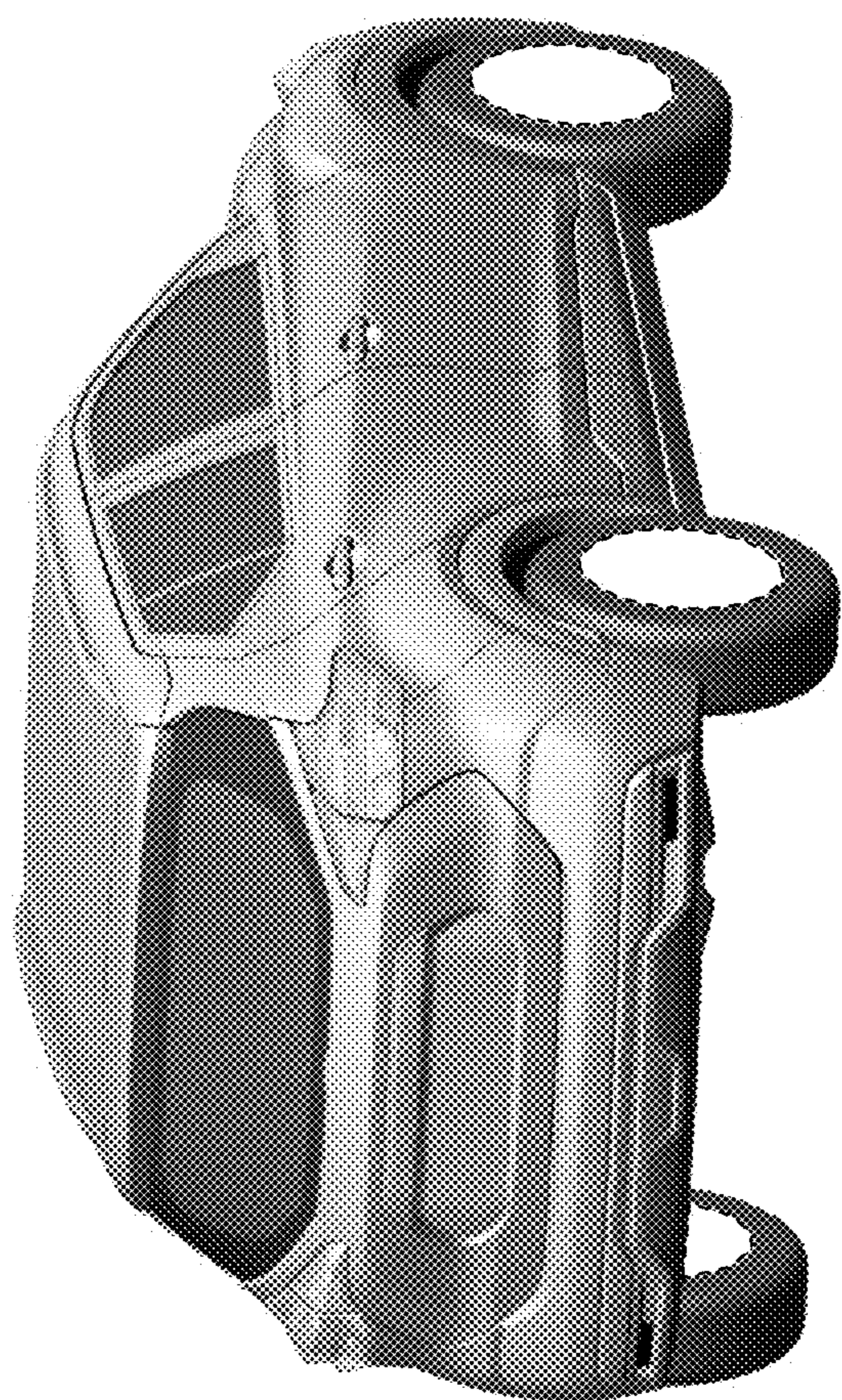

FIG. 6

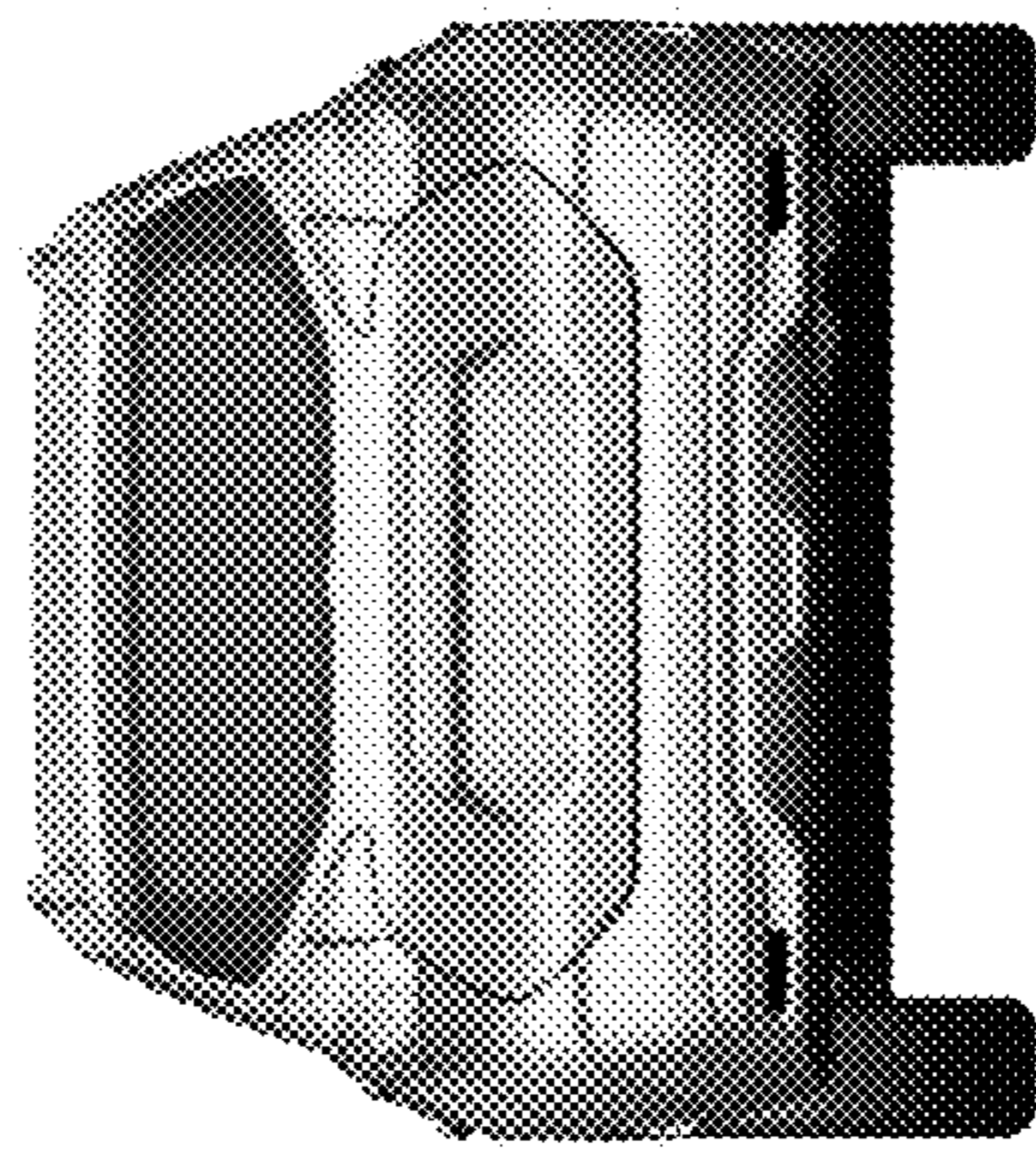

FIG. 7