



US00D803420S

(12) **United States Design Patent** (10) **Patent No.:** **US D803,420 S**
Walsh (45) **Date of Patent:** **** Nov. 21, 2017**

- (54) **LITE FOR DOORS AND ENTRYWAYS**
- (71) Applicant: **Masonite Corporation**, Tampa, FL (US)
- (72) Inventor: **Jason Walsh**, Batavia, IL (US)
- (73) Assignee: **Masonite Corporation**, Tampa, FL (US)
- (**) Term: **15 Years**
- (21) Appl. No.: **29/560,973**
- (22) Filed: **Apr. 12, 2016**
- Related U.S. Application Data**
- (60) Continuation of application No. 29/491,968, filed on May 27, 2014, now Pat. No. Des. 753,846, which is a division of application No. 29/434,039, filed on Oct. 9, 2012, now Pat. No. Des. 705,950, which is a division of application No. 29/409,476, filed on Dec. 23, 2011, now Pat. No. Des. 668,791.
- (51) **LOC (10) Cl.** **25-01**
- (52) **U.S. Cl.**
USPC **D25/103**
- (58) **Field of Classification Search**
USPC D25/48.3, 48.7, 103, 106, 109-111;
49/DIG. 2, 501, 504; 52/171.3, 204.59,
52/306, 311.2, 455, 456, 458, 474, 475.1,
52/630, 656.4, 764, 778, 779, 782.1,
52/784.1; 428/13, 34, 38, 426
See application file for complete search history.

- (56) **References Cited**
U.S. PATENT DOCUMENTS

286,434 A 10/1883 Herzog
D37,803 S 1/1906 Shurman

D41,286 S	4/1911	McQuinn	
1,612,054 A	12/1926	Rez	
1,678,439 A	7/1928	Le Roy	
2,450,127 A	9/1948	Gardener	
4,619,850 A	10/1986	Charlton	
D336,139 S	6/1993	Wilkening et al.	
D380,839 S *	7/1997	Lint	D25/103
D383,221 S *	9/1997	Lint	D25/103
D402,047 S	12/1998	Sadovenko	
6,185,883 B1	2/2001	Howard	
D478,674 S	8/2003	Lamberts	
D482,132 S	11/2003	Alexander	
D488,565 S	4/2004	Bresciani	
6,736,534 B1	5/2004	Fite	
D490,909 S	6/2004	Barnard	
D559,409 S	1/2008	McCarthy	
D627,083 S	11/2010	Walsh et al.	
D631,173 S *	1/2011	Hu	D25/103
D631,174 S *	1/2011	Hu	D25/103
D664,676 S *	7/2012	Walsh	D25/103
D668,790 S	10/2012	Walsh	

(Continued)

Primary Examiner — Susan Bennett Hattan
Assistant Examiner — Leanne Was-Englehart
(74) *Attorney, Agent, or Firm* — Berenato & White, LLC

(57) **CLAIM**
The ornamental design for a lite for doors and entryways, as shown and described.

DESCRIPTION
FIG. 1 is a front elevational view of my design; and, FIG. 2 is a front elevational view of a second embodiment. The rear elevational view of each of FIGS. 1 and 2 is a mirror image thereof. The stippling in FIG. 2 represents a contrast in appearance. The broken lines in the drawings depict environment that forms no part of the claimed design.

1 Claim, 2 Drawing Sheets

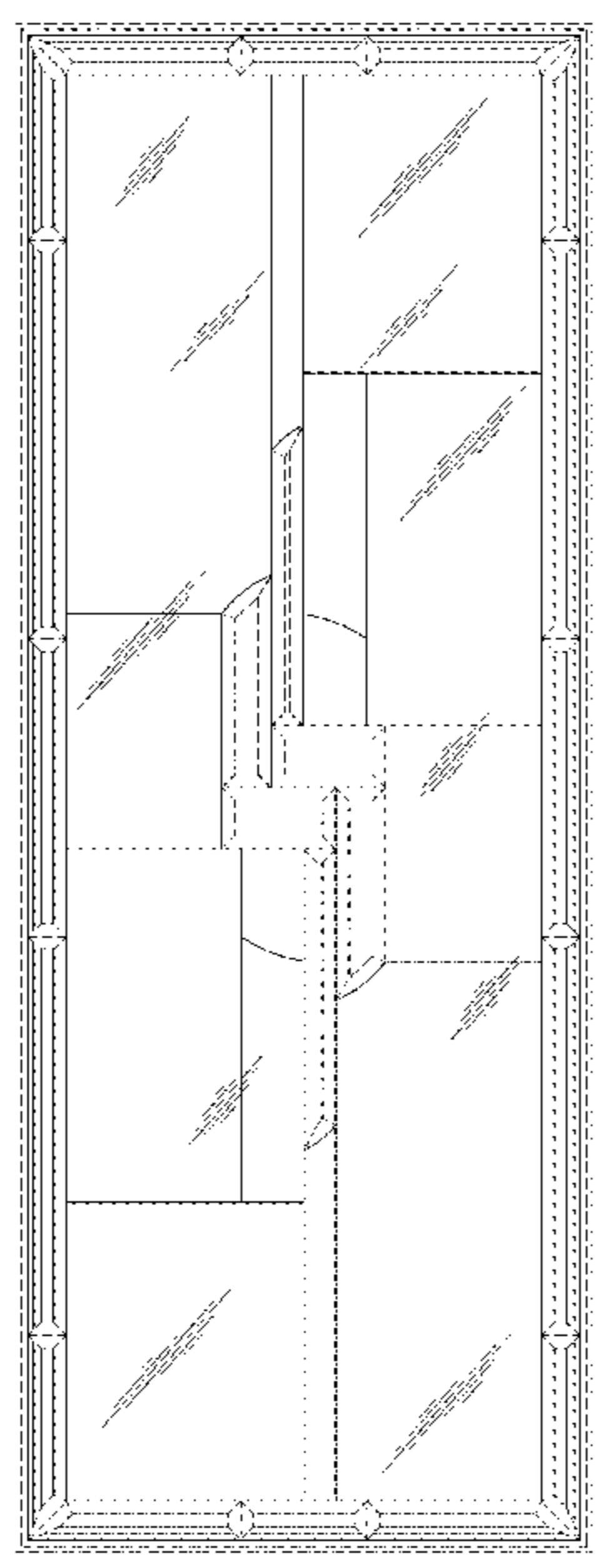

(56)

References Cited

U.S. PATENT DOCUMENTS

D668,791	S	*	10/2012	Walsh	D25/111
D669,196	S	*	10/2012	Walsh	D25/111
D670,005	S	*	10/2012	Walsh	D25/103
D692,164	S	*	10/2013	Walsh	D25/103
D692,584	S	*	10/2013	Walsh	D25/103
D694,429	S	*	11/2013	Walsh	D25/103
D694,430	S	*	11/2013	Walsh	D25/110
D705,451	S	*	5/2014	Hu	D25/103
D705,950	S	*	5/2014	Walsh	D25/110
D706,954	S	*	6/2014	Walsh	D25/103
D739,040	S	*	9/2015	Ege	D25/103
D751,219	S	*	3/2016	Walsh	D25/103
D751,220	S	*	3/2016	Walsh	D25/103
D753,846	S	*	4/2016	Walsh	D25/111
D765,878	S	*	9/2016	Walsh	D25/103
2006/0000173	A1		1/2006	Edstrom		
2006/0046017	A1		3/2006	Adickes		

* cited by examiner

FIG. 1

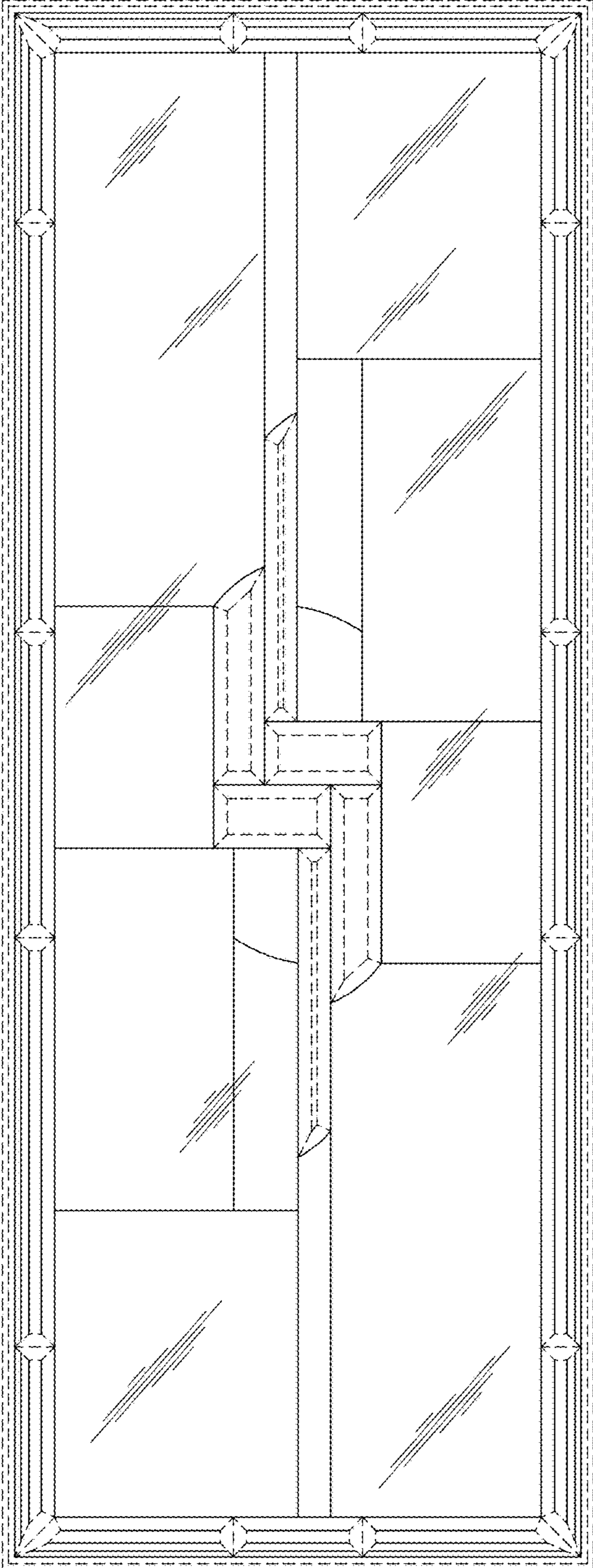

FIG. 2

