



US00D802245S

(12) **United States Design Patent**
Marshall

(10) **Patent No.:** **US D802,245 S**

(45) **Date of Patent:** **** Nov. 7, 2017**

(54) **LOADING RAMP**

(71) Applicant: **MARSHALL INDUSTRIAL INC.,**
Ajax (CA)

(72) Inventor: **Bob Marshall,** Ajax (CA)

(**) Term: **15 Years**

(21) Appl. No.: **29/570,299**

(22) Filed: **Jul. 7, 2016**

(30) **Foreign Application Priority Data**

Jun. 17, 2016 (CA) 169090

(51) **LOC (10) Cl.** **12-05**

(52) **U.S. Cl.**
USPC **D34/32**

(58) **Field of Classification Search**

USPC D34/28, 32, 35; 254/88, 124; 193/38,
193/41; 414/537, 495, 678, 546, 541,
414/523; 14/71.1, 69.5, 71.3, 71.7, 71.5;
187/222, 245

CPC B65G 69/30; B65G 69/28; B60P 1/435;
B60P 1/43; B60P 1/431; B60P 1/436;
A61G 3/061; B66F 7/243

See application file for complete search history.

(56) **References Cited**

U.S. PATENT DOCUMENTS

- | | | | | | |
|--------------|------|--------|---------------|-------|------------|
| 4,372,727 | A * | 2/1983 | Fredrickson | | B60P 1/433 |
| | | | | | 414/537 |
| 6,179,545 | B1 * | 1/2001 | Petersen, Jr. | | A61G 3/061 |
| | | | | | 14/71.7 |
| D543,675 | S * | 5/2007 | Ji | | D34/32 |
| D596,368 | S * | 7/2009 | Holicki | | D34/32 |
| 7,870,629 | B2 * | 1/2011 | Setzer, Jr. | | B65G 69/30 |
| | | | | | 14/69.5 |
| D640,854 | S * | 6/2011 | Leum | | D34/32 |
| D706,513 | S * | 6/2014 | LaBarbera | | D34/32 |
| D712,112 | S * | 8/2014 | Leum | | D34/32 |
| 2013/0094931 | A1 * | 4/2013 | Bluhm | | B60P 1/431 |
| | | | | | 414/523 |

OTHER PUBLICATIONS

Youtube "LD5000 Adapt a Ramp", www.youtube.com. Jan. 15, 2016. shown in p. 1, Item # LD5000.*

Marshall Industrial Inc. "LD5000 Adapt a Ramp", https://www.portablemobileloadingramps.com/. Apr. 10, 2017. shown in p. 1, Item # LD5000.*

* cited by examiner

Primary Examiner — Cynthia Ramirez

Assistant Examiner — Michael Maharajh

(57) **CLAIM**

I claim the ornamental design for a loading ramp, as shown and described.

DESCRIPTION

FIG. 1 is a perspective rear, top and right side view of a loading ramp showing my new design;

FIG. 2 is a right side elevational view of the loading ramp of FIG. 1;

FIG. 3 is a left side elevational view of the loading ramp shown in FIG. 1;

FIG. 4 is a top plan view of the loading ramp shown in FIG. 1;

FIG. 5 is a front elevational view of the loading ramp shown in FIG. 1;

FIG. 6 is a rear elevational view of the loading ramp shown in FIG. 1;

FIG. 7 is a bottom plan view of the loading ramp shown in FIG. 1; and,

FIG. 8 is a perspective rear, top and right side view of the loading ramp shown in FIG. 1, with a lip plate of the loading ramp shown in a raised position.

The broken lines depict portions of a loading ramp which form no part of the claimed design.

1 Claim, 7 Drawing Sheets

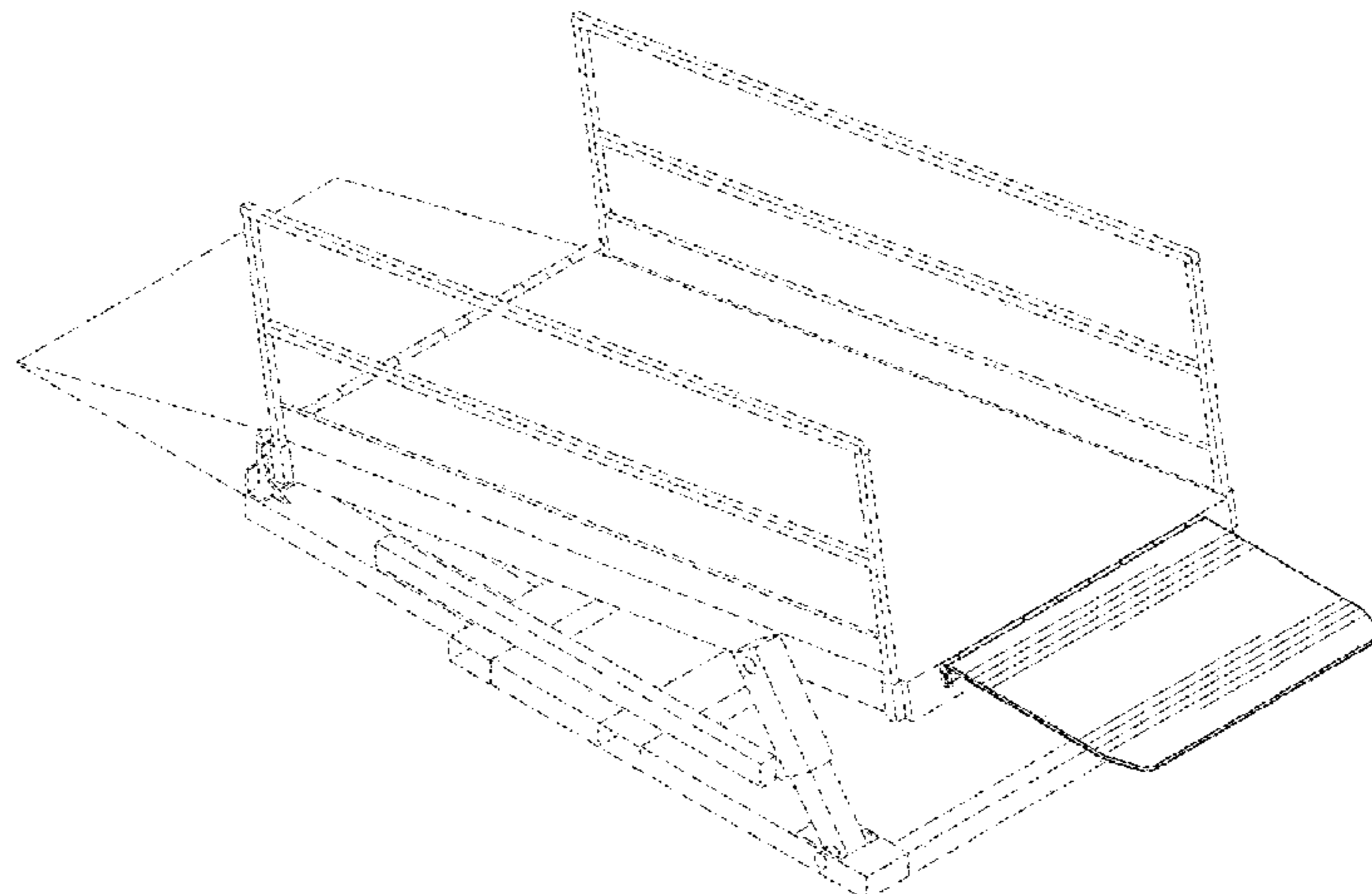

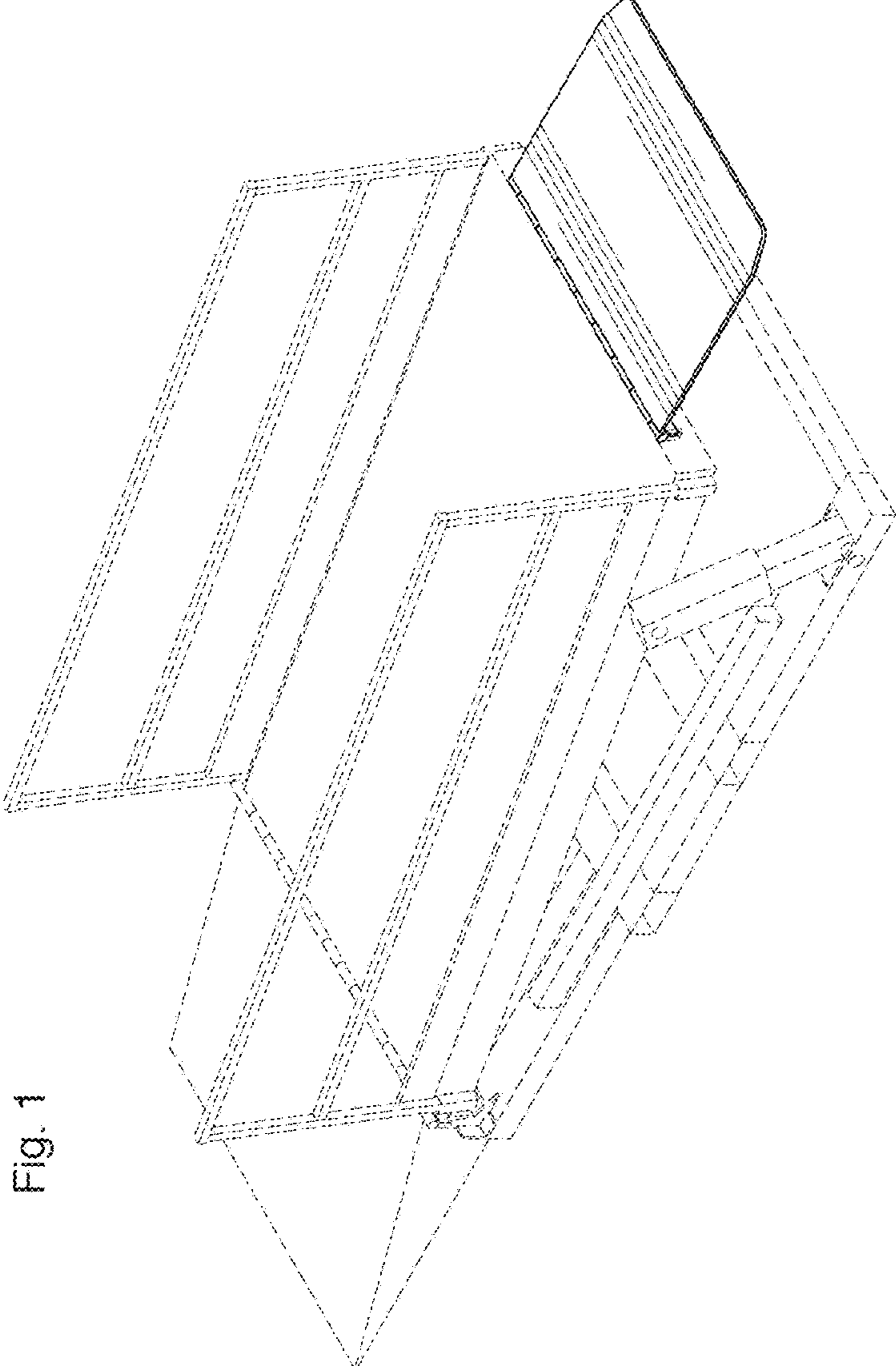

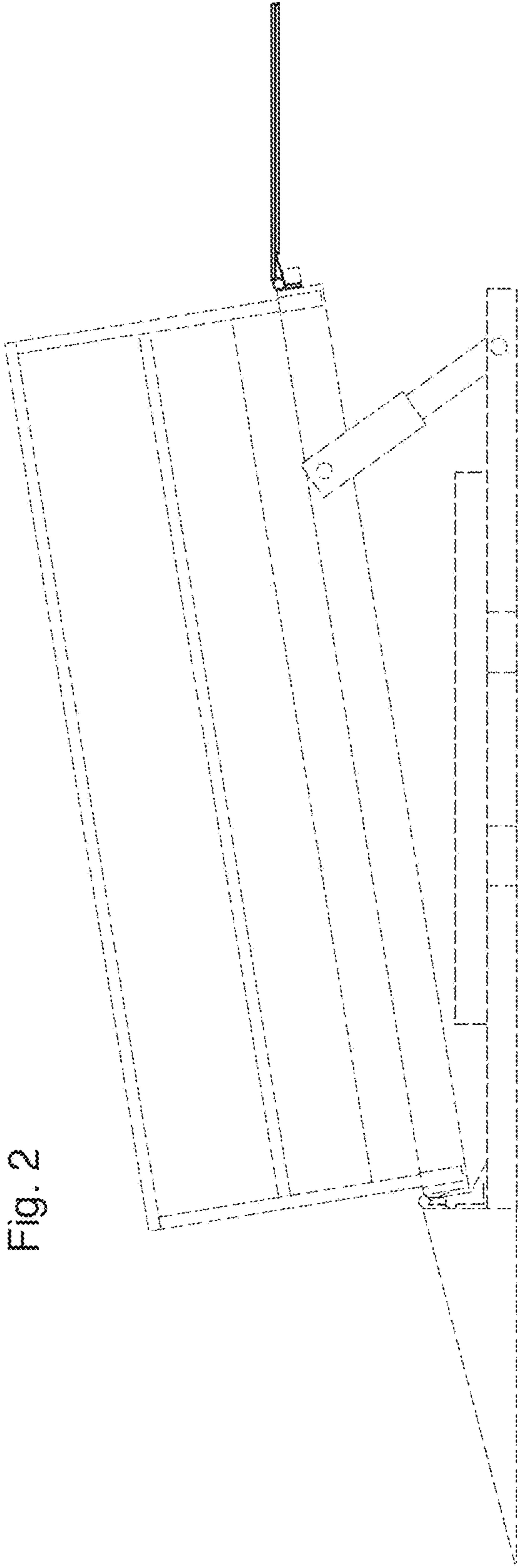
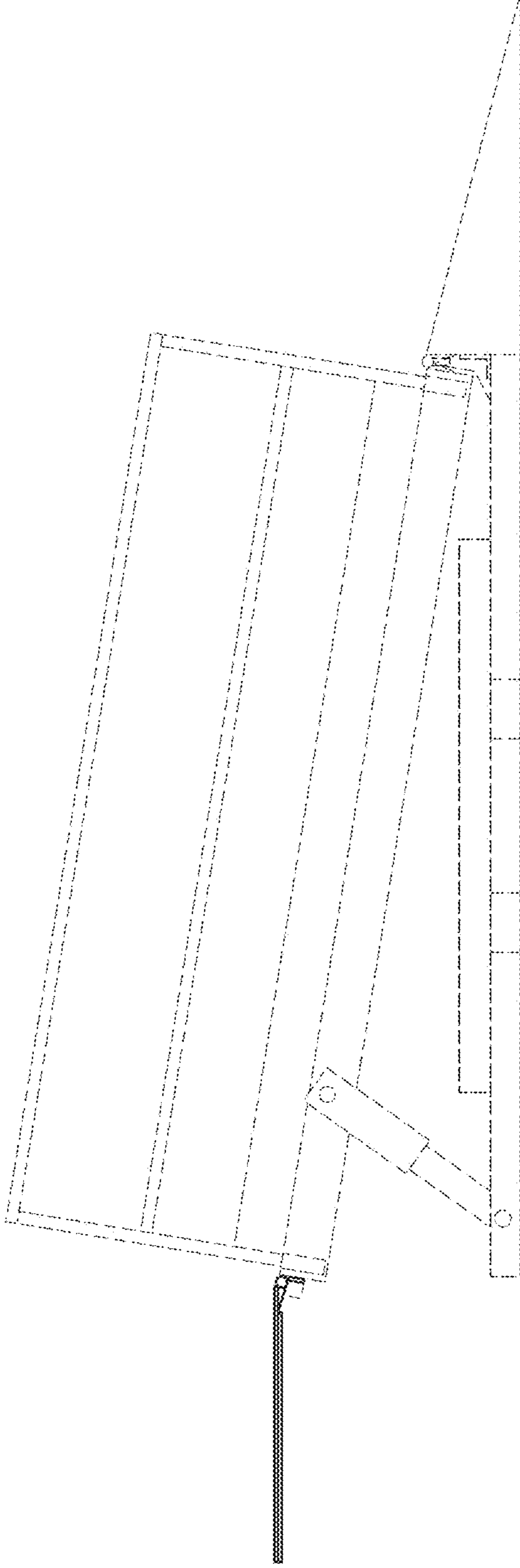

Fig. 2

Fig. 3



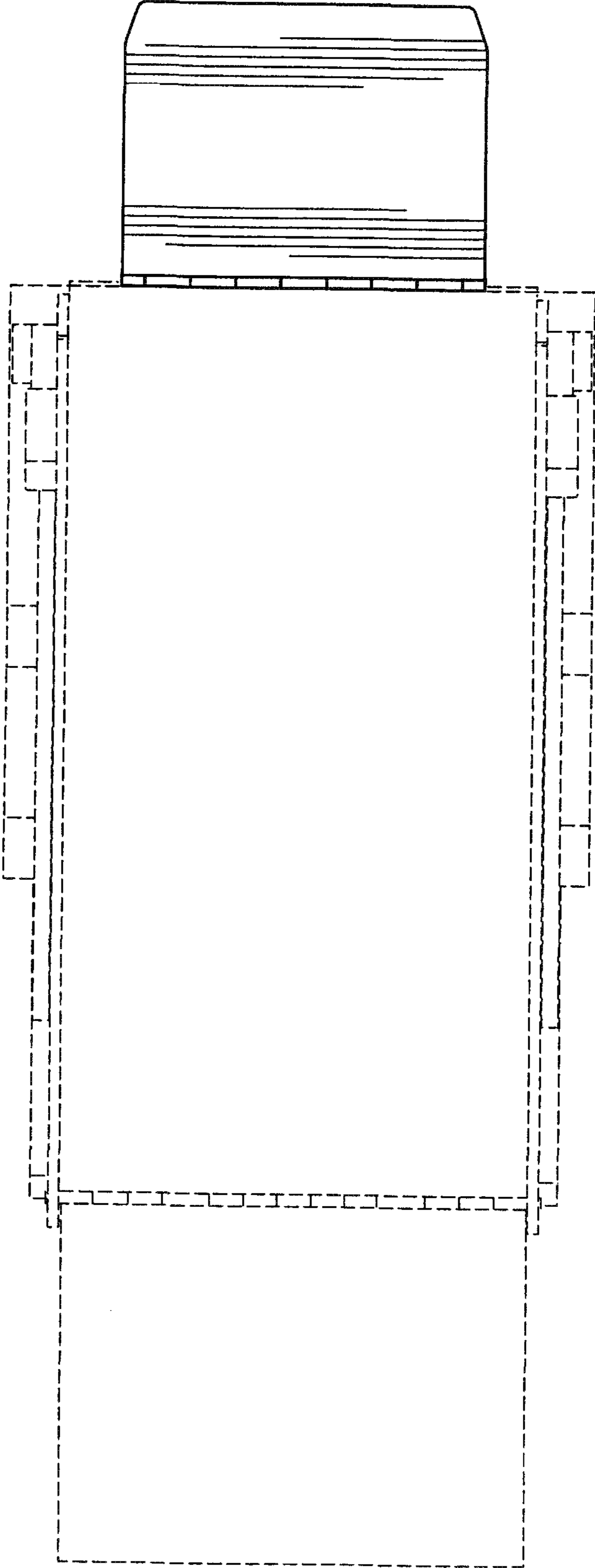

Fig. 4

Fig. 6

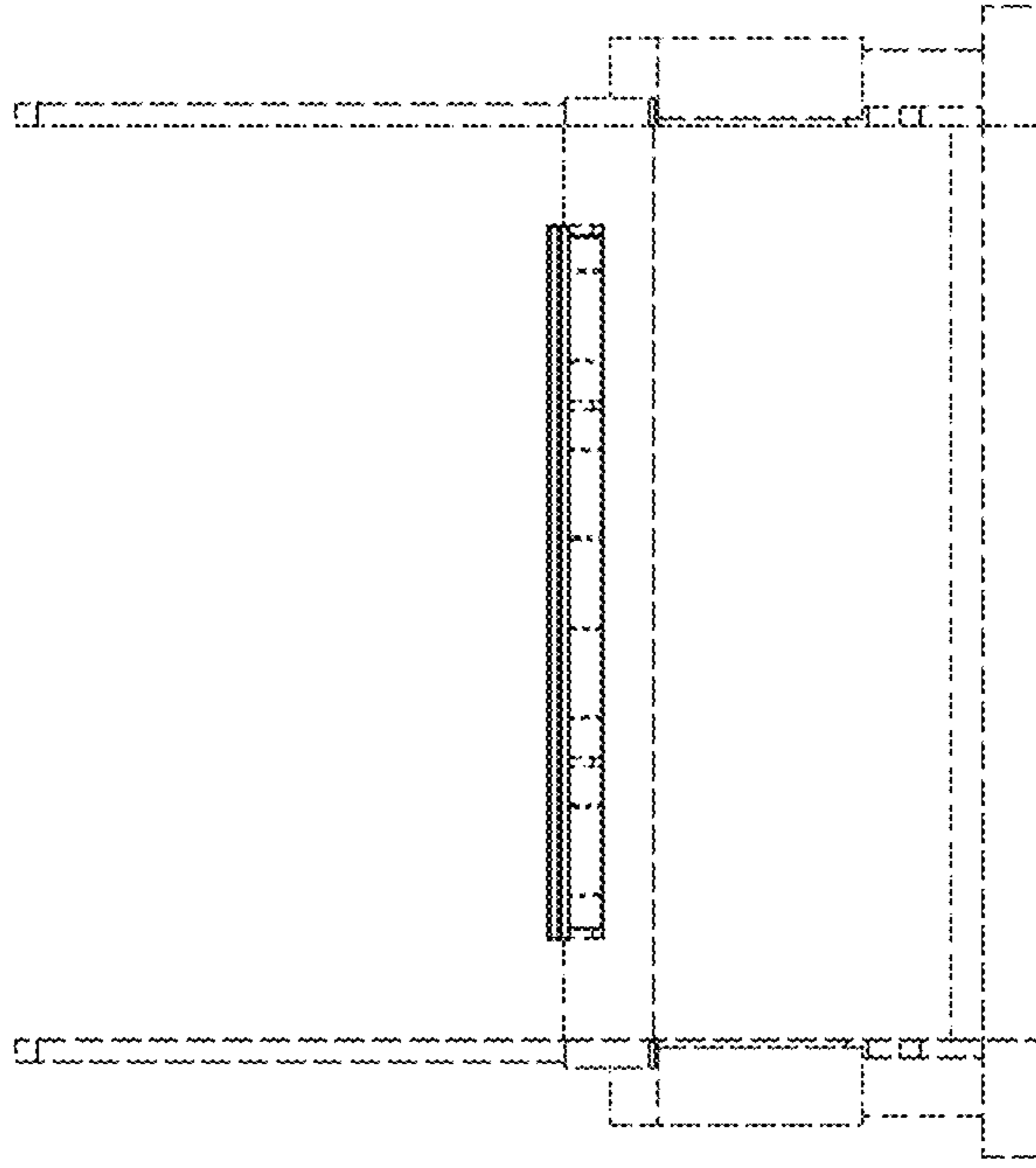
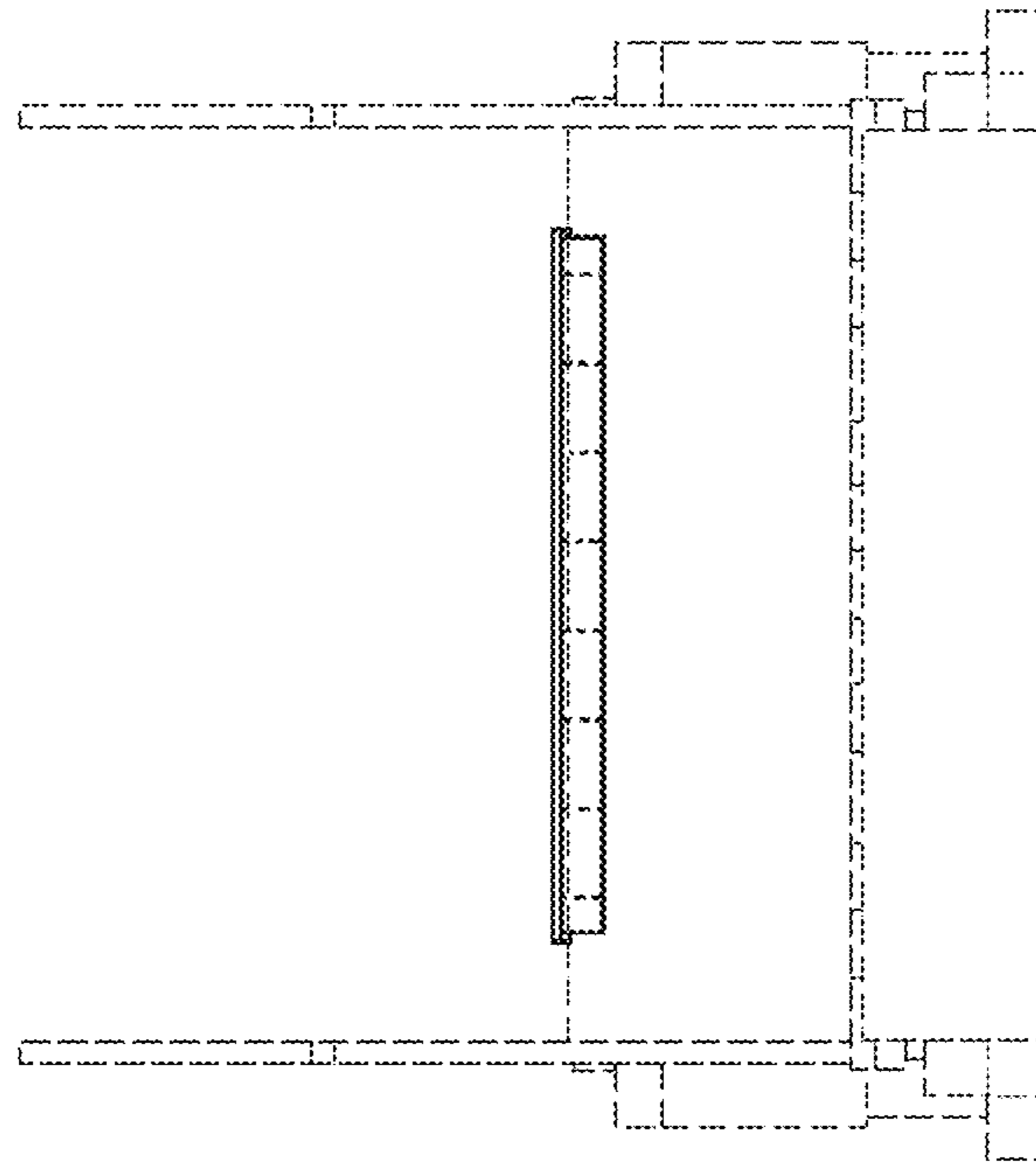

Fig. 5



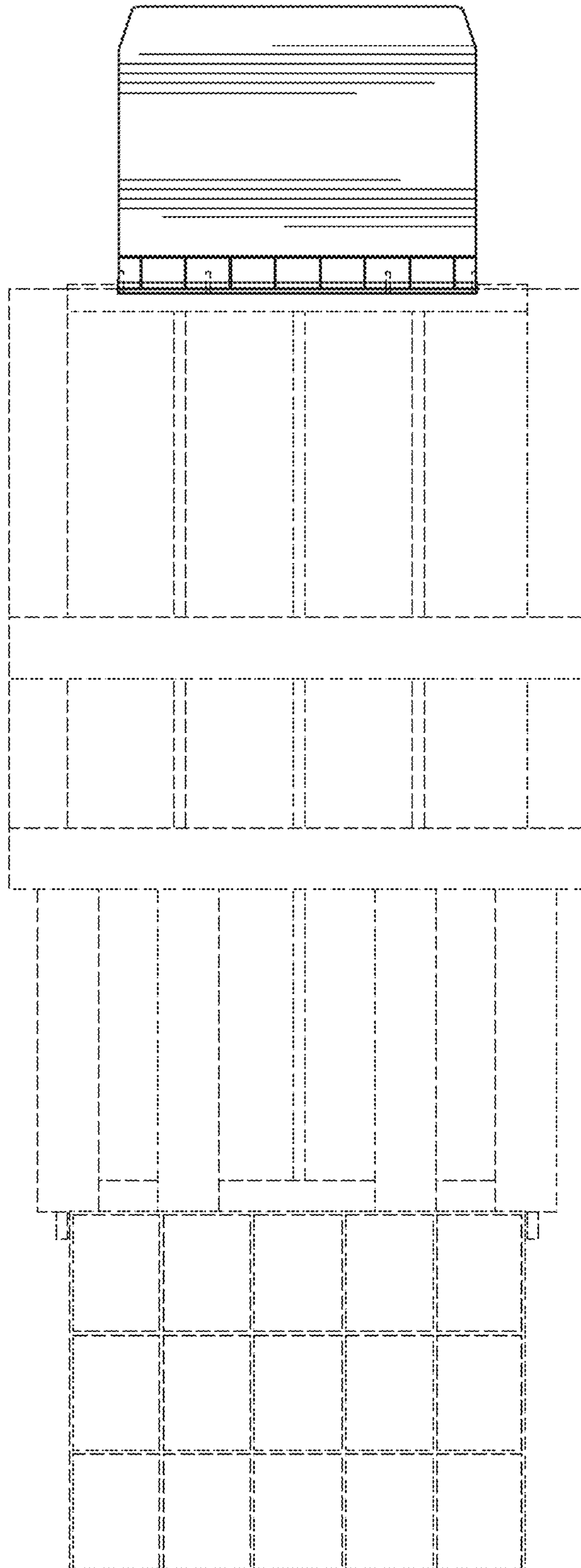

Fig. 7

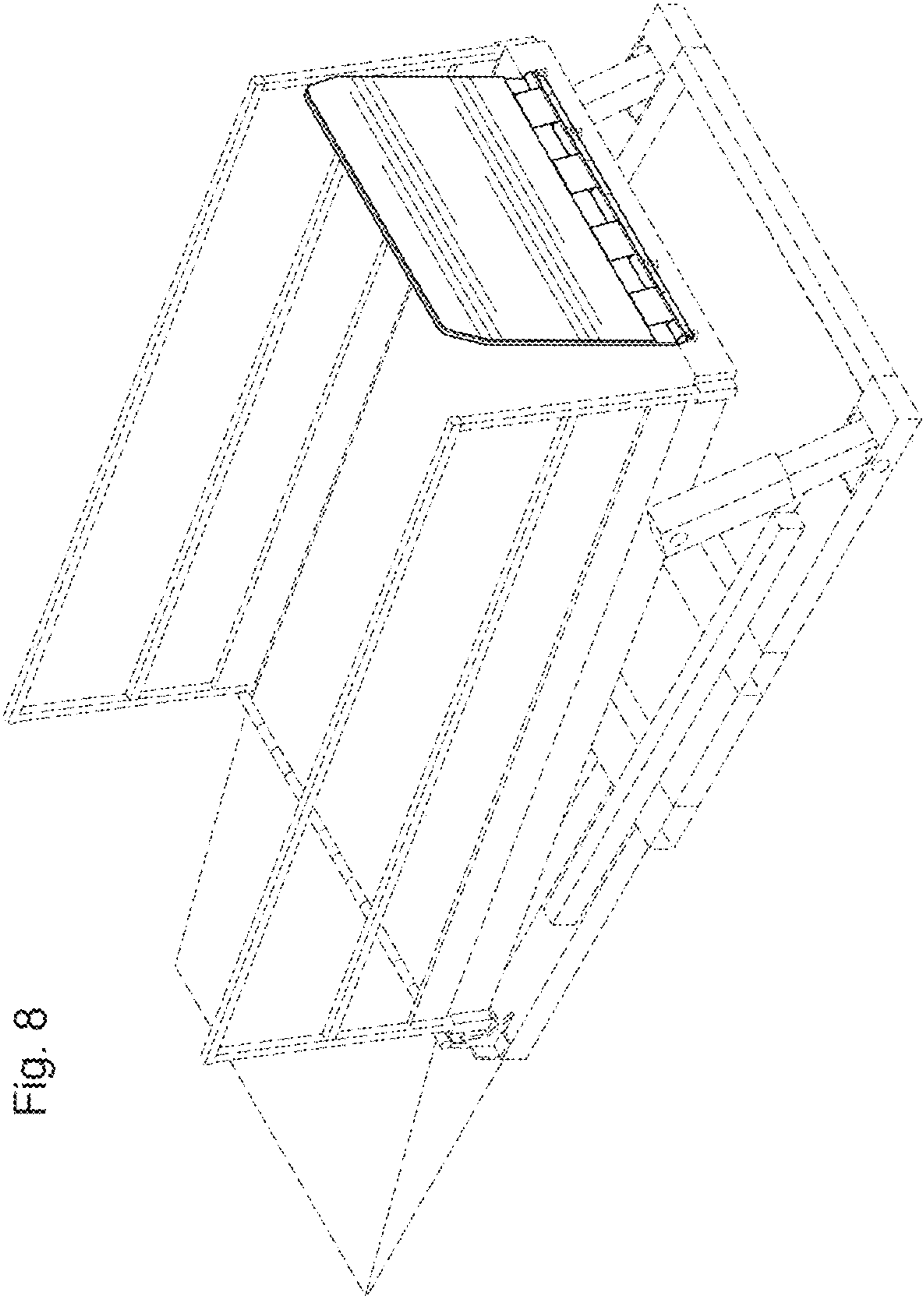

Fig. 8