



US00D801151S

(12) **United States Design Patent**
DiBlasi et al.

(10) **Patent No.:** **US D801,151 S**

(45) **Date of Patent:** **** Oct. 31, 2017**

(54) **I-BEAM CONNECTING ROD**
(71) Applicants: **Nickolaus DiBlasi**, Mission Viejo, CA
(US); **Sean Crawford**, Villa Park, CA
(US); **Clayton Stothers**, Irvine, CA
(US)

(72) Inventors: **Nickolaus DiBlasi**, Mission Viejo, CA
(US); **Sean Crawford**, Villa Park, CA
(US); **Clayton Stothers**, Irvine, CA
(US)

(73) Assignee: **Race Winning Brands, Inc.**, Mentor,
OH (US)

(**) Term: **15 Years**

(21) Appl. No.: **29/570,468**

(22) Filed: **Jul. 8, 2016**

(51) **LOC (10) Cl.** **08-05**

(52) **U.S. Cl.**
USPC **D8/354**

(58) **Field of Classification Search**
USPC 248/58, 59, 62, 72, 65; 29/239;
225/104, 105; 123/197.3; D15/5;
D3/207-212; D12/345; D8/354;
D23/262
CPC F16L 3/1016; F16L 3/1025
See application file for complete search history.

(56) **References Cited**

U.S. PATENT DOCUMENTS

4,019,705	A *	4/1977	Habuda, Sr.	F16L 3/11 248/228.6
5,230,488	A *	7/1993	Condon	F16L 3/12 248/73
5,685,508	A *	11/1997	Smith	F16L 3/18 248/49
5,702,077	A *	12/1997	Heath	F16L 3/14 248/59

D416,131	S *	11/1999	Dafski	D3/211
6,134,779	A	10/2000	Walker et al.	
6,329,022	B1 *	12/2001	Schlegel	C23C 4/12 29/888.09
6,367,151	B1 *	4/2002	Schlegel	C23C 4/12 29/888.09
6,502,480	B1	1/2003	Walker et al.	
6,560,869	B1 *	5/2003	Schlegel	F16C 7/023 29/413
7,155,791	B1 *	1/2007	Foster	B23D 31/003 29/239
7,299,716	B2	11/2007	Nakajima et al.	
7,331,549	B2 *	2/2008	Wirth, Jr.	F16L 3/10 248/65
7,418,886	B2	9/2008	Kubota et al.	

(Continued)

Primary Examiner — Lakiya Rogers
Assistant Examiner — Harold E Blackwell, II
(74) *Attorney, Agent, or Firm* — Buckingham, Doolittle
& Burroughs, LLC

(57) **CLAIM**

We claim the ornamental design for a I-beam connecting rod, as shown and described.

DESCRIPTION

FIG. 1 is a perspective view of the I-beam connecting rod of the present invention.
FIG. 2 is a front elevational view of the I-beam connecting rod of the present invention.
FIG. 3 is a right side elevational view of the I-beam connecting rod of the present invention.
FIG. 4 is a left side elevational view of the I-beam connecting rod of the present invention.
FIG. 5 is a rear elevational view of the I-beam connecting rod of the present invention.
FIG. 6 is a top view of the I-beam connecting rod of the present invention; and,
FIG. 7 is a bottom view of the I-beam connecting rod of the present invention.

1 Claim, 7 Drawing Sheets

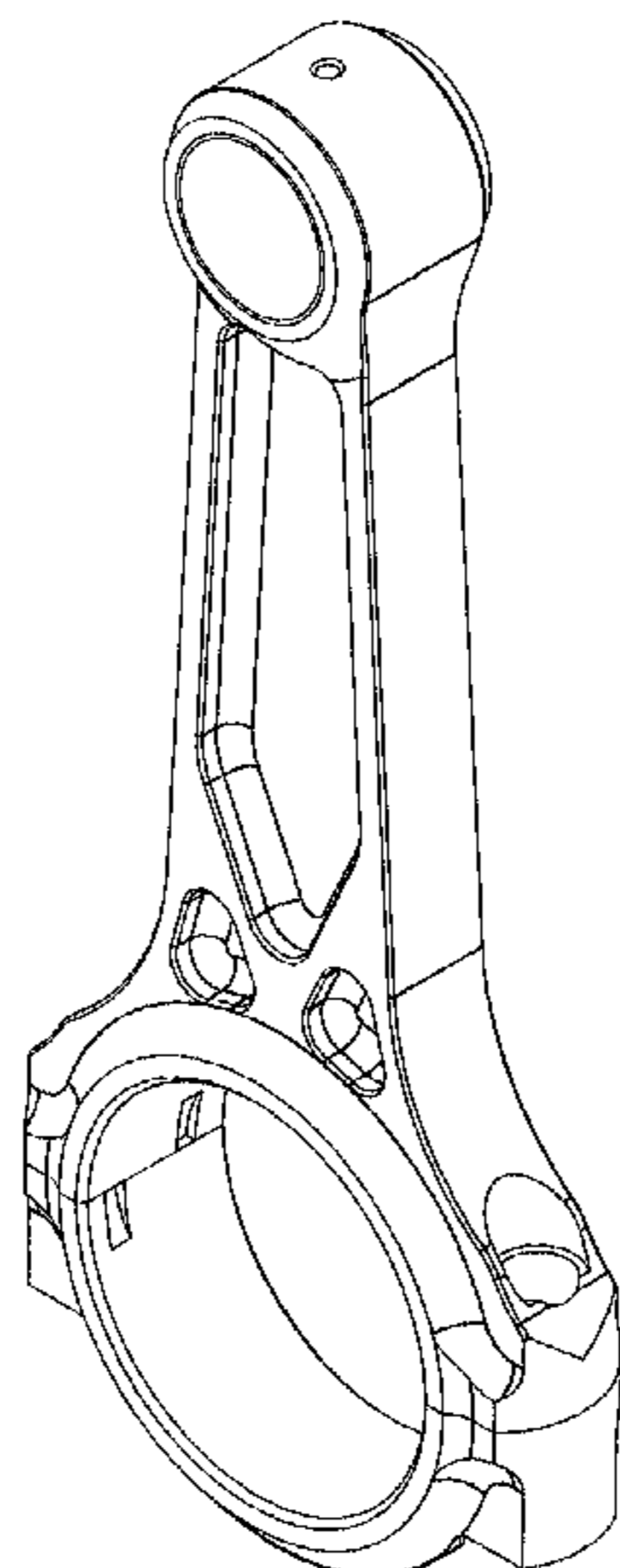

(56)

References Cited

U.S. PATENT DOCUMENTS

7,500,417 B2 3/2009 Ogawa et al.
 7,574,795 B2 8/2009 Ishida et al.
 7,739,928 B2 6/2010 Betzmeir
 D623,579 S 9/2010 Masson
 D623,580 S 9/2010 Masson
 D623,581 S 9/2010 Masson
 D638,342 S 5/2011 Masson
 D638,775 S 5/2011 Masson
 D638,776 S 5/2011 Masson
 7,963,699 B2* 6/2011 Kraemer C23C 4/00
 29/888.09
 D643,441 S 8/2011 Knobloch et al.
 8,152,939 B2* 4/2012 Hasegawa F16C 7/023
 148/333
 8,302,271 B2* 11/2012 Hashimoto B23D 31/003
 225/104
 8,376,723 B2* 2/2013 Kugelev F04B 53/147
 417/568
 8,413,971 B2* 4/2013 Kim B08B 7/02
 269/228

8,613,137 B2 12/2013 Lapp et al.
 8,935,852 B2* 1/2015 Donaldson B22F 5/008
 29/888.09
 9,181,896 B2* 11/2015 Pauls F16C 7/023
 9,291,192 B2* 3/2016 Brock, II F16J 7/00
 9,403,223 B2* 8/2016 Prieto B23D 31/002
 9,528,546 B2* 12/2016 Melde-Tuczai F02B 75/045
 9,567,902 B2* 2/2017 Paul F02B 75/044
 9,599,148 B2* 3/2017 Domanchuk F16J 1/16
 9,638,242 B2* 5/2017 Andersen B21K 1/766
 2004/0154578 A1 8/2004 Weaver
 2005/0145060 A1 7/2005 Weaver
 2008/0047393 A1 2/2008 Nakajima et al.
 2008/0282838 A1 11/2008 Weaver
 2010/0260631 A1 10/2010 Kugelev et al.
 2010/0300397 A1 12/2010 Lapp et al.
 2010/0319650 A1 12/2010 Clozza et al.
 2011/0290948 A1* 12/2011 Benne F16L 3/11
 248/58
 2013/0098330 A1 4/2013 Sigrist et al.
 2015/0048219 A1* 2/2015 Richards F16B 33/002
 248/67.5
 2015/0053169 A1 2/2015 Galli et al.

* cited by examiner

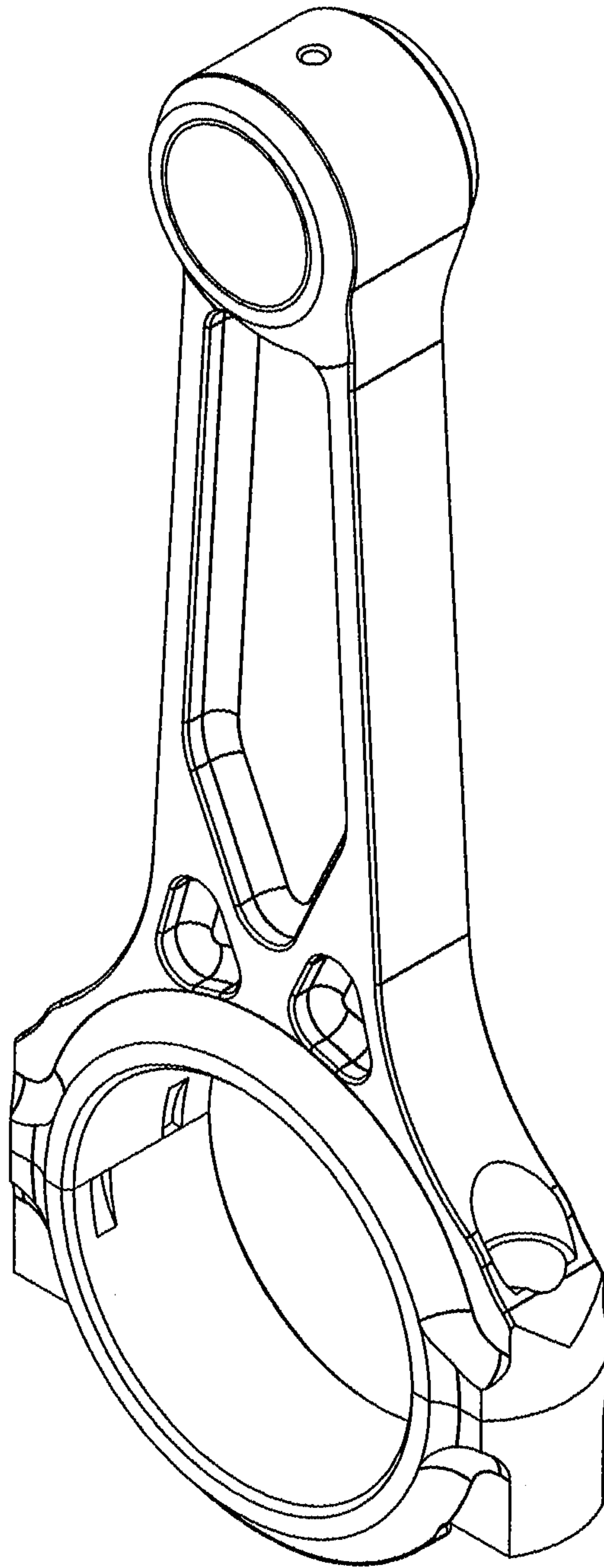

FIG. 1

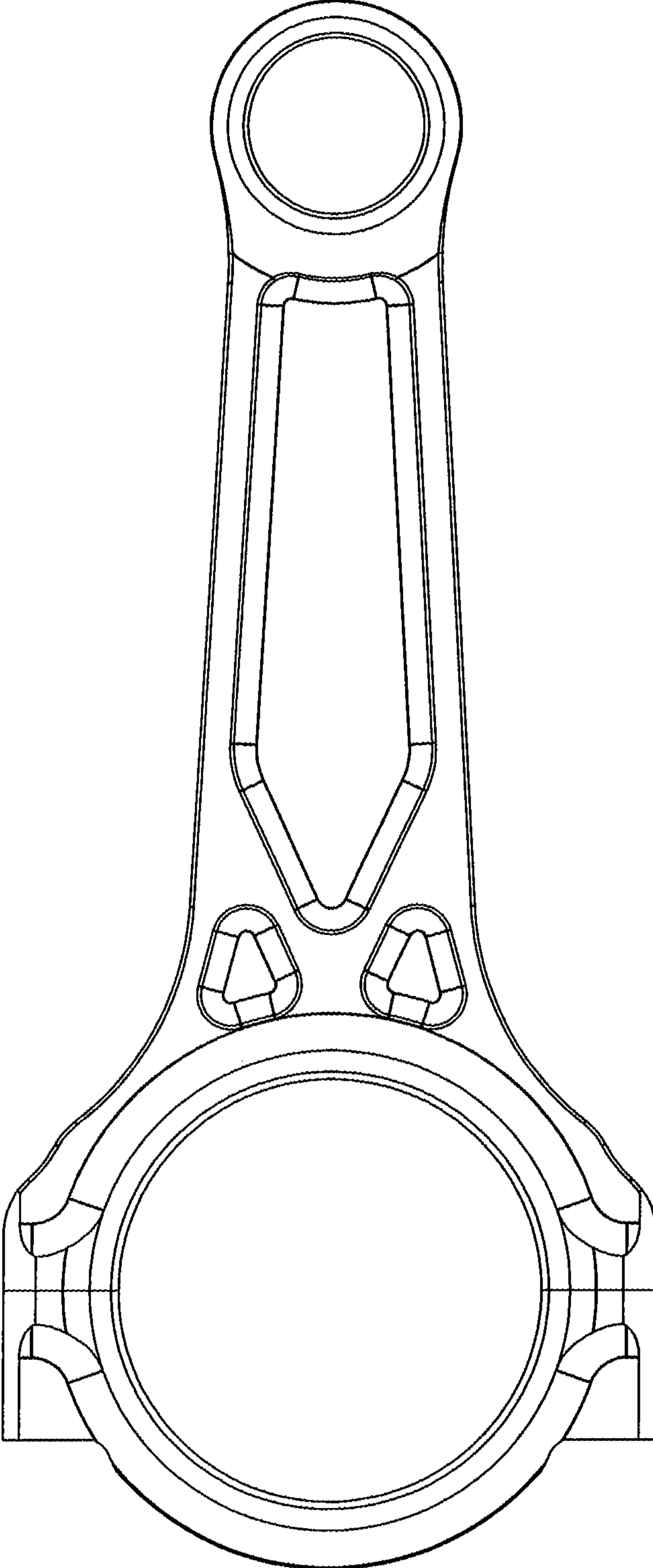

FIG. 2

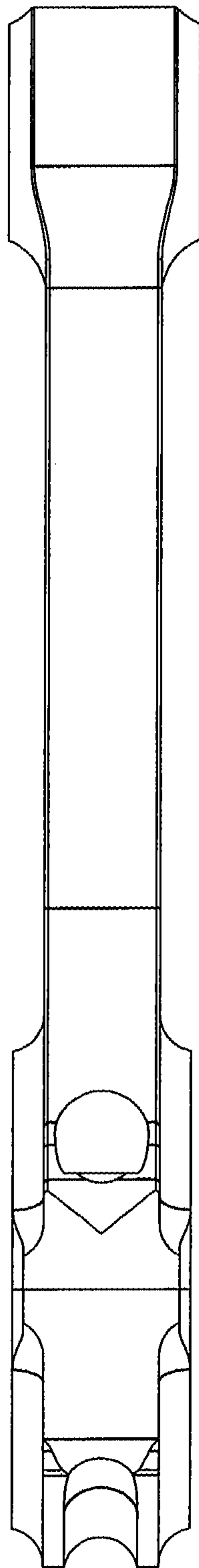

FIG. 3

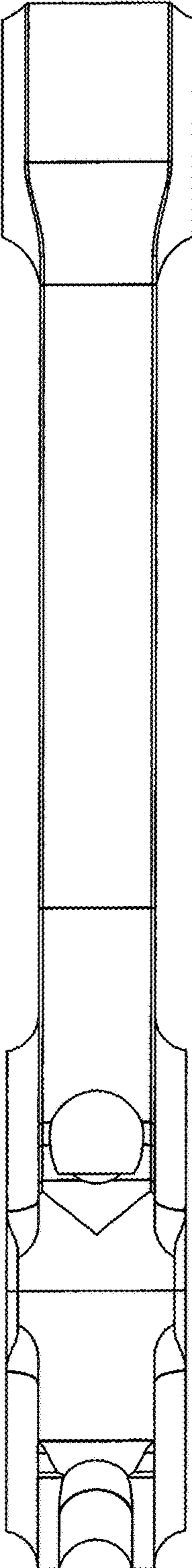

FIG. 4

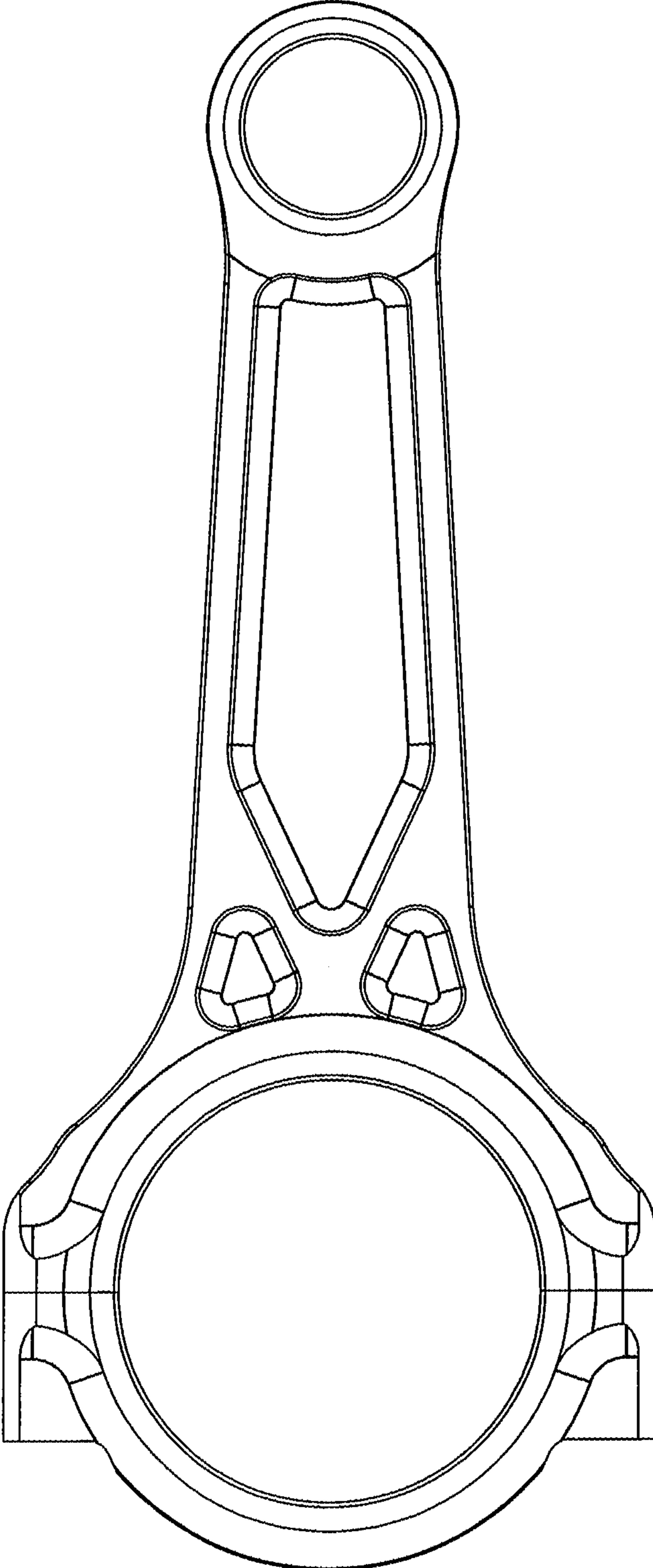

FIG. 5

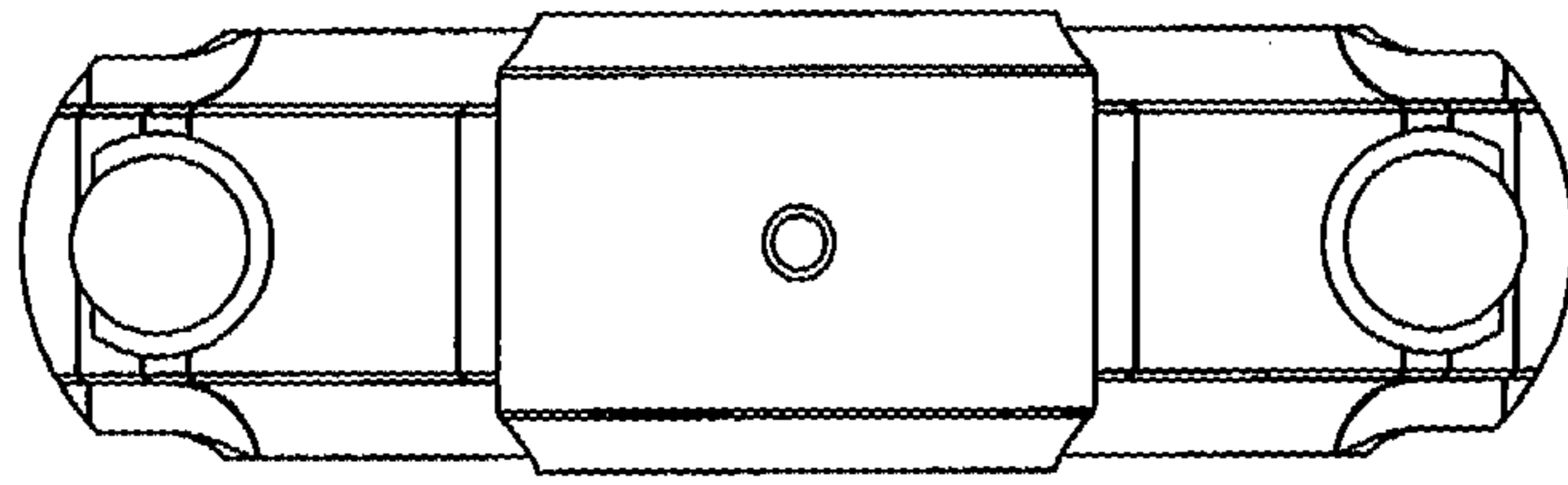

FIG. 6

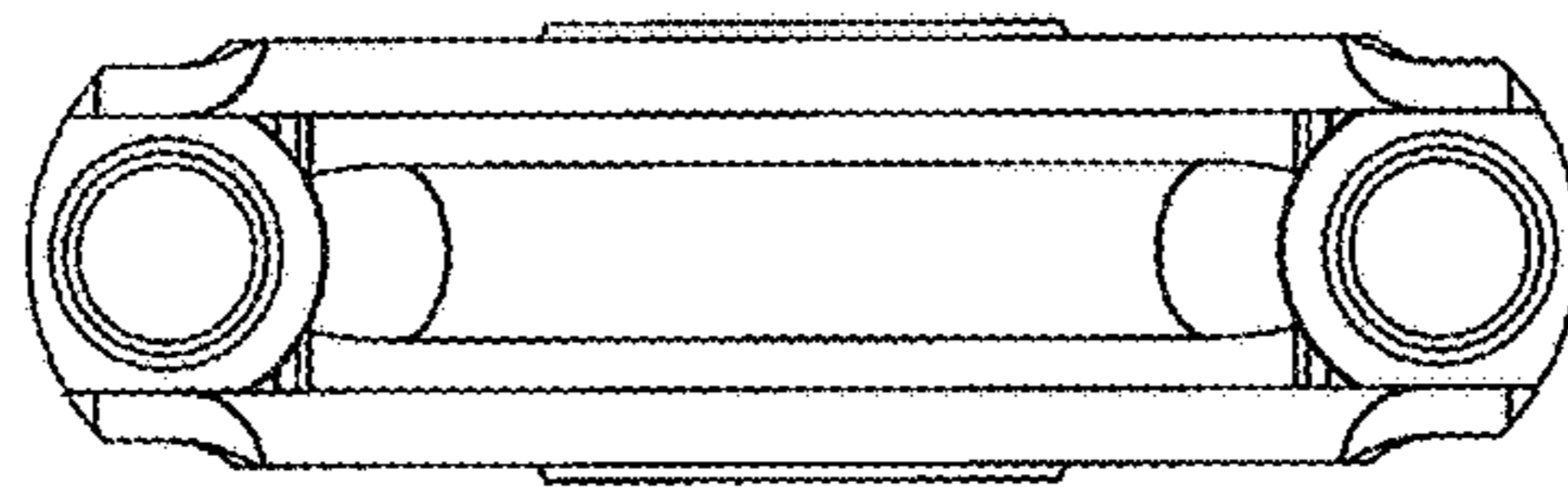

FIG. 7