



US00D801145S

(12) **United States Design Patent** (10) **Patent No.:** **US D801,145 S**  
**Aoki et al.** (45) **Date of Patent:** **\*\* Oct. 31, 2017**

(54) **NAILER**

D699,535 S \* 2/2014 Albrecht ..... D8/68  
D713,704 S \* 9/2014 Wang ..... D8/68  
D724,404 S \* 3/2015 Fischer-Zernin ..... D8/68

(Continued)

(71) Applicant: **Hitachi Koki Co., Ltd.**, Minato-Ku, Tokyo (JP)

(72) Inventors: **Yoshiki Aoki**, Hitachinaka (JP); **Masato Sakai**, Hitachinaka (JP)

**OTHER PUBLICATIONS**

Jul. 27, 2016—JP Office Action—Des App 2015026164.

(Continued)

(73) Assignee: **Hitachi Koki Co., Ltd.**, Minato-Ku, Tokyo (JP)

*Primary Examiner* — Darlington Ly

(\*\*) Term: **15 Years**

(74) *Attorney, Agent, or Firm* — Banner & Witcoff, Ltd.

(21) Appl. No.: **29/565,711**

(57) **CLAIM**

(22) Filed: **May 24, 2016**

The ornamental design for a nailer, as shown and described.

(30) **Foreign Application Priority Data**

**DESCRIPTION**

Nov. 24, 2015 (JP) ..... 2015-026164

(51) **LOC (10) Cl.** ..... **08-05**

(52) **U.S. Cl.**  
USPC ..... **D8/68**

(58) **Field of Classification Search**  
USPC ..... D8/61-70  
CPC .. B25C 1/001; B25C 1/04; B25C 1/06; B25C 1/041; B25C 1/047  
See application file for complete search history.

FIG. 1 is a front perspective view of the nailer according to the first embodiment showing our new design;  
FIG. 2 is a front view thereof;  
FIG. 3 is a rear view thereof;  
FIG. 4 is a left side view thereof;  
FIG. 5 is a right side view thereof;  
FIG. 6 is a top view thereof;  
FIG. 7 is a bottom view thereof;  
FIG. 8 is a front perspective view of the nailer according to the second embodiment showing our new design;  
FIG. 9 is a front view thereof;  
FIG. 10 is a rear view thereof;  
FIG. 11 is a left side view thereof;  
FIG. 12 is a right side view thereof;  
FIG. 13 is a top view thereof; and,  
FIG. 14 is a bottom view thereof.

(56) **References Cited**

**U.S. PATENT DOCUMENTS**

D353,664 S \* 12/1994 Eminger ..... D8/69  
D483,240 S \* 12/2003 Garvis ..... D8/68  
D484,383 S \* 12/2003 Yang ..... D8/68  
D484,765 S \* 1/2004 Yang ..... D8/68  
D500,655 S \* 1/2005 Leasure ..... D8/69  
6,913,180 B2 \* 7/2005 Schuster ..... B25C 1/005  
227/109  
D512,620 S \* 12/2005 Thomas ..... D8/69  
D514,911 S \* 2/2006 Thomas ..... D8/69  
D532,668 S \* 11/2006 Wen ..... D8/69  
D660,122 S \* 5/2012 Hotta ..... D8/69

The even broken lines in the drawings illustrate portions of the nailer; whereas the dash-dot broken lines is a symbolic representation for a boundary of the claim. Neither the portions of the nailer in broken lines and the boundary in dash-dot broken lines form part of the claimed design.

**1 Claim, 10 Drawing Sheets**

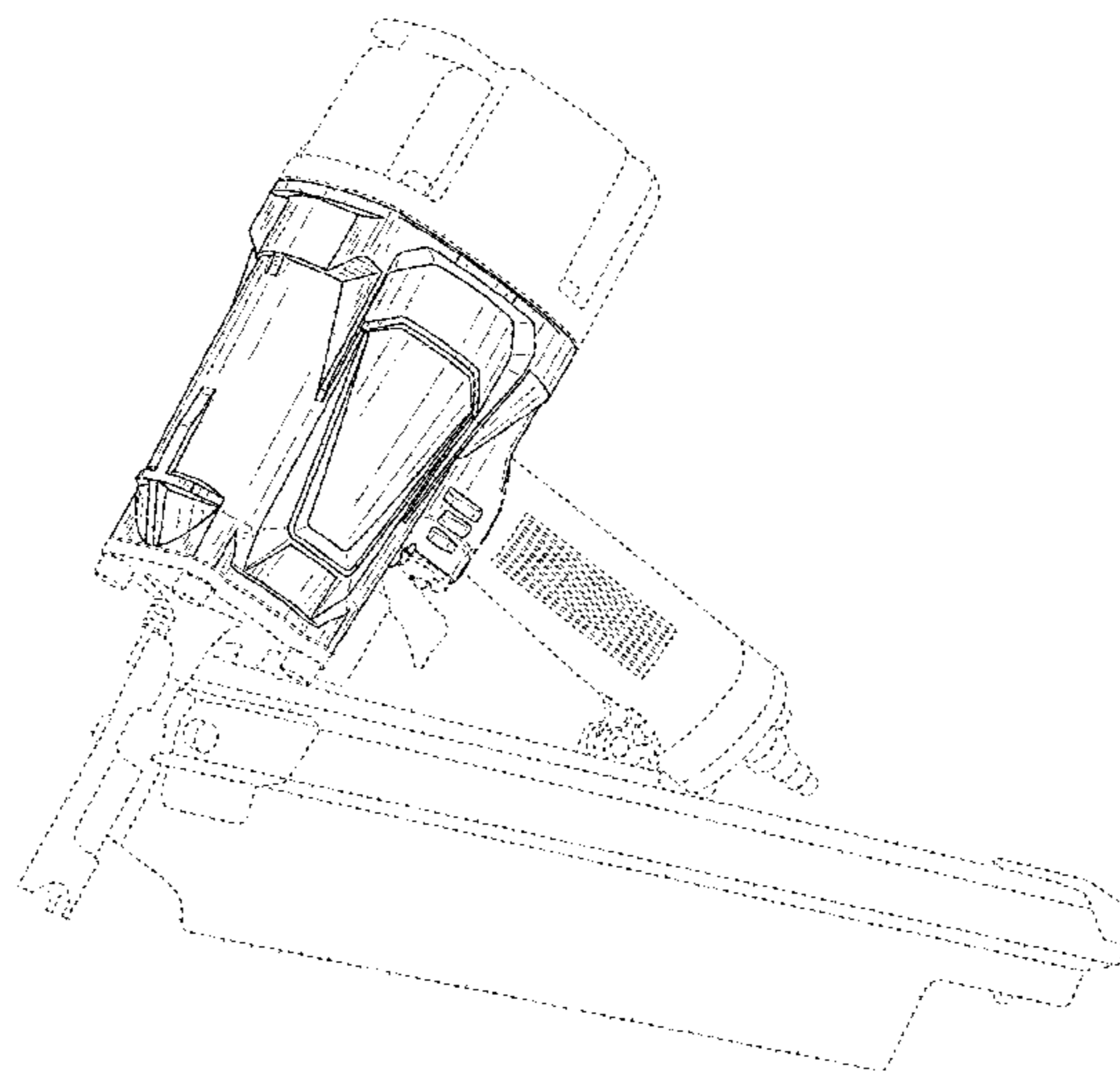

(56)

**References Cited**

U.S. PATENT DOCUMENTS

D787,290 S \* 5/2017 Meyer ..... D8/68  
2005/0001007 A1 \* 1/2005 Butzen ..... B25C 1/005  
227/130  
2012/0292472 A1 \* 11/2012 Segura ..... B25F 5/02  
248/225.21

OTHER PUBLICATIONS

<https://www.amazon.com/Hitachi-NR83A3-Plastic-Collated-Framing/dp/B00FKAC9K4>, retrieved on Nov. 21, 2016 but publicly known prior to the date of filing of the present application.

\* cited by examiner

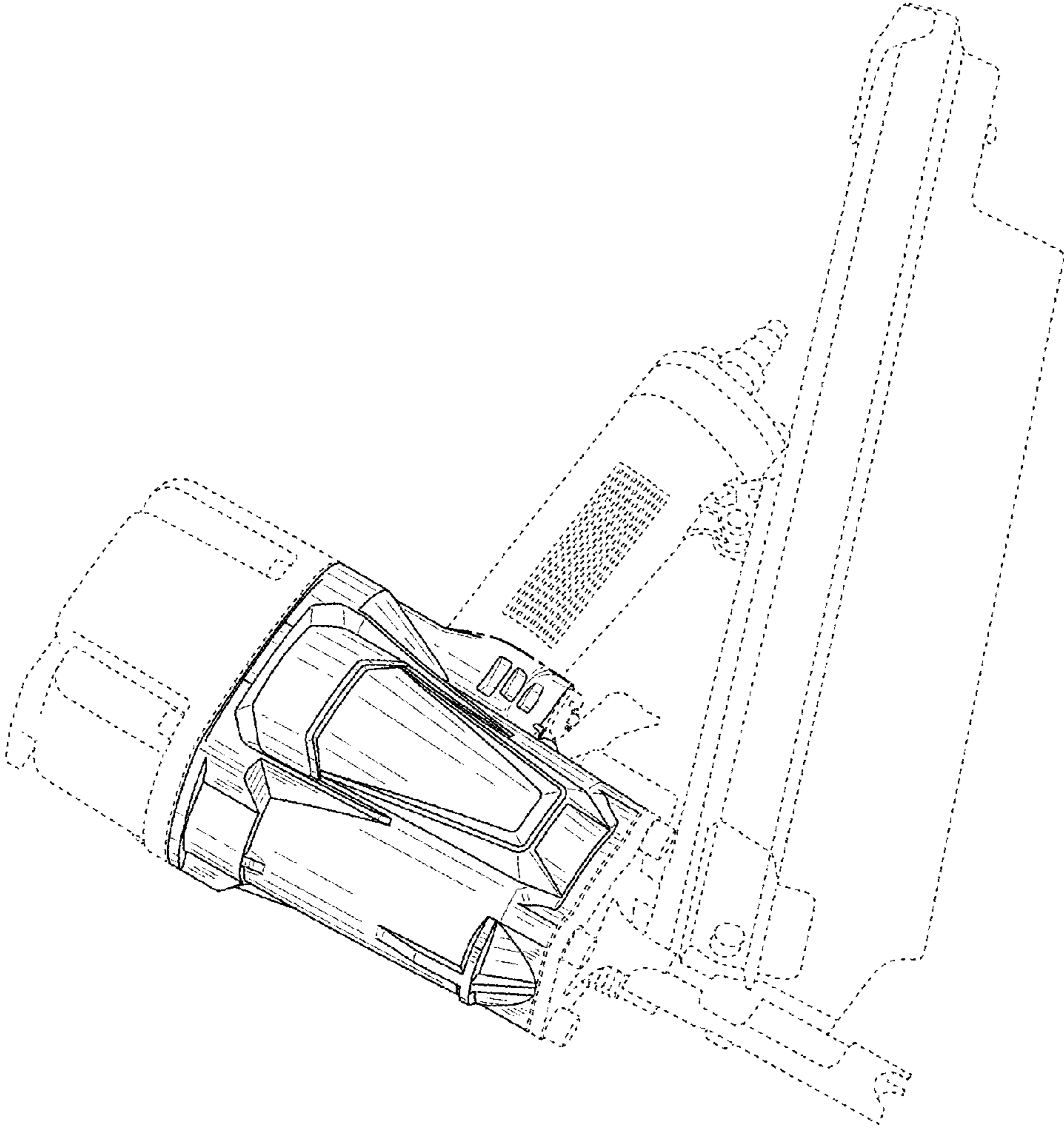

FIG. 1

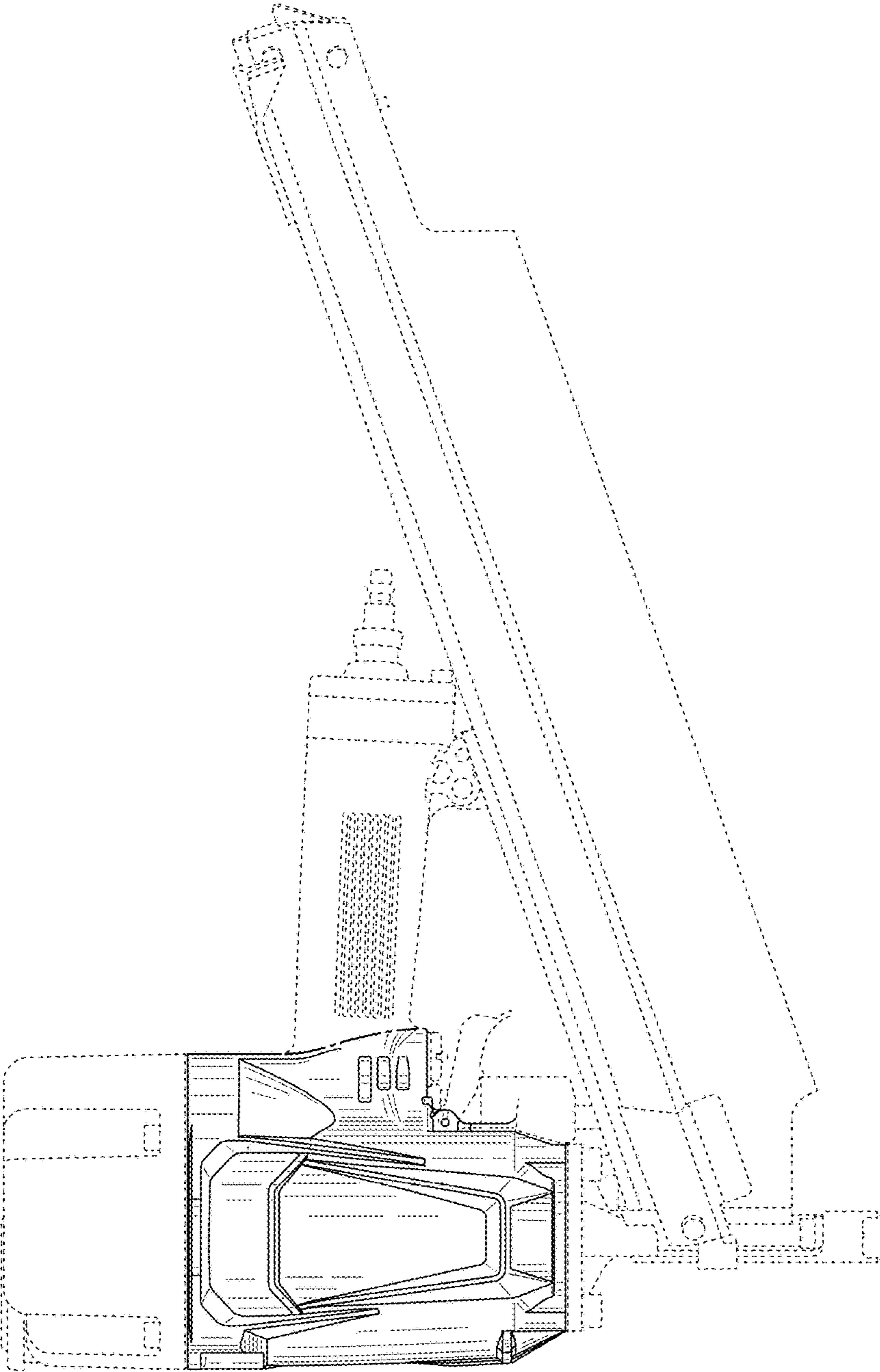

FIG. 2

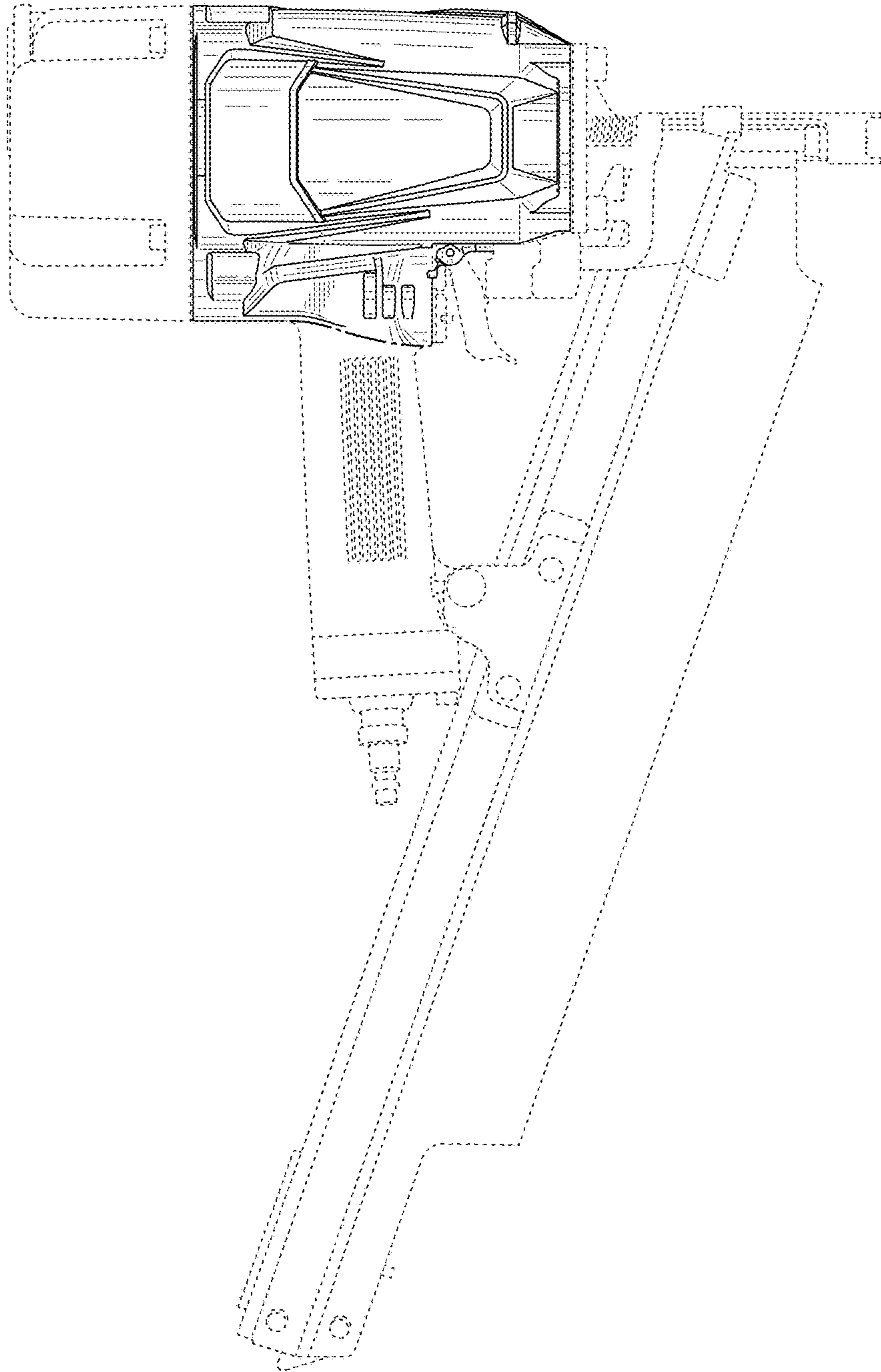

FIG. 3



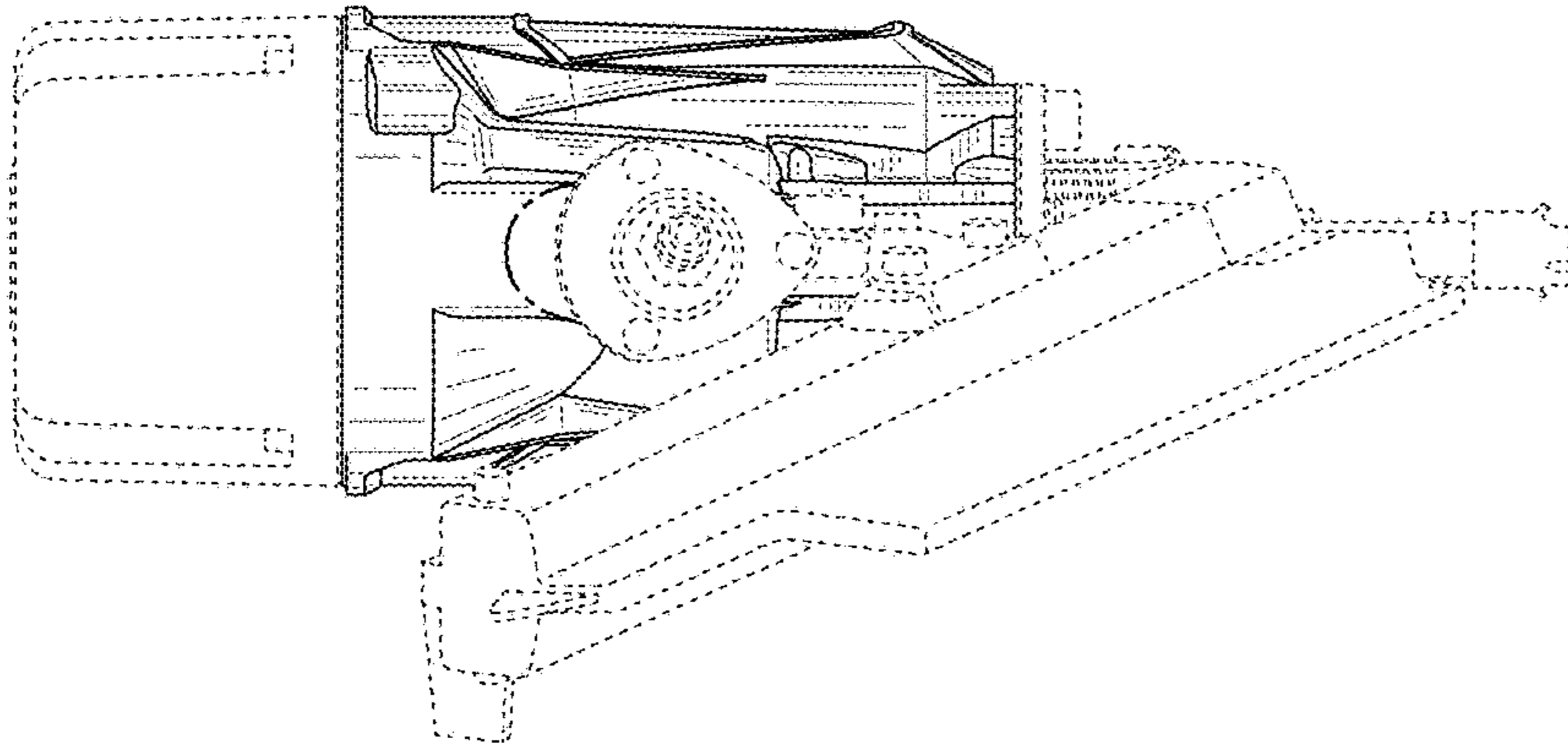

FIG. 5

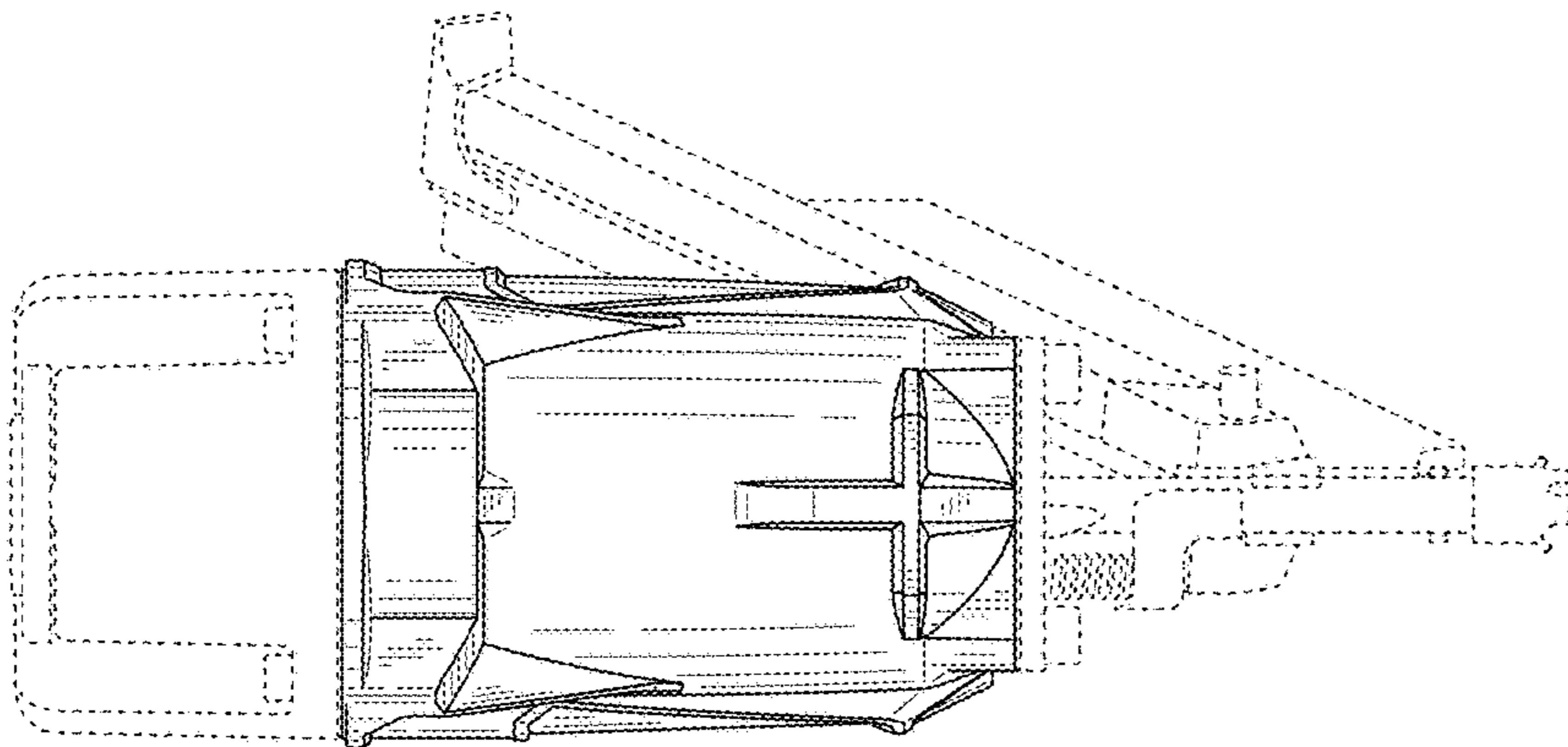

FIG. 4

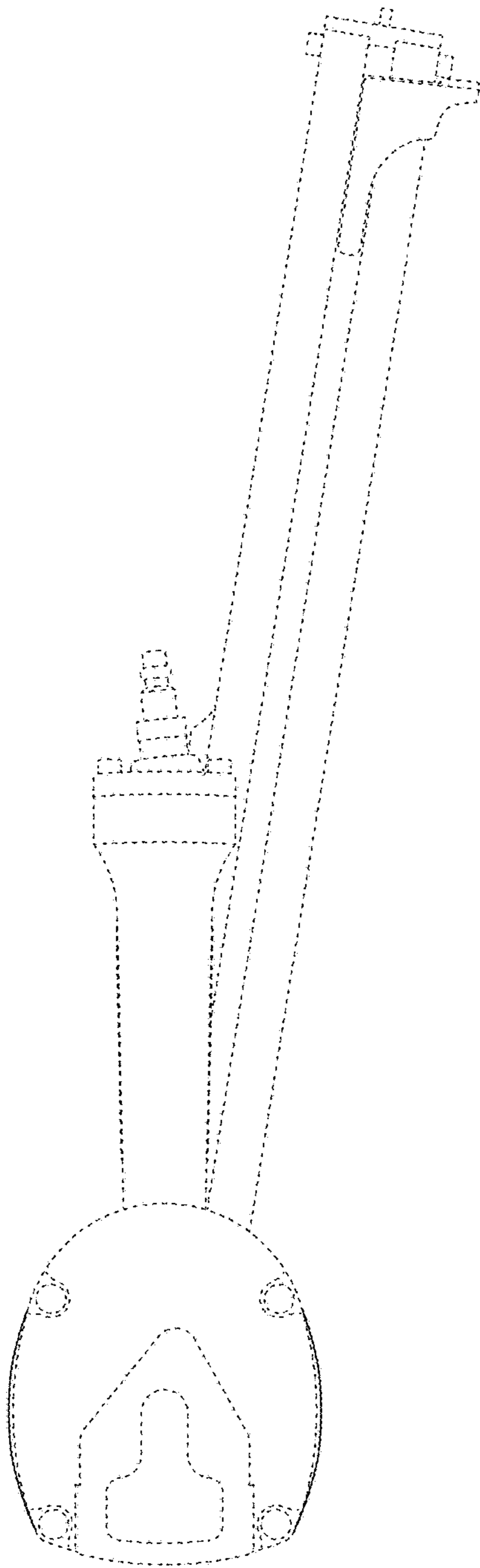

FIG. 6

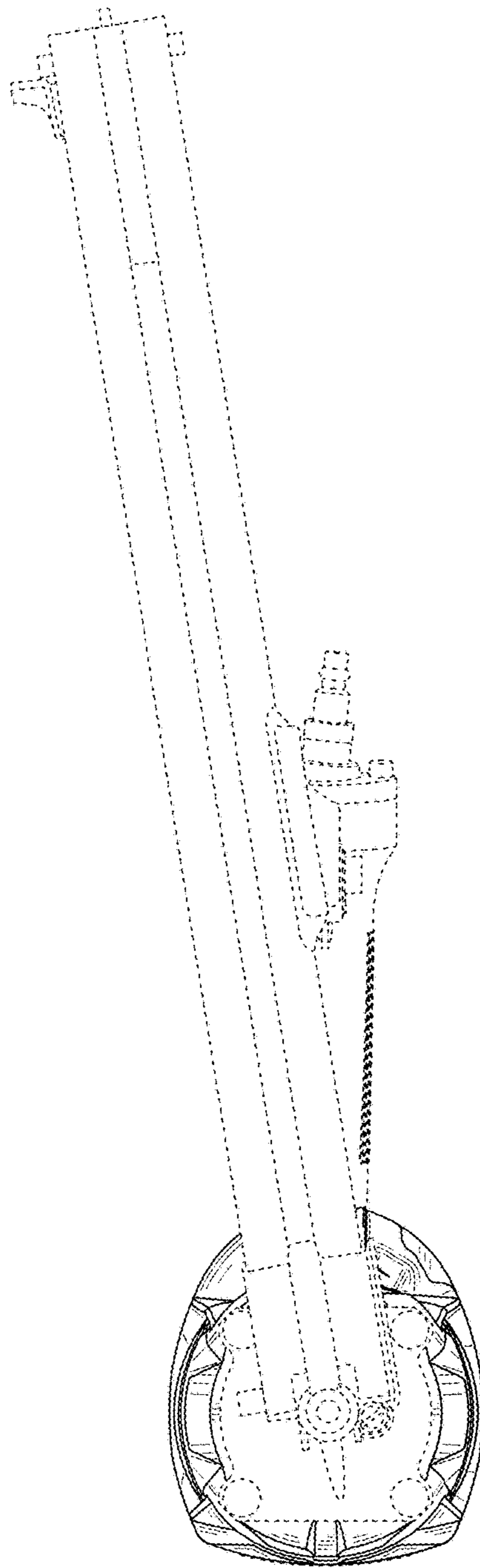

FIG. 7

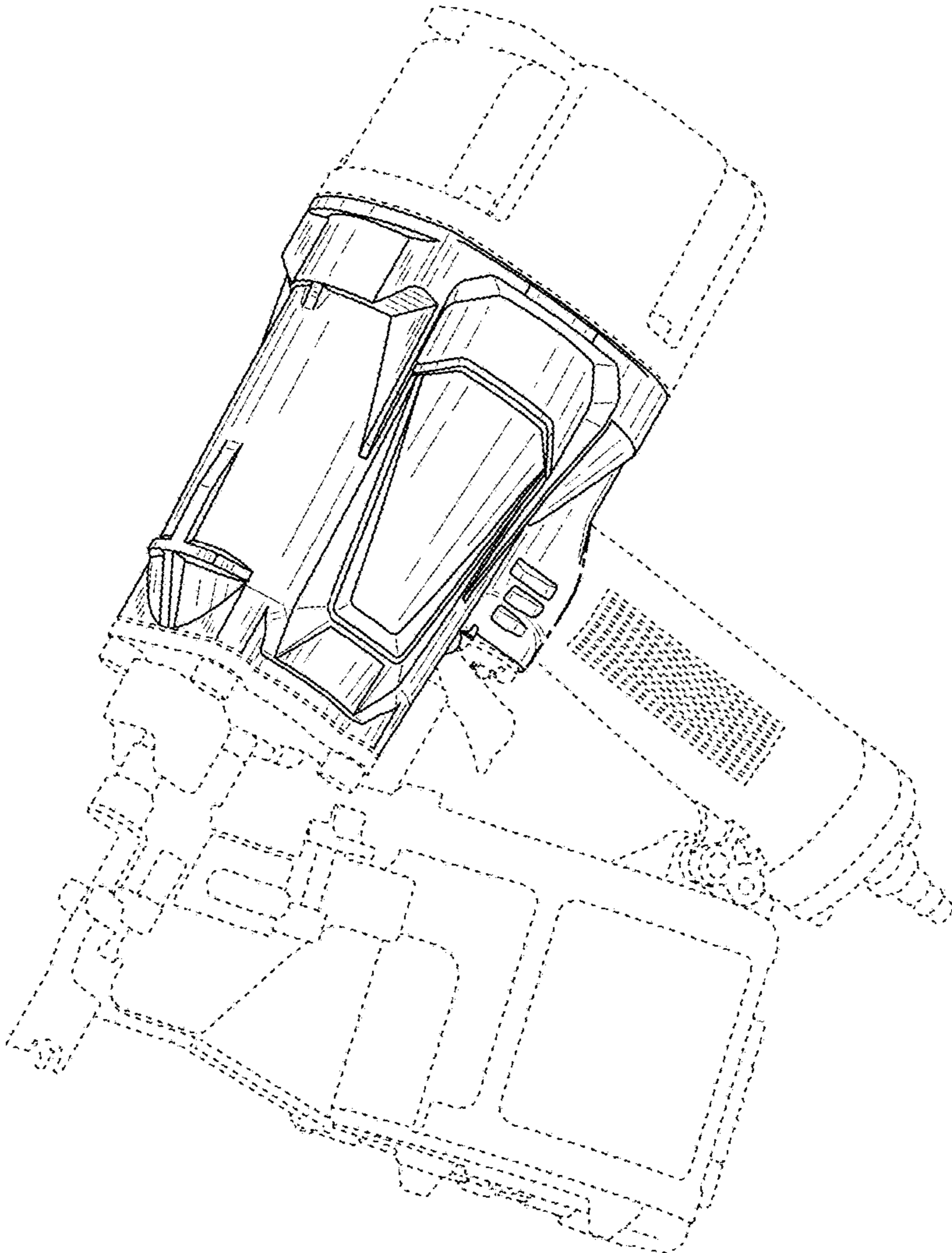

FIG. 8



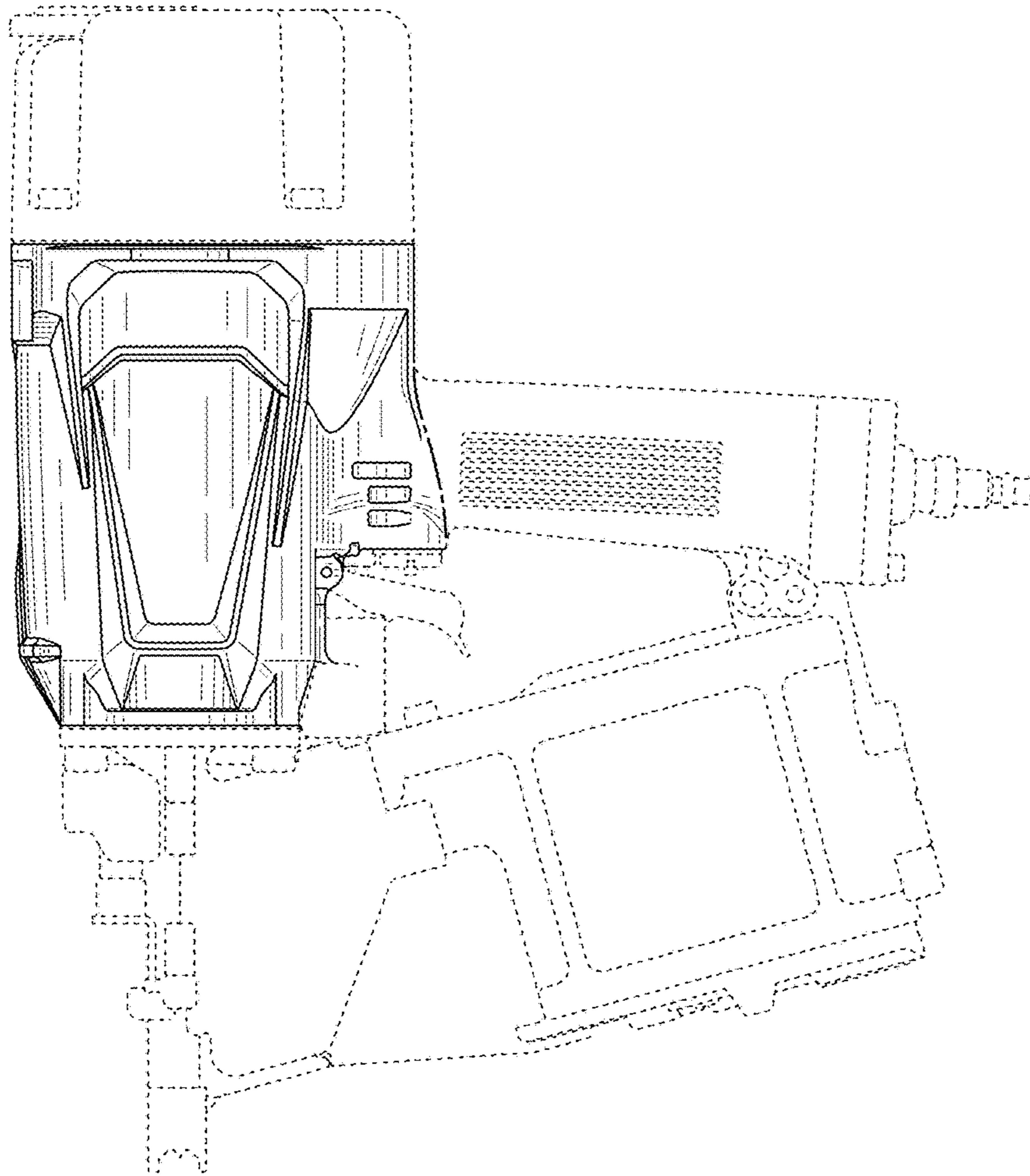

FIG. 9

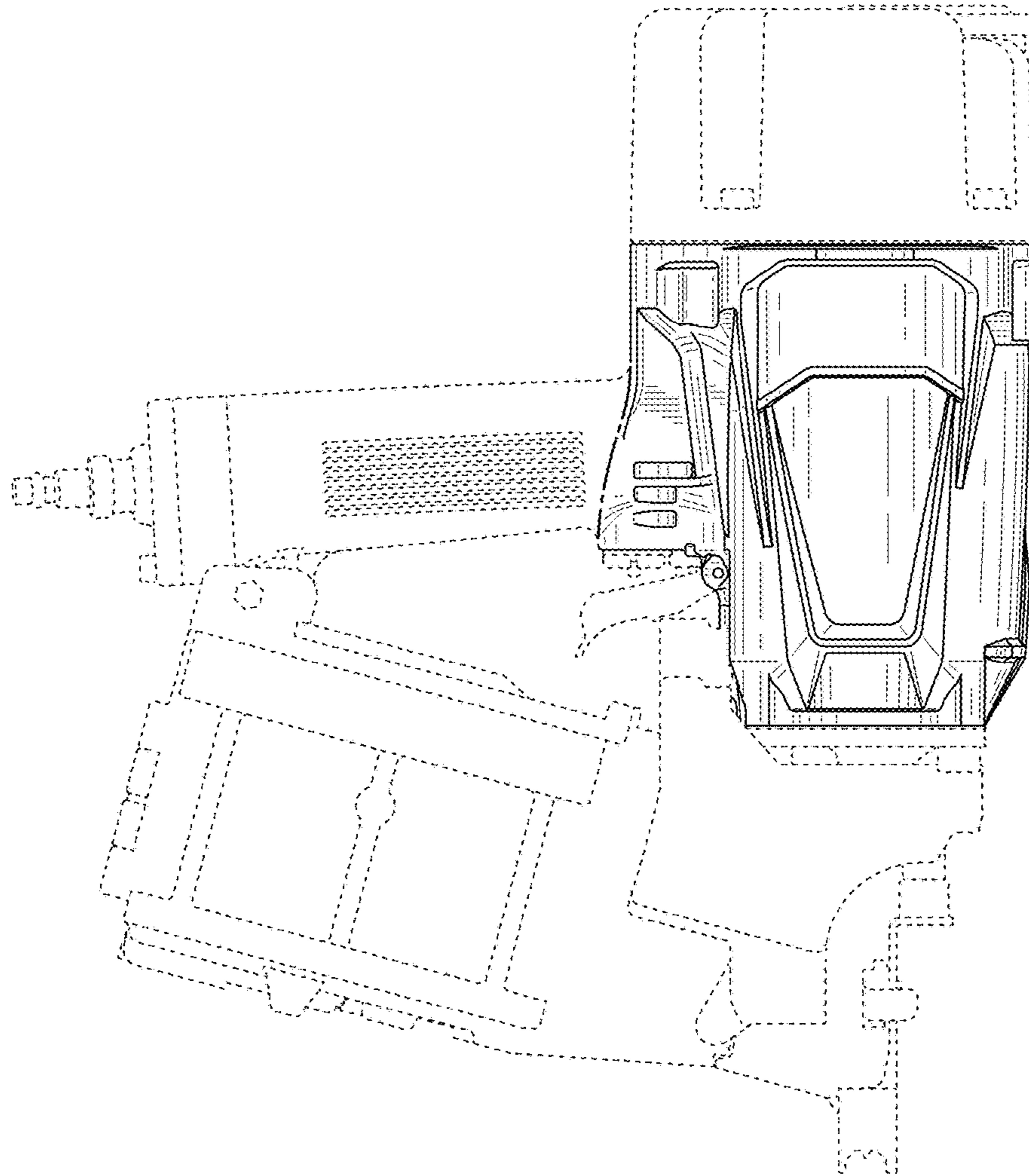

FIG. 10

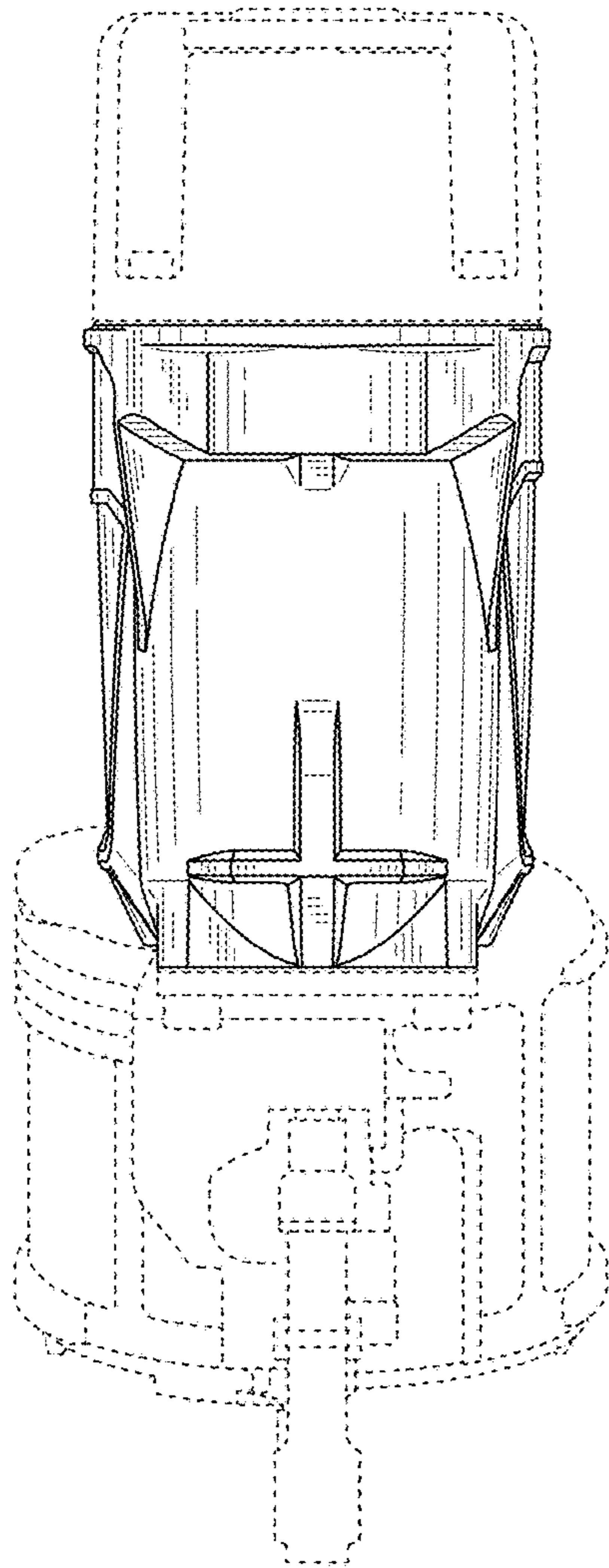

FIG. 11

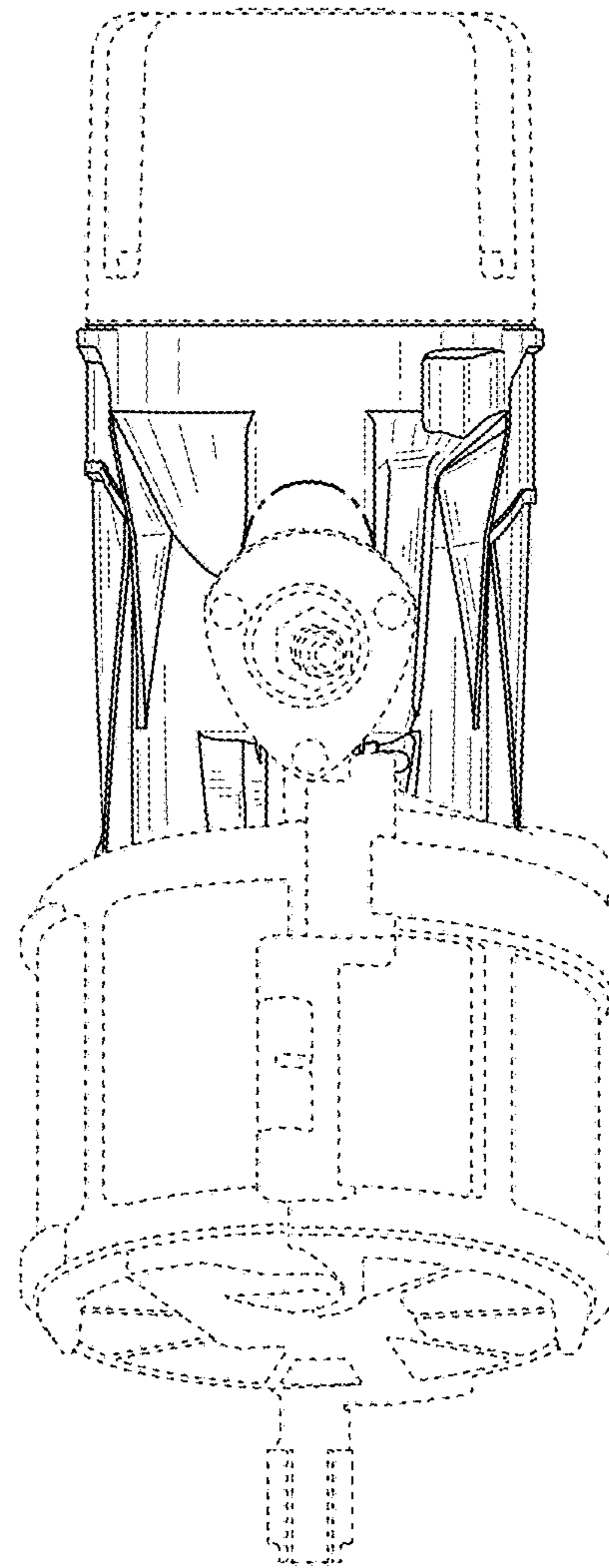

FIG. 12

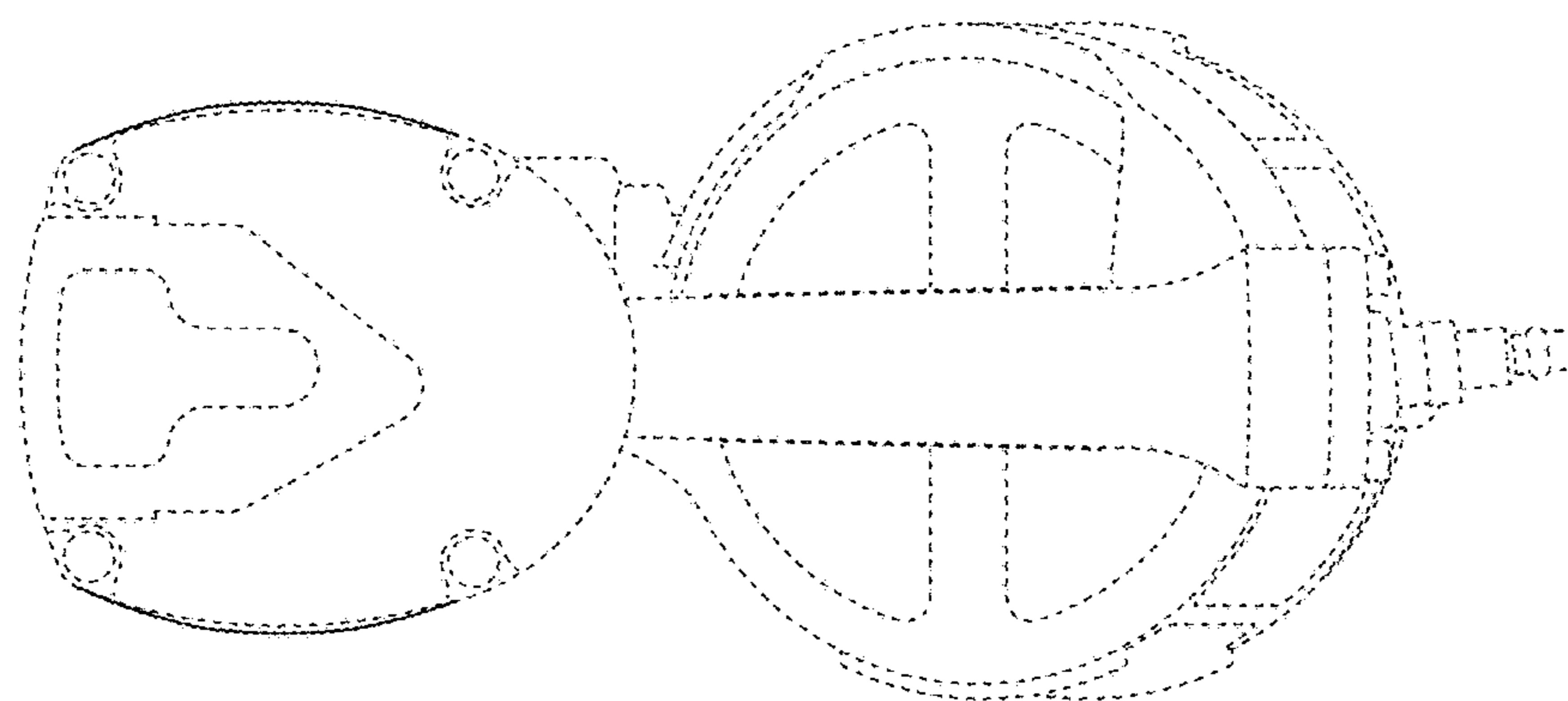

FIG. 13

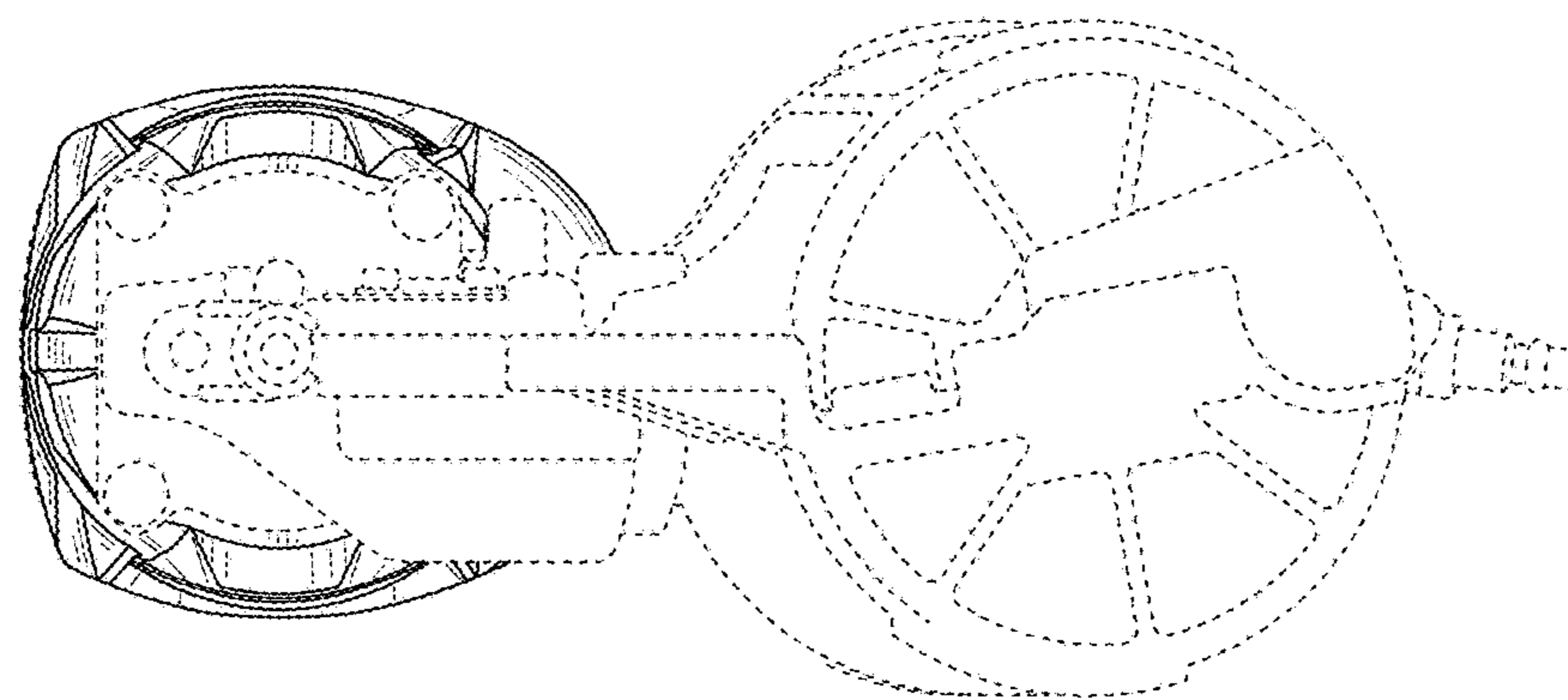

FIG. 14