



US00D800871S

(12) **United States Design Patent**  
**Arai**

(10) **Patent No.:** **US D800,871 S**  
(45) **Date of Patent:** **\*\* Oct. 24, 2017**

(54) **VALVE**  
(71) Applicant: **FUJIKOKI CORPORATION**, Tokyo (JP)  
(72) Inventor: **Yusuke Arai**, Tokyo (JP)  
(\*\*) Term: **15 Years**  
(21) Appl. No.: **35/500,726**

D693,903 S \* 11/2013 Tamura ..... D23/233  
D725,231 S \* 3/2015 Doi ..... D23/233  
D731,620 S \* 6/2015 Galle ..... D23/233  
D736,889 S \* 8/2015 Nishiyama ..... D23/233  
D740,918 S \* 10/2015 Morodomi ..... D23/233  
9,194,510 B2 \* 11/2015 Arai ..... F16K 31/406  
D753,796 S \* 4/2016 Suematsu ..... D23/233  
D753,797 S \* 4/2016 Suematsu ..... D23/233  
9,404,601 B2 \* 8/2016 Yoshida ..... F16K 31/0655  
9,546,737 B1 \* 1/2017 Wang ..... F16K 15/18

\* cited by examiner

(22) Filed: **Feb. 2, 2016**

*Primary Examiner* — Michael A. Pratt

(80) **Hague Agreement Data**

Int. Filing Date: **Feb. 2, 2016**  
Int. Reg. No.: **DM/089664**  
Int. Reg. Date: **Feb. 2, 2016**  
Int. Reg. Pub. Date: **Mar. 18, 2016**

(57) **CLAIM**

The ornamental design for a valve, as shown and described.

(51) **LOC (10) Cl.** ..... **23-01**  
(52) **U.S. Cl.**  
USPC ..... **D23/233**

**DESCRIPTION**

(58) **Field of Classification Search**  
USPC ..... D23/233, 321, 421; D10/49  
CPC .... F16K 31/0675; F16K 27/029; F16K 31/02;  
F16K 31/082; F16K 27/048; F16K 11/24;  
F24F 11/06; F25B 2600/2513  
See application file for complete search history.

- 1. Valve
- 1.1: Perspective
- 1.2: Front
- 1.3: Back
- 1.4: Top
- 1.5: Bottom
- 1.6: Right
- 1.7: Left

Design 1: a valve; the thin lines in the drawings illustrate the shape of the surface; the broken lines in the drawings illustrate environmental structures that form no part of the claimed design, more specifically the complete upper sole-noid in Figure 1.1 through 1.7 does not form a part of the claimed design, including all aspects of the electrical connector shown in Figure 1.6.

(56) **References Cited**

U.S. PATENT DOCUMENTS

D416,309 S \* 11/1999 Hayashi ..... D23/233  
D689,594 S \* 9/2013 Kumakura ..... D23/233

**1 Claim, 7 Drawing Sheets**

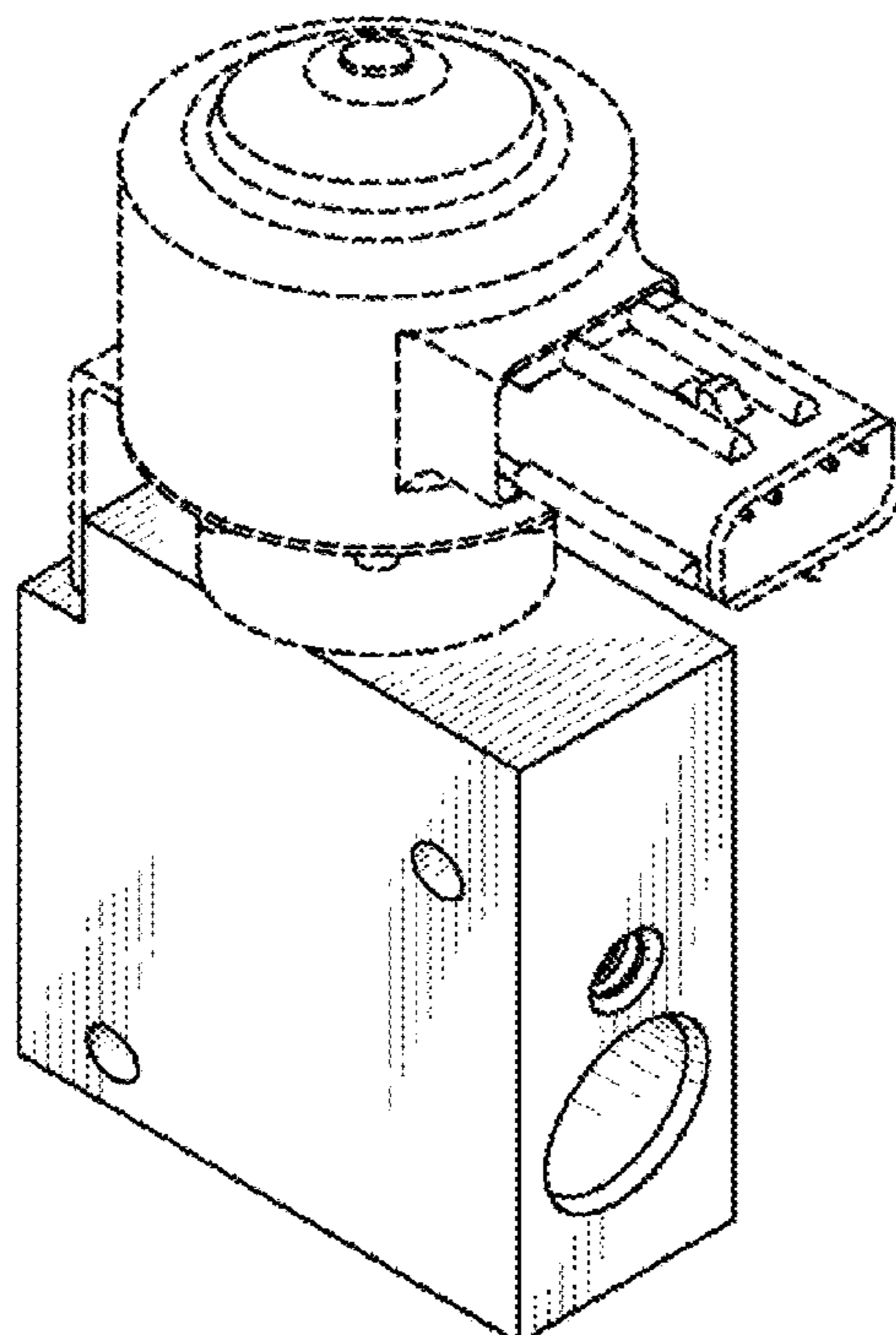

1.1

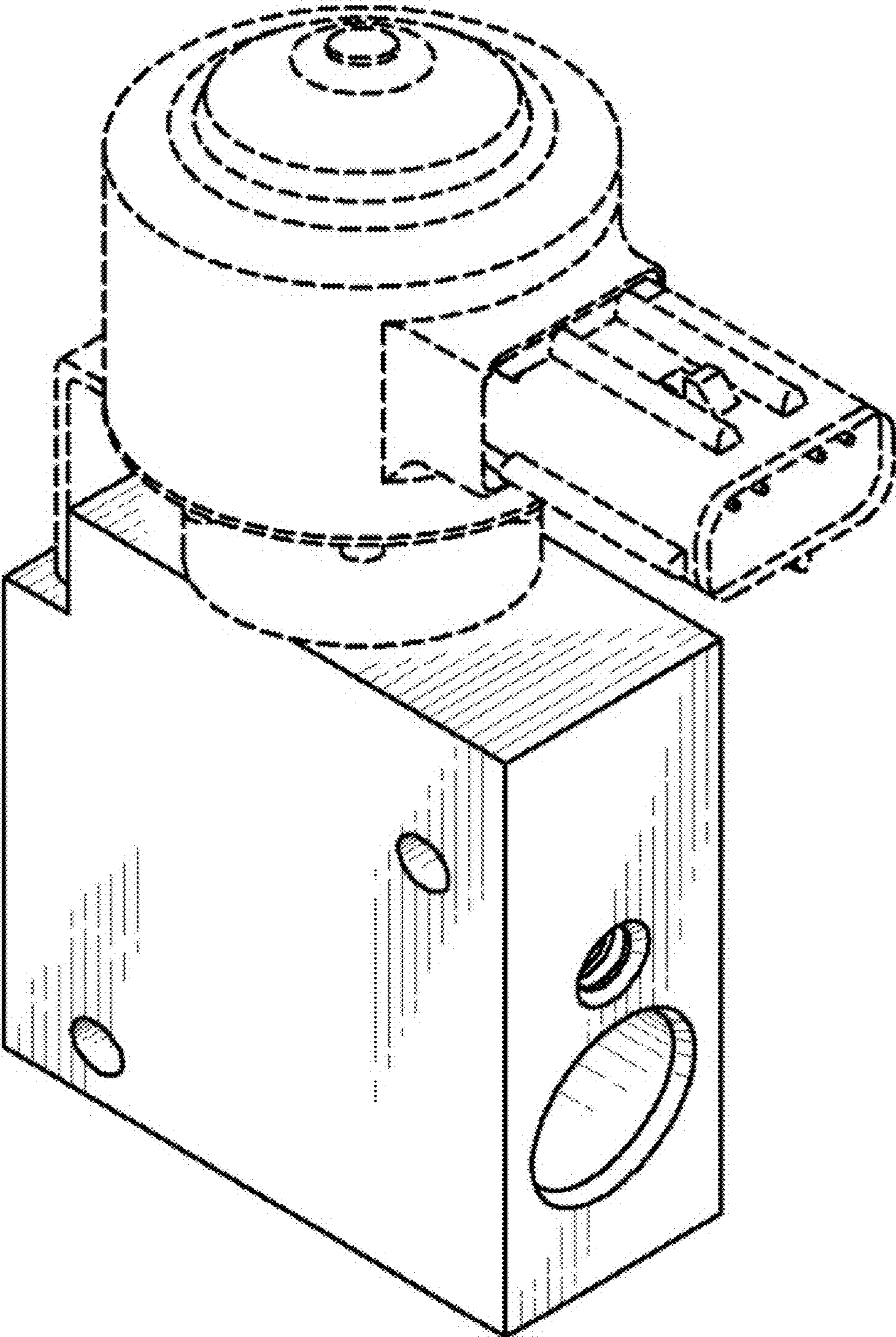

1.2

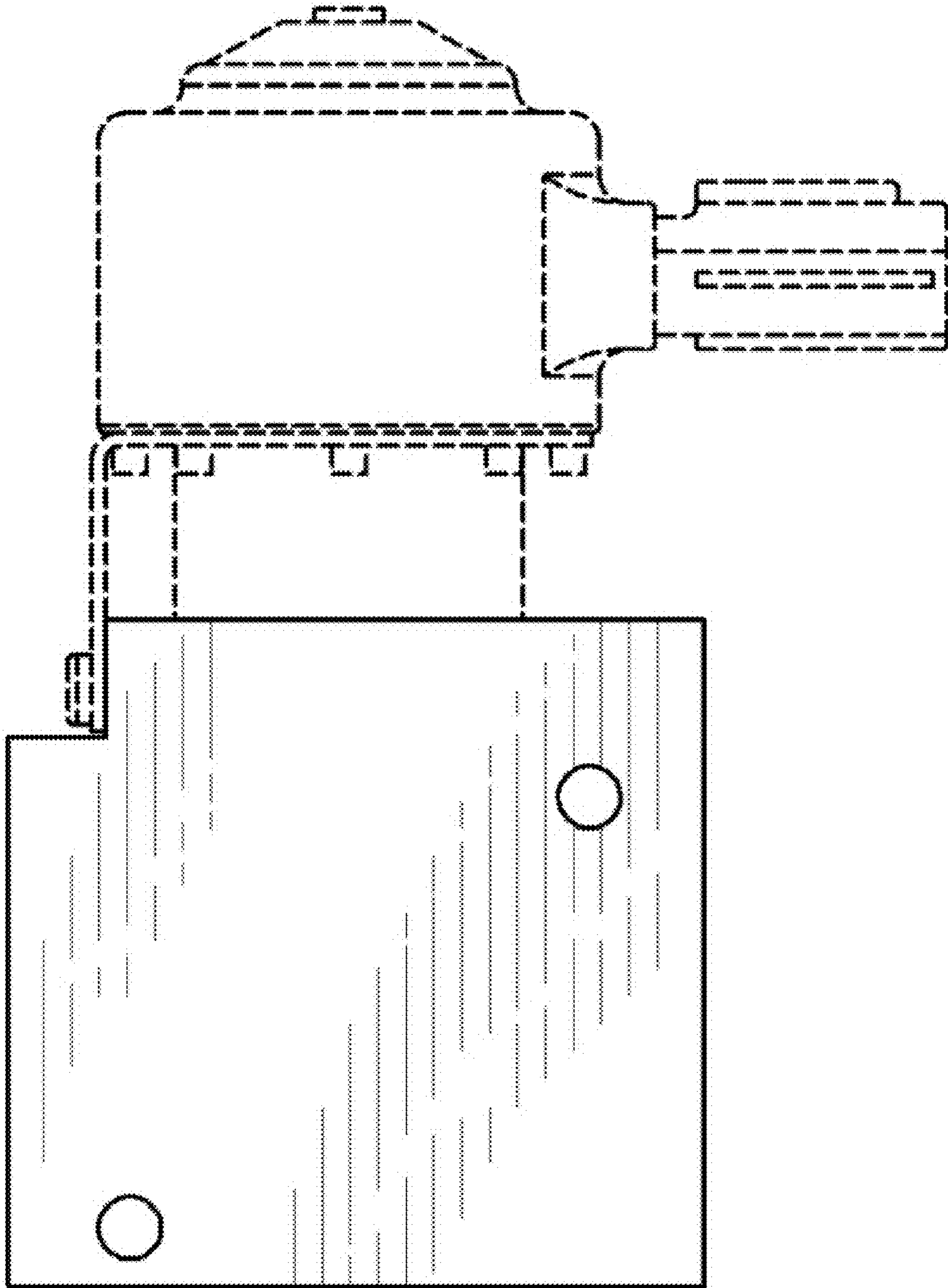

1.3

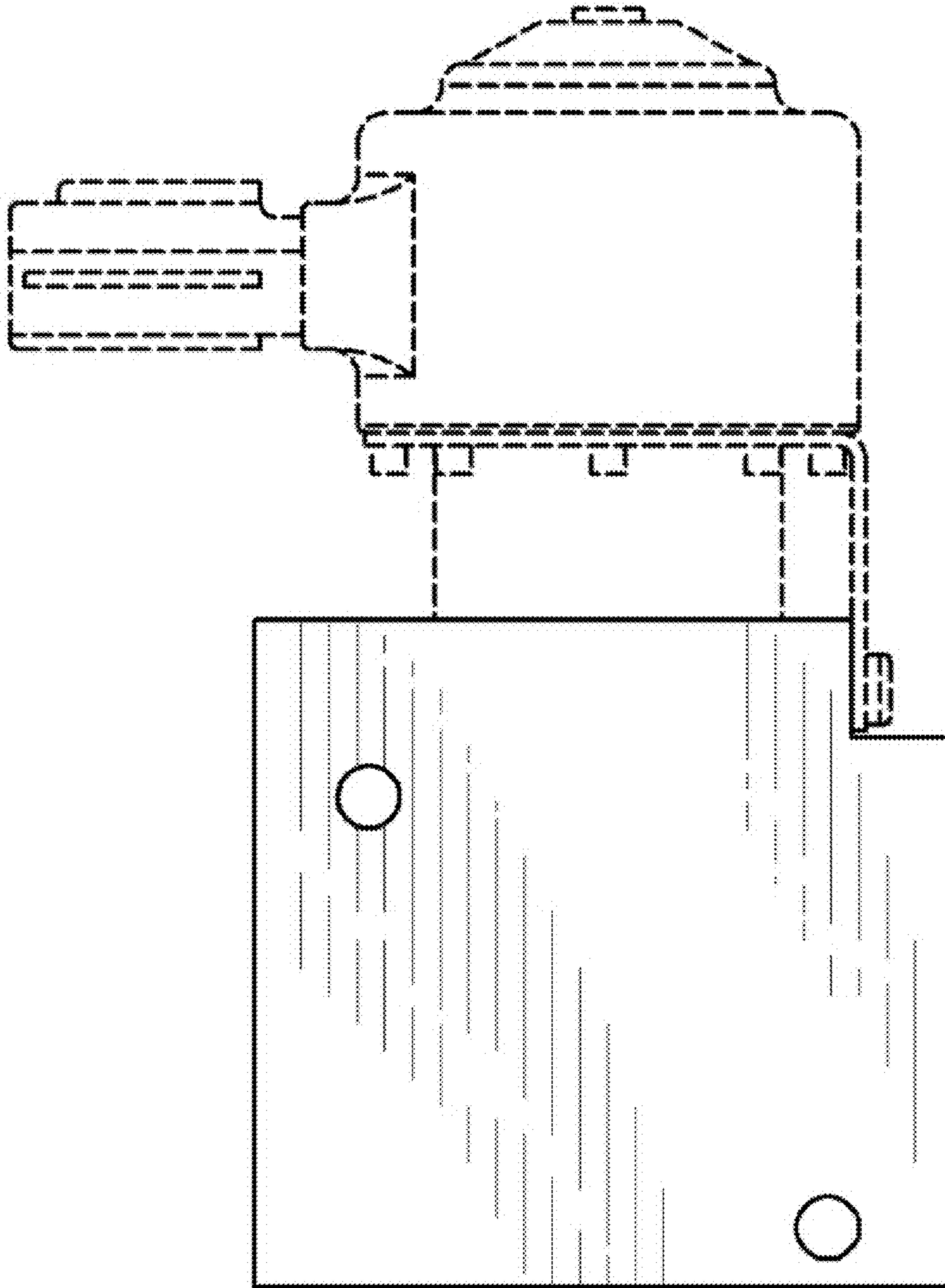

1.4

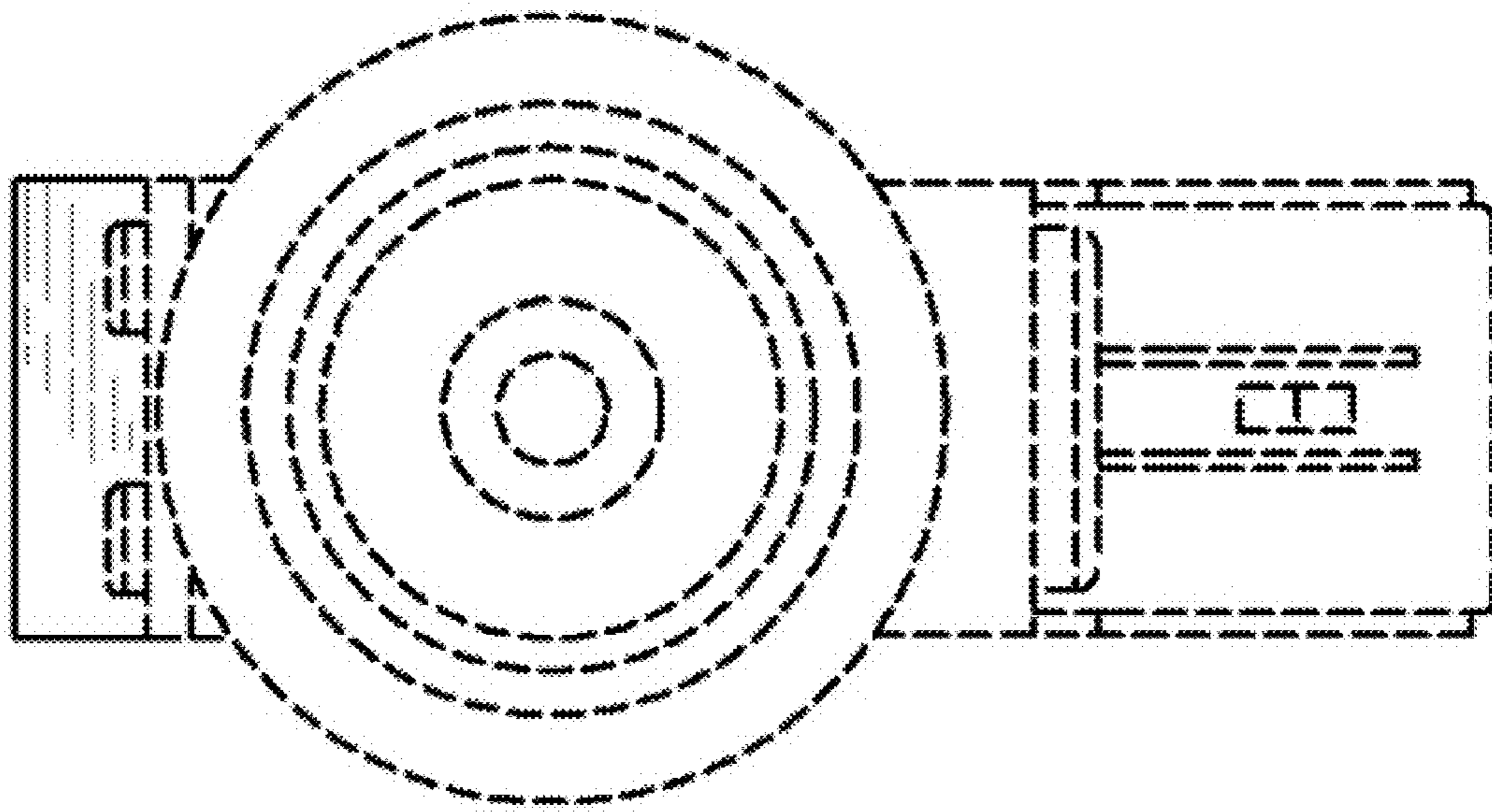

**1.5**

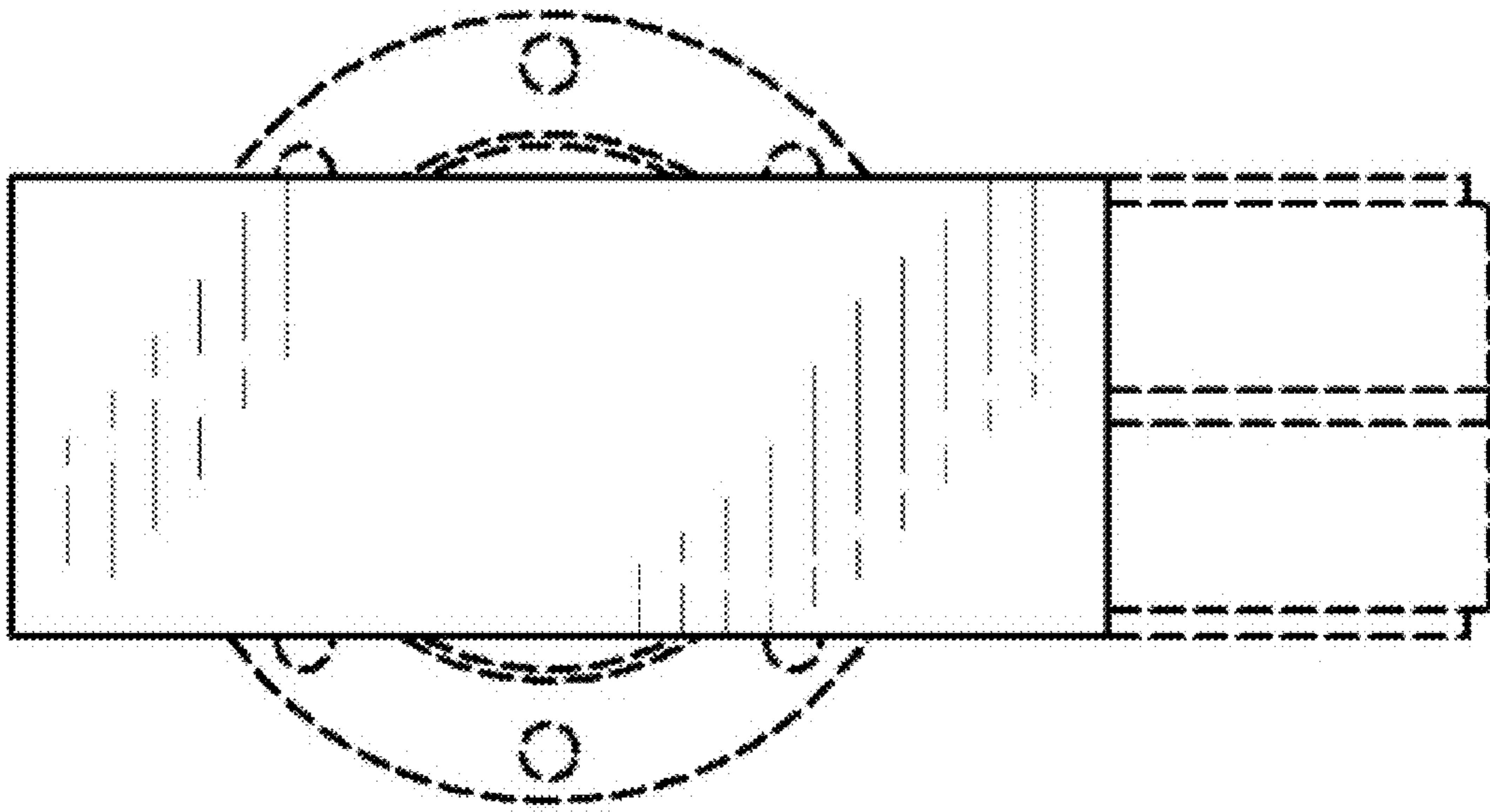

1.6

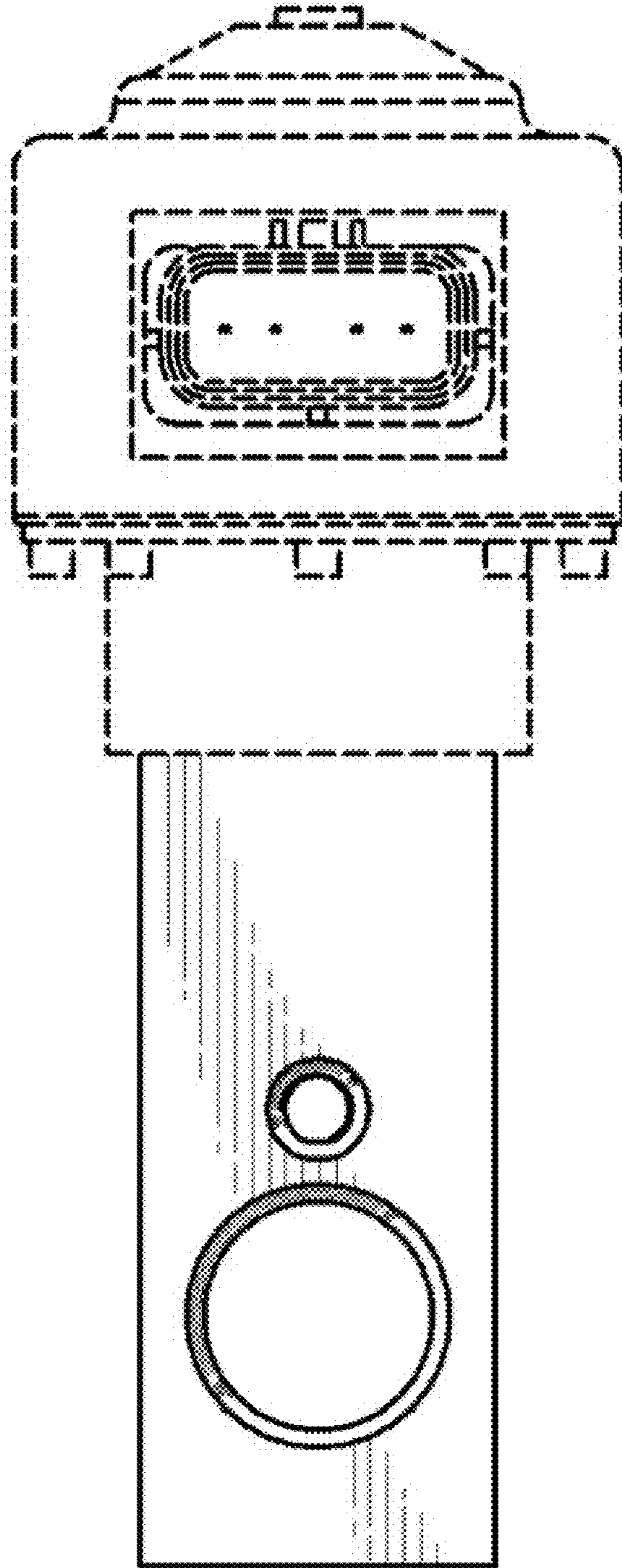

1.7

