



US00D800509S

(12) **United States Design Patent** (10) **Patent No.:** **US D800,509 S**  
**Rummel et al.** (45) **Date of Patent:** **\*\* Oct. 24, 2017**

(54) **HOLDER FOR A DRINKING VESSEL**  
(71) Applicant: **BRITA GMBH**, Taunusstein (DE)  
(72) Inventors: **Christian Rummel**, Benningen (DE);  
**Tim Storti**, Schwieberdingen (DE)  
(73) Assignee: **BRITA GMBH**, Taunusstein (DE)

(\*\*) Term: **15 Years**  
(21) Appl. No.: **29/574,760**  
(22) Filed: **Aug. 18, 2016**

(30) **Foreign Application Priority Data**

Mar. 24, 2016 (EM) ..... 003 040 906

(51) **LOC (10) Cl.** ..... **07-06**  
(52) **U.S. Cl.**  
USPC ..... **D7/622**

(58) **Field of Classification Search**  
USPC ..... D7/619.1-625, 605-608, 707-708, 533,  
D7/536, 393, 396.2, 509-511; D9/499,  
D9/455, 434, 436, 443  
CPC . A45F 5/10; A61J 9/06; B65D 23/106; B65D  
23/10; B65D 23/104; B65D 23/0233;  
B65D 23/0241; B65D 23/0216; A47G  
23/0266; A47G 23/0241; A47G 23/0258;  
A47G 23/02; A47J 45/10; A47J 45/077  
See application file for complete search history.

(56) **References Cited**

U.S. PATENT DOCUMENTS

D412,938 S \* 8/1999 Kesselring ..... D20/28  
D528,862 S \* 9/2006 Li ..... D7/510

D600,973 S \* 9/2009 Lane ..... D7/387  
D626,409 S \* 11/2010 Hooley ..... D7/622  
D699,516 S 2/2014 Kim  
D724,896 S 3/2015 Williams  
D736,562 S 8/2015 Green  
9,694,953 B2\* 7/2017 Meyers ..... B65D 47/247

FOREIGN PATENT DOCUMENTS

DE 49912013-0001 2/2000  
DE 40011218-0001 11/2000  
DE 402010002629-0001 5/2010  
DE 402012004085-0012 9/2012  
DE 402012004085-0023 9/2012  
DE 402012004085-0025 9/2012  
EM 000605902-0001 10/2006  
EM 000605902-0002 10/2006  
JP 1391631 S 7/2009  
JP 1509480 S 12/2012

\* cited by examiner

*Primary Examiner* — Terry Wallace

(74) *Attorney, Agent, or Firm* — Hudak, Shunk & Farine  
Co., LPA

(57) **CLAIM**

The ornamental design for a “holder for a drinking vessel,”  
as shown and described.

**DESCRIPTION**

FIG. 1 is a front right side slightly downward-looking  
perspective view of a holder for a drinking vessel;  
FIG. 2 is a top view thereof;  
FIG. 3 is a bottom view thereof;  
FIG. 4 is a right side view thereof;  
FIG. 5 is a left side view thereof;  
FIG. 6 is a front view thereof; and,  
FIG. 7 is a rear view thereof.

**1 Claim, 7 Drawing Sheets**

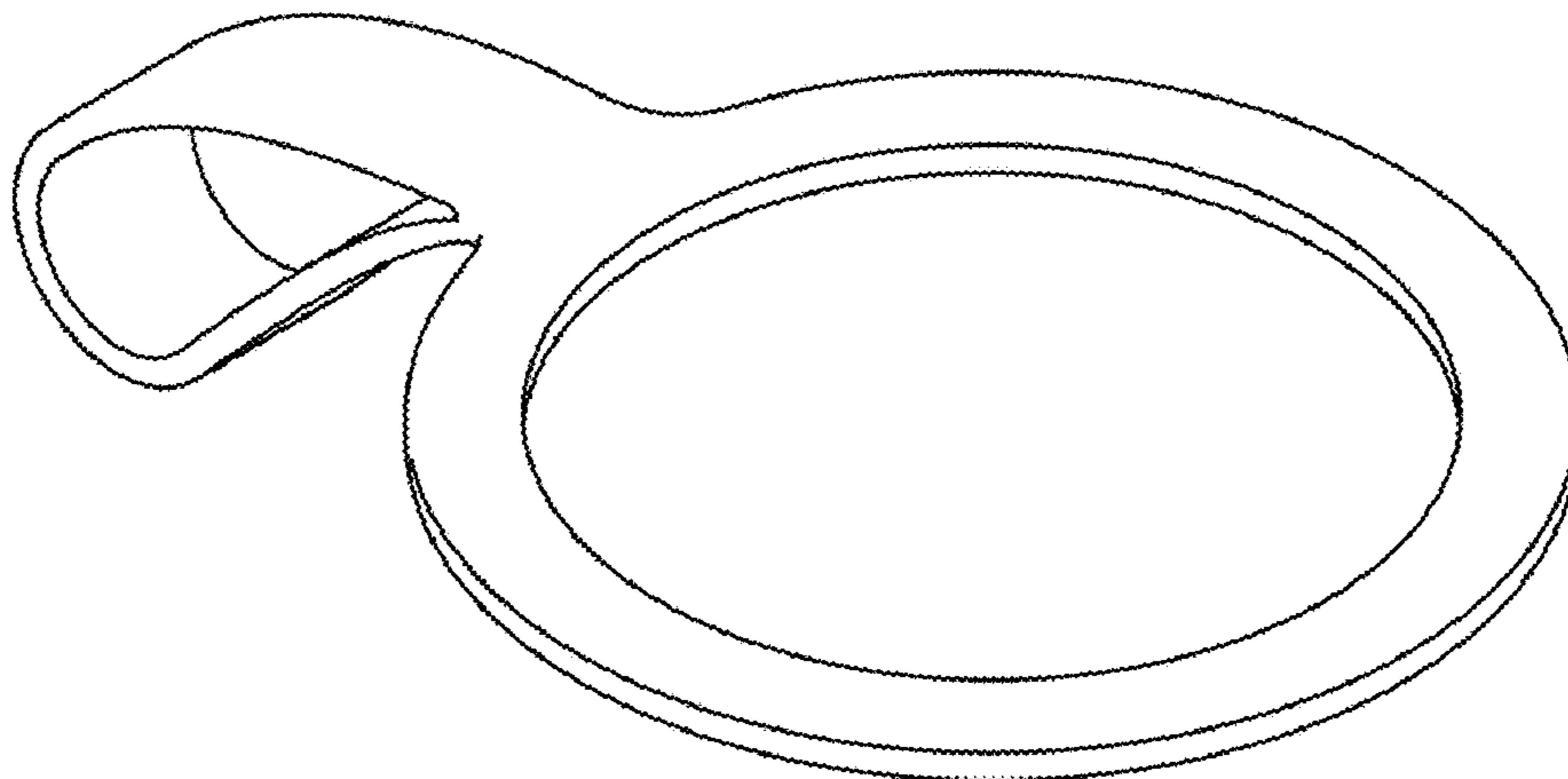

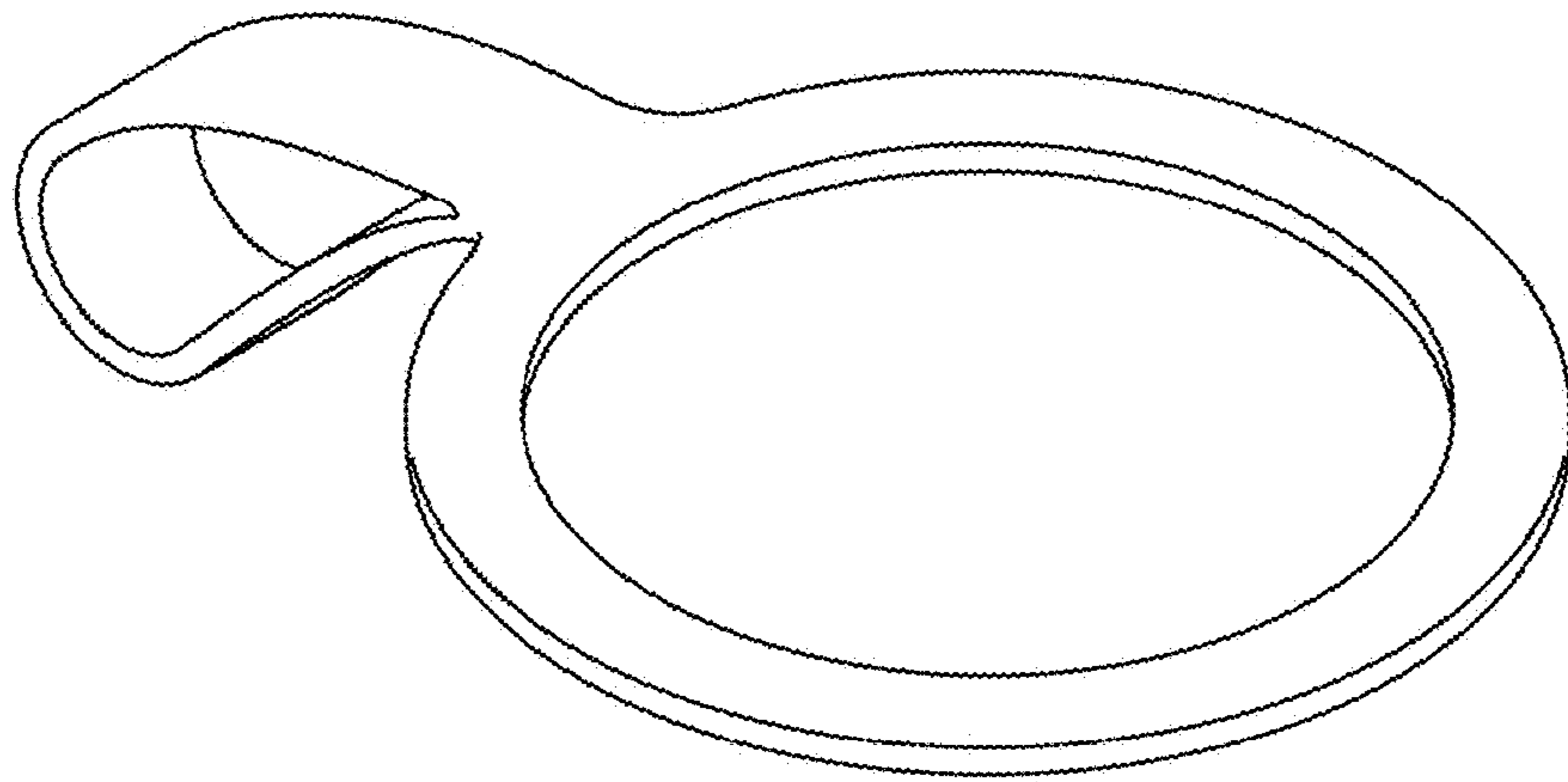

FIG. 1

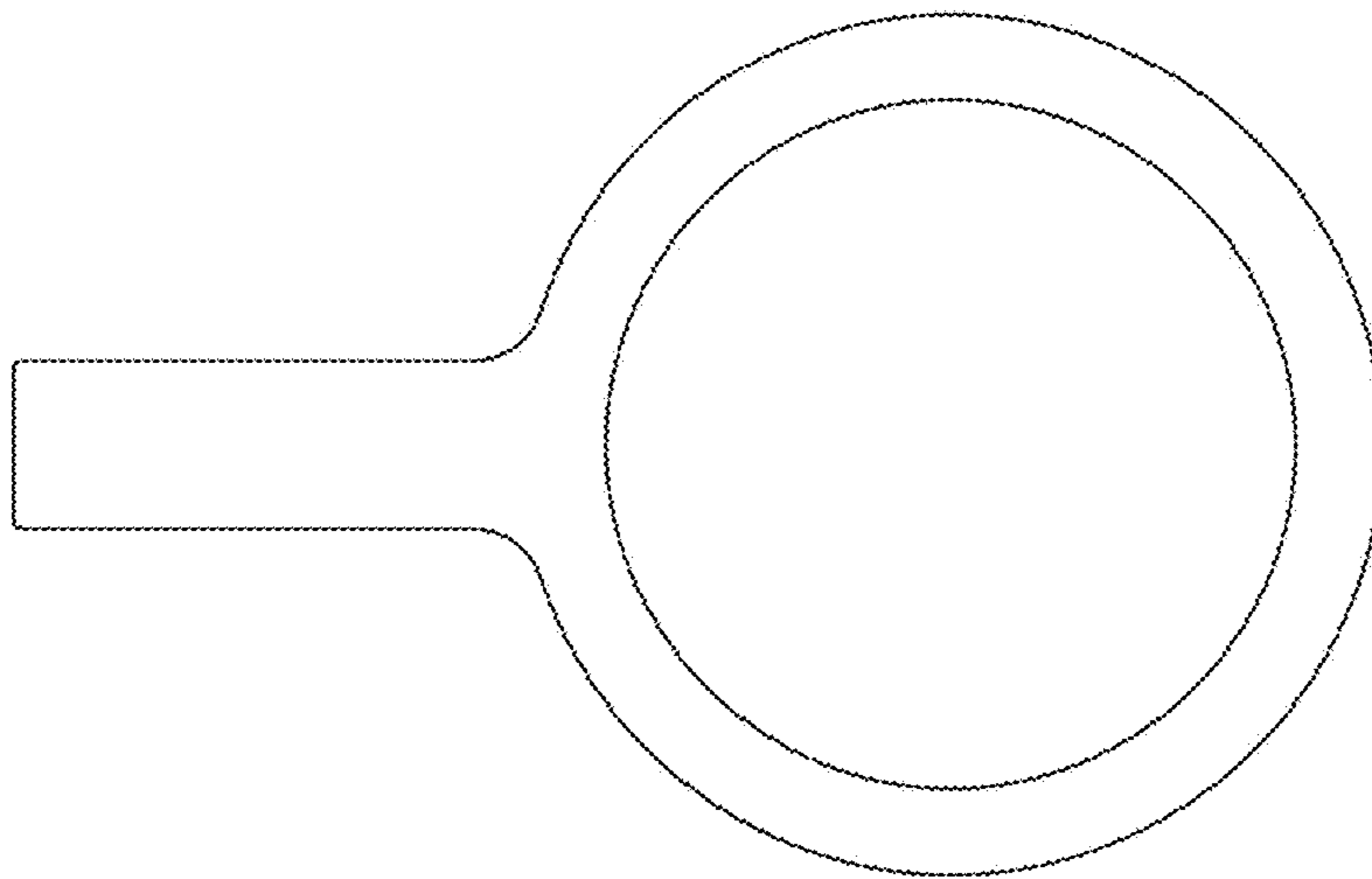
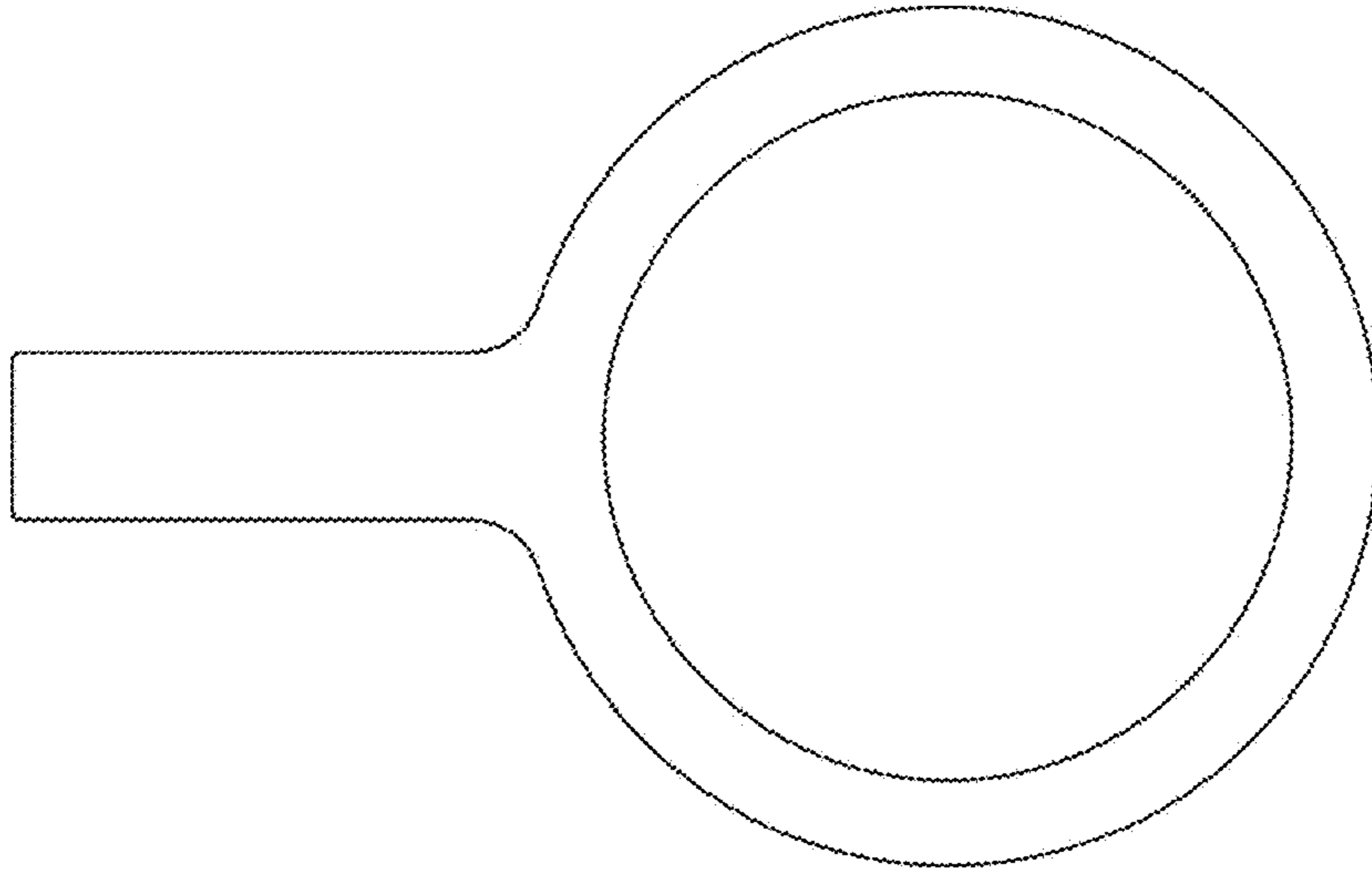

FIG. 2



**FIG. 3**

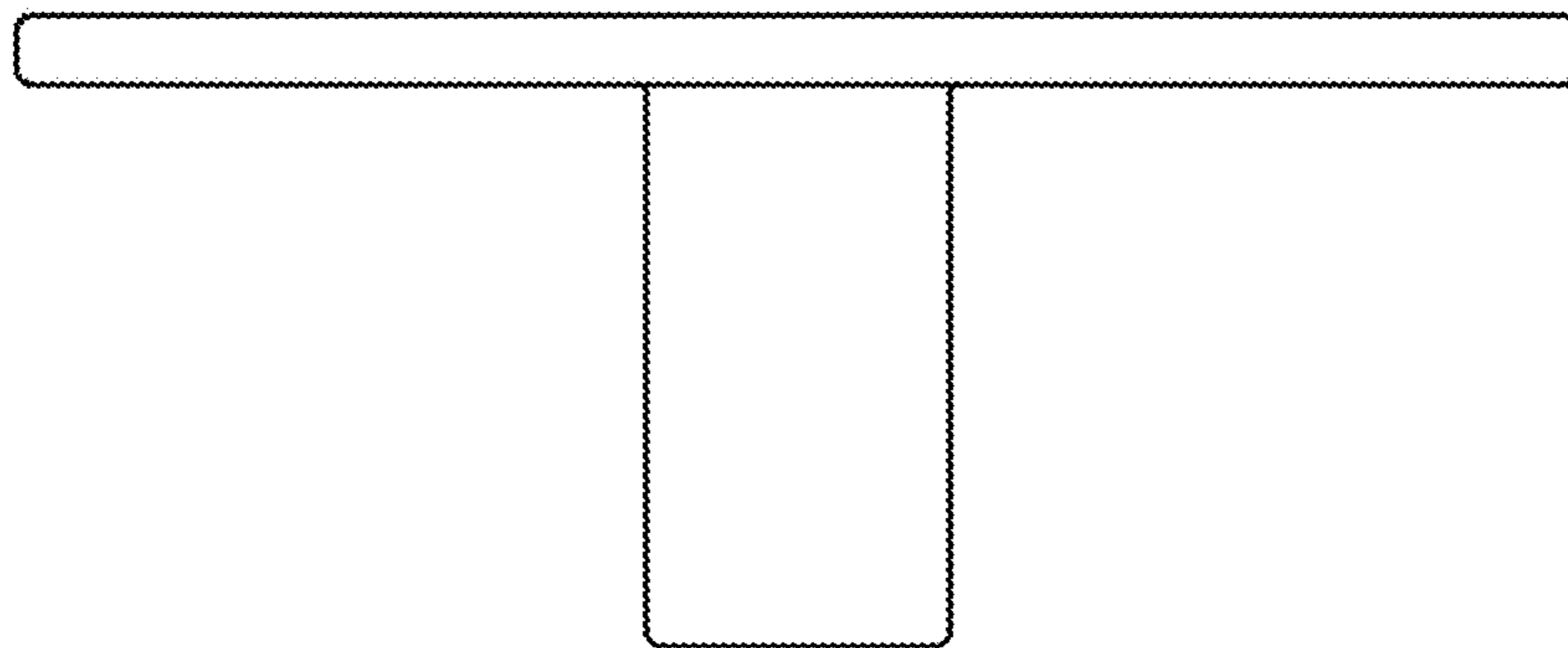

FIG. 4

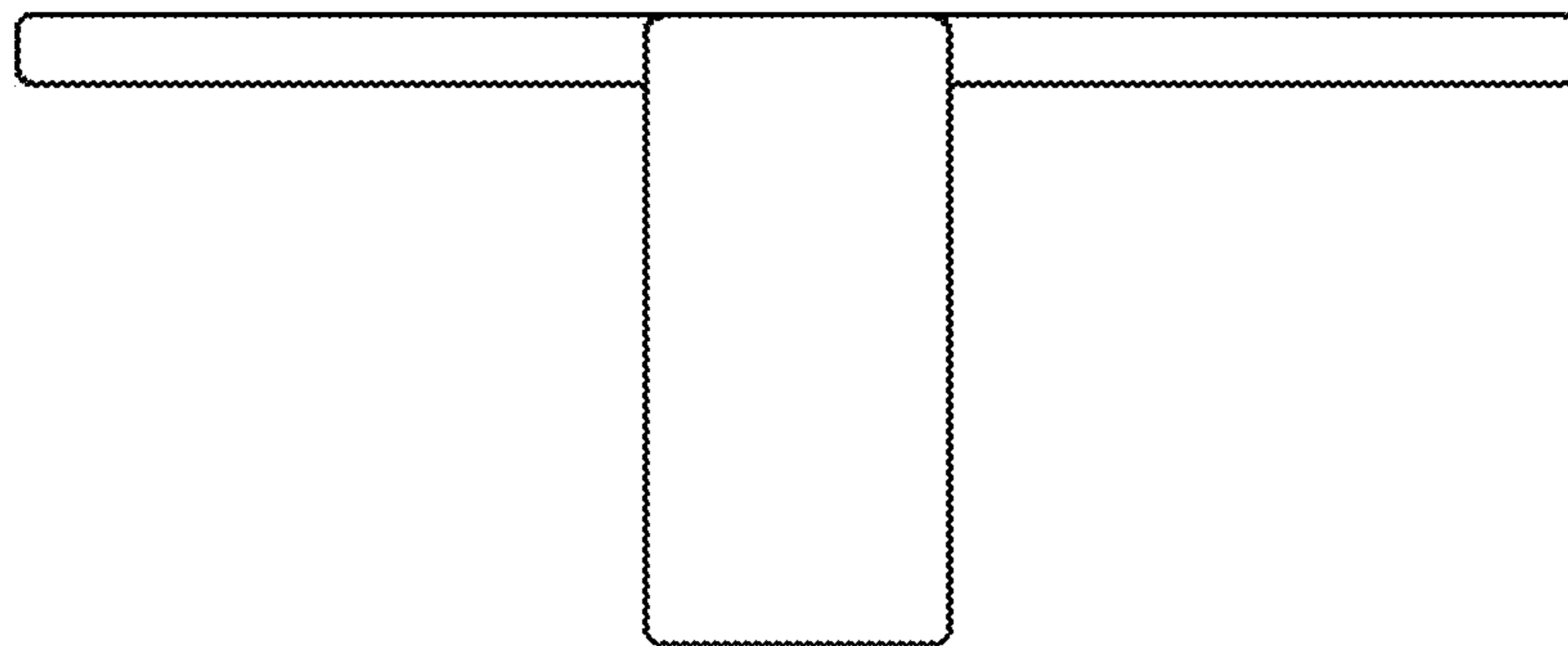

FIG. 5

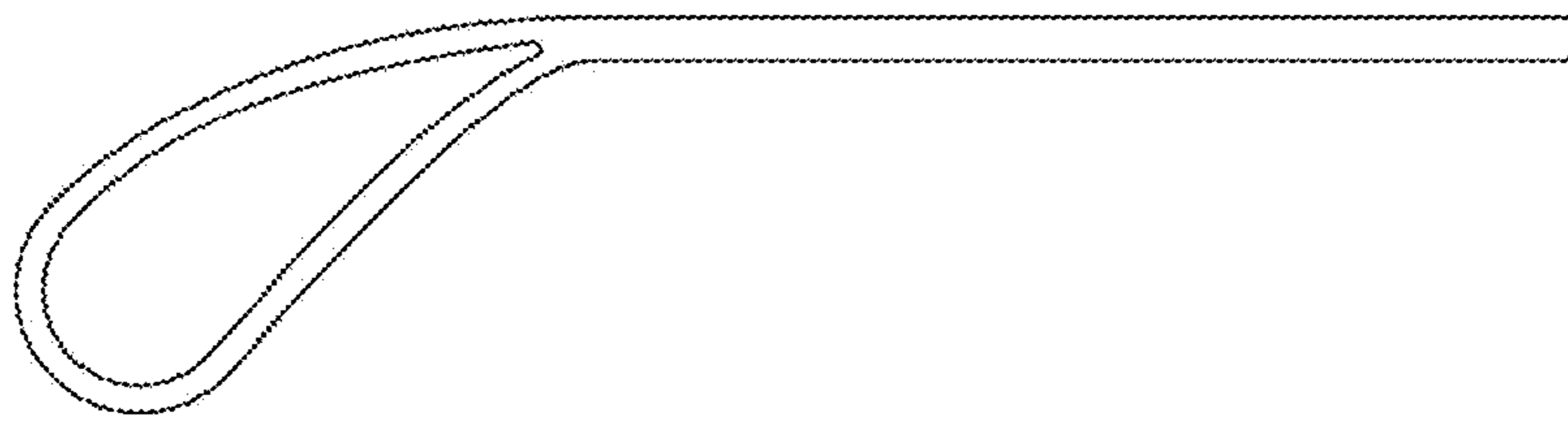

FIG. 6

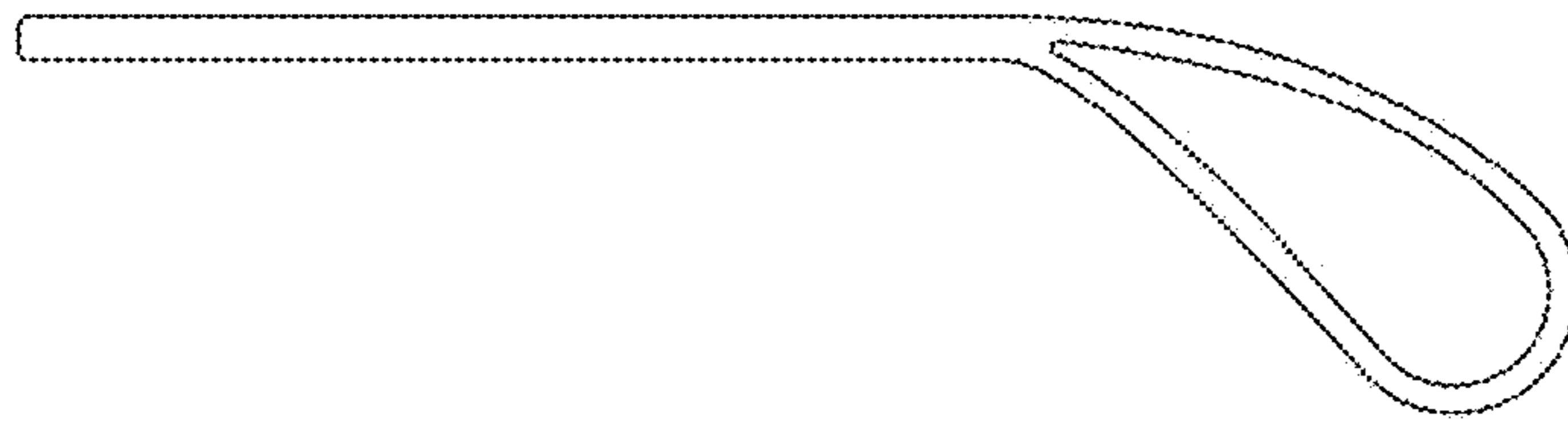

FIG. 7