



US00D800186S

(12) **United States Design Patent** (10) **Patent No.:** **US D800,186 S**
Maeda et al. (45) **Date of Patent:** **** Oct. 17, 2017**

(54) **REFRIGERATING MACHINE**

(56) **References Cited**

(71) Applicant: **Mitsubishi Electric Corporation,**
Tokyo (JP)
(72) Inventors: **Koichi Maeda,** Tokyo (JP); **Kenichiro Toriumi,** Tokyo (JP); **Ataru Nakamura,** Tokyo (JP); **Hajime Fujimoto,** Tokyo (JP); **Hiroshi Sata,** Tokyo (JP)
(73) Assignee: **Mitsubishi Electric Corporation,**
Tokyo (JP)

U.S. PATENT DOCUMENTS

2,077,348 A	4/1937	Gaston	
2,109,986 A	3/1938	Atchison	
6,484,364 B2	11/2002	Turner	
D584,596 S	1/2009	Doverspike	
D612,226 S	3/2010	Dinh	
7,857,267 B2 *	12/2010	Watts	H05K 7/1489 211/41.12
D636,618 S	4/2011	Kundinger et al.	
D645,623 S	9/2011	Helot et al.	
D667,718 S	9/2012	Preda	
8,297,450 B2 *	10/2012	Zavidniak	H05K 7/183 211/13.1

(**) Term: **15 Years**

(Continued)

(21) Appl. No.: **29/592,088**

Primary Examiner — Ian Simmons

(22) Filed: **Jan. 26, 2017**

Assistant Examiner — Khawaja Anwar

Related U.S. Application Data

(74) *Attorney, Agent, or Firm* — Stuebaker & Brackett
PC

(62) Division of application No. 29/524,992, filed on Apr. 24, 2015, now Pat. No. Des. 788,189.

(30) **Foreign Application Priority Data**

(57) **CLAIM**

Jan. 15, 2015	(JP)	2015-000548
Jan. 15, 2015	(JP)	2015-000550
Jan. 15, 2015	(JP)	2015-000551
Jan. 15, 2015	(JP)	2015-000552

The ornamental design for refrigerating machine, as shown and described.

(51) **LOC (10) Cl.** **15-07**

(52) **U.S. Cl.**
USPC **D15/89**

DESCRIPTION

(58) **Field of Classification Search**
USPC D15/79-91; D8/349, 354, 363, 366, 371, D8/373, 380, 381, 382, 384; D32/1, 5-6, D32/8, 10, 25
CPC .. F25D 23/028; F25D 23/062; F25D 2500/06; F25D 2600/00; F25D 2700/02; F25D 2700/06; F25D 2700/08; F25D 29/00; A47F 3/0434; A47F 11/10; A47F 3/001; A47F 3/043

FIG. 1 is a perspective view of the front, right, and top sides of a refrigerating machine showing our new design;
FIG. 2 is a front view thereof;
FIG. 3 is a rear view thereof;
FIG. 4 is a left side view thereof;
FIG. 5 is a right side view thereof;
FIG. 6 is a top view thereof; and,
FIG. 7 is a bottom view thereof.

The broken line in the figure drawings is included for the purpose of illustrating environment and forms no part of the claimed design.

See application file for complete search history.

1 Claim, 7 Drawing Sheets

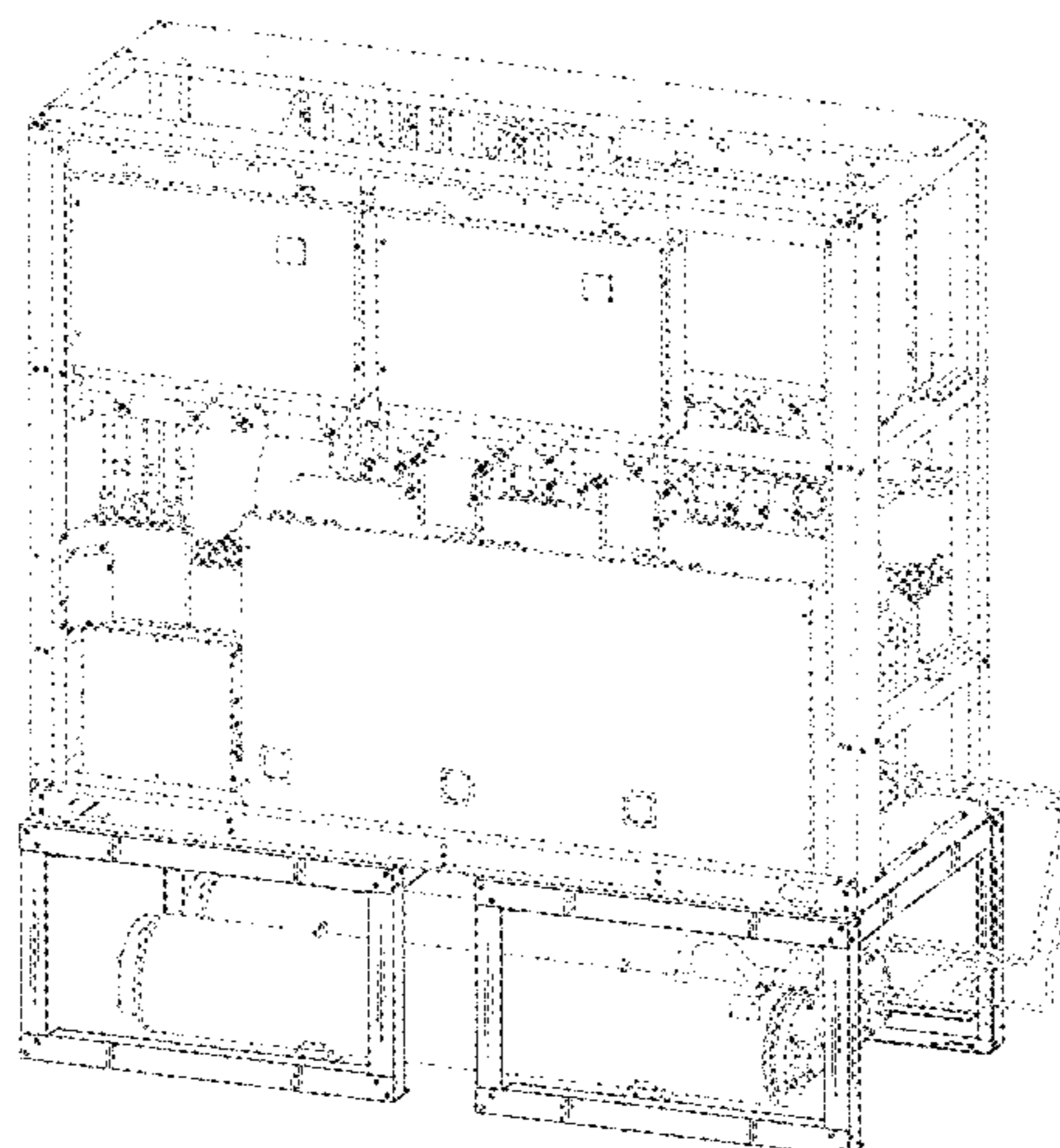

(56)

References Cited

U.S. PATENT DOCUMENTS

D681,072	S	4/2013	Sata et al.	
D681,076	S	4/2013	Sata et al.	
D708,875	S *	7/2014	McNamara	D6/705
D760,579	S *	7/2016	Tonthat	D8/354
D788,189	S *	5/2017	Maeda	D15/89
2003/0155319	A1 *	8/2003	Wishart	A47B 47/027 211/189
2004/0007550	A1 *	1/2004	Leeman	A47F 5/101 211/189
2005/0145588	A1 *	7/2005	Stitchick	A47B 47/022 211/183
2009/0178983	A1 *	7/2009	Green	H05K 7/186 211/13.1

* cited by examiner

Fig. 1

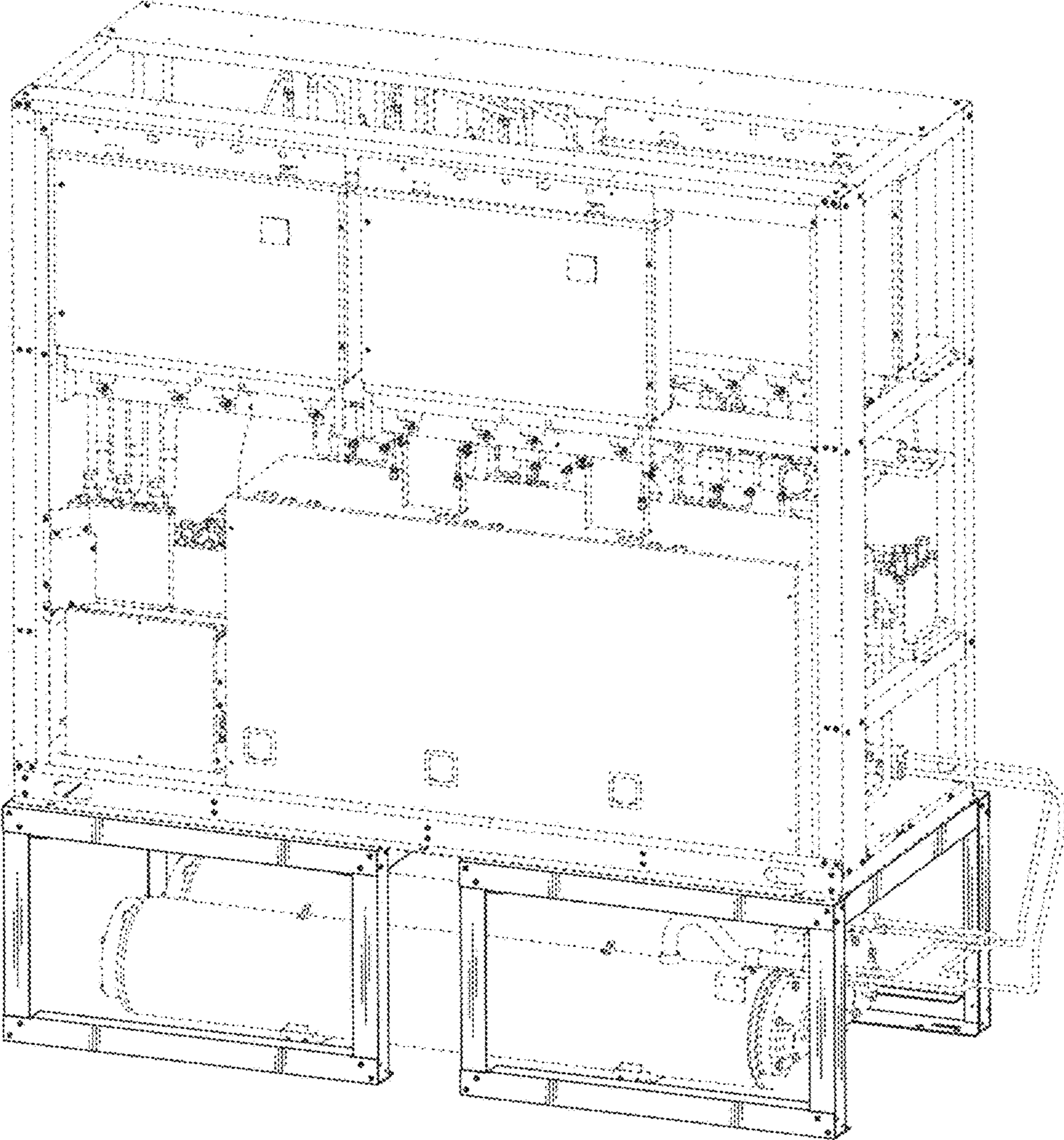

Fig. 2

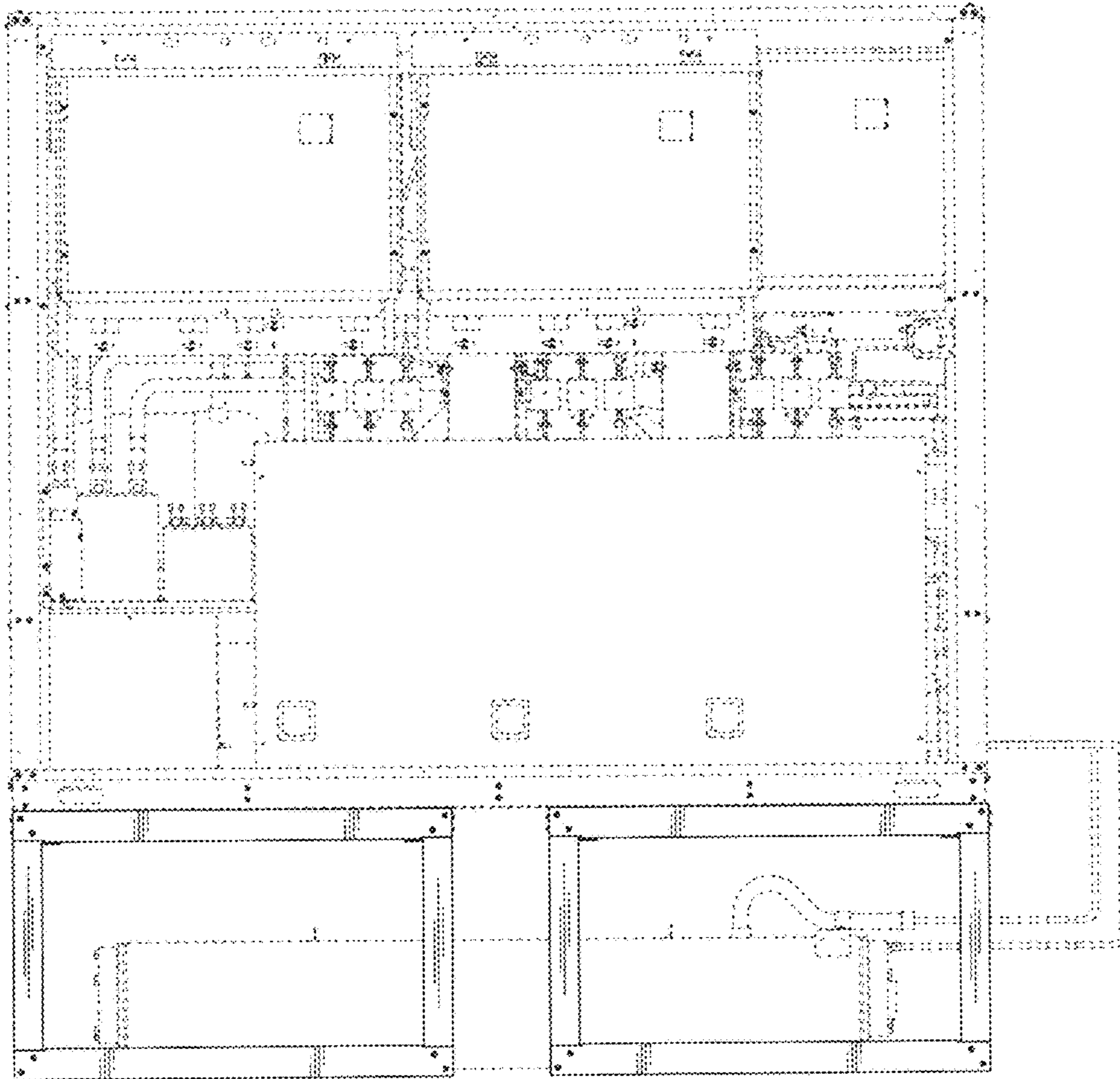

Fig. 3

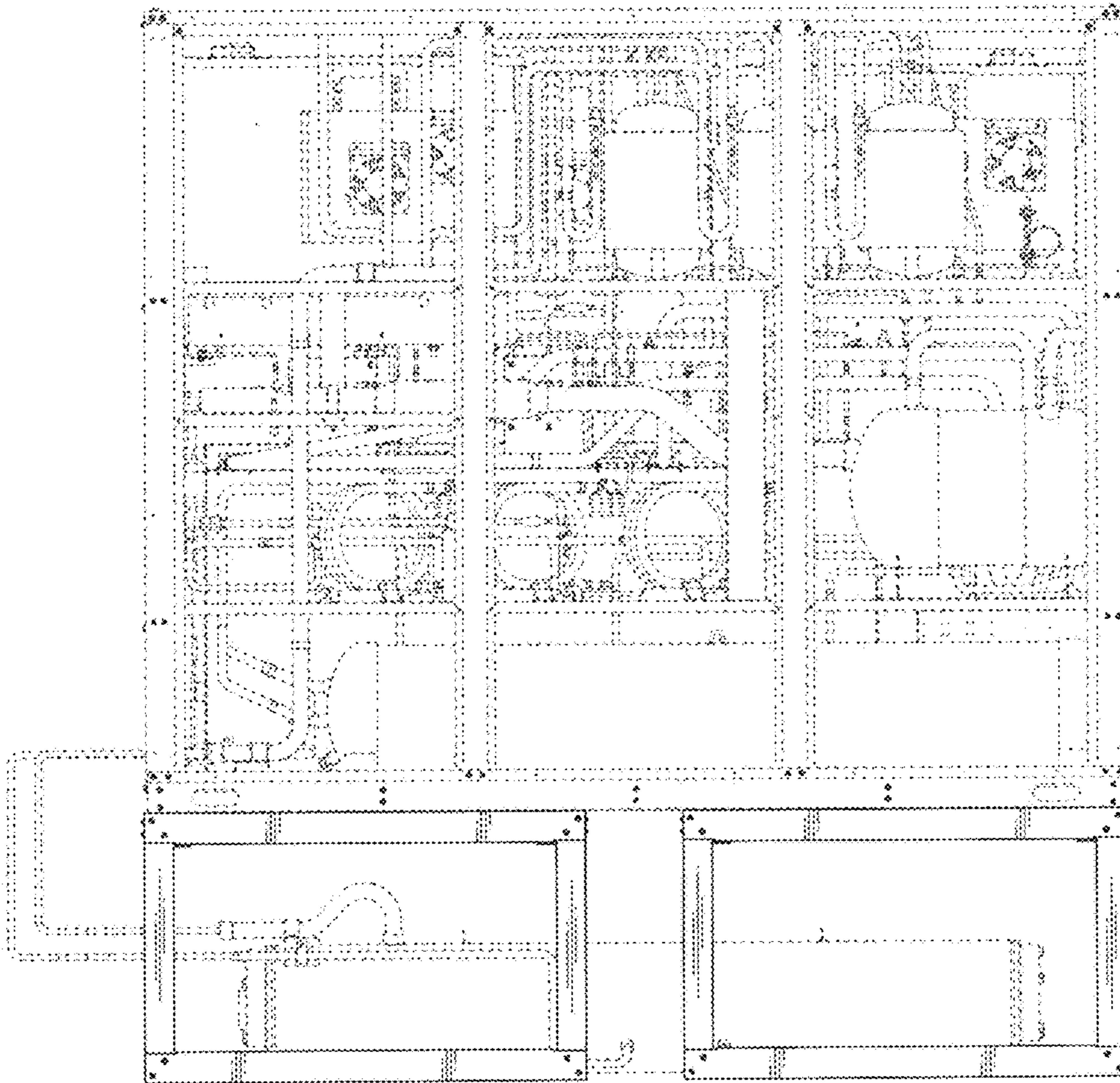

Fig. 4

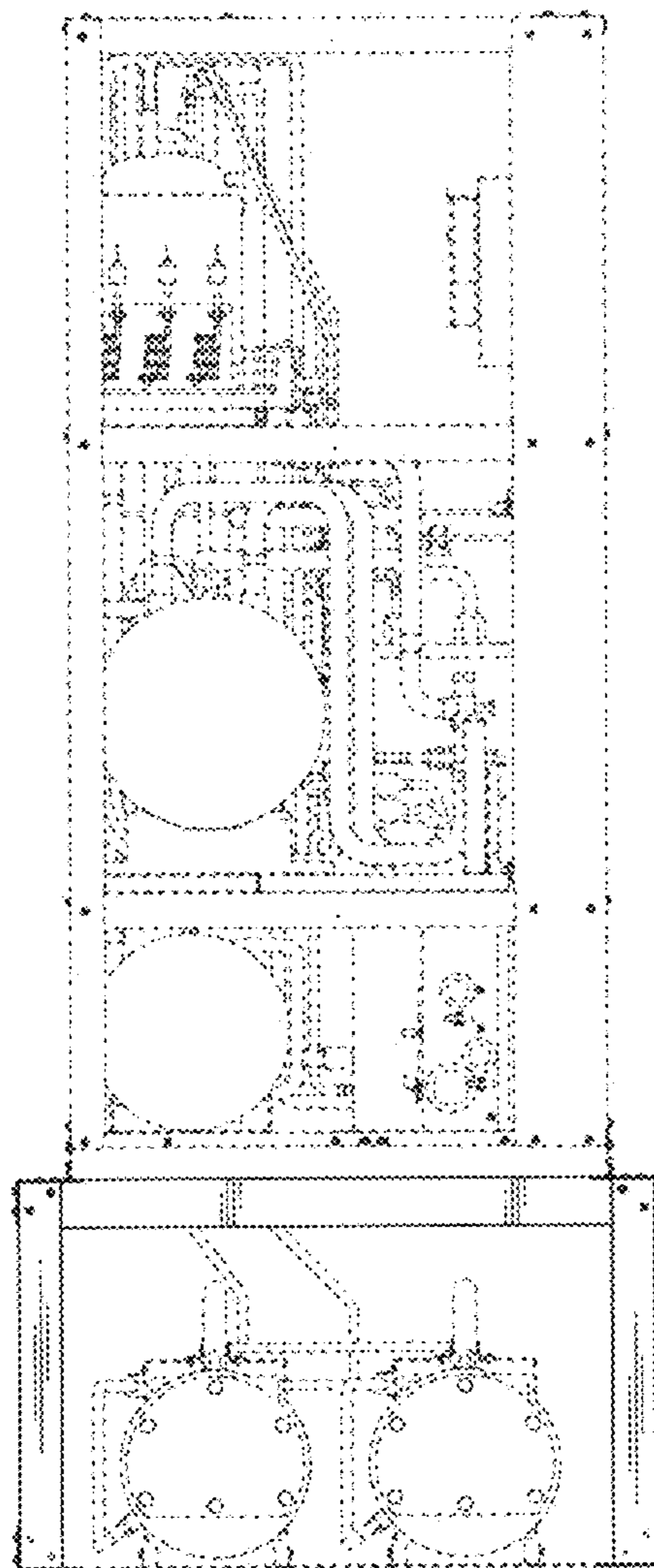

Fig. 5

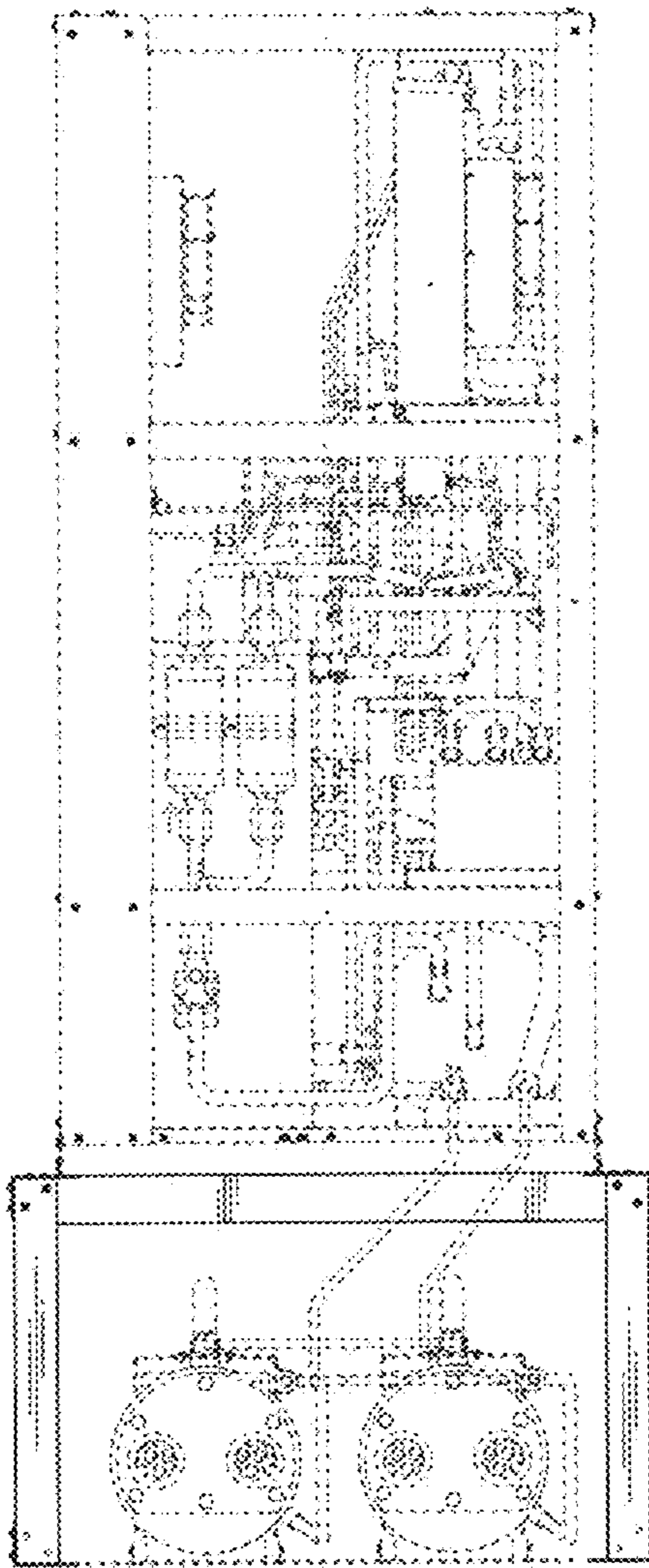

Fig. 6

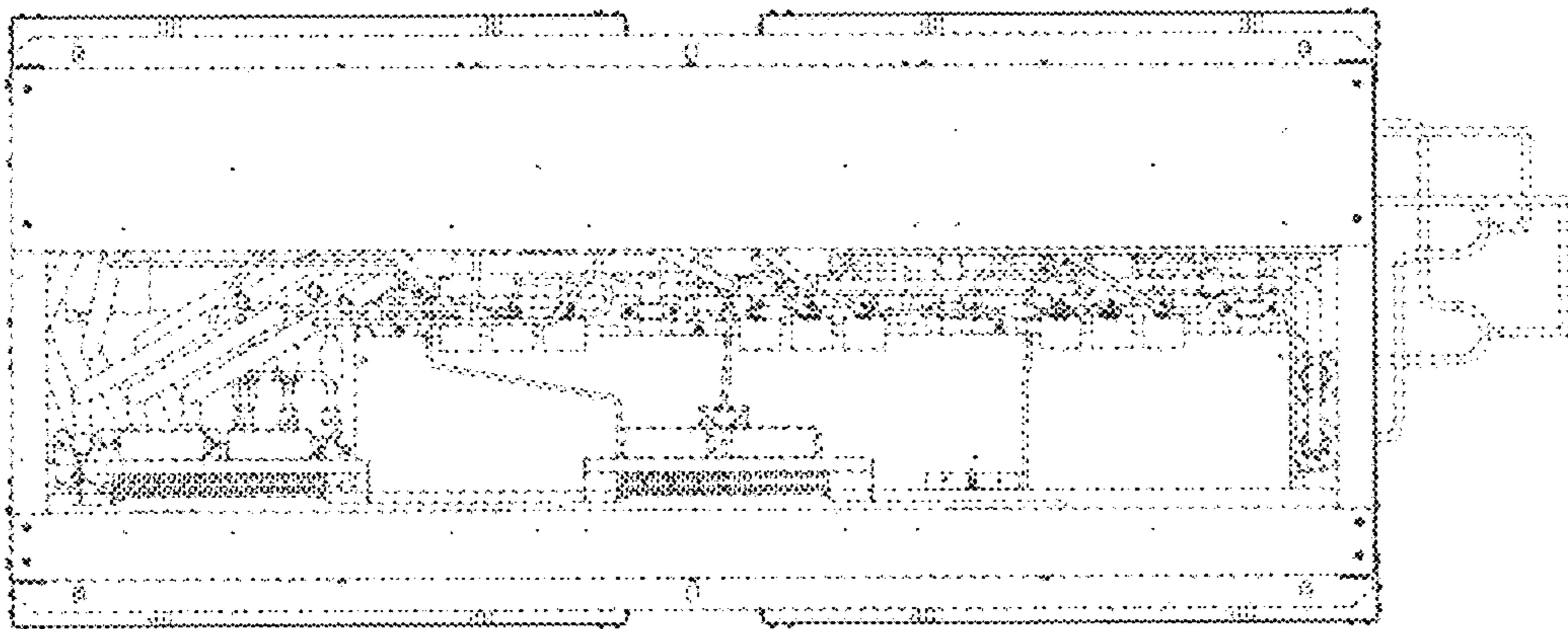

Fig. 7

