



US00D800134S

(12) **United States Design Patent** (10) **Patent No.:** **US D800,134 S**
McDonald (45) **Date of Patent:** **** Oct. 17, 2017**

- (54) **CHARGING STAND**
- (71) Applicant: **DesignPro Innovations LLC**, Stewart Manor, NY (US)
- (72) Inventor: **Patrick McDonald**, Stewart Manor, NY (US)
- (73) Assignee: **DesignPro Innovations LLC**, Stewart Manor, NY (US)
- (**) Term: **15 Years**
- (21) Appl. No.: **29/532,063**
- (22) Filed: **Jul. 1, 2015**
- (51) **LOC (10) Cl.** **08-07**
- (52) **U.S. Cl.**
USPC **D14/447**; D13/108
- (58) **Field of Classification Search**
USPC D13/107-110, 118-119, 184; D14/251, D14/253, 432, 434, 447
CPC Y02E 60/12; Y02T 90/14; Y02T 90/122; Y02T 90/128; Y02T 90/163; H02J 7/025; H02J 7/0042; H02J 7/0044; H02J 7/0045; H02J 7/0003; H01F 38/14; H01R 13/6675; H01M 2/1022; H01M 2/1055; H01M 10/44; H01M 10/46; H01M 10/425; B60L 11/182
See application file for complete search history.

- (56) **References Cited**
U.S. PATENT DOCUMENTS
6,129,323 A * 10/2000 Mandokoro A47B 21/045 24/67 R
D558,192 S * 12/2007 Daly D14/251

D579,278 S *	10/2008	Umnitz	D7/637
D666,174 S *	8/2012	Du	D14/217
D676,054 S *	2/2013	Izen	D14/447
D677,260 S *	3/2013	Hong	D14/447
D683,141 S *	5/2013	Symons	D14/447
D689,744 S *	9/2013	Tarantino	D19/86
D693,826 S *	11/2013	Ashida	D14/447
D714,297 S *	9/2014	Poulsen	D14/447
D717,306 S *	11/2014	Clouser	D14/447
D722,065 S *	2/2015	Zwerner	D14/447
D756,367 S *	5/2016	Kim	D14/447
D760,214 S *	6/2016	Kemper	D14/253
2005/0162508 A1 *	7/2005	Basmadjian	H04N 5/2251 348/14.01
2010/0282924 A1 *	11/2010	Boies	A47B 23/042 248/163.1

* cited by examiner

Primary Examiner — Rosemary K Tarcza
Assistant Examiner — Nathaniel D Buckner
(74) *Attorney, Agent, or Firm* — Schroeder Law PC

(57) **CLAIM**

The ornamental design for a charging stand, as shown and described.

DESCRIPTION

FIG. 1 is a front perspective view of a charging stand showing my new design;
FIG. 2 is another front perspective view;
FIG. 3 is a left side elevation view, the right side elevation view being a mirror image thereof
FIG. 4 is a front elevation view thereof; and,
FIG. 5 is a rear elevation view thereof.
The broken lines in the figures represent portions of the article which form no part of the claim.

1 Claim, 5 Drawing Sheets

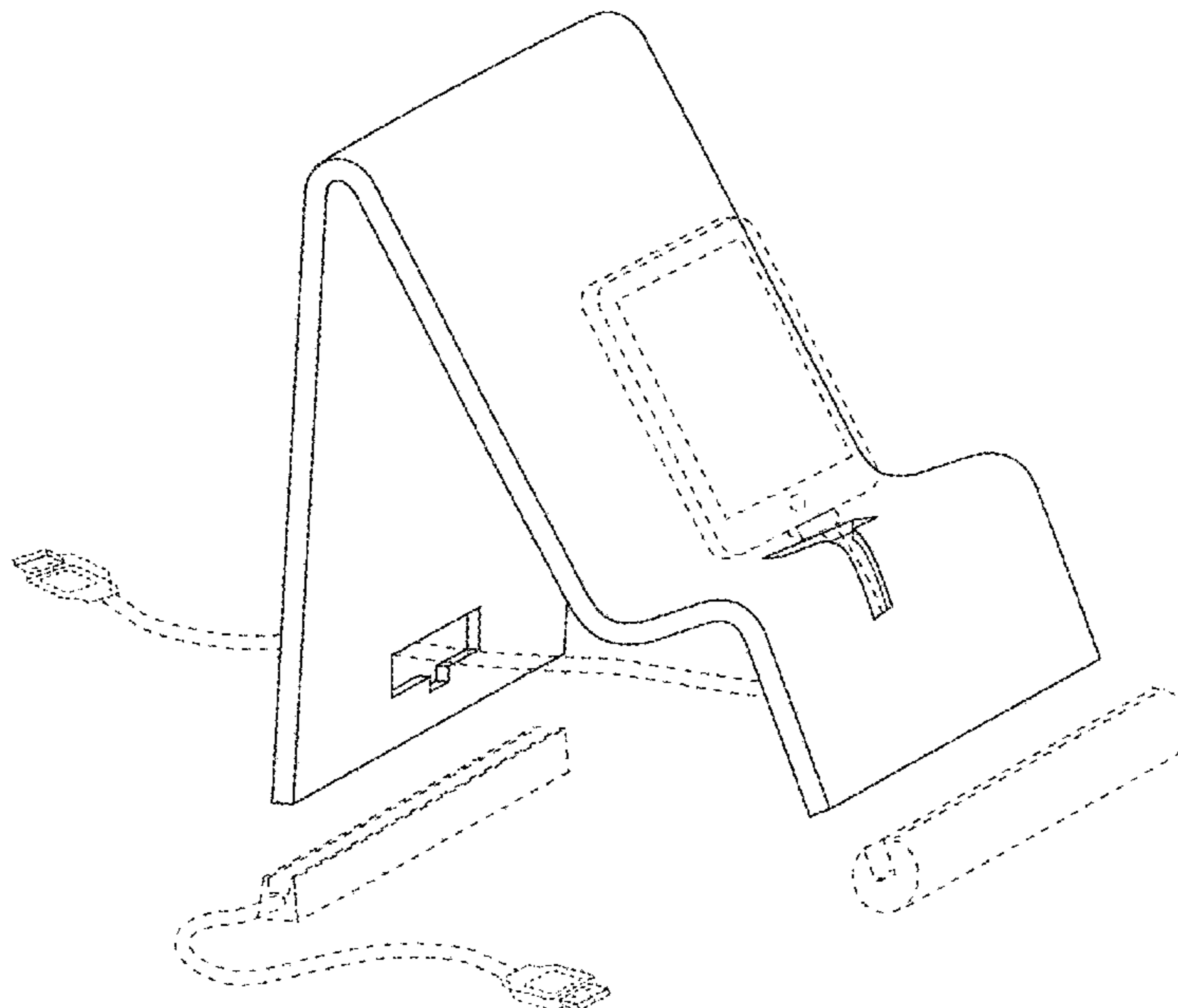

Figure 1

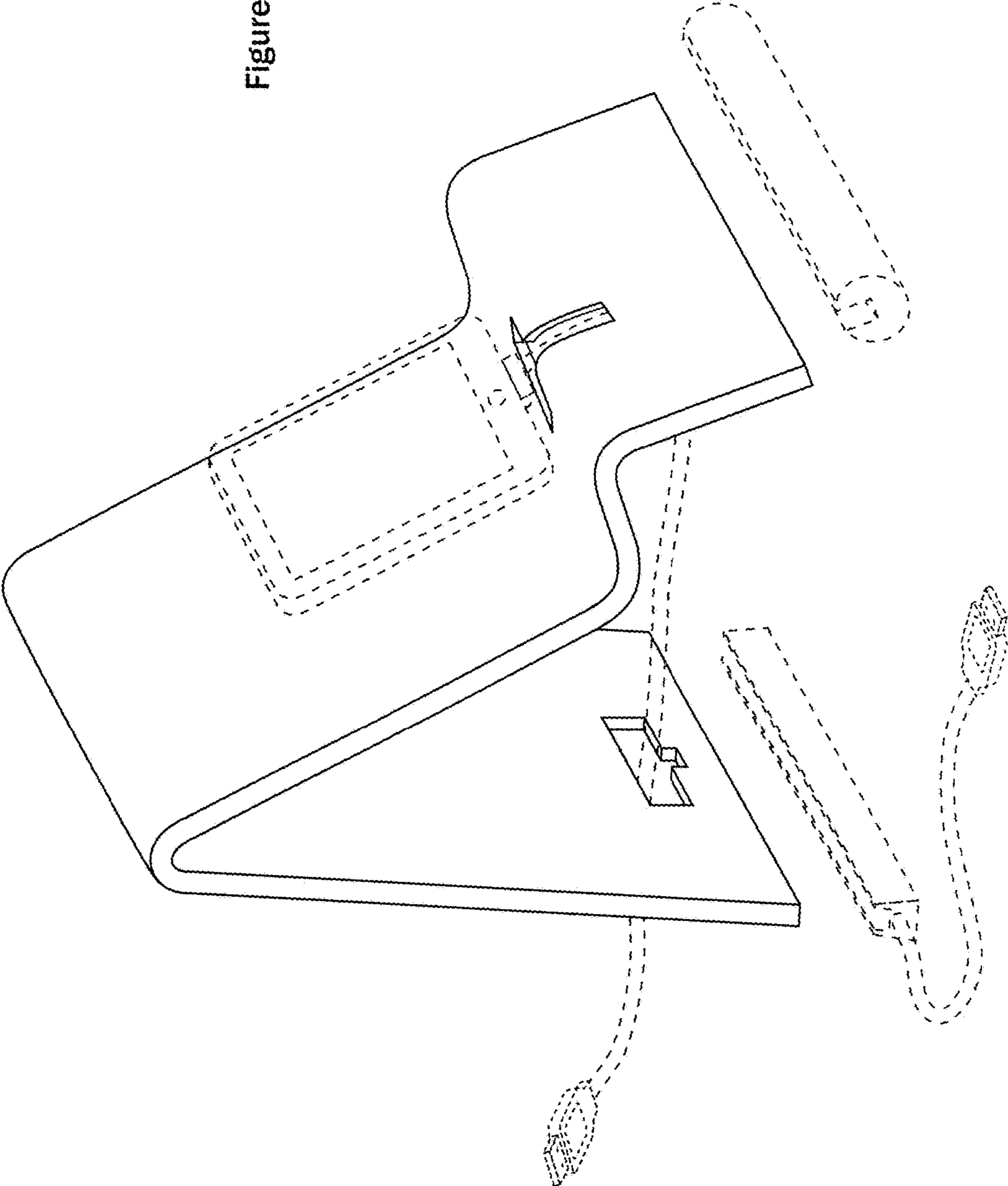

Figure 2

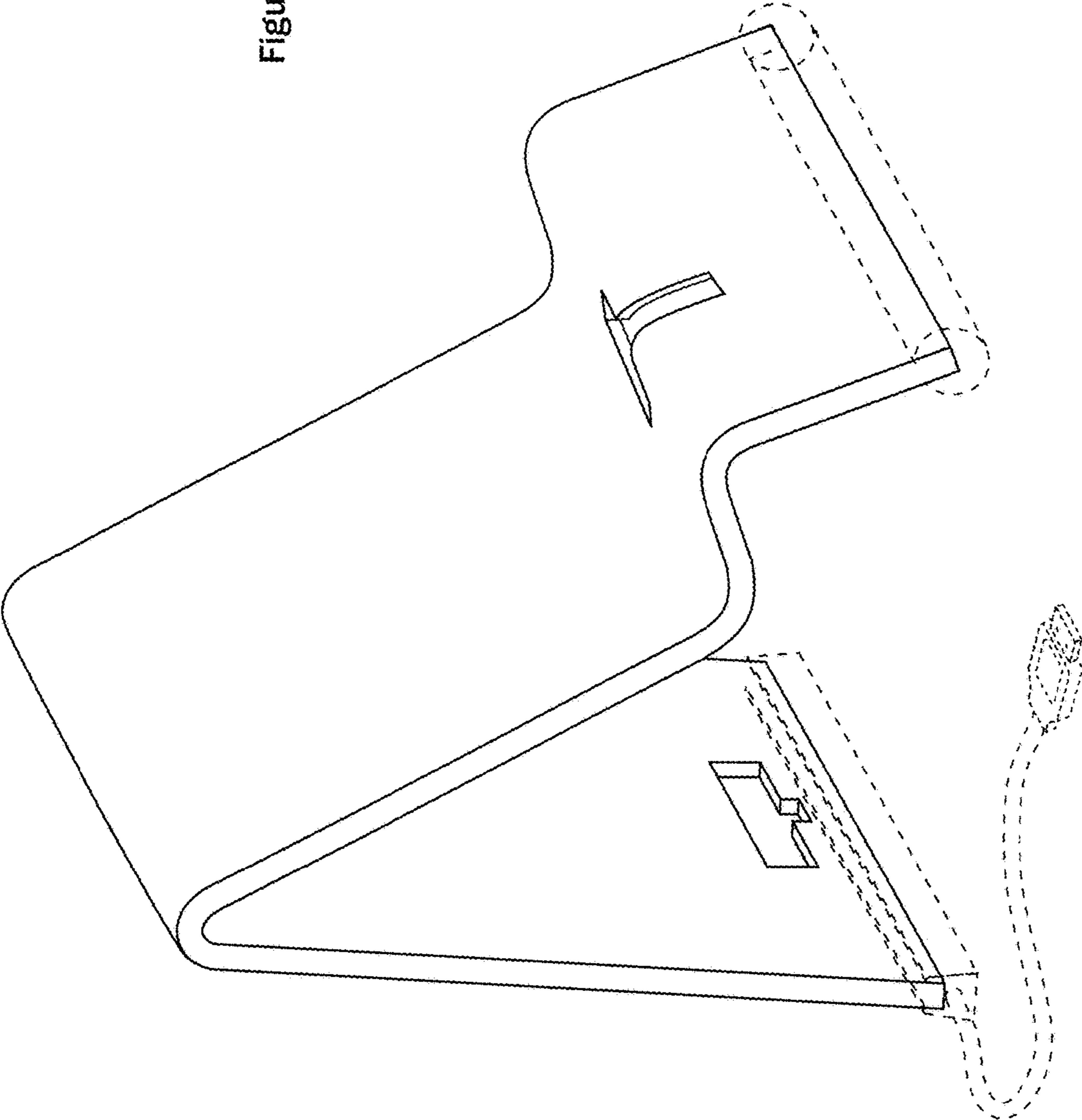

Figure 3

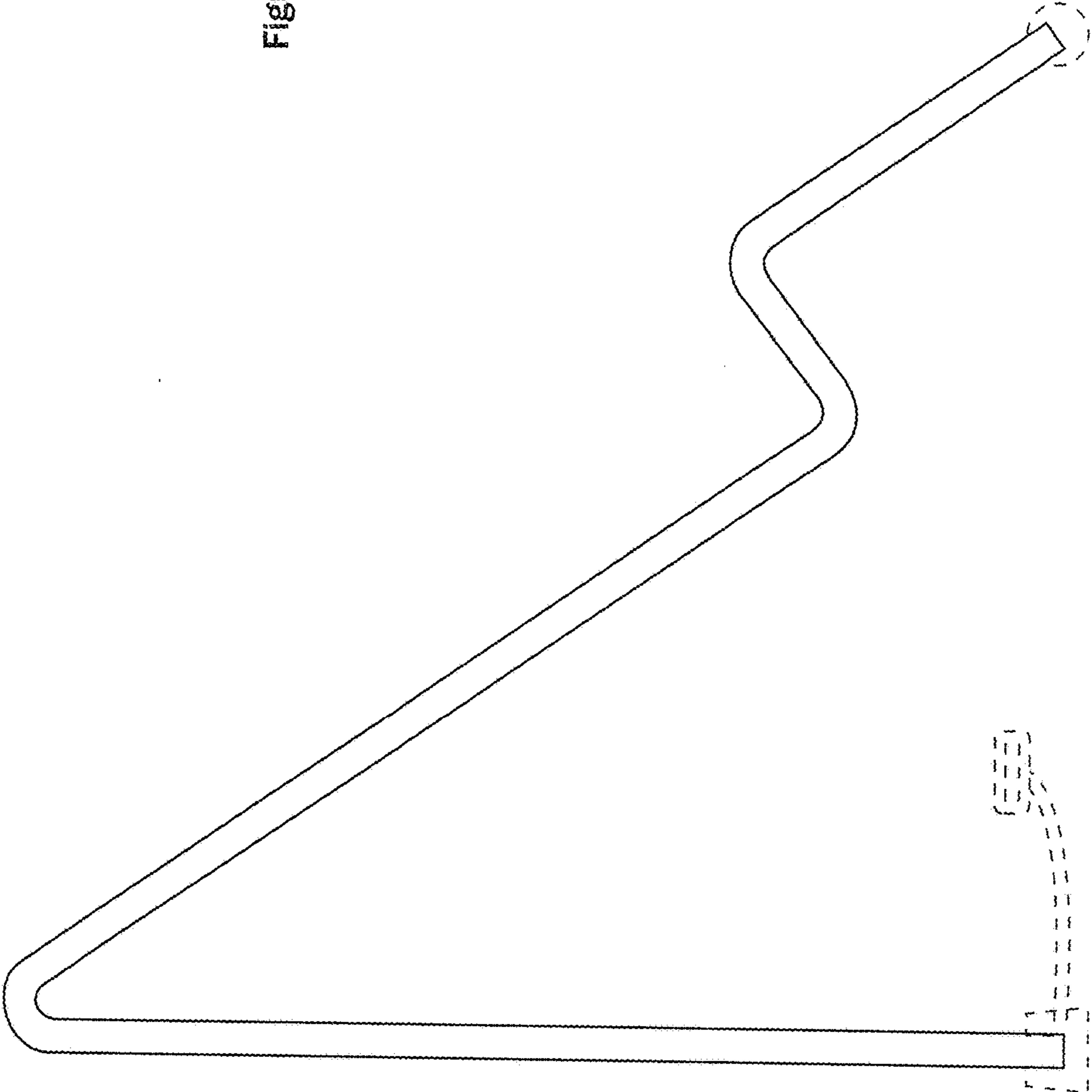

Figure 4

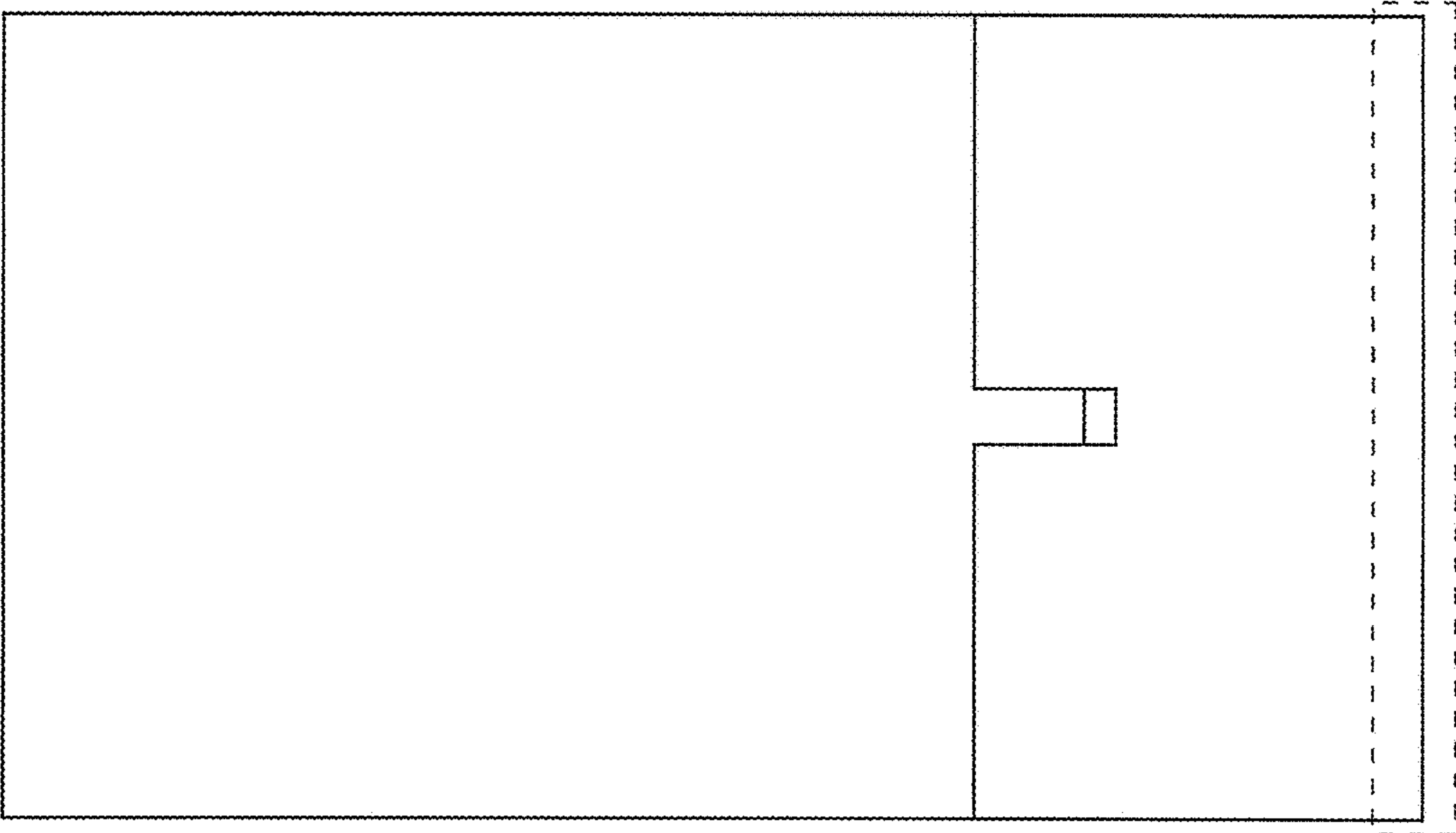

Figure 5

