

US00D800053S

(12) **United States Design Patent** (10) **Patent No.:** **US D800,053 S**  
**Yoon** (45) **Date of Patent:** **\*\* \*Oct. 17, 2017**

(54) **TIRE STUD**  
(71) Applicant: **HANKOOK TIRE CO., LTD.**, Seoul (KR)  
(72) Inventor: **Sung Hee Yoon**, Seoul (KR)  
(73) Assignee: **Hankook Tire Co., Ltd.**, Seoul (KR)  
(\* ) Notice: This patent is subject to a terminal disclaimer.  
(\*\*) Term: **15 Years**  
(21) Appl. No.: **29/535,760**

D584,979 S *	1/2009	Pirhonen .....	D12/608
D608,233 S *	1/2010	Pirhonen .....	D12/608
D609,127 S *	2/2010	Pirhonen .....	D12/608
D706,709 S *	6/2014	Matsumoto .....	D12/608
D708,567 S *	7/2014	Matsumoto .....	D12/608
D774,449 S *	12/2016	Matsumoto .....	D12/608
D775,585 S *	1/2017	Matsumoto .....	D12/608
D775,586 S *	1/2017	Matsumoto .....	D12/608
D776,047 S *	1/2017	Matsumoto .....	D12/608
D776,048 S *	1/2017	Matsumoto .....	D12/608
D776,049 S *	1/2017	Matsumoto .....	D12/608
D777,097 S *	1/2017	Matsumoto .....	D12/608
2012/0067480 A1 *	3/2012	Hietarinta-Salakari .	B60C 11/16 152/210
2013/0000807 A1 *	1/2013	Pons .....	B60C 11/1643 152/210

(22) Filed: **Aug. 10, 2015**  
(30) **Foreign Application Priority Data**  
Feb. 17, 2015 (KR) ..... 30-2015-0008717  
(51) **LOC (10) Cl.** ..... **12-15**  
(52) **U.S. Cl.**  
USPC ..... **D12/604**  
(58) **Field of Classification Search**  
USPC ..... D12/605, 604, 606, 607, 608, 400, 500,  
D12/501, 544, 579  
CPC ... B60C 27/08; B60C 27/086; B60C 27/0223;  
B60C 11/1675; B60C 11/14  
See application file for complete search history.

\* cited by examiner

*Primary Examiner* — George D. Kirschbaum  
*Assistant Examiner* — Clese Moore, Jr.  
(74) *Attorney, Agent, or Firm* — Hamre, Schumann,  
Mueller & Larson, P.C.

(57) **CLAIM**

The ornamental design for a tire stud, as shown and described.

**DESCRIPTION**

FIG. 1 is a perspective view of a tire stud showing my new design;  
FIG. 2 is a front elevational view thereof;  
FIG. 3 is a rear elevational view thereof;  
FIG. 4 is a left side view thereof;  
FIG. 5 is a right side view thereof;  
FIG. 6 is a top plan view thereof; and,  
FIG. 7 is a bottom plan view thereof.

(56) **References Cited**  
U.S. PATENT DOCUMENTS  
D431,215 S \* 9/2000 Nyblom ..... D12/608  
D550,611 S \* 9/2007 Liukkula ..... D12/608  
D551,614 S \* 9/2007 Liukkula ..... D12/608  
D559,775 S \* 1/2008 Liukkula ..... D12/608

**1 Claim, 3 Drawing Sheets**

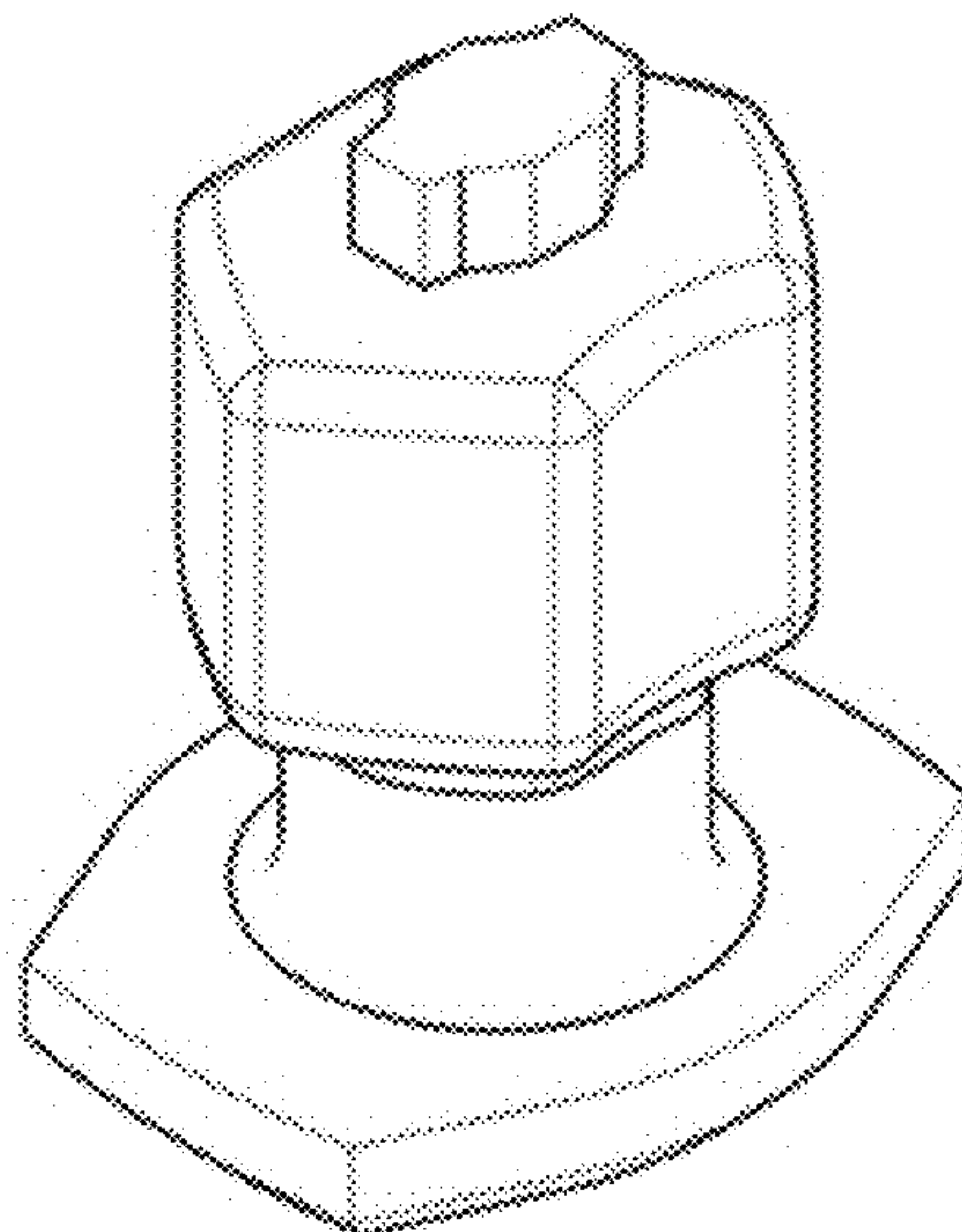

FIG. 1

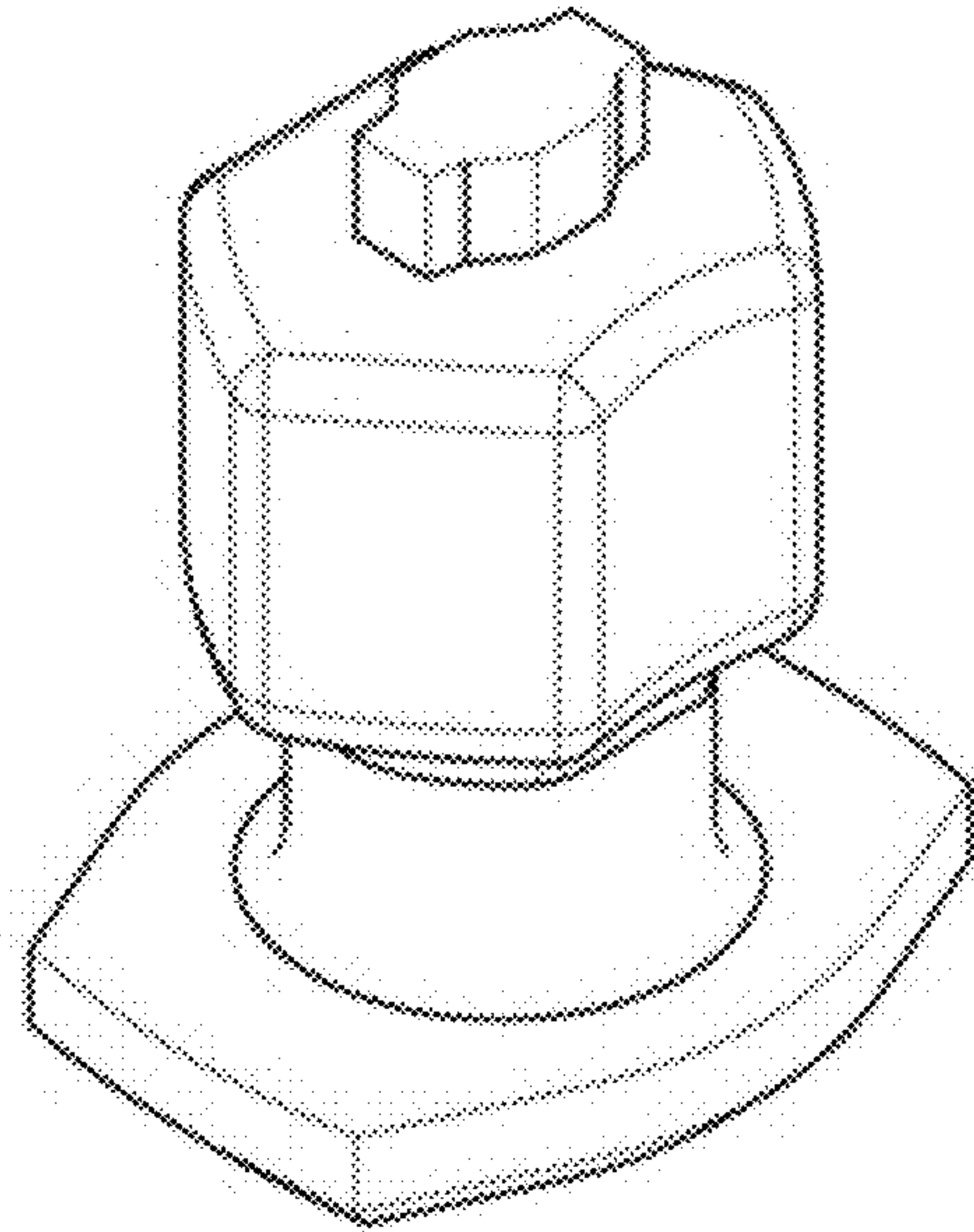

FIG. 2

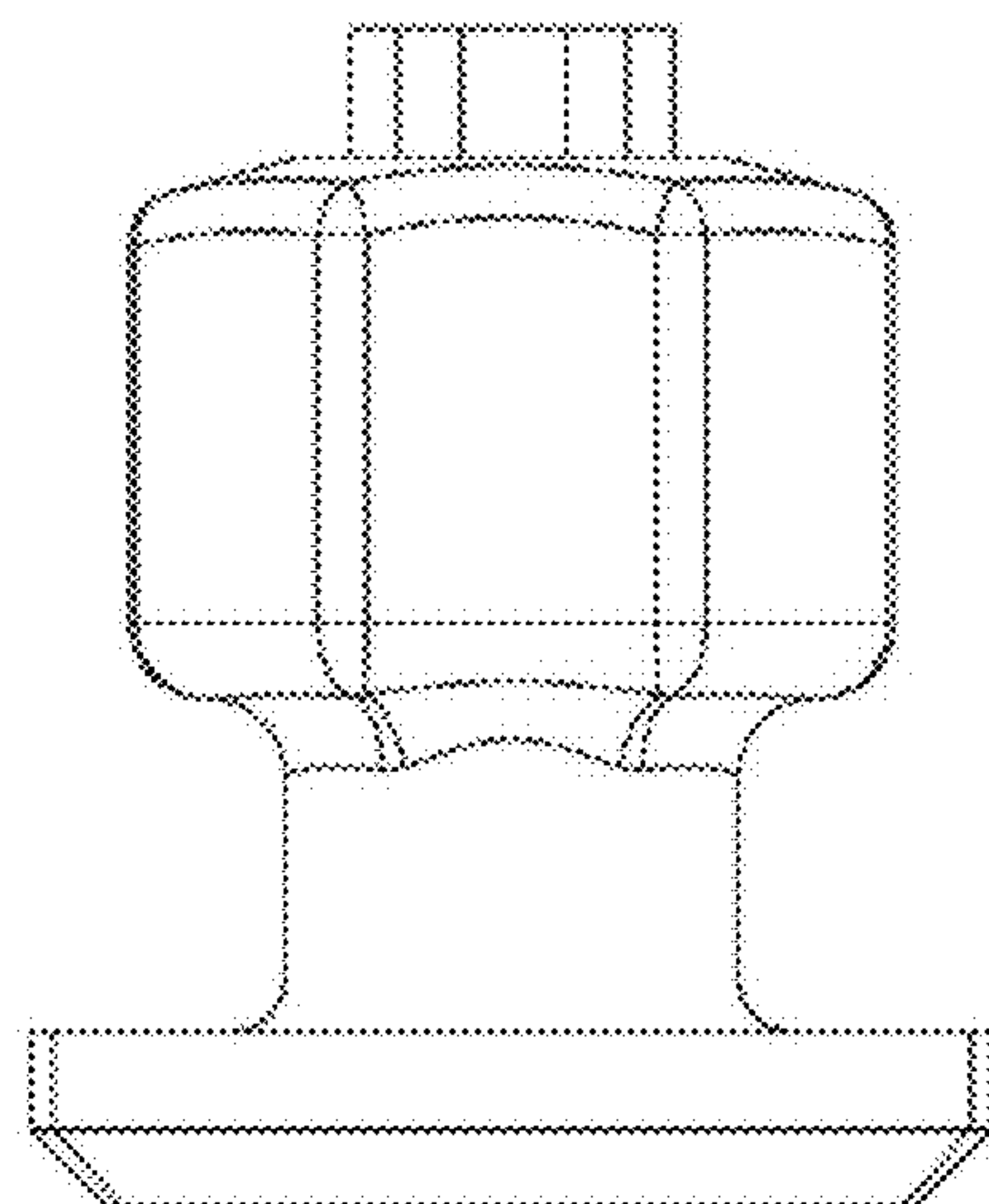

FIG. 3

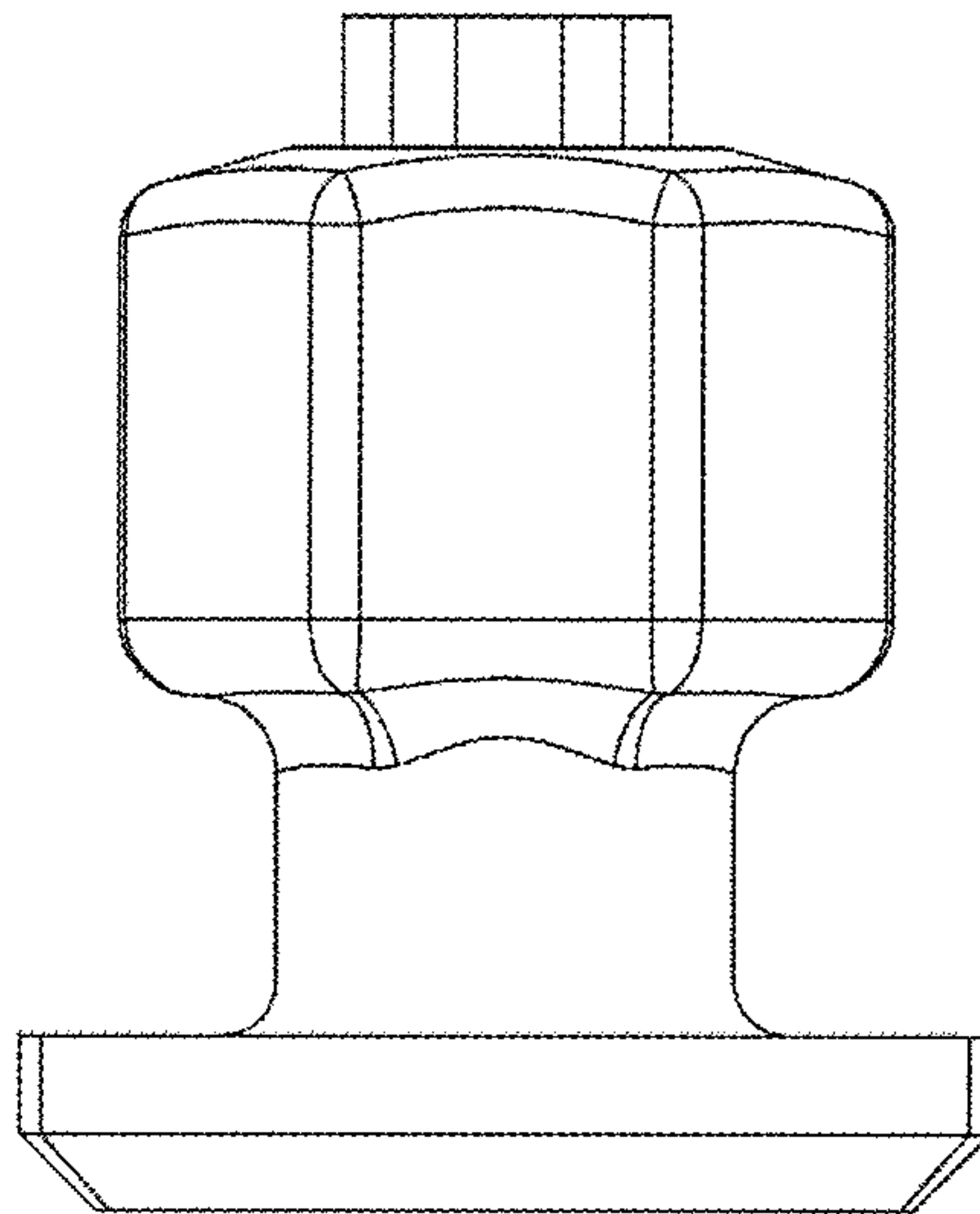

FIG. 4

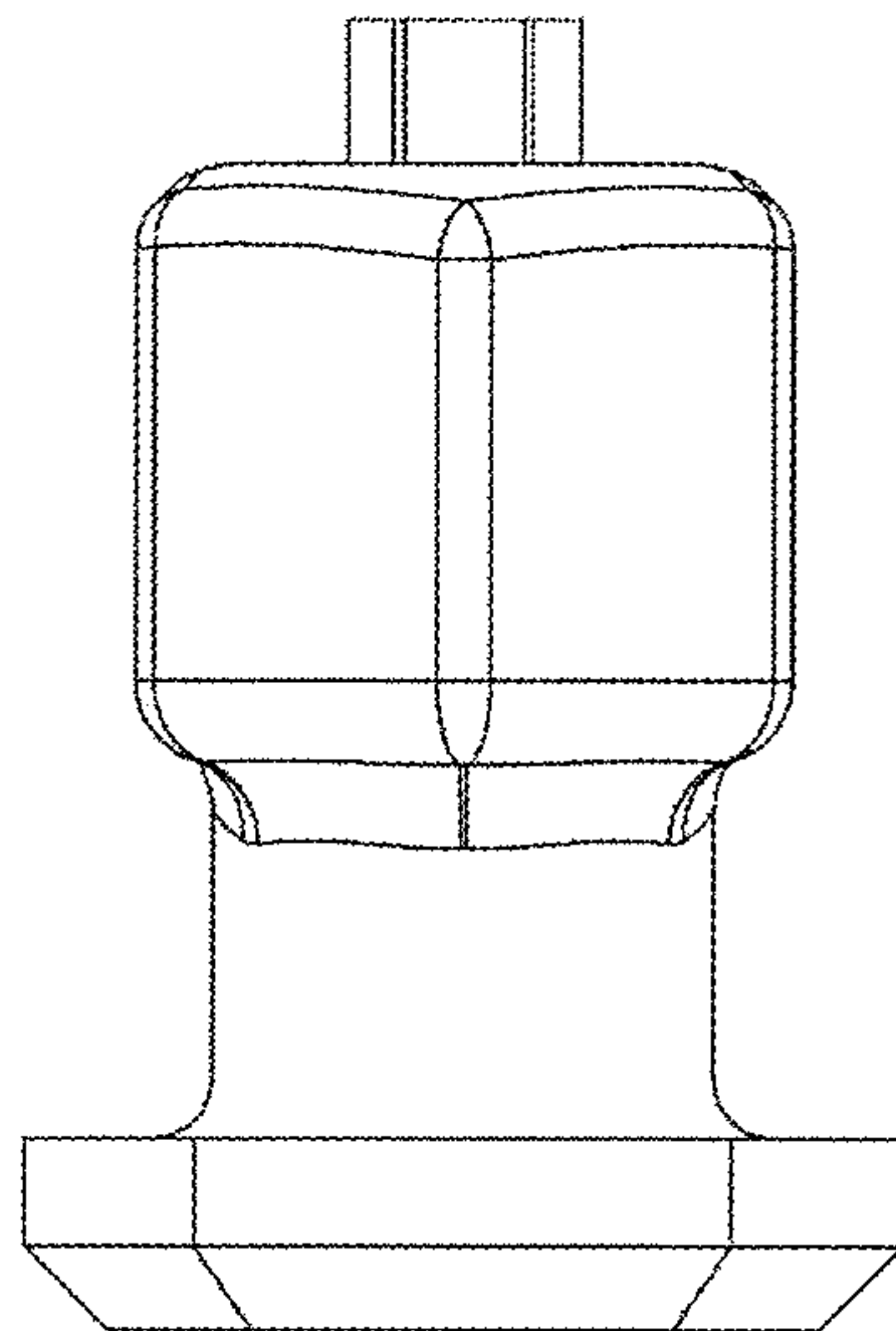

FIG. 5

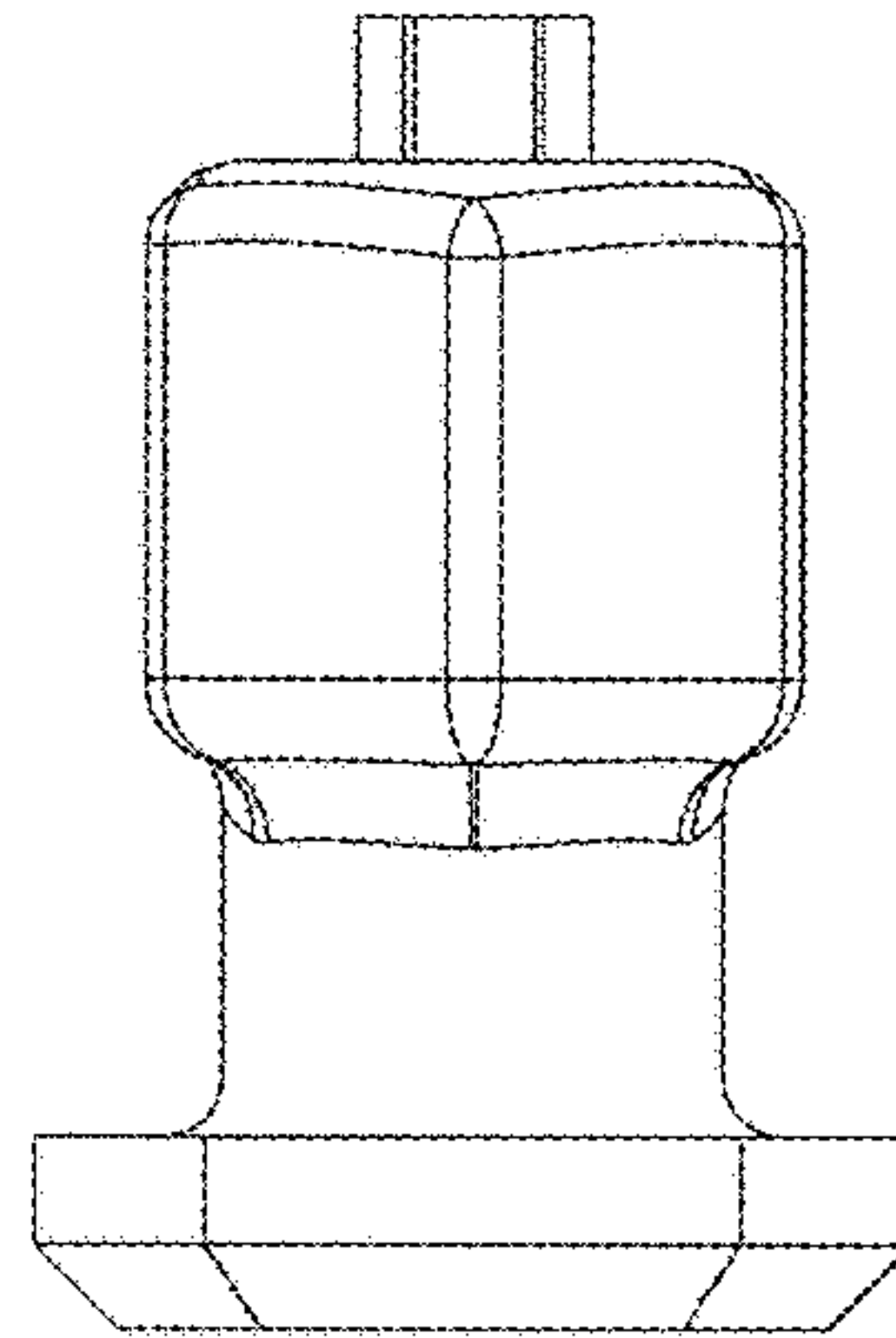

FIG. 6

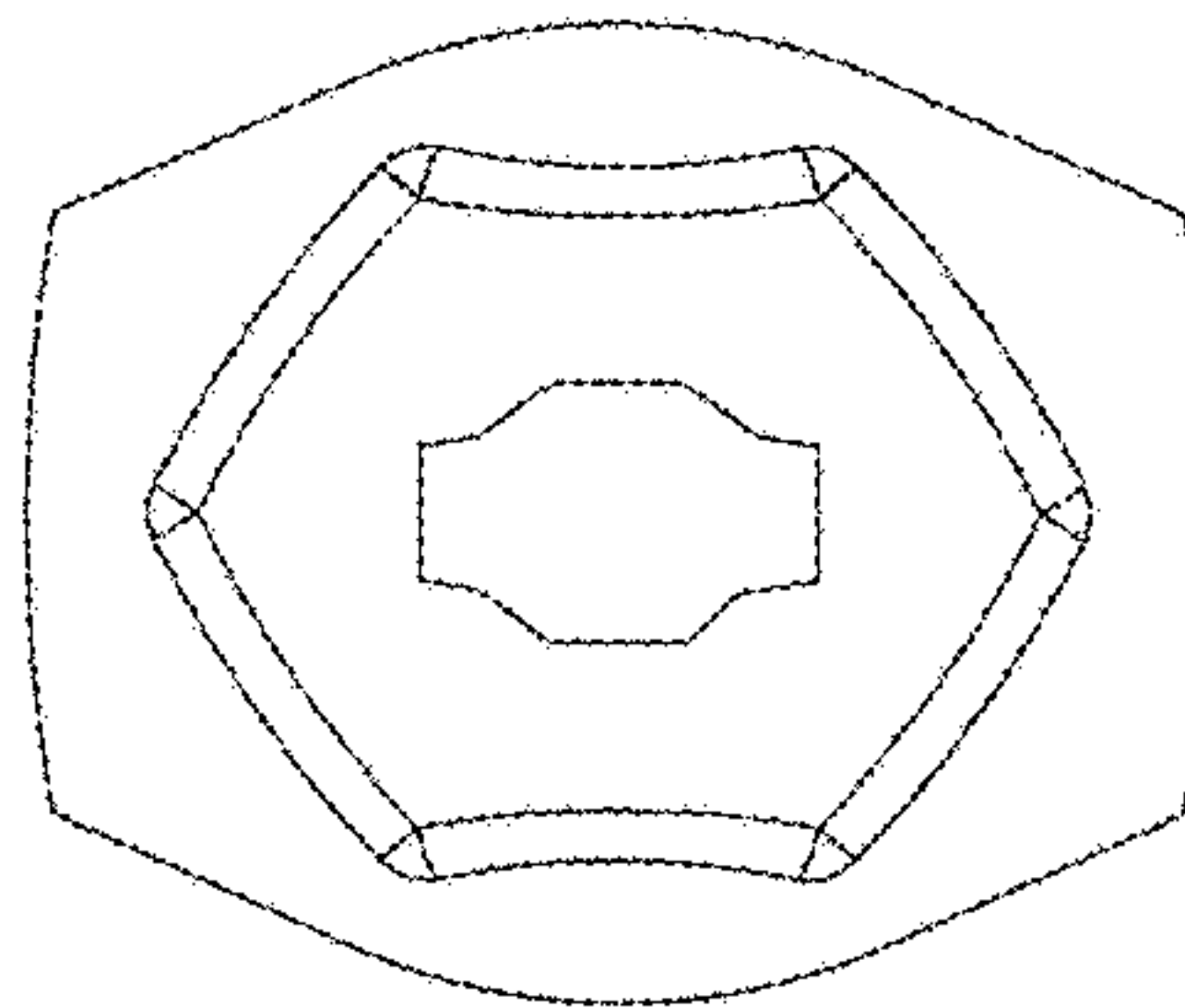

FIG. 7

