



US00D797047S

(12) **United States Design Patent** (10) **Patent No.:** **US D797,047 S**  
**Ohno** (45) **Date of Patent:** **\*\* Sep. 12, 2017**

(54) **POWER SOURCE GENERATOR FOR MEDICAL EQUIPMENT**

(71) Applicant: **FUJIFILM CORPORATION**, Tokyo (JP)

(72) Inventor: **Hirotohi Ohno**, Ashigarakami-gun (JP)

(73) Assignee: **FUJIFILM Corporation**, Tokyo (JP)

(\*\*) Term: **14 Years**

(21) Appl. No.: **29/512,328**

(22) Filed: **Dec. 18, 2014**

(30) **Foreign Application Priority Data**

Jun. 27, 2014 (JP) ..... 2014-014210

(51) **LOC (10) Cl.** ..... **13-02**

(52) **U.S. Cl.**  
USPC ..... **D13/122**

(58) **Field of Classification Search**  
USPC ..... D13/122, 101, 110, 118, 123, 162, 164, D13/184, 199; 307/150-152; 361/600, 361/601, 622, 702, 703, 730, 796, 809; 363/141, 142; D14/348, 349, 356, 357; D24/144, 170

(Continued)

(56) **References Cited**

**U.S. PATENT DOCUMENTS**

D244,385 S \* 5/1977 McCord ..... D13/112

D303,246 S \* 9/1989 Freeman ..... D13/147

(Continued)

*Primary Examiner* — Derrick Holland

(74) *Attorney, Agent, or Firm* — Sughrue Mion, PLLC

(57) **CLAIM**

The ornamental design for a power source generator for medical equipment, as shown and described.

**DESCRIPTION**

FIG. 1 is a top, front and left side perspective view of a power source generator for medical equipment showing my new design;

FIG. 2 is a front elevational view thereof;

FIG. 3 is a rear elevational view thereof;

FIG. 4 is a top plan view thereof;

FIG. 5 is a bottom plan view thereof;

FIG. 6 is a left side elevational view thereof;

FIG. 7 is a right side elevational view thereof;

FIG. 8 is an enlarged partial cross-sectional view of a portion defined by an arrow B between arrowheads A-A and of FIG. 2;

FIG. 9 is an enlarged partial cross-sectional view of a portion defined by an arrow D between arrowheads C-C and of FIG. 2;

FIG. 10 is an enlarged partial cross-sectional view of a portion defined by an arrow F between arrowheads E-E and of FIG. 6;

FIG. 11 is an enlarged partial cross-sectional view of a portion defined by an arrow G between arrowheads E-E and of FIG. 6;

FIG. 12 is an enlarged partial cross-sectional view of a portion defined by an arrow I between arrowheads H-H and of FIG. 6;

FIG. 13 is an enlarged partial cross-sectional view of a portion defined by an arrow J between arrowheads H-H and of FIG. 6; and,

FIG. 14 is a top, front and left side perspective view thereof in a manner of use, to which medical equipment is connected.

The broken lines shown represent unclaimed subject matter and form no part of the claimed design.

The dash-dot broken lines in FIGS. 8-13 represent cutting-plane lines and form no part of the claimed design.

**1 Claim, 11 Drawing Sheets**

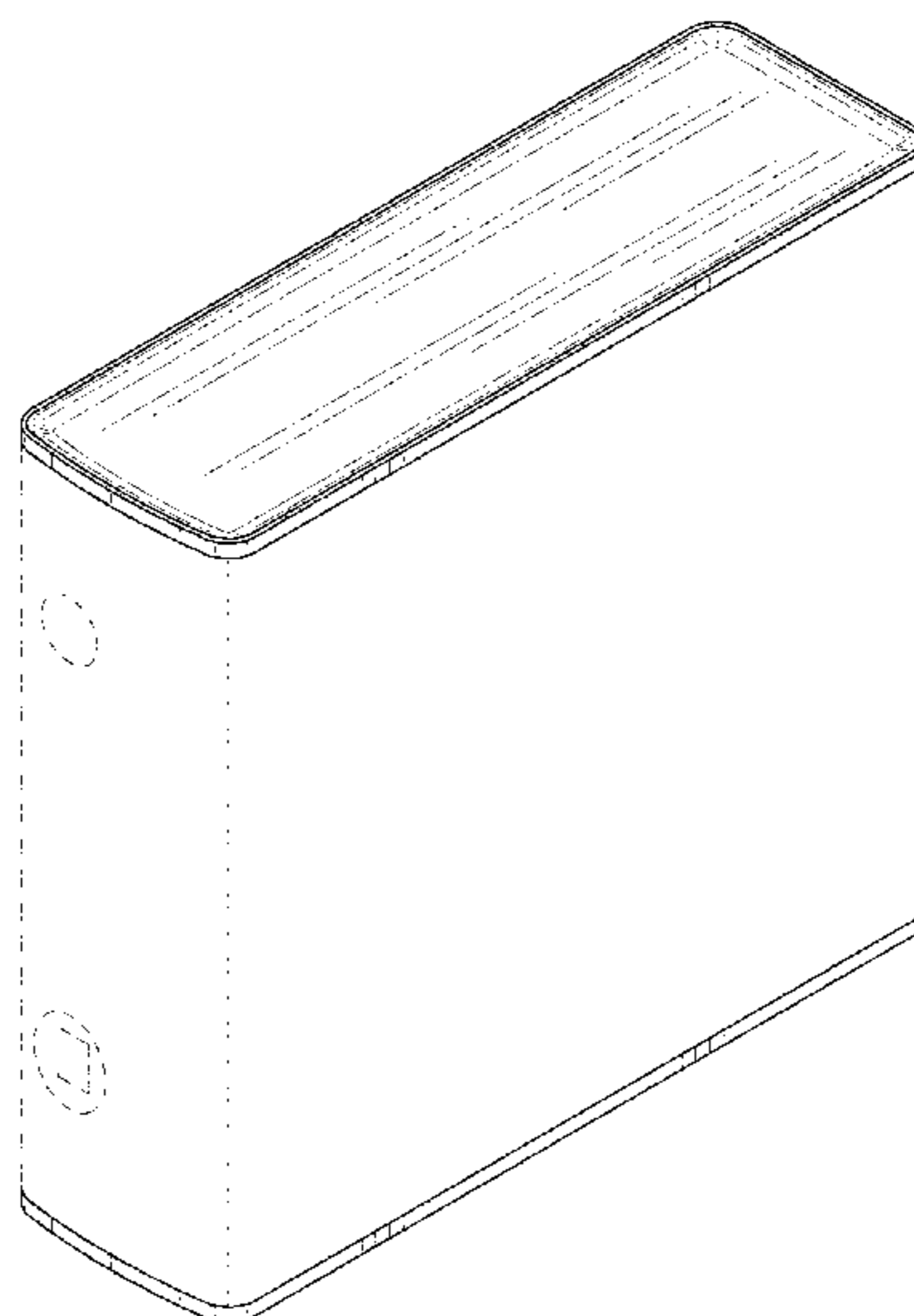

(58) **Field of Classification Search**

CPC ..... H02M 7/00; H02M 7/02; H02M 7/003;  
H05K 5/00; H05K 5/0017; H05K 7/00;  
H05K 7/1427; H05K 7/1457; H05K  
7/20918; A61M 16/00; A61M 16/125;  
A61M 16/202; A61M 16/205; A61M  
16/0003; A61M 16/0057; A61M 16/0841;  
A61M 2205/17; A61M 2205/18; A61M  
2205/35; A61M 2205/3507; A61M  
2205/3592

See application file for complete search history.

(56) **References Cited**

U.S. PATENT DOCUMENTS

D582,044	S	*	12/2008	Hacker	.....	D24/170
D602,859	S	*	10/2009	Kaiser	.....	D13/101
D631,160	S	*	1/2011	Schurg	.....	D24/144
D674,342	S	*	1/2013	Ho	.....	D13/110
D689,858	S	*	9/2013	Lo	.....	D14/357
D718,237	S	*	11/2014	Asakura	.....	D13/110
D783,527	S	*	4/2017	Hao	.....	D13/110
2011/0197882	A1	*	8/2011	Truschel	.....	A61M 16/00 128/204.18

\* cited by examiner

FIG. 1

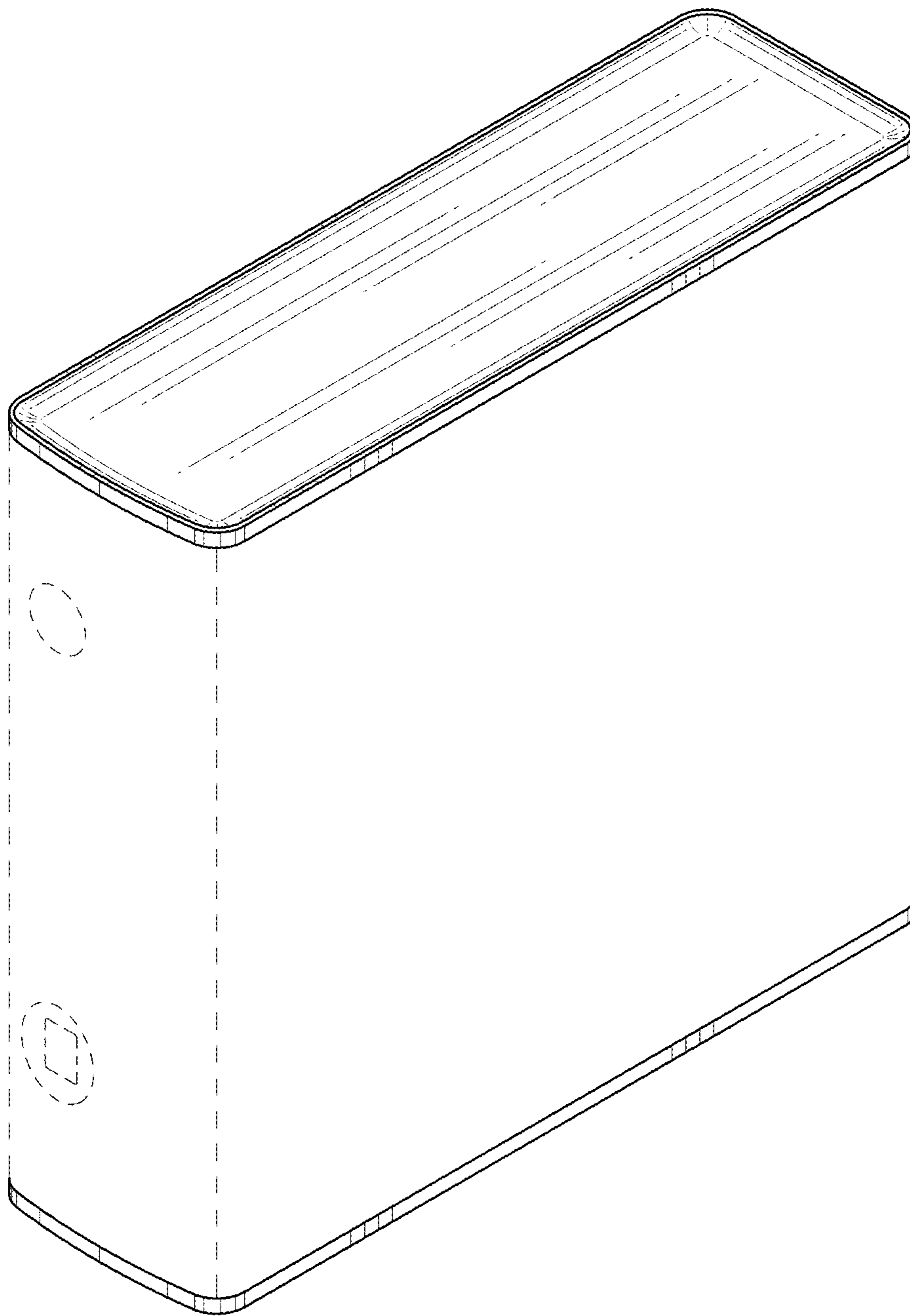

FIG. 2

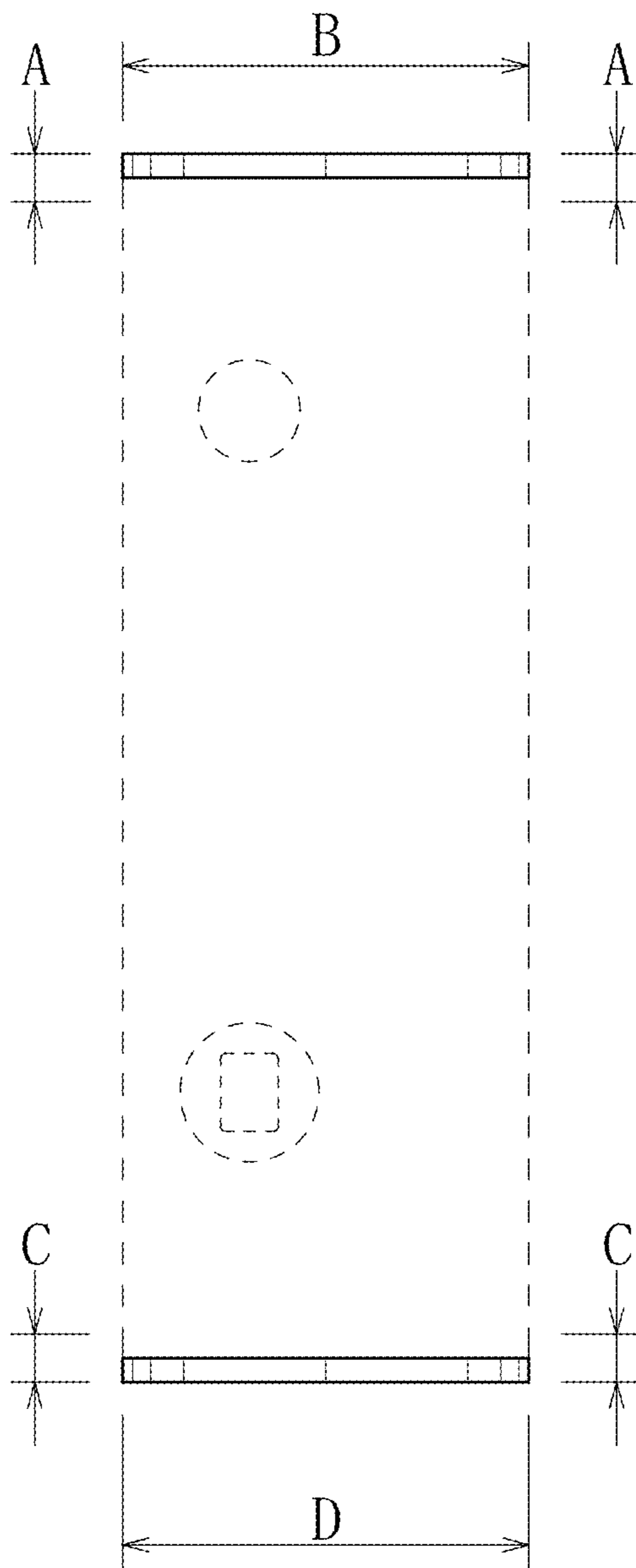

FIG. 3

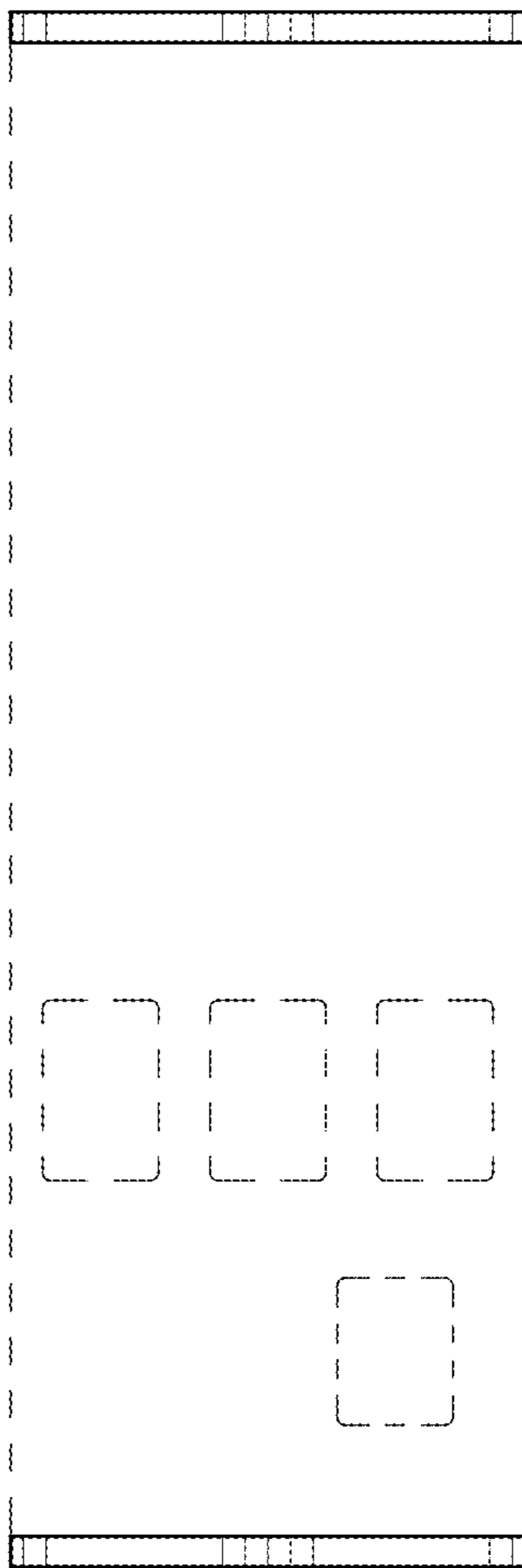

FIG. 4

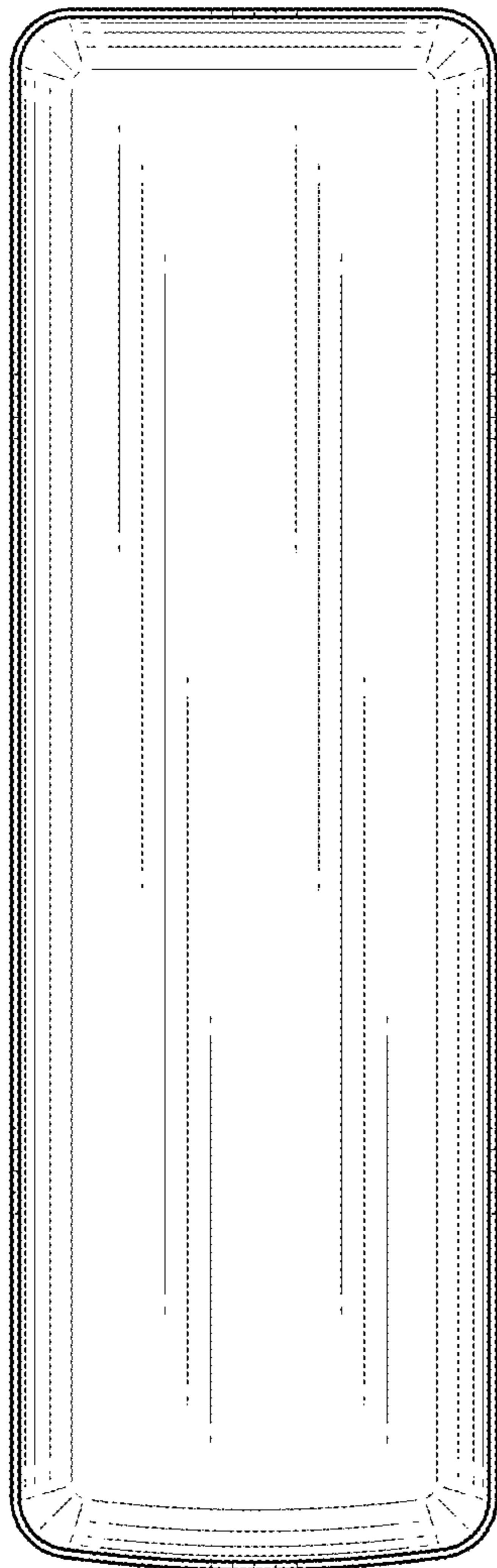

FIG. 5

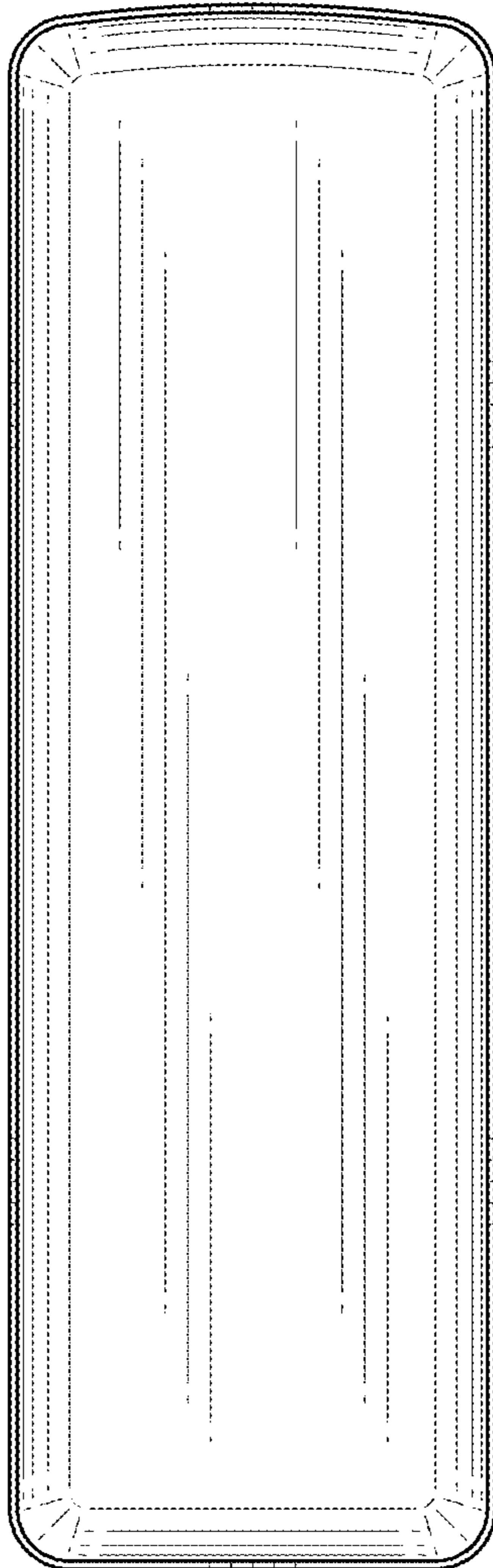

FIG. 6

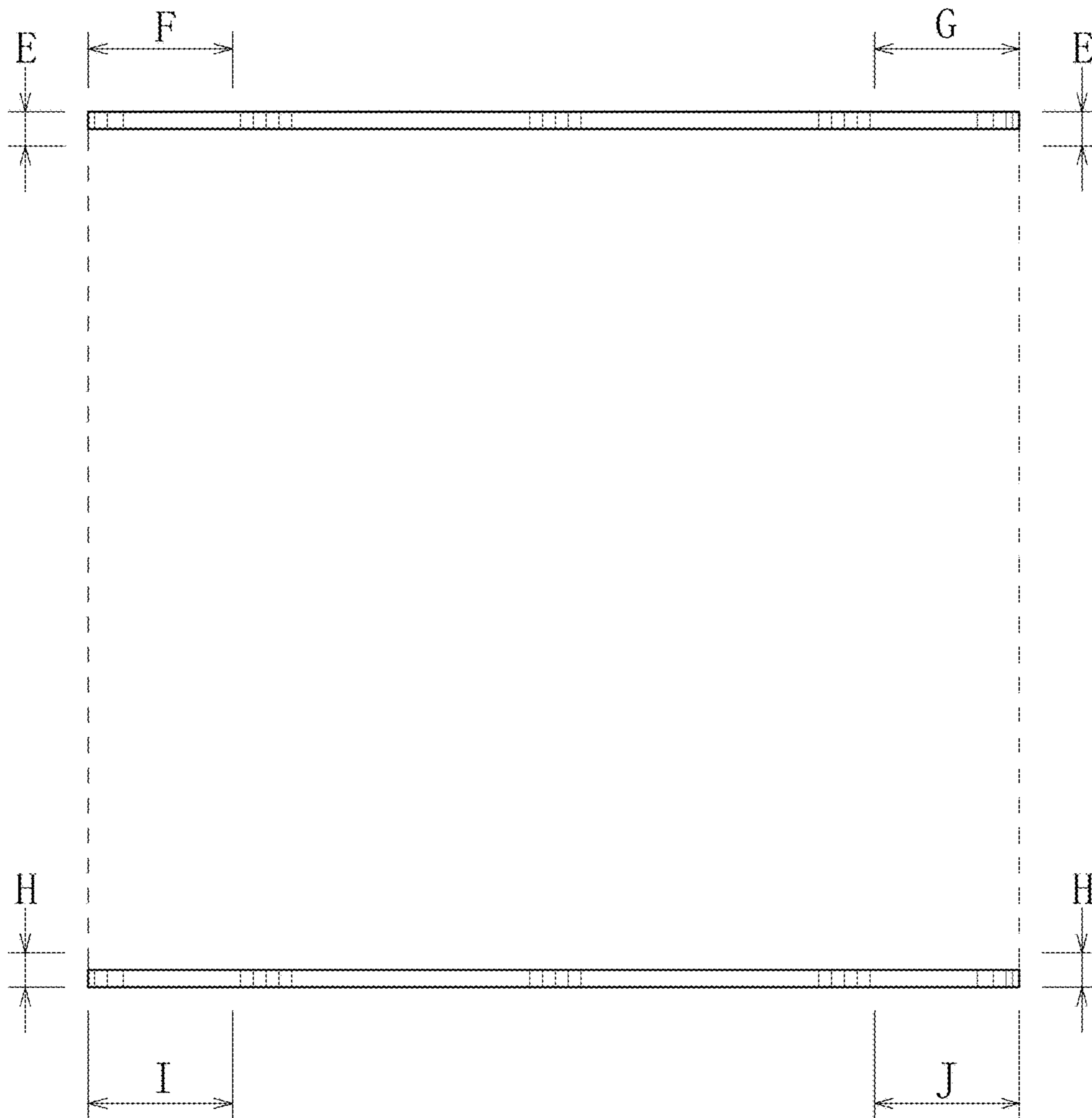



FIG. 7

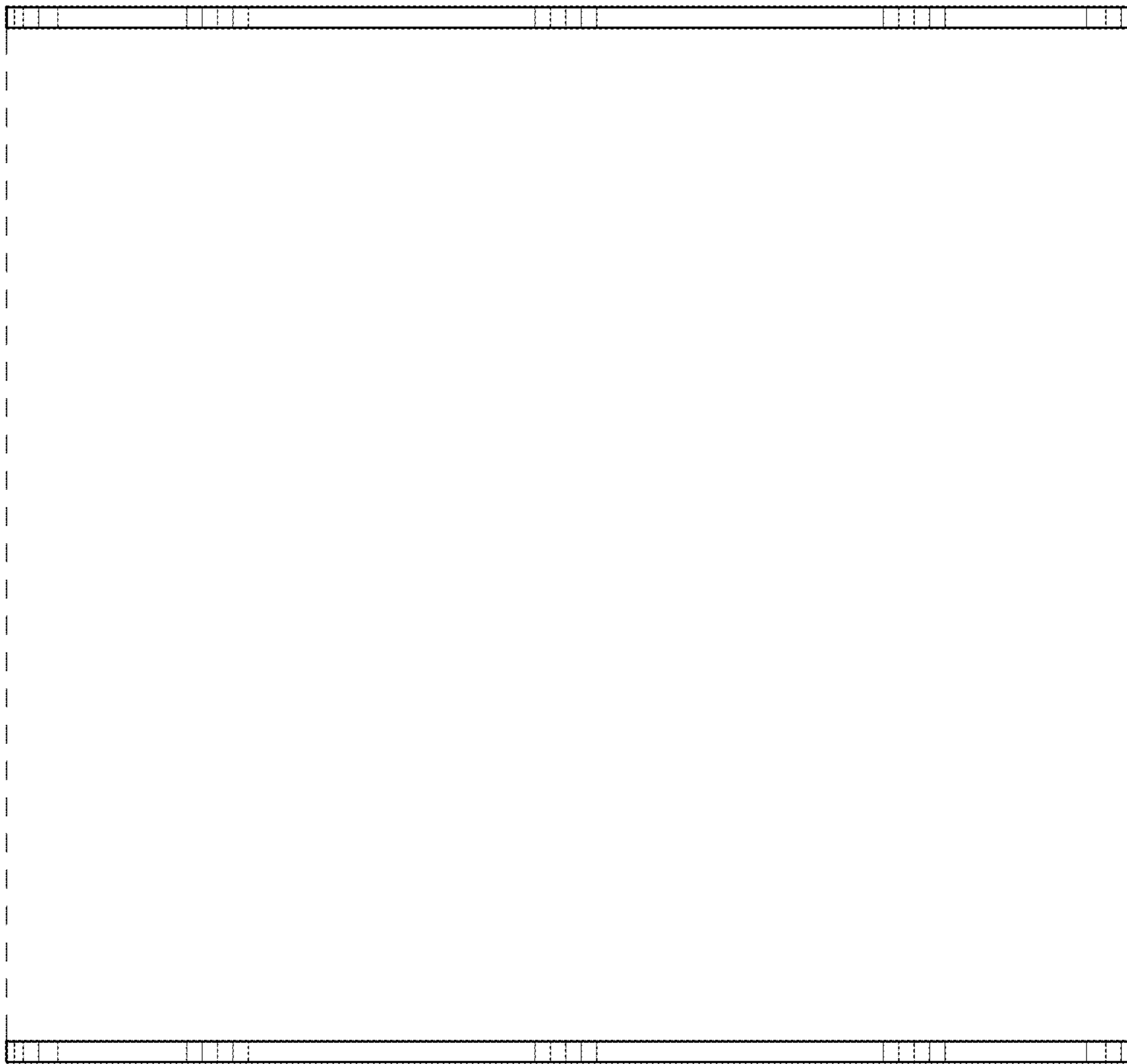

FIG. 8

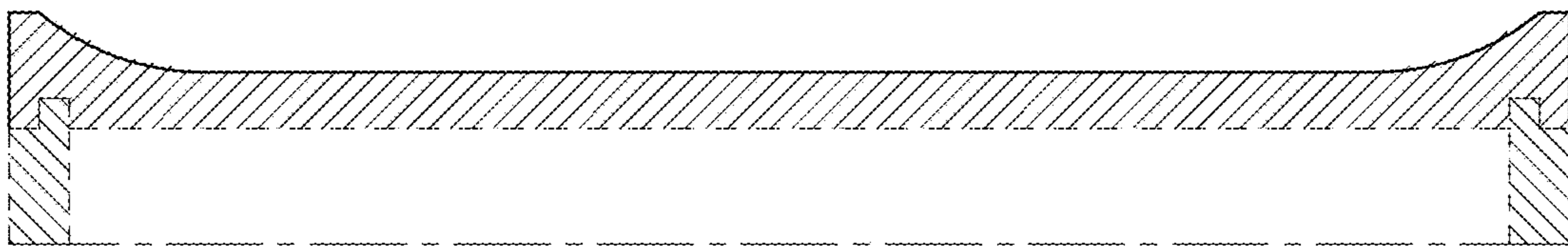

FIG. 9

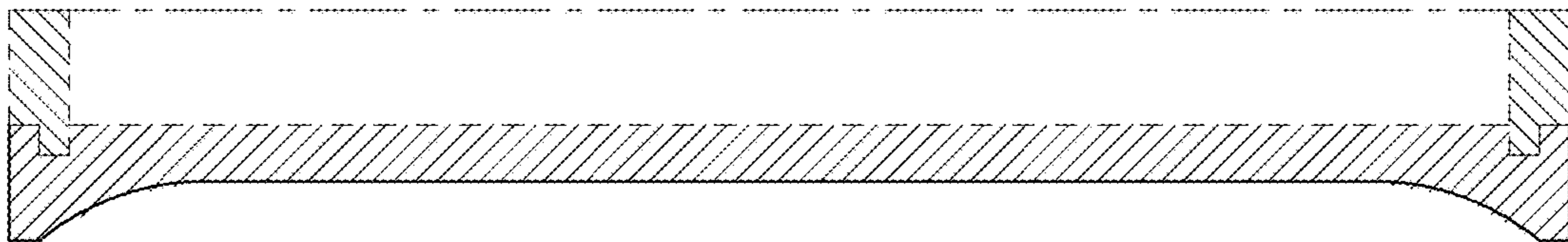

FIG. 10

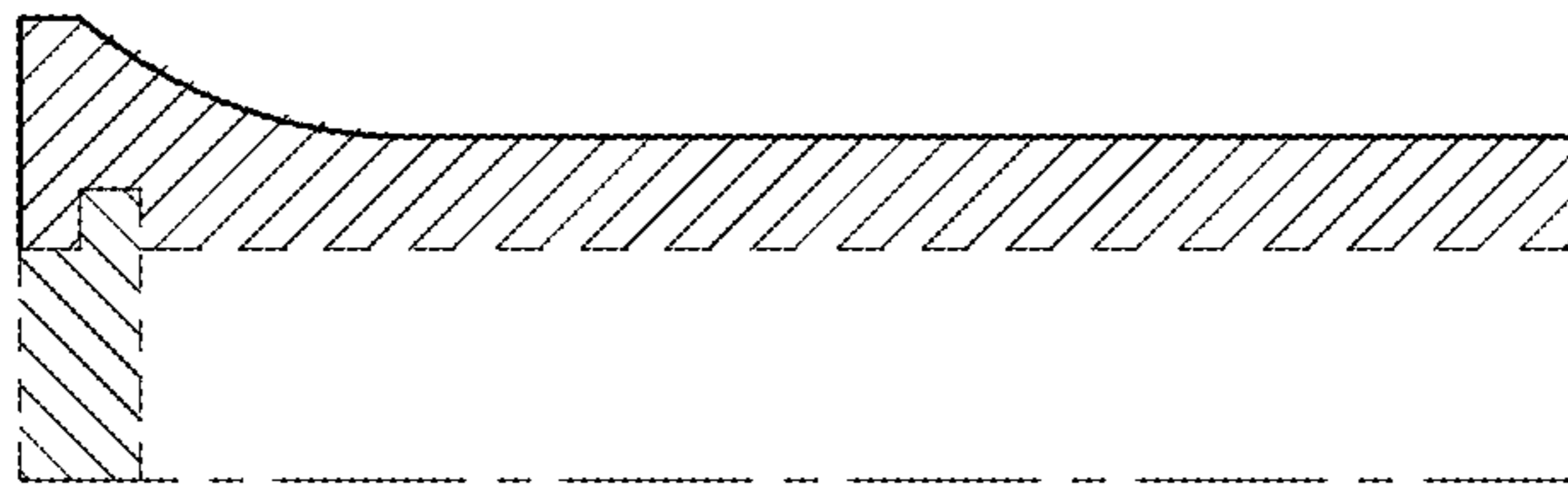

FIG. 11

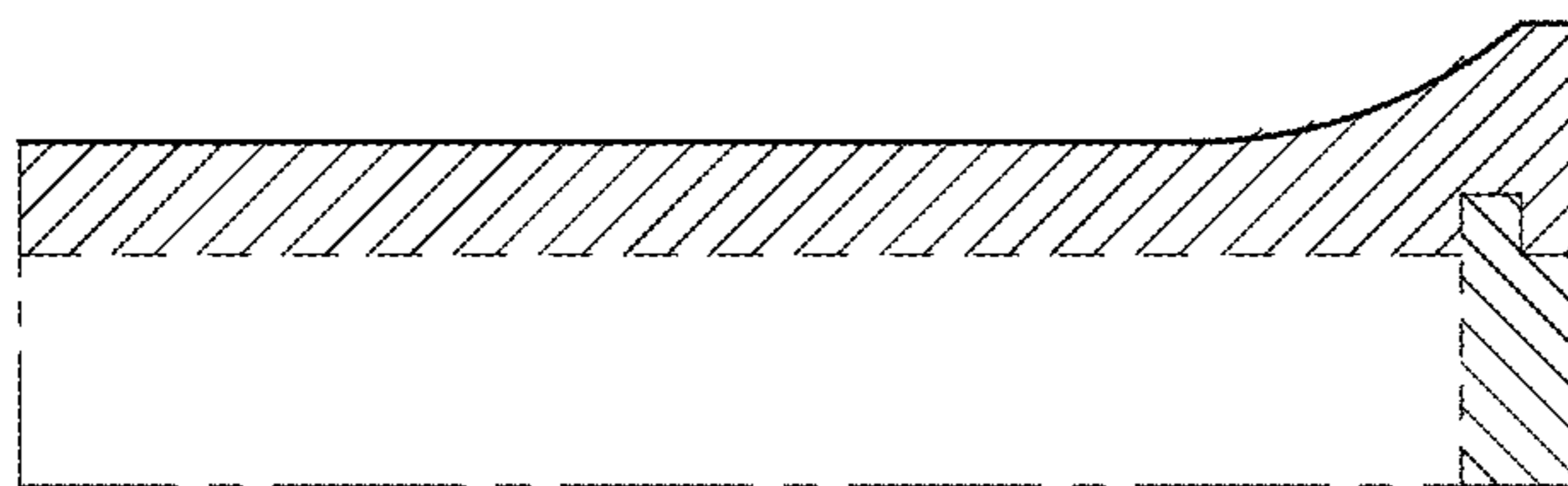

FIG. 12

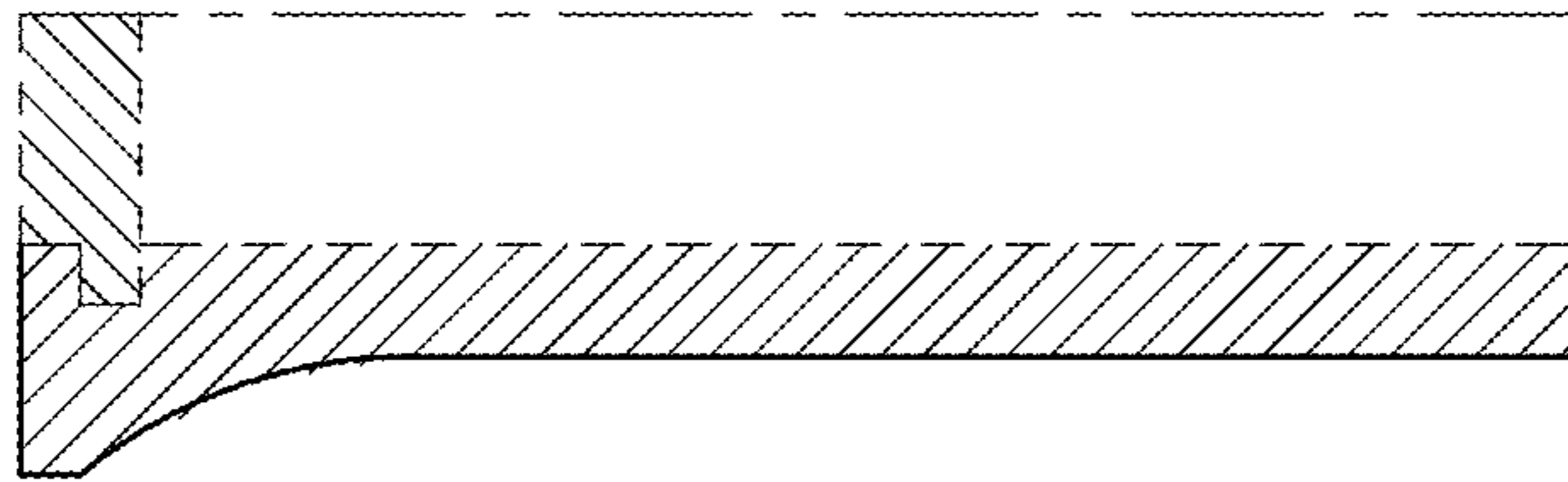

FIG. 13

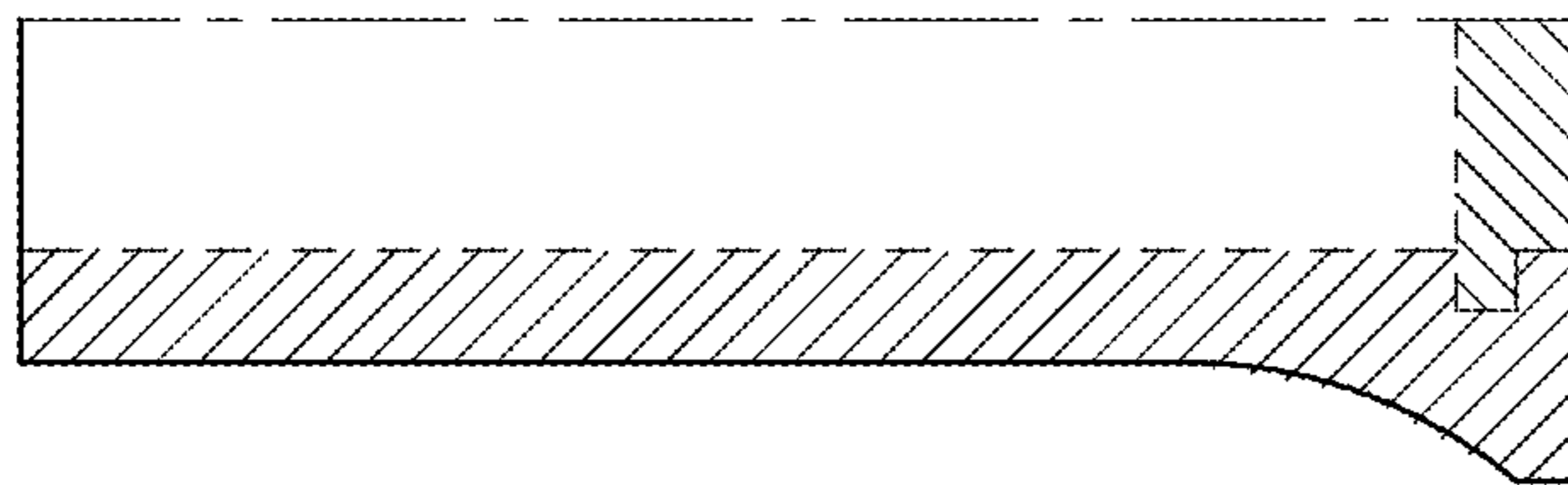

FIG. 14

