



US00D797006S

(12) **United States Design Patent** (10) **Patent No.:** **US D797,006 S**
Hu (45) **Date of Patent:** **** Sep. 12, 2017**

(54) **DECORATIONS FOR A MOTORCYCLE**
(71) Applicant: **NINGBO XINKAIHONG MACHINE FABRICATE CO., LTD**, Ningbo, Zhejiang (CN)
(72) Inventor: **Hongbin Hu**, Zhejiang (CN)
(73) Assignee: **NINGBO XINKAIHONG MACHINE FABRICATE CO., LTD**, Ningbo (CN)

(**) Term: **15 Years**

(21) Appl. No.: **29/553,165**

(22) Filed: **Jan. 28, 2016**

(51) **LOC (10) Cl.** **12-11**

(52) **U.S. Cl.**
USPC **D12/114**

(58) **Field of Classification Search**
USPC D12/114, 110, 123, 125, 213, 126, 174, D12/177-180, 223, 197, 400; D8/349
CPC .. B62J 7/06; B62J 25/00; B62K 21/26; B62K 25/02

See application file for complete search history.

(56) **References Cited**

U.S. PATENT DOCUMENTS

D319,037 S * 8/1991 Hoeptner, III D12/114
D405,393 S * 2/1999 Stahel D12/114
6,161,859 A * 12/2000 Cheng B62J 25/00
280/291
D506,707 S * 6/2005 Egan D12/114
D512,894 S * 12/2005 Nimphius D12/114
D523,739 S * 6/2006 Williams D8/397
D523,786 S * 6/2006 Chacon D12/114
D528,477 S * 9/2006 Egan D12/114
D533,481 S * 12/2006 Goerges D12/114
D533,813 S * 12/2006 Fujiwara B62K 21/26
D12/114

D546,733 S * 7/2007 Tanaka D12/114
D560,562 S * 1/2008 Egan D12/114
D591,206 S * 4/2009 Donner D12/114
D654,775 S * 2/2012 Higashi D8/303
D723,981 S * 3/2015 May D12/114
D760,626 S * 7/2016 Amidon D12/114
2009/0255093 A1 * 10/2009 Hsu B25G 1/01
16/421
2015/0308484 A1 * 10/2015 Dubowski F16B 41/005
411/372.6

* cited by examiner

Primary Examiner — George D. Kirschbaum
Assistant Examiner — Clese Moore, Jr.

(57) **CLAIM**

The ornamental design for decorations for a motorcycle, as shown and described.

DESCRIPTION

FIG. 1 is a front elevational view of a first embodiment of decorations for a motorcycle showing my new design;
FIG. 2 is a rear elevational view of FIG. 1;
FIG. 3 is a left side view of FIG. 1;
FIG. 4 is a right side view of FIG. 1;
FIG. 5 is a top plan view of FIG. 1;
FIG. 6 is a bottom plan view of FIG. 1;
FIG. 7 is a first perspective view of FIG. 1;
FIG. 8 is a second perspective view of FIG. 1;
FIG. 9 is a front elevational view of a second embodiment of decorations for a motorcycle;
FIG. 10 is a rear elevational view of FIG. 9;
FIG. 11 is a left side view of FIG. 9;
FIG. 12 is a right side view of FIG. 9;
FIG. 13 is a top plan view of FIG. 9;
FIG. 14 is a bottom plan view of FIG. 9;
FIG. 15 is a top plan view of FIG. 9; and,
FIG. 16 is a bottom plan view of FIG. 9.

1 Claim, 14 Drawing Sheets

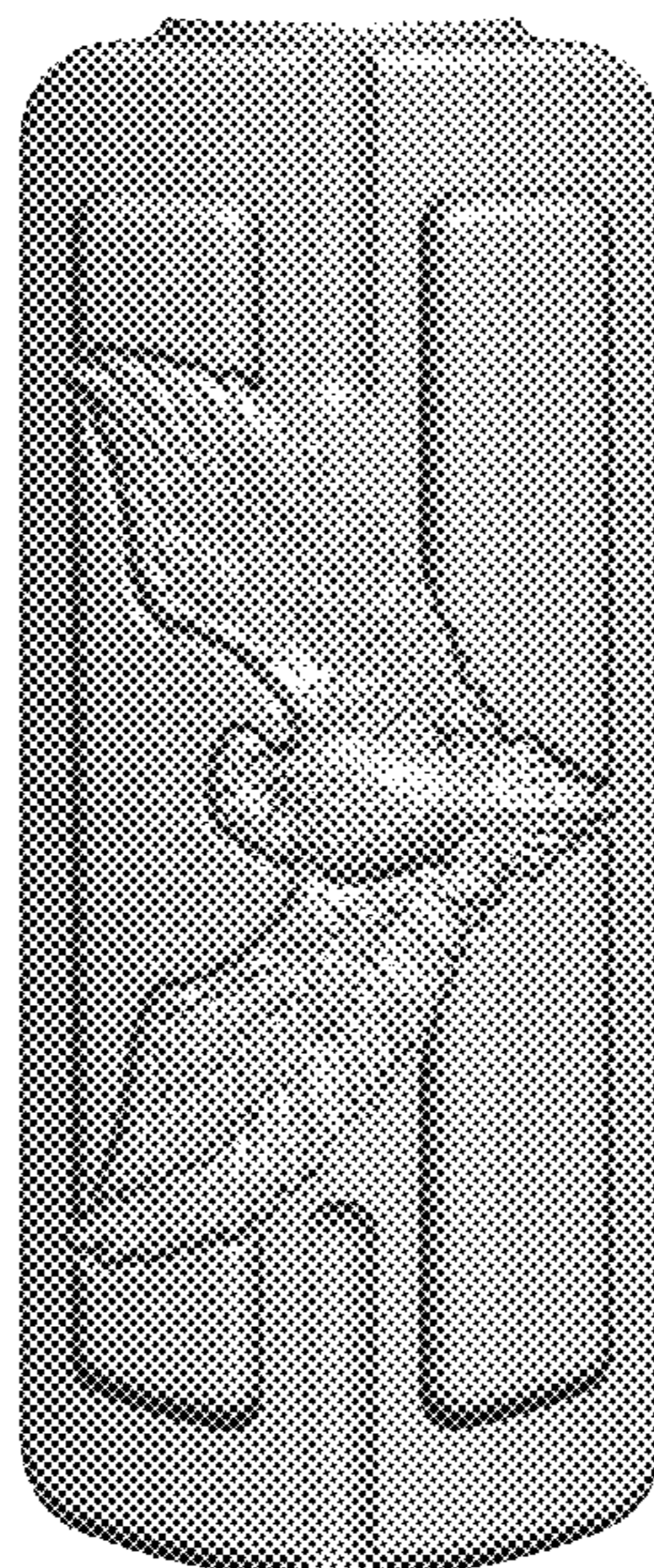



FIG.1



FIG.2

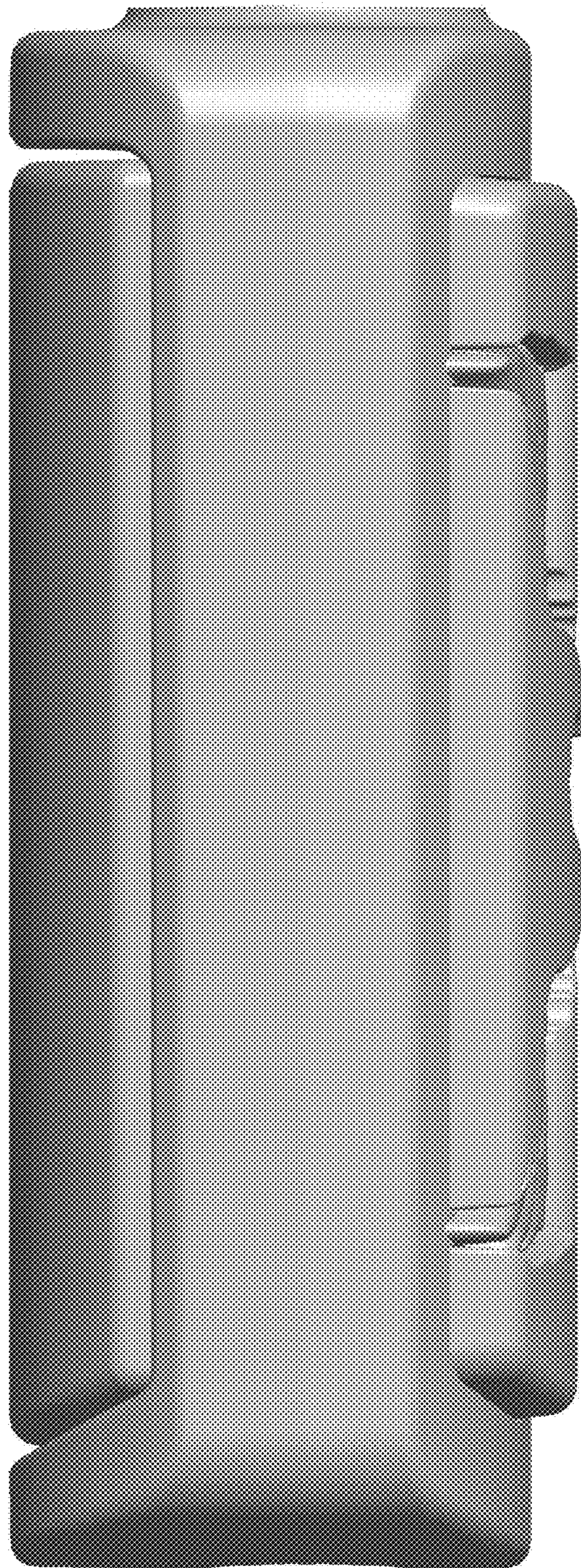

FIG.3

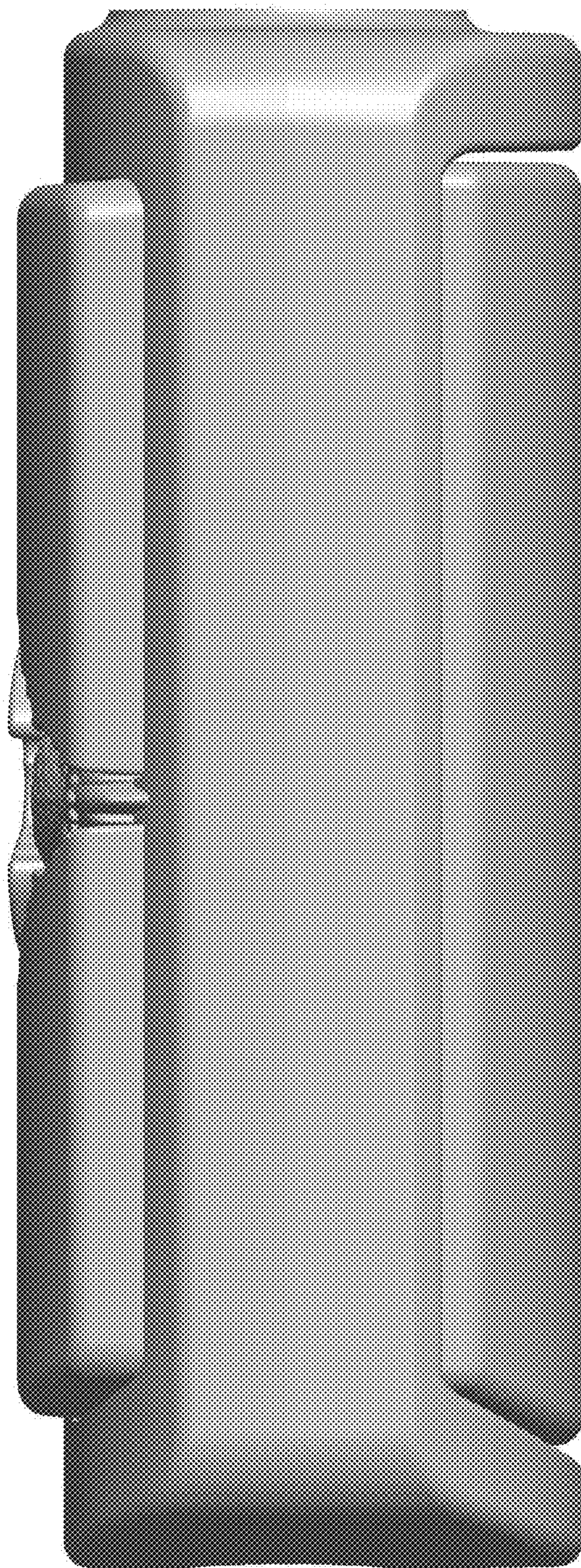

FIG.4

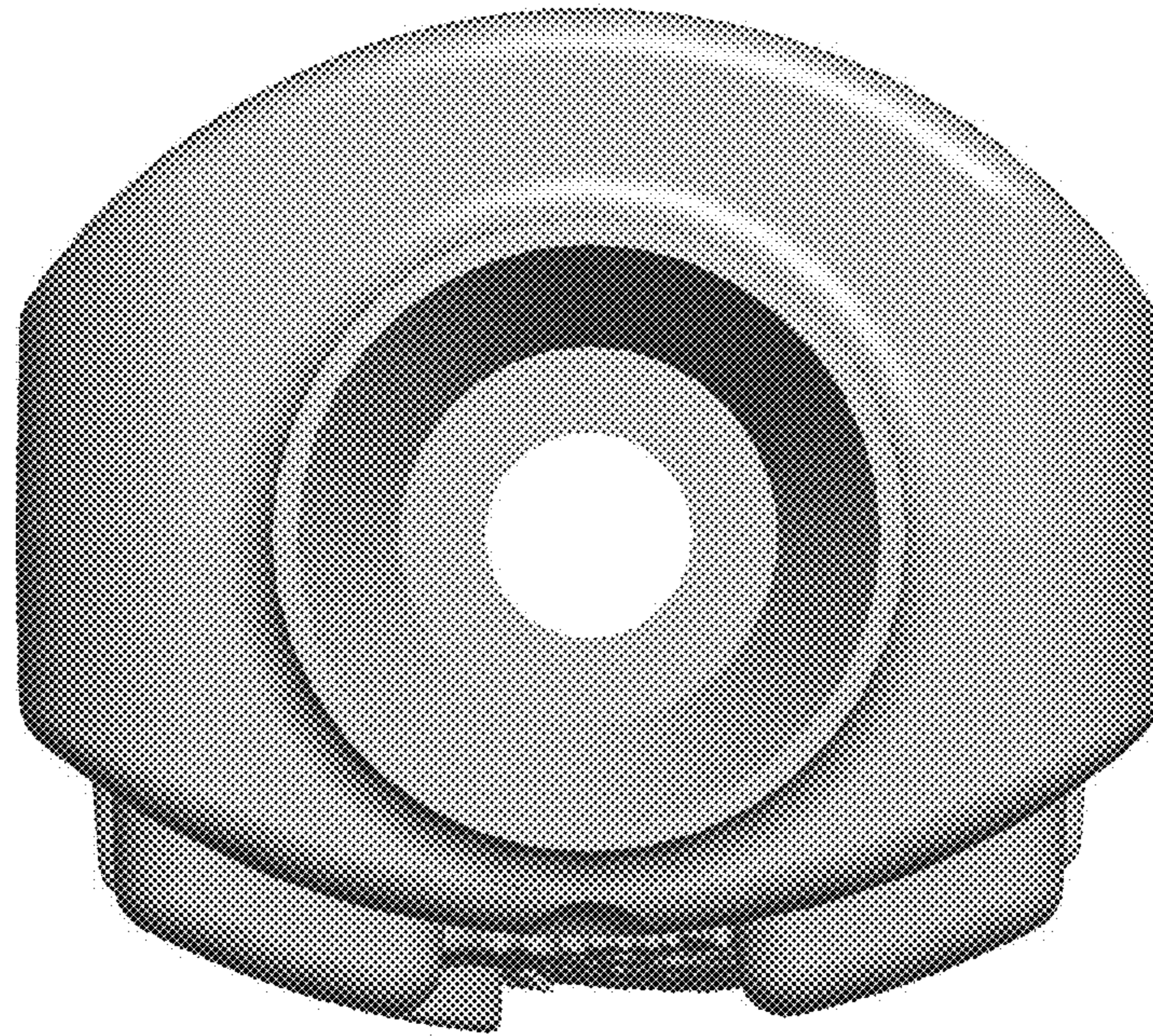

FIG. 5

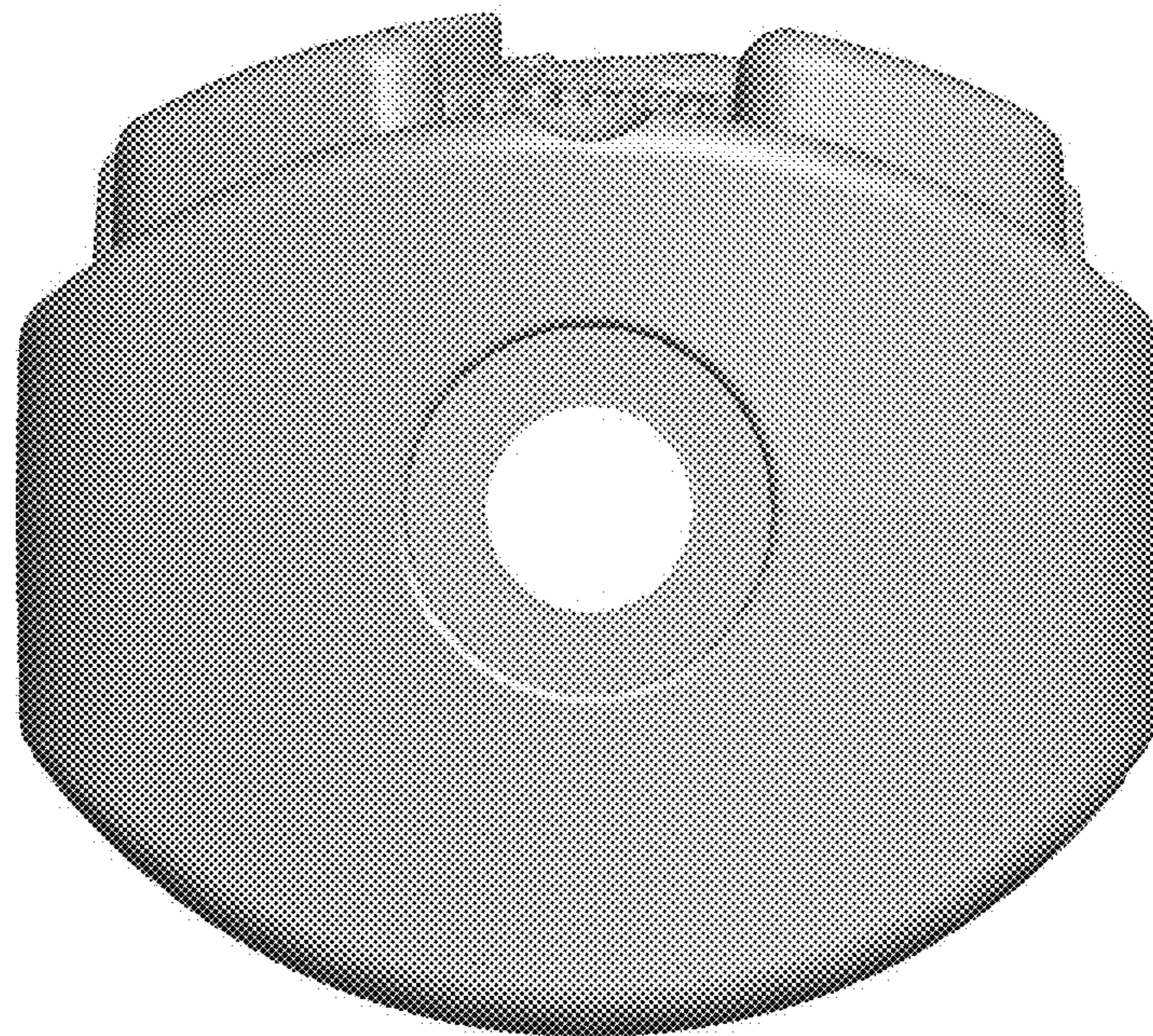

FIG. 6

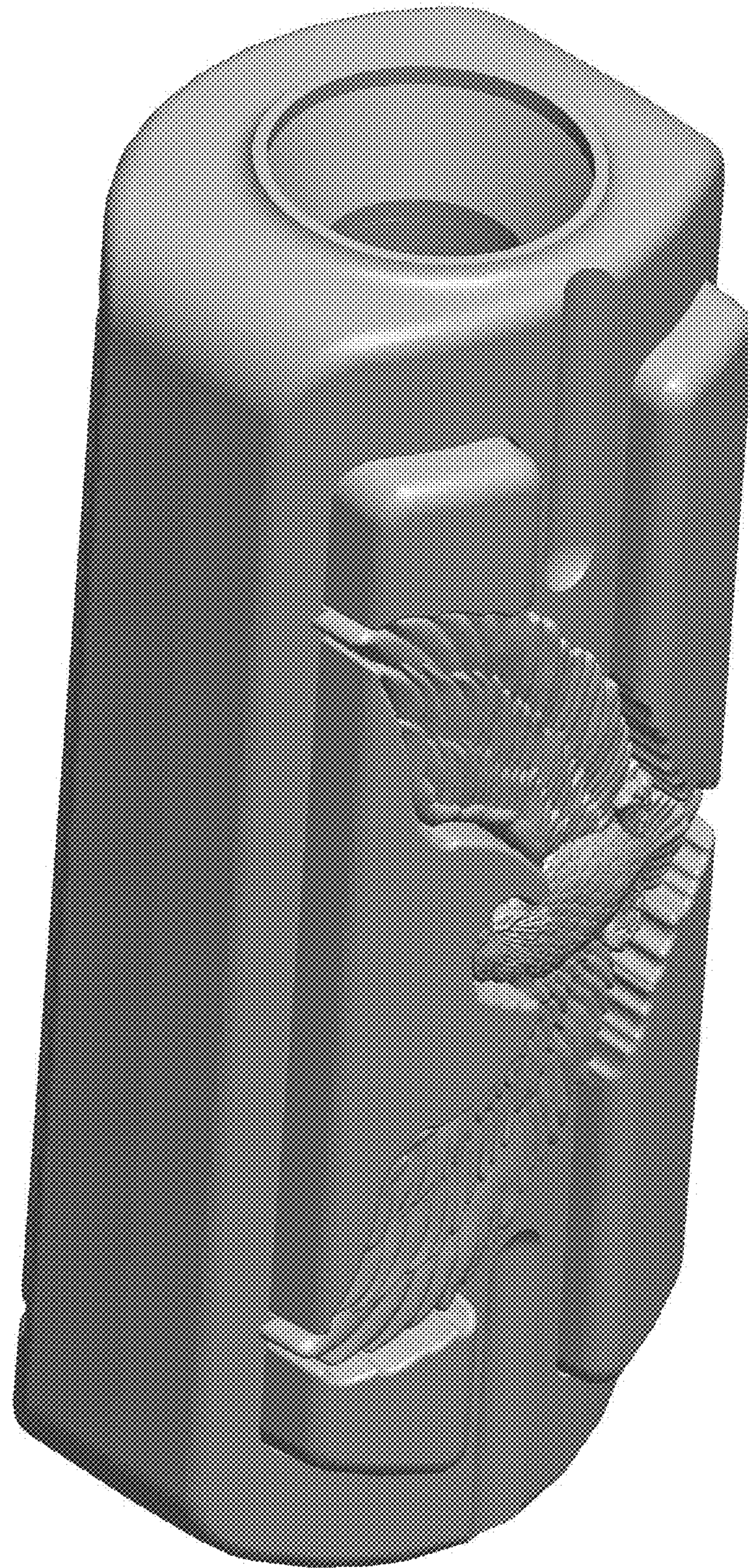

FIG.7

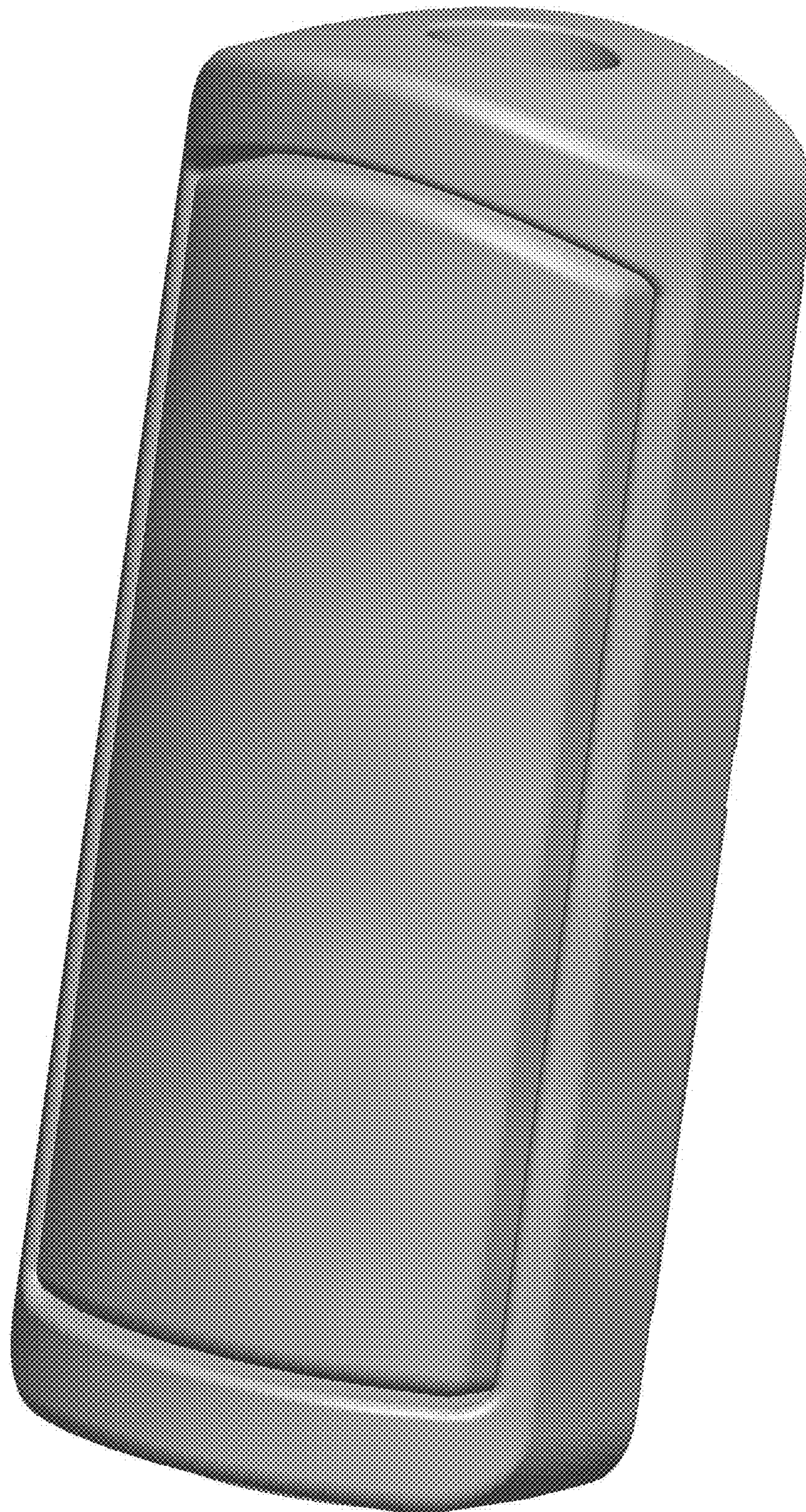

FIG.8

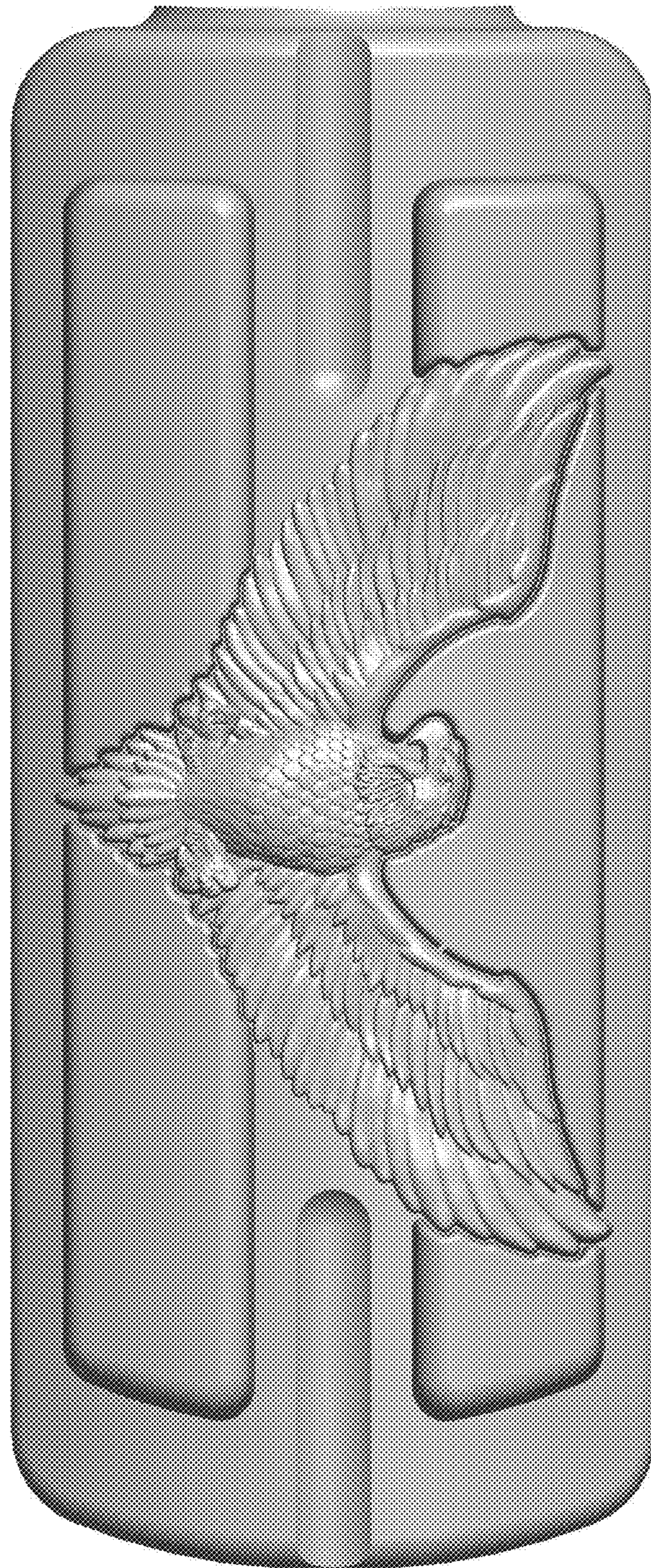

FIG.9



FIG.10

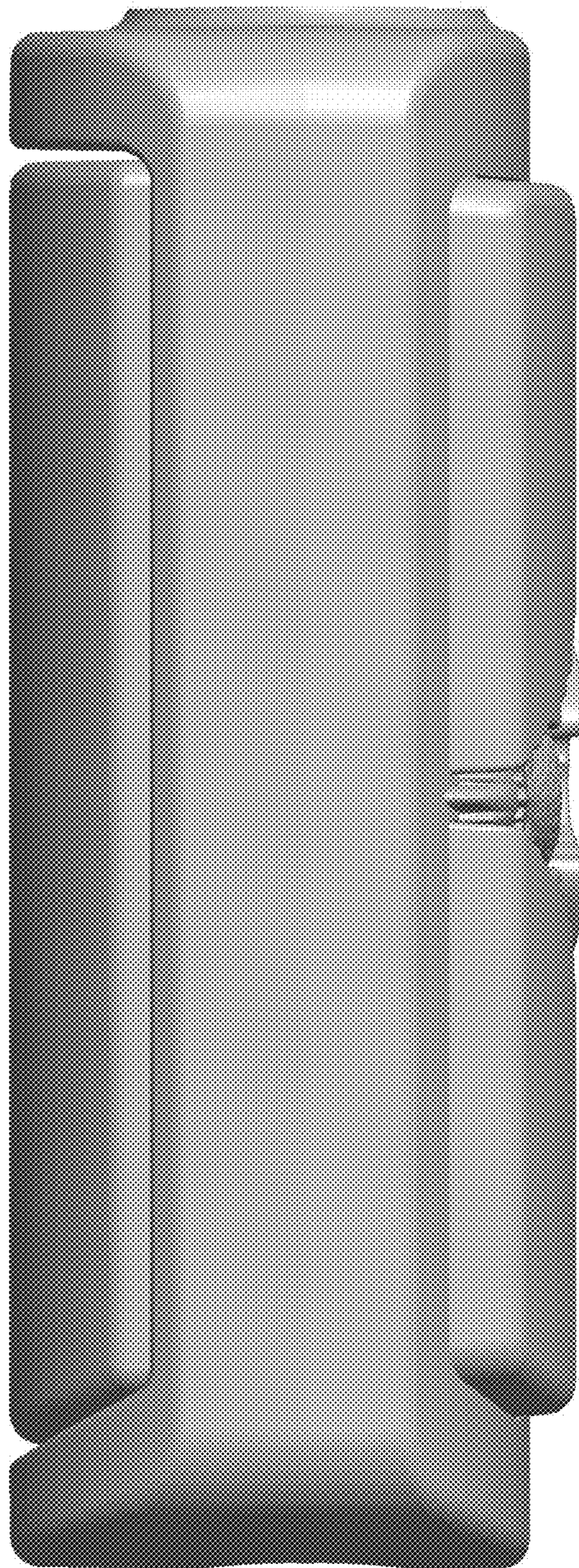

FIG.11

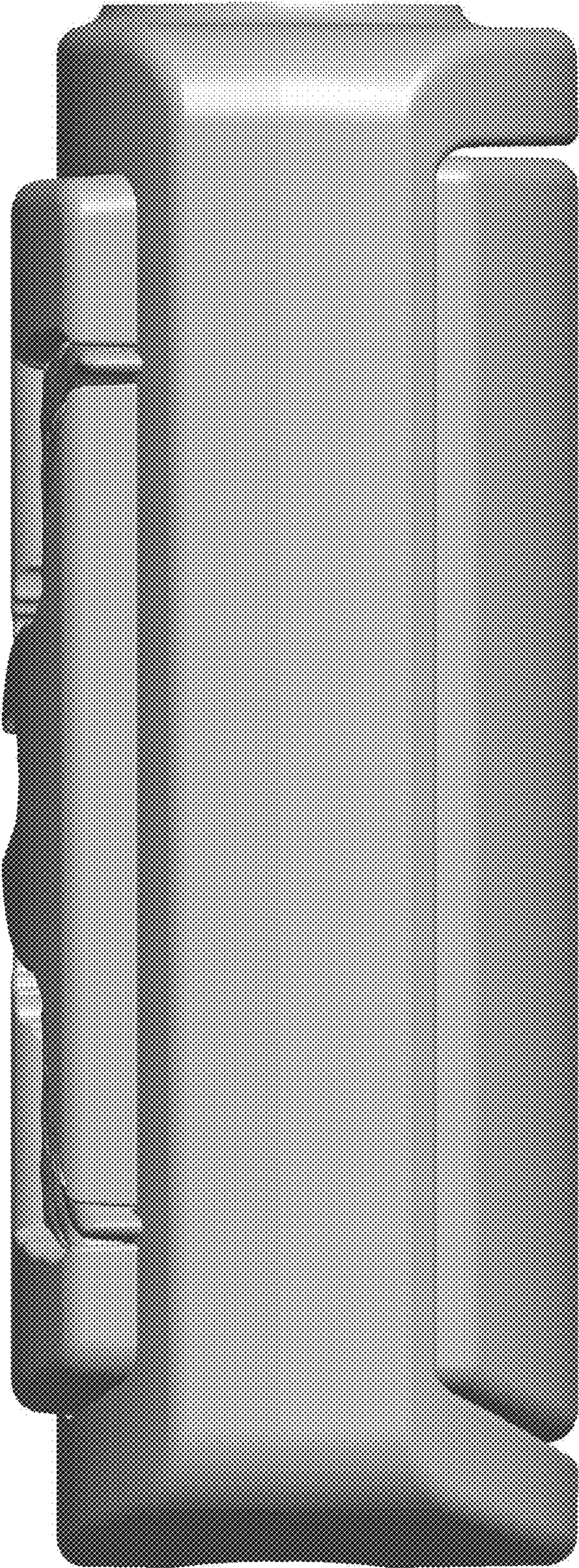

FIG.12

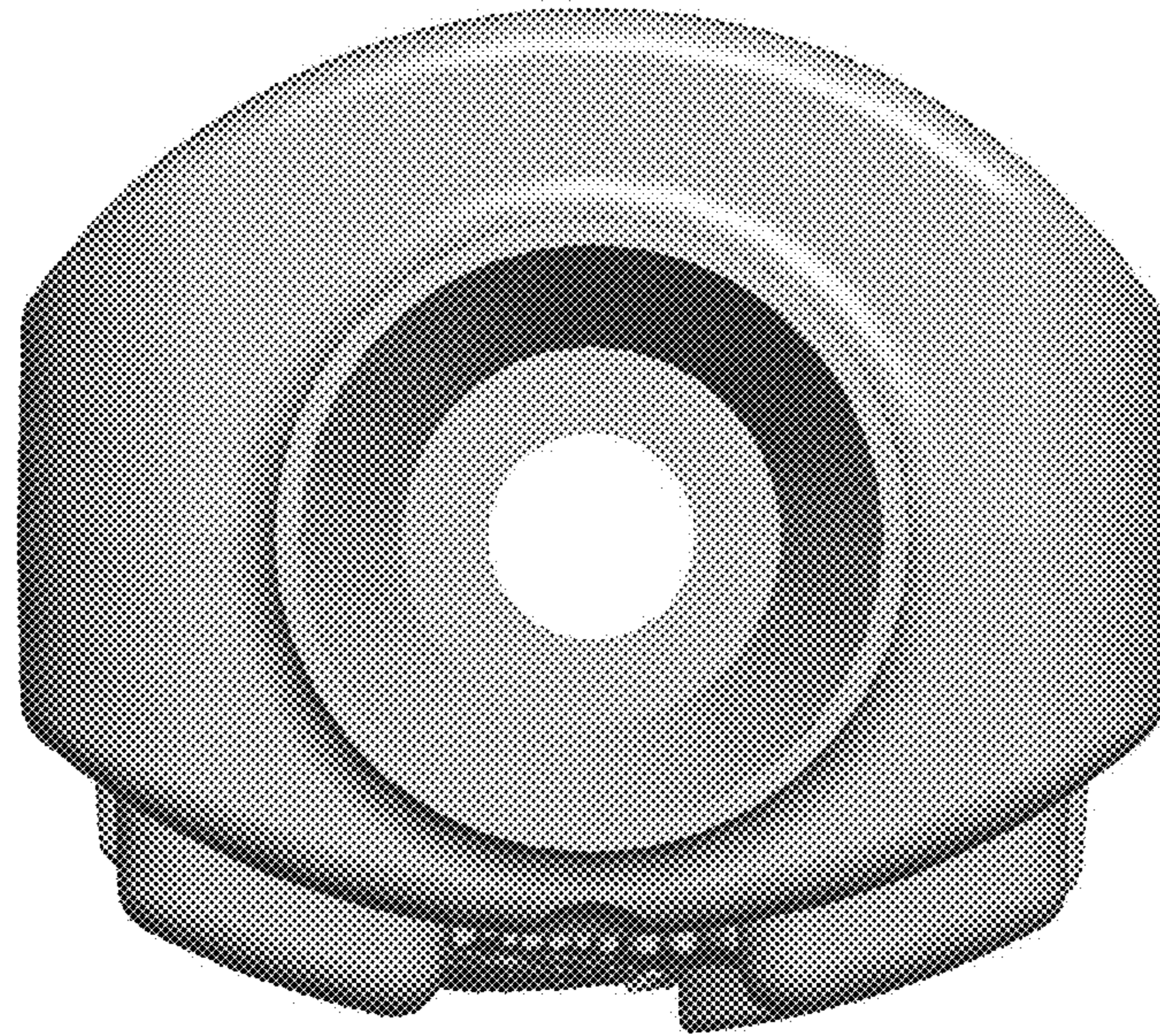

FIG. 13



FIG. 14

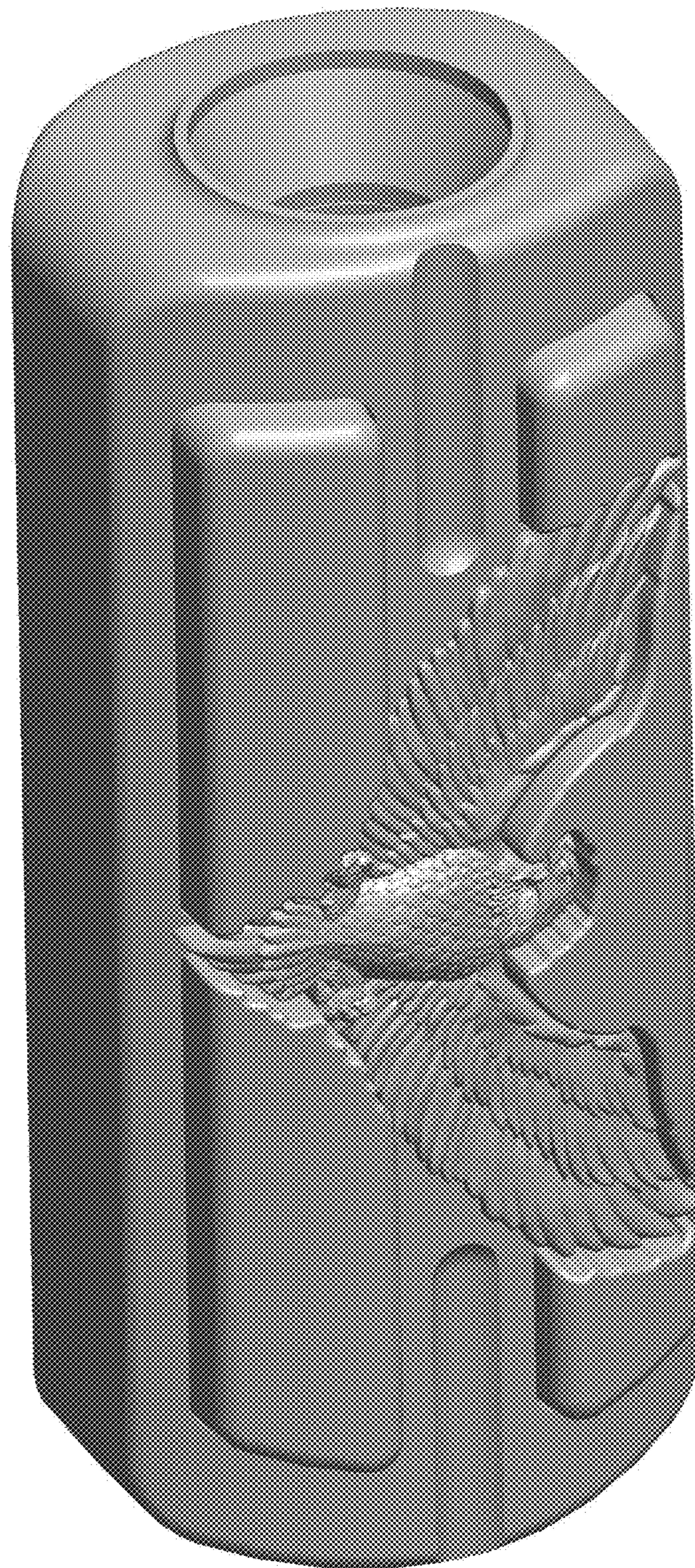

FIG.15

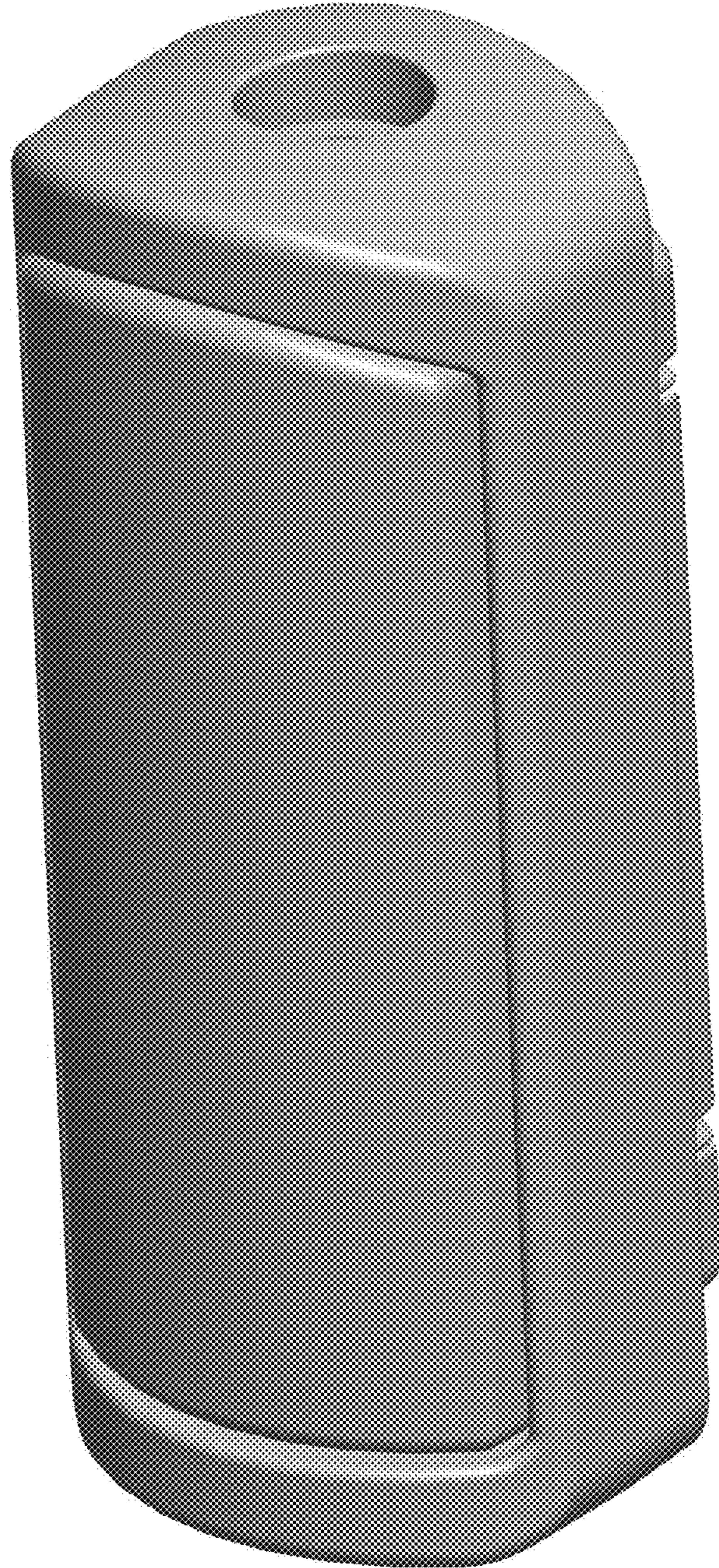

FIG.16