



US00D796630S

(12) **United States Design Patent**
Yang et al.

(10) **Patent No.:** **US D796,630 S**
(45) **Date of Patent:** **** Sep. 5, 2017**

- (54) **SPRAY GUN**
- (71) Applicant: **ZHEJIANG PRULDE ELECTRIC APPLIANCE CO., LTD**, Jinhua (CN)
- (72) Inventors: **Weiming Yang**, Jinhua (CN); **Ting Han**, Jinhua (CN)
- (73) Assignee: **Zhejiang Prulde Electric Appliance Co., Ltd.**, Jinhua (CN)
- (**) Term: **15 Years**
- (21) Appl. No.: **29/573,915**
- (22) Filed: **Aug. 10, 2016**
- (30) **Foreign Application Priority Data**

| | | | | | | |
|-----------|----|---|---------|---------|-------|------------------------|
| D657,016 | S | * | 4/2012 | Crawley | | D23/225 |
| D664,628 | S | * | 7/2012 | Zhou | | D23/225 |
| 8,267,332 | B1 | * | 9/2012 | Jones | | B05B 1/3436 239/463 |
| D692,095 | S | * | 10/2013 | Hines | | D23/225 |
| 8,550,376 | B2 | * | 10/2013 | Munn | | B05B 7/0815 239/290 |
| D693,428 | S | * | 11/2013 | Tullney | | D23/225 |
| D713,500 | S | * | 9/2014 | Muhl | | D23/225 |
| 8,944,348 | B2 | * | 2/2015 | Zhou | | H02K 7/145 222/401 |
| D723,659 | S | * | 3/2015 | Tullney | | D23/225 |
| 9,174,231 | B2 | * | 11/2015 | Shultz | | B05B 9/043 |
| 9,180,472 | B2 | * | 11/2015 | Munn | | B05B 9/01 |
| D757,897 | S | * | 5/2016 | Tullney | | D23/223 |
| D759,199 | S | * | 6/2016 | Wrobel | | D23/225 |

* cited by examiner

Primary Examiner — Robin V Webster

(74) *Attorney, Agent, or Firm* — Wang Law Firm, Inc.

- Apr. 18, 2016 (CN) 2016 3 0129314
- (51) **LOC (10) Cl.** **23-01**
- (52) **U.S. Cl.**
USPC **D23/225**
- (58) **Field of Classification Search**
USPC D23/213, 223, 225, 226; 239/304,
239/DIG. 14, 146, 147; 222/465.1
CPC B05B 7/26; B05B 7/2443; B05B 9/0861;
B05B 11/00; B05B 7/1413; B05B 9/01;
B05B 9/03; B05B 7/1209; B05B 12/002
See application file for complete search history.

(57) **CLAIM**

The ornamental design for a spray gun, as shown and described.

DESCRIPTION

FIG. 1 is a right view showing my new design;
 FIG. 2 is a rear view thereof;
 FIG. 3 is a front view thereof;
 FIG. 4 is a left view thereof;
 FIG. 5 is a top view thereof;
 FIG. 6 is a bottom view thereof; and,
 FIG. 7 is a perspective view thereof.

The broken lines shown on the drawings are for the purpose of illustration and form no part of the claimed design.

(56) **References Cited**

U.S. PATENT DOCUMENTS

| | | | | | | |
|----------|---|---|--------|----------|-------|---------|
| D519,603 | S | * | 4/2006 | Schumann | | D23/225 |
| D651,691 | S | * | 1/2012 | Muetzel | | D23/225 |

1 Claim, 5 Drawing Sheets

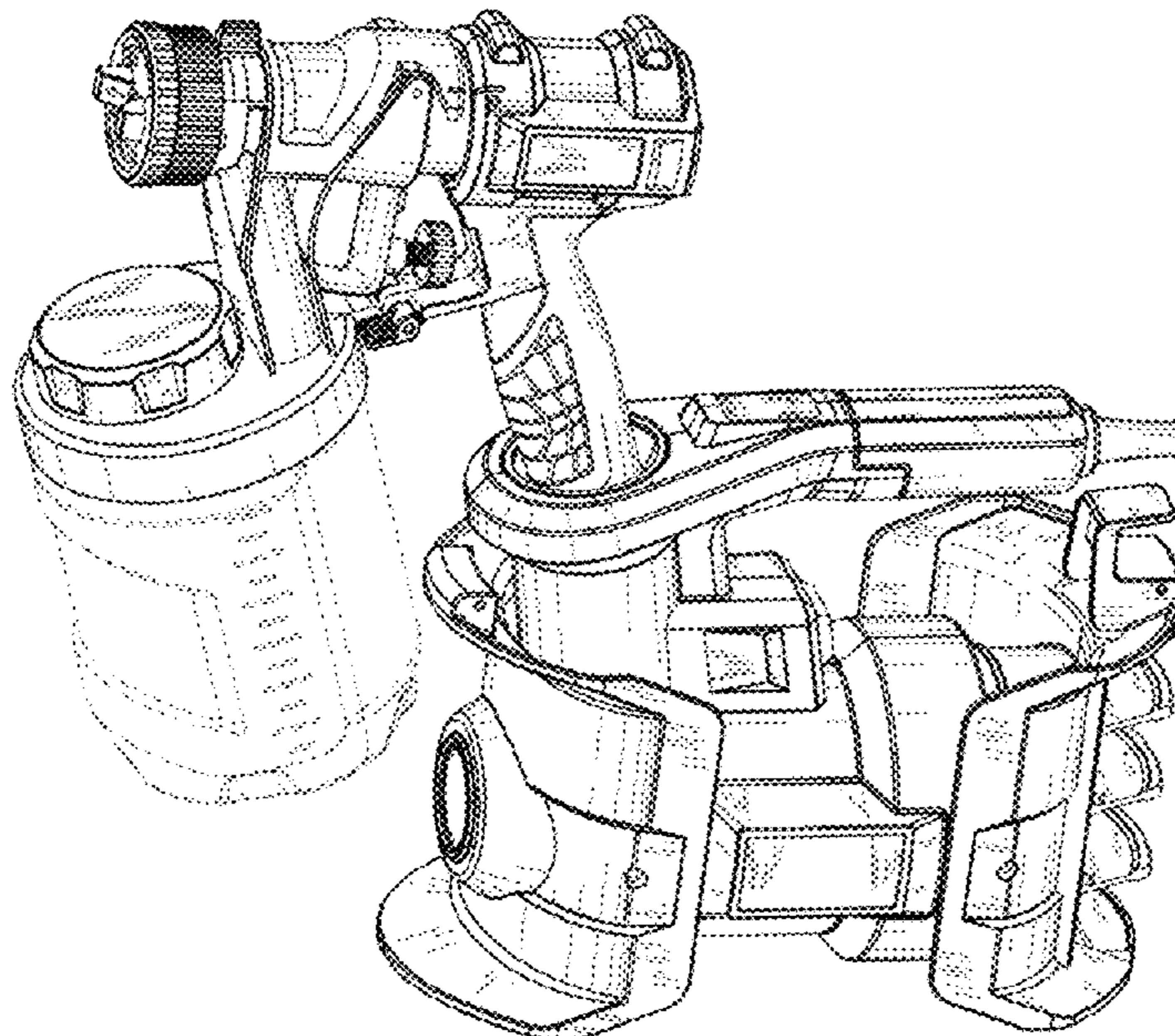

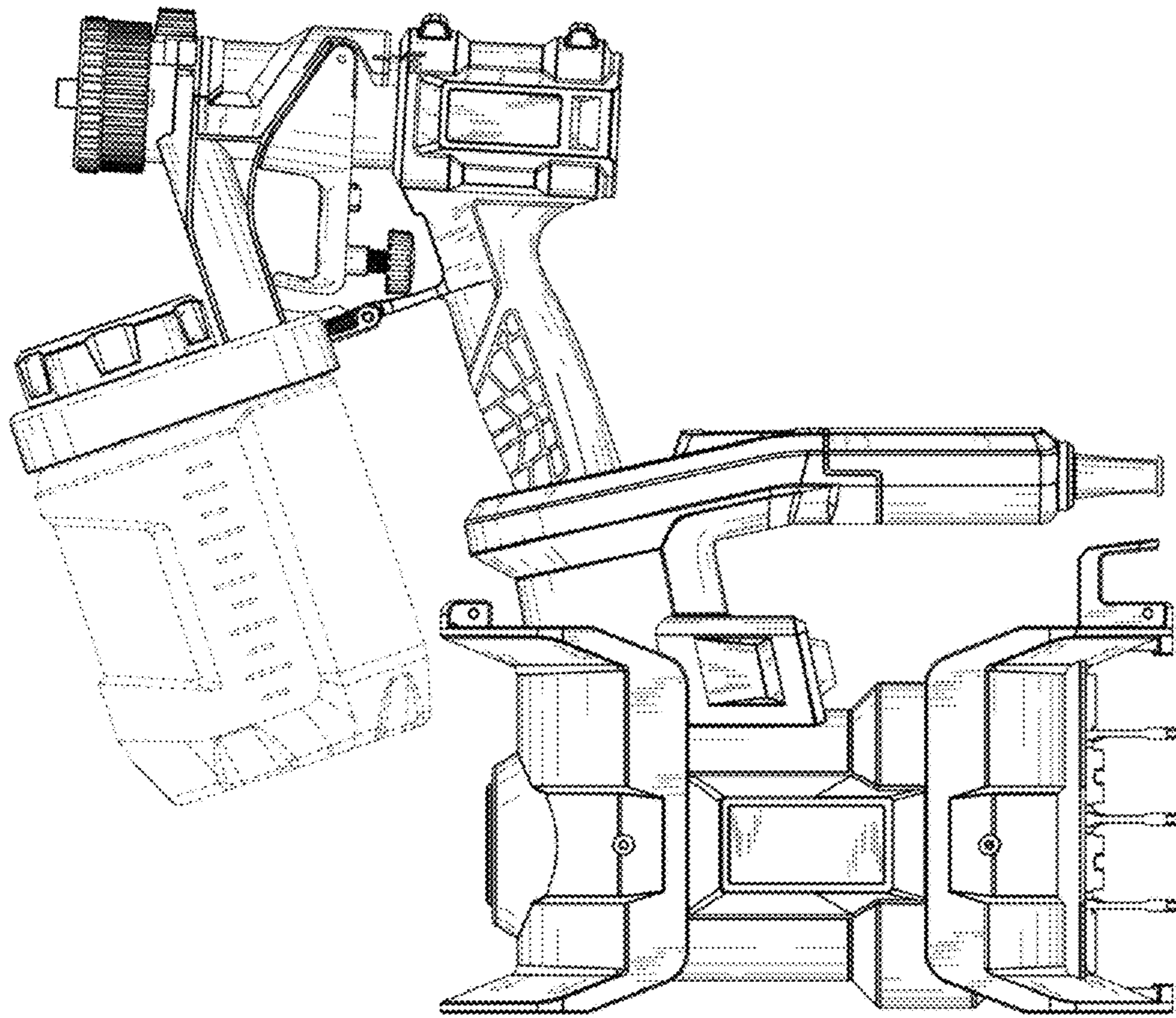

FIG. 1

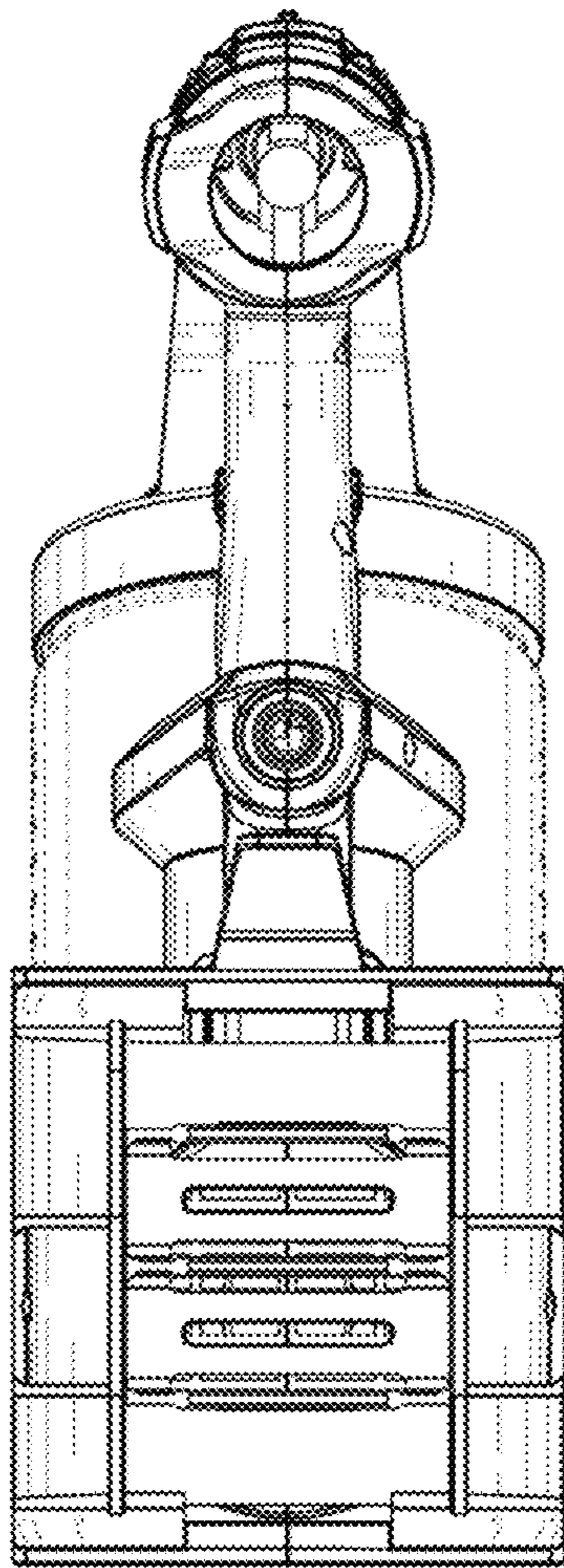

FIG. 2

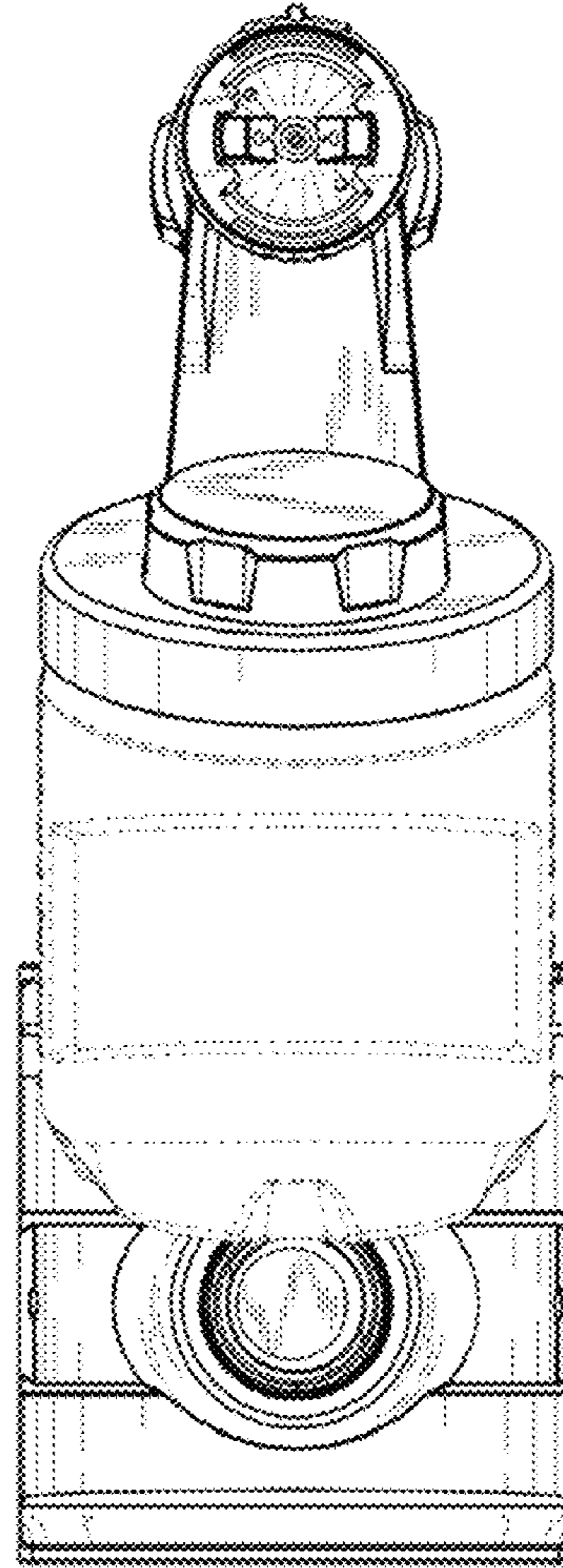

FIG. 3

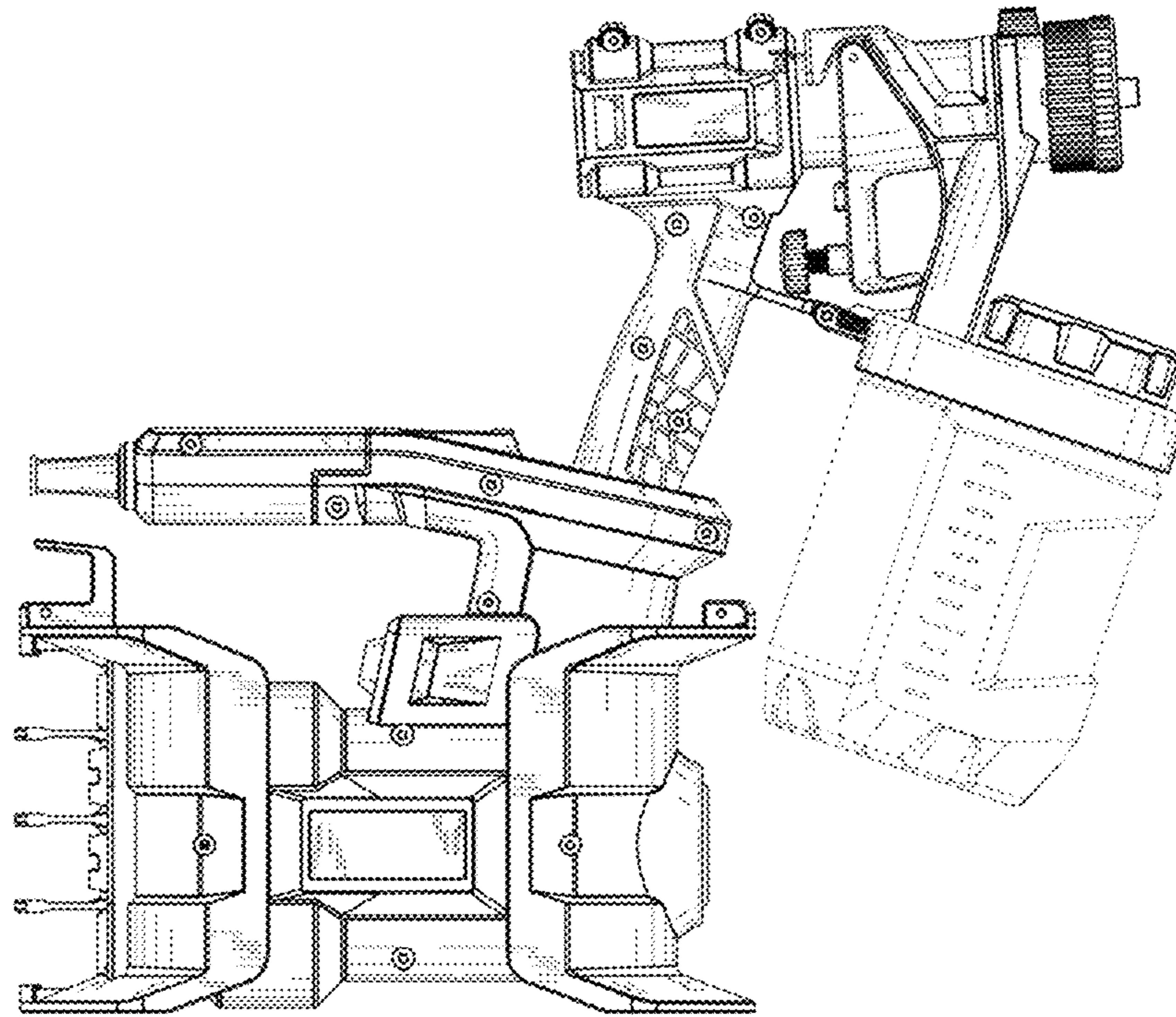

FIG. 4

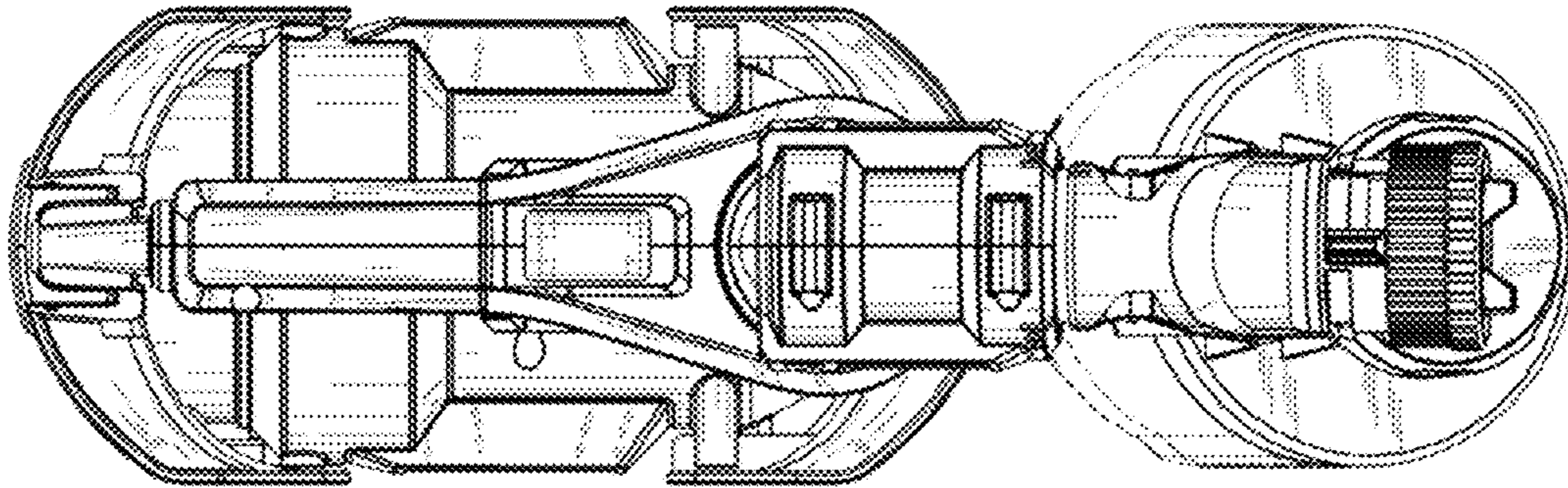

FIG. 5

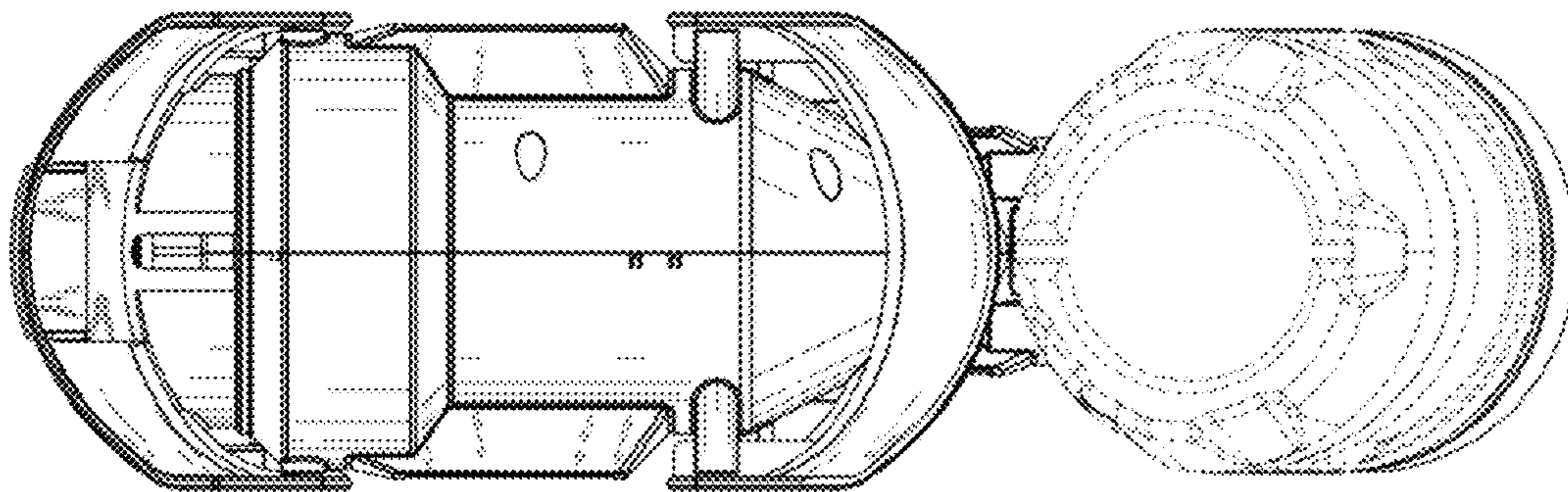

FIG. 6

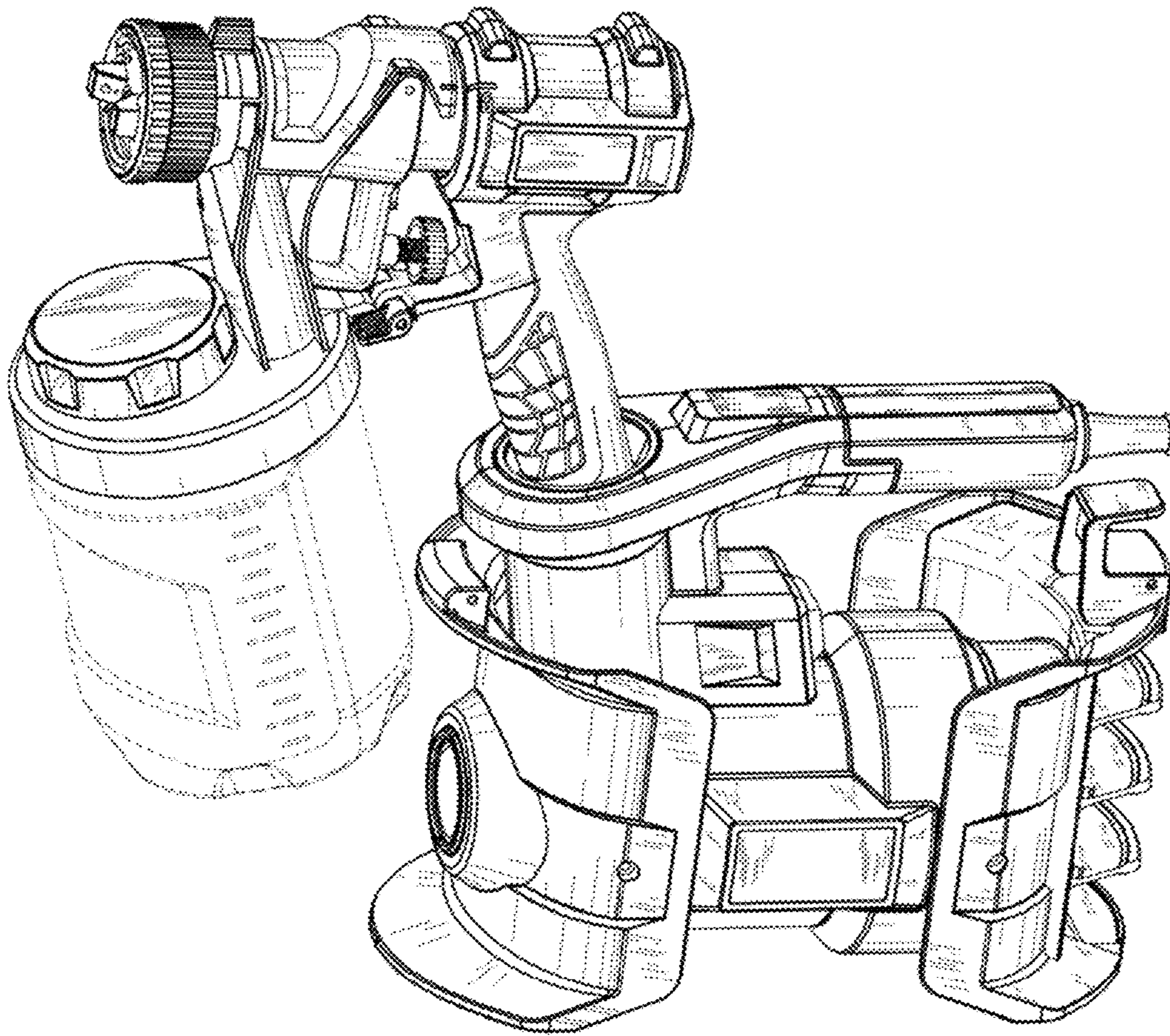

FIG. 7