



US00D795027S

(12) **United States Design Patent**
Kolano

(10) **Patent No.:** **US D795,027 S**

(45) **Date of Patent:** **** Aug. 22, 2017**

(54) **COMBINED COOKIE STAMP CONTAINER AND STAMPS**

(71) Applicant: **HUTZLER MANUFACTURING CO., INC.**, Canaan, CT (US)

(72) Inventor: **William Kolano**, Pittsburgh, PA (US)

(73) Assignee: **Hutzler Manufacturing Co., Inc.**, Canaan, CT (US)

(**) Term: **15 Years**

(21) Appl. No.: **29/585,264**

(22) Filed: **Nov. 22, 2016**

4,424,601	A *	1/1984	Weber	A21C 11/106	30/302
D274,592	S *	7/1984	Bever	426/87	
D401,482	S *	11/1998	De Are	D7/677	
D558,394	S *	12/2007	Lober	D18/16	
D570,157	S *	6/2008	De La Torre	D7/410	
D672,213	S *	12/2012	Abrams	D7/675	
D689,341	S *	9/2013	Dooley	D7/675	
2006/0225579	A1 *	10/2006	Errera	A21C 11/02	99/388
2008/0118605	A1 *	5/2008	Owen	A21C 14/00	426/87
2008/0241326	A1 *	10/2008	Ekberg	A21C 9/068	426/512
2010/0068321	A1 *	3/2010	Errera	A21C 11/02	425/96
2012/0251690	A1 *	10/2012	Flores	A21C 14/00	426/383

* cited by examiner

Related U.S. Application Data

(62) Division of application No. 29/513,944, filed on Jan. 7, 2015, now Pat. No. Des. 779,290.

(51) **LOC (10) Cl.** **07-99**

(52) **U.S. Cl.**
USPC **D7/669**

(58) **Field of Classification Search**
USPC D7/669, 368, 672-677, 629, 630
CPC A47J 9/00; A47J 37/0892; A22C 7/0076;
A21C 11/106; A21C 14/00; A21C 11/02;
A21C 9/068

See application file for complete search history.

(56) **References Cited**

U.S. PATENT DOCUMENTS

D14,102	S *	7/1883	Oyster	D7/675
2,312,511	A *	3/1943	Weinberg	A47J 9/00
					425/304
2,483,669	A *	10/1949	Reid	A47J 37/0892
					219/229
D204,554	S *	4/1966	Benz	D18/15

Primary Examiner — Terry Wallace

(74) *Attorney, Agent, or Firm* — Michael J. Striker

(57) **CLAIM**

The ornamental design for combined cookie stamp container and stamps, as shown and described.

DESCRIPTION

FIG. 1 is an exploded top perspective view of combined cookie stamp container and stamps showing my new design; FIG. 2 is an exploded bottom perspective view thereof; FIG. 3 is an exploded front elevational view thereof; FIG. 4 is an exploded rear elevational view thereof; FIG. 5 is an exploded left elevational view thereof; FIG. 6 is an exploded right elevational view thereof; FIG. 7 is an exploded top elevational view thereof; and, FIG. 8 is an exploded bottom elevational view thereof. The broken lines are for illustrative purposes only and form no part of the claimed design.

1 Claim, 8 Drawing Sheets

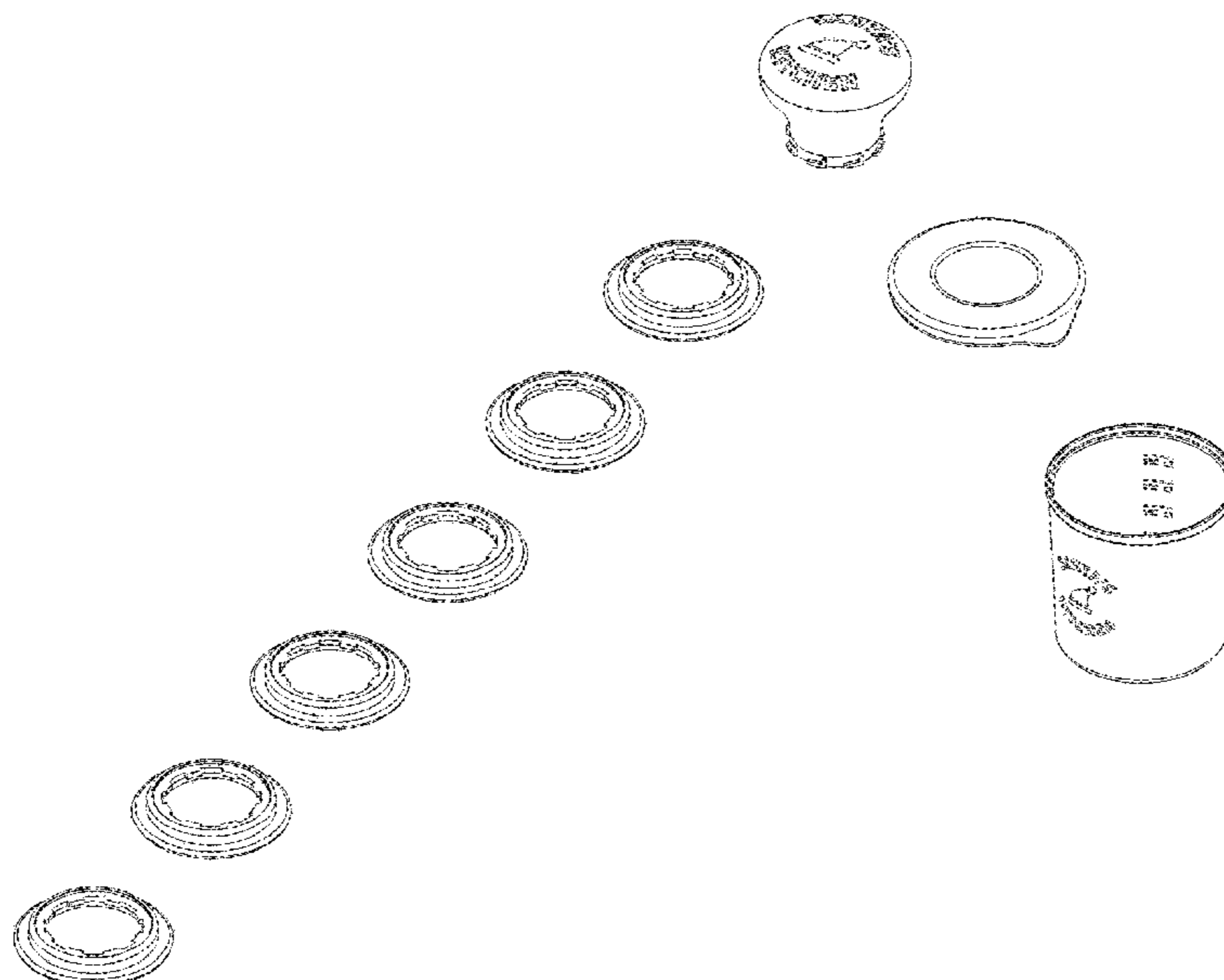

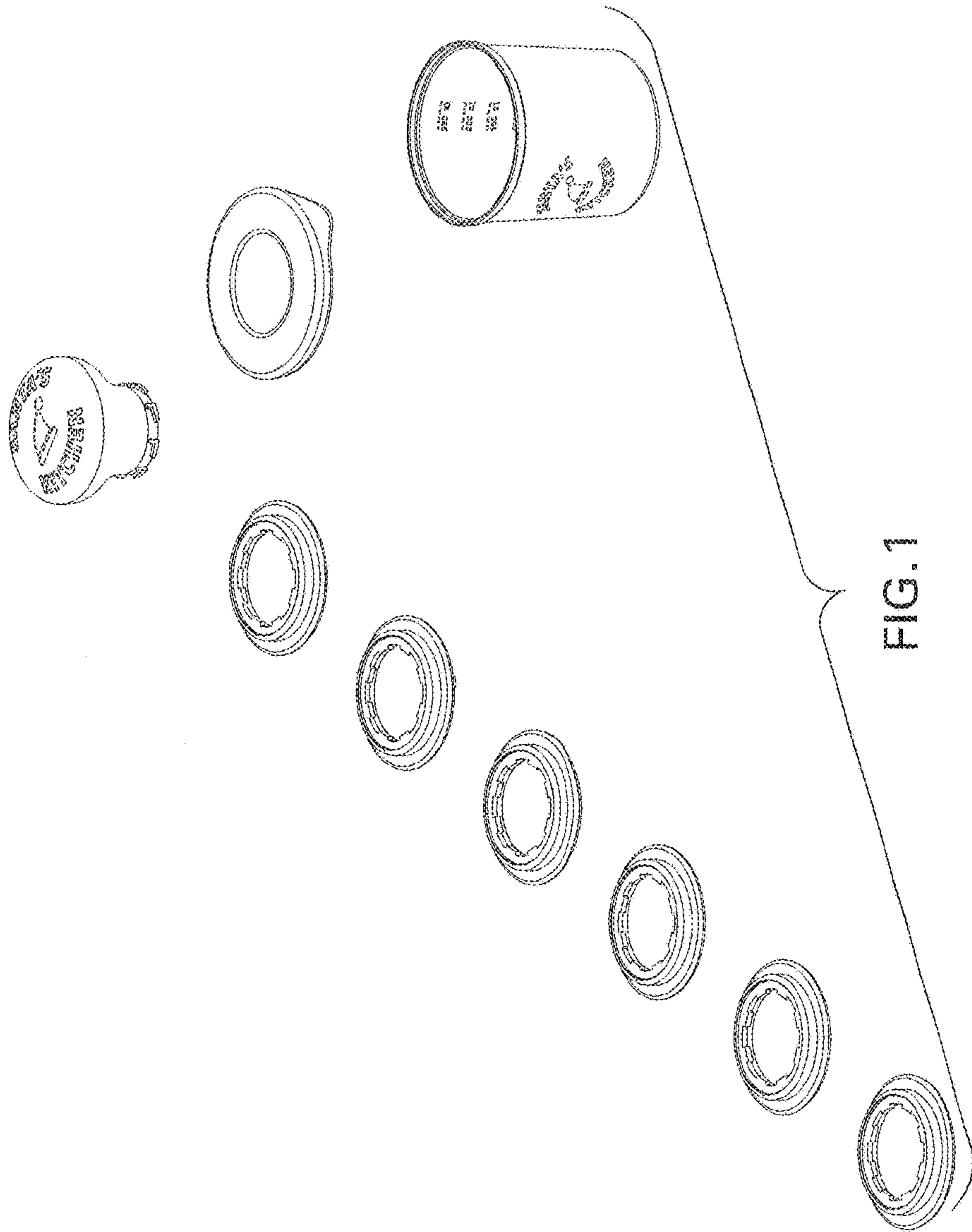

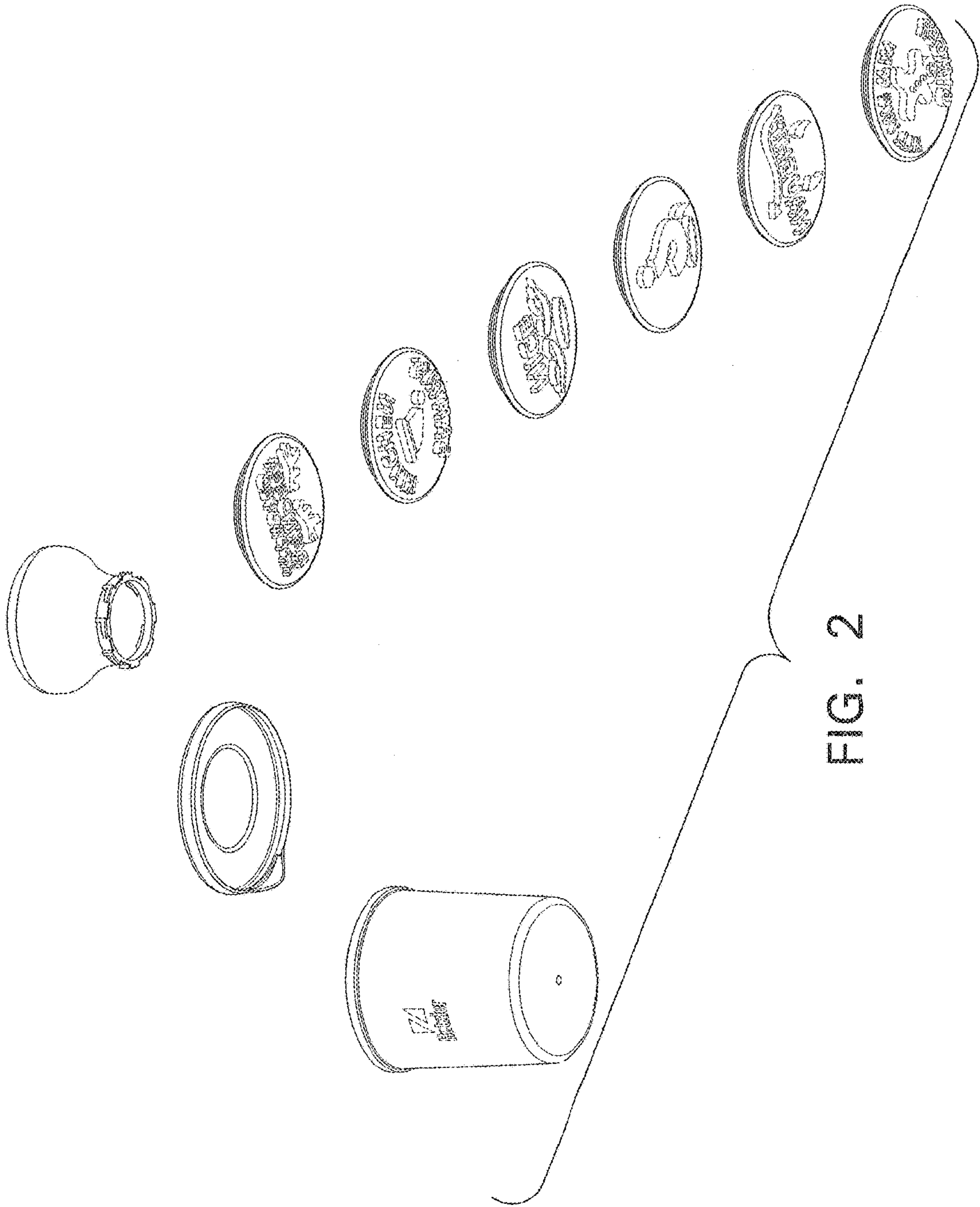

FIG. 2

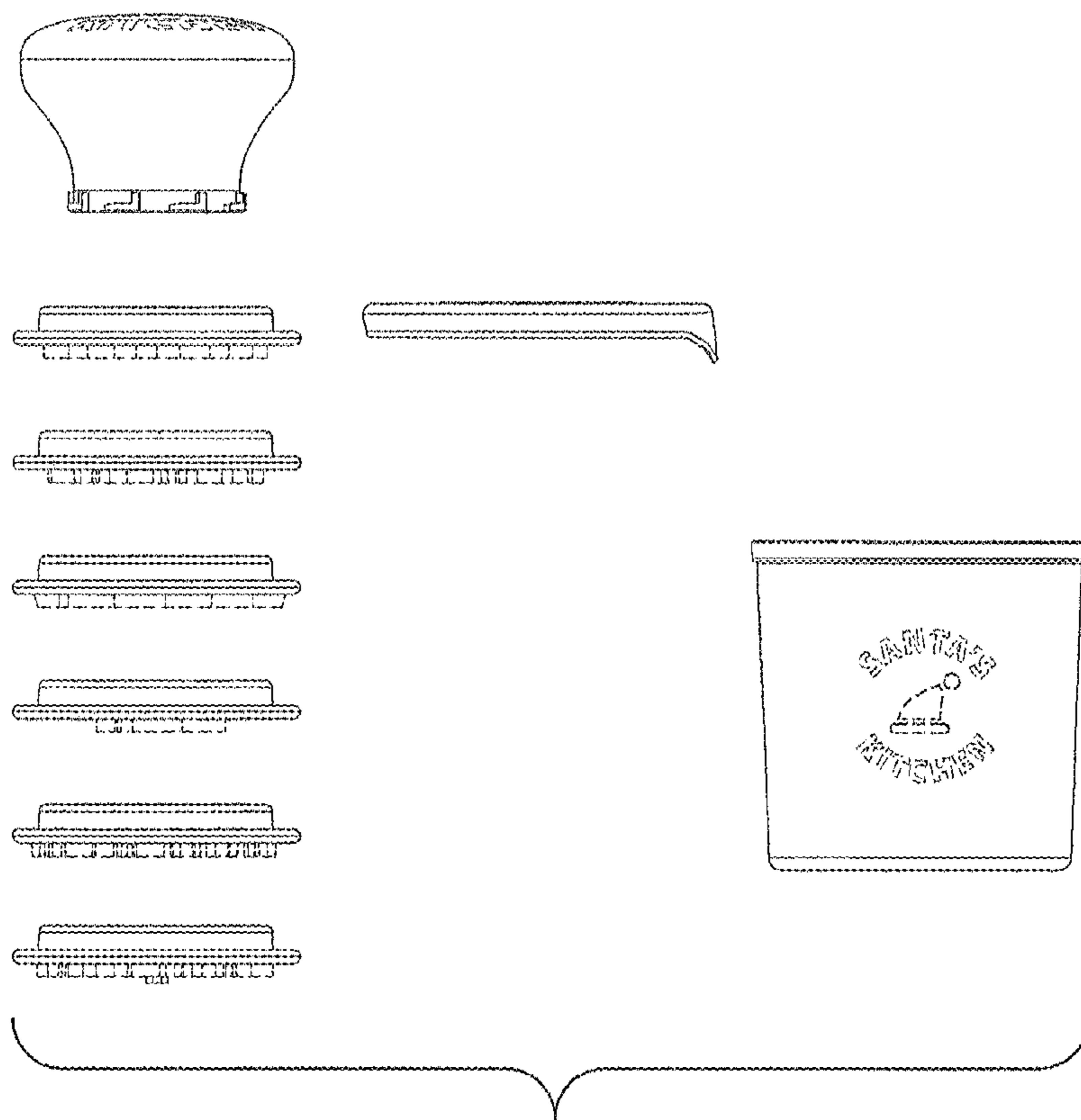

FIG. 3

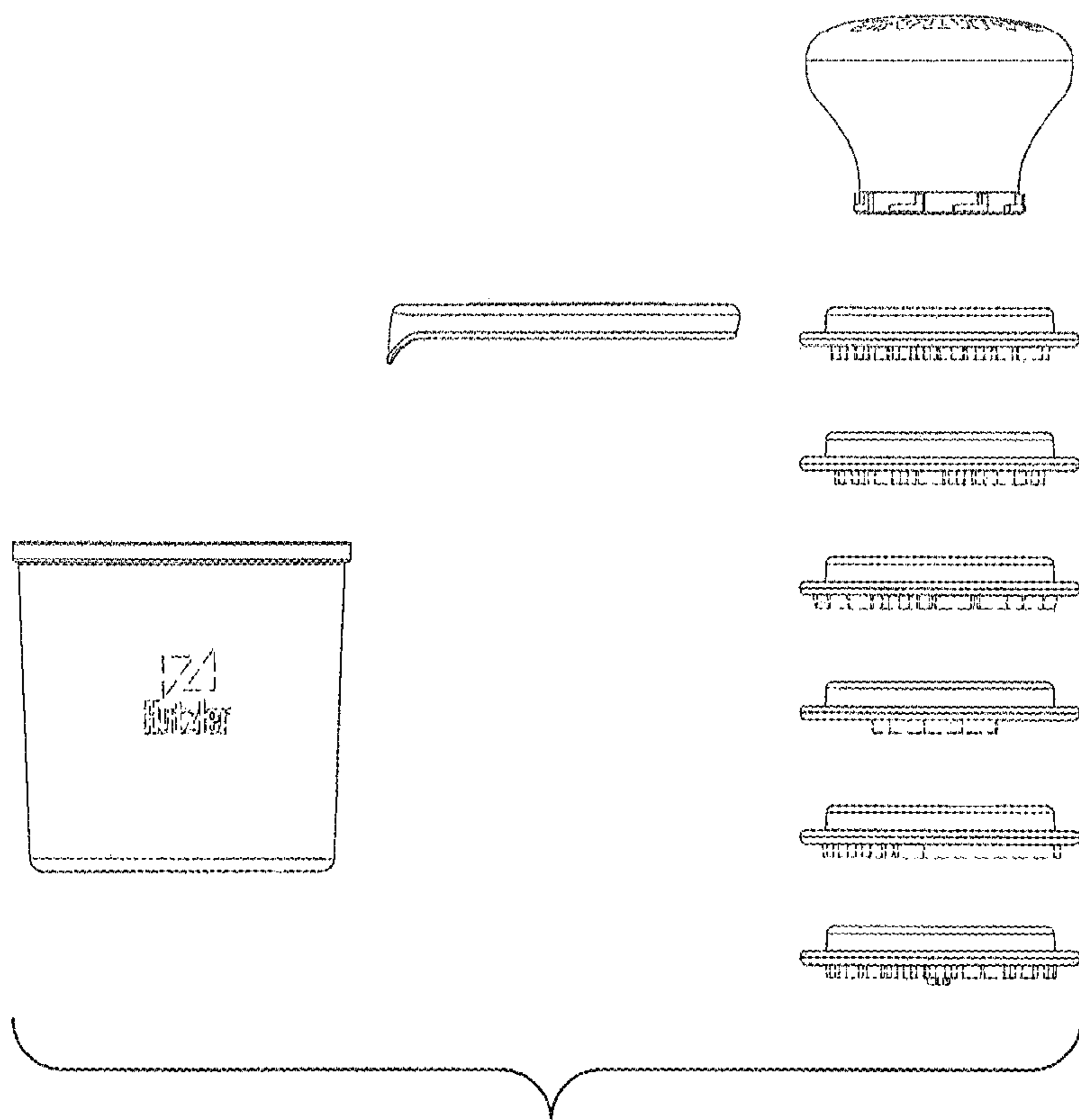

FIG. 4

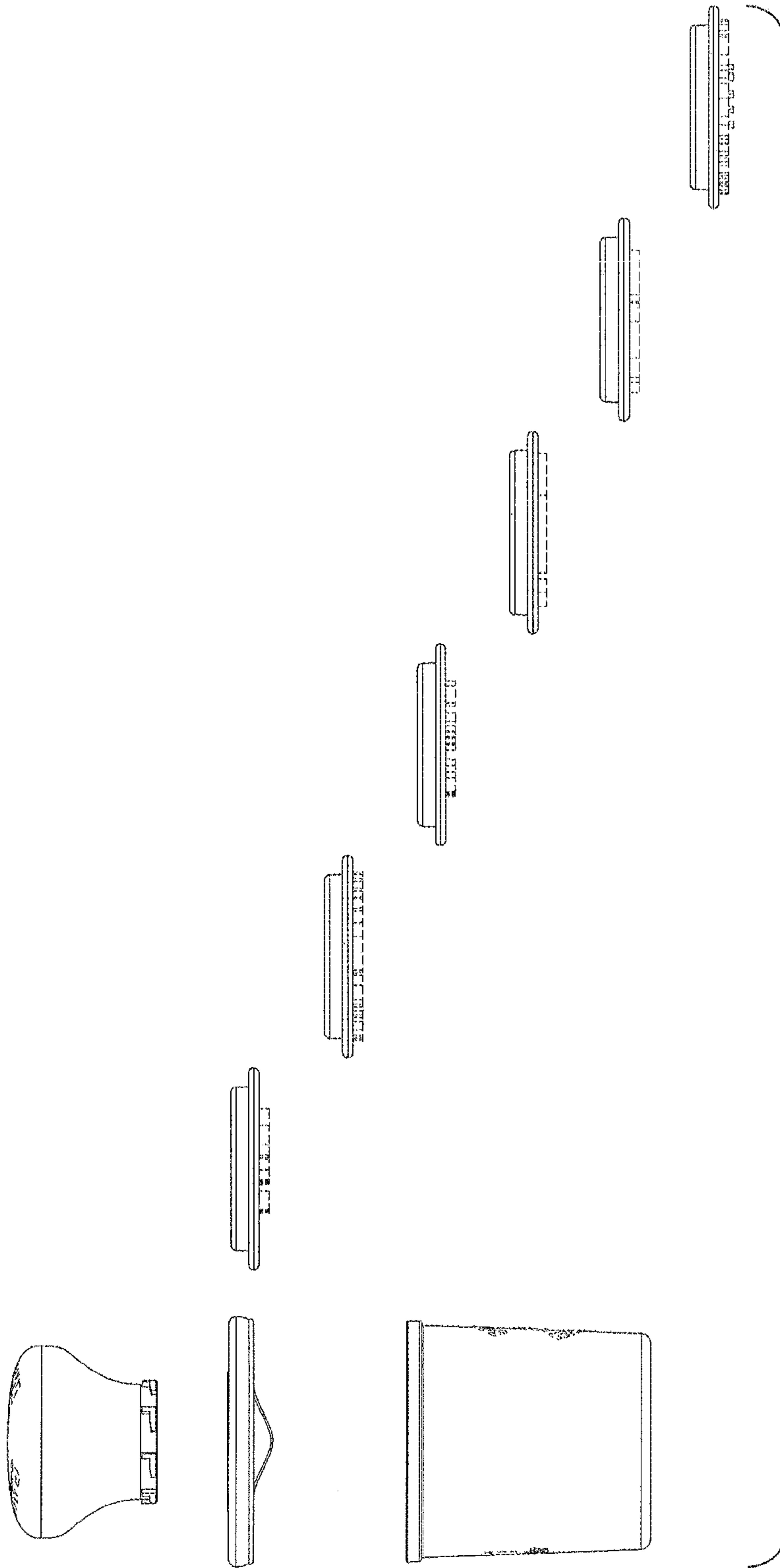
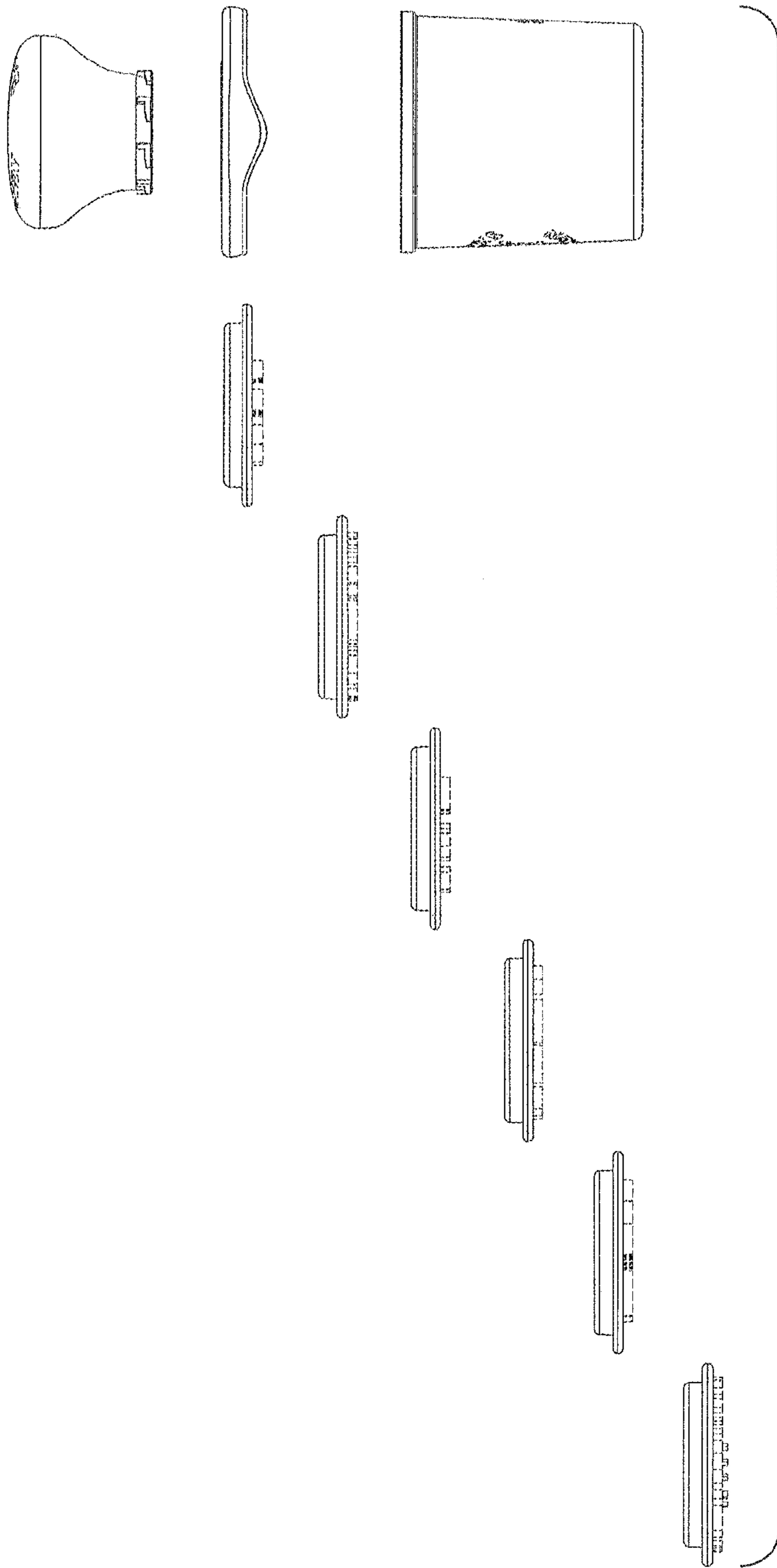

FIG. 5



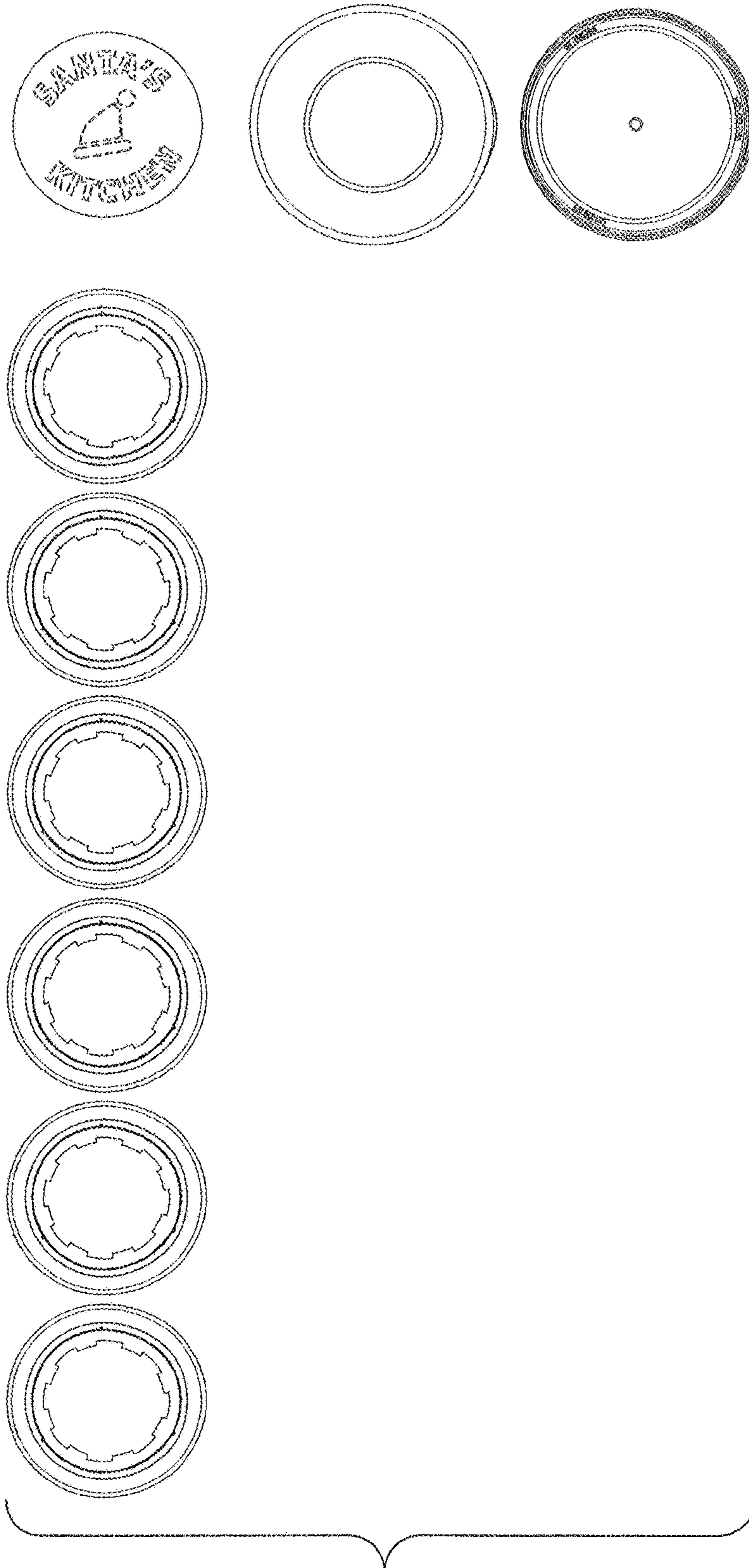

FIG. 7

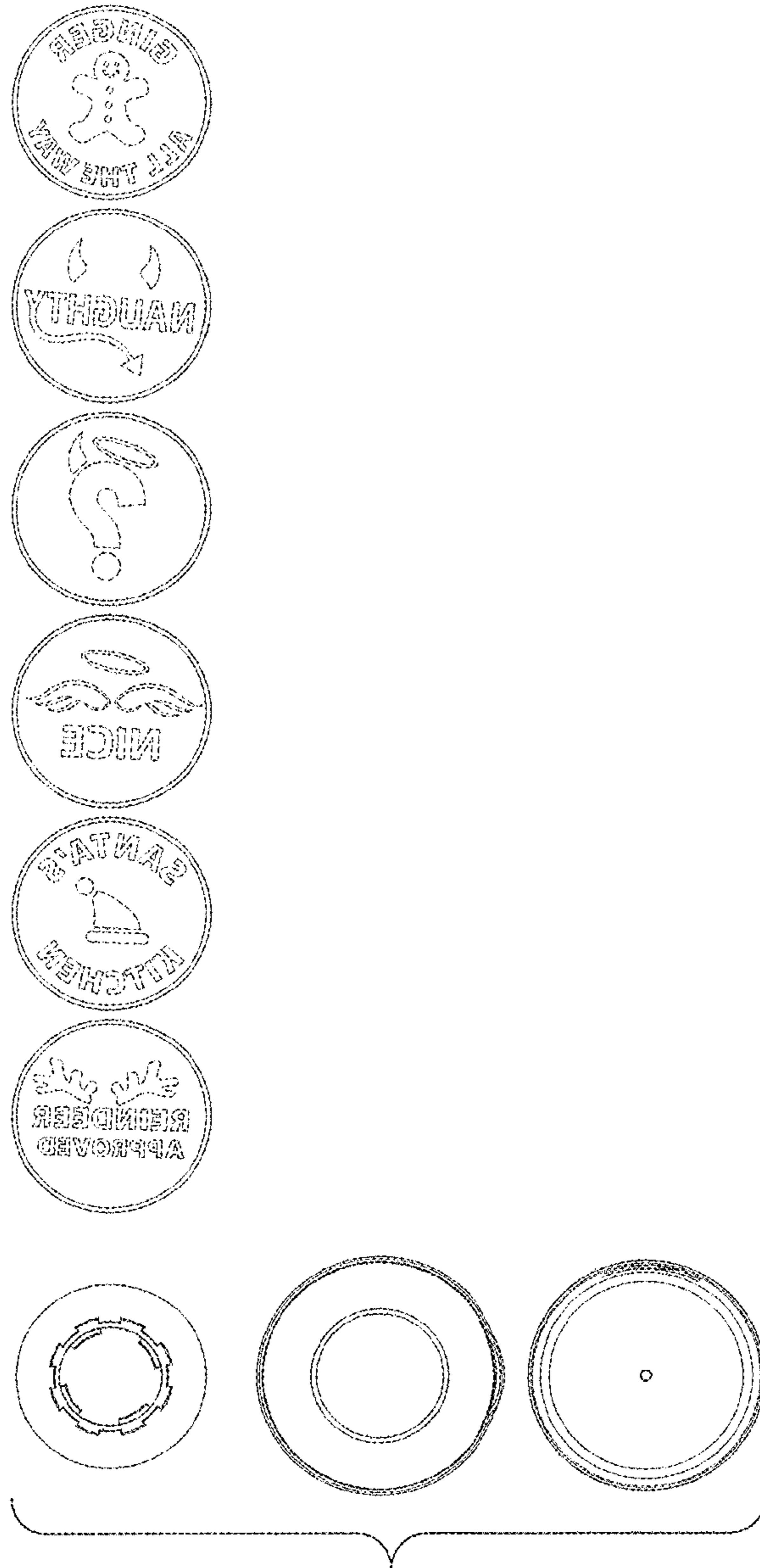

FIG. 8