



US00D794737S

(12) **United States Design Patent** (10) **Patent No.:** **US D794,737 S**  
**Boan** (45) **Date of Patent:** **\*\* Aug. 15, 2017**

(54) **GOLF TRAINING APPARATUS**  
(71) Applicant: **Scott Steven Boan**, Elburn, IL (US)  
(72) Inventor: **Scott Steven Boan**, Elburn, IL (US)  
(\*\*) Term: **15 Years**  
(21) Appl. No.: **29/554,352**  
(22) Filed: **Feb. 10, 2016**  
(51) **LOC (10) Cl.** ..... **21-02**  
(52) **U.S. Cl.**  
USPC ..... **D21/791**  
(58) **Field of Classification Search**  
USPC ..... D21/789, 791  
CPC ..... A63B 57/357; A63B 57/40; A63B 63/08;  
A63B 63/00; A63B 69/3676; A63B  
69/3697  
See application file for complete search history.

(56) **References Cited**  
U.S. PATENT DOCUMENTS  
1,417,458 A \* 5/1922 Cory ..... A63B 57/40  
473/189  
1,903,480 A \* 4/1933 Ryan ..... A63B 57/40  
473/180  
3,065,971 A \* 11/1962 Coles ..... A63B 57/405  
473/182  
3,424,464 A \* 1/1969 Greenhouse ..... A63B 57/357  
248/346.04  
D237,633 S \* 11/1975 Weber ..... D21/790

5,205,559 A \* 4/1993 Plopper ..... A63B 63/00  
273/127 B  
5,478,071 A 12/1995 Barrs et al.  
D385,610 S \* 10/1997 McDonald ..... D21/790  
D400,631 S \* 11/1998 Moore ..... D21/791  
D427,267 S \* 6/2000 Laperle ..... D21/791  
D460,798 S \* 7/2002 Tamanaha ..... D21/791  
D487,296 S \* 3/2004 Lister ..... D21/791  
D508,547 S \* 8/2005 Llewellyn ..... D21/791  
D536,404 S \* 2/2007 Lister ..... D21/791  
D568,432 S \* 5/2008 Rubino ..... D21/790  
D624,982 S 10/2010 Perusa  
8,177,233 B2 \* 5/2012 Grayson ..... A63B 63/08  
273/118 R  
D673,635 S \* 1/2013 Cameron ..... D21/791  
8,870,672 B2 10/2014 Downing  
8,915,498 B2 12/2014 Hynds  
2007/0099716 A1 5/2007 Du Plessis

\* cited by examiner  
*Primary Examiner* — Mitchell Siegel  
(74) *Attorney, Agent, or Firm* — Enrique Perez

(57) **CLAIM**  
The ornamental design of a golf training apparatus, as shown and described.

**DESCRIPTION**  
FIG. 1 is a top, front perspective view of a golf training apparatus showing our new design;  
FIG. 2 is a top plan view thereof;  
FIG. 3 is a right side elevational view thereof; and,  
FIG. 4 is a bottom perspective view thereof.

**1 Claim, 1 Drawing Sheet**

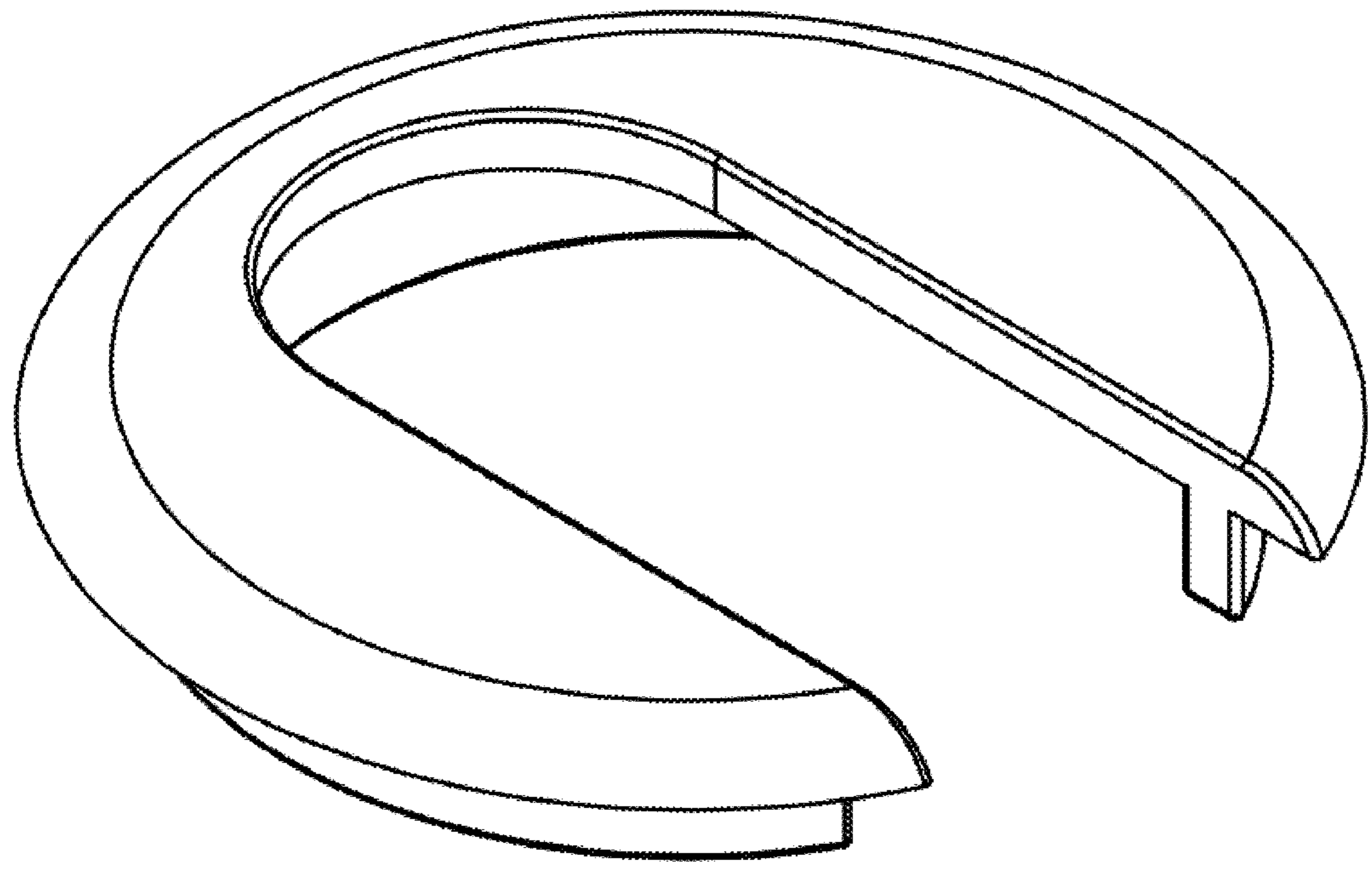

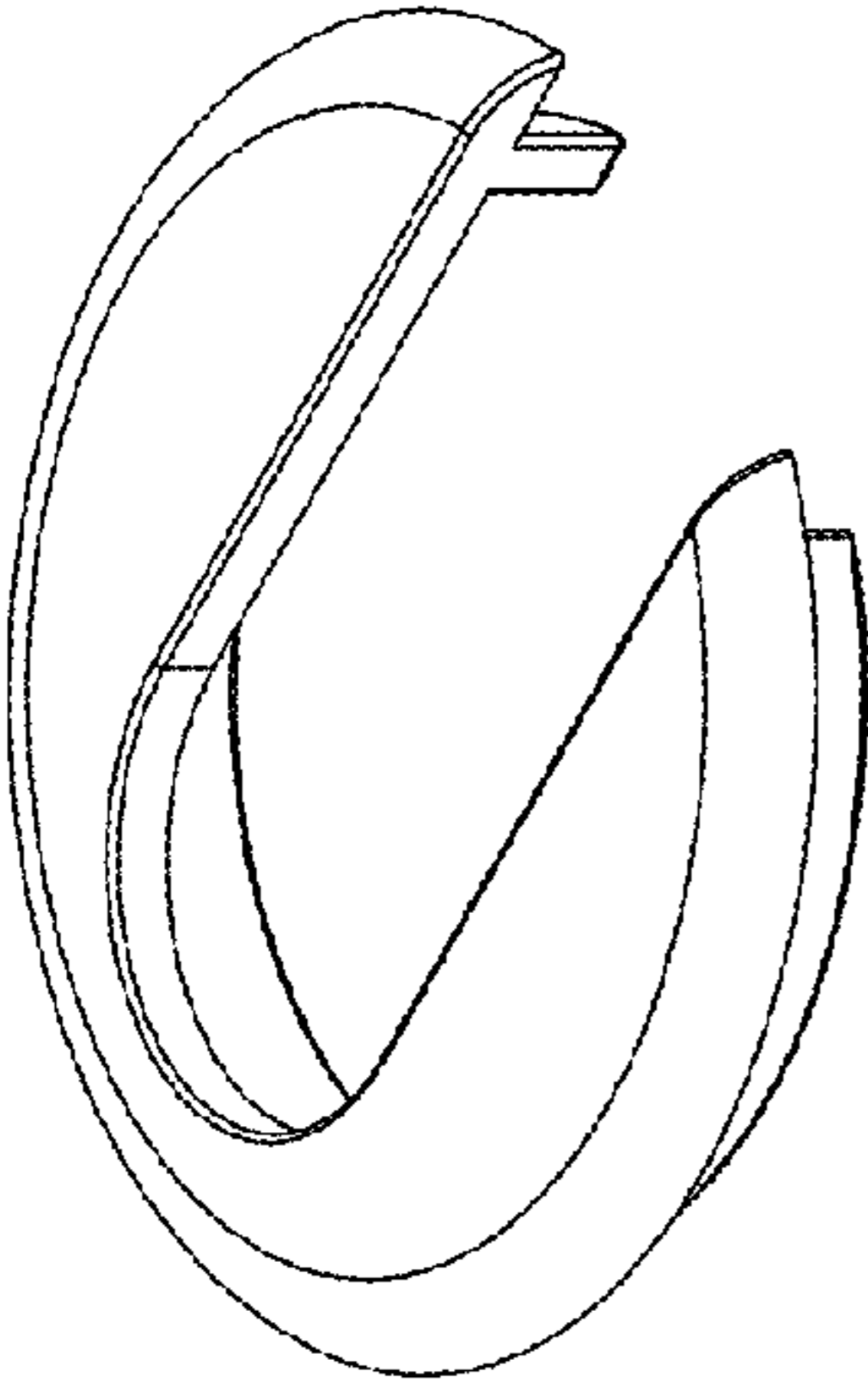

FIG. 1

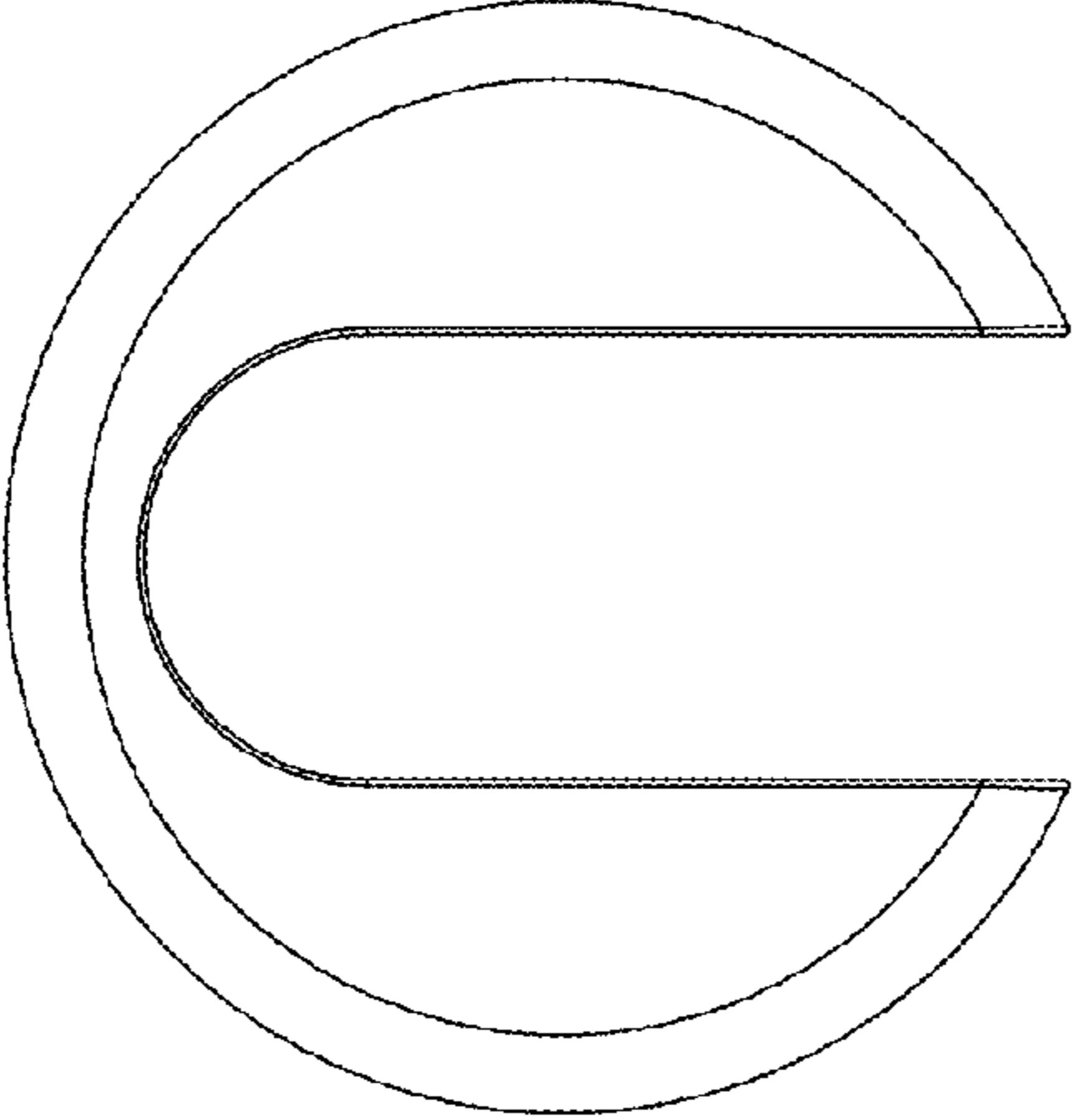

FIG. 2

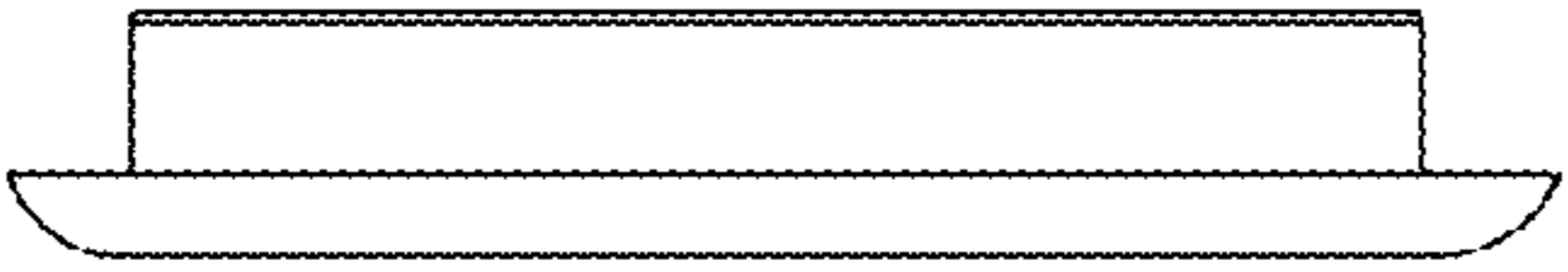

FIG. 3

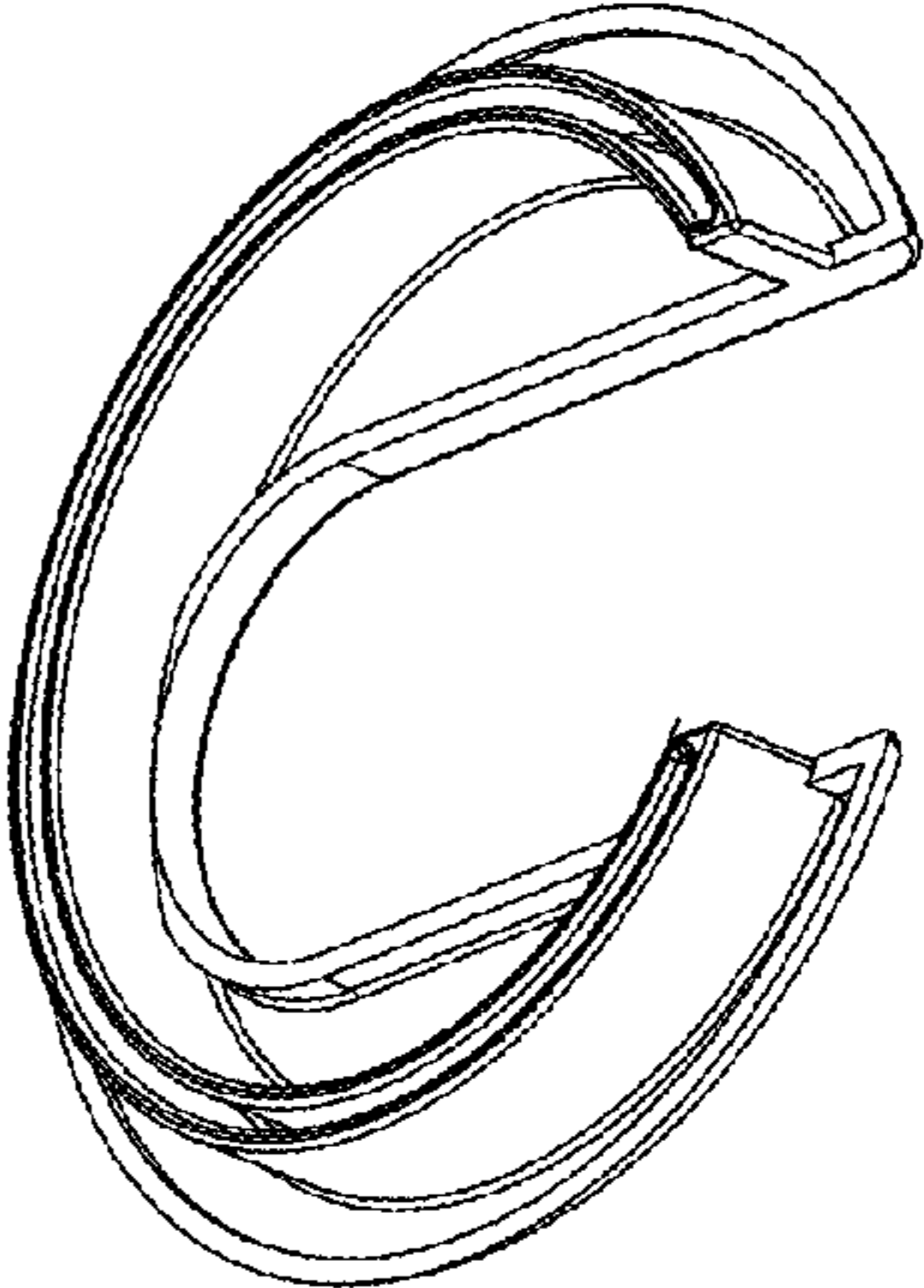

FIG. 4