



US00D794116S

(12) **United States Design Patent** (10) **Patent No.:** **US D794,116 S**
Suzuki (45) **Date of Patent:** **** Aug. 8, 2017**

(54) **TONER CONTAINER**
(71) Applicant: **Michiharu Suzuki**, Ohta-ku (JP)
(72) Inventor: **Michiharu Suzuki**, Ohta-ku (JP)
(73) Assignee: **RICOH COMPANY, LTD.**, Tokyo (JP)
(**) Term: **14 Years**
(21) Appl. No.: **29/514,213**
(22) Filed: **Jan. 9, 2015**

(30) **Foreign Application Priority Data**
Jul. 14, 2014 (JP) 2014-015352
(51) **LOC (10) Cl.** **16-03**
(52) **U.S. Cl.**
USPC **D18/43**
(58) **Field of Classification Search**
USPC D18/12, 18, 36, 40, 43, 44, 56; D14/230,
D14/471, 474, 475, 511; D9/500;
D8/20, 98; D7/650; D15/138, 139;
399/24-27, 91, 106-112, 194, 196, 197,
399/222-224, 258; 347/49, 197, 214,
347/222; 400/194, 196; 408/204, 208;
30/165, 388; 137/15.14; 299/105;
606/45; D16/136, 212-219, 235, 250;
D10/122-132
CPC G03G 15/08; G03G 15/0832; G03G
15/0834; G03G 15/0836; G03G 15/0837;
G03G 15/0867; G03G 15/0868; G03G
2215/067; G03G 2215/0668; G03G
21/1619; Y10S 222/01; B23B 51/0406;
B23B 2260/072; B23B 2260/07; B27B
5/12
See application file for complete search history.

(56) **References Cited**
U.S. PATENT DOCUMENTS
D602,985 S * 10/2009 Yoshizawa D18/43
D606,583 S * 12/2009 Kurenuma D18/43

D607,044 S * 12/2009 Kurenuma D18/43
D607,045 S * 12/2009 Kurenuma D18/43
D636,016 S * 4/2011 Naito D18/43
D636,436 S * 4/2011 Takami D18/43
D636,813 S * 4/2011 Kikuchi D18/43
D650,414 S * 12/2011 Takami D18/43
D652,074 S * 1/2012 Sakai D18/43

(Continued)

Primary Examiner — Wan Laymon
Assistant Examiner — Clint A Samuel
(74) *Attorney, Agent, or Firm* — Oblon, McClelland,
Maier & Neustadt, L.L.P.

(57) **CLAIM**

The ornamental design for a toner container, as shown and described.

DESCRIPTION

FIG. 1 is a front, top, and right side perspective view of a toner container;
FIG. 2 is a detail view showing a partial enlarged front, top, and right side perspective view thereof, along line 2-2 in FIG. 1;
FIG. 3 is a front elevational view thereof;
FIG. 4 is a top plan view thereof;
FIG. 5 is a right side elevational view thereof;
FIG. 6 is an enlarged right side elevational view thereof;
FIG. 7 is a detail view showing a partial enlarged front elevational view thereof, along line 7-7 in FIG. 3; and,
FIG. 8 is a detail view showing a partial enlarged top plan view thereof, along line 8-8 in FIG. 4.
The shorter broken lines in the drawings depict environmental subject matter only and form no part of the claimed design. The longer broken lines in FIGS. 2, 7, and 8 correspond to the area defined by line 2-2 in FIG. 1, line 7-7 in FIG. 3, and line 8-8 in FIG. 4, respectively, and form no part of the claimed design.

1 Claim, 8 Drawing Sheets

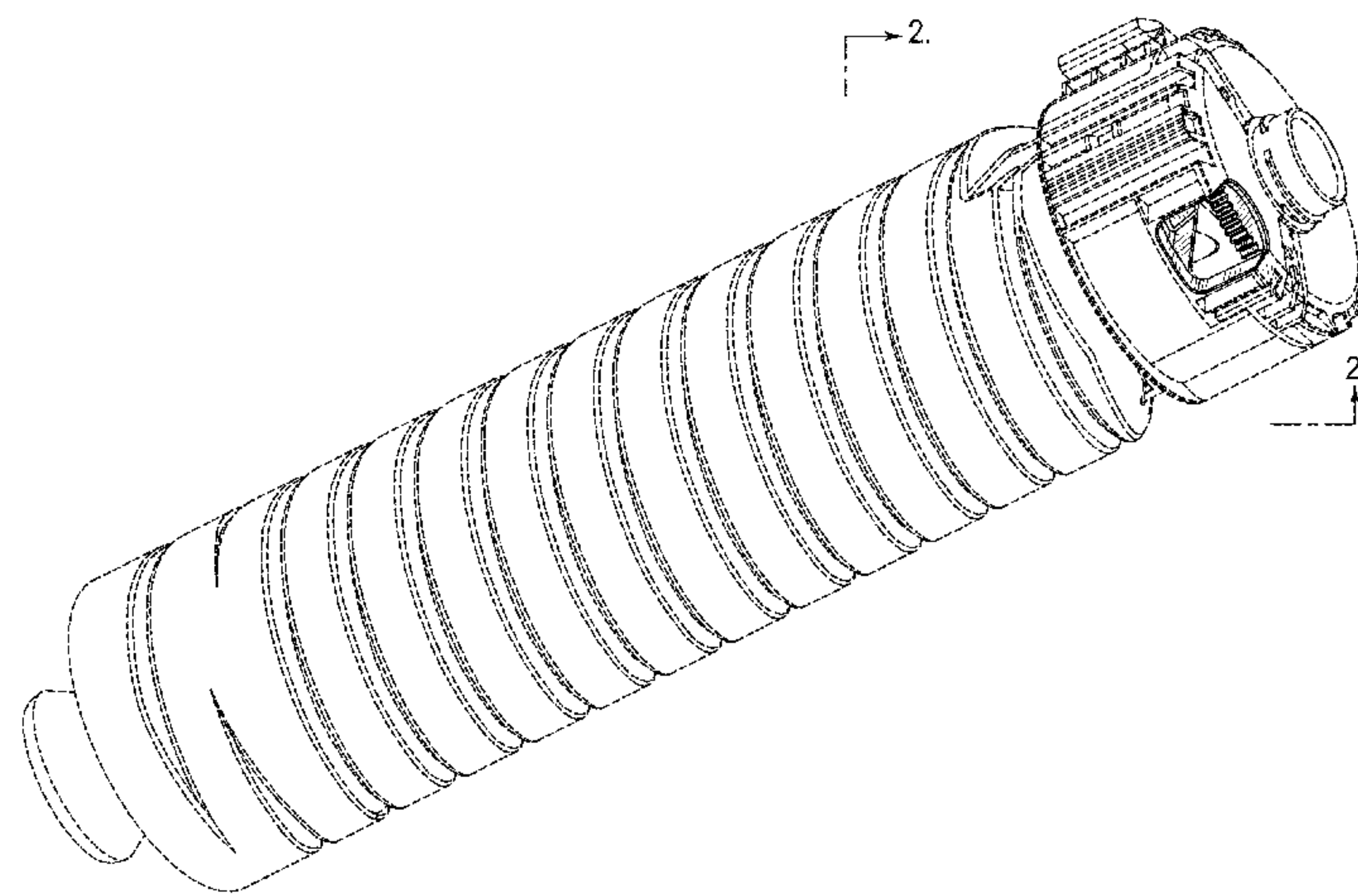

(56)

References Cited

U.S. PATENT DOCUMENTS

D653,702 S * 2/2012 Amberg D18/43
D656,181 S * 3/2012 Kikuchi D18/43
2006/0251448 A1* 11/2006 Kawamura G03G 15/0872
399/262

* cited by examiner

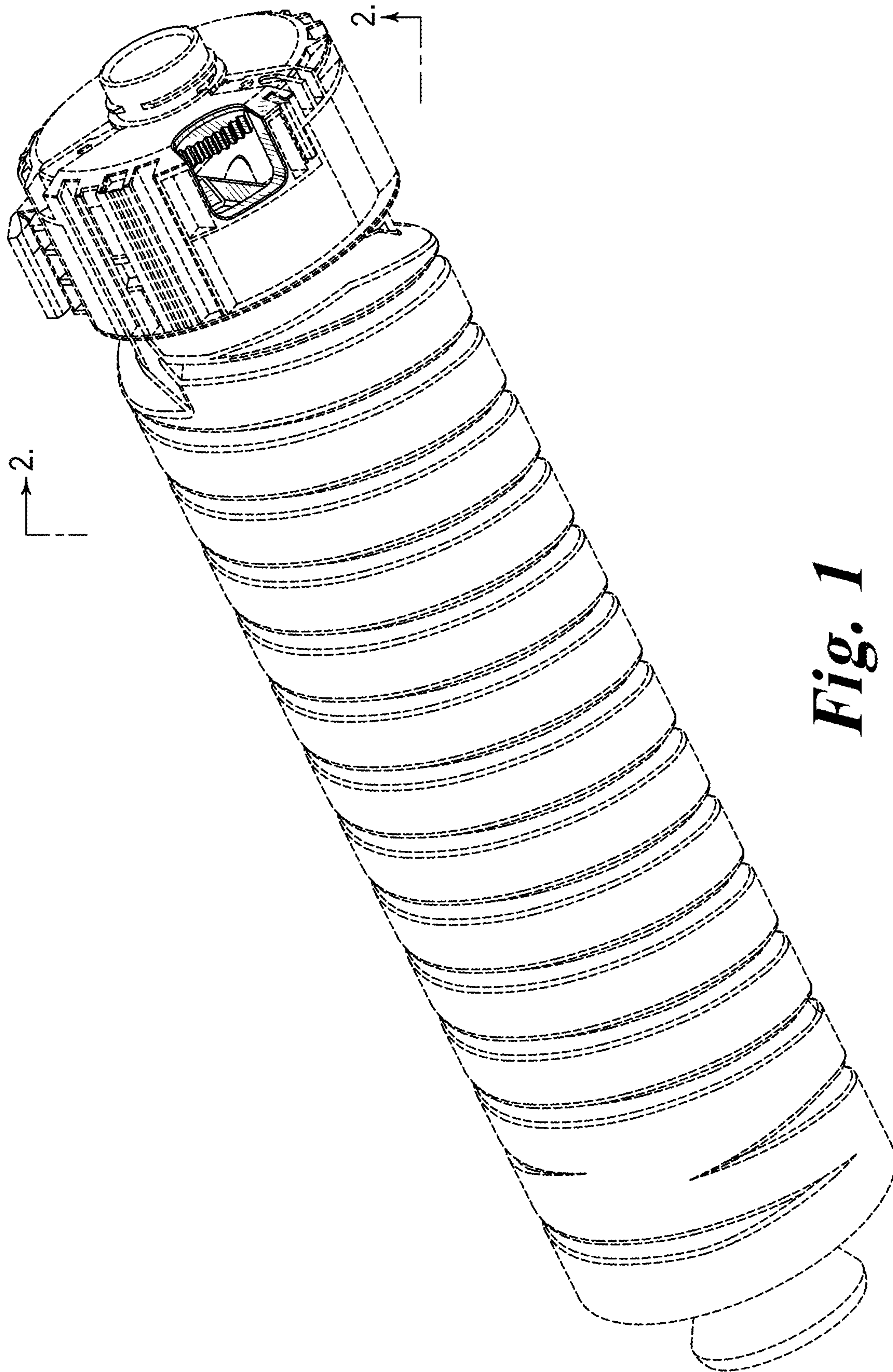

Fig. 1

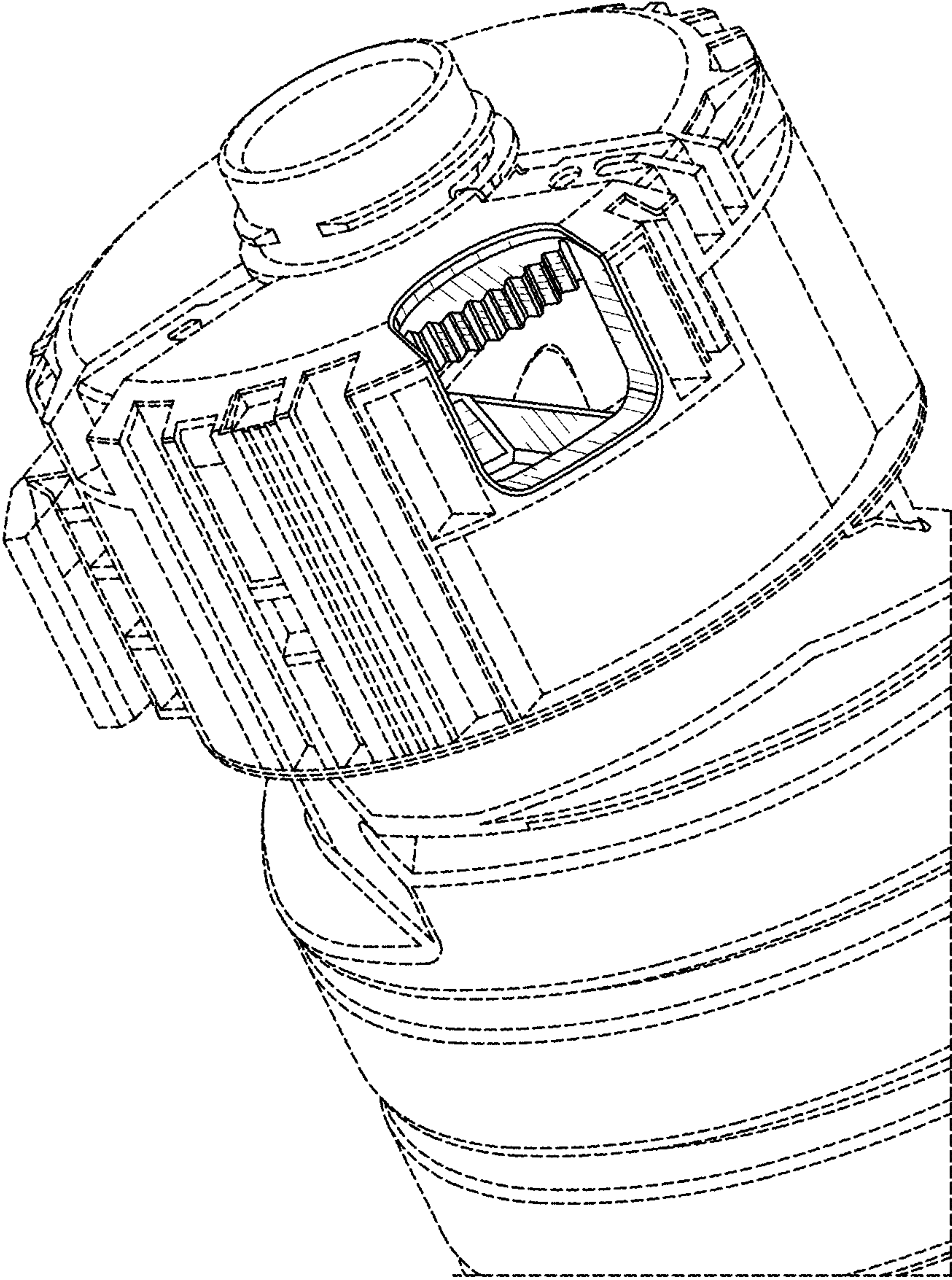

Fig. 2

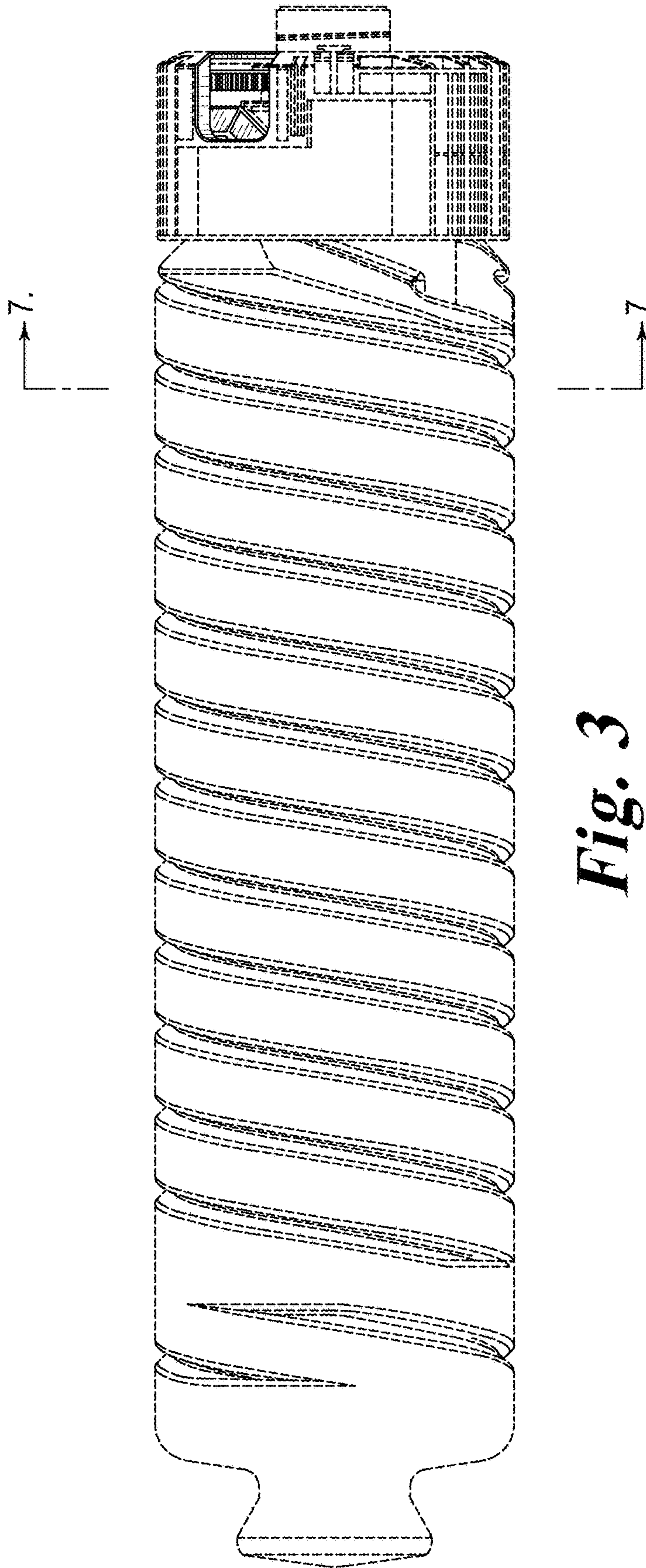

Fig. 3

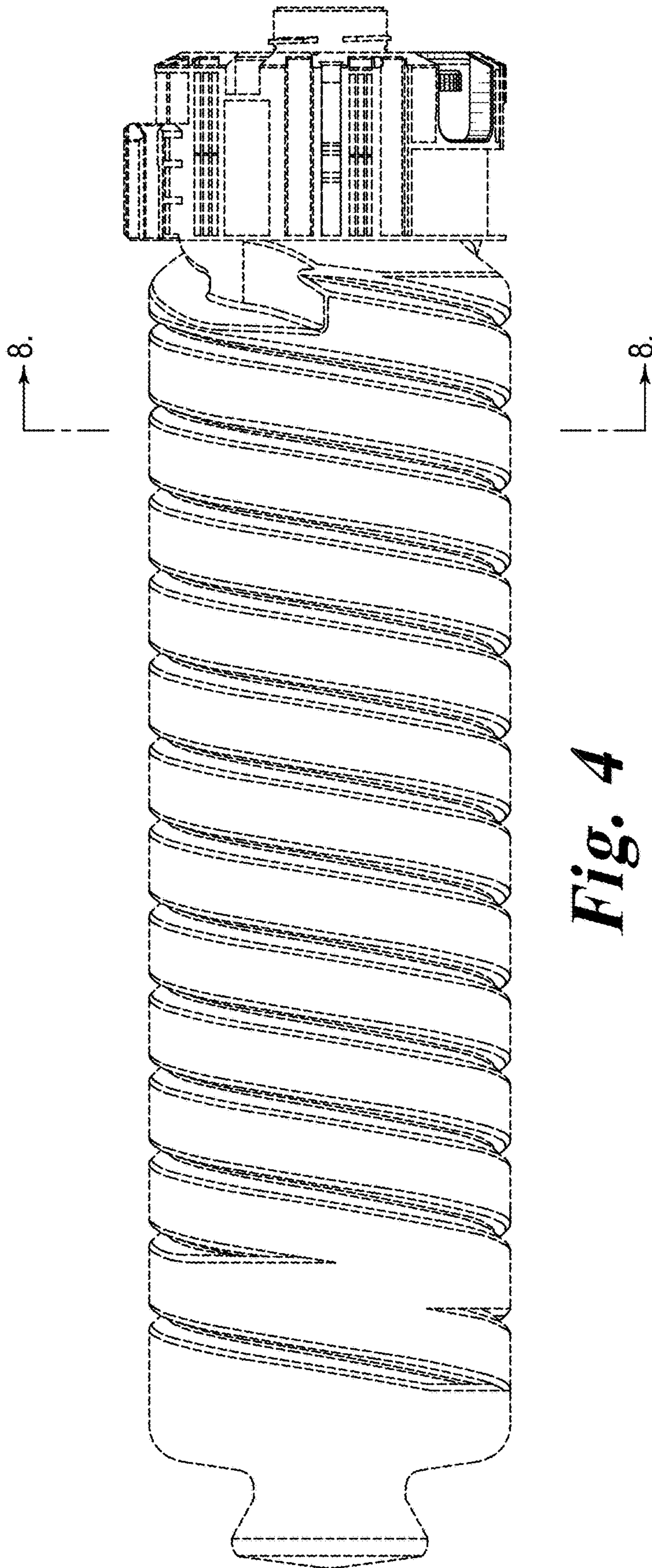

Fig. 4

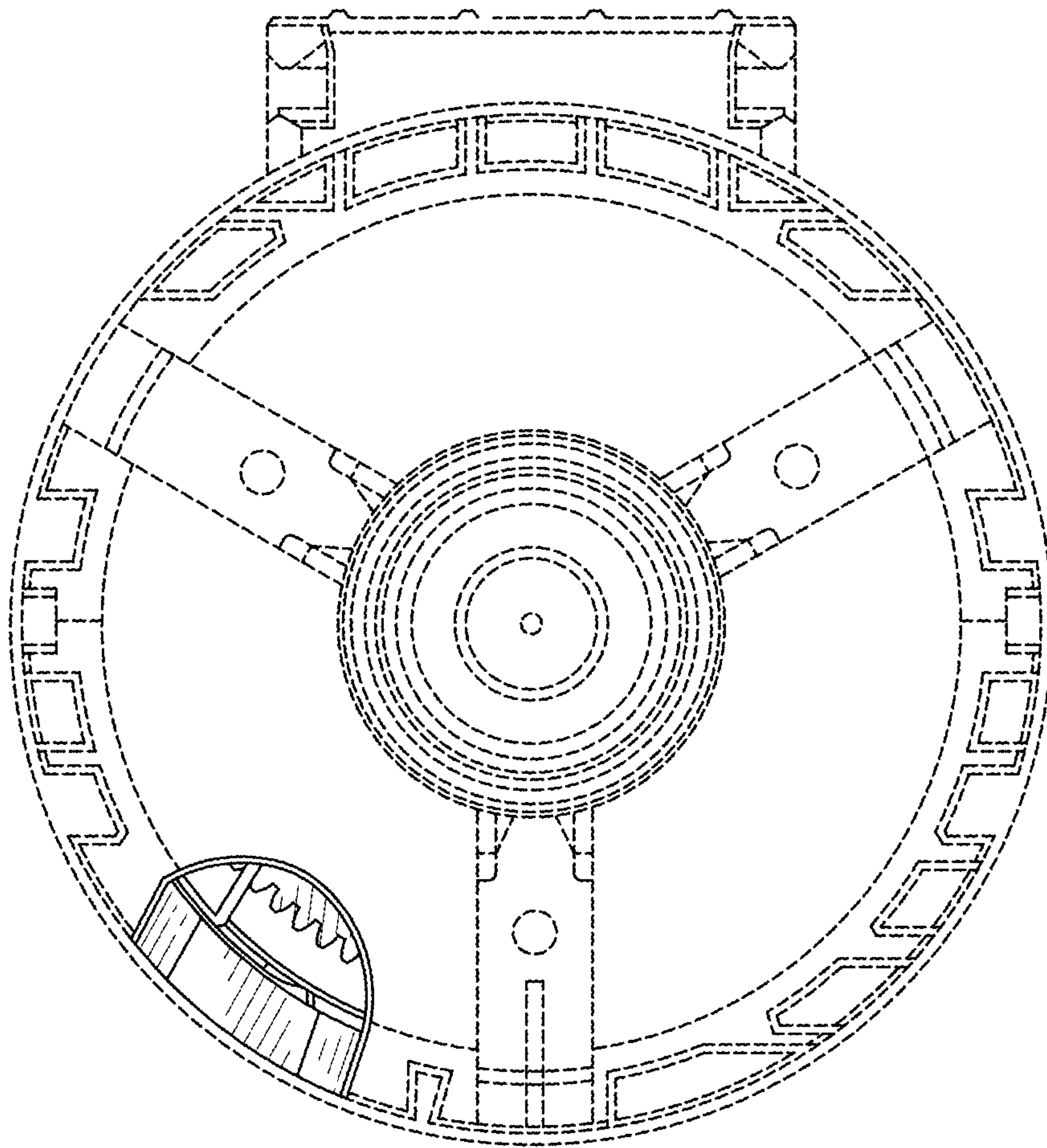

Fig. 5

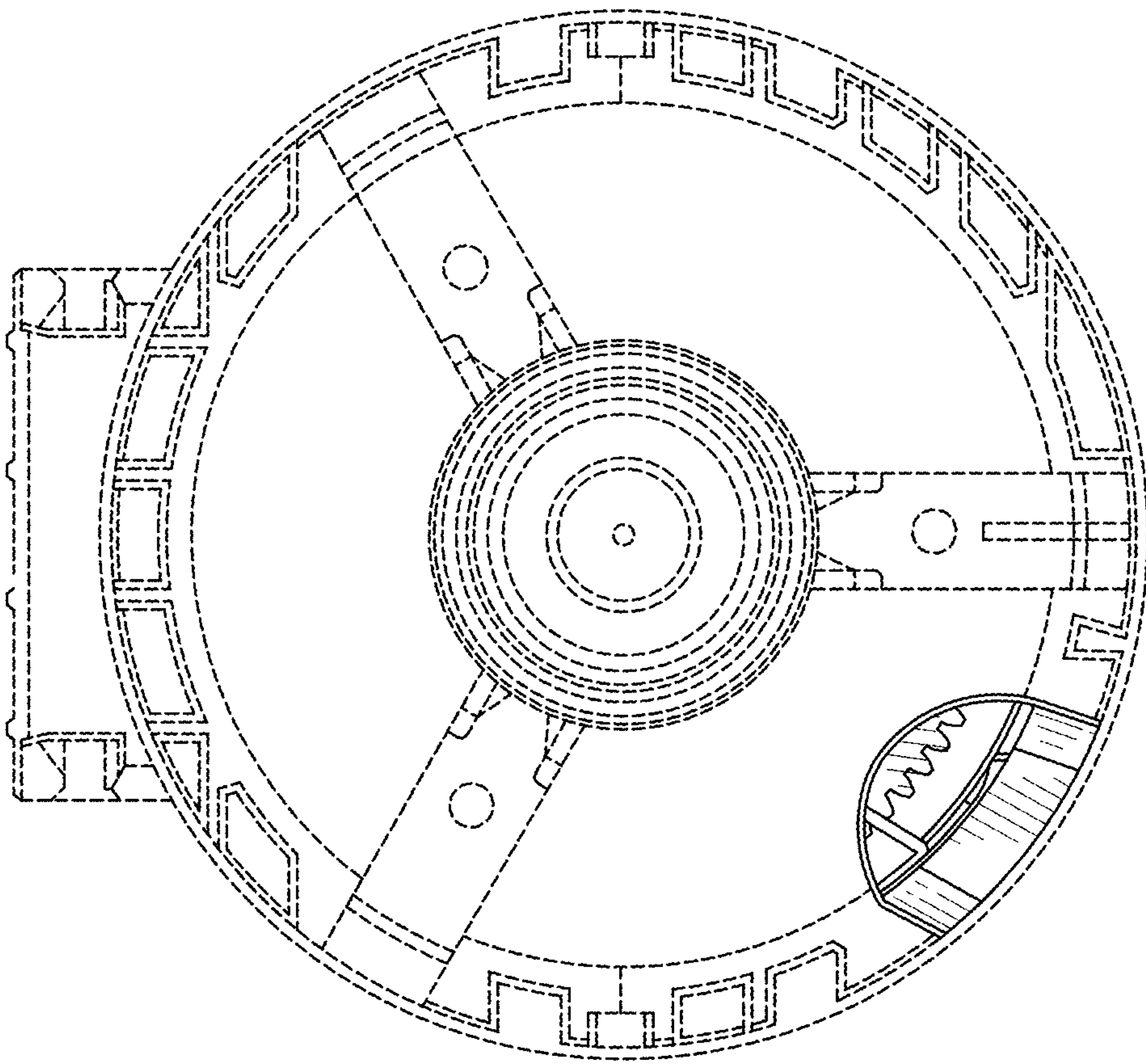

Fig. 6

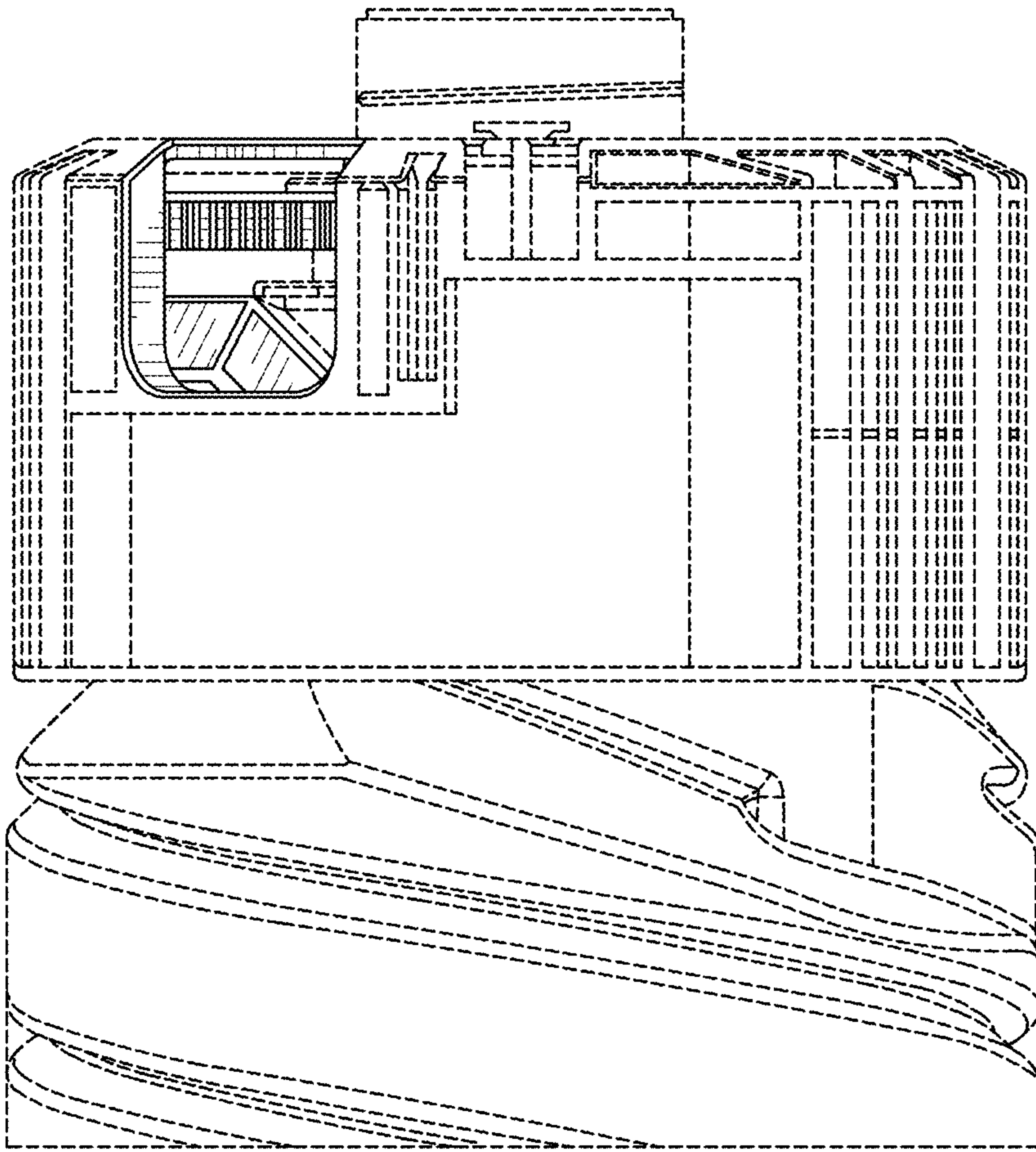

Fig. 7

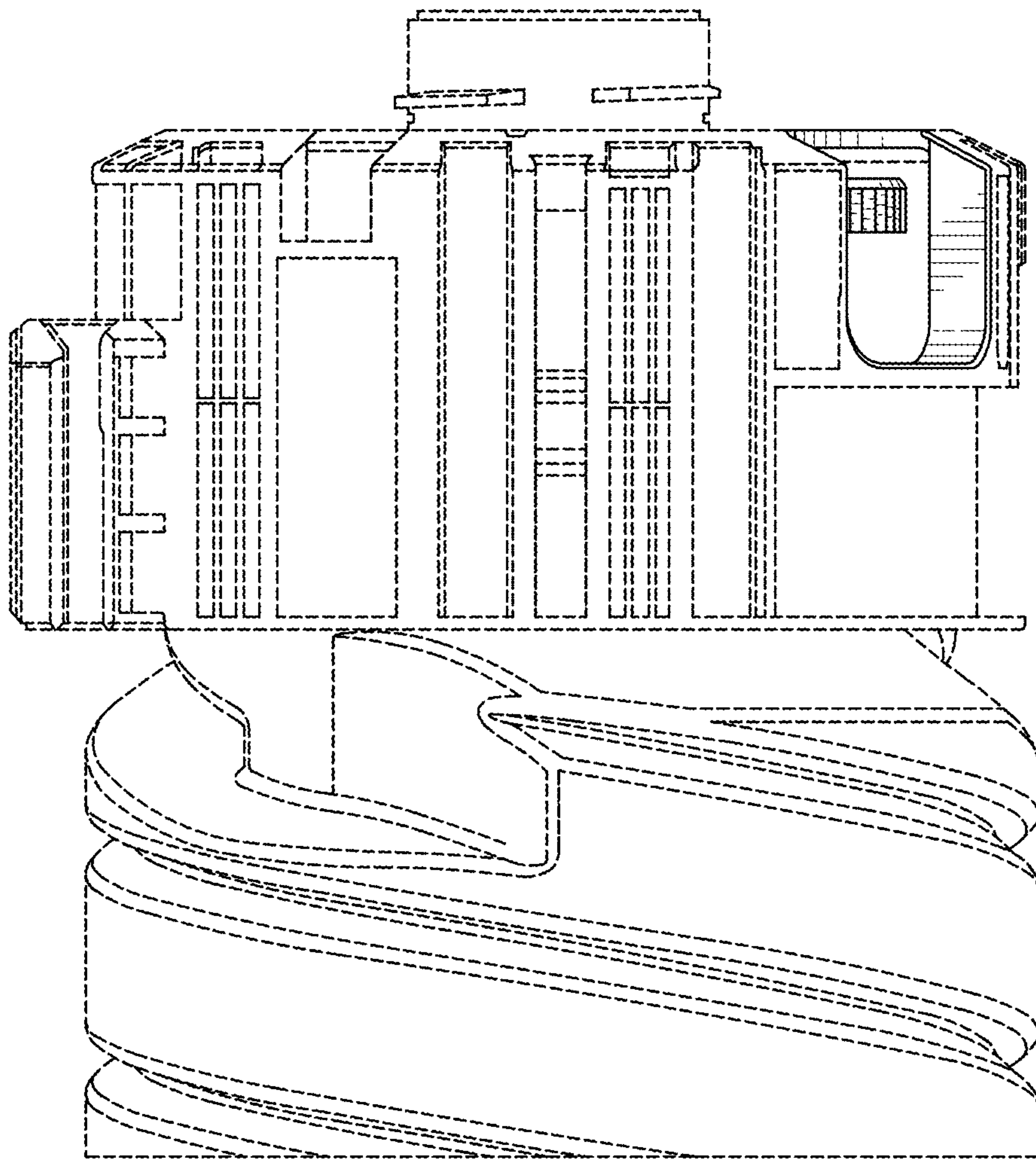

Fig. 8