



US00D790306S

(12) **United States Design Patent**
Waldron

(10) **Patent No.:** **US D790,306 S**
(45) **Date of Patent:** **** Jun. 27, 2017**

- (54) **POWERED CIRCULAR SAW TOOL**
- (71) Applicants: **7RDD Limited**, York (GB); **Ningbo Gemay Industry Company Limited**, Ningbo (CN)
- (72) Inventor: **Michael Waldron**, York (GB)
- (73) Assignees: **7RDD Limited**, York (GB); **Ningbo Gemay Industry Company Limited**, Ningbo (CN)
- (**) Term: **15 Years**
- (21) Appl. No.: **29/559,336**
- (22) Filed: **Mar. 28, 2016**
- (51) **LOC (10) Cl.** **08-03**
- (52) **U.S. Cl.**
USPC **D8/66**
- (58) **Field of Classification Search**
USPC D8/69, 68, 67, 66, 64, 61, 70; 83/698.41, 83/747, 166.3, 374, 373, 375, 376, 391, 83/377, 390, 388, 389; 125/13.01; 144/218
CPC B27B 9/00; B27B 9/02; B27B 5/02; B27B 5/18; B27B 33/08; B28D 1/04; B28D 1/045; B23D 45/00
See application file for complete search history.

D538,124 S *	3/2007	Yamamoto	D8/66
D552,953 S *	10/2007	Jones	D8/66
D555,450 S *	11/2007	Van Wambeke	D8/66
D632,940 S *	2/2011	Yamamoto	D8/66
D638,681 S *	5/2011	Yamada	D8/66
D653,513 S *	2/2012	Tirone	D8/66
D654,340 S *	2/2012	Kawase	D8/66
D685,243 S *	7/2013	Waldron	D8/66
D699,088 S *	2/2014	Abe	D8/66
D710,172 S *	8/2014	Tschopp	D8/66
D756,738 S *	5/2016	Itoh	D8/66
2003/0024368 A1 *	2/2003	Fukuoka	B23D 59/00 83/698.41

* cited by examiner

Primary Examiner — Austin Murphy
(74) *Attorney, Agent, or Firm* — McKee, Voorhees & Sease, PLC

(57) **CLAIM**

The ornamental design for a powered circular saw tool, as shown and described.

DESCRIPTION

FIG. 1 is a perspective view of a powered circular saw tool according to the present invention;
 FIG. 2 is a front view of the powered circular saw tool shown in FIG. 1;
 FIG. 3 is a left side view of the powered circular saw tool shown in FIG. 1;
 FIG. 4 is a rear view of the powered circular saw tool shown in FIG. 1;
 FIG. 5 is a right side view of the powered circular saw tool shown in FIG. 1;
 FIG. 6 is a top view of the powered circular saw tool shown in FIG. 1; and,
 FIG. 7 is a bottom view of the powered circular saw tool shown in FIG. 1.

1 Claim, 7 Drawing Sheets

- (56) **References Cited**
U.S. PATENT DOCUMENTS
- | | | | | |
|--------------|---------|----------|-------|-------|
| D329,363 S * | 9/1992 | Sasaki | | D8/66 |
| D453,099 S * | 1/2002 | Welsh | | D8/66 |
| D499,001 S * | 11/2004 | Wu | | D8/66 |
| D502,373 S * | 3/2005 | Wu | | D8/66 |
| D503,878 S * | 4/2005 | Tillman | | D8/66 |
| D525,503 S * | 7/2006 | Waldron | | D8/66 |
| D525,504 S * | 7/2006 | Corcoran | | D8/66 |

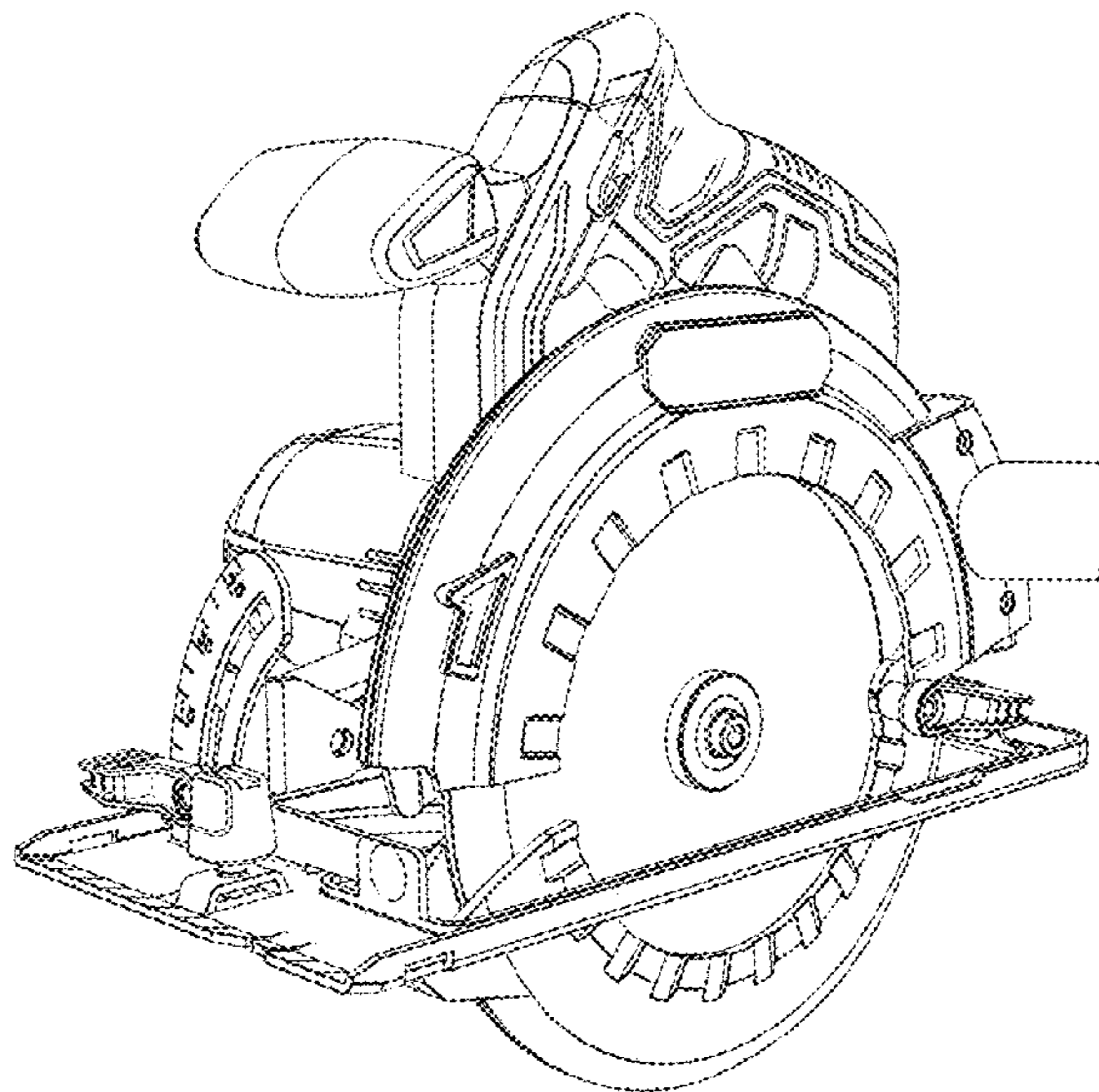

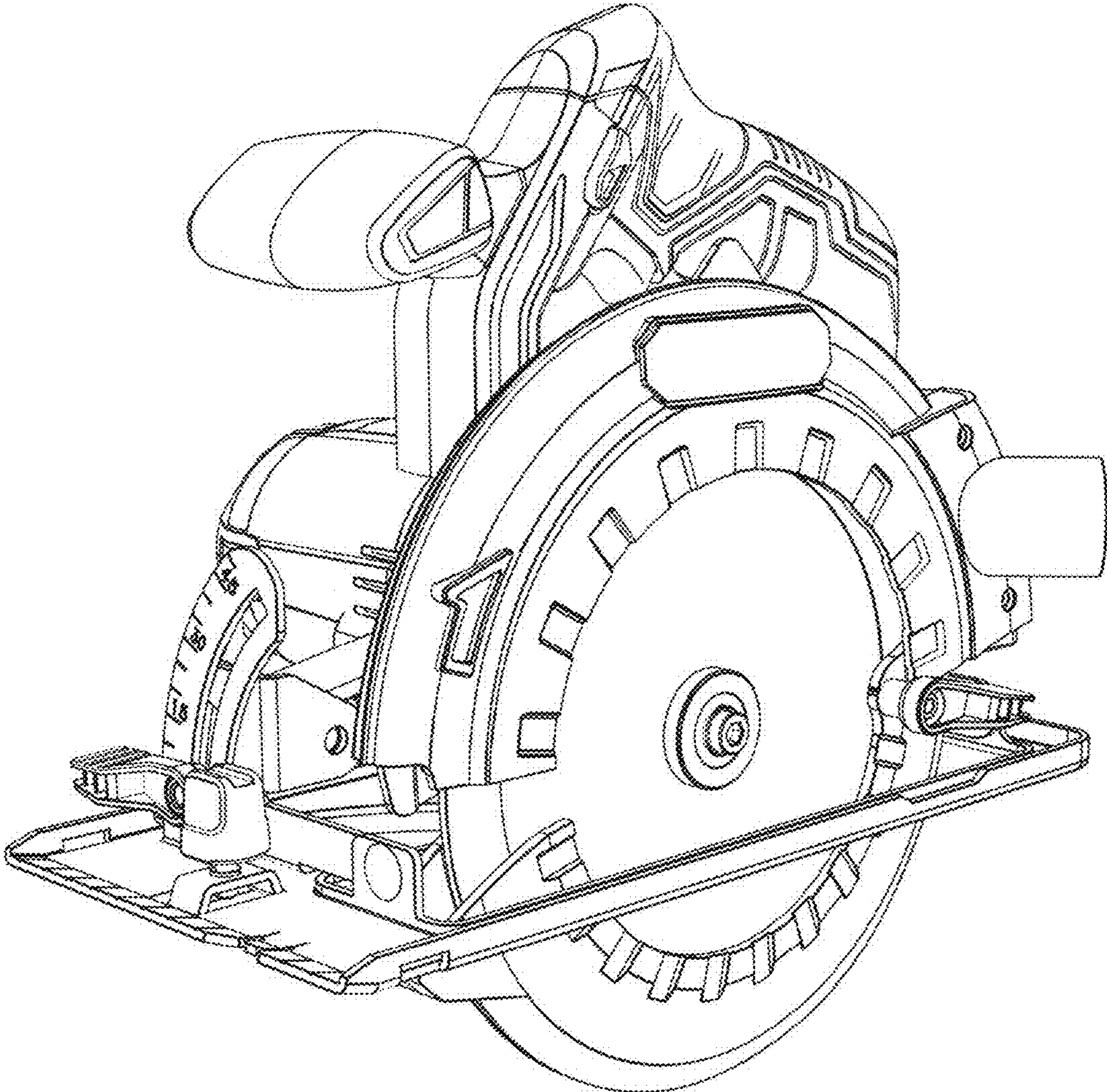

FIG. 1

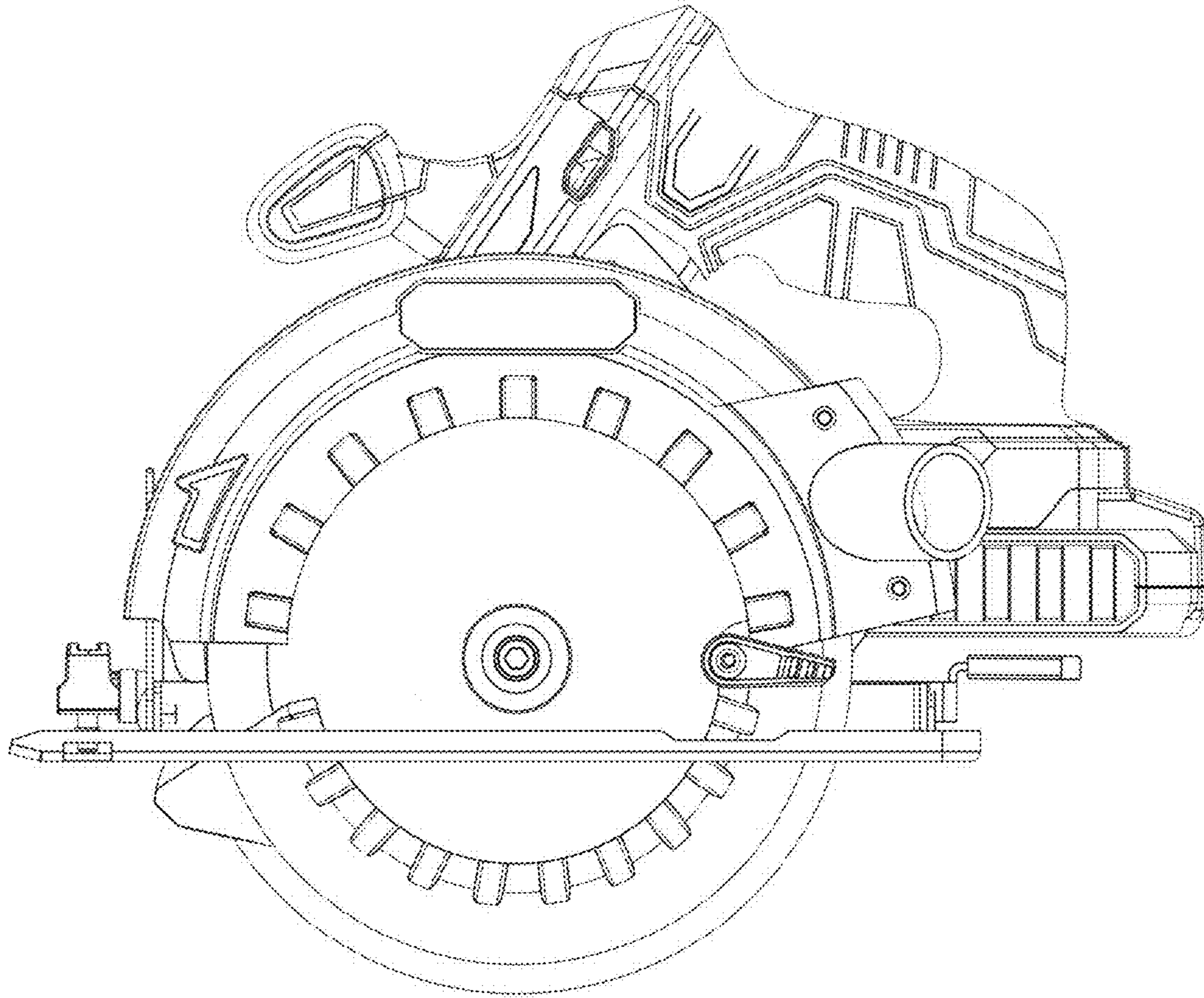

FIG. 2

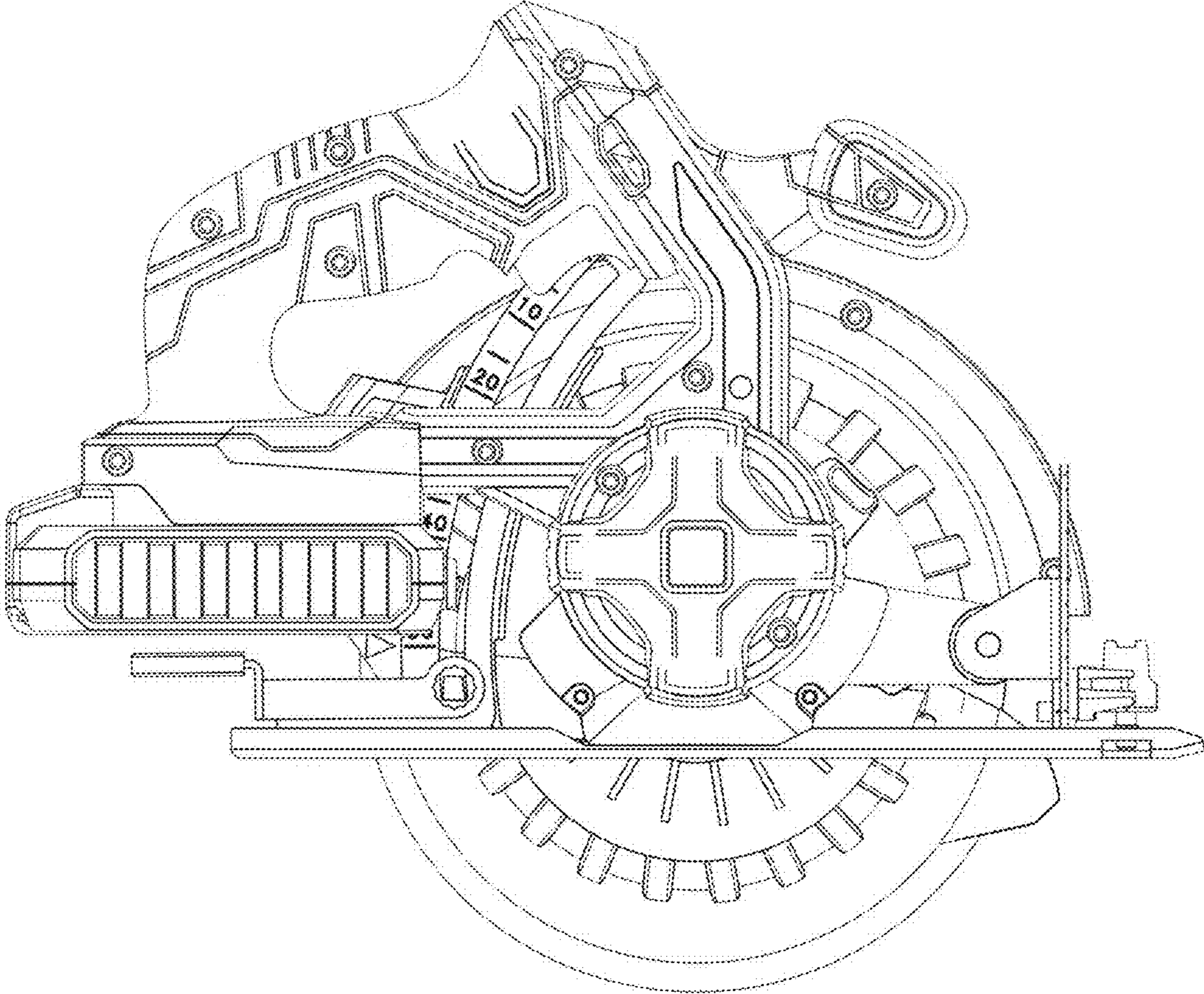

FIG. 3

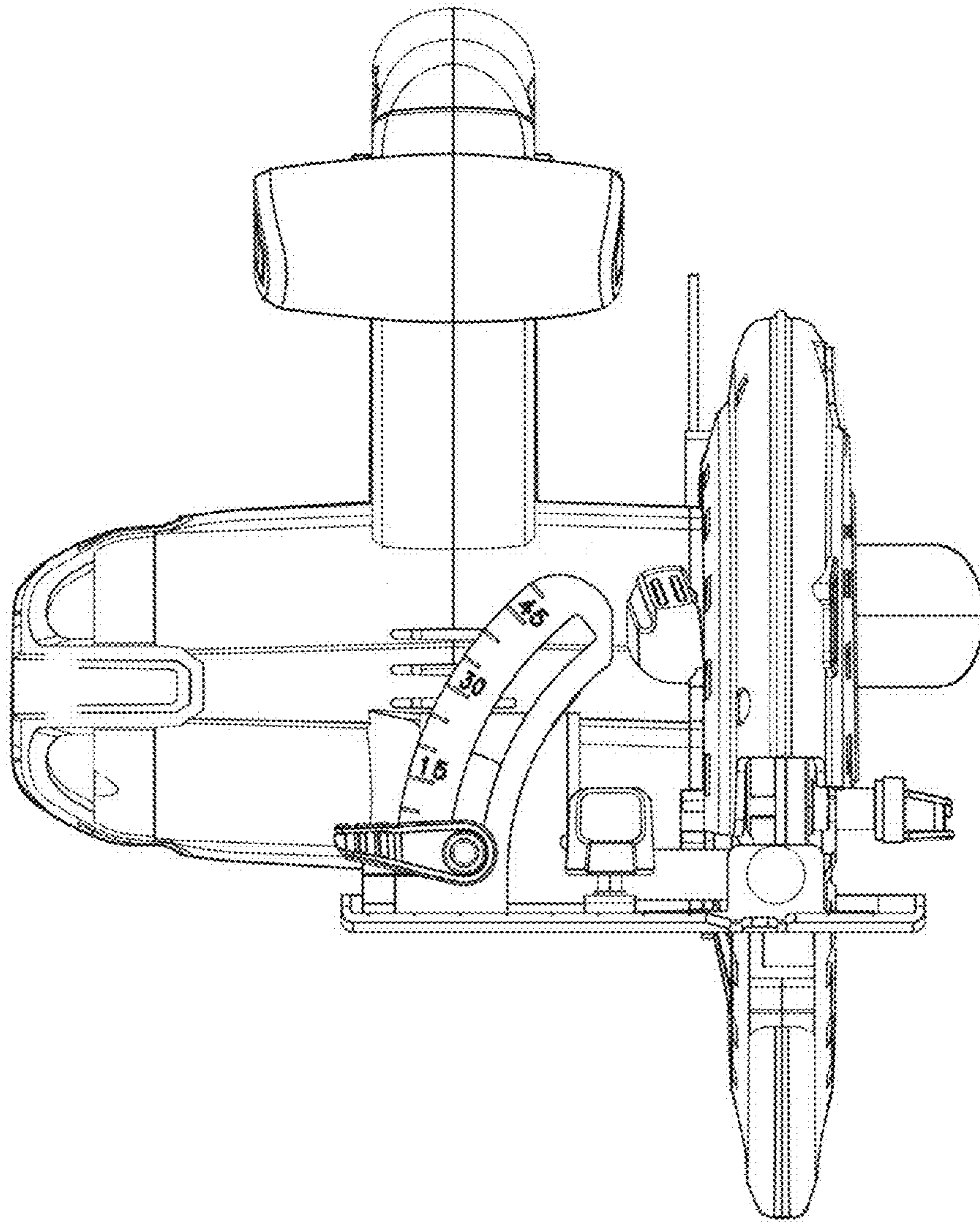

FIG. 4

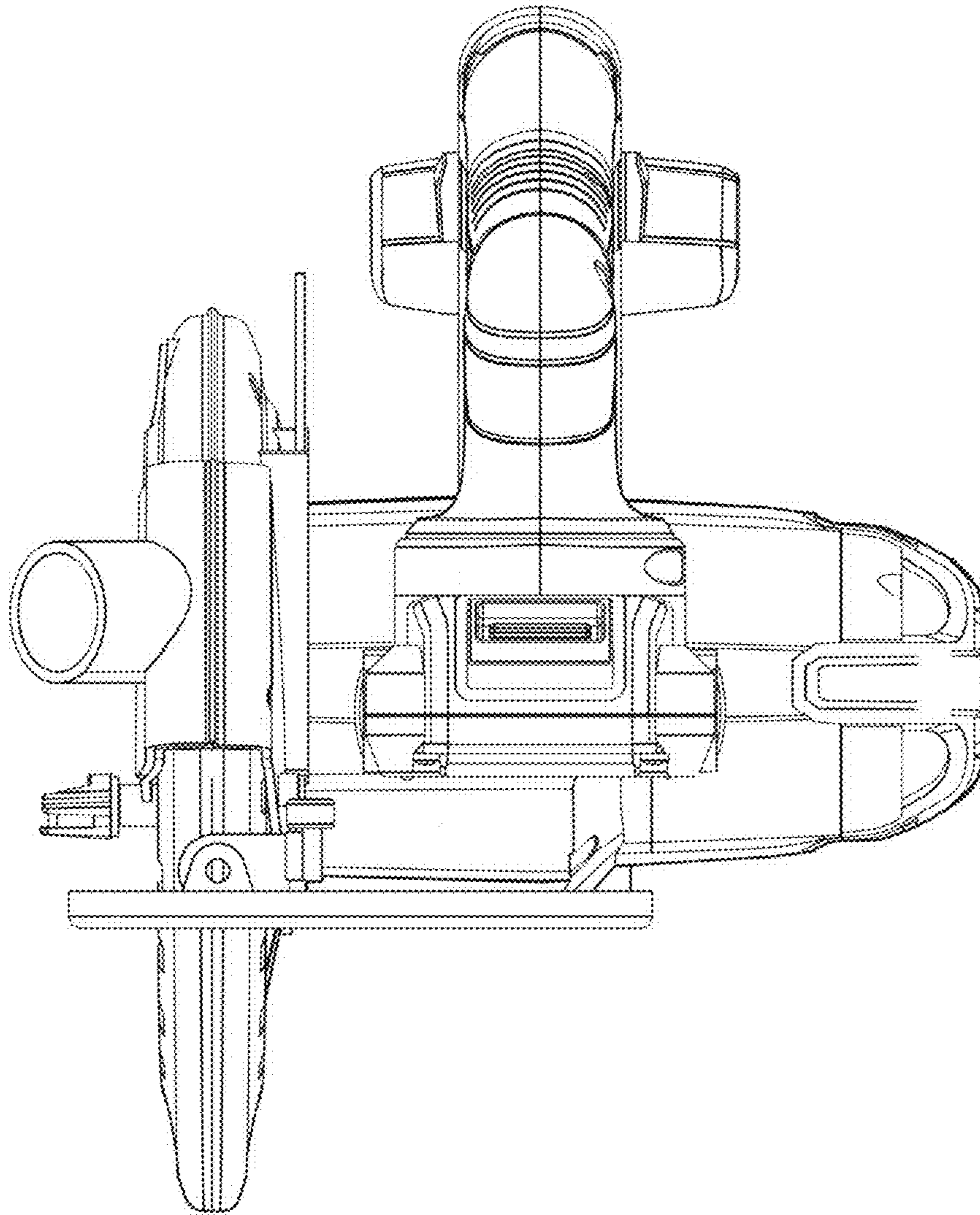

FIG. 5

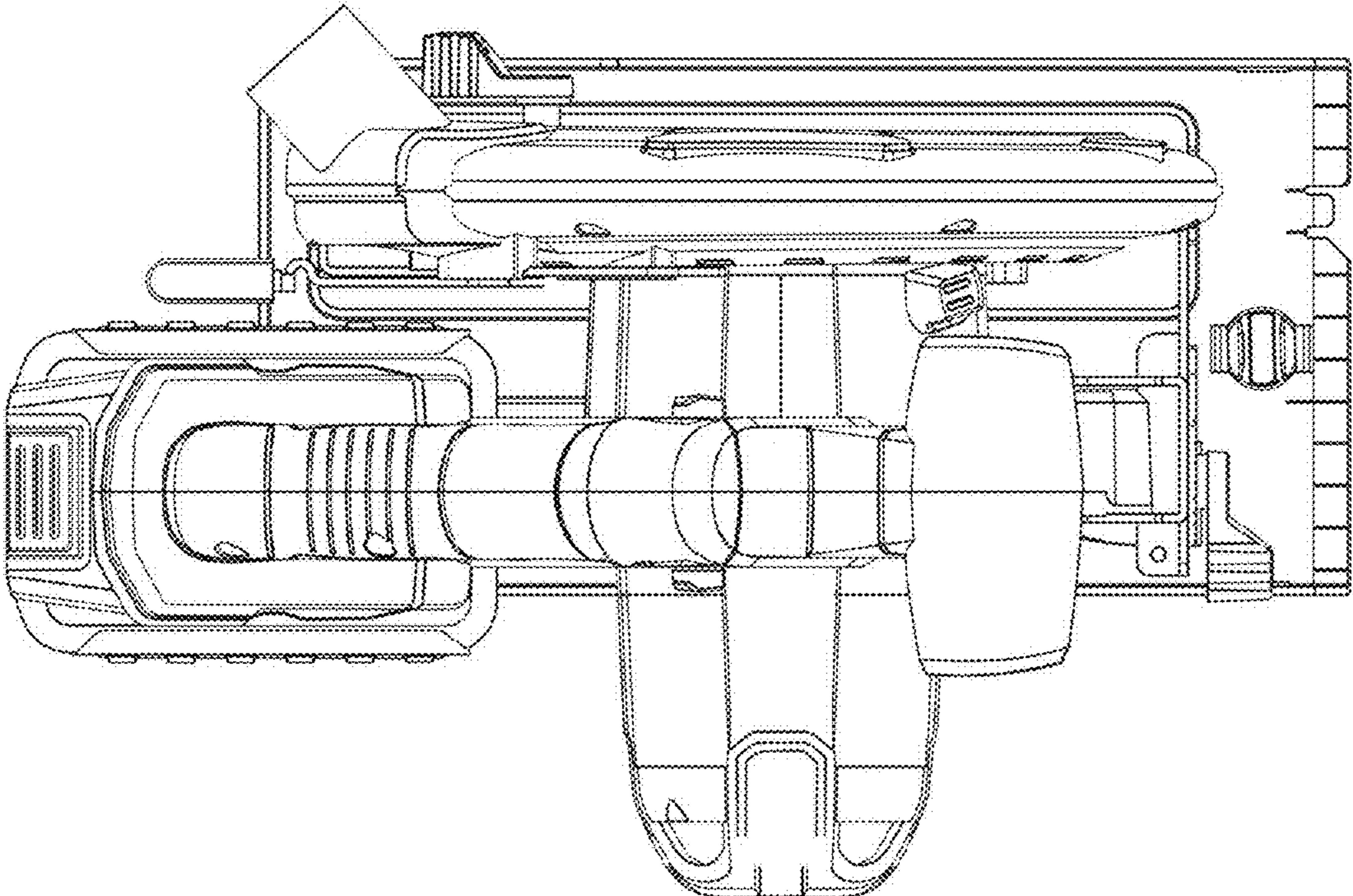

FIG. 6

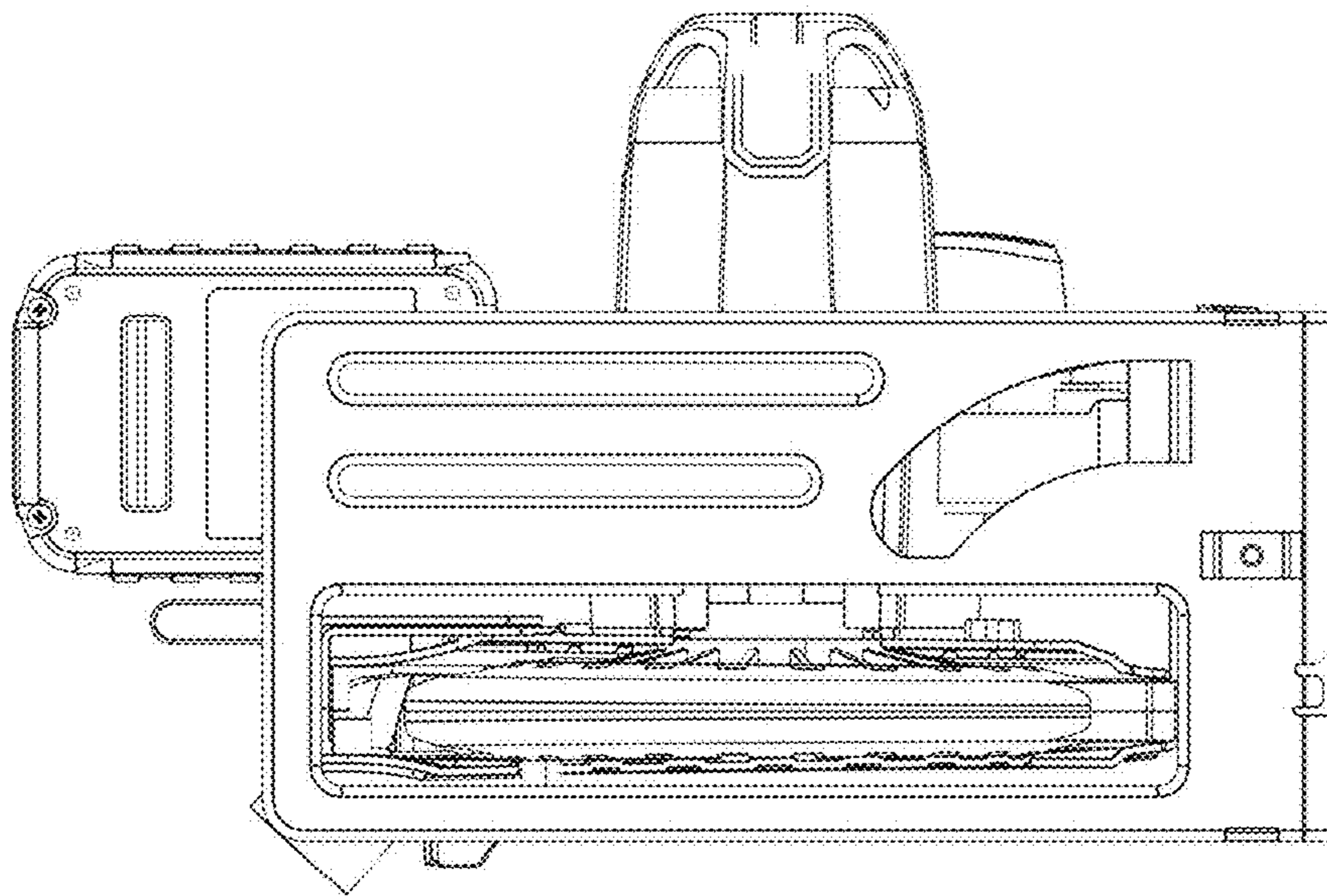

FIG. 7