



US00D789781S

(12) **United States Design Patent** (10) **Patent No.:** **US D789,781 S**
Johnson (45) **Date of Patent:** **** Jun. 20, 2017**

(54) AUTOMOTIVE WHEEL LUG NUT	6,062,787 A * 5/2000 Maddalena B25B 13/485 411/373
(71) Applicant: Kelly R. Johnson , City of Industry, CA (US)	D484,785 S * 1/2004 Plumer D8/397 D488,715 S * 4/2004 Plumer D8/397 7,392,674 B1 * 7/2008 Grote F16B 37/14 411/910
(72) Inventor: Kelly R. Johnson , City of Industry, CA (US)	D583,656 S * 12/2008 Bush D8/397 D590,243 S * 4/2009 Bush D8/397 D614,942 S * 5/2010 Gaudron D8/387 D666,901 S * 9/2012 Surjan D8/387 D722,489 S * 2/2015 Yamazaki D8/387 D731,300 S * 6/2015 Vargas D8/397 D741,159 S * 10/2015 Campbell D8/387 D747,645 S * 1/2016 Pascoe D8/397 9,278,445 B2 * 3/2016 Li B25G 1/005
(73) Assignee: Wheel Group Holdings, LLC , Ontario, CA (US)	
(**) Term: 15 Years	
(21) Appl. No.: 29/533,001	

* cited by examiner

(22) Filed: **Jul. 13, 2015**

(51) **LOC (10) Cl.** **08-08**

(52) **U.S. Cl.**
USPC **D8/397**

(58) **Field of Classification Search**
USPC D8/397, 387, 394, 382, 349; 411/432,
411/918, 179, 180, 190, 327, 531;
248/154; 606/232
CPC F16B 23/00; B60B 31/00; B60B 29/00;
A63F 9/0876
See application file for complete search history.

Primary Examiner — Cynthia Underwood
(74) *Attorney, Agent, or Firm* — Law Offices of S.J. Christine Yang

(57) **CLAIM**

The ornamental design for an automotive wheel lug nut, as show and described.

DESCRIPTION

(56) **References Cited**
U.S. PATENT DOCUMENTS

D242,117 S * 11/1976 Ono et al.	D8/387
D242,118 S * 11/1976 Ono et al.	D8/387
D242,323 S * 11/1976 Ono et al.	D8/387
D249,227 S * 9/1978 Ismert, III	D8/387
5,147,093 A * 9/1992 Tisdale	A63F 9/0876 273/153 R
D420,898 S * 2/2000 Landman	D8/397

FIG. 1 is a perspective view of the automotive wheel lug nut showing my new design;
FIG. 2 us a side view of FIG. 1;
FIG. 3 is a bottom view thereof; and,
FIG. 4 is a top view thereof.
The broken lines and that within the broken lines represent environment and form no part of the claim.

1 Claim, 1 Drawing Sheet

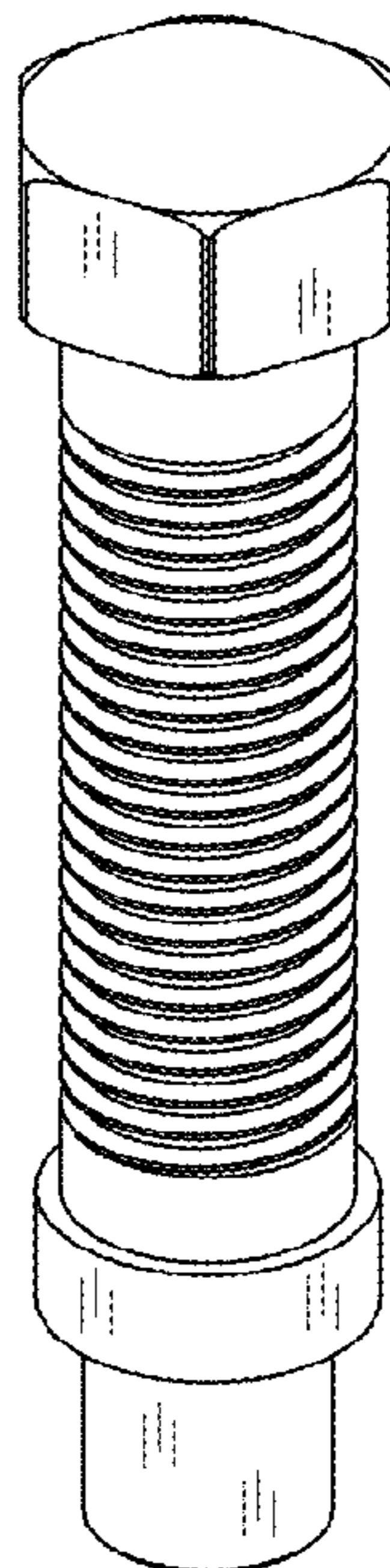

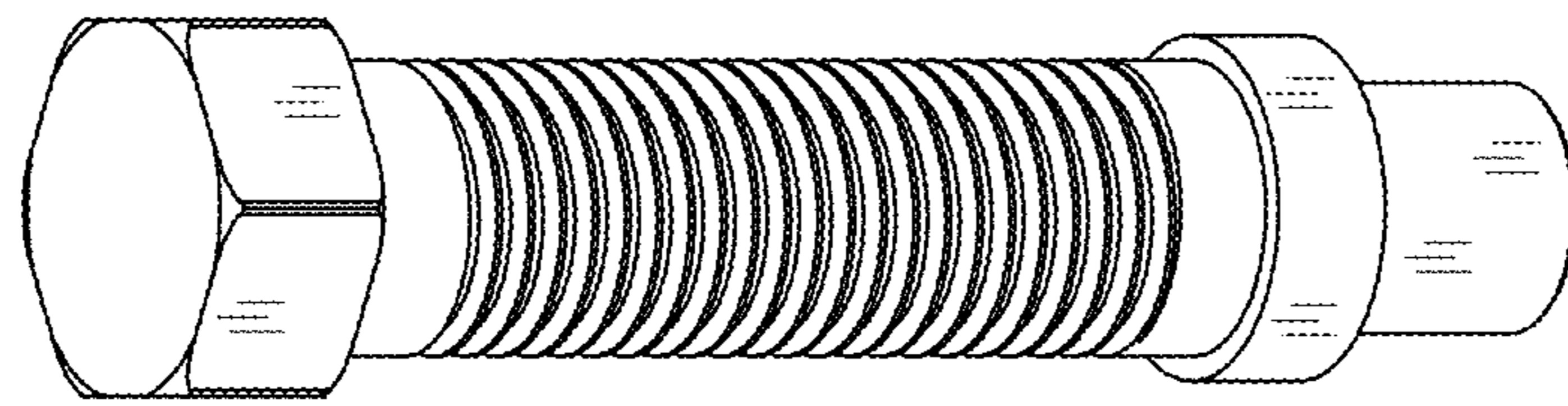

FIG. 1

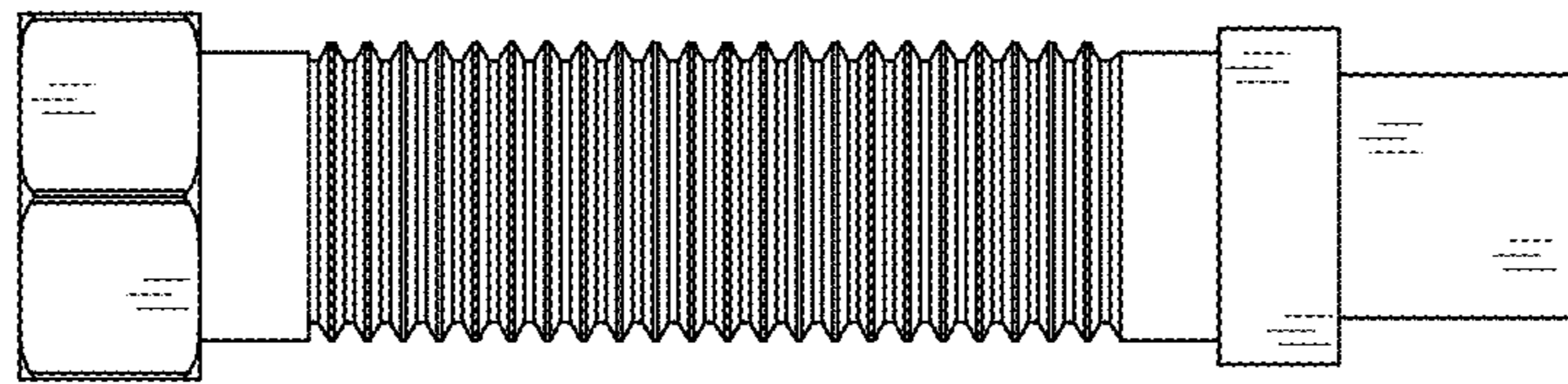

FIG. 2

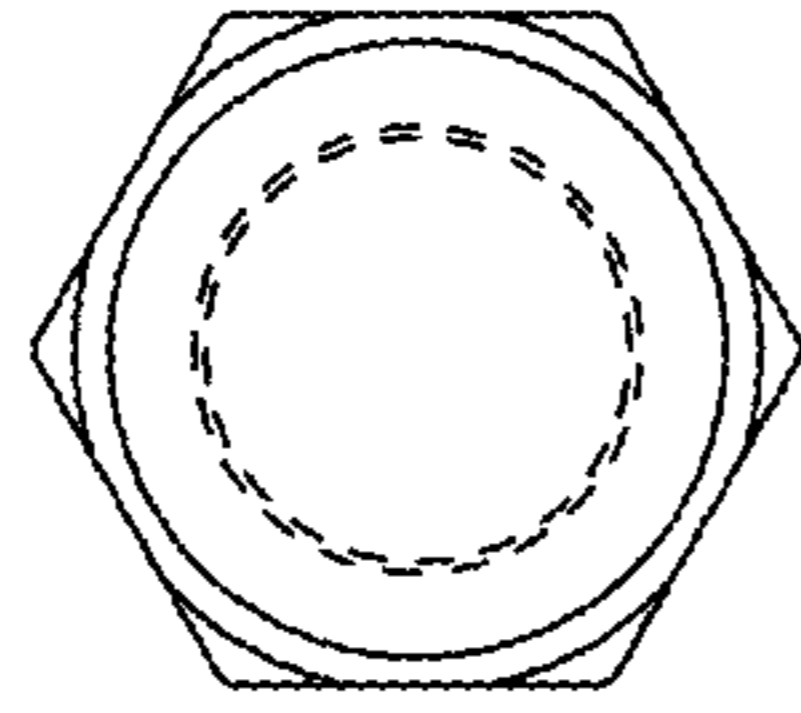

FIG. 3

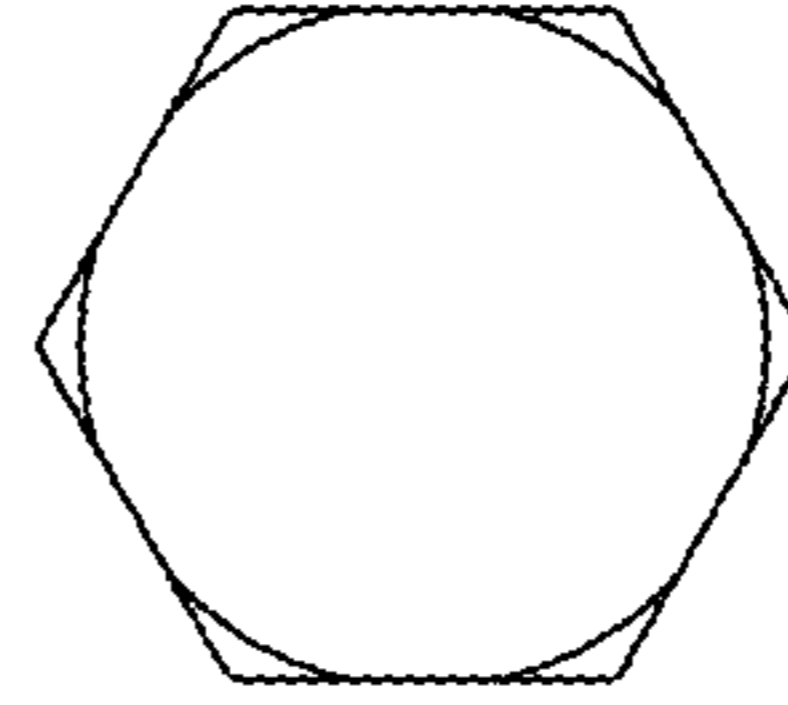

FIG. 4