



US00D789170S

(12) **United States Design Patent** (10) **Patent No.:** **US D789,170 S**  
**Saunders et al.** (45) **Date of Patent:** **\*\* Jun. 13, 2017**

(54) **ROTARY POWER TOOL** 7,798,245 B2 9/2010 Trautner  
7,896,097 B2\* 3/2011 Teng ..... B25B 21/02  
173/178  
(71) Applicant: **AC (Macao Commercial Offshore)** 8,075,155 B2\* 12/2011 Watanabe ..... B25F 5/00  
**Limited, Macau (MO)** 307/126

(Continued)

(72) Inventors: **William J. Saunders**, Anderson, SC  
(US); **Amir Tayyebi**, Atlanta, GA (US)

FOREIGN PATENT DOCUMENTS

(73) Assignee: **TTI (MACAO COMMERCIAL**  
**OFFSHORE) LIMITED, Macau (MO)**

CA 2147735 10/1995  
CA 2435212 8/2002

(Continued)

(\*\*) Term: **15 Years**

OTHER PUBLICATIONS

(21) Appl. No.: **29/553,940**

Makita Corporation "Makita LXDT01 Cordless Impact Driver Owner's Manual" downloaded from <http://makitatools.com/> on Apr. 23, 2013 (32 pages).

(22) Filed: **Feb. 5, 2016**

(Continued)

(51) **LOC (10) Cl.** ..... **08-01**

(52) **U.S. Cl.**  
USPC ..... **D8/68**

(58) **Field of Classification Search**  
USPC ..... D8/61, 67, 68; D13/162, 169, 170, 171,  
D13/173, 174

CPC .... B62D 23/005; B62D 29/00; B62D 29/043;  
B62D 31/00; B62D 33/046; B62D 35/00;  
B62D 35/001; B60Q 1/005

See application file for complete search history.

*Primary Examiner* — Darlington Ly  
(74) *Attorney, Agent, or Firm* — Michael Best & Friedrich LLP

(57) **CLAIM**

We claim the ornamental design for a rotary power tool, as shown and described.

**DESCRIPTION**

FIG. 1 is a rear perspective view of a rotary power tool showing our new design;  
FIG. 2 is a left side elevation view thereof;  
FIG. 3 is a right side elevation view thereof;  
FIG. 4 is a top plan view thereof;  
FIG. 5 is a bottom plan view thereof; and  
FIG. 6 is a front elevation view thereof; and,  
FIG. 7 is a rear elevation view thereof.

The even broken lines in the drawings illustrate portions of the rotary power tool that forms no part of the claimed design. Additionally, the dash-dot broken lines in the drawings illustrate boundaries of the claimed design and form no part thereof.

(56) **References Cited**

U.S. PATENT DOCUMENTS

4,118,614 A 10/1978 Leibundgut  
4,636,961 A 1/1987 Bauer  
5,526,460 A 6/1996 DeFrancesco et al.  
6,431,289 B1 8/2002 Potter et al.  
D489,240 S \* 5/2004 Bartfeld ..... D8/68  
D503,879 S \* 4/2005 Watson ..... D8/68  
D515,375 S \* 2/2006 Tsang ..... D8/68  
D556,002 S \* 11/2007 Ino ..... D8/68  
D609,544 S \* 2/2010 Lopano ..... D8/68  
7,717,192 B2 5/2010 Schroeder et al.  
D617,622 S \* 6/2010 Lopano ..... D8/68

**1 Claim, 6 Drawing Sheets**

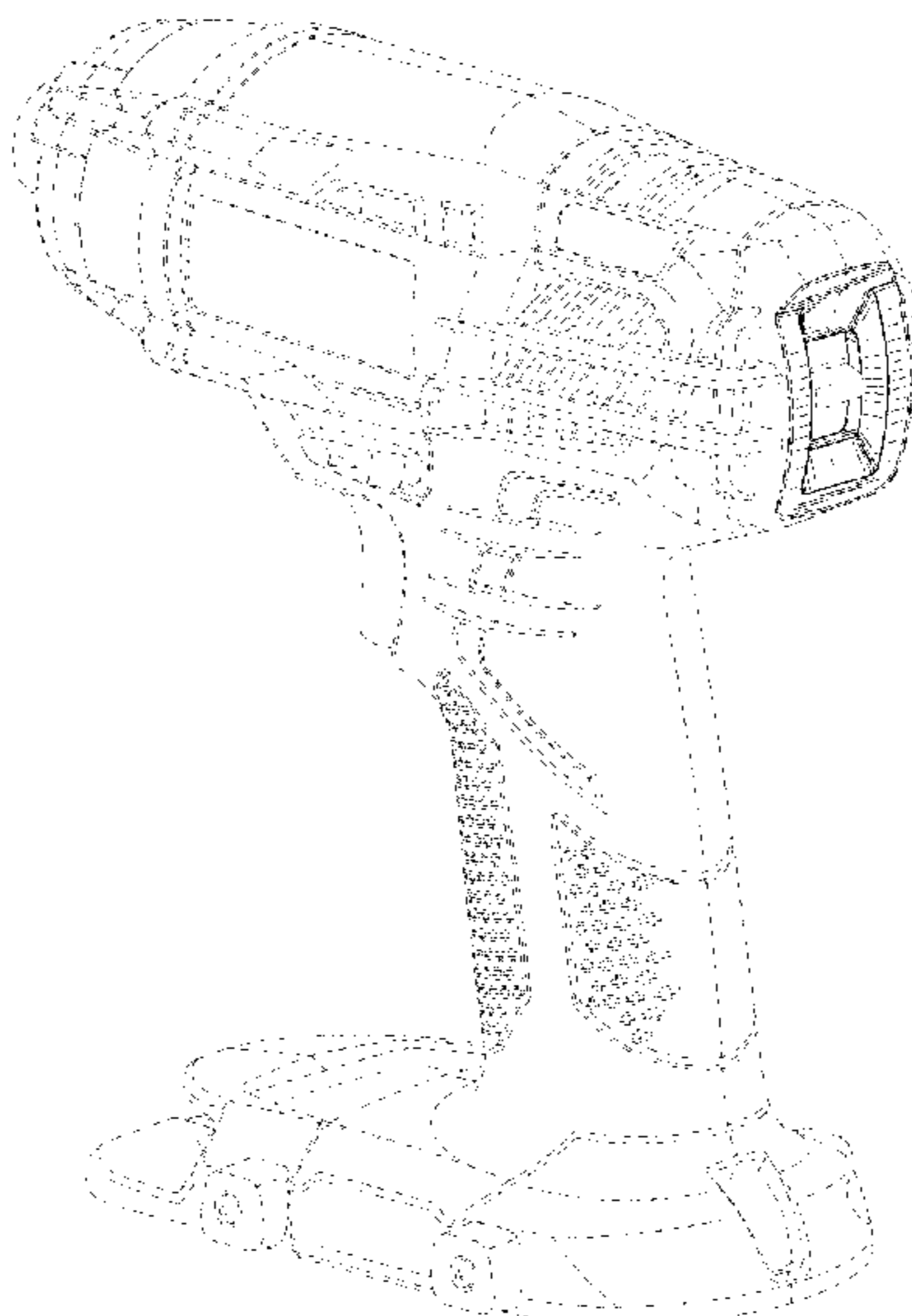

(56)

**References Cited**

U.S. PATENT DOCUMENTS

D656,804	S *	4/2012	Murray .....	D8/68
8,251,158	B2	8/2012	Tomayko et al.	
8,319,379	B2	11/2012	Onose et al.	
D677,137	S *	3/2013	Kawase .....	D8/68
D679,160	S *	4/2013	Okuda .....	D8/68
D679,161	S *	4/2013	Kawase .....	D8/61
D691,444	S *	10/2013	Tirone .....	D8/68
D700,822	S *	3/2014	Tschopp .....	D8/68
D707,522	S *	6/2014	Naksen .....	D8/68
D777,545	S *	1/2017	Kosugi .....	D8/68
2011/0227430	A1 *	9/2011	Omori .....	B25F 5/00 310/50
2011/0315417	A1	12/2011	Matsunaga et al.	
2012/0169256	A1	7/2012	Suda et al.	
2012/0175140	A1	7/2012	Hecht et al.	
2013/0014967	A1	1/2013	Ito et al.	
2015/0083451	A1 *	3/2015	Nishikawa .....	B25B 21/026 173/48

FOREIGN PATENT DOCUMENTS

CA	2435251	8/2002
CA	2686810	8/2002
WO	2012014503	2/2012

OTHER PUBLICATIONS

Makita Corporation "Makita LXDT01 Parts Breakdown" downloaded from <http://makitatools.com/> on Apr. 23, 2013 (2 pages).

\* cited by examiner

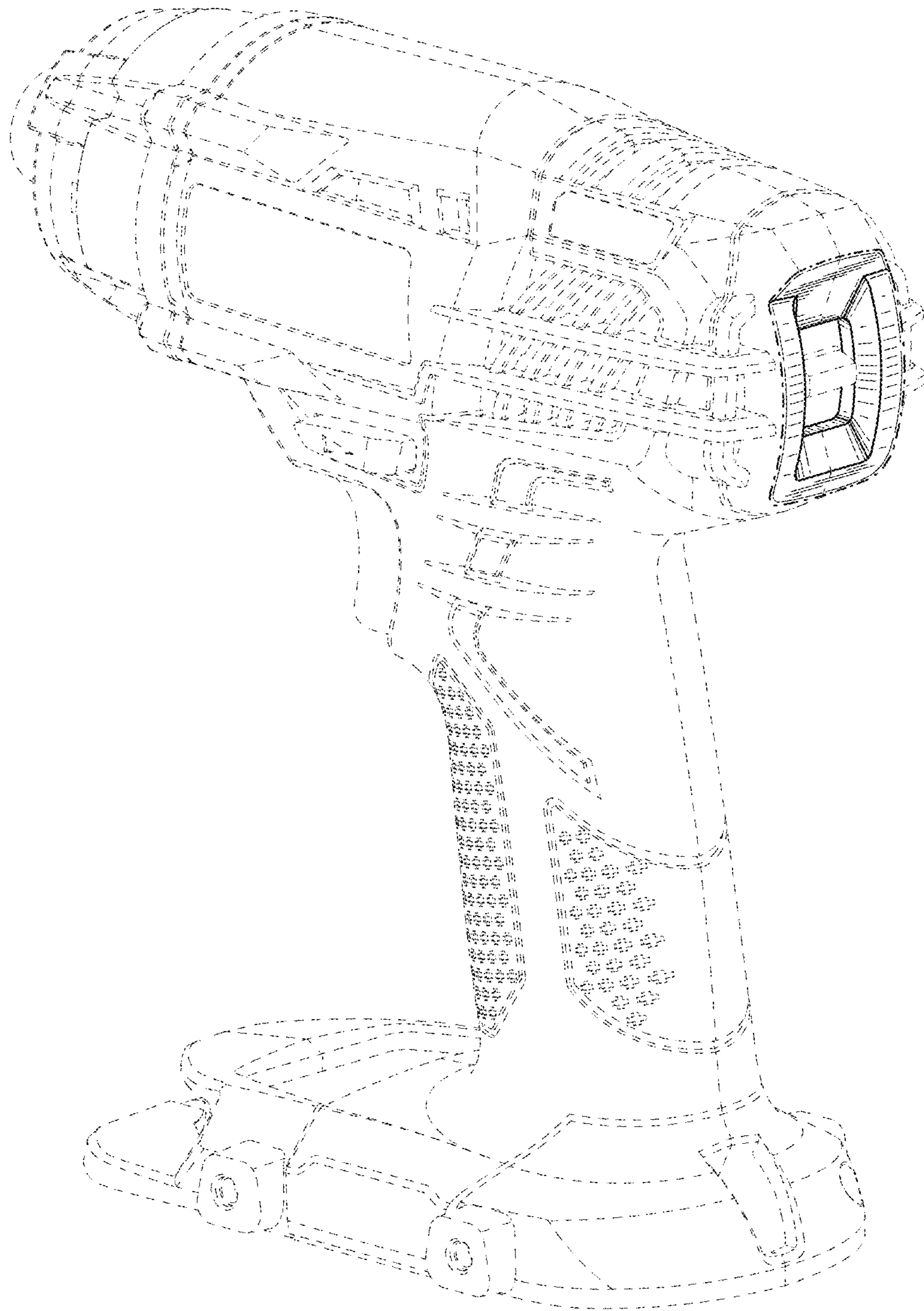

**FIG. 1**

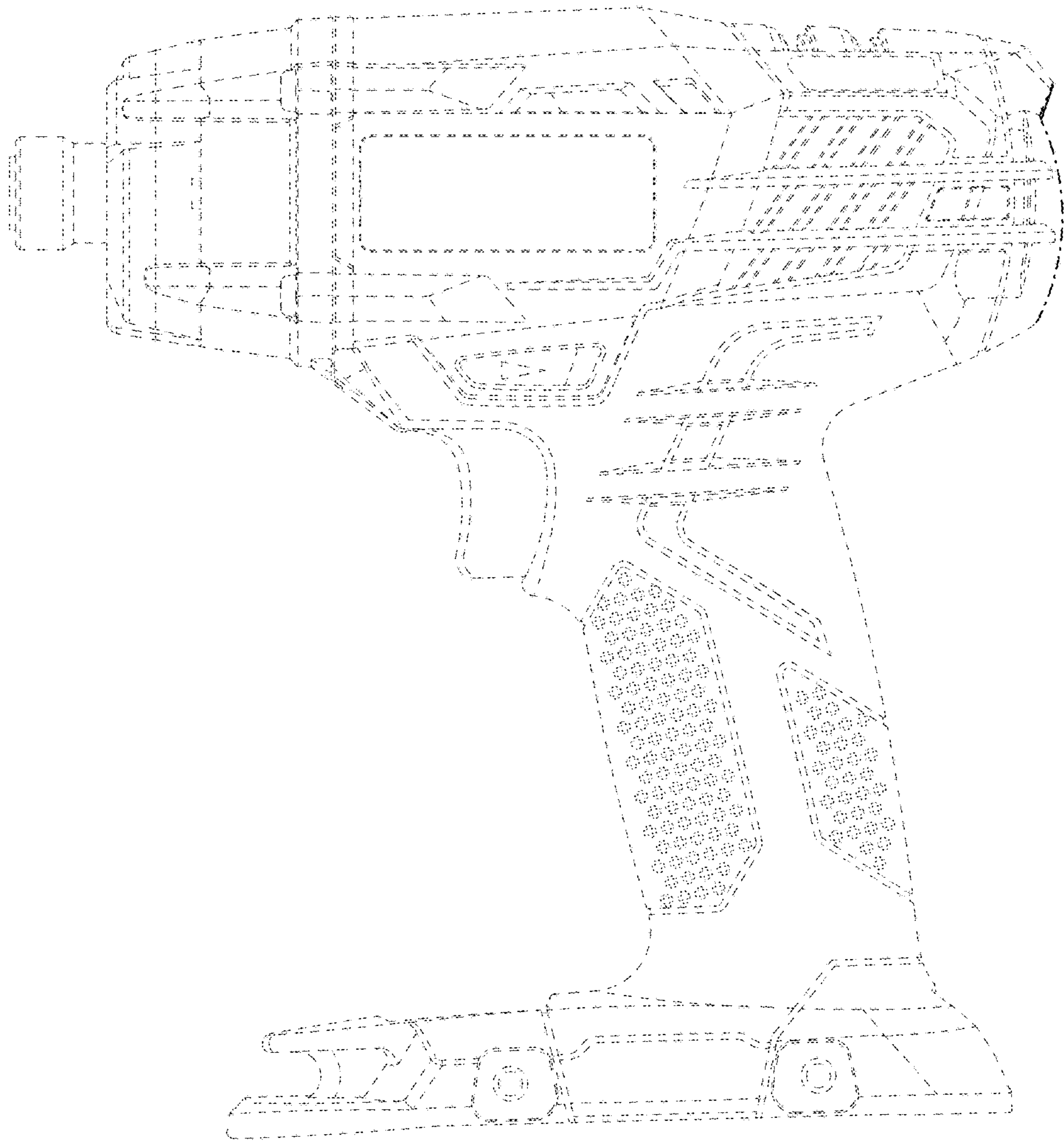

**FIG. 2**

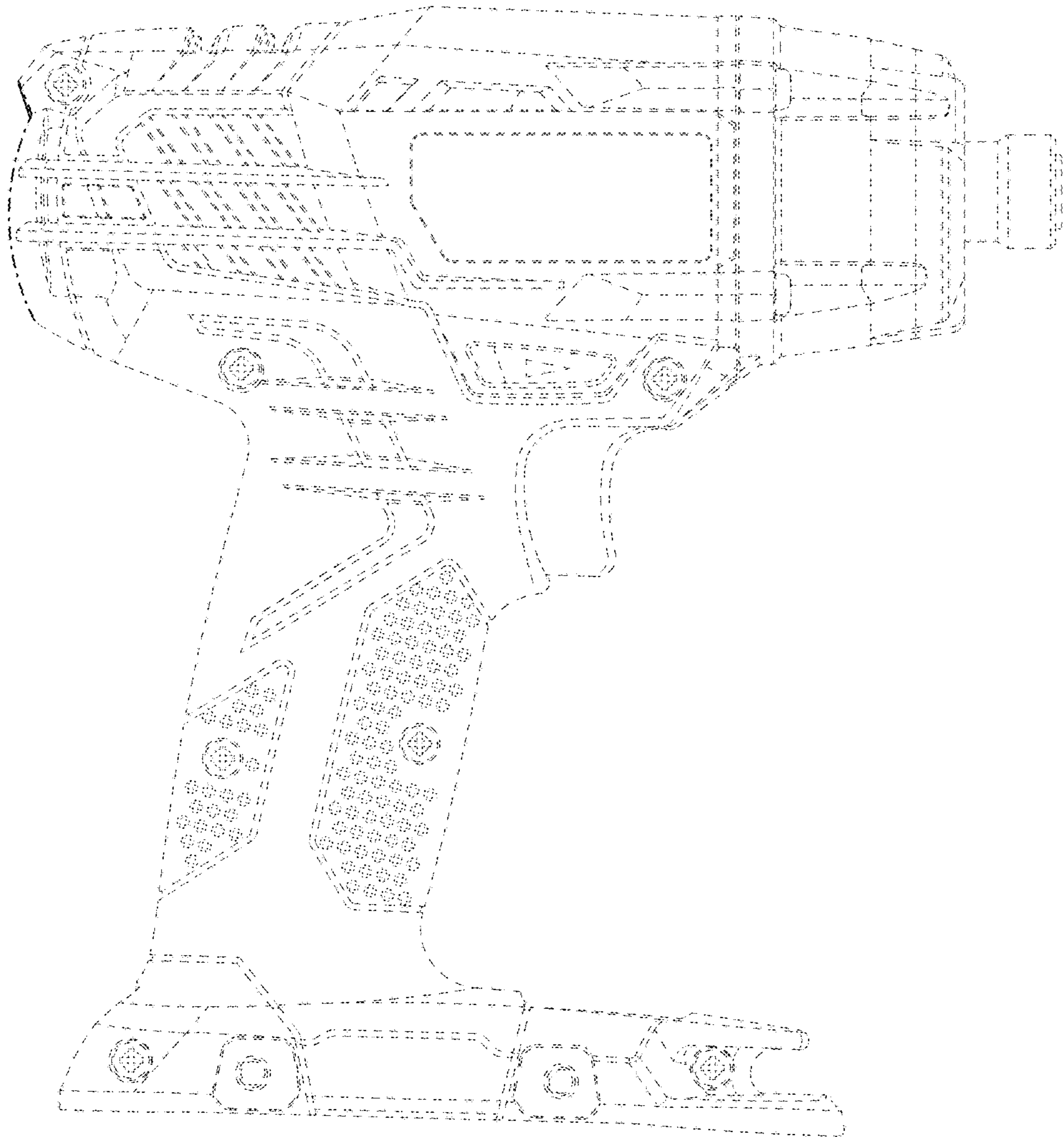

**FIG. 3**

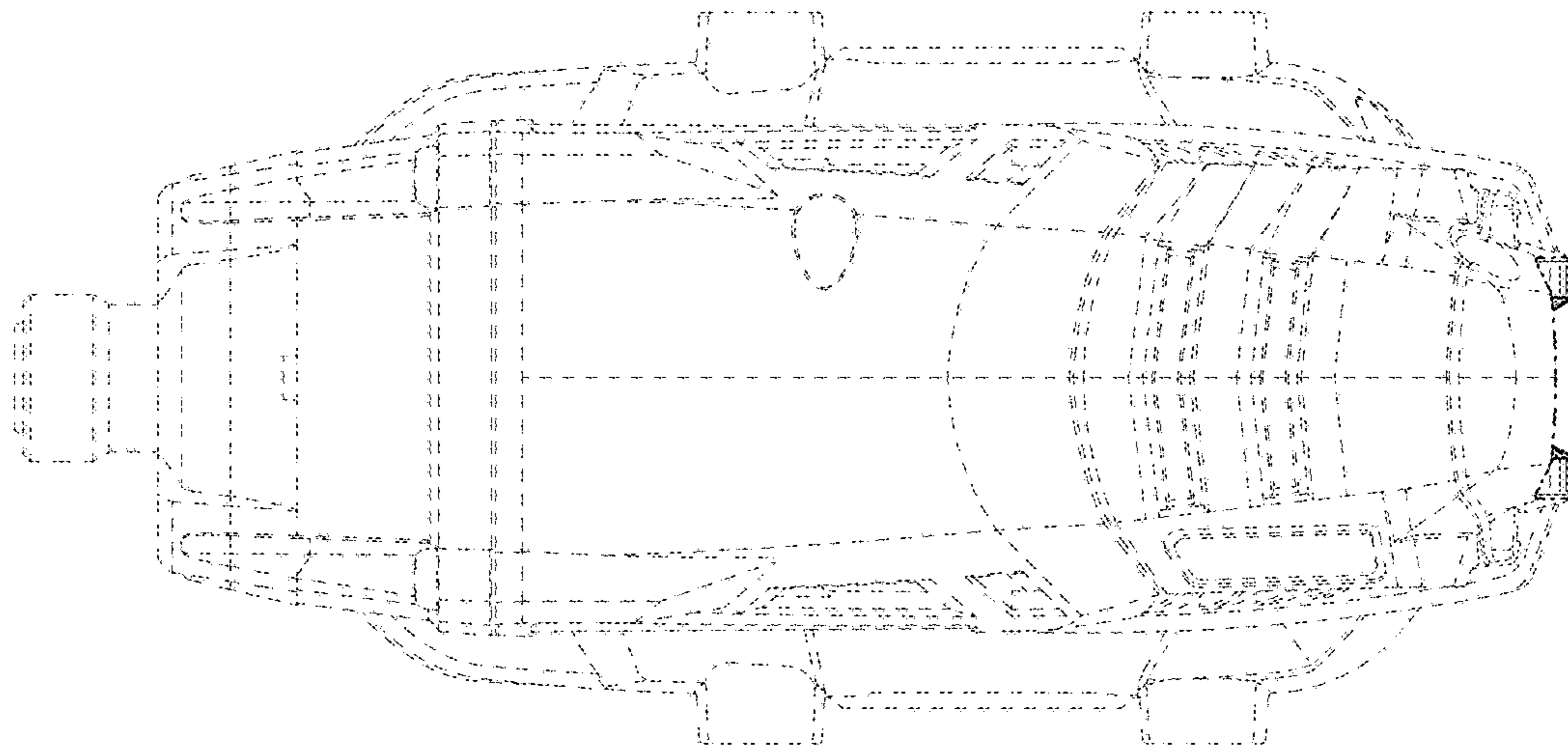

**FIG. 4**

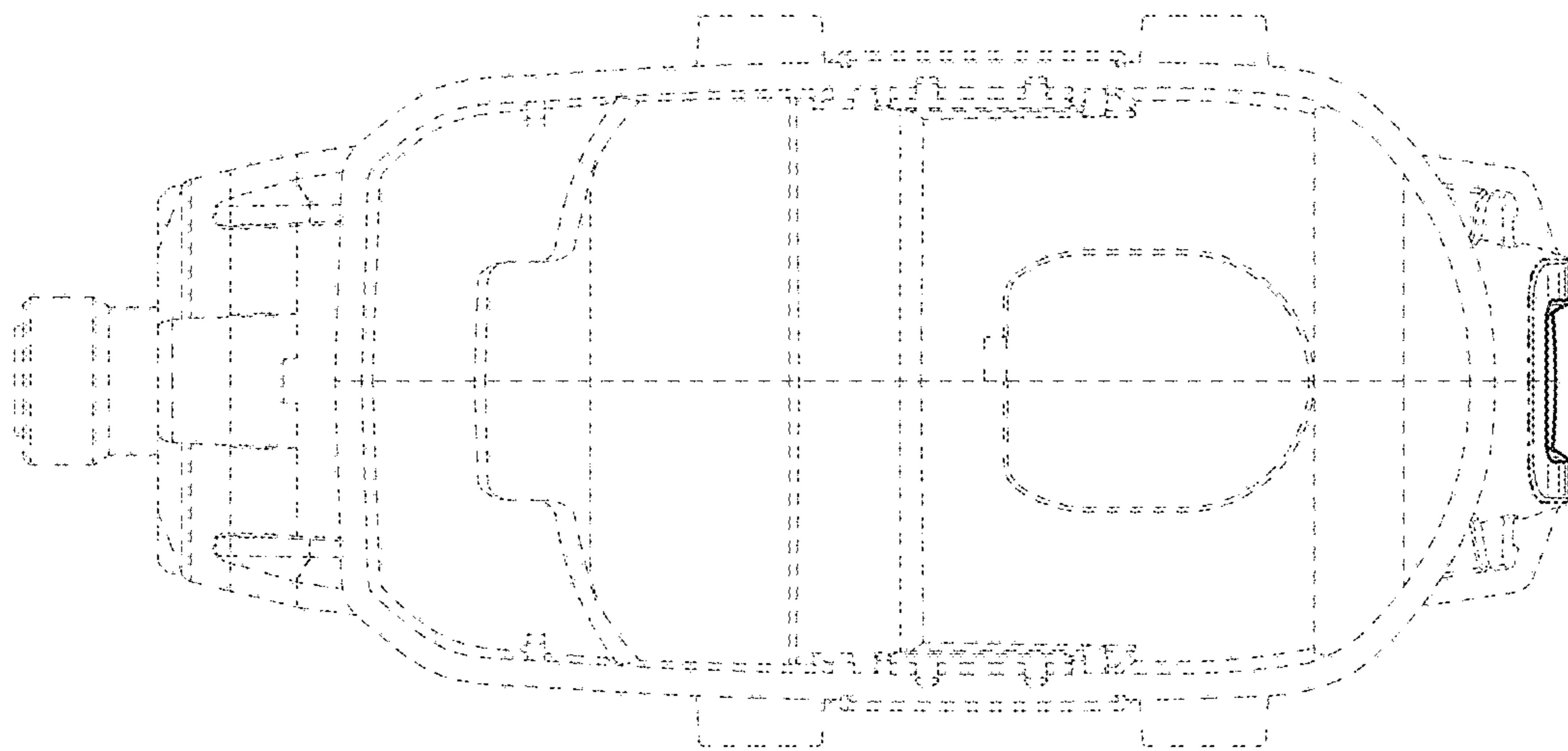

**FIG. 5**

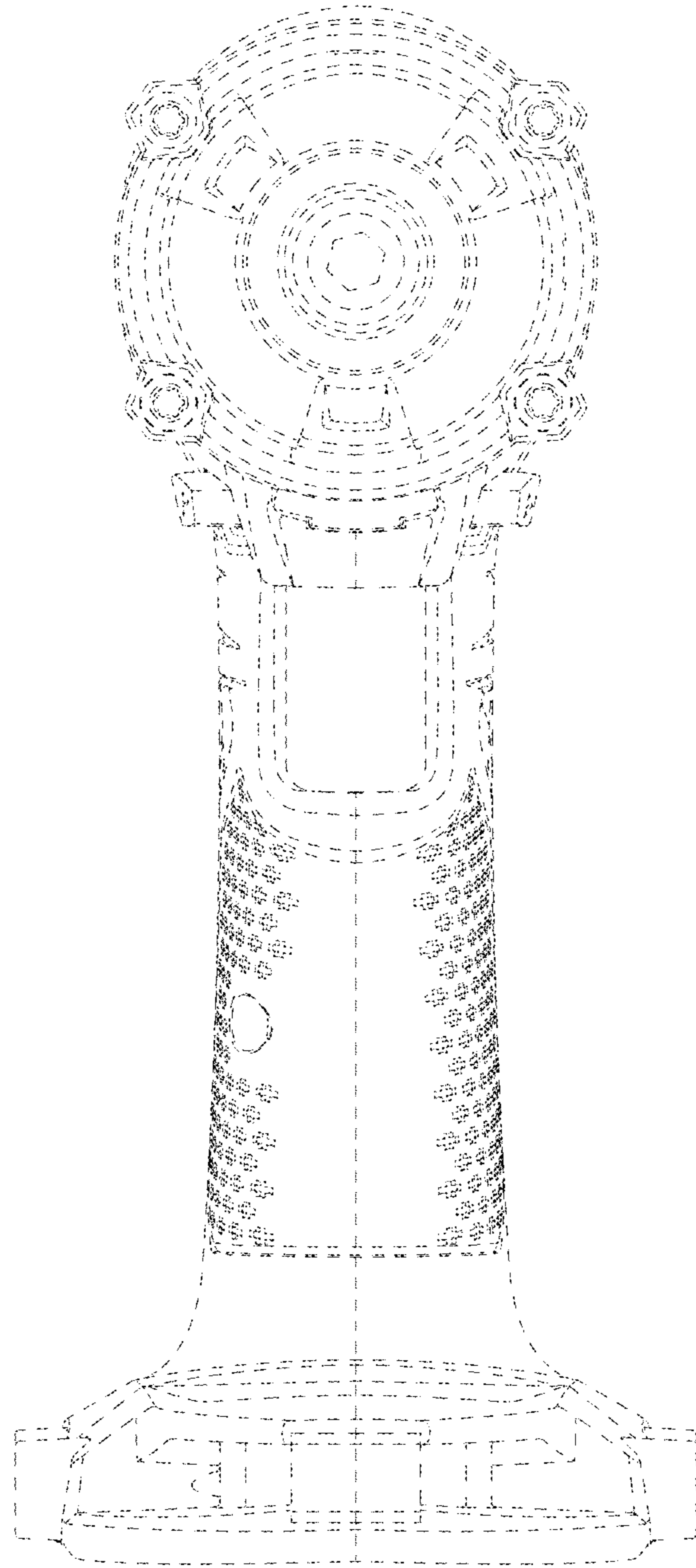

**FIG. 6**

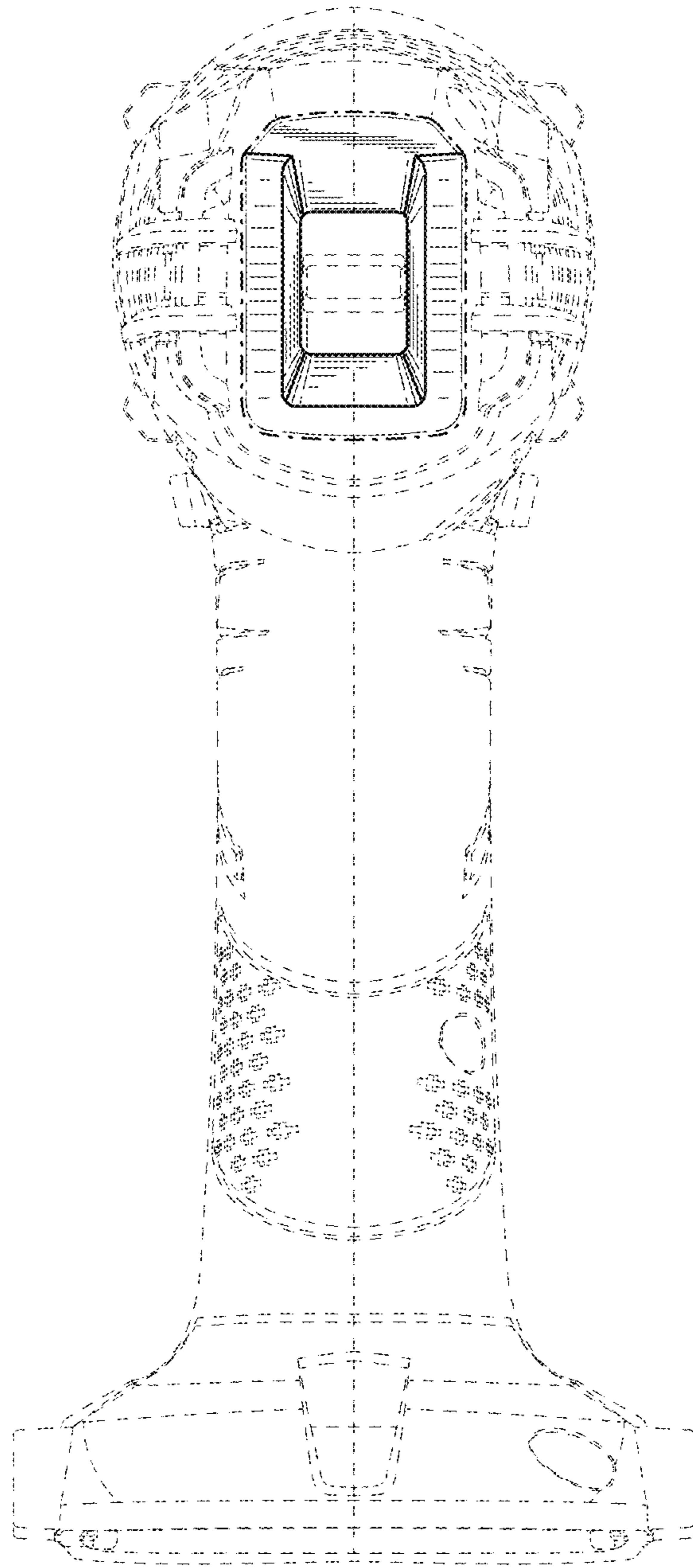

**FIG. 7**