



US00D788844S

(12) **United States Design Patent**  
**Sakano**

(10) **Patent No.:** **US D788,844 S**

(45) **Date of Patent:** **\*\* Jun. 6, 2017**

(54) **TAPE CARTRIDGE FOR A LABEL PRINTER**

(71) Applicant: **SEIKO EPSON CORPORATION,**  
Tokyo (JP)

(72) Inventor: **Hideki Sakano,** Matsumoto (JP)

(73) Assignee: **SEIKO EPSON CORPORATION,**  
Tokyo (JP)

(\*\*) Term: **15 Years**

(21) Appl. No.: **29/540,835**

(22) Filed: **Sep. 28, 2015**

(30) **Foreign Application Priority Data**

Apr. 3, 2015 (JP) ..... 2015-007686  
Apr. 3, 2015 (JP) ..... 2015-007691

(51) **LOC (10) Cl.** ..... **18-02**

(52) **U.S. Cl.**  
USPC ..... **D18/56**

(58) **Field of Classification Search**  
USPC ..... D18/12, 40, 43, 56; D20/11, 19, 22, 27,  
D20/28  
CPC ..... B41J 3/4075; B41J 15/044; B41J 32/00;  
B31D 1/027; G06F 17/30725; G06Q  
20/3274; G06Q 20/3276  
See application file for complete search history.

(56) **References Cited**

**U.S. PATENT DOCUMENTS**

D220,740 S \* 5/1971 Larson ..... D20/22  
4,741,793 A \* 5/1988 Jones ..... B44C 3/12  
156/249  
D313,569 S \* 1/1991 Allard ..... D10/121  
D344,102 S \* 2/1994 Polak ..... D20/11  
5,934,812 A \* 8/1999 Nunokawa ..... B41J 3/4075  
400/621  
6,373,510 B1 \* 4/2002 Hosokawa ..... B41J 3/4075  
347/171  
D587,145 S \* 2/2009 Nakatsubo ..... D10/52

D588,029 S \* 3/2009 Nakatsubo ..... D10/52  
D653,144 S \* 1/2012 Kazyaka ..... D10/122  
D660,352 S \* 5/2012 Sodeyama ..... D18/56  
D665,020 S \* 8/2012 Sodeyama ..... D18/56  
9,022,503 B2 \* 5/2015 Toya ..... B41J 2/2114  
347/14

(Continued)

*Primary Examiner* — Cathron Brooks  
*Assistant Examiner* — Andrew Nemeth

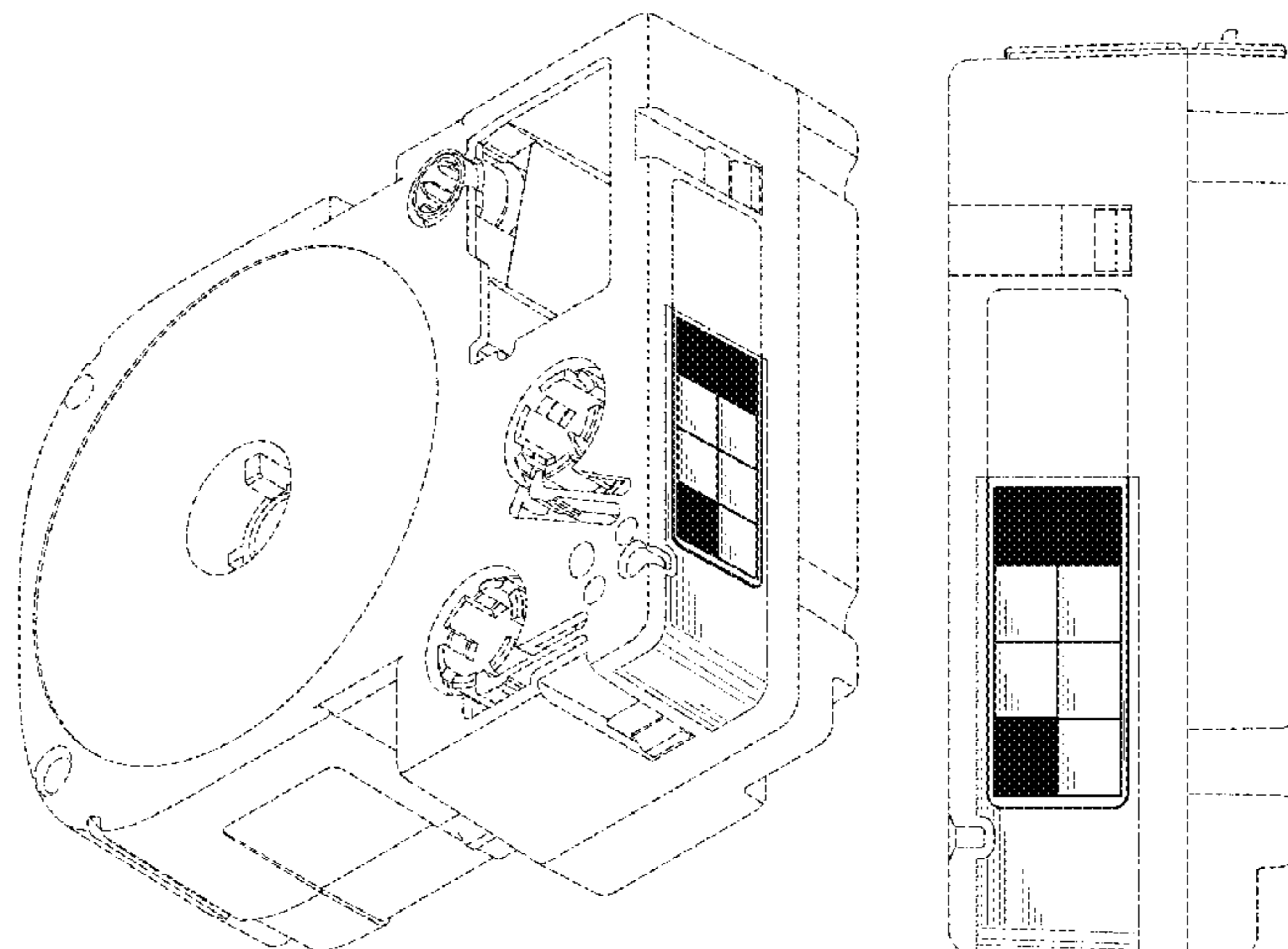
(57) **CLAIM**

The ornamental design for a tape cartridge for a label printer,  
as shown and described.

**DESCRIPTION**

FIG. 1 is a front, bottom, and right side perspective view of a first embodiment of a tape cartridge for a label printer showing my new design;  
FIG. 2 is a front elevational view thereof;  
FIG. 3 is a rear elevational view thereof;  
FIG. 4 is a top plan view thereof;  
FIG. 5 is a bottom plan view thereof;  
FIG. 6 is a right side elevational view thereof;  
FIG. 7 is a left side elevational view thereof;  
FIG. 8 is a front, bottom, and right side perspective view of a second embodiment of a tape cartridge for a label printer showing my new design;  
FIG. 9 is a front elevational view thereof;  
FIG. 10 is a rear elevational view thereof;  
FIG. 11 is a top plan view thereof;  
FIG. 12 is a bottom plan view thereof;  
FIG. 13 is a right side elevational view thereof; and,  
FIG. 14 is a left side elevational view thereof.  
The features shown in broken lines in the drawings depict environmental subject matter only and form no part of the claimed design. The dash-dotted lines denote the boundary of the claim and form no part of the claimed design. The solid black areas in the drawing are black in color.

**1 Claim, 14 Drawing Sheets**



(56)

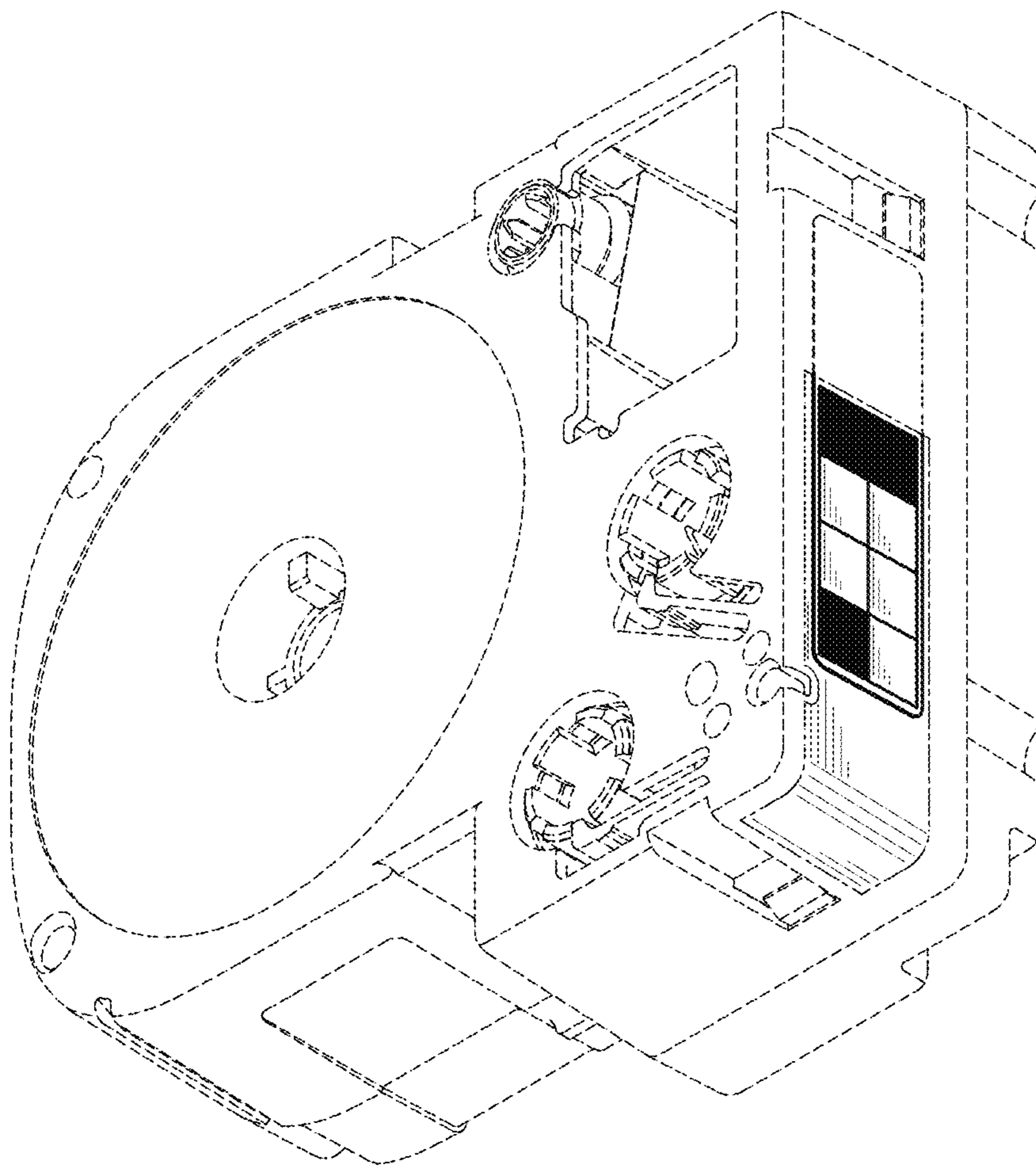
**References Cited**

U.S. PATENT DOCUMENTS

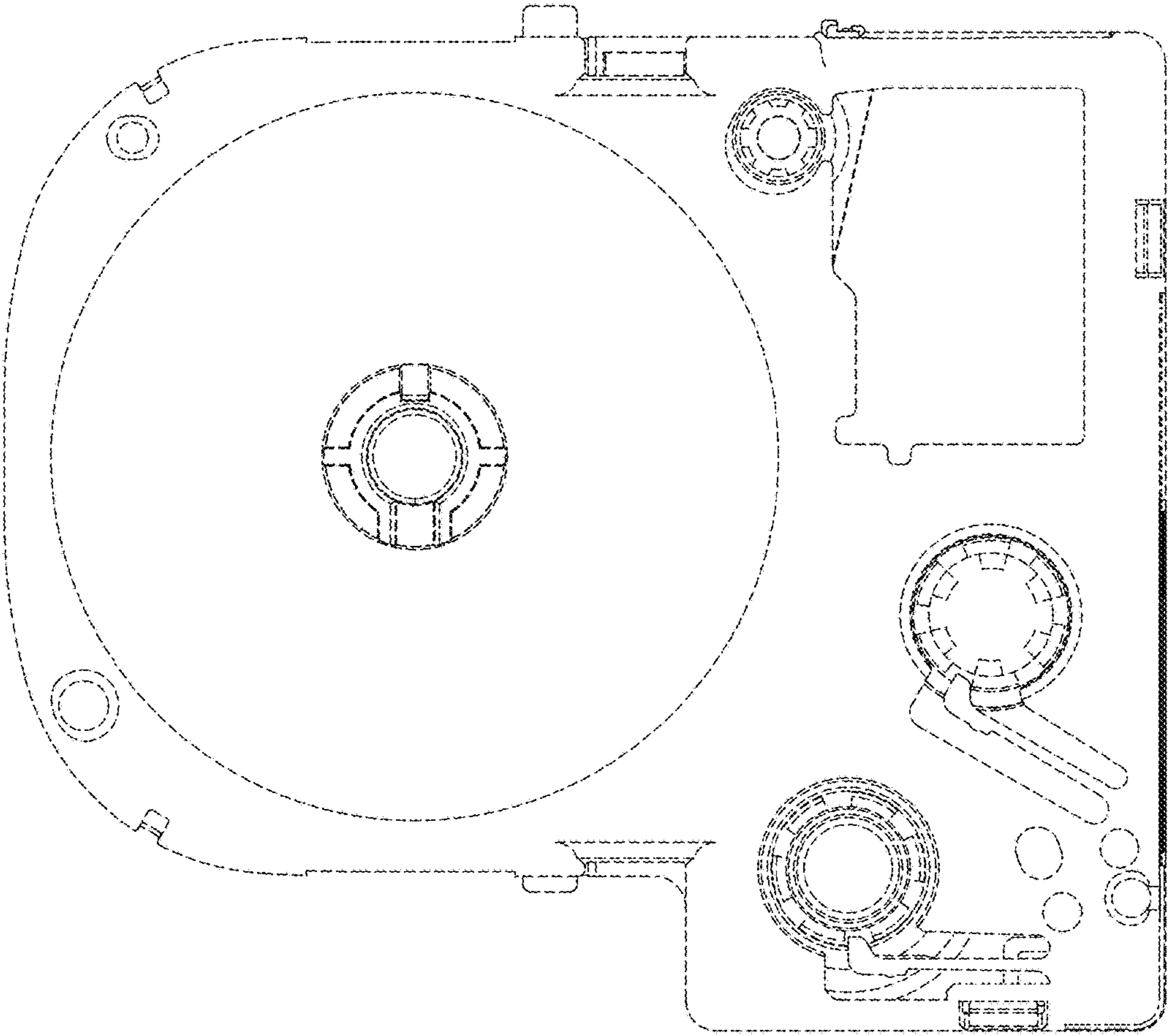
9,145,008	B2 *	9/2015	Nakajima .....	B41J 11/663
9,399,357	B2 *	7/2016	Ishino .....	B41J 2/3551
2002/0030712	A1 *	3/2002	Silverbrook .....	B41J 2/14 347/19
2002/0071104	A1 *	6/2002	Silverbrook .....	B41J 2/14 355/18
2006/0222429	A1 *	10/2006	Kurashina .....	B41J 3/32 400/76
2014/0292983	A1 *	10/2014	Nagahara .....	B41J 11/663 347/104
2015/0283836	A1 *	10/2015	Sakano .....	B41J 3/4075 347/214
2016/0271983	A1 *	9/2016	Sakano .....	B41J 17/32

\* cited by examiner

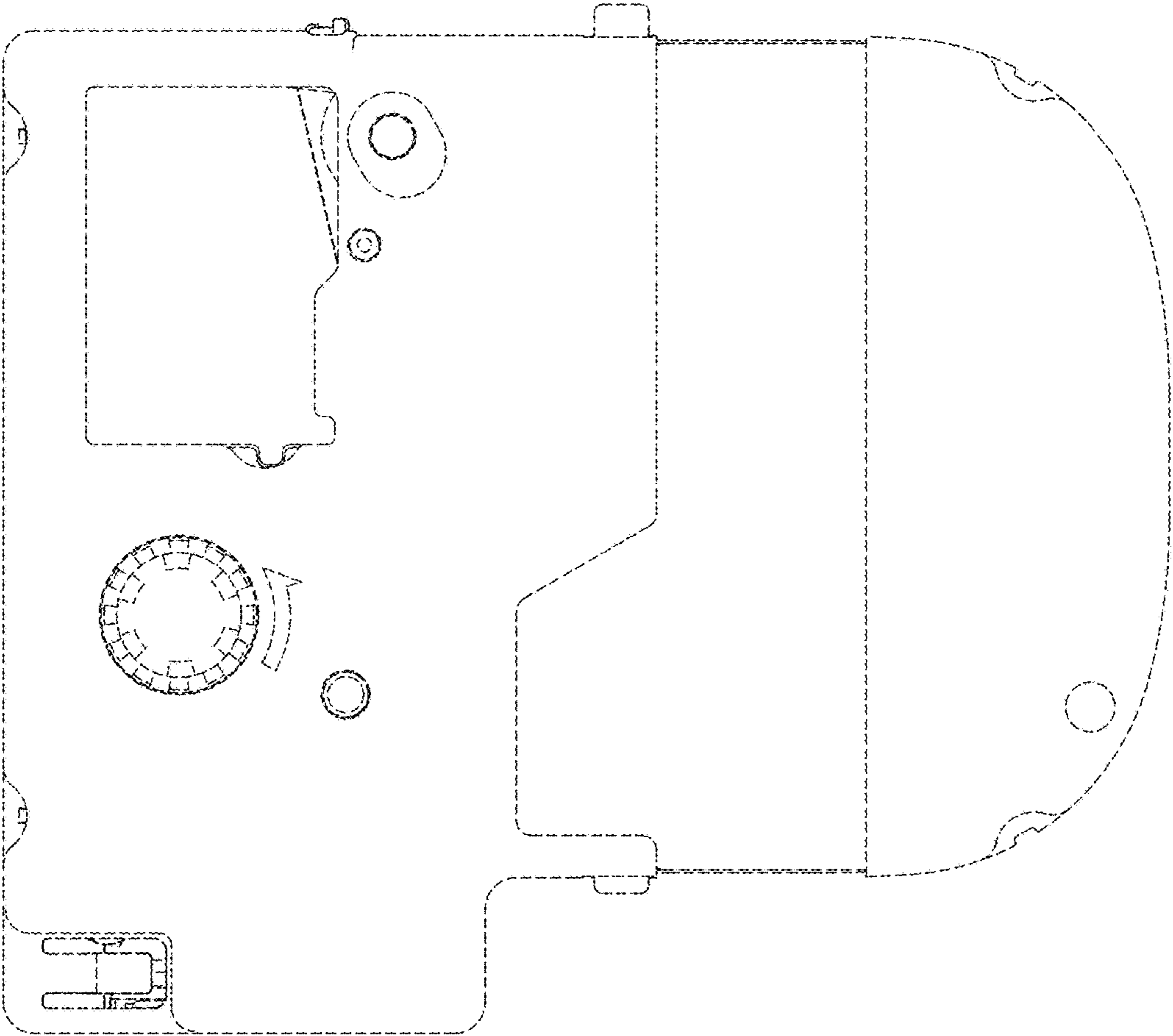
**FIG. 1**



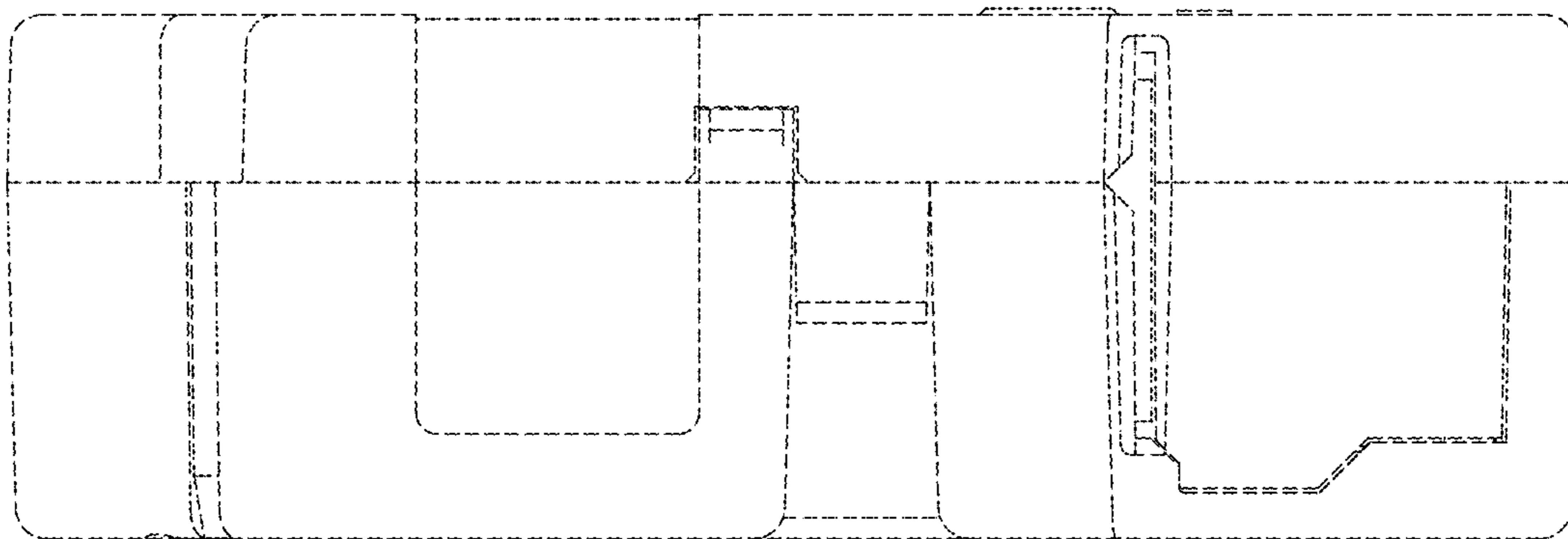
**FIG. 2**



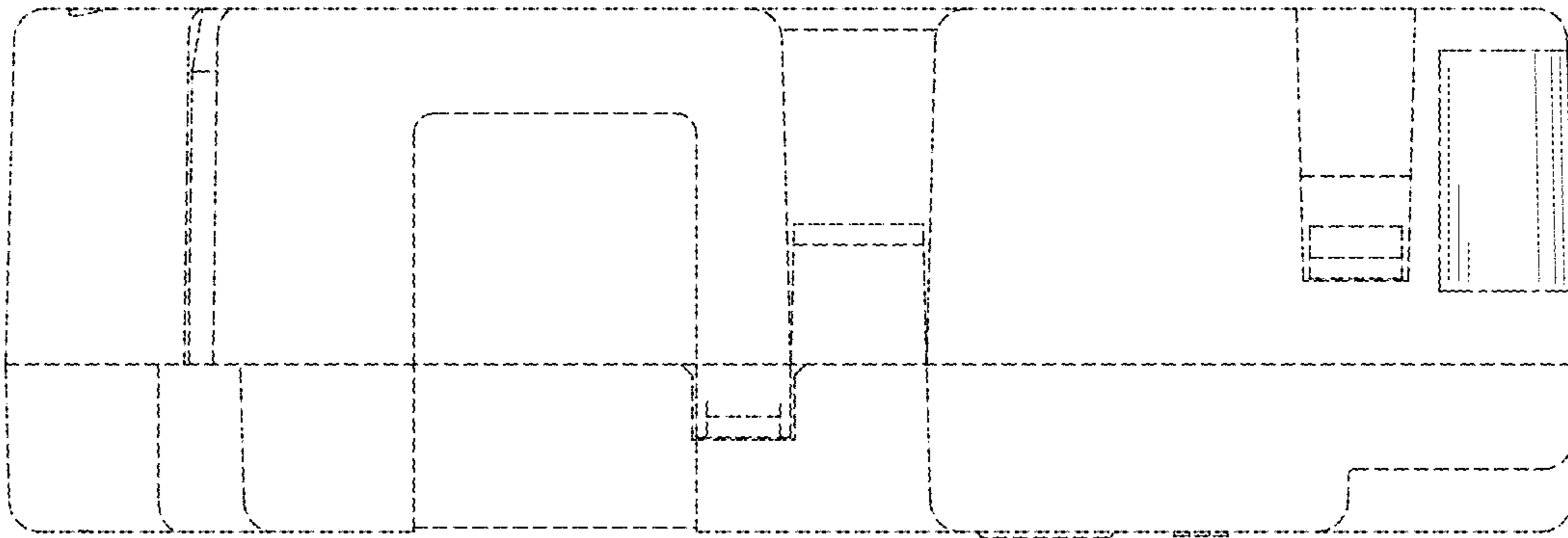
**FIG. 3**



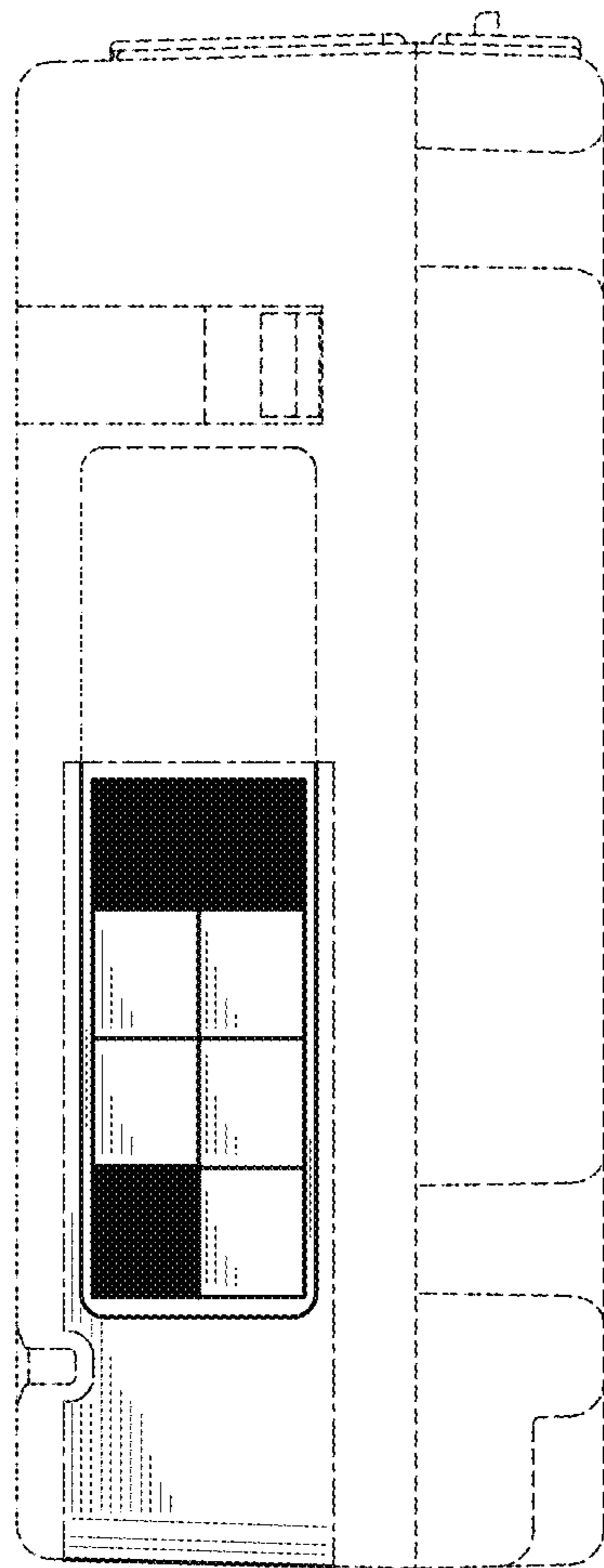
**FIG. 4**



***FIG. 5***

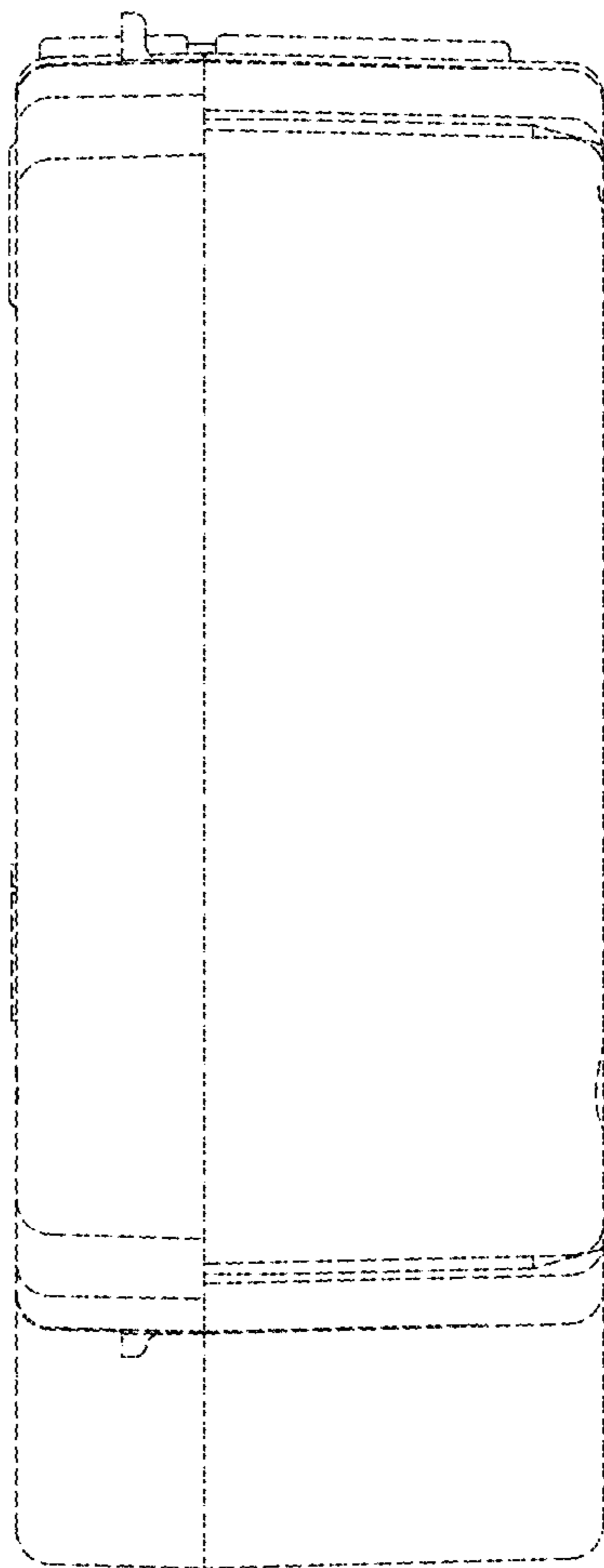


**FIG. 6**

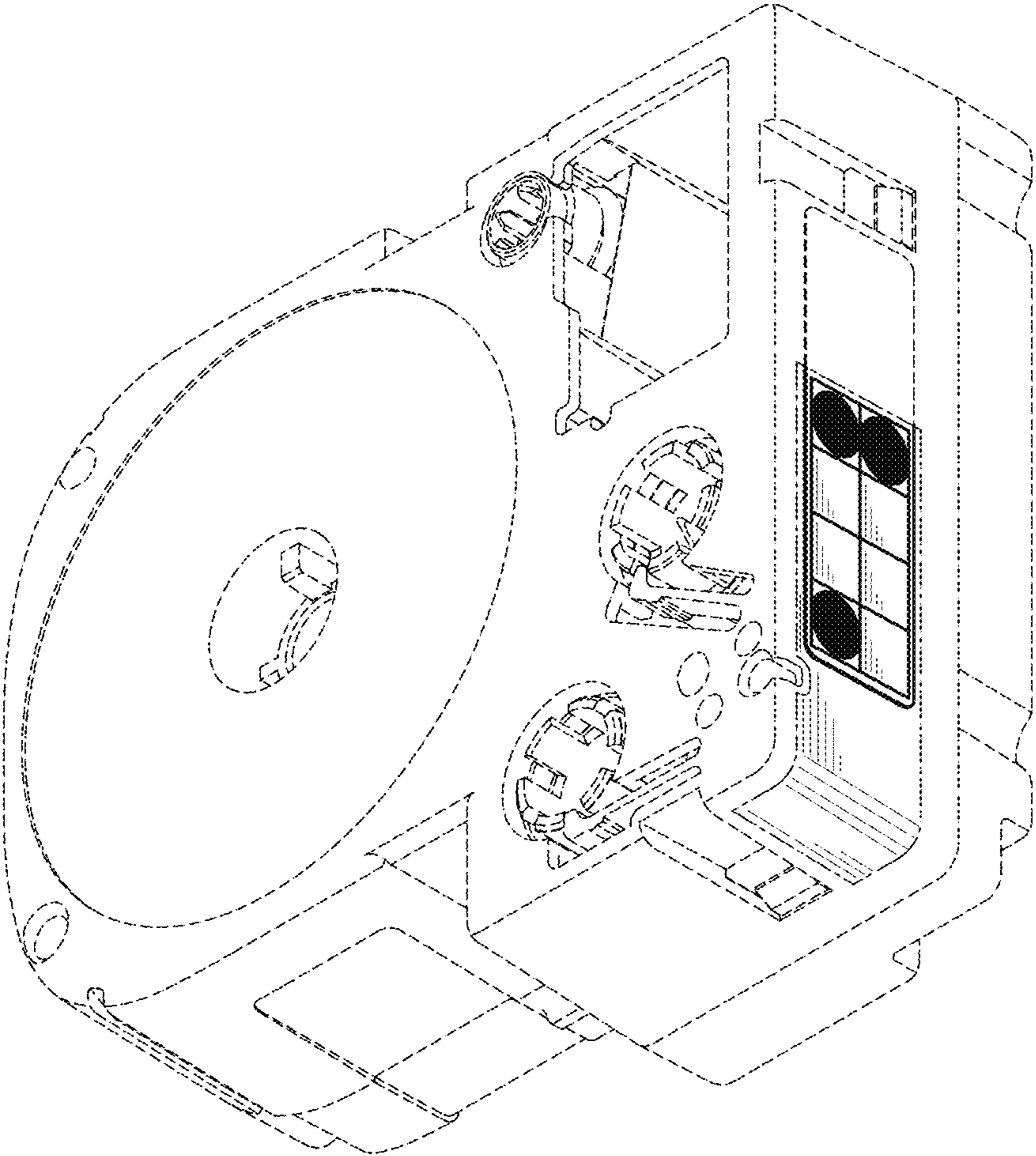




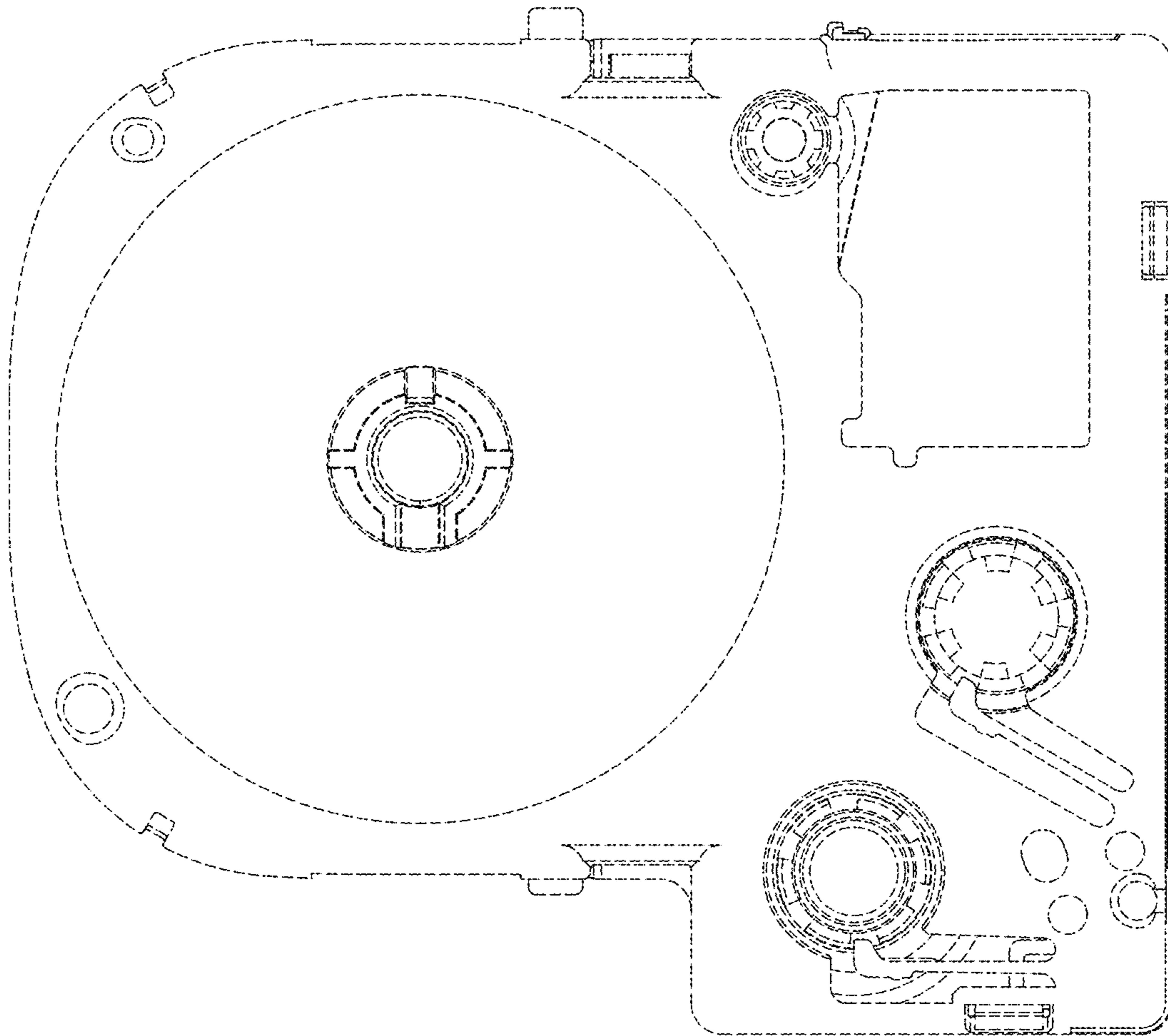
**FIG. 7**



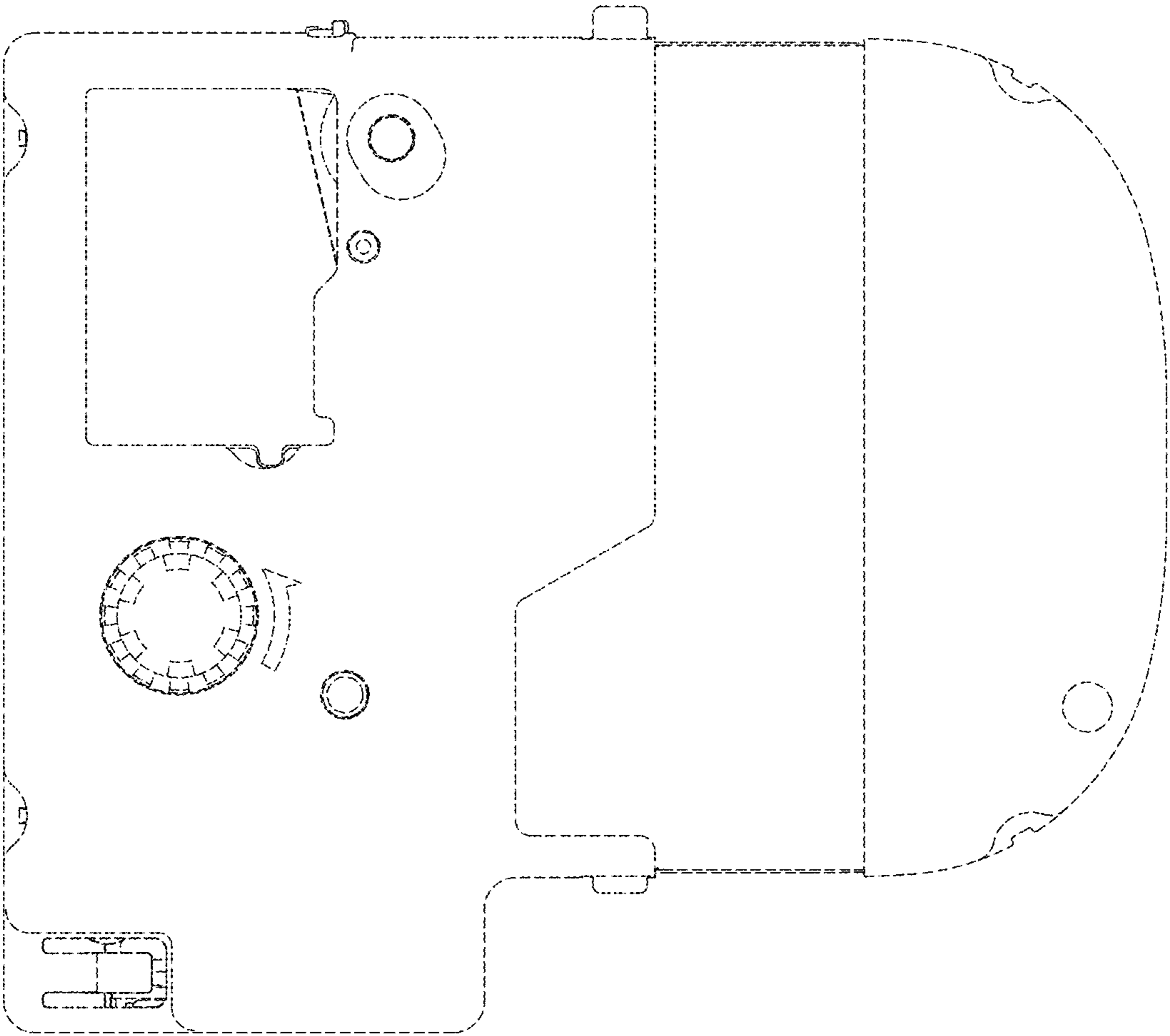
**FIG. 8**



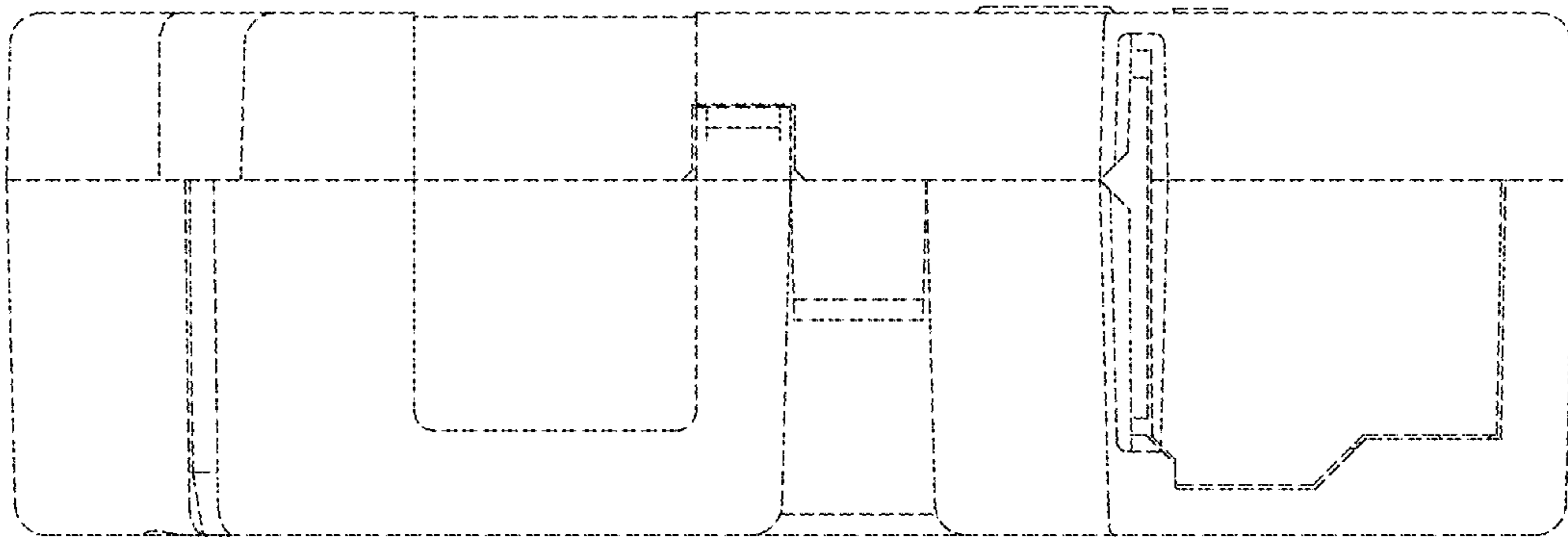
**FIG. 9**



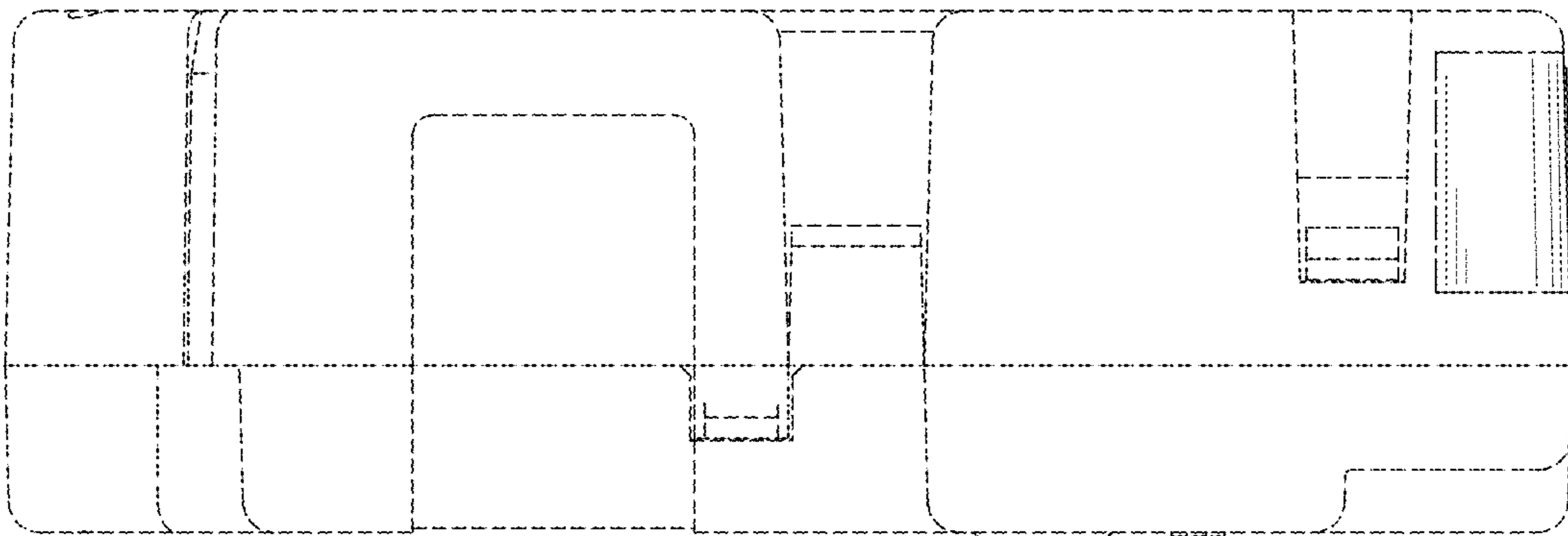
**FIG. 10**



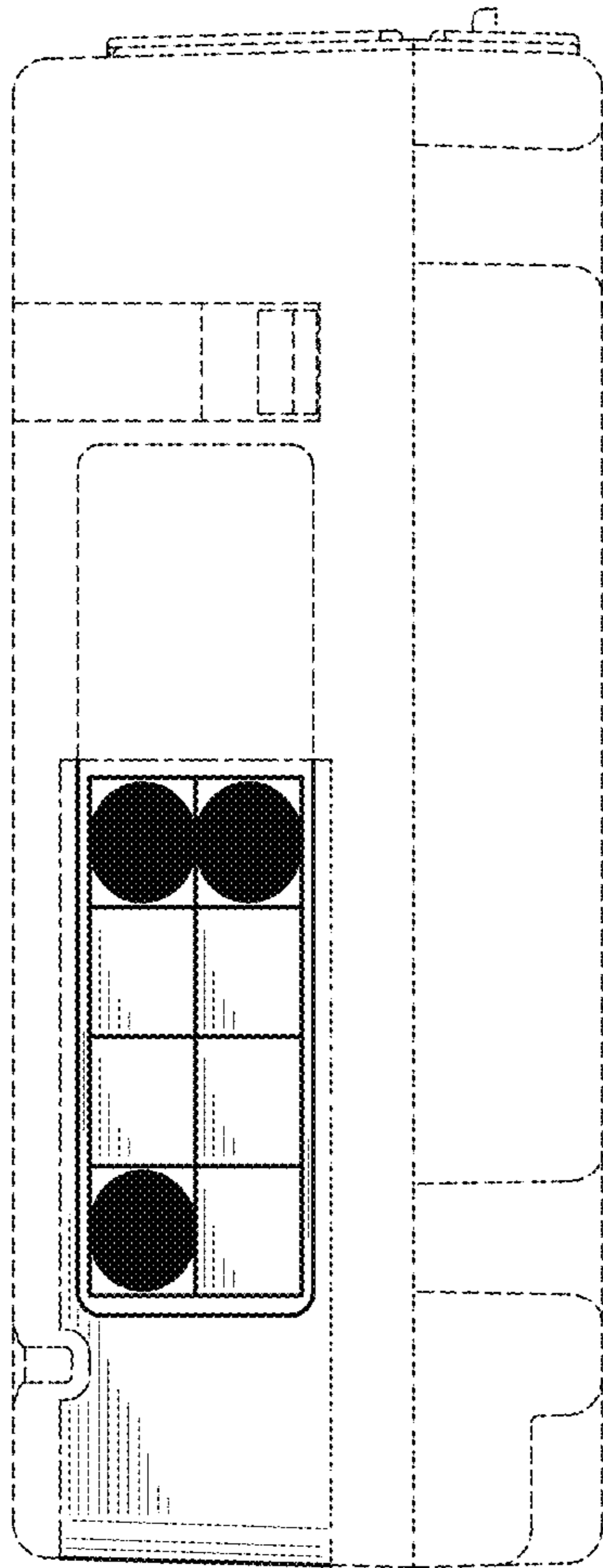
***FIG. 11***



***FIG. 12***



*FIG. 13*



***FIG. 14***

