



US00D788823S

(12) **United States Design Patent** (10) **Patent No.:** **US D788,823 S**
Ito (45) **Date of Patent:** **** Jun. 6, 2017**

(54) **ENGINE FOR BRUSH CUTTER**
(71) Applicant: **YAMABIKO CORPORATION**, Tokyo (JP)
(72) Inventor: **Tomoki Ito**, Tokyo (JP)
(73) Assignee: **Yamabiko Corporation**, Tokyo (JP)
(**) Term: **15 Years**
(21) Appl. No.: **29/552,341**
(22) Filed: **Jan. 21, 2016**

(30) **Foreign Application Priority Data**
Aug. 28, 2015 (JP) 2015-019016
(51) **LOC (10) Cl.** **15-01**
(52) **U.S. Cl.**
USPC **D15/1**
(58) **Field of Classification Search**
USPC D15/1-5, 11, 12, 17, 14, 149;
D32/15-19, 21, 25; D23/213, 383
CPC F01P 5/02; F01P 1/02; F01P 1/06; F01P
2001/023; F02B 75/007; F02B 63/02;
F02B 75/02; F02B 2075/022; F02B
75/16; F02B 2075/025; F02B 75/18
See application file for complete search history.

(56) **References Cited**
U.S. PATENT DOCUMENTS
D416,265 S * 11/1999 Kato D15/1
D503,410 S * 3/2005 Kato D15/1
D599,822 S * 9/2009 Okuda D15/1
D638,856 S * 5/2011 Koizumi D15/5

D644,664 S * 9/2011 Sugiyama D15/1
D646,299 S * 10/2011 Aruga D15/1
D667,024 S * 9/2012 Taniguchi D15/1
D682,782 S * 5/2013 Yamamoto D13/112
D700,620 S * 3/2014 Aruga D15/1
D704,741 S * 5/2014 Tinius D15/1
2013/0284126 A1* 10/2013 Kimura F01P 1/06
123/2
2014/0216402 A1* 8/2014 Oppenlander F02M 3/10
123/437
2016/0237876 A1* 8/2016 Ichihashi F01N 3/10
* cited by examiner

Primary Examiner — T. Chase Nelson
Assistant Examiner — Ania Aman
(74) *Attorney, Agent, or Firm* — Dykema Gossett PLLC

(57) **CLAIM**
The ornamental design of an engine for brush cutter, as shown and described.

DESCRIPTION
FIG. 1 is a front view of an engine for brush cutter according to my new and ornamental design,
FIG. 2 is a rear view thereof,
FIG. 3 is a top plan view thereof,
FIG. 4 is a bottom plan view thereof,
FIG. 5 is a right side view thereof,
FIG. 6 is a left side view thereof,
FIG. 7 is a first perspective view thereof; and,
FIG. 8 is a second perspective view thereof.
The broken lines shown in the drawings are for the purpose of illustrating portions of the article that form no part of the claimed design.

1 Claim, 8 Drawing Sheets

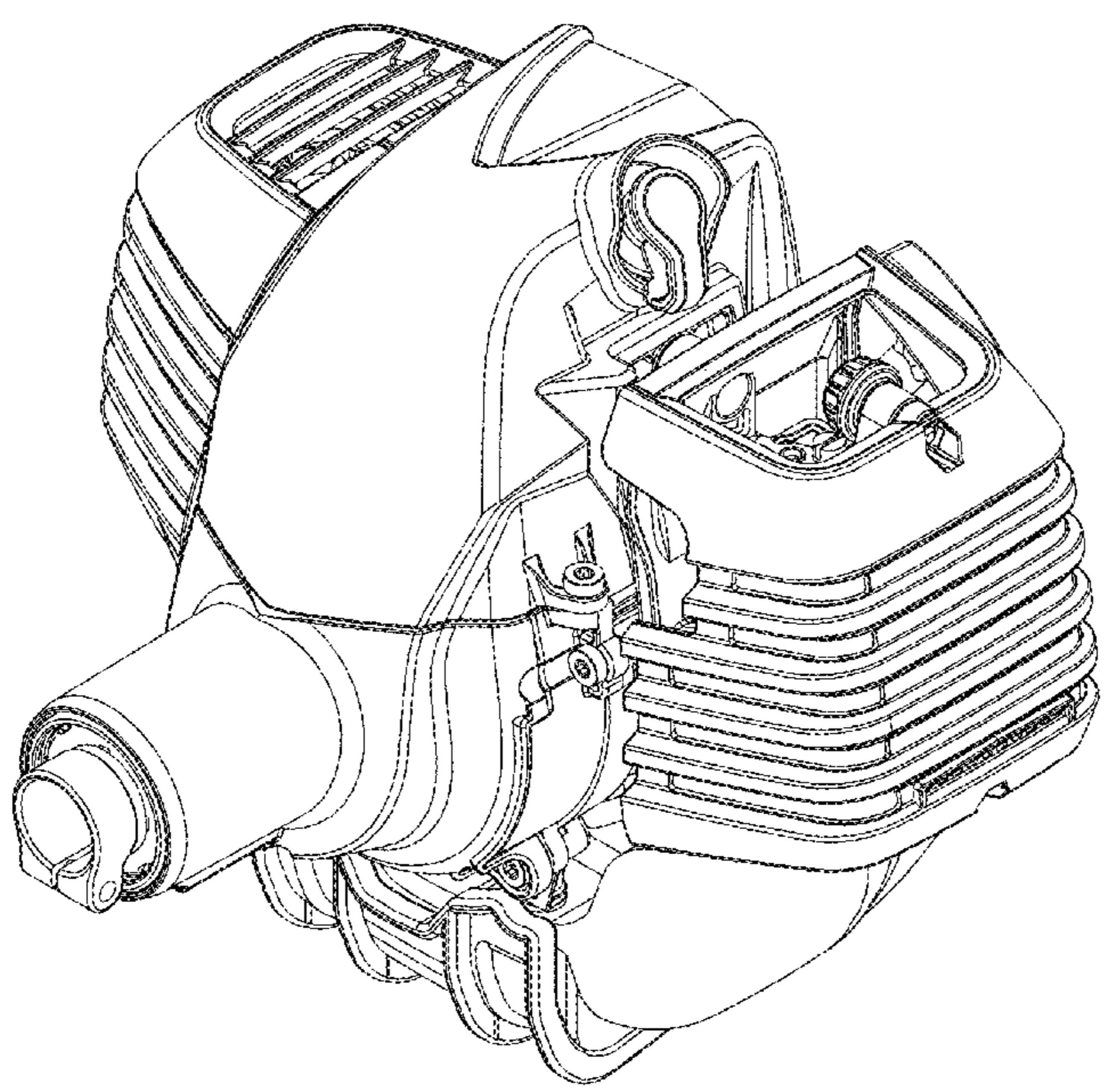

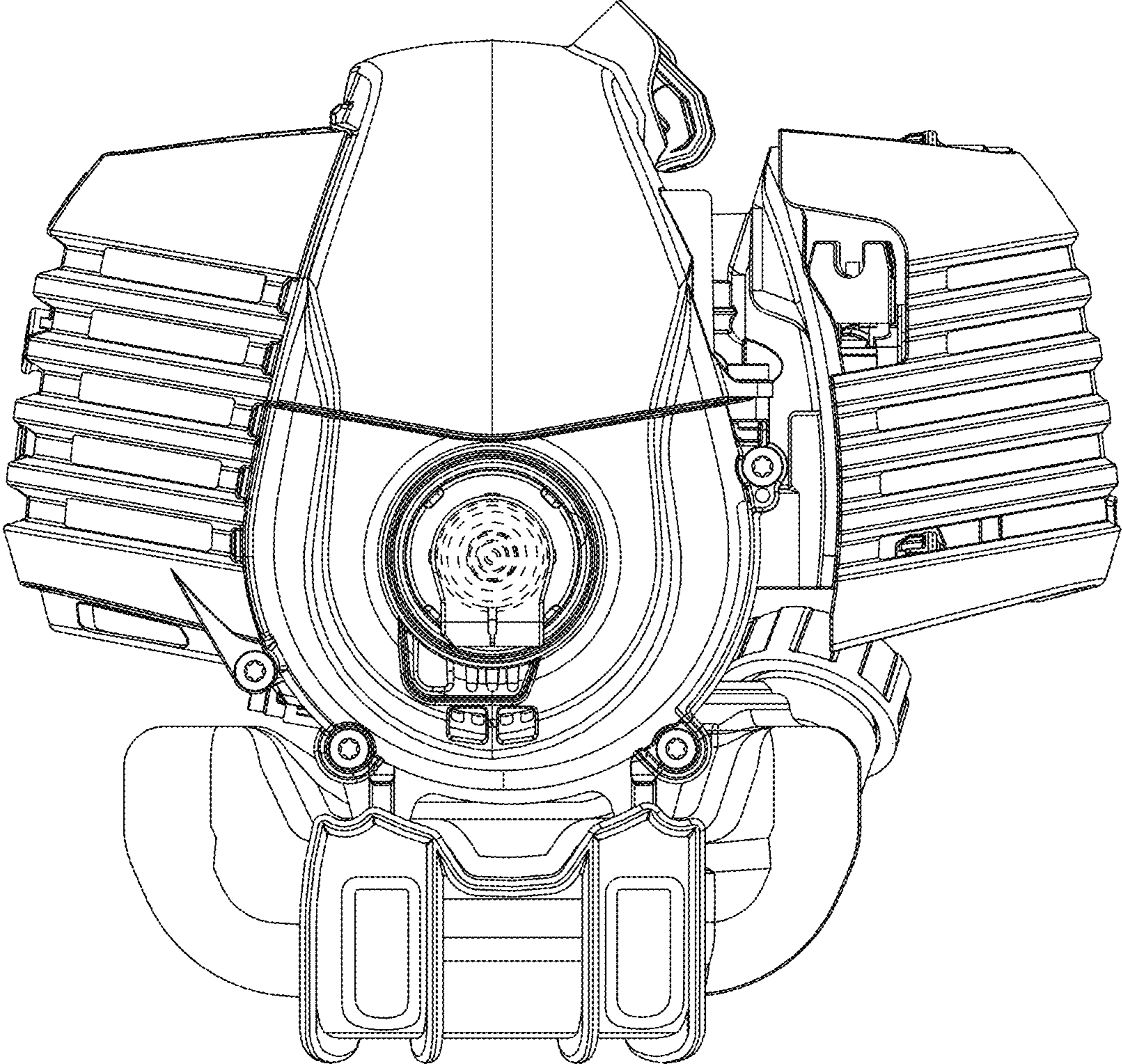

FIG. 1

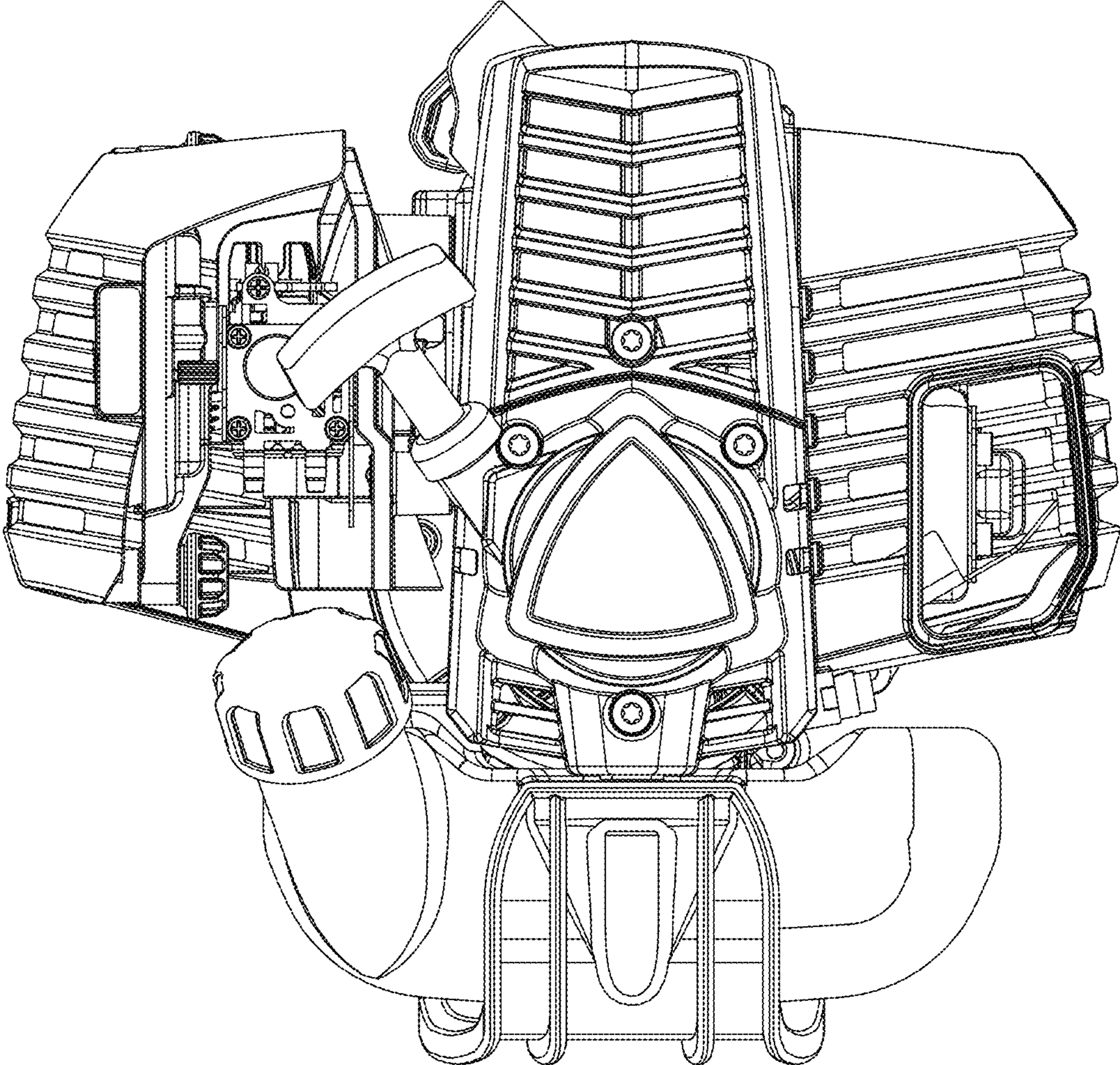

FIG. 2

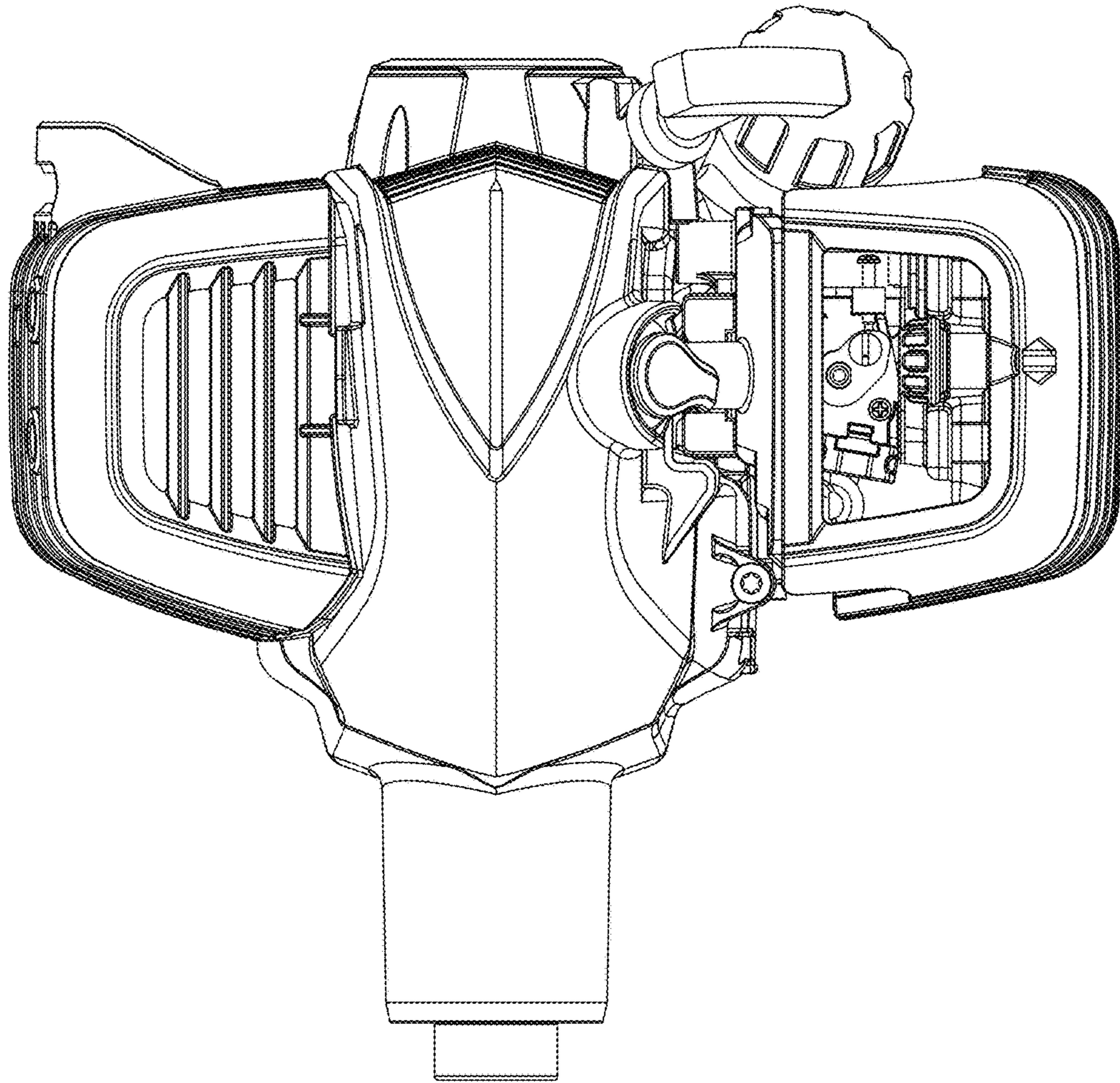

FIG. 3

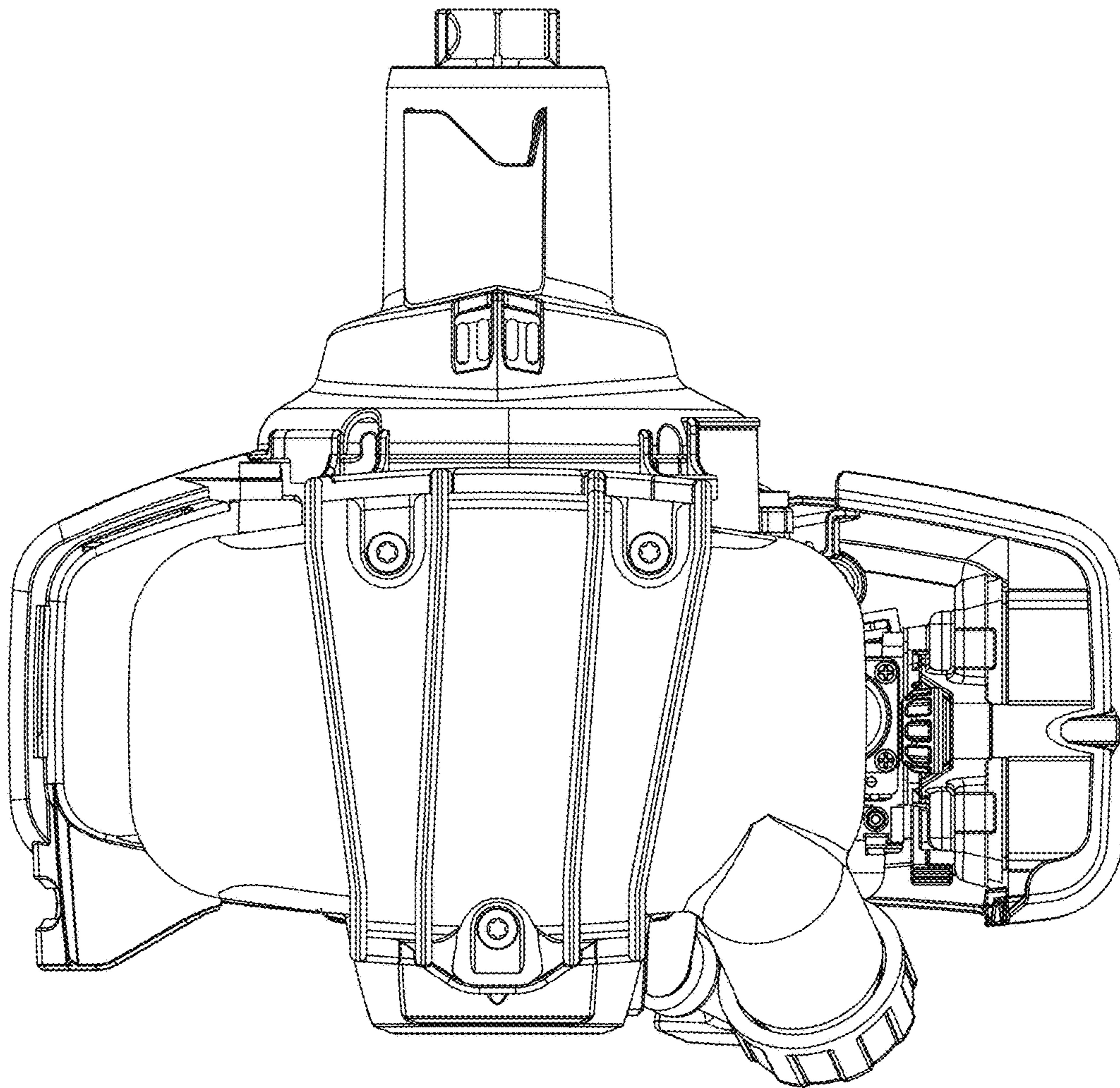

FIG. 4

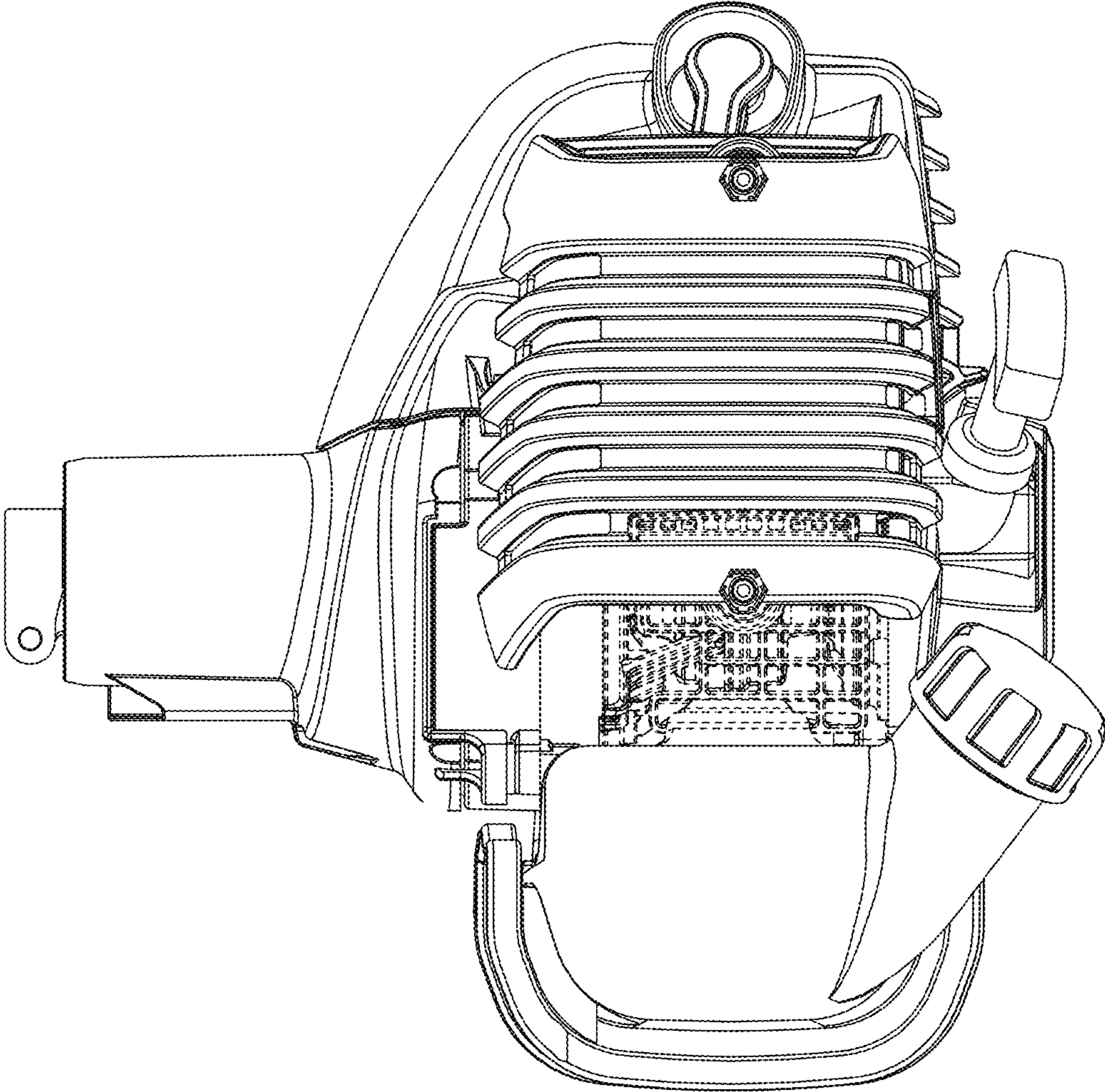

FIG. 5

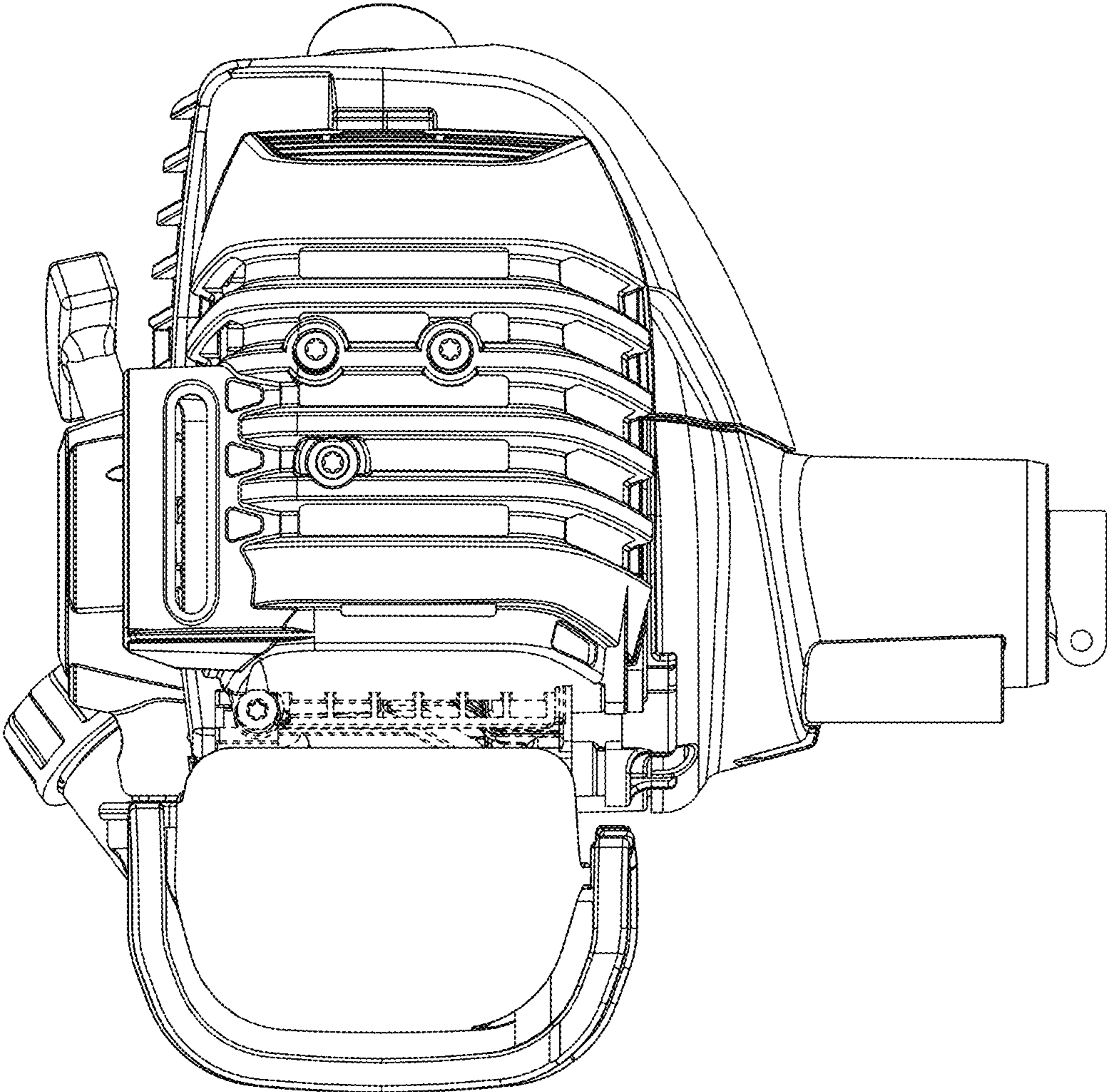

FIG. 6

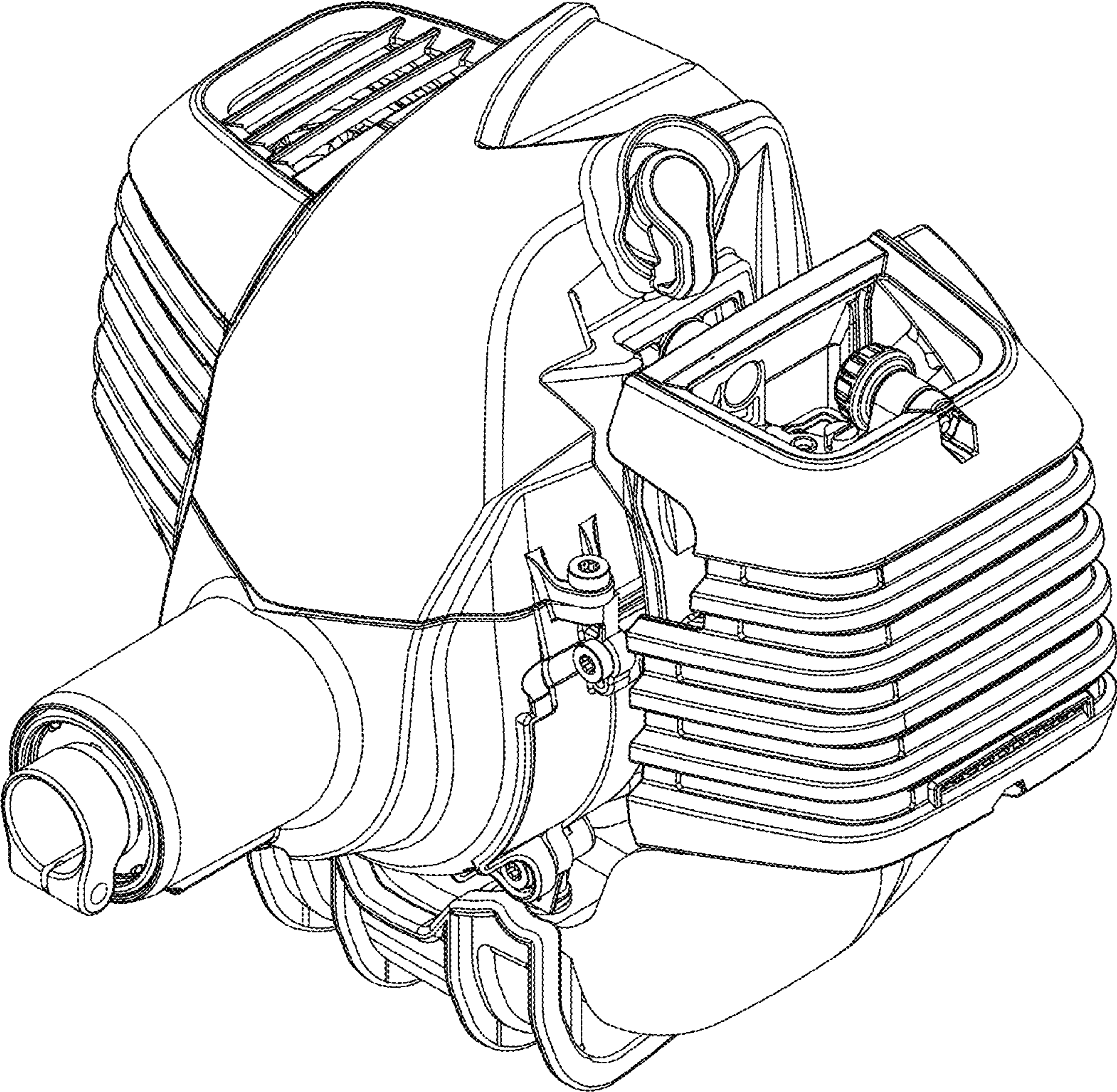

FIG. 7

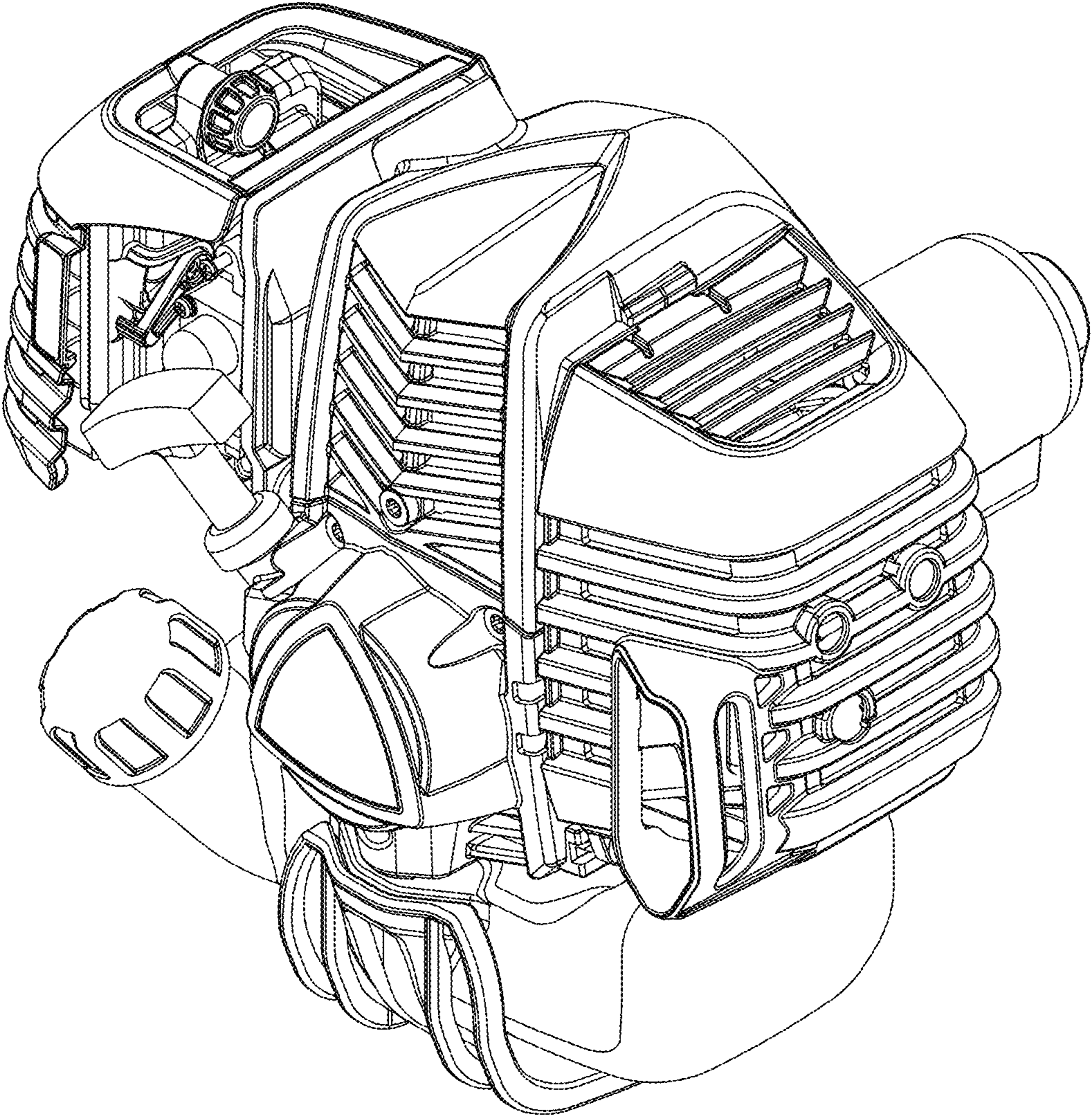

FIG. 8