



US00D787442S

(12) **United States Design Patent** (10) **Patent No.:** **US D787,442 S**
Tio et al. (45) **Date of Patent:** **** May 23, 2017**

(54) **INDUSTRIAL CONTROL COMPONENT INTERFACE**

(71) Applicant: **ROCKWELL AUTOMATION ASIA PACIFIC BUSINESS CENTER PTE. LTD.**, Singapore (SG)

(72) Inventors: **Donald Yuen Leong Tio**, Singapore (SG); **Scott Peter Miles**, Belgium, WI (US); **Jimmy See Yong Koh**, Singapore (SG)

(73) Assignee: **ROCKWELL AUTOMATION ASIA PACIFIC BUSINESS CENTER PTE. LTD.**, Singapore (SG)

(**) Term: **14 Years**

(21) Appl. No.: **29/513,026**

(22) Filed: **Dec. 24, 2014**

Related U.S. Application Data

(63) Continuation of application No. 29/432,413, filed on Sep. 14, 2012, now Pat. No. Des. 722,019.

(51) **LOC (10) Cl.** **13-03**

(52) **U.S. Cl.**
USPC **D13/110**

(58) **Field of Classification Search**
USPC D13/110, 101, 123, 184, 199; D15/3-6, D15/14, 17, 149; 307/150-152;
(Continued)

(56) **References Cited**

U.S. PATENT DOCUMENTS

D449,817 S 10/2001 Takeuchi et al.
D527,349 S 8/2006 Lee
(Continued)

FOREIGN PATENT DOCUMENTS

TW D147004 5/2012
TW D148492 8/2012

OTHER PUBLICATIONS

Taiwan Examination Report dated Oct. 25, 2013.
Taiwan Examination Report dated Mar. 19, 2014.

Primary Examiner — Ian Simmons

Assistant Examiner — Khawaja Anwar

(74) *Attorney, Agent, or Firm* — Fletcher Yoder, P.C.

(57) **CLAIM**

The ornamental design for an industrial control component interface, as shown and described.

DESCRIPTION

FIG. 1 is a top perspective view of an industrial control component interface, showing our new design; FIG. 2 is a front side elevational view thereof; FIG. 3 is a rear side elevational view thereof; FIG. 4 is a right side elevational view thereof; FIG. 5 is a left side elevational view thereof; FIG. 6 is a top plan view thereof; FIG. 7 is a bottom plan view thereof; FIG. 8 is a bottom perspective view of a disassembled top portion of an industrial control component interface; FIG. 9 is a right side elevational view thereof; FIG. 10 is a left side elevational view thereof; FIG. 11 is a front side elevational view thereof; FIG. 12 is a rear side elevational view thereof; FIG. 13 is a bottom plan view thereof; FIG. 14 is a top perspective view of a disassembled bottom portion of an industrial control component interface; FIG. 15 is a right side elevational view thereof; FIG. 16 is a left side elevational view thereof; FIG. 17 is a top plan view thereof; FIG. 18 is a front side elevational view thereof; and, FIG. 19 is a rear side elevational view thereof.

In the drawings, the solid lines illustrate the claimed ornamental design, whereas the broken lines illustrate environmental features that form no part of the claimed ornamental design. The dash-dot line represents the boundary of the claim and forms no part of the claimed design.

1 Claim, 9 Drawing Sheets

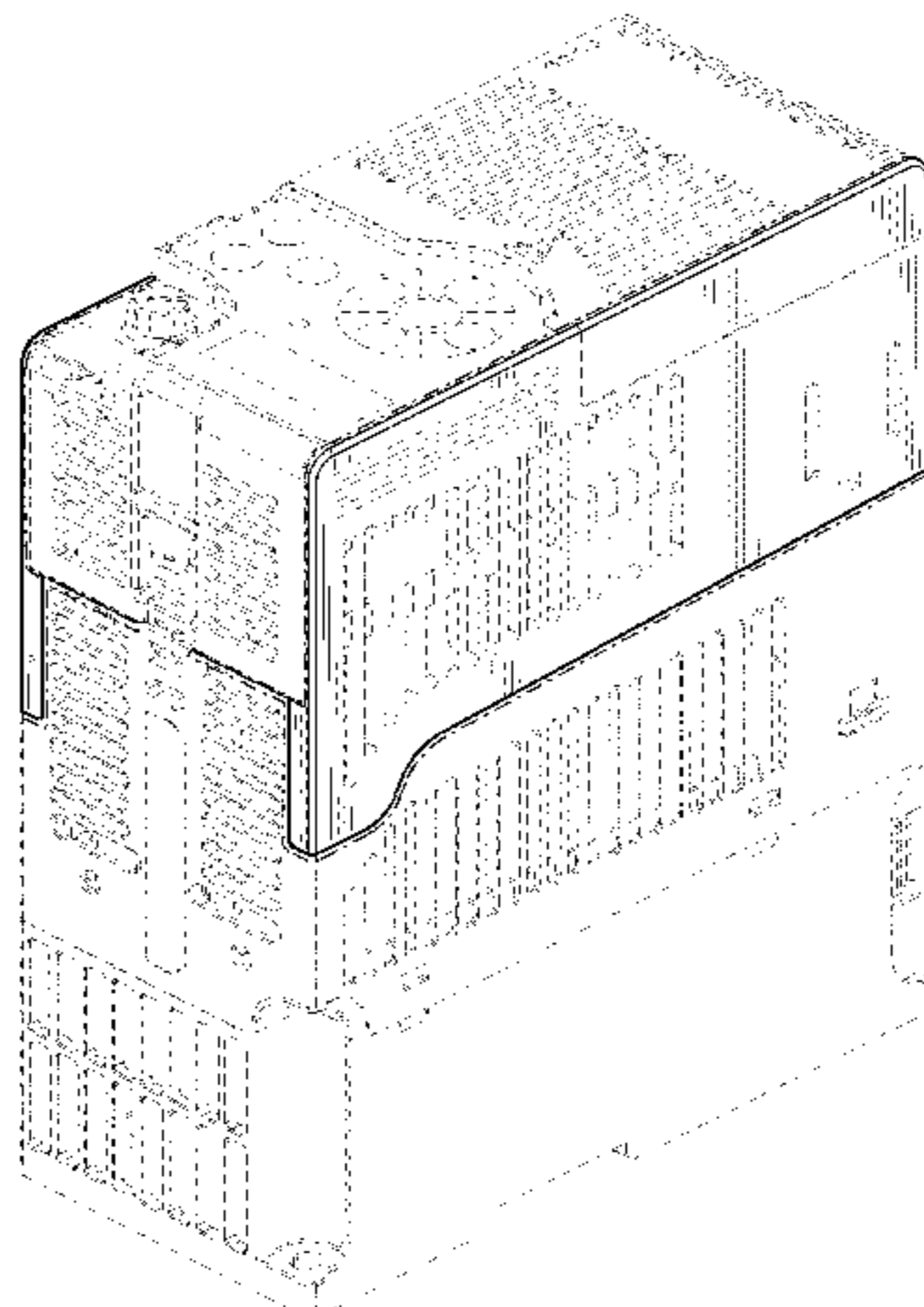

(58) Field of Classification Search

USPC 361/600, 601, 622, 702, 703, 730, 796,
361/809
CPC H01L 2924/00; H01L 2924/0002; H01L
2924/13055; H01L 2924/1305; H01L
2924/13091; H01L 2924/00013; H01L
2224/48091; H01L 2924/181; H01L
2924/00014; H01L 2224/48247; H01L
2924/00012; H01L 2924/1306; H01L
23/473; H01L 2224/16227; H01L
2224/32225; H01L 2224/32245; H01L
2224/4103; H01L 2224/48227; H01L
2224/48463; H01L 2224/4847; H01L
2224/73253; H01L 2225/06513; H01L
2225/06541; H01L 2225/06589; H01L
23/3121; H01L 23/34; H02J 5/005; H02J
3/383; H02J 17/00; H02J 1/00; H02J
7/025; H02J 3/386; H02J 9/06; H02J
1/102; H02J 3/00; H02J 3/385; H02J
7/35; H02J 1/08; H02J 1/10; H02J 1/108;
H02J 2007/0062; H02J 3/381; H02J
3/387; H02J 7/00

See application file for complete search history.

(56)

References Cited

U.S. PATENT DOCUMENTS

D563,317 S	3/2008	Higuchi	
D563,318 S	3/2008	Higuchi	
D609,195 S	2/2010	Yamashita et al.	
D631,436 S	1/2011	Huang et al.	
D654,024 S	2/2012	Choi	
D682,207 S	5/2013	Nakahira et al.	
D692,840 S	11/2013	Liu et al.	
D696,634 S	12/2013	Liu et al.	
D707,176 S	6/2014	Choi	
D722,019 S *	2/2015	Tio	D13/110
D723,463 S *	3/2015	Tio	D13/110
D724,051 S *	3/2015	Nakahira	D13/110
D724,052 S *	3/2015	Nakahira	D14/188
D737,242 S *	8/2015	Nakahira	D13/110
D745,847 S *	12/2015	Ho	D13/110
D755,123 S *	5/2016	Ho	D13/110
D758,969 S *	6/2016	Kato	D13/123
2014/0084837 A1	3/2014	Tio et al.	
2014/0084841 A1	3/2014	Middlestetter et al.	

* cited by examiner

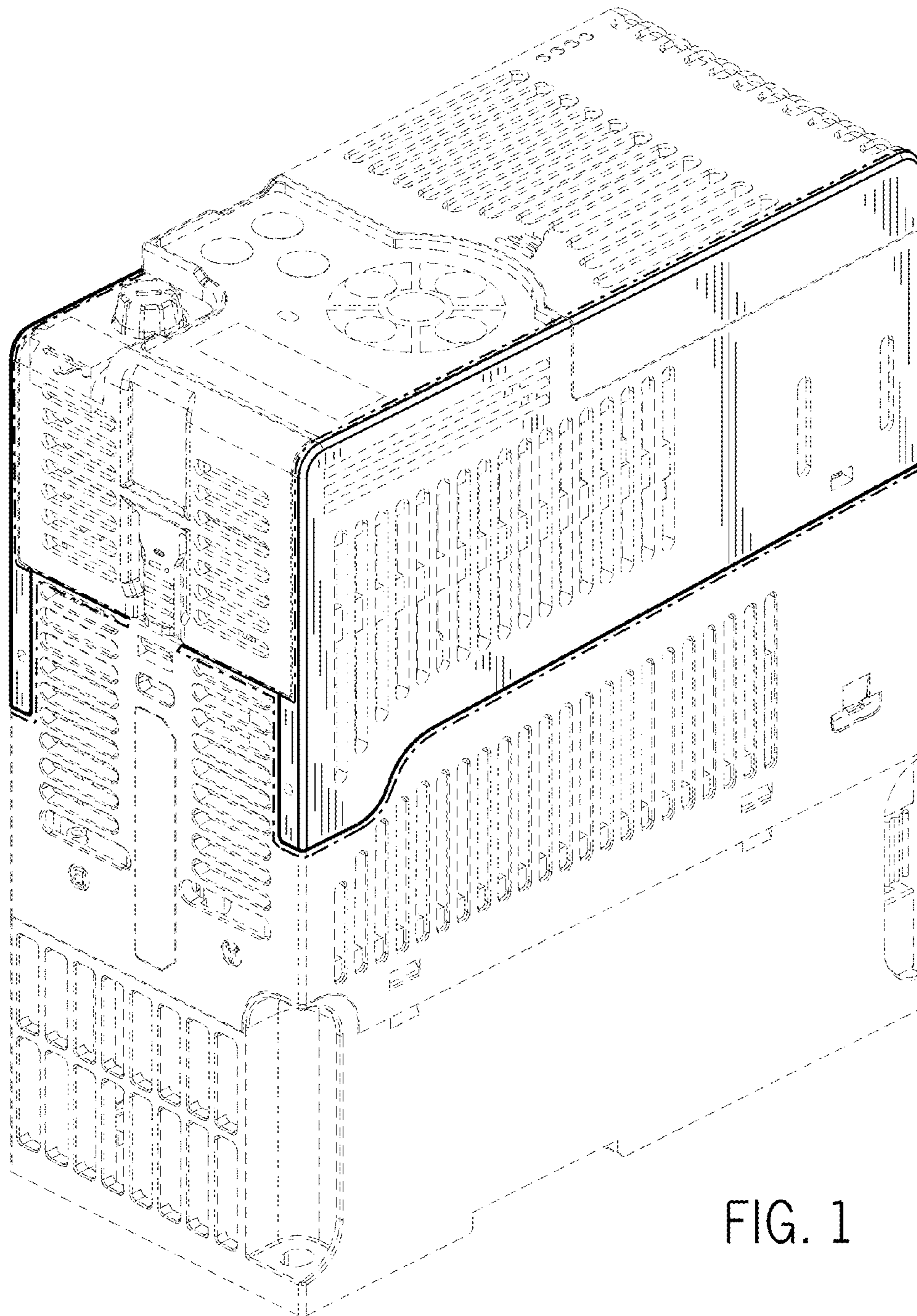

FIG. 1

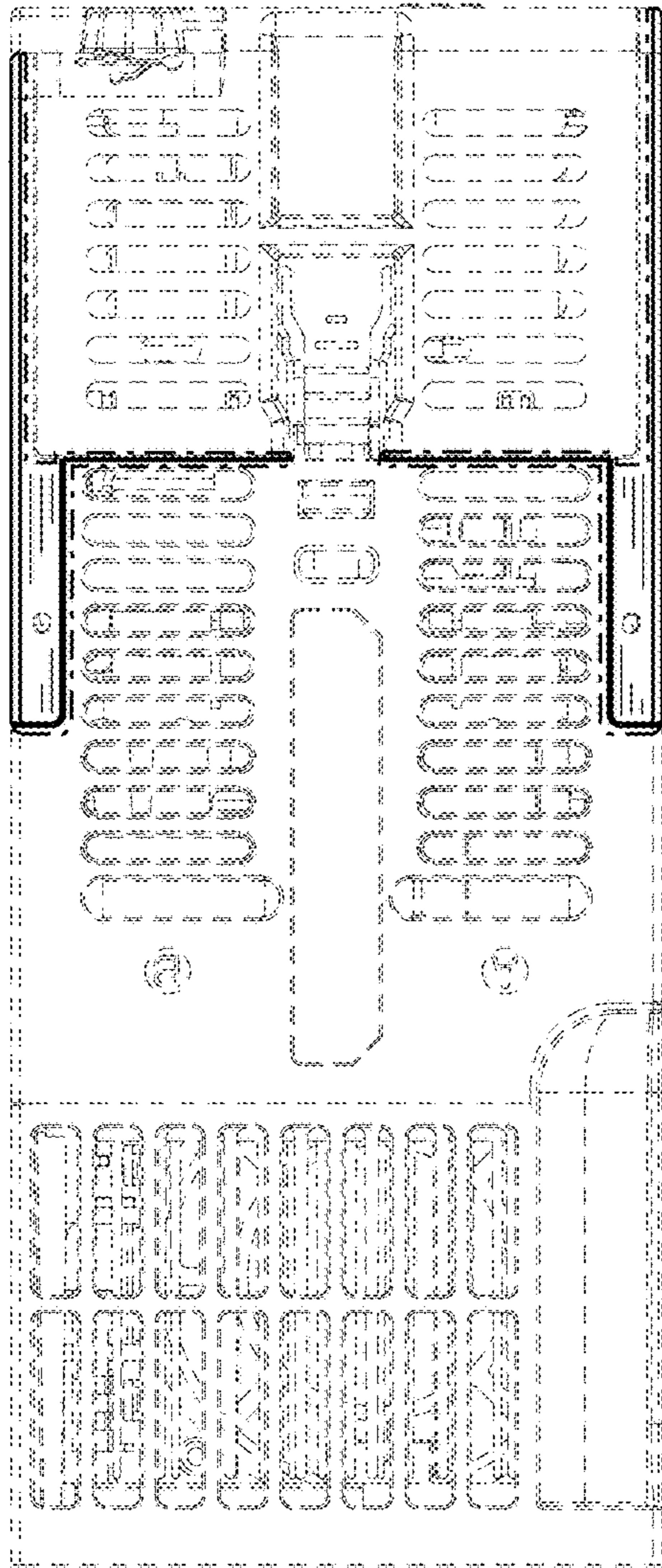

FIG. 2

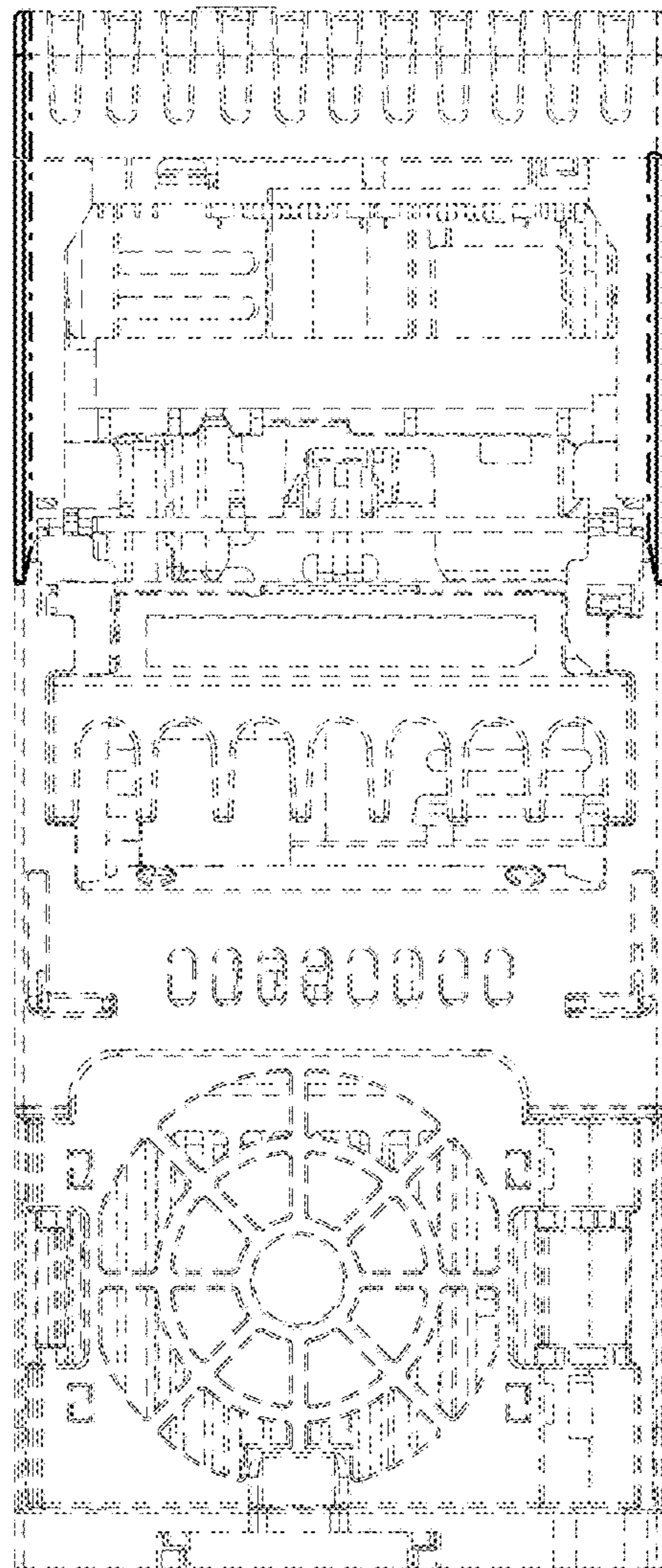

FIG. 3

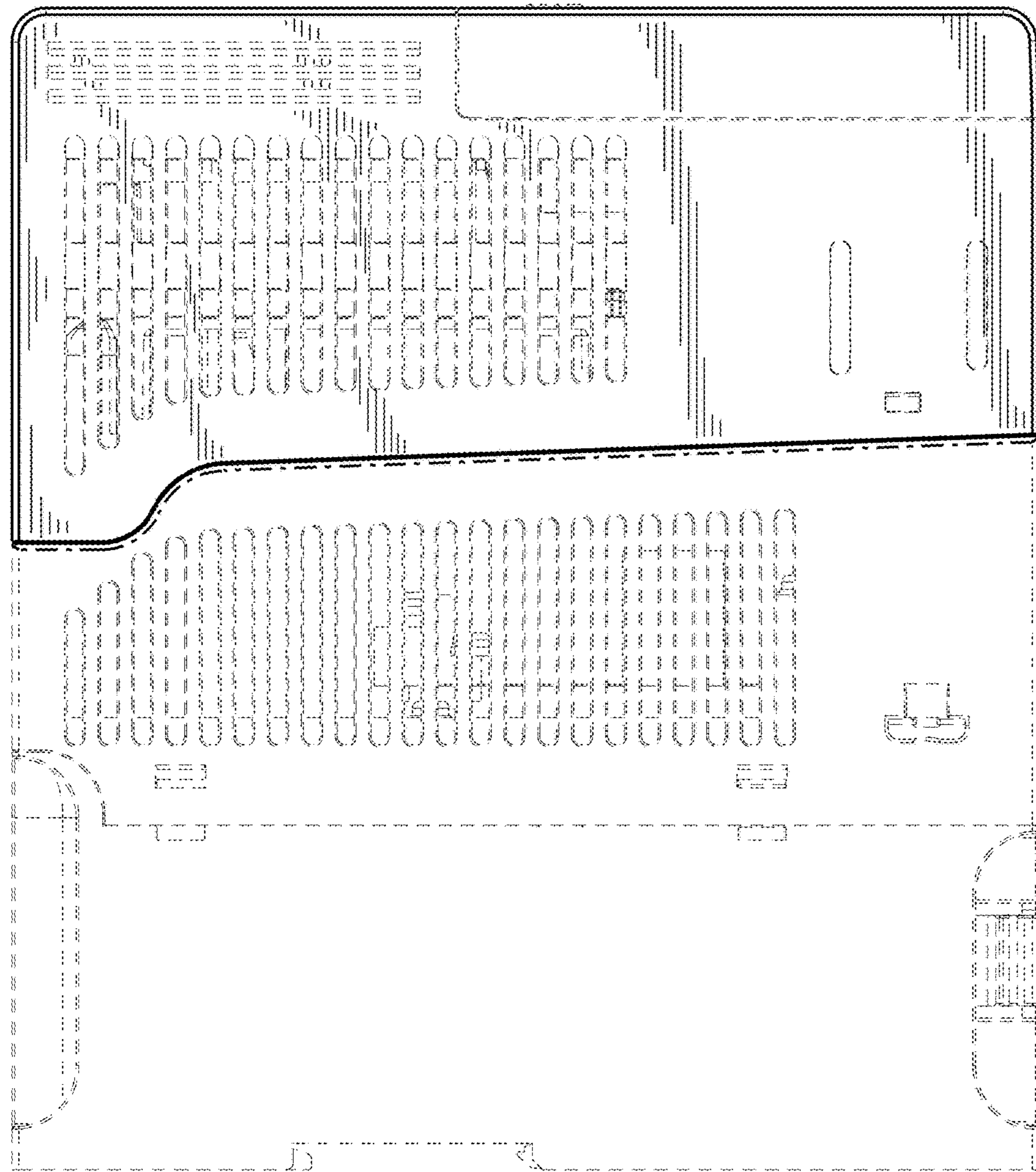

FIG. 4

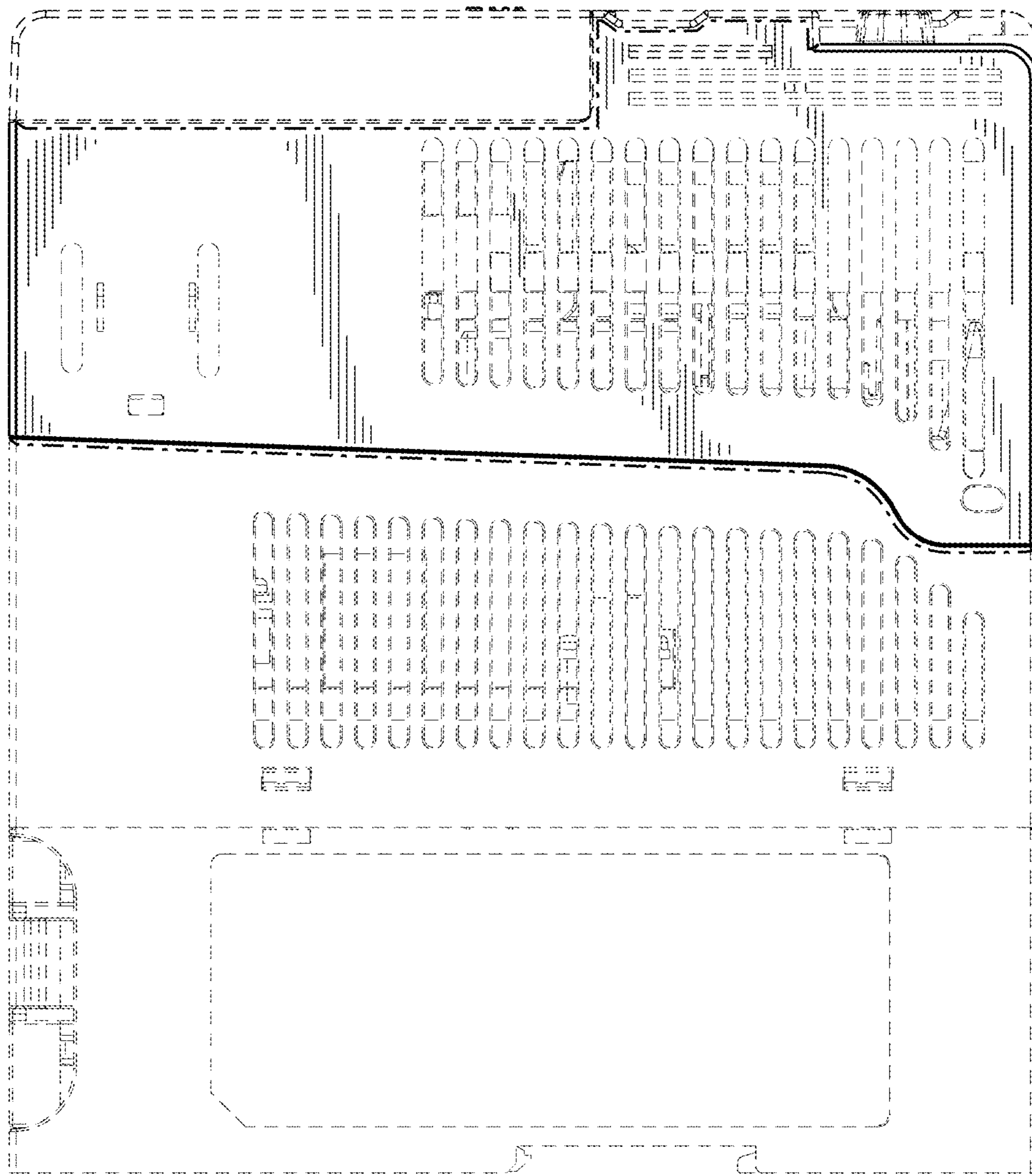

FIG. 5

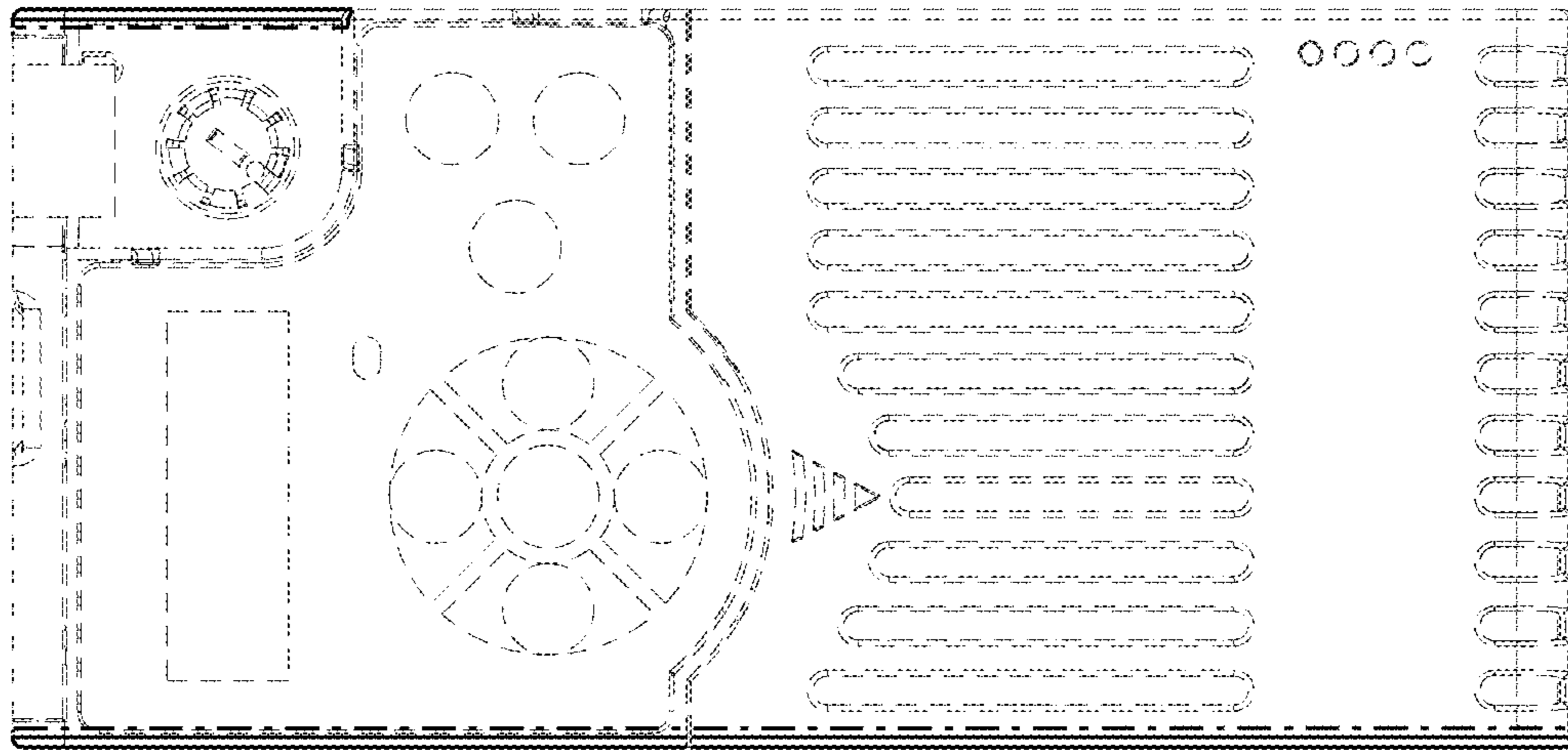

FIG. 6

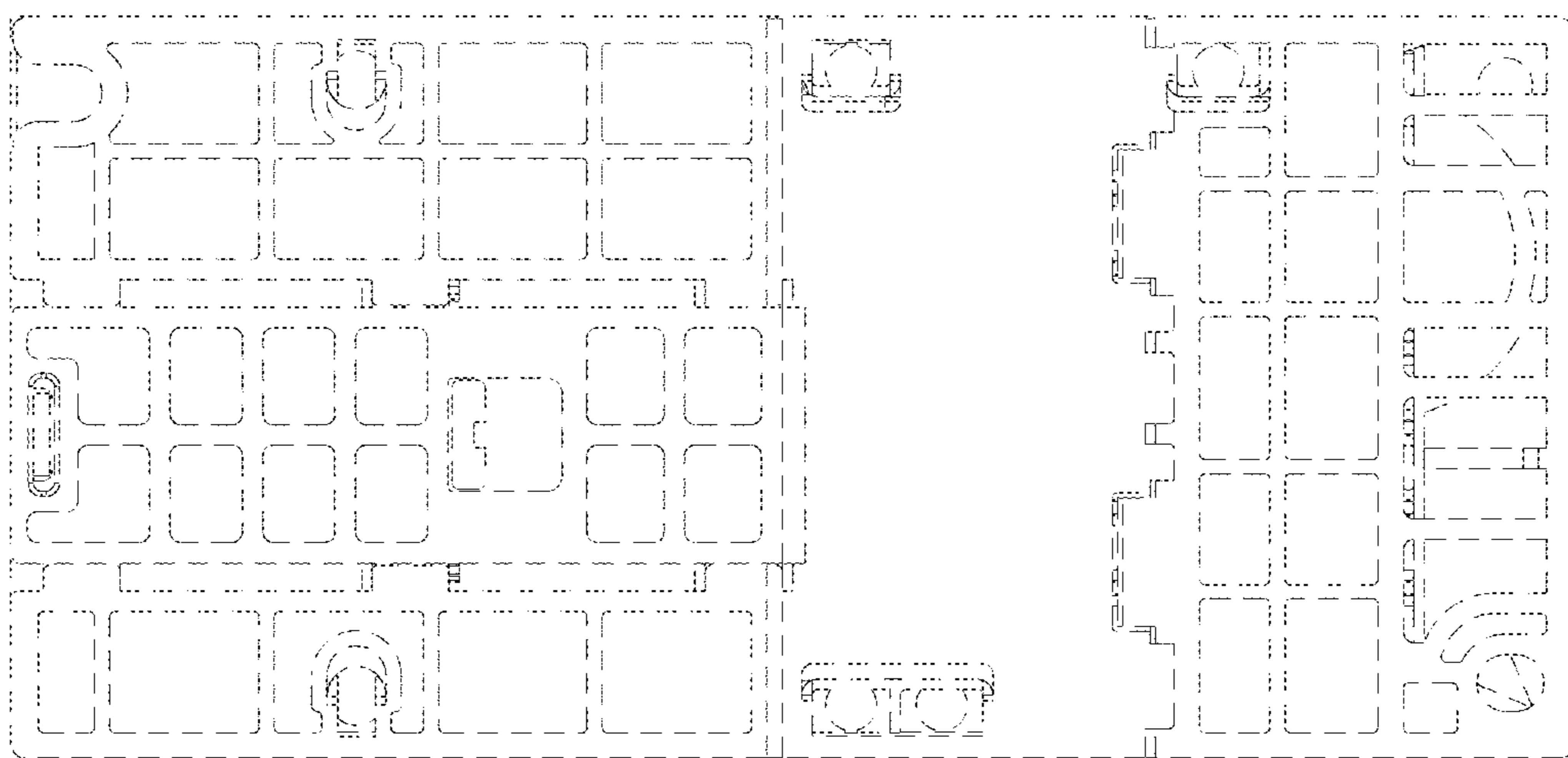

FIG. 7

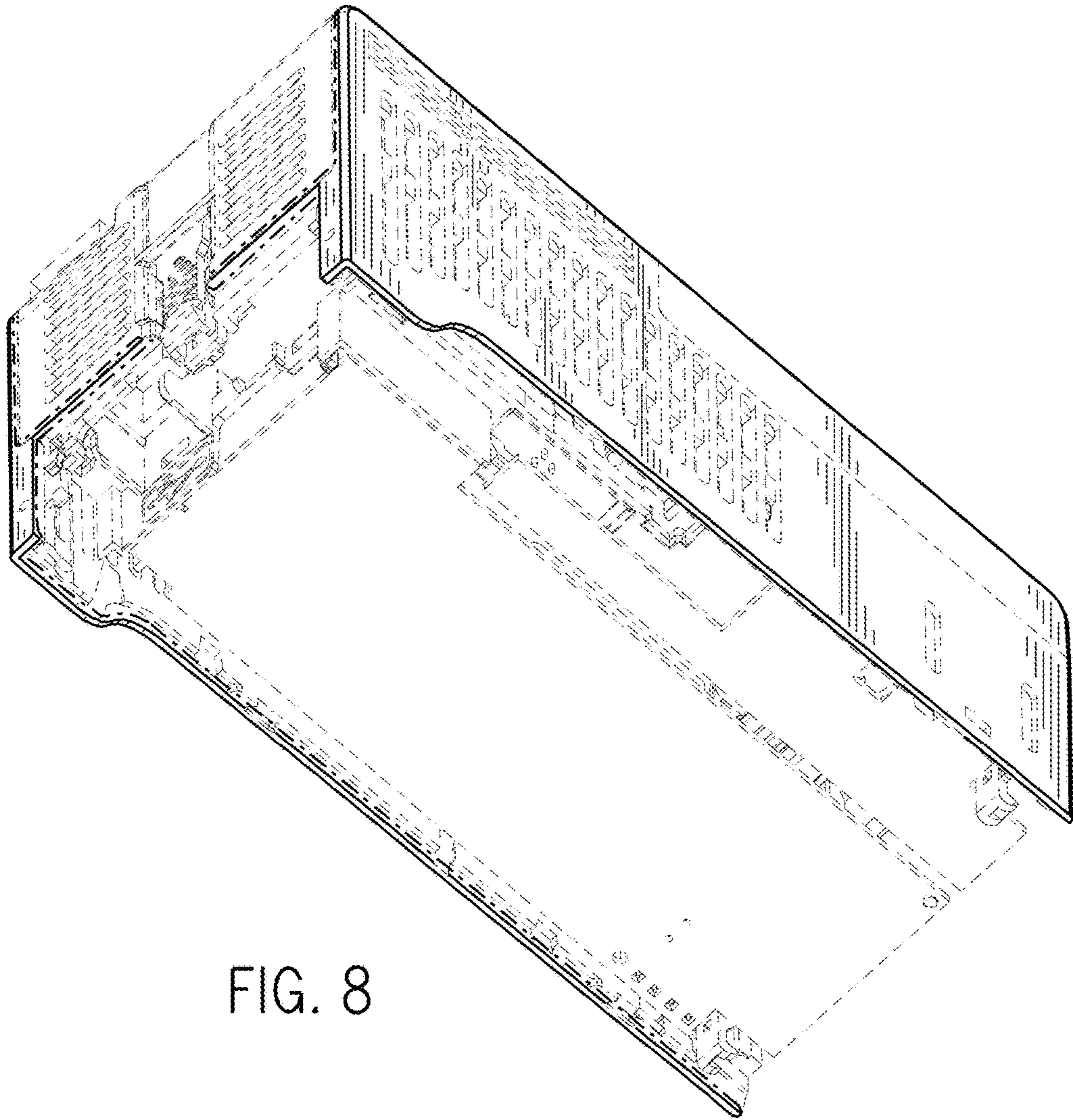



FIG. 9

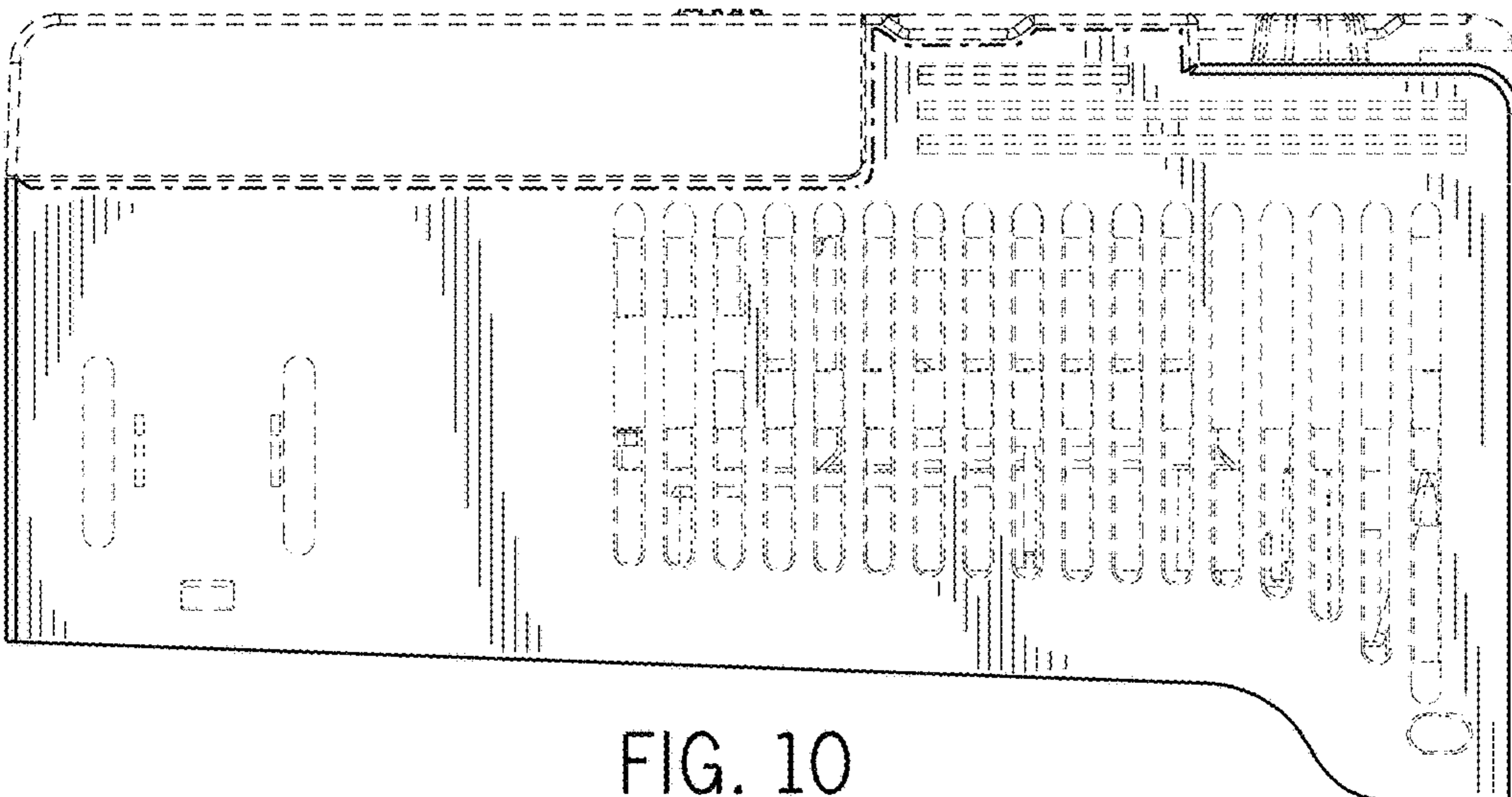

FIG. 10

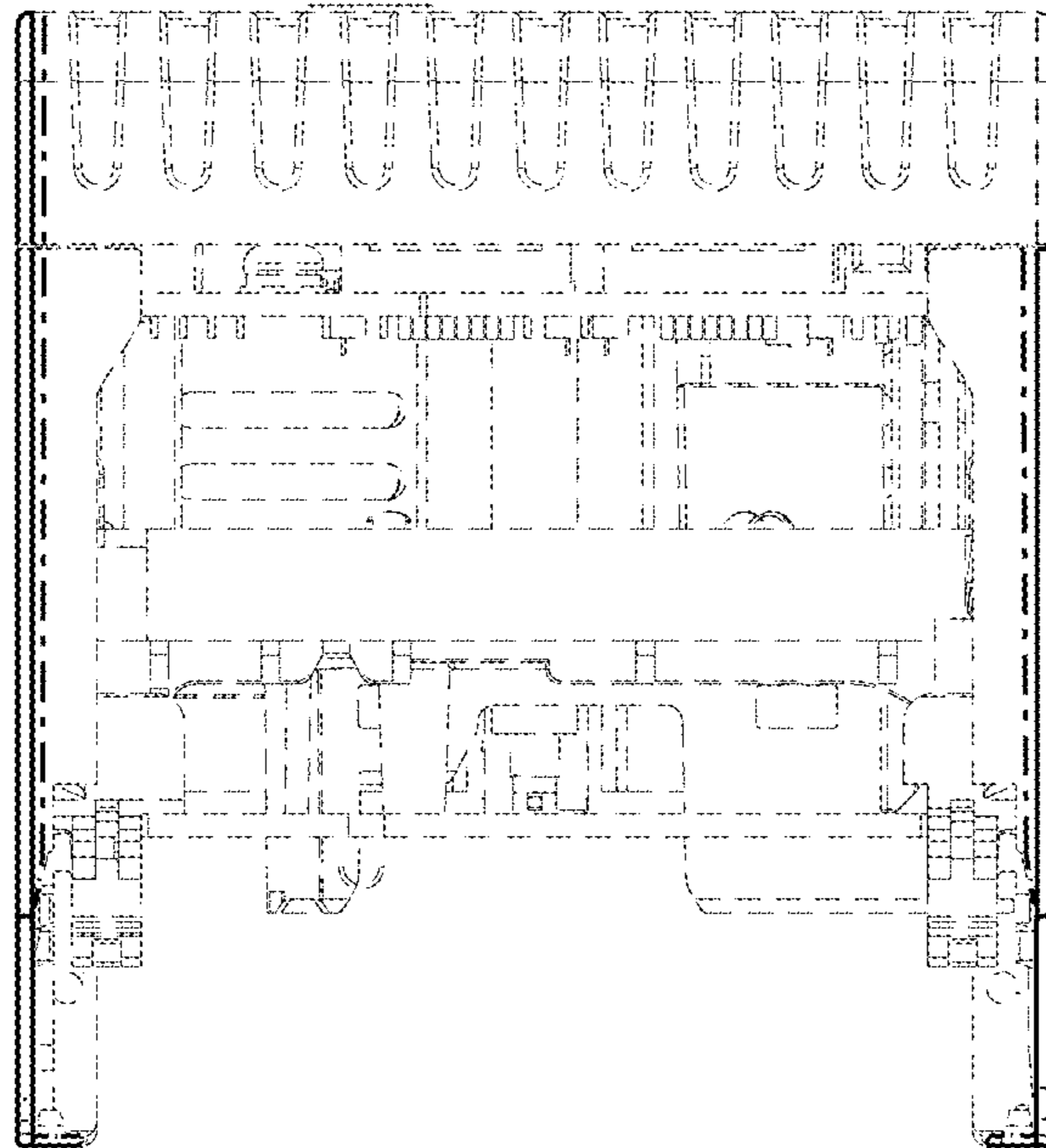

FIG. 11

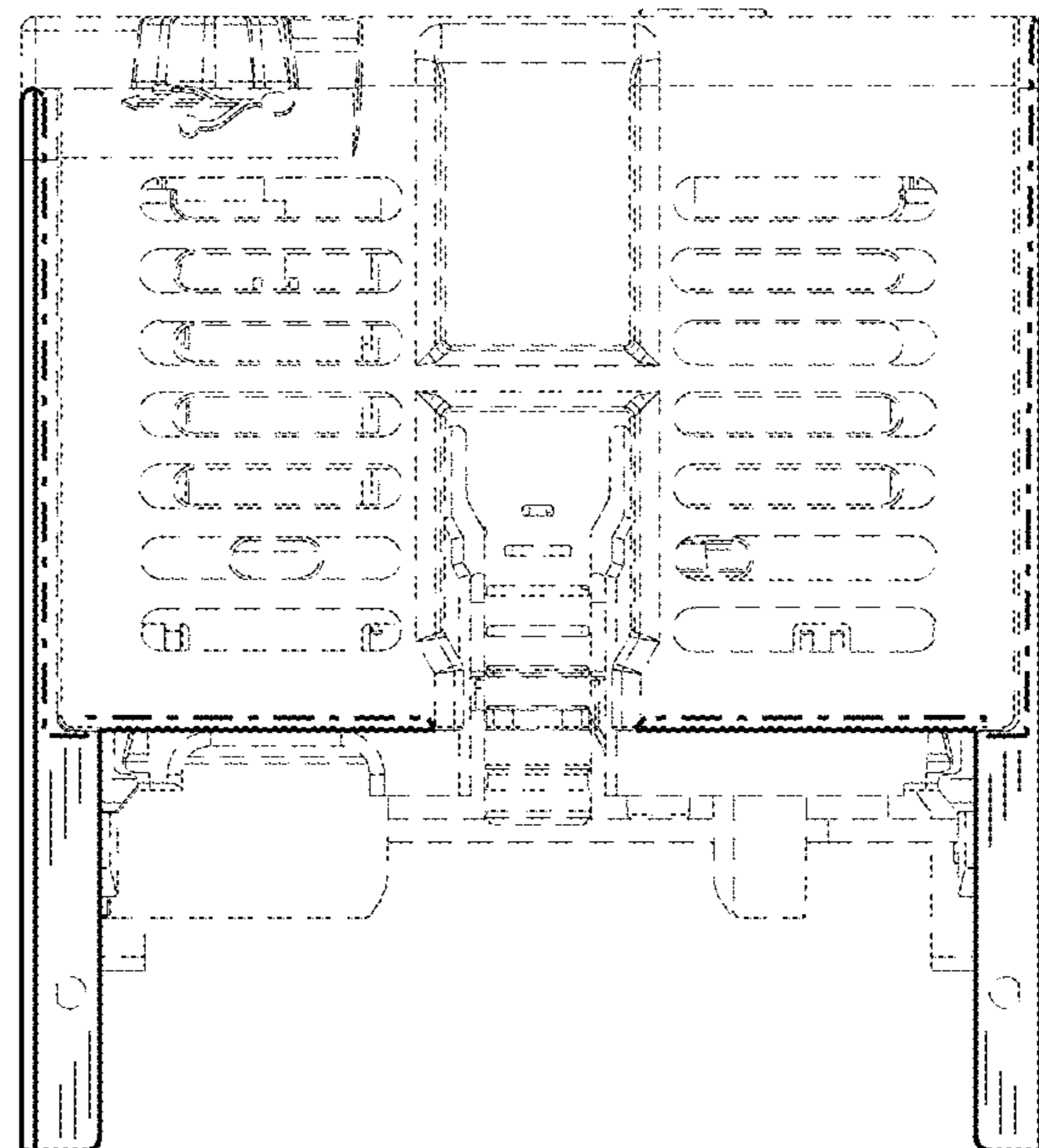

FIG. 12

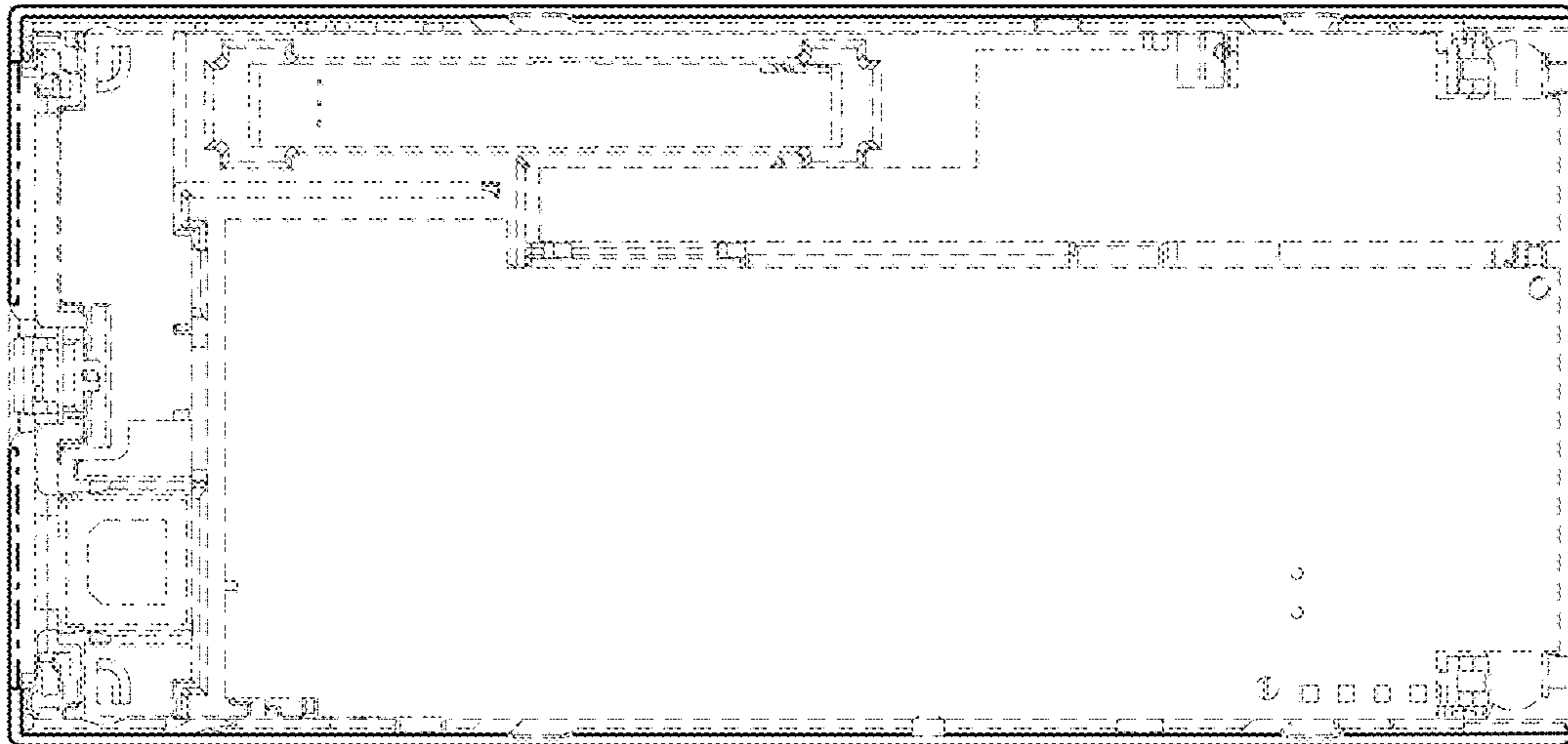

FIG. 13