



US00D786941S

(12) **United States Design Patent**
Kushita

(10) **Patent No.:** **US D786,941 S**

(45) **Date of Patent:** **** May 16, 2017**

(54) **TRACTOR**

(71) Applicant: **Kubota Corporation**, Osaka-shi (JP)

(72) Inventor: **Yoshihiro Kushita**, Sakai (JP)

(73) Assignee: **KUBOTA CORPORATION**, Osaka (JP)

(**) Term: **15 Years**

(21) Appl. No.: **29/563,480**

(22) Filed: **May 5, 2016**

(51) **LOC (10) Cl.** **15-03**

(52) **U.S. Cl.**
USPC **D15/26**

(58) **Field of Classification Search**

USPC D15/10, 14, 15, 22-26, 33; 180/69.2,
180/89.1, 89.12, 900; 56/12.7, 15.8, 16.7,
56/13.3, 10.1, 202, 320.1

CPC A01B 51/026; B62D 49/02; B62D 33/06;
B62D 33/0604; B62D 33/0617; B62D
25/10; B60K 15/063; B60K 15/073;
B60K 2015/0637

See application file for complete search history.

(56) **References Cited**

U.S. PATENT DOCUMENTS

D345,166 S	*	3/1994	Kamlukin	D15/15
D353,146 S	*	12/1994	Yaguchi	D15/15
D363,939 S	*	11/1995	Kato	D15/15
D422,606 S	*	4/2000	Katoh	D15/15
D438,546 S	*	3/2001	Katoh	D15/23
D501,487 S	*	2/2005	Katoh	D15/23

D526,335 S	*	8/2006	Kuwae	D15/23
D547,333 S	*	7/2007	Nishi	D15/15
D553,159 S	*	10/2007	Higashikawa	D15/15
D558,797 S	*	1/2008	Yamamoto	D15/23
D581,953 S	*	12/2008	Matsumoto	D15/15
D598,473 S	*	8/2009	Ferrari	D15/15
D599,826 S	*	9/2009	Kuwae	D15/23
D600,255 S	*	9/2009	Kushita	D15/23
D605,668 S	*	12/2009	Matsumoto	D15/23
D613,313 S	*	4/2010	Bhanuprakash	D15/23
D622,292 S	*	8/2010	Ryczek	D15/15
D678,353 S	*	3/2013	Kakudate	D15/23
D692,463 S	*	10/2013	Matsui	D15/23
D706,837 S	*	6/2014	Takagi	D15/23
D710,911 S	*	8/2014	Iwata	D15/23
D720,369 S	*	12/2014	Furukawa	D15/23
D748,677 S		2/2016	Kushita et al.		
D749,144 S	*	2/2016	Higashikawa	D15/23
D759,128 S	*	6/2016	Yang	D15/23

* cited by examiner

Primary Examiner — Mark Goodwin

(74) *Attorney, Agent, or Firm* — The Webb Law Firm

(57) **CLAIM**

The ornamental design for a tractor, as shown and described.

DESCRIPTION

FIG. 1 is a front view of a tractor showing my new design;
FIG. 2 is a rear view thereof;
FIG. 3 is a left side view thereof;
FIG. 4 is a right side view thereof;
FIG. 5 is a top view thereof;
FIG. 6 is an upper right front perspective view thereof; and,
FIG. 7 is an upper left rear perspective view thereof.

1 Claim, 7 Drawing Sheets

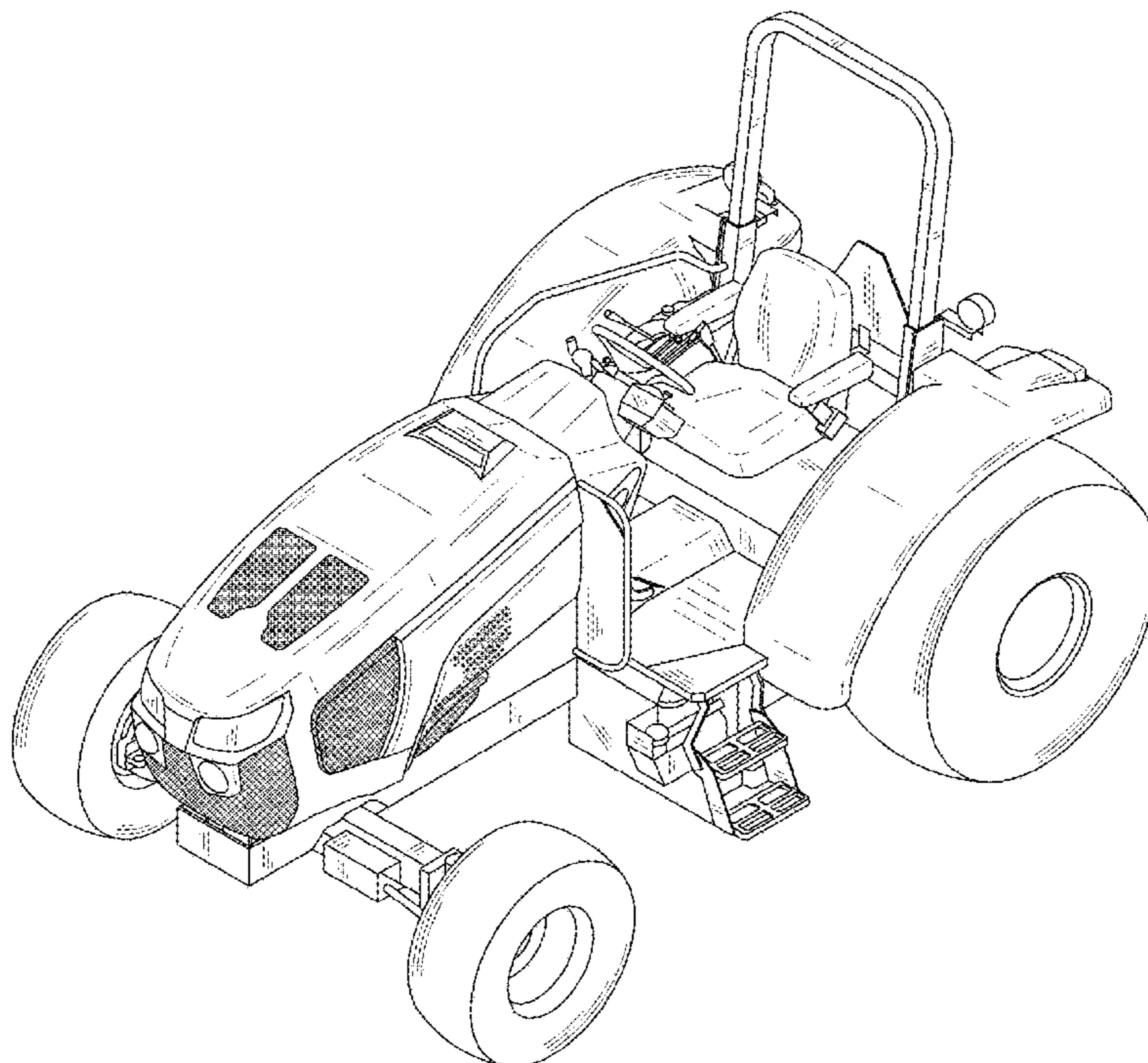

Fig. 1

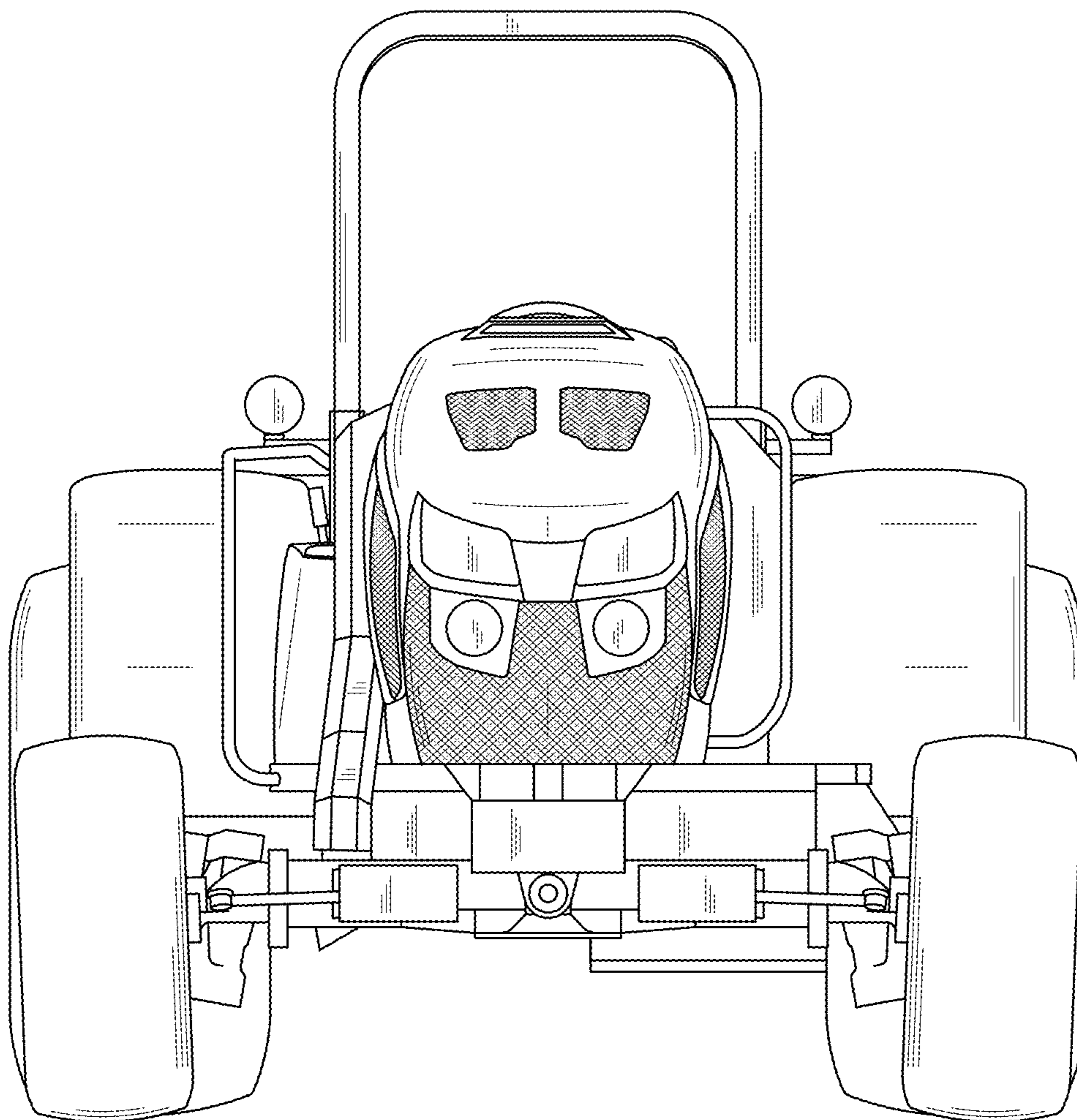

Fig.2

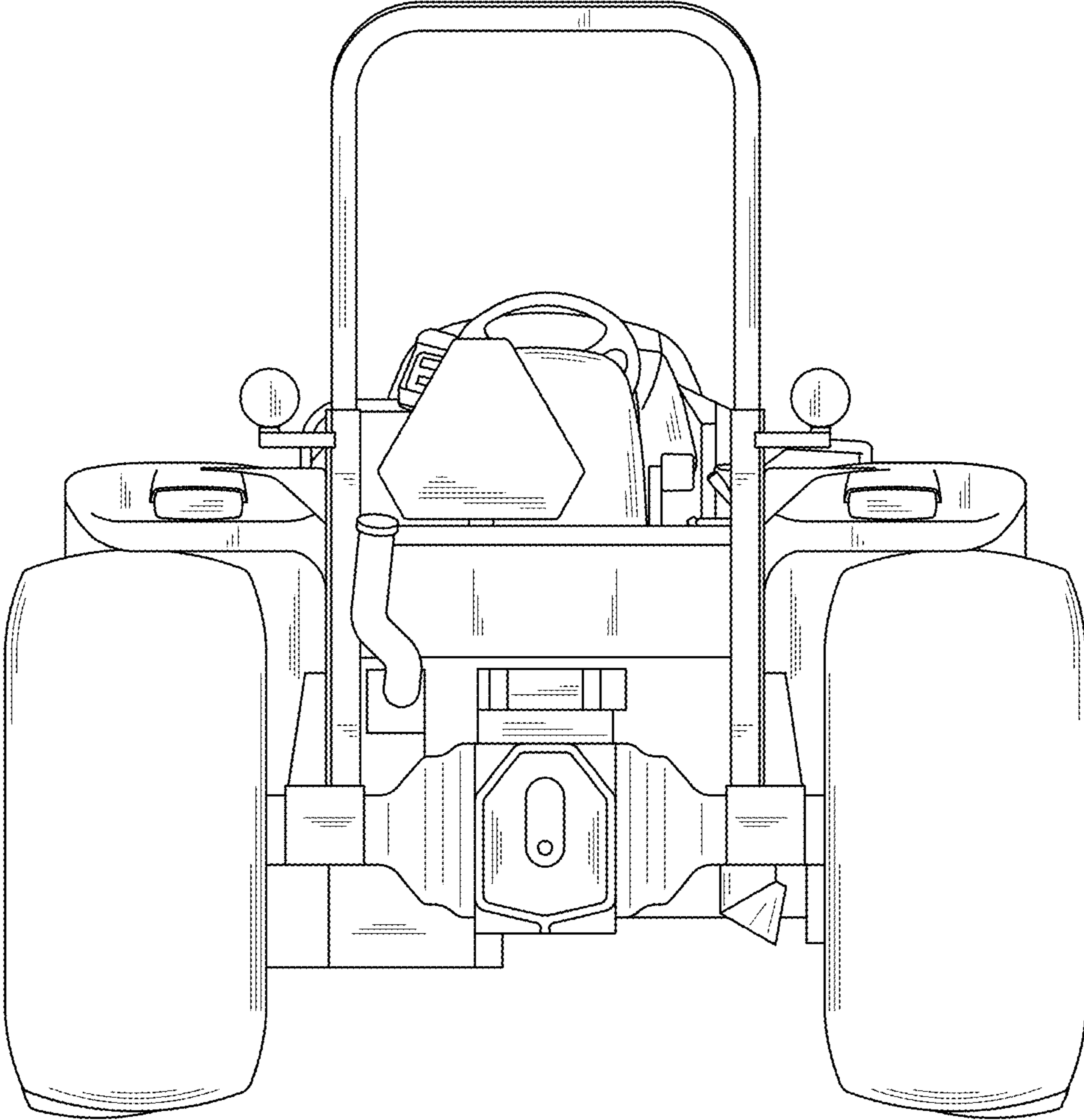

Fig. 3

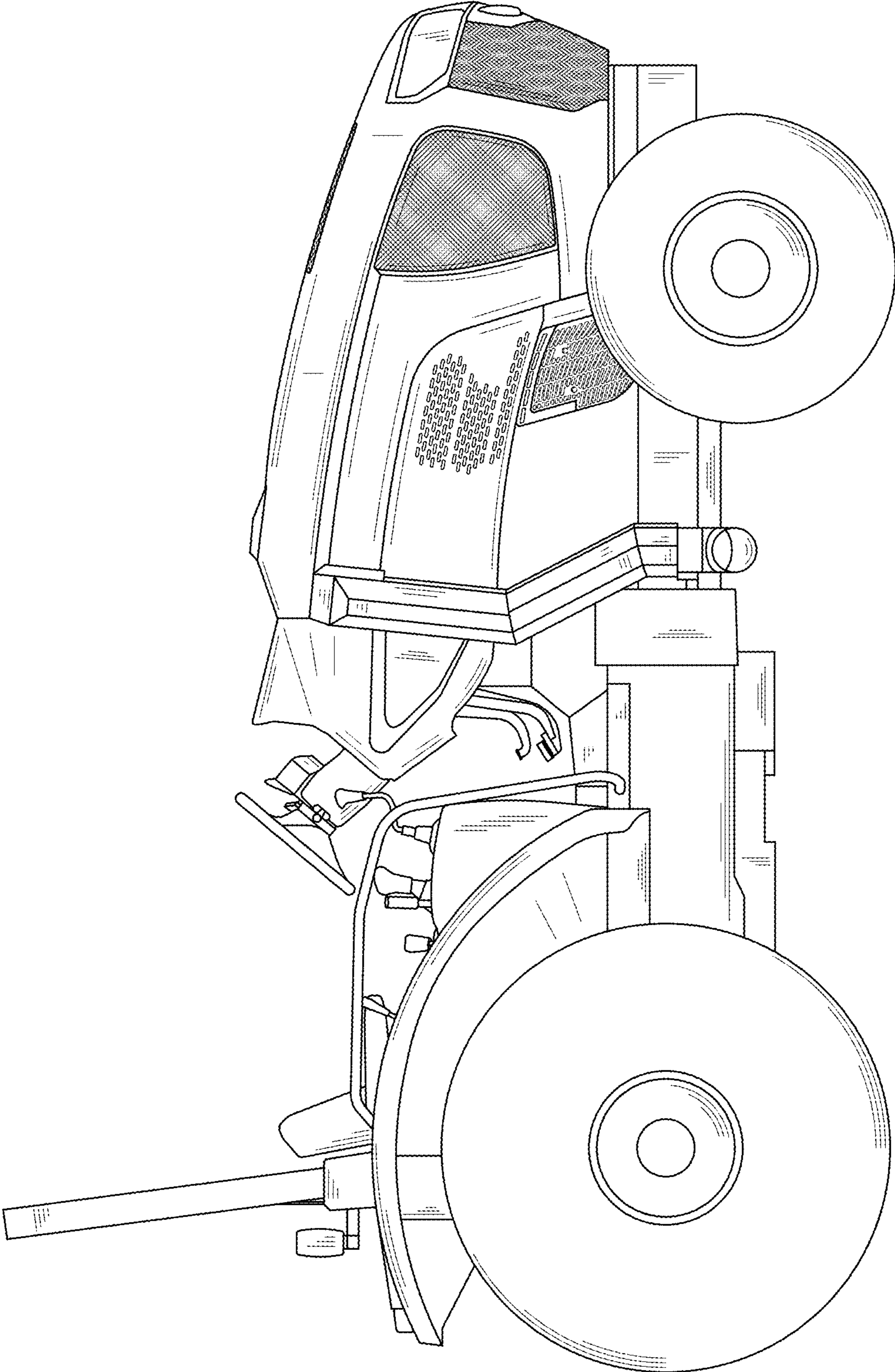

Fig.4

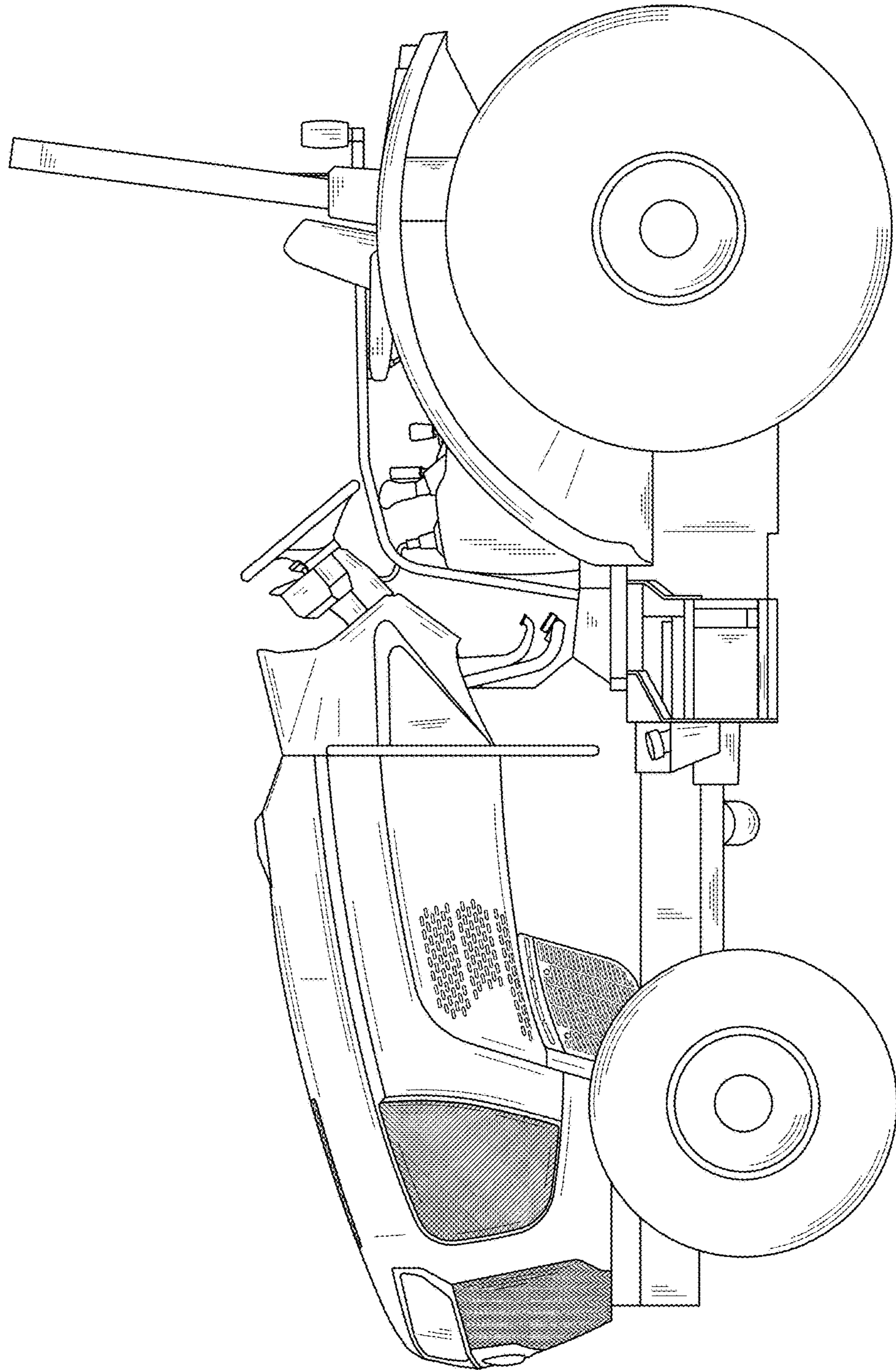
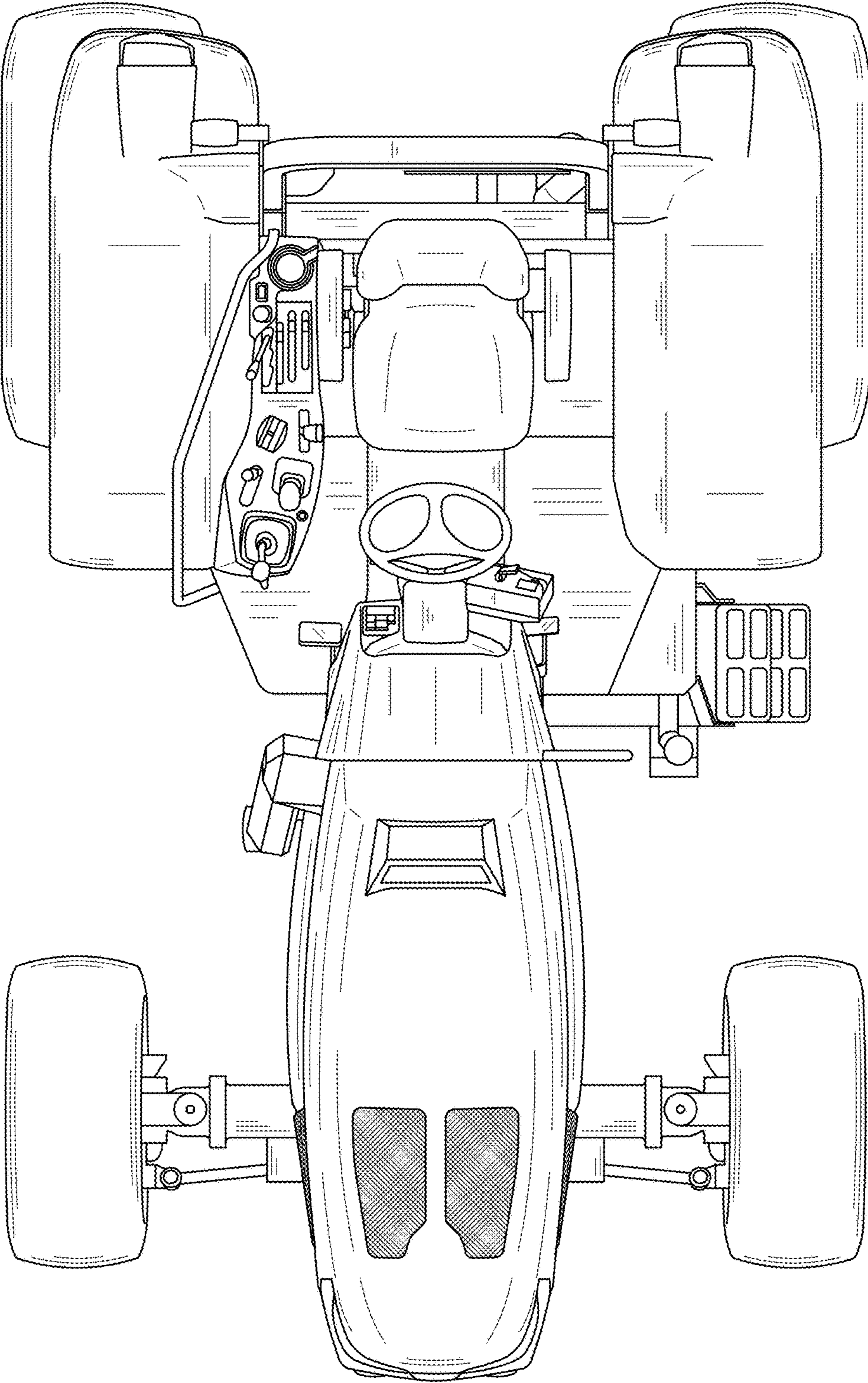

Fig.5



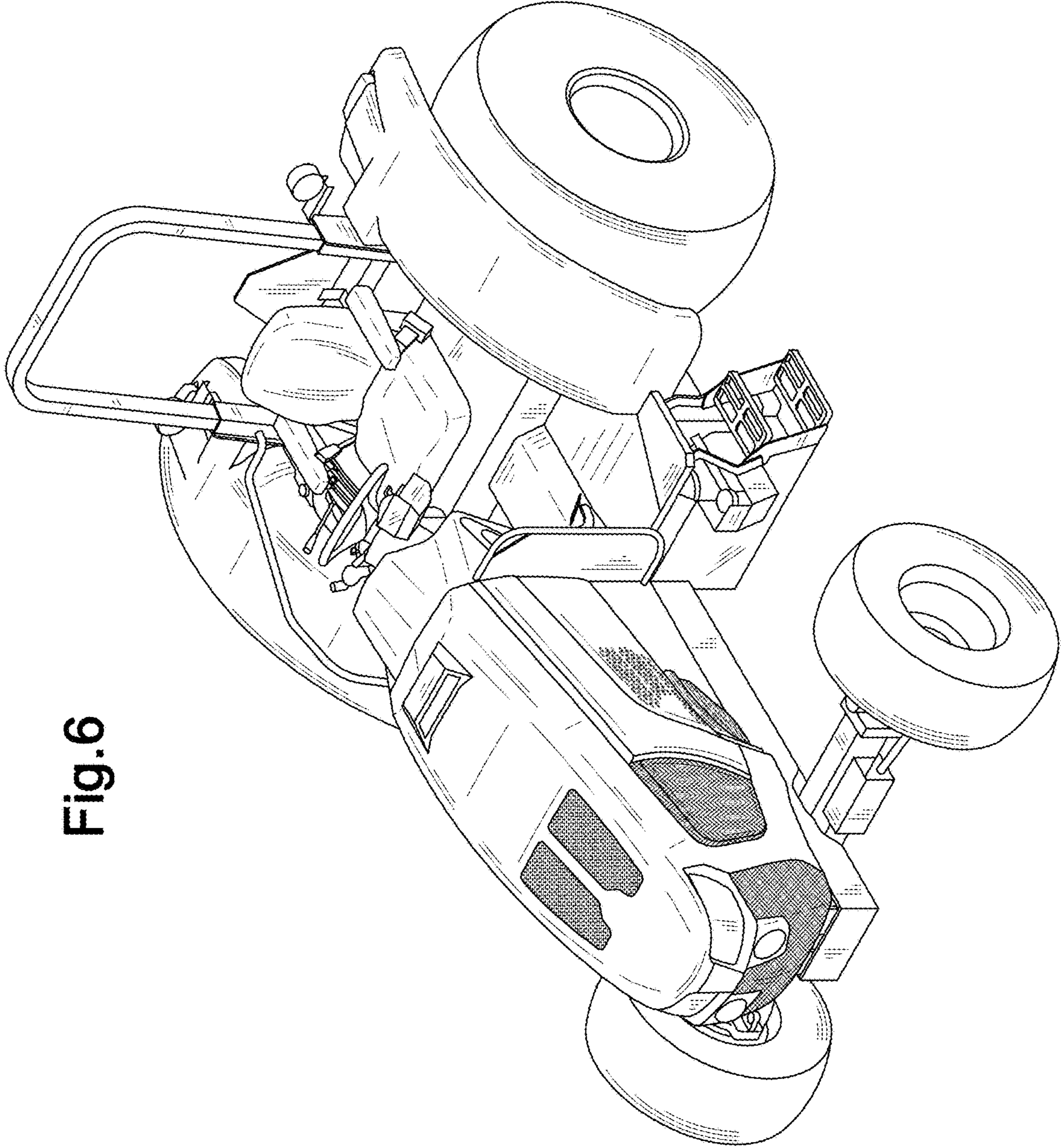

Fig.6

Fig. 7

