



US00D786799S

(12) **United States Design Patent** (10) **Patent No.:** **US D786,799 S**  
**Salomon** (45) **Date of Patent:** **\*\* May 16, 2017**

(54) **ELECTRICAL CONNECTOR DEVICE**

(71) Applicant: **Phoenix Contact GmbH & Co. KG,**  
Blomberg (DE)

(72) Inventor: **Thomas Salomon, Verl** (DE)

(73) Assignee: **PHOENIX CONTACT GMBH & CO.**  
**KG, Blomberg** (DE)

(\*\*) Term: **15 Years**

(21) Appl. No.: **29/547,908**

(22) Filed: **Dec. 9, 2015**

**Related U.S. Application Data**

(62) Division of application No. 29/489,891, filed on May 5, 2014, now Pat. No. Des. 762,582.

(30) **Foreign Application Priority Data**

Nov. 4, 2013	(EM)	002338418-0001
Nov. 4, 2013	(EM)	002338418-0002
Nov. 4, 2013	(EM)	002338418-0003
Nov. 4, 2013	(EM)	002338418-0004
Nov. 4, 2013	(EM)	002338418-0005
Nov. 4, 2013	(EM)	002338418-0006
Nov. 4, 2013	(EM)	002338418-0007
Nov. 4, 2013	(EM)	002338418-0008
Nov. 4, 2013	(EM)	002338418-0009
Nov. 4, 2013	(EM)	002338418-0010
Nov. 4, 2013	(EM)	002338418-0011
Nov. 4, 2013	(EM)	002338418-0012
Nov. 4, 2013	(EM)	002338418-0013
Nov. 4, 2013	(EM)	002338418-0014

(51) **LOC (10) Cl.** ..... **13-03**

(52) **U.S. Cl.**  
USPC ..... **D13/147**

(58) **Field of Classification Search**

USPC ..... D13/146, 147, 154, 156, 184, 199  
CPC .... H01R 4/64; H01R 9/2608; H01R 13/6271;  
H01R 13/5202; H01R 13/5219  
See application file for complete search history.

(56) **References Cited**

**U.S. PATENT DOCUMENTS**

D306,716	S	*	3/1990	Shimirak	.....	D13/147
D408,789	S	*	4/1999	Middlehurst	.....	D13/147
D412,489	S	*	8/1999	Middlehurst	.....	D13/147
D561,708	S	*	2/2008	Anzai	.....	D13/177
D635,519	S	*	4/2011	Hoffman	.....	D13/147
D762,582	S	*	8/2016	Salomon	.....	D13/147
2016/0278228	A1	*	9/2016	Bury	.....	H01R 11/03

\* cited by examiner

*Primary Examiner* — Daniel Bui

(74) *Attorney, Agent, or Firm* — Leydig, Voit & Mayer, Ltd.

(57) **CLAIM**

The ornamental design for an electrical connector device, as shown and described.

**DESCRIPTION**

FIG. 1 is a top, right perspective view of an electrical connector showing my new design;  
FIG. 2 is a top plan view thereof;  
FIG. 3 is a right side elevational view thereof;  
FIG. 4 is a front elevational view thereof;  
FIG. 5 is a left side elevational view thereof;  
FIG. 6 is a rear elevational view thereof; and,  
FIG. 7 is a bottom plan view thereof.

Any broken lines in the drawings illustrate unclaimed subject matter and/or environment and form no part of the claimed design.

**1 Claim, 7 Drawing Sheets**

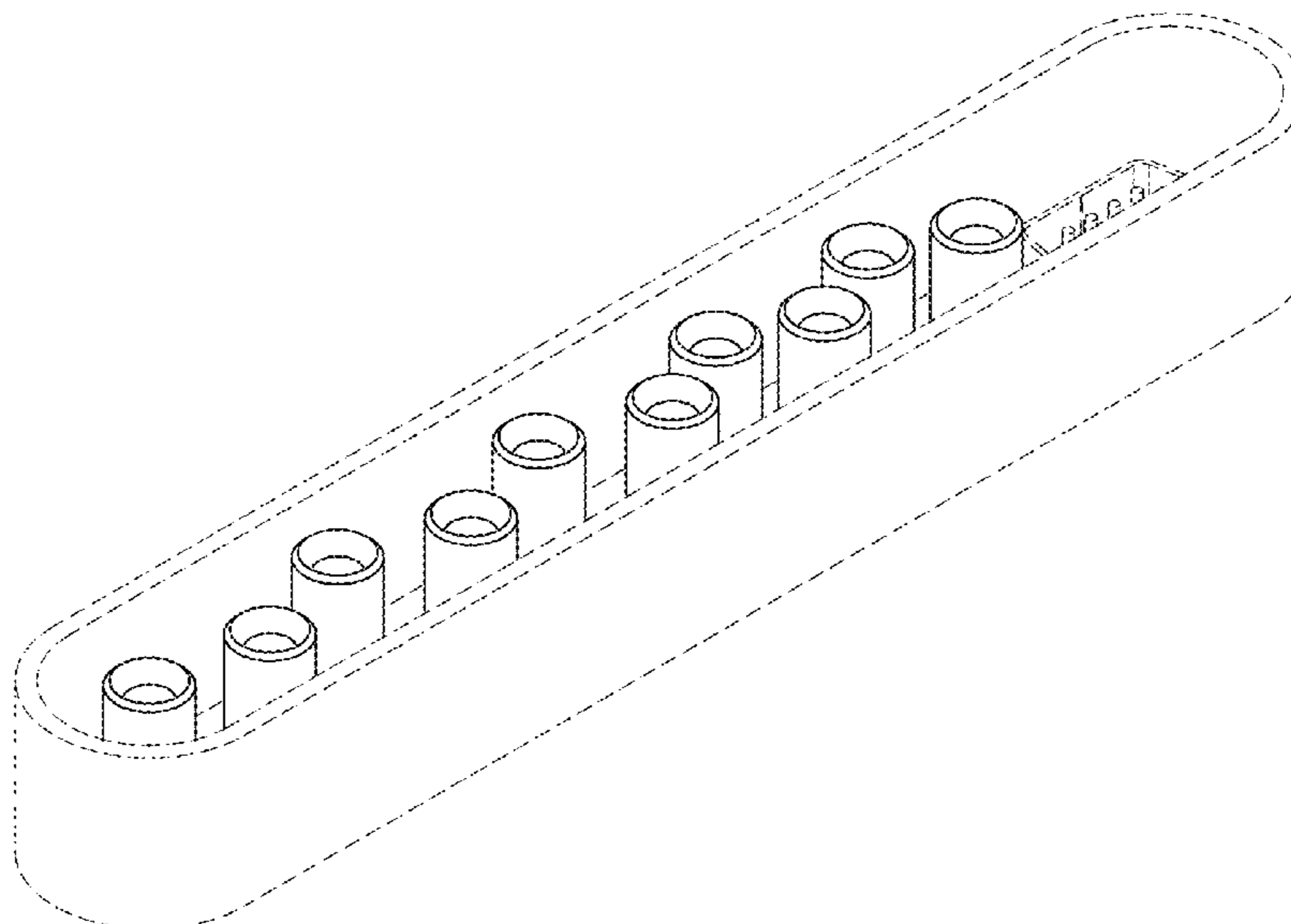

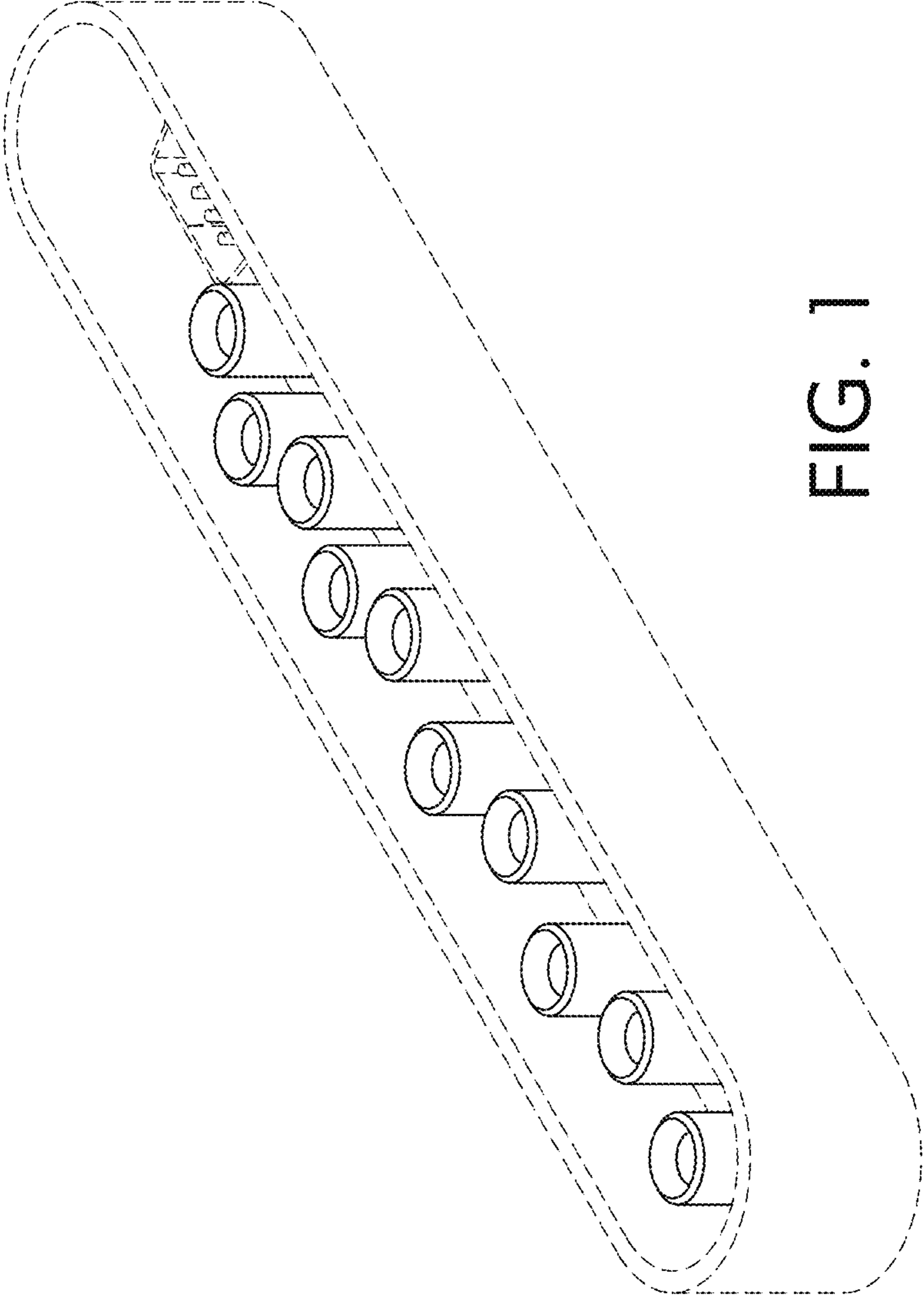

FIG. 1

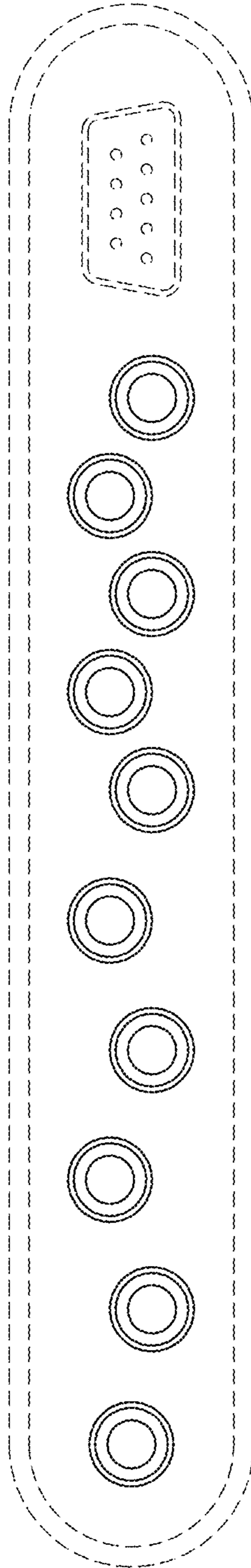

FIG. 2

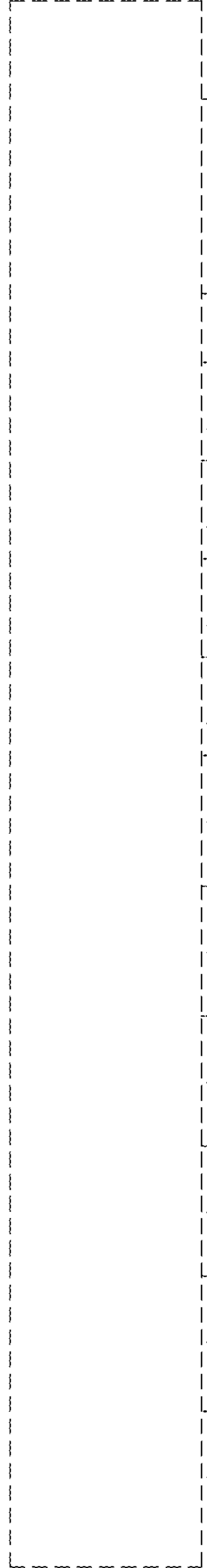

FIG. 3

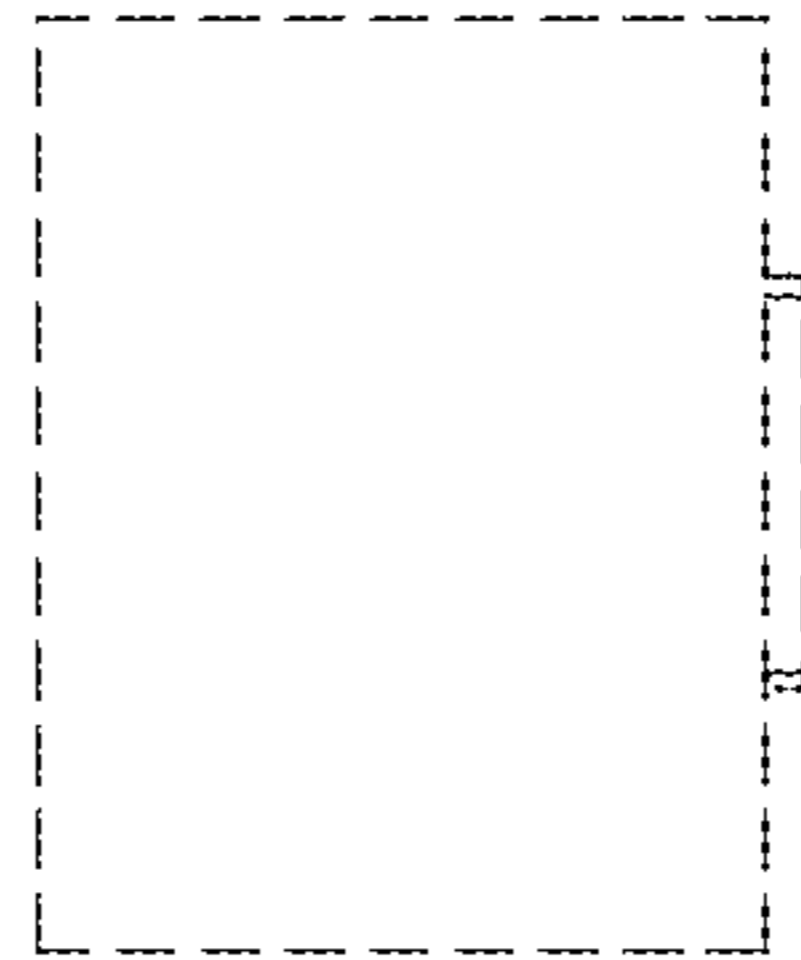

FIG. 4

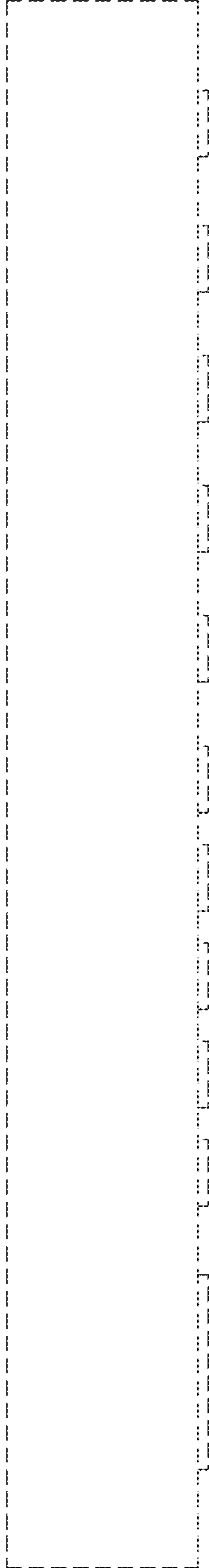

FIG. 5

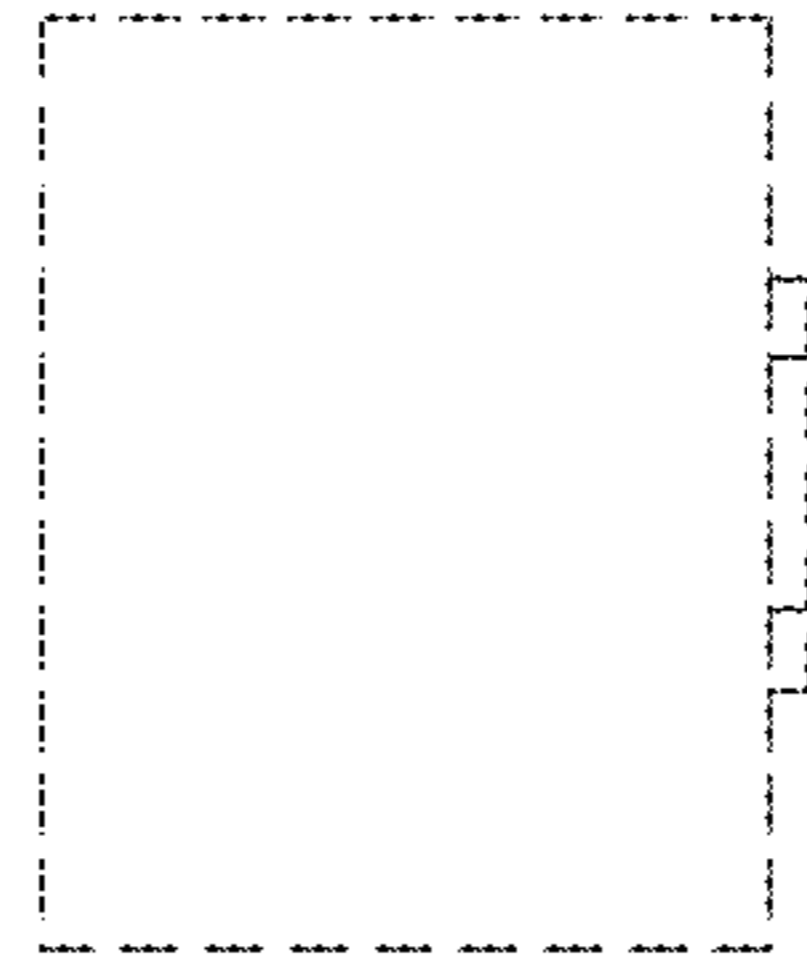

FIG. 6

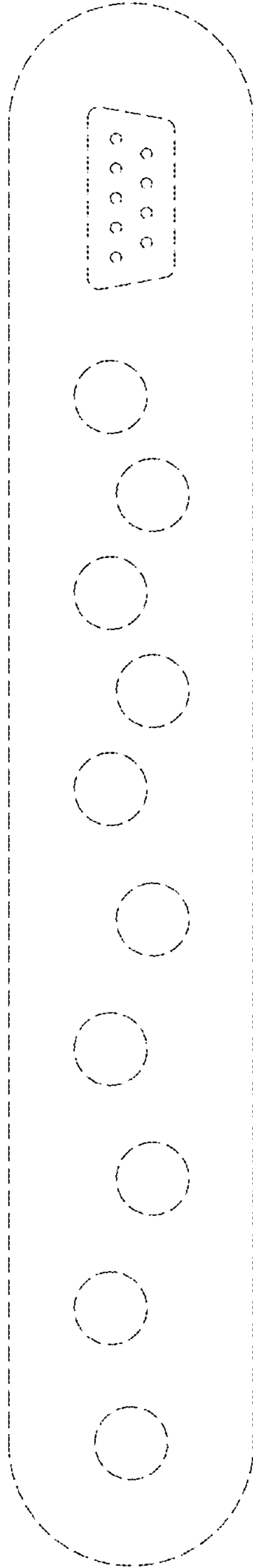

FIG. 7