



US00D786146S

(12) **United States Design Patent** (10) **Patent No.:** **US D786,146 S**
Woodhouse et al. (45) **Date of Patent:** **** May 9, 2017**

(54) **VEHICLE REAR SKID PLATE WITH EXHAUST OUTLET**

(71) Applicant: **Ford Global Technologies, LLC**, Dearborn, MI (US)

(72) Inventors: **David Woodhouse**, Troy, MI (US); **Earl C. Lucas**, Southfield, MI (US); **Jaewoo Chang**, Novi, MI (US)

(73) Assignee: **Ford Global Technologies, LLC**, Dearborn, MI (US)

(**) Term: **15 Years**

(21) Appl. No.: **29/558,706**

(22) Filed: **Mar. 21, 2016**

(51) **LOC (10) Cl.** **12-16**

(52) **U.S. Cl.**
USPC **D12/167**

(58) **Field of Classification Search**
USPC D12/86-92, 163-712; 296/35.2, 193.09, 296/193.1

CPC B60R 19/02; B60R 19/023; B60R 19/18; B60R 19/24; B60R 19/44; B60R 19/56; B60R 2019/527; B60R 2019/1886; B60R 3/00; B62D 21/15

See application file for complete search history.

(56) **References Cited**

U.S. PATENT DOCUMENTS

D599,265 S * 9/2009 Gueler D12/196
D647,445 S * 10/2011 Tonello D12/196

D690,639 S * 10/2013 Messale D12/196
D739,321 S * 9/2015 Blanski D12/169
D746,190 S * 12/2015 Wolff D12/169
D754,041 S * 4/2016 Behmer D12/169
D769,163 S * 10/2016 Platto D12/196
D771,535 S * 11/2016 Wolff D12/169

* cited by examiner

Primary Examiner — Daniel Bui

Assistant Examiner — Andrew Kerr

(74) *Attorney, Agent, or Firm* — Damian Porcari

(57) **CLAIM**

The ornamental design for a vehicle rear skid plate with exhaust outlet, as shown and described.

DESCRIPTION

FIG. 1 is a bottom left perspective view of a vehicle rear skid plate with exhaust outlet, showing our new design; FIG. 2 is a bottom right perspective view thereof; FIG. 3 is a front elevational view thereof; FIG. 4 is a rear elevational view thereof; FIG. 5 is a left side elevational view thereof; FIG. 6 is a right side elevational view thereof; FIG. 7 is a top plan view thereof; and, FIG. 8 is a bottom plan view thereof.

1 Claim, 8 Drawing Sheets

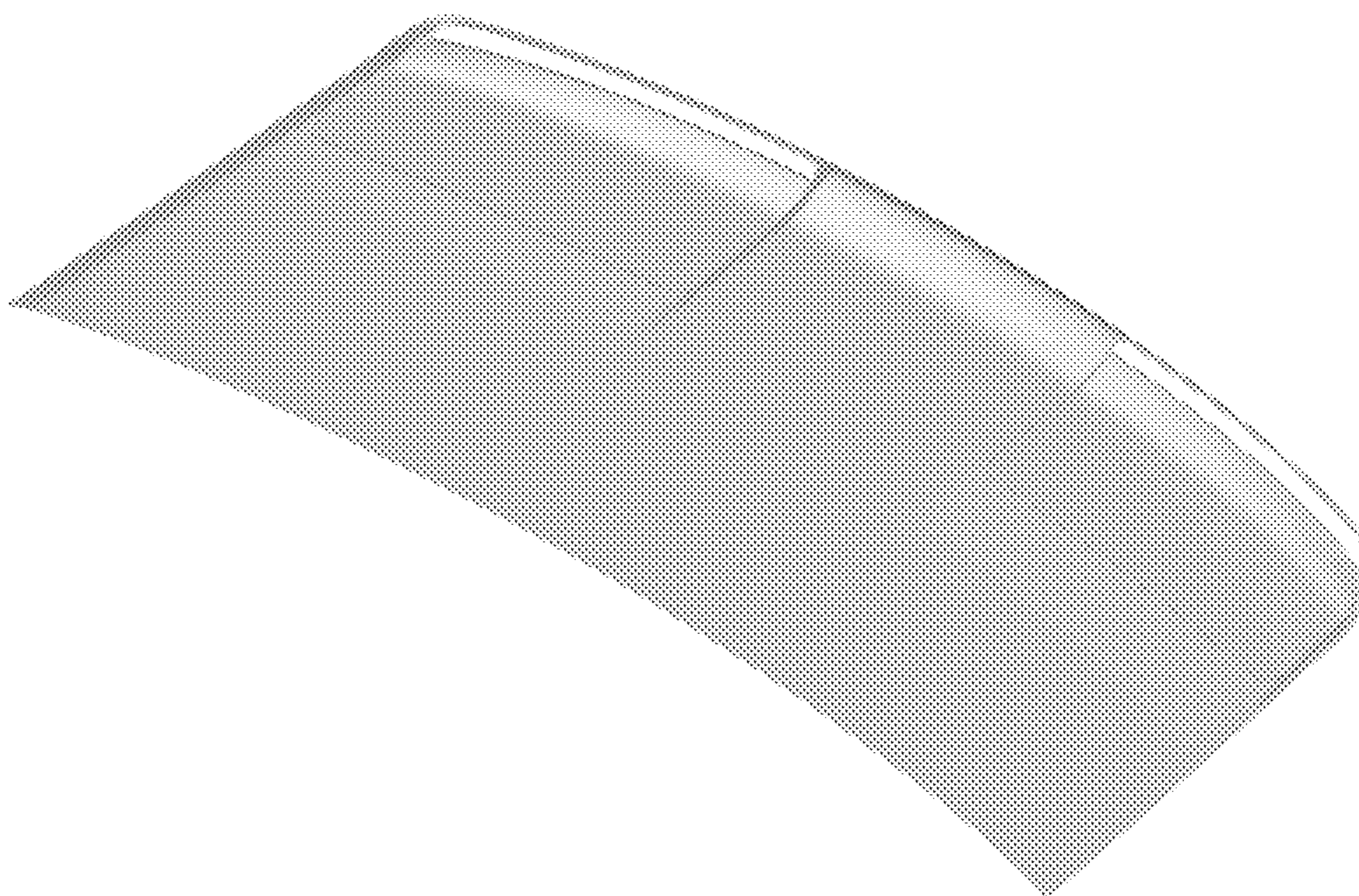

Figure 1



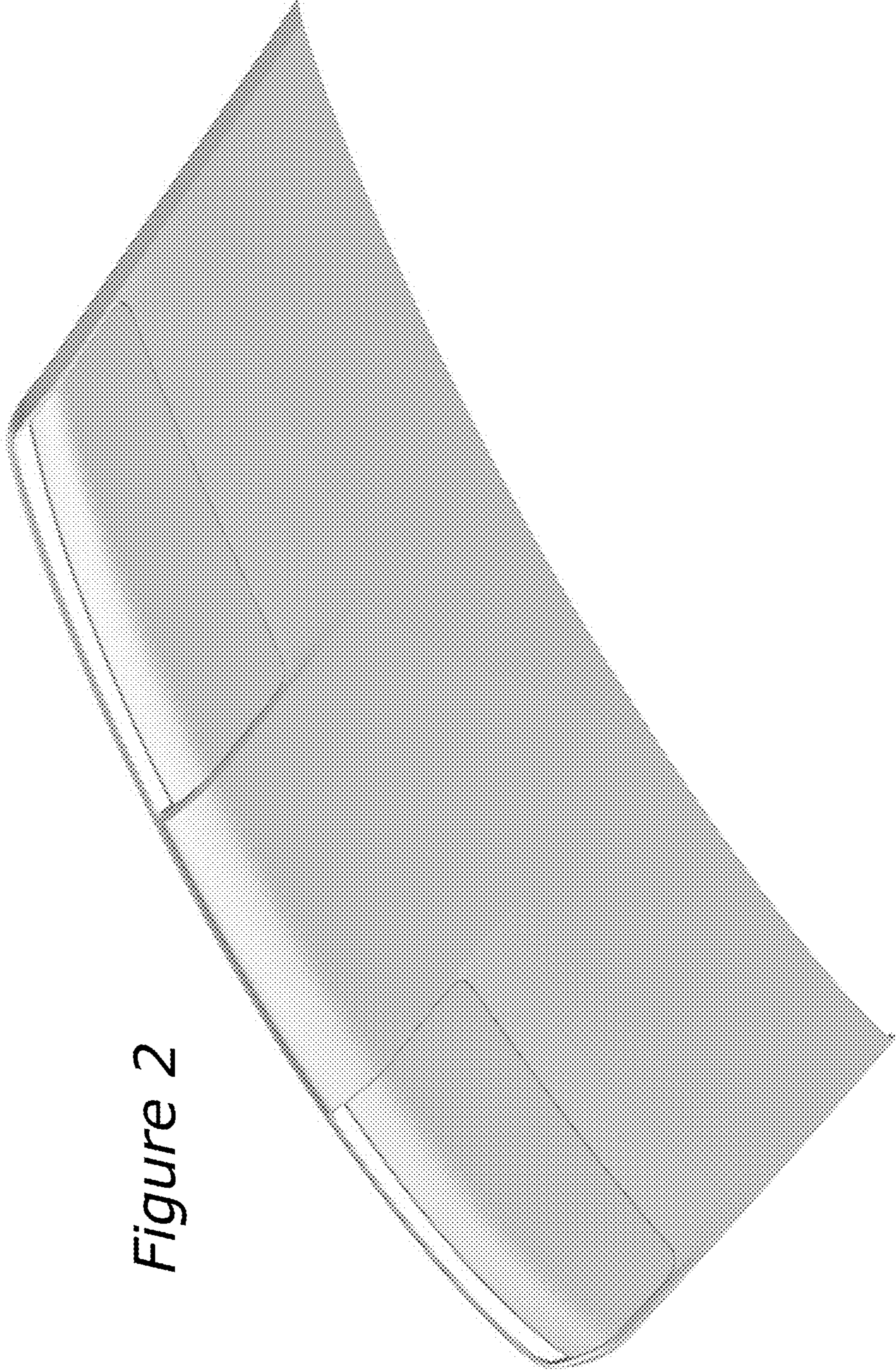

Figure 2

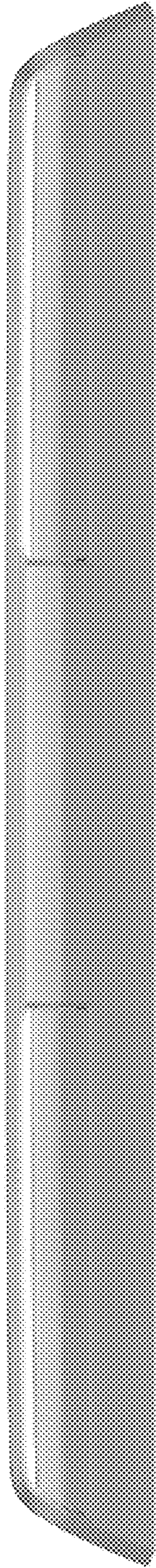

Figure 3

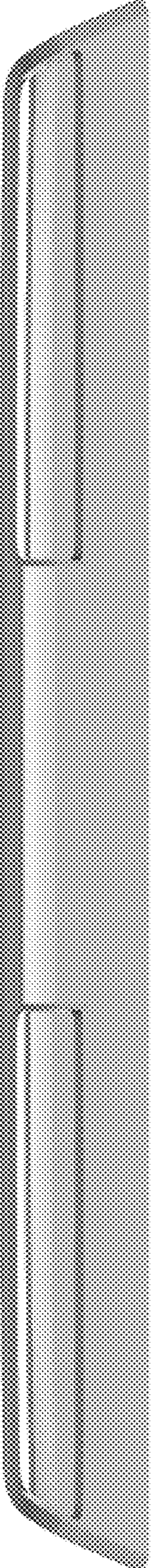

Figure 4

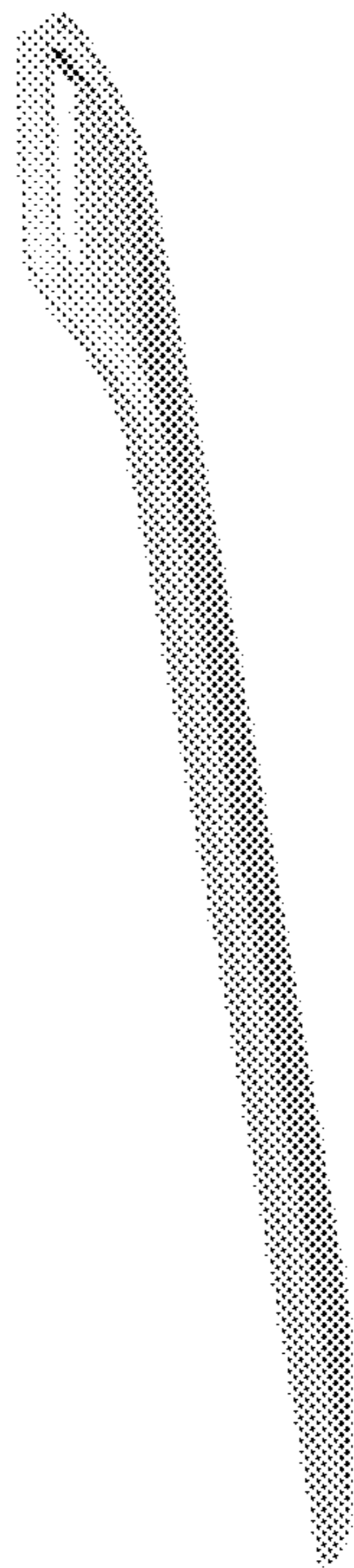

Figure 5

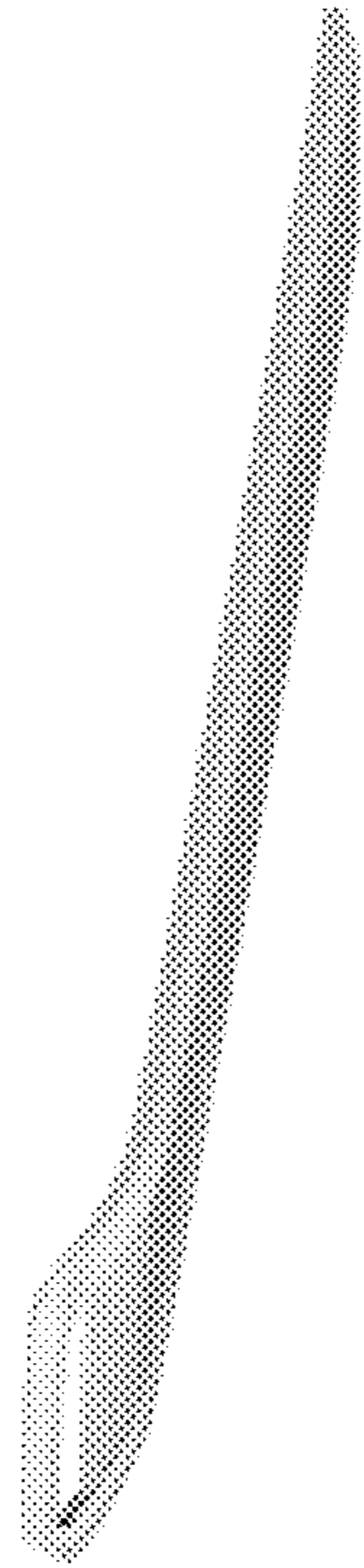

Figure 6

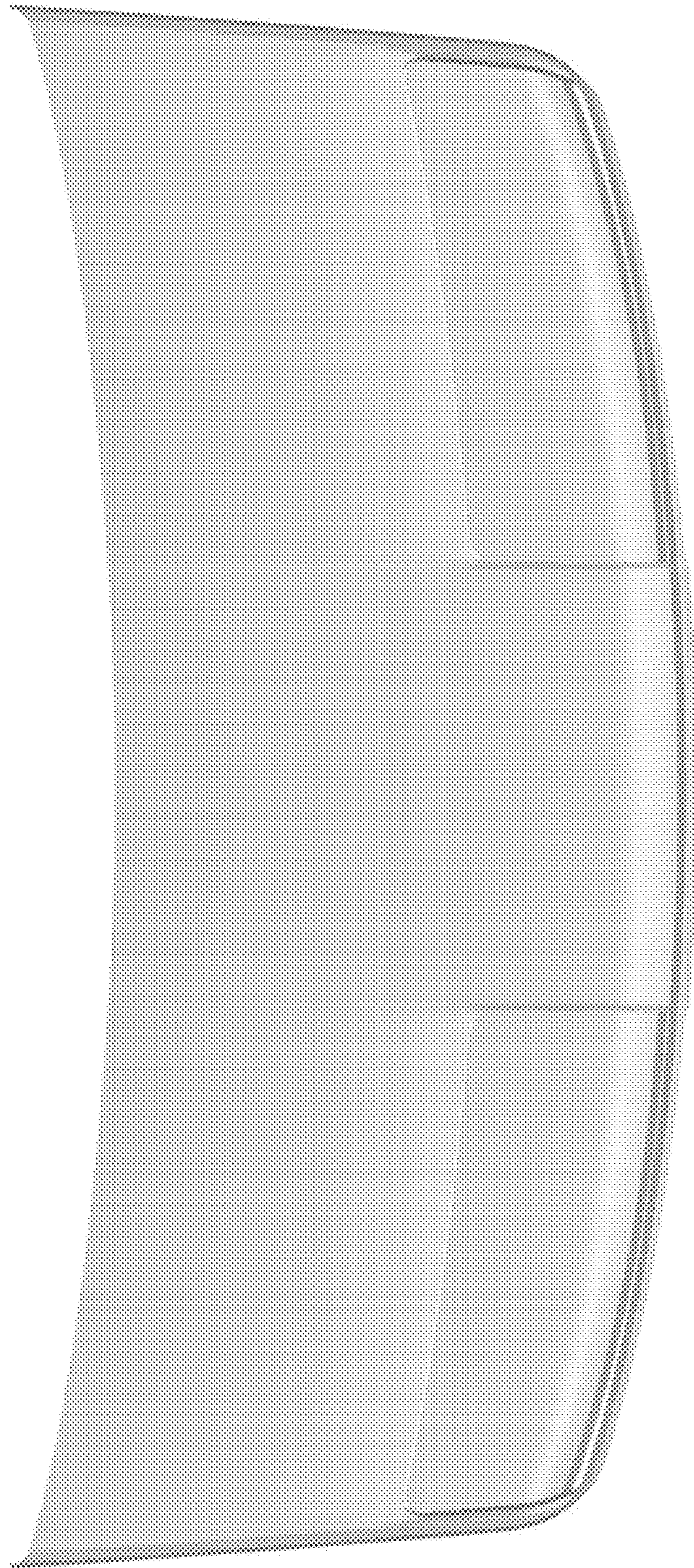

Figure 7

Figure 8

