



US00D785877S

(12) **United States Design Patent**  
**Cao et al.**

(10) **Patent No.:** **US D785,877 S**

(45) **Date of Patent:** **\*\* May 2, 2017**

(54) **CLEANER**

(71) Applicants: **JIANGSU MIDEA CLEANING APPLIANCES CO., LTD**, Suzhou (CN); **MIDEA GROUP CO., LTD**, Foshan (CN)

(72) Inventors: **Pei Cao**, Suzhou (CN); **Yang Gu**, Suzhou (CN)

(73) Assignees: **JIANGSU MIDEA CLEANING APPLIANCES CO., LTD**, Suzhou, Jiangsu (CN); **MIDEA GROUP CO., LTD**, Foshan, Guangdong (CN)

D506,042 S *	6/2005	Griffin	.....	D32/21
D534,696 S *	1/2007	Choi	.....	D32/21
D567,458 S *	4/2008	Jiang	.....	D32/15
D596,359 S *	7/2009	Hollis	.....	D32/21
D618,870 S *	6/2010	Williams	.....	D32/24
D646,030 S *	9/2011	Carr	.....	D32/21
D724,801 S *	3/2015	Yoon	.....	D32/21
D730,599 S *	5/2015	Uim	.....	D32/18
D737,006 S *	8/2015	Heck	.....	D32/21
D744,178 S *	11/2015	Choi	.....	D32/21
D749,282 S *	2/2016	Kim	.....	D32/18
D749,283 S *	2/2016	Kim	.....	D32/18
D749,285 S *	2/2016	Kim	.....	D32/31
D752,831 S *	3/2016	Kim	.....	D32/18
D760,969 S *	7/2016	Kim	.....	D32/18

\* cited by examiner

(\*\*) Term: **15 Years**

(21) Appl. No.: **29/543,689**

(22) Filed: **Oct. 27, 2015**

(51) **LOC (10) Cl.** ..... **15-05**

(52) **U.S. Cl.**  
USPC ..... **D32/17**

(58) **Field of Classification Search**  
USPC ..... D32/1, 21, 31, 18  
CPC ..... A47L 5/28; A47L 9/1633; A47L 2201/04;  
A47L 2201/00

See application file for complete search history.

(56) **References Cited**

**U.S. PATENT DOCUMENTS**

D343,934 S *	2/1994	Meelen	.....	D32/21
D381,779 S *	7/1997	Pritchett	.....	D32/22
D405,570 S *	2/1999	Broecking	.....	D32/32
D418,643 S *	1/2000	Hoshino	.....	D32/21
D454,994 S *	3/2002	Harada	.....	D32/21
D462,488 S *	9/2002	Santiago	.....	D32/18
6,553,612 B1 *	4/2003	Dyson	.....	A47L 5/28

15/319

*Primary Examiner* — Michael A. Pratt

*Assistant Examiner* — Michelle E Wilson

(74) *Attorney, Agent, or Firm* — Hamre, Schumann, Mueller & Larson, P.C.

(57) **CLAIM**

The ornamental design for a “cleaner,” as shown and described.

**DESCRIPTION**

FIG. 1 is a front view of the cleaner;  
FIG. 2 is a rear view of the cleaner;  
FIG. 3 is a left side view of the cleaner;  
FIG. 4 is a right side view of the cleaner;  
FIG. 5 is a top view of the cleaner;  
FIG. 6 is a bottom view of the cleaner;  
FIG. 7 is one perspective view of the cleaner; and,  
FIG. 8 is another perspective view of the cleaner.  
The broken lines showing in the figures are for illustrative purposes only and form no part of the claimed design.

**1 Claim, 8 Drawing Sheets**

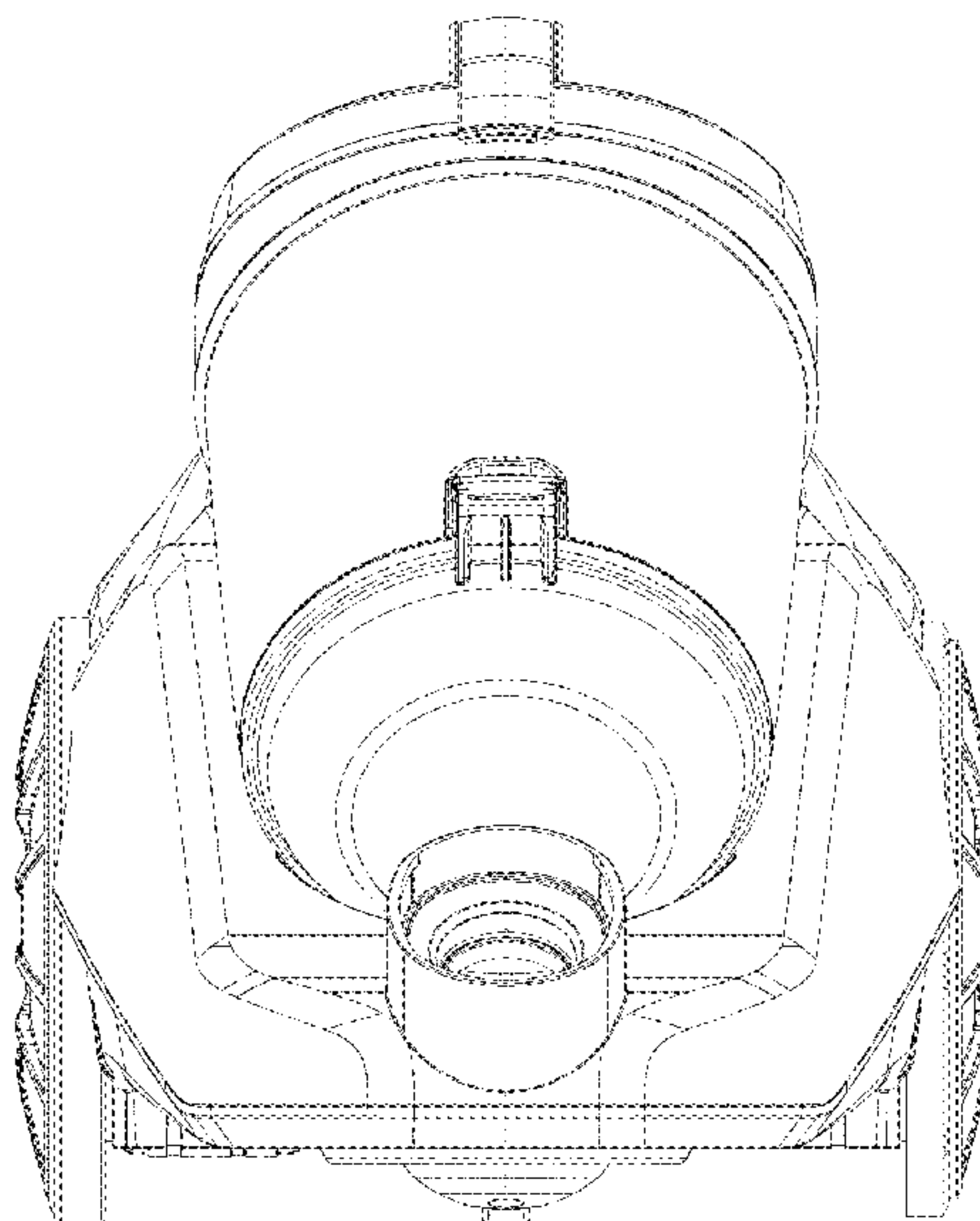

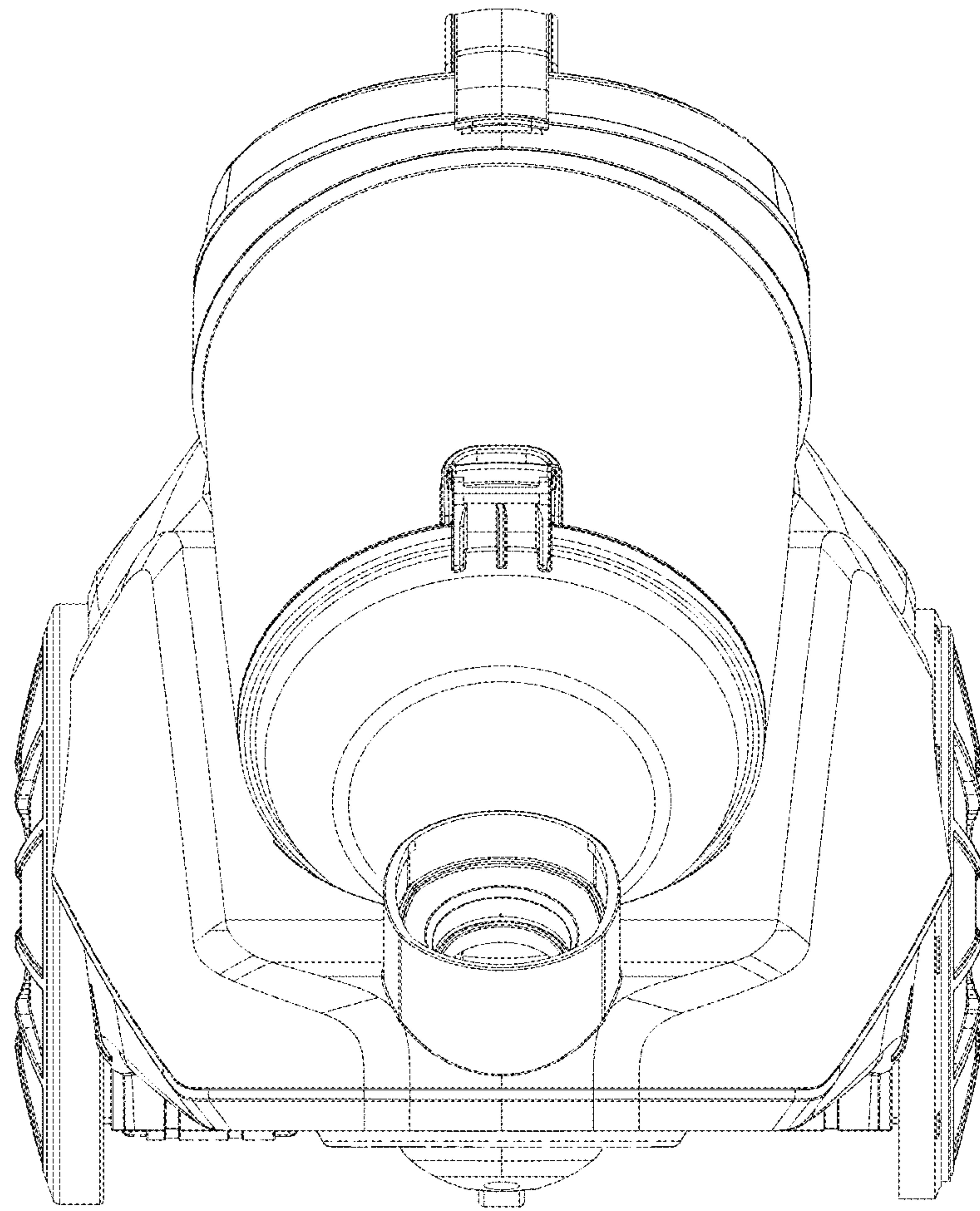

FIG. 1

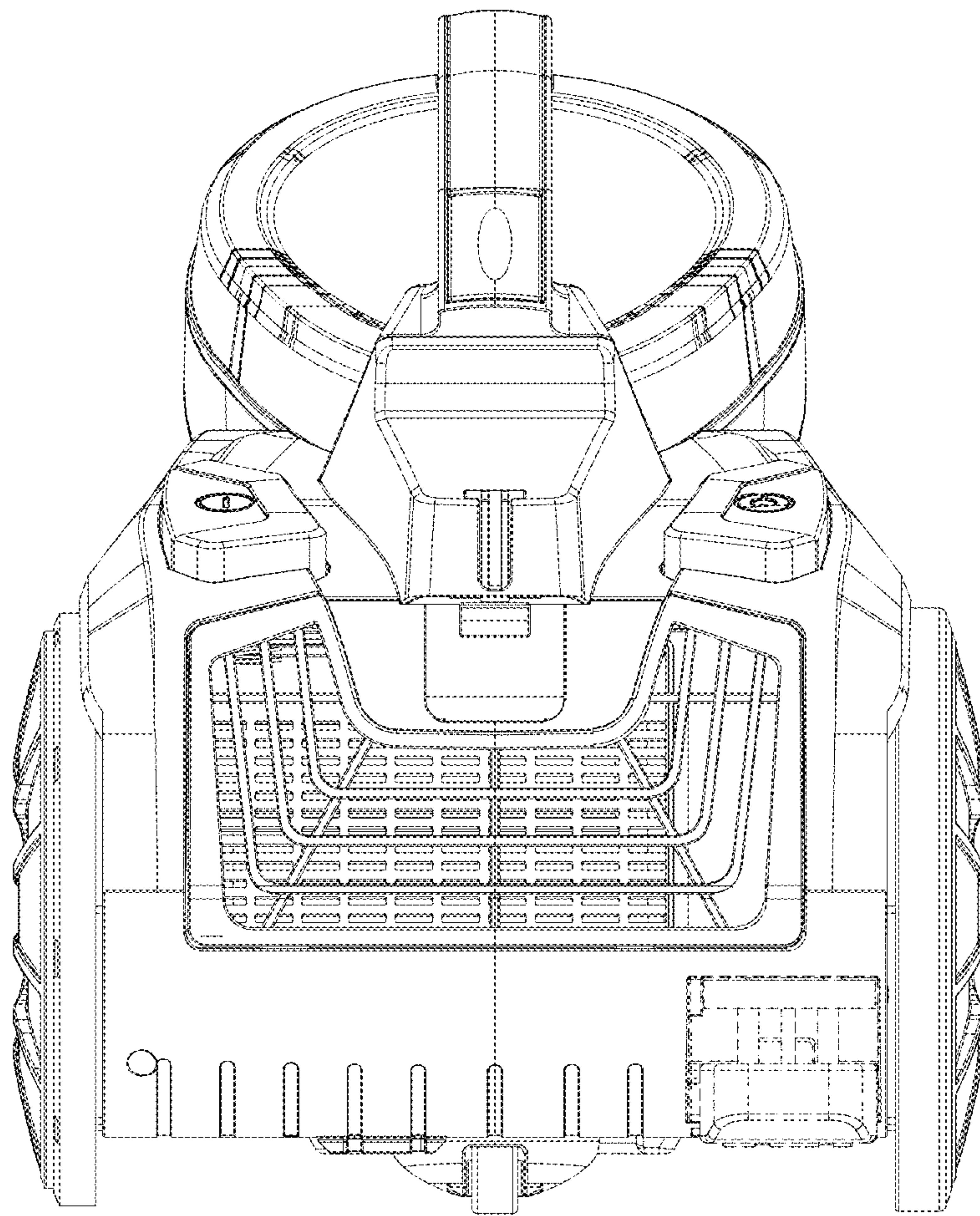

FIG. 2



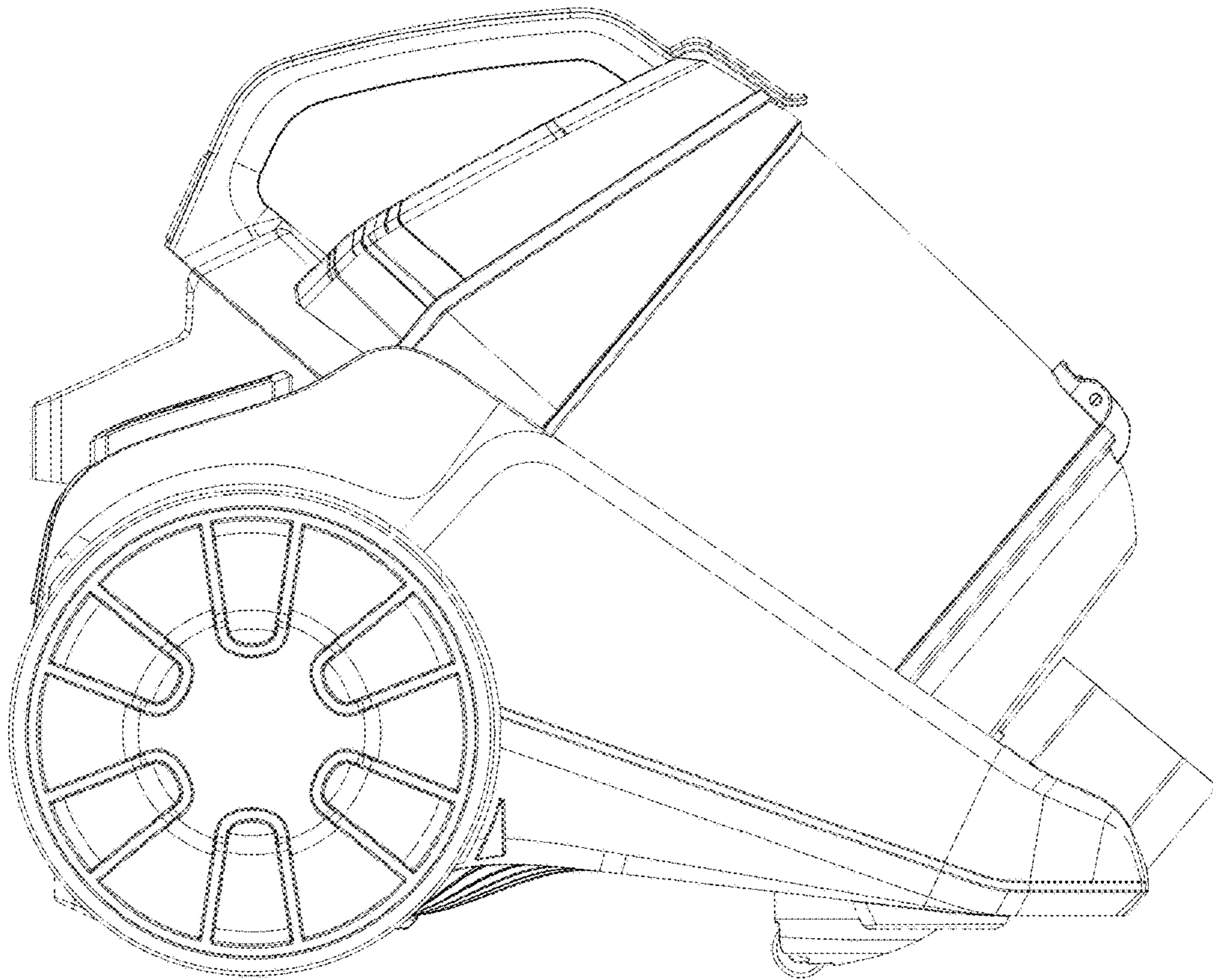

FIG. 3

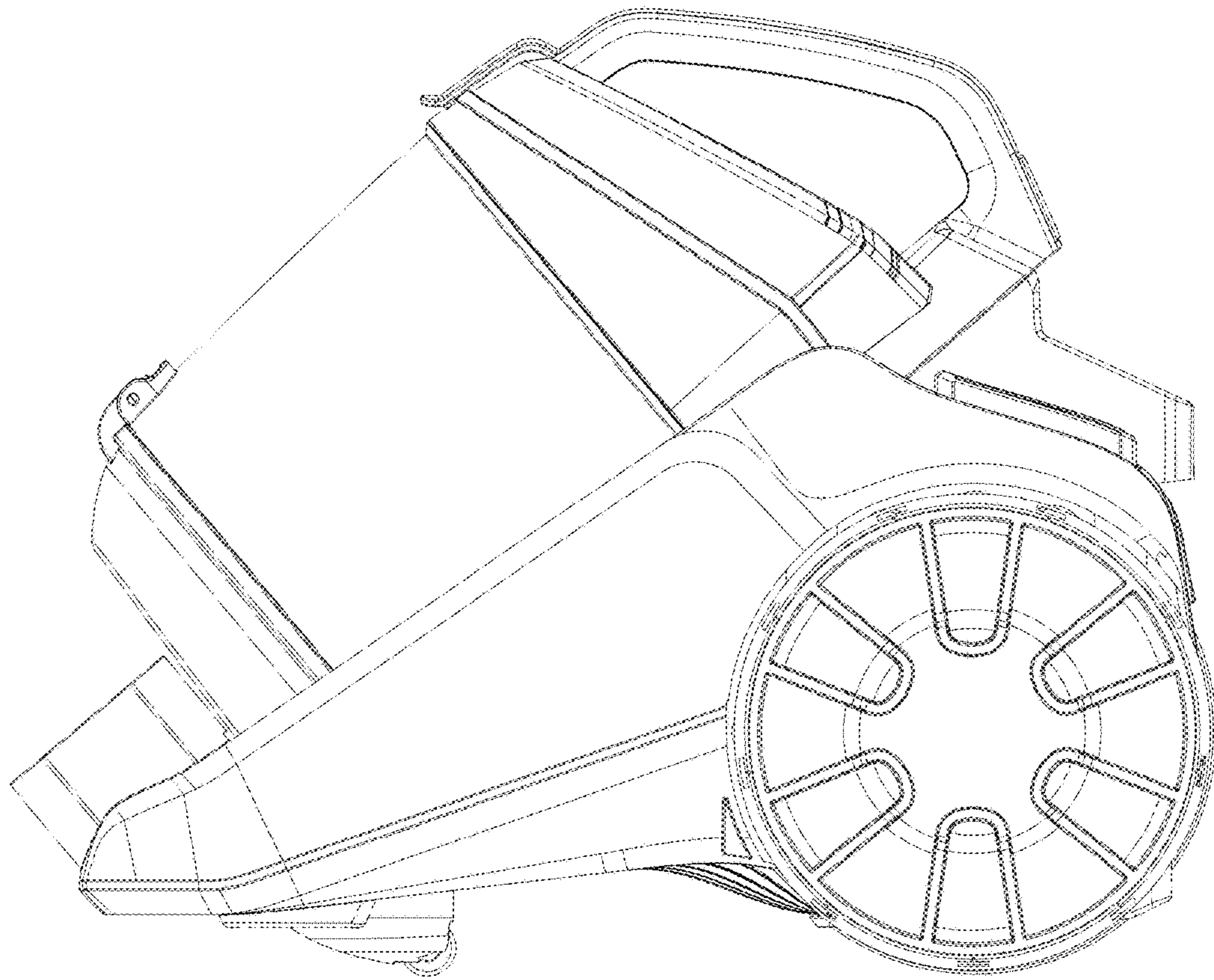

FIG. 4

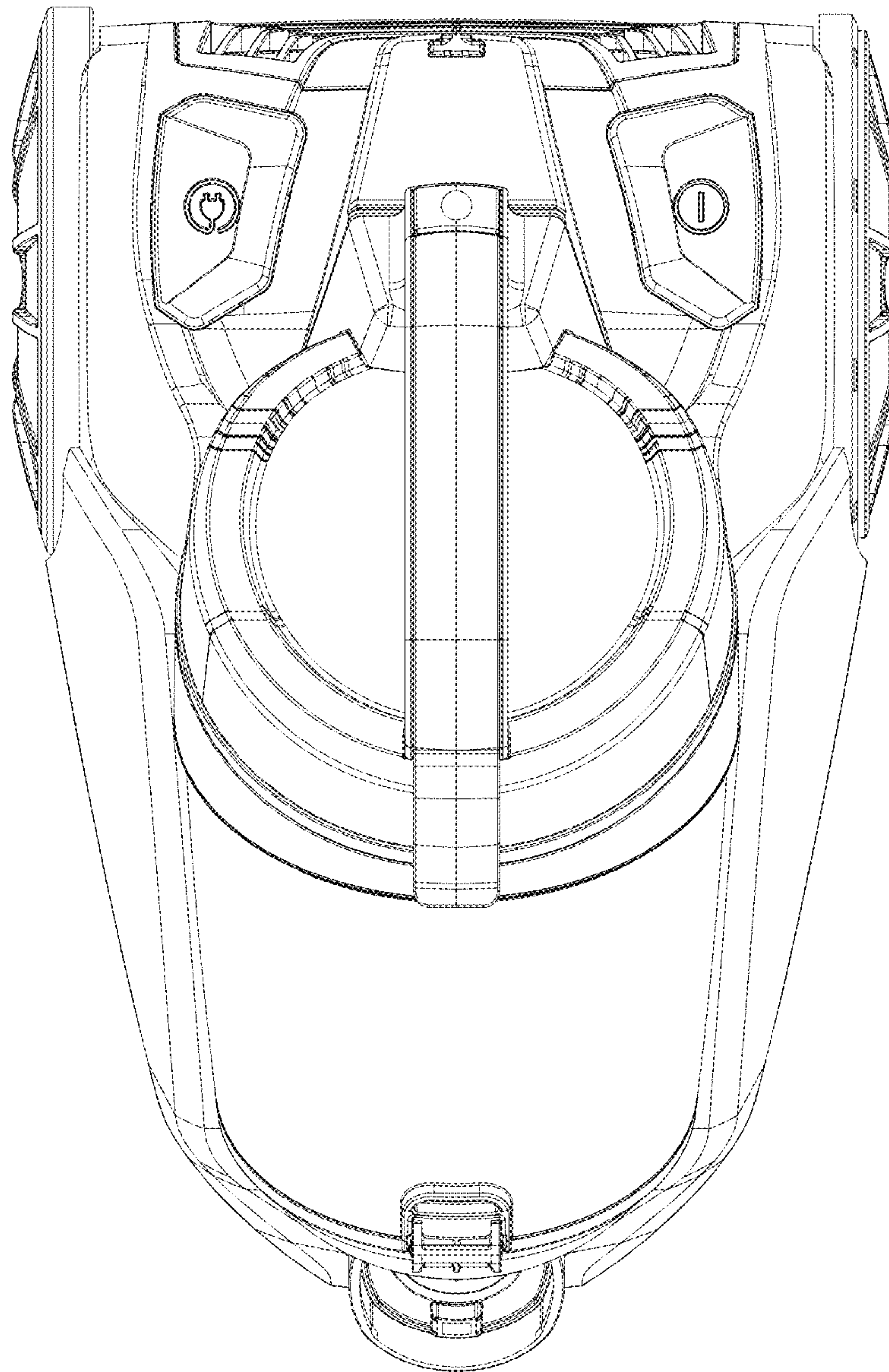

FIG. 5



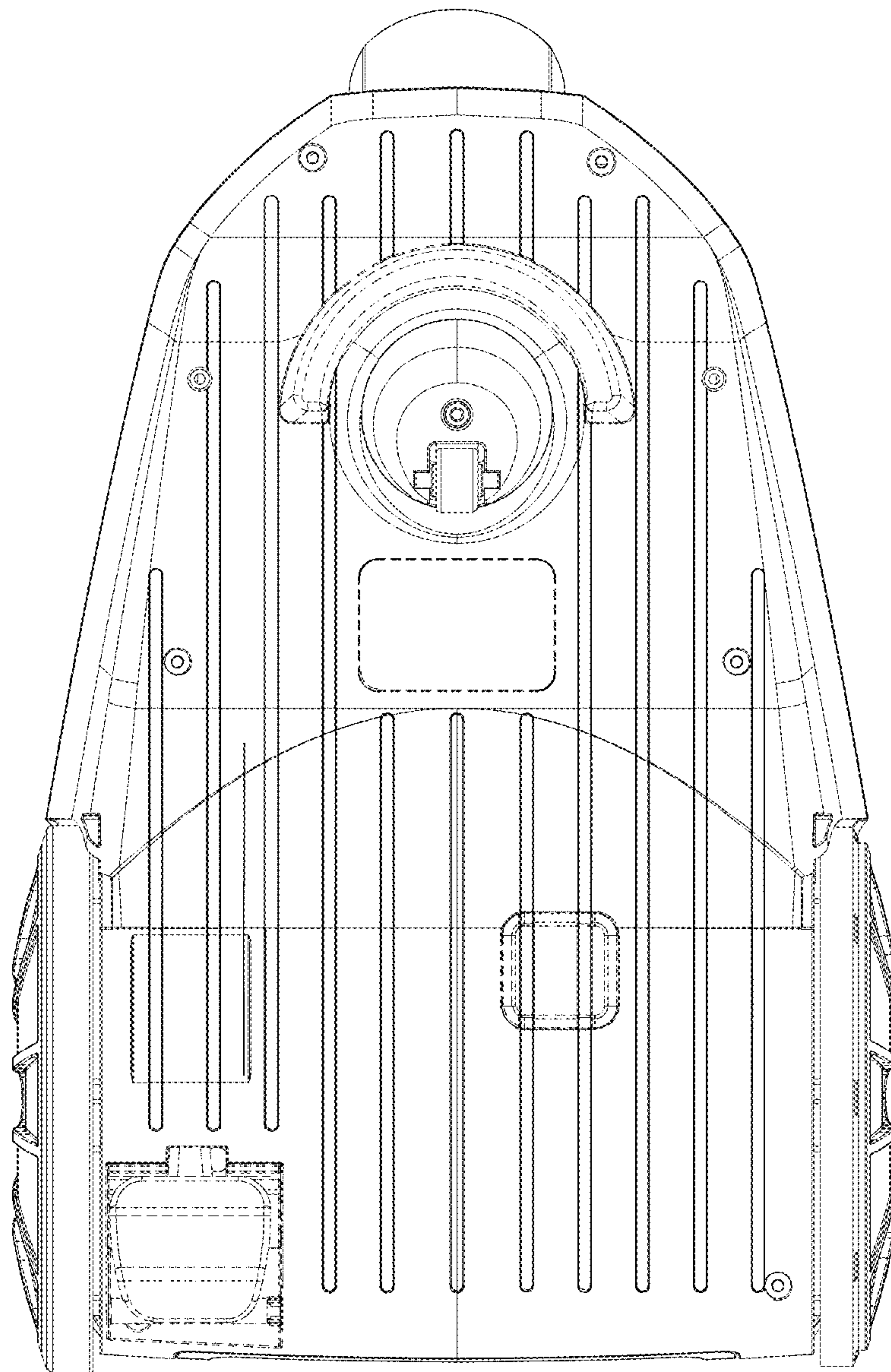

FIG. 6

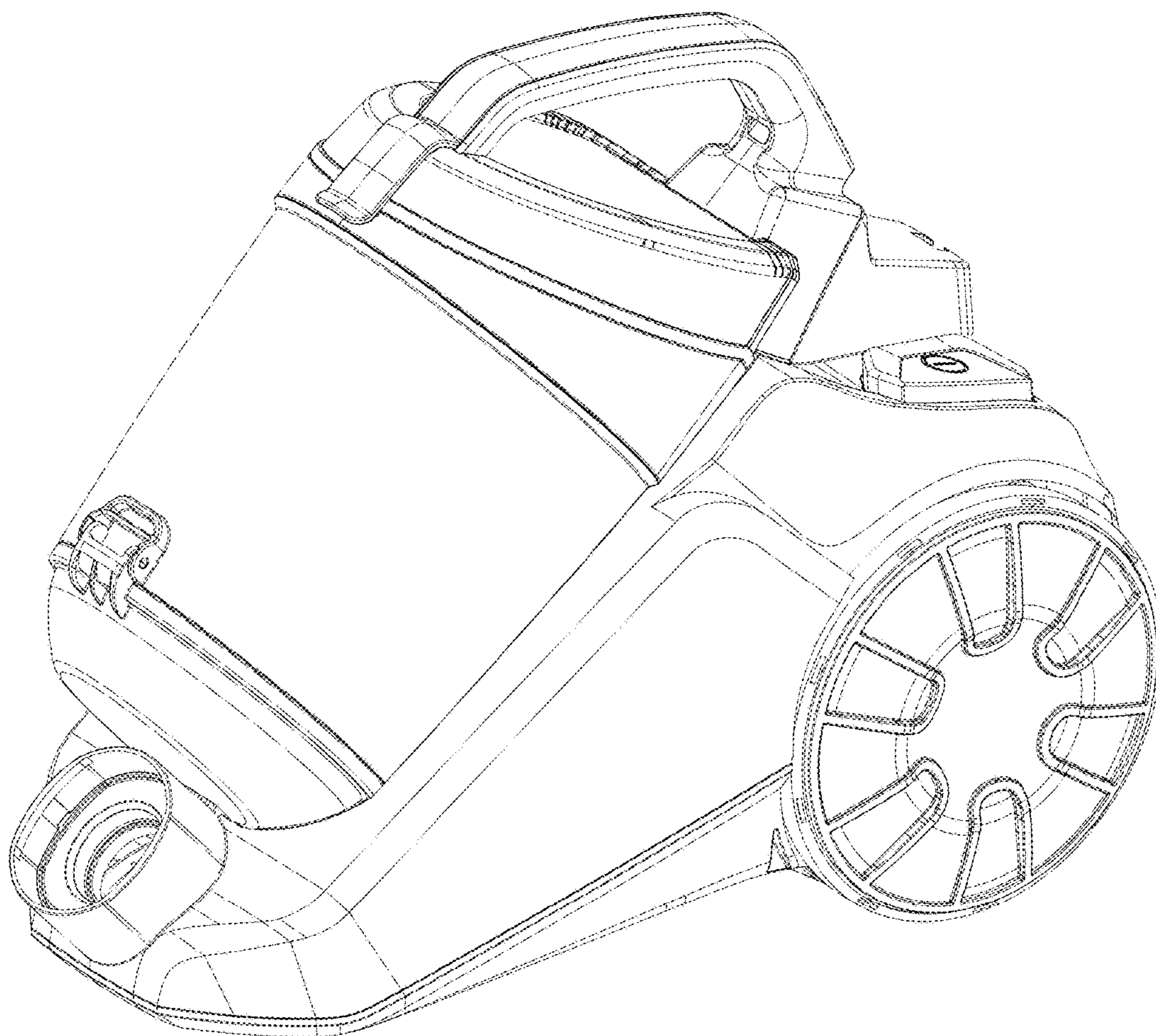

FIG. 7



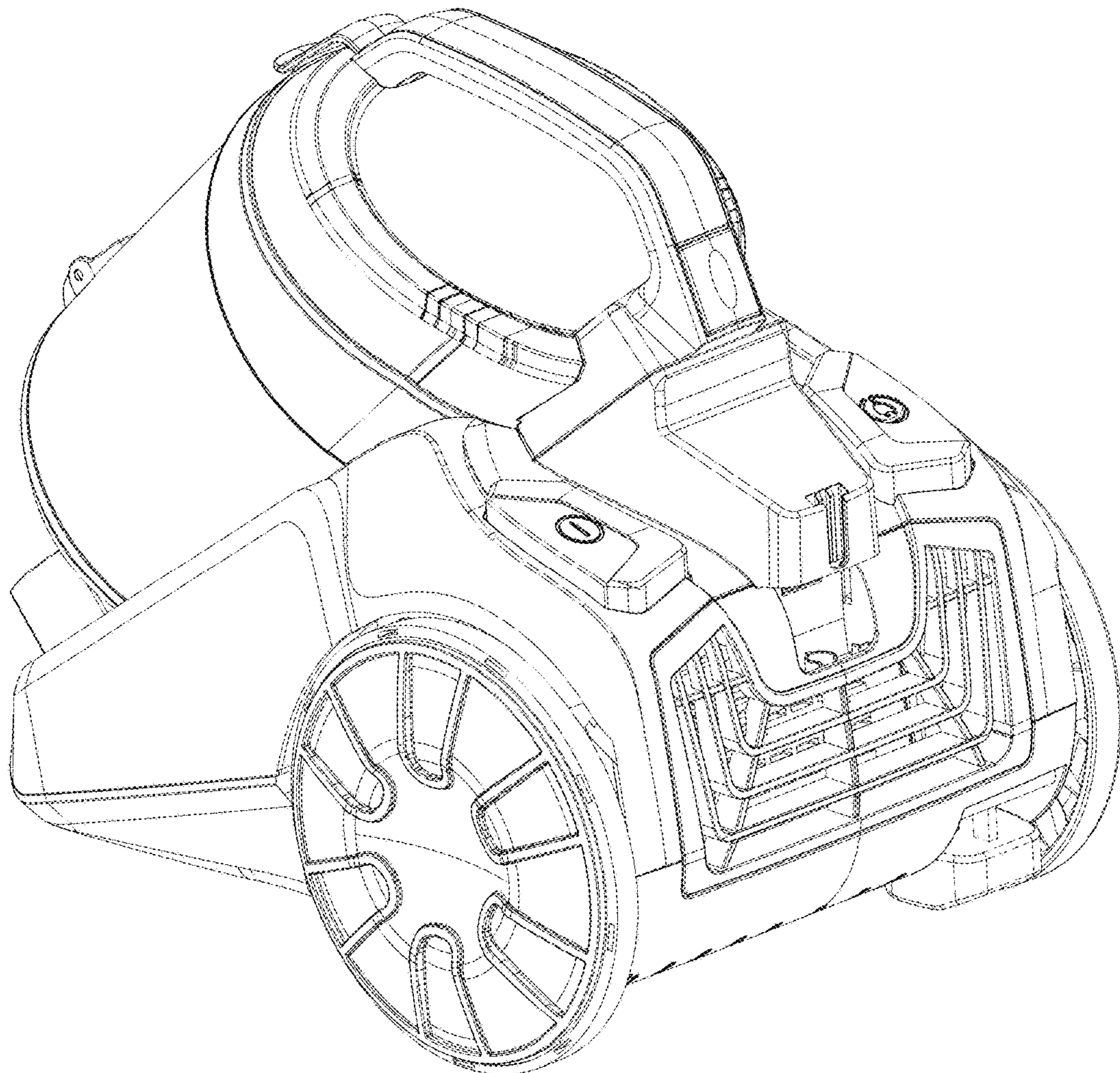

FIG. 8