



US00D785233S

(12) **United States Design Patent**
Dupras

(10) **Patent No.:** **US D785,233 S**
(45) **Date of Patent:** **** Apr. 25, 2017**

(54) **MOUNTING SYSTEM FOR LIGHT FIXTURE**

(71) Applicant: **LUMISAVE INDUSTRIAL LED TECHNOLOGIES LTD.**, Prince George (CA)

(72) Inventor: **Jay Dupras**, Prince George (CA)

(73) Assignee: **Lumisave Industrial LED Technologies LTD**, Prince George, BC (CA)

(**) Term: **15 Years**

(21) Appl. No.: **29/544,112**

(22) Filed: **Oct. 30, 2015**

(51) **LOC (10) Cl.** **02-99**

(52) **U.S. Cl.**
USPC **D26/138**

(58) **Field of Classification Search**
USPC D26/51, 56, 61-67, 102, 104, 105, 107, D26/108, 109, 110; D8/16-20, 363, 373
CPC .. F21S 48/134; F21S 48/1109; F21S 48/1159; F21S 48/2237; F21S 48/1747; F21S 48/145; F16M 1/00; F16M 13/022; F21Y 2101/00; G08B 17/00

See application file for complete search history.

(56) **References Cited**

U.S. PATENT DOCUMENTS

D488,708 S * 4/2004 Lam D8/363
D560,116 S * 1/2008 Brassard D14/251
D562,113 S * 2/2008 Ciungan D14/452
D590,238 S * 4/2009 Richter D8/363

D599,355 S * 9/2009 Richter D14/253
RE44,740 E * 2/2014 Ciungan D14/452
D699,547 S * 2/2014 Syed D8/363
D733,957 S * 7/2015 Tragatschnig D26/118
D744,321 S * 12/2015 Boynton D8/363
D748,457 S * 2/2016 Lockridge D8/363
D752,421 S * 3/2016 Atkins D8/373

* cited by examiner

Primary Examiner — John Windmuller

Assistant Examiner — Benjamin Weeks

(74) *Attorney, Agent, or Firm* — Preti Flaherty Beliveau & Pachios LLP

(57) **CLAIM**

The ornamental design for a mounting system for light fixture, as shown.

DESCRIPTION

FIG. 1 is a perspective view of the mounting system. FIG. 2 is a bottom view of the mounting system of FIG. 1. FIG. 3 is a top view of the mounting system of FIG. 1. FIG. 4 is a front view of the mounting system of FIG. 1. FIG. 5 is a back view of the mounting system of FIG. 1. FIG. 6 is a left side view of the mounting system of FIG. 1. FIG. 7 is a right side view of the mounting system of FIG. 1; and, FIG. 8 is an environmental perspective view which shows the mounting system in the context of its operating environment.

The broken lines showing the remainder of the mounting system for light fixture form no part of the claimed design.

1 Claim, 5 Drawing Sheets

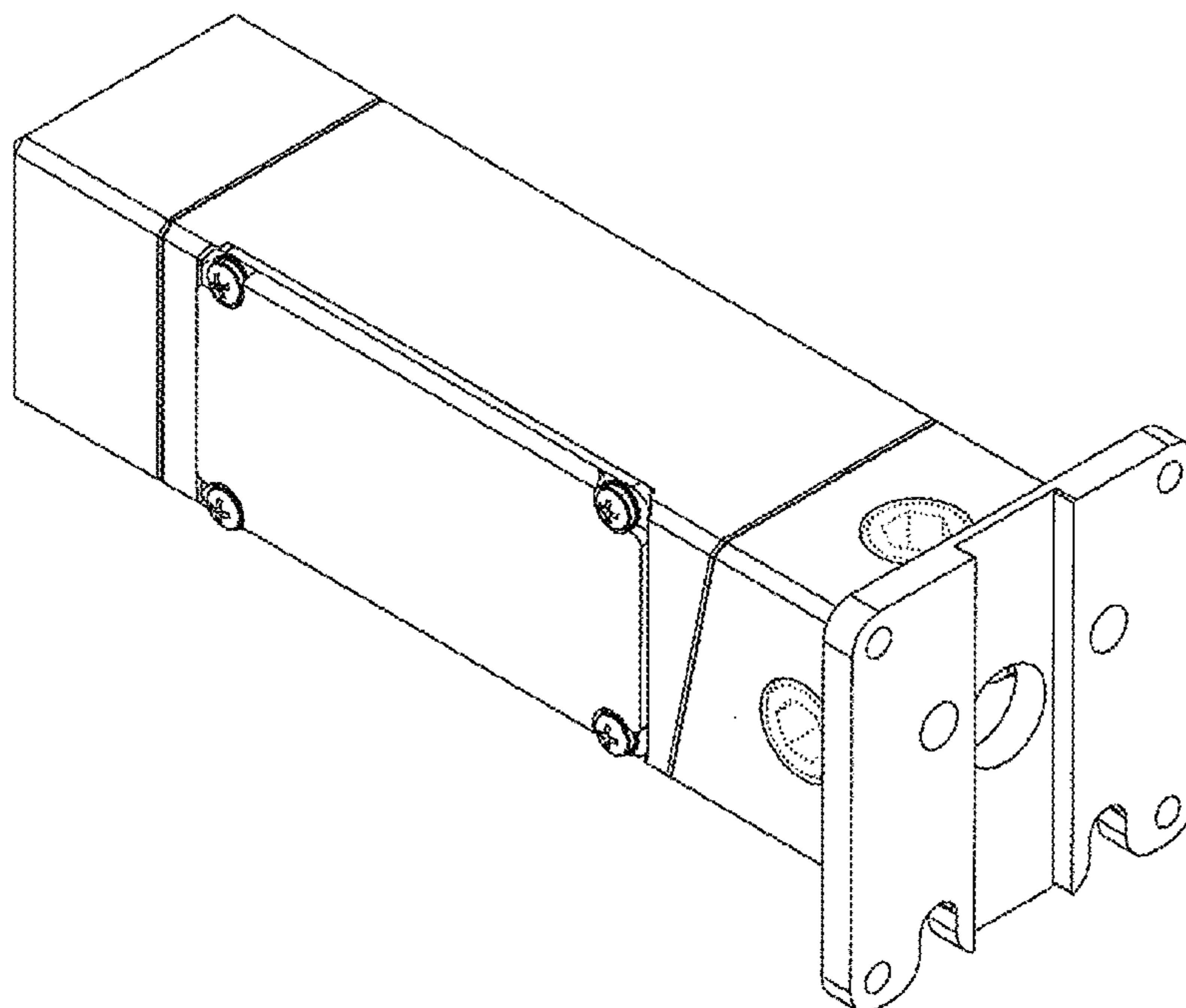

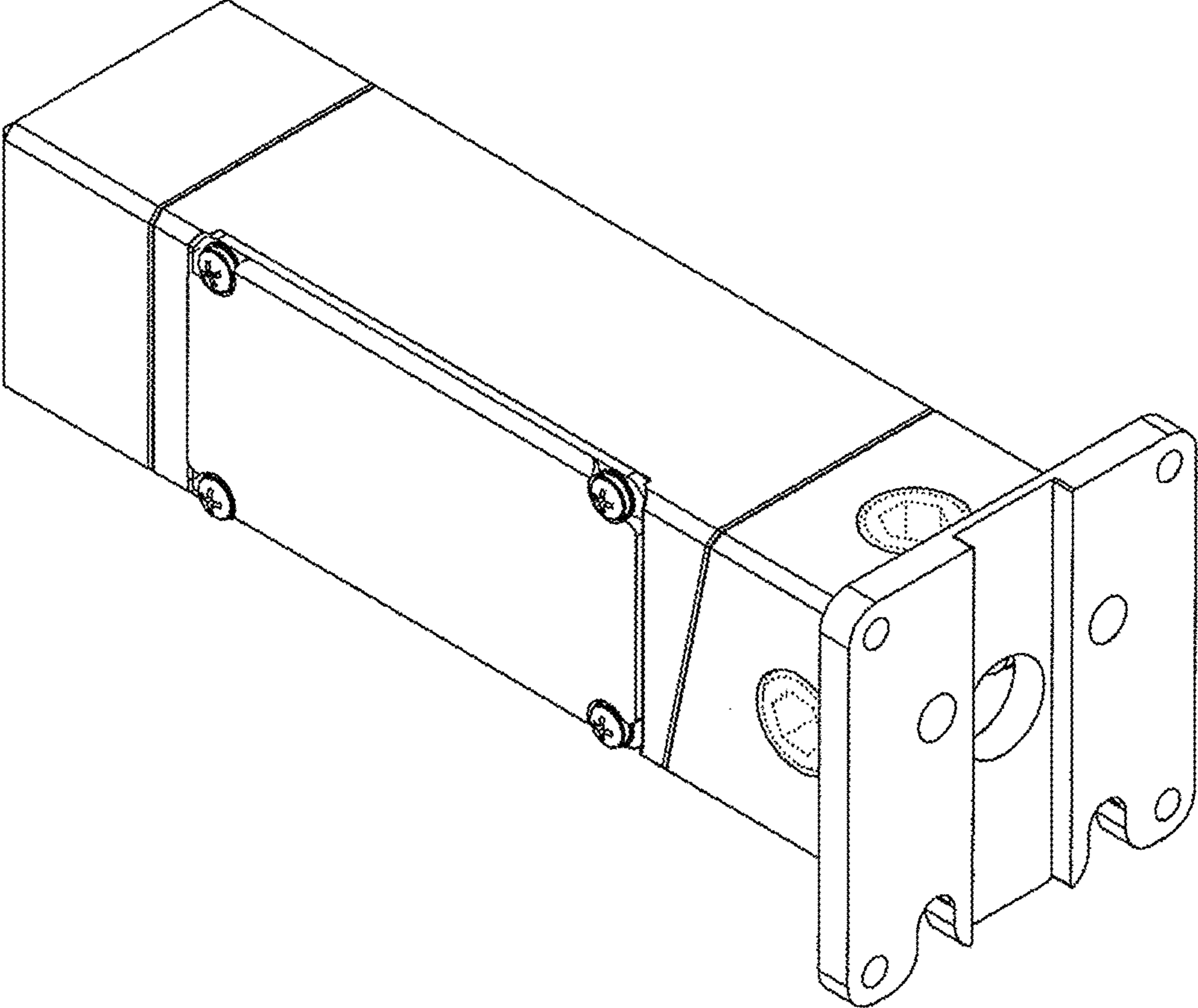

FIG. 1

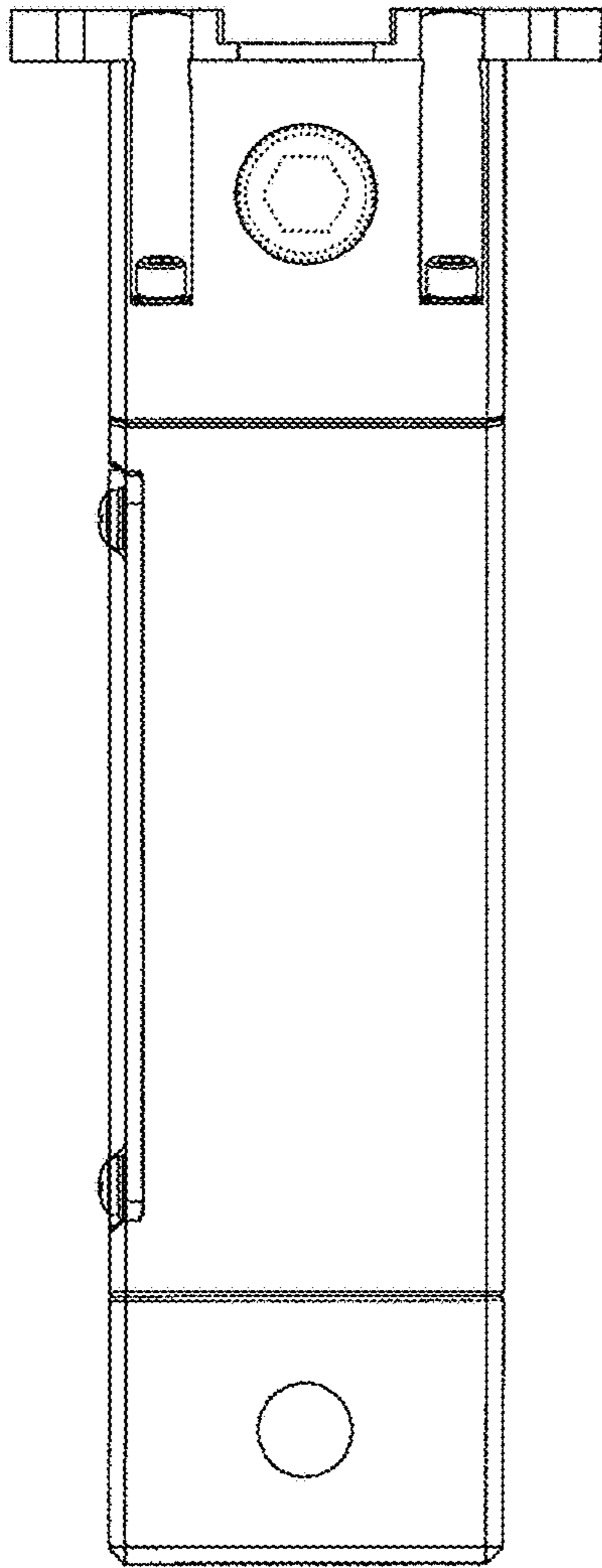

FIG. 2

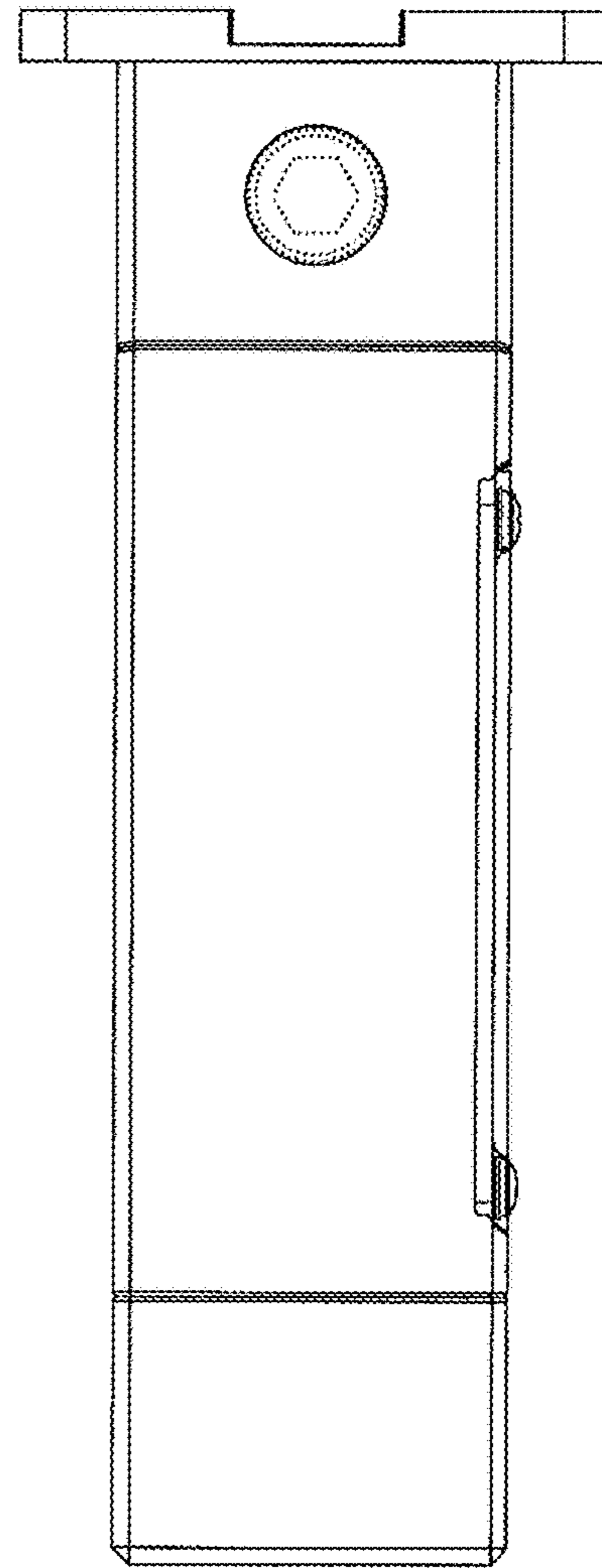

FIG. 3

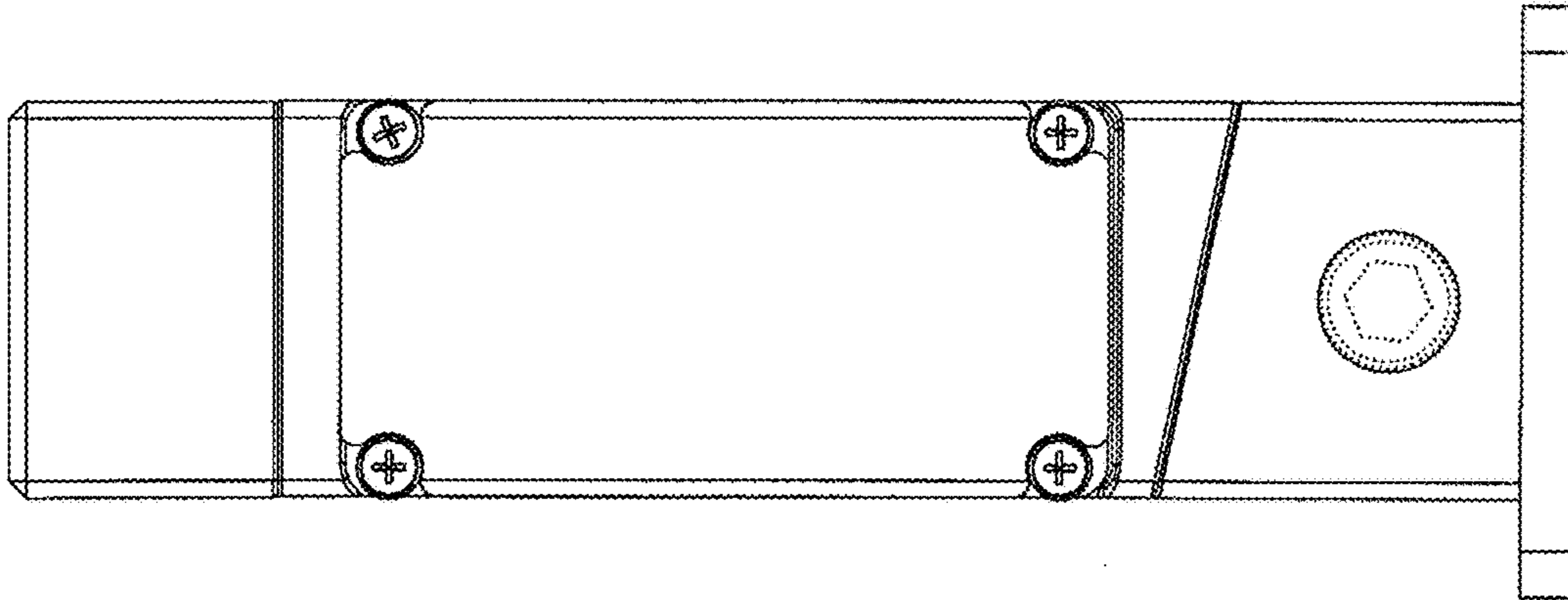

FIG. 4

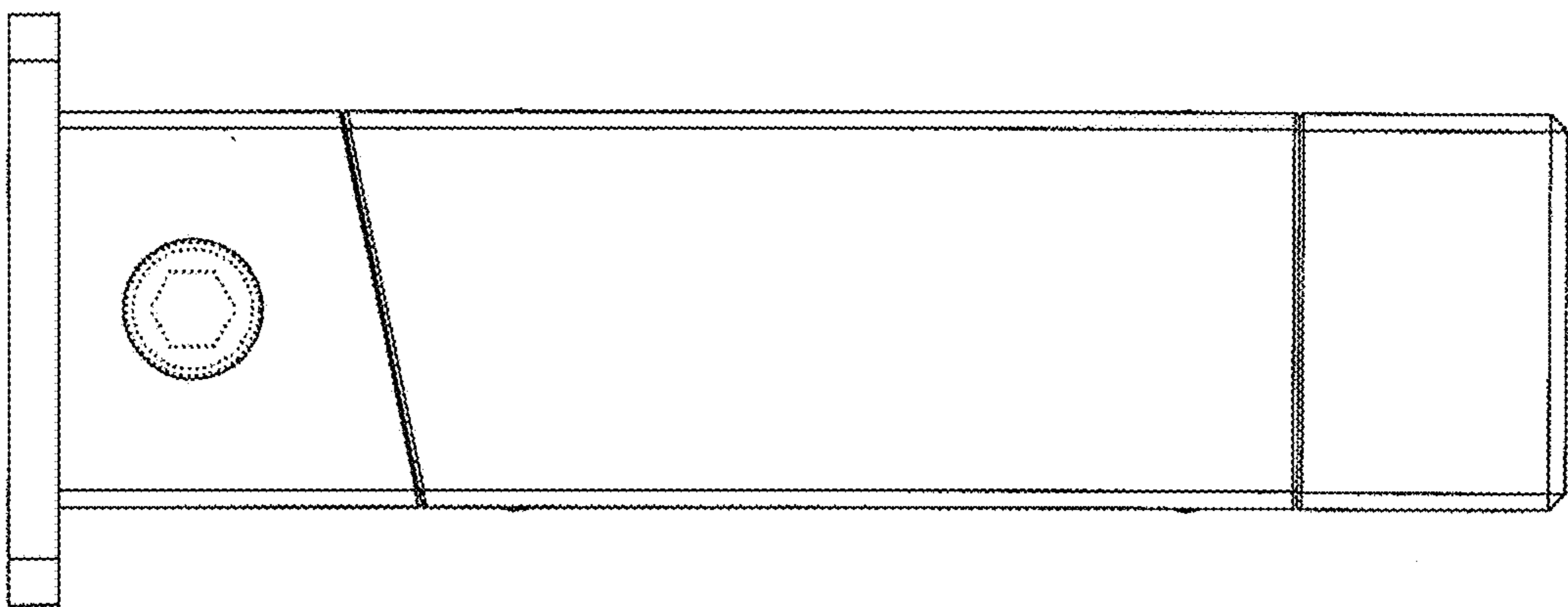

FIG. 5

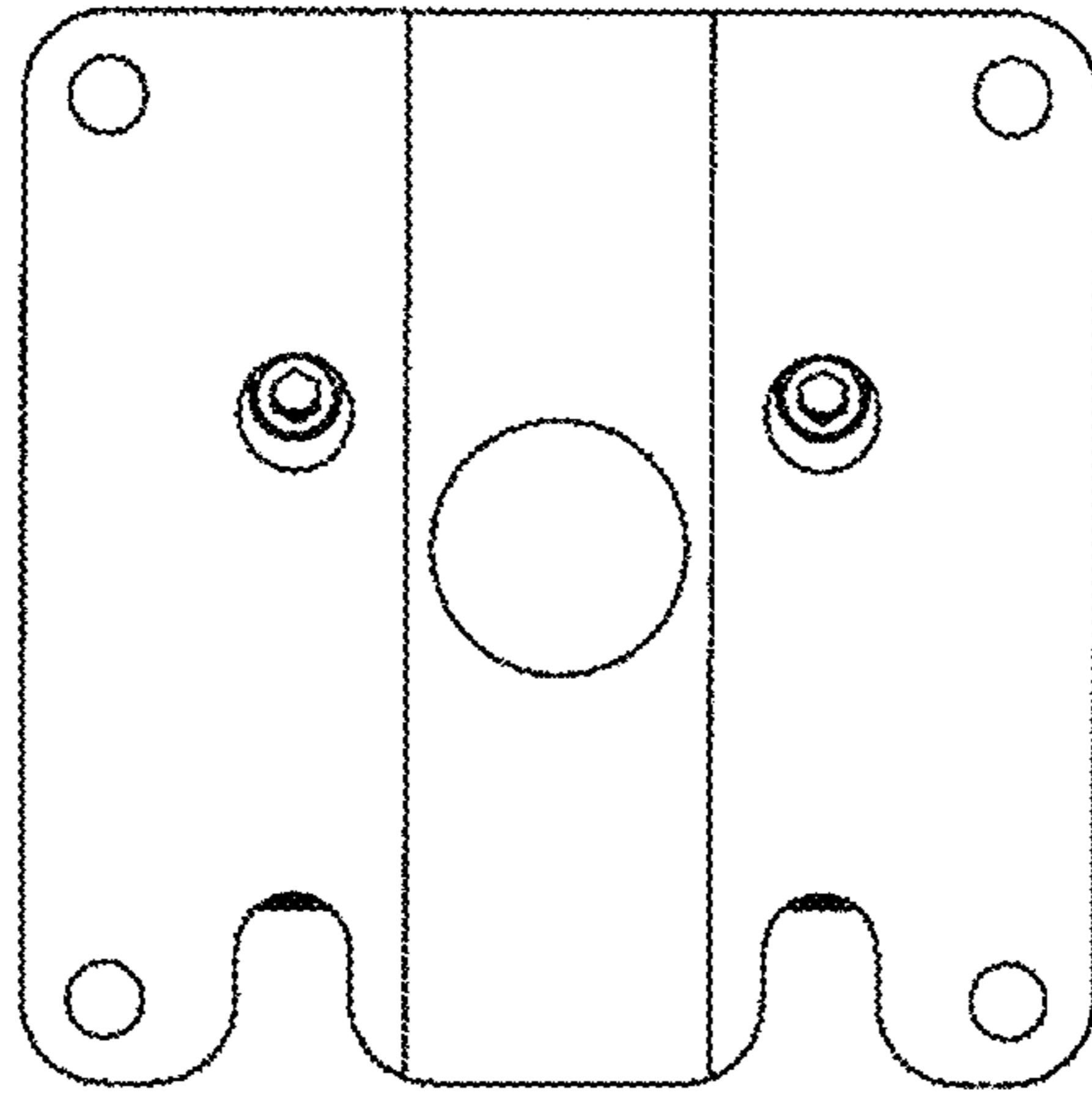

FIG. 6

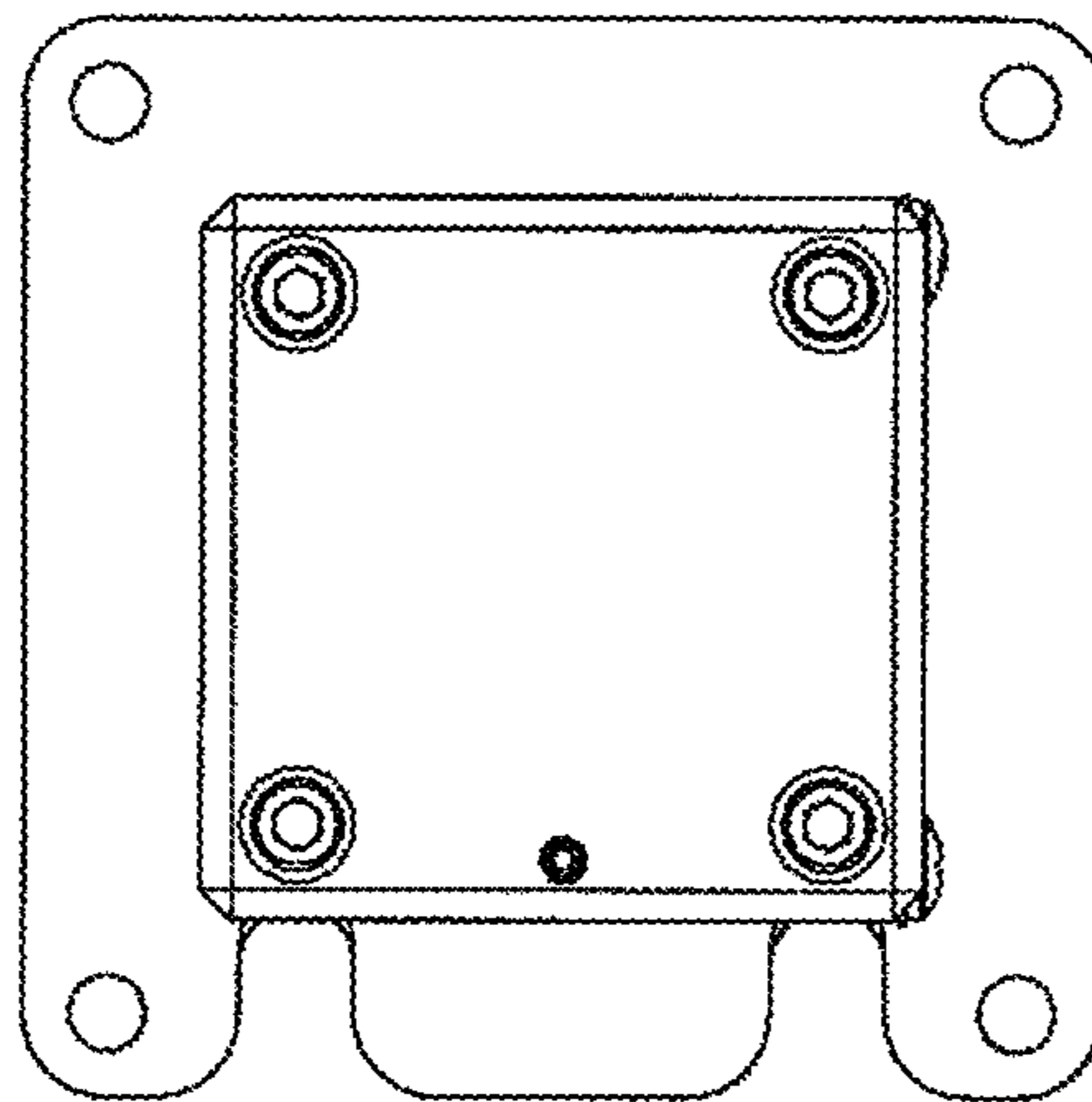

FIG. 7

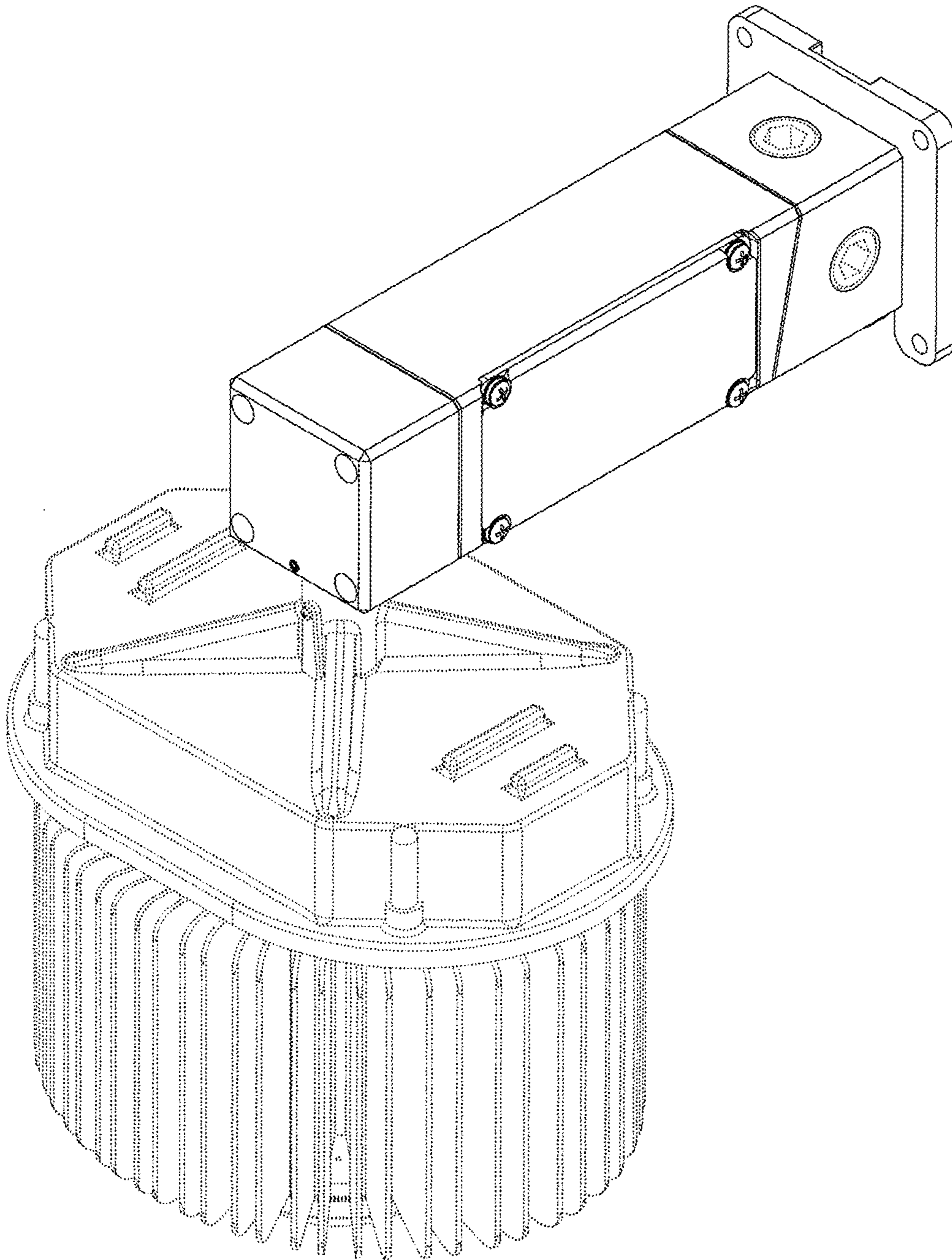

FIG.8