



US00D784965S

(12) **United States Design Patent**
Chang et al.

(10) **Patent No.:** **US D784,965 S**

(45) **Date of Patent:** **** Apr. 25, 2017**

- (54) **ANTENNA**
- (71) Applicant: **Airgain, Incorporated**, San Diego, CA (US)
- (72) Inventors: **Wei Chang**, Zhang Jia Gang (CN); **Bei Zheng**, Zhang Jia Gang (CN); **Keyoor Gosalia**, Carlsbad, CA (US); **Simon Yang**, Carlsbad, CA (US)
- (73) Assignee: **Airgain Incorporated**, San Diego, CA (US)
- (**) Term: **15 Years**

D646,669 S *	10/2011	Suleiman	D14/234
D709,053 S *	7/2014	Chang	D14/230
D766,221 S *	9/2016	Zheng	D14/230
D766,884 S *	9/2016	Zheng	D14/240
2005/0040994 A1 *	2/2005	Mazoki	G06K 19/07786 343/809

- (21) Appl. No.: **29/532,915**
- (22) Filed: **Jul. 10, 2015**
- (51) **LOC (10) Cl.** **14-03**
- (52) **U.S. Cl.**
USPC **D14/230**
- (58) **Field of Classification Search**
USPC D14/138, 230-238.1, 299, 358; D13/182
CPC H01L 33/48; H01L 33/486; H01L 23/02;
H05K 5/00; H01Q 13/10
See application file for complete search history.

(56) **References Cited**

U.S. PATENT DOCUMENTS

D211,179 S *	5/1968	Rosenberry et al.	D14/234
7,123,207 B2 *	10/2006	Yazdandoost	H01Q 9/285 343/700 MS
7,193,576 B2 *	3/2007	Yazdandoost	H01Q 9/285 343/700 MS
D587,693 S *	3/2009	Ohshima	D14/230
D604,275 S *	11/2009	Norris	D14/230

OTHER PUBLICATIONS

<http://airgain.com/our-services/embedded-antennas/>—Retrieved Jan. 4, 2017.*

<http://www.globalsources.com/gsol/1/3G-antenna/p/sm/1055002445.htm#1055002445>—Retrieved Jan. 4, 2017.*

* cited by examiner

Primary Examiner — Manpreet Matharu

Assistant Examiner — Mojtaba Tehrani

(74) *Attorney, Agent, or Firm* — Clause Eight IPS; Michael Catania

(57) **CLAIM**

The ornamental design for an antenna, as shown and described.

DESCRIPTION

FIG. 1 is a front elevation view of an antenna, showing our new design;

FIG. 2 is a side plan view thereof;

FIG. 3 is a rear elevation view thereof;

FIG. 4 is a front perspective view thereof;

FIG. 5 is a front elevation view thereof, with unclaimed environment not shown; and,

FIG. 6 is a rear elevation view thereof, with unclaimed environment not shown.

The broken line in the figure drawings represents unclaimed environment only and forms no part of the claimed design.

1 Claim, 4 Drawing Sheets

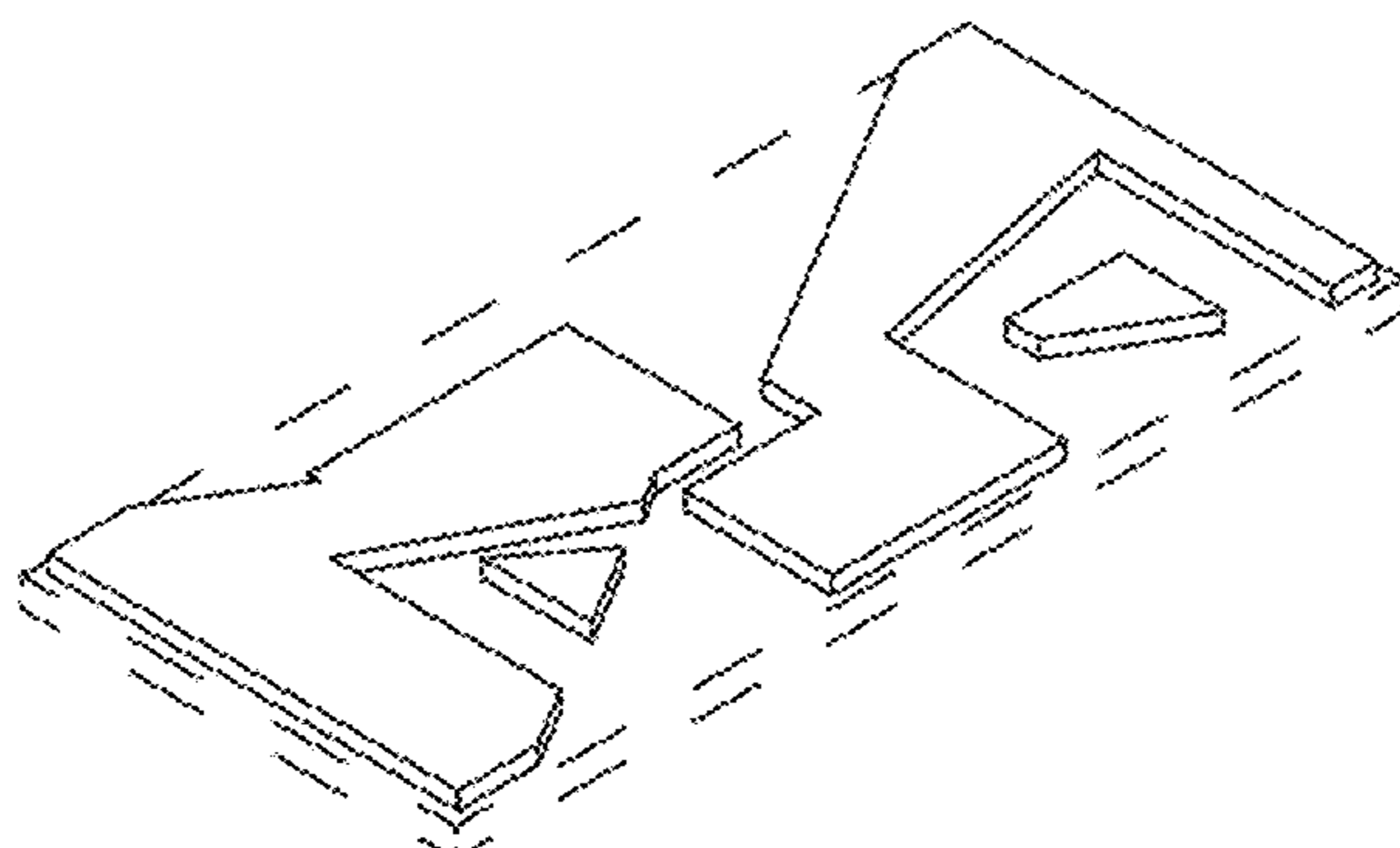
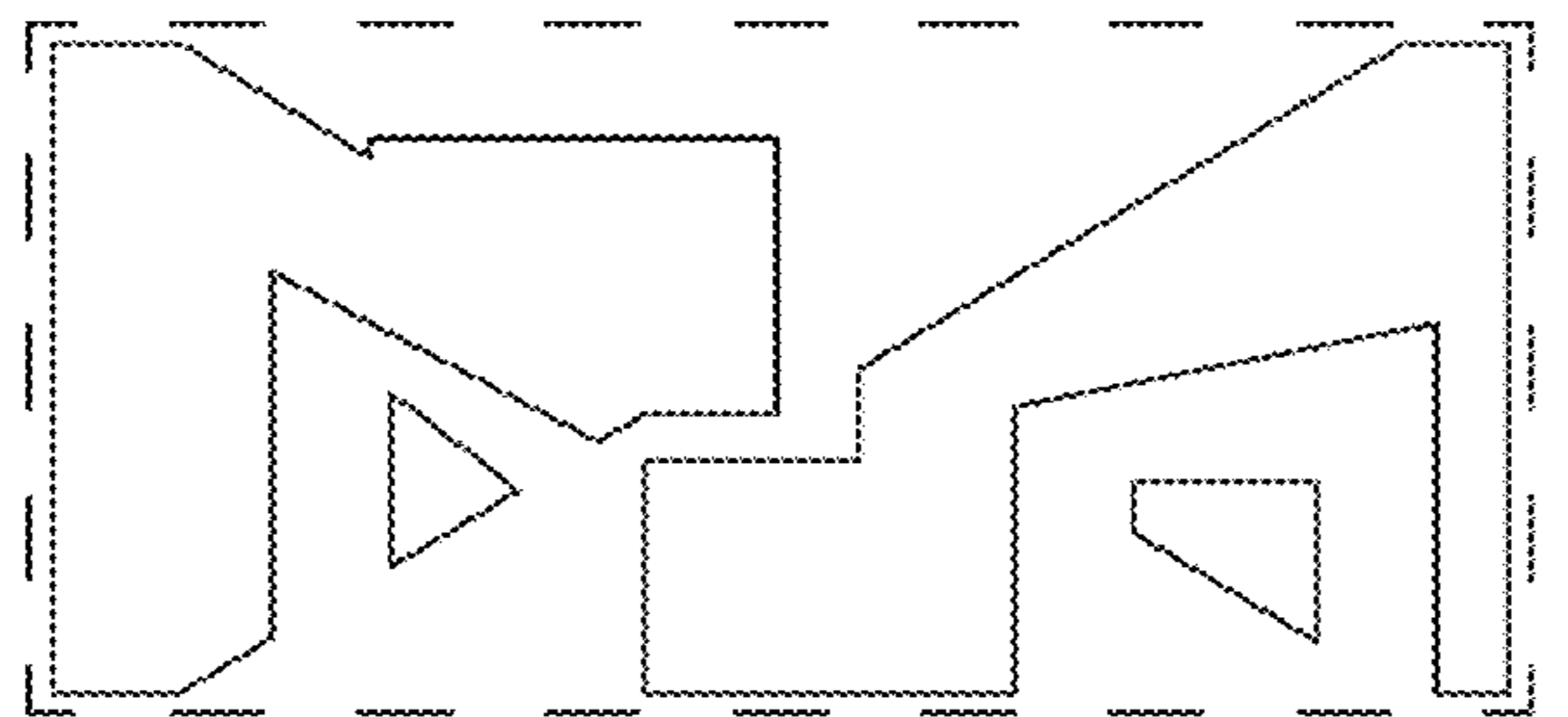

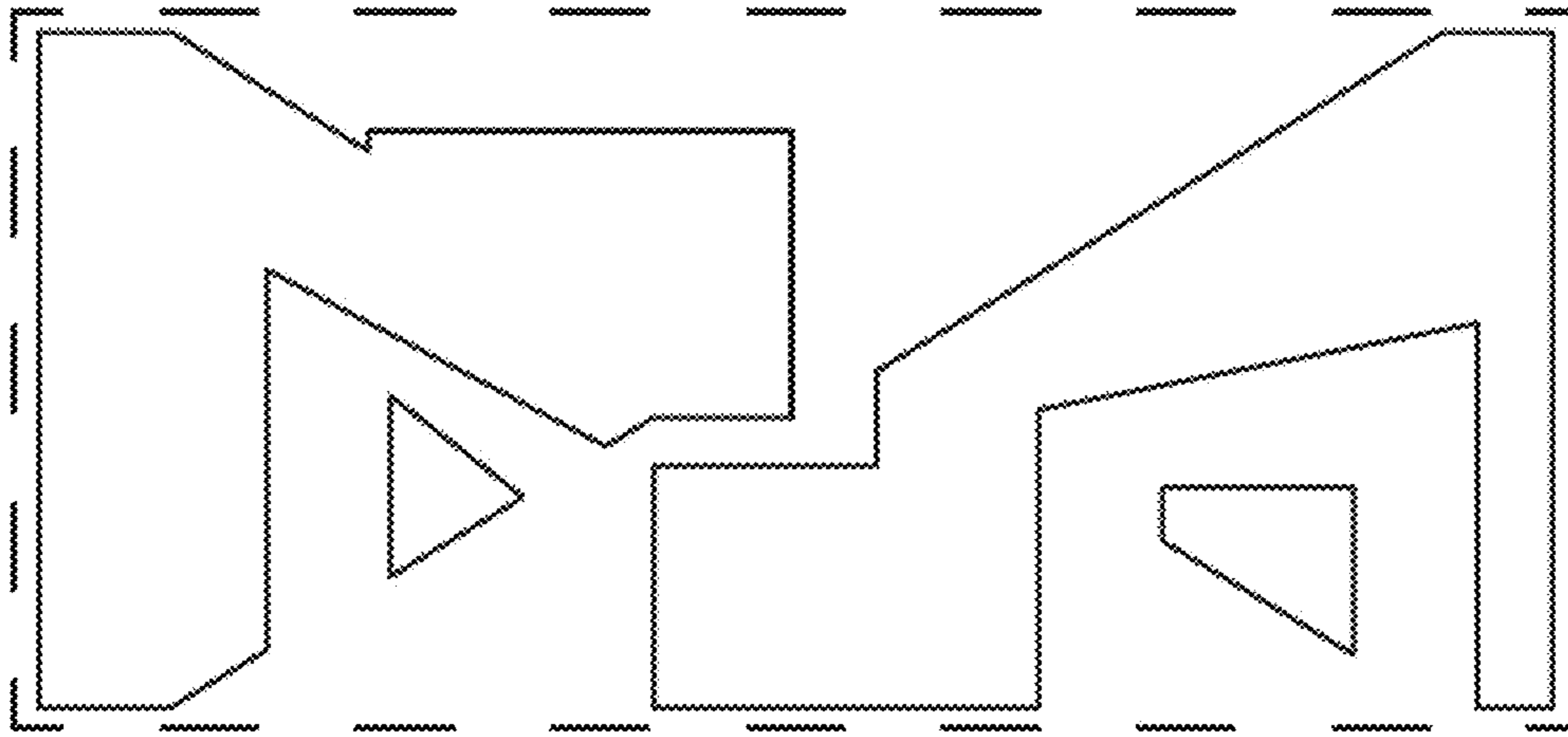

FIG. 1

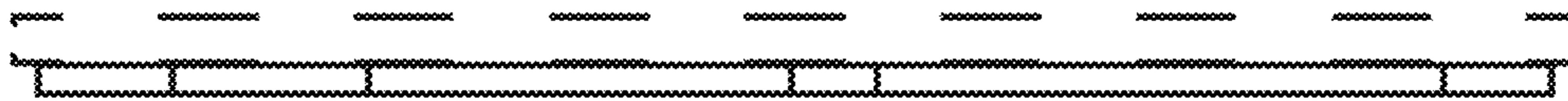

FIG. 2



FIG. 3

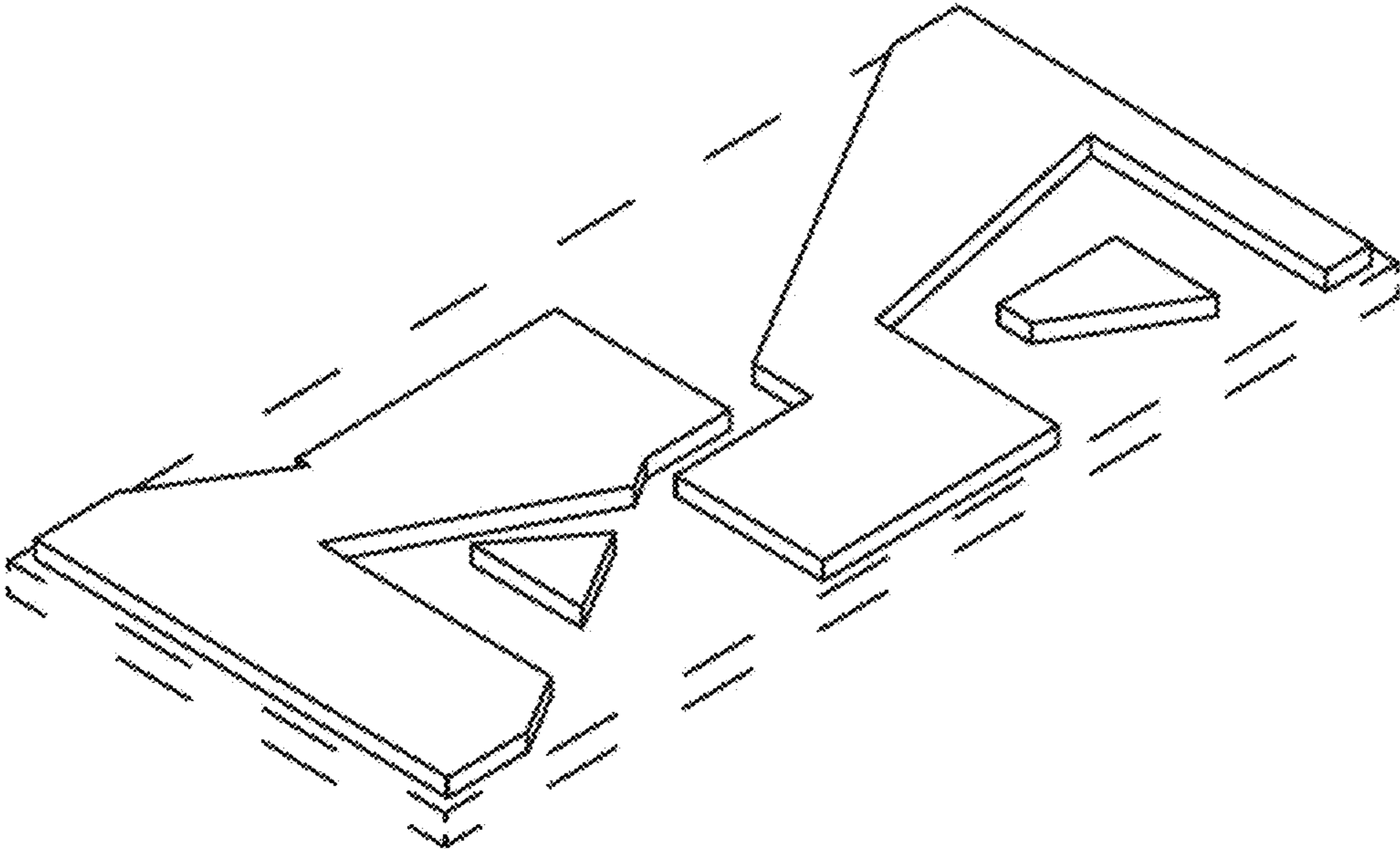

FIG. 4

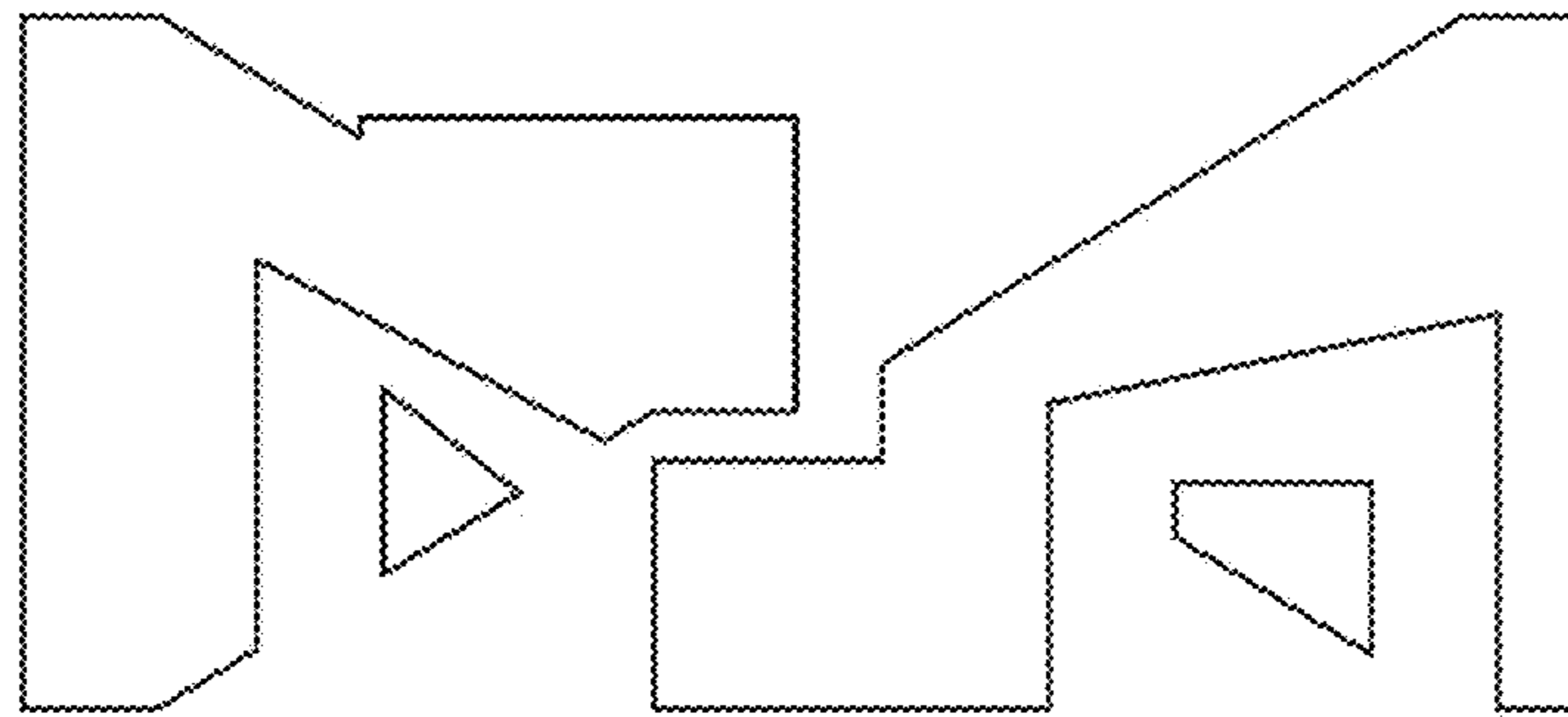

FIG. 5

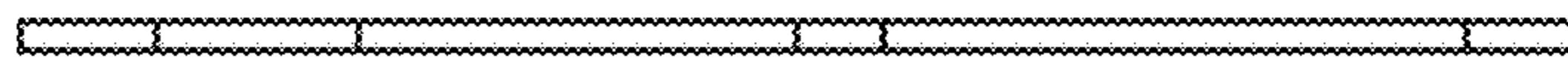

FIG. 6