



US00D784121S

(12) **United States Design Patent** (10) **Patent No.:** **US D784,121 S**
Hutchison (45) **Date of Patent:** **** Apr. 18, 2017**

(54) **DOUBLE FRICTION KNUCKLE CONNECTOR**

(74) *Attorney, Agent, or Firm* — Miller & Martin PLLC; Douglas T. Johnson

(71) Applicant: **Steve Hutchison**, Pegram, TN (US)

(57) **CLAIM**

(72) Inventor: **Steve Hutchison**, Pegram, TN (US)

The ornamental design for a double friction knuckle connector, as shown and described.

(**) Term: **14 Years**

DESCRIPTION

(21) Appl. No.: **29/526,137**

(22) Filed: **May 6, 2015**

(51) **LOC (10) Cl.** **08-08**

(52) **U.S. Cl.**
USPC **D8/382**

(58) **Field of Classification Search**
USPC D8/14, 71, 72, 74, 106, 310, 349, 382,
D8/394, 396; D14/432, 433, 483, 217,
D14/299
CPC .. F16M 13/00; F16M 11/00; F16M 2200/028;
G03B 17/561; G03B 17/566
See application file for complete search history.

FIG. 1 is a an environmental rear upper left perspective view of the double friction knuckle connector;
 FIG. 2 is a rear upper left perspective view of the double friction knuckle connector of FIG. 1, shown in alternate environment;
 FIG. 3 is a rear upper left perspective view of the double friction knuckle connector of FIG. 2, shown in alternate environment;
 FIG. 4 is a front upper right perspective view of the double friction knuckle connector shown in FIG. 1;
 FIG. 5 is a rear lower left perspective view of the double friction knuckle connector shown in FIG. 1;
 FIG. 6 is a rear upper right perspective view of the double friction knuckle connector shown in FIG. 1;
 FIG. 7 is a front elevation view of the double friction knuckle connector shown in FIG. 1;
 FIG. 8 is a left side elevation of the interactive intelligent panel show in FIG. 1;
 FIG. 9 is a right side elevation view of the double friction knuckle connector shown in FIG. 1;
 FIG. 10 is a top plan view of the double friction knuckle connector shown in FIG. 1;
 FIG. 11 is a bottom plan view of the double friction knuckle connector shown in FIG. 1; and,
 FIG. 12 is a rear elevation view of the double friction knuckle connector shown in FIG. 1.
 The broken lines shown in FIGS. 1-3 represent the environment of the claimed design and form no part thereof. The broken lines shown in FIGS. 9-11 illustrate portions of the double friction knuckle connector and form no part of the claimed design.

(56) **References Cited**

U.S. PATENT DOCUMENTS

D35,028 S *	9/1901	Ricker	D8/356
884,772 A *	4/1908	Sorensen	F16B 2/12
				16/252
D157,592 S *	3/1950	Hollaender	285/188
D157,593 S *	3/1950	Hollaender	285/188
4,572,692 A *	2/1986	Sauber	B65H 75/08
				242/599.2
4,788,724 A *	12/1988	Lazzeroni	H04R 1/08
				2/422
5,371,991 A *	12/1994	Bechtel	E04C 5/167
				24/336
D353,986 S *	1/1995	Maglica	D12/114
D364,555 S *	11/1995	Neiert	D8/396
D374,608 S *	10/1996	Shoda	D8/382

(Continued)

Primary Examiner — Sandra Snapp
Assistant Examiner — Ieisha Price

1 Claim, 4 Drawing Sheets

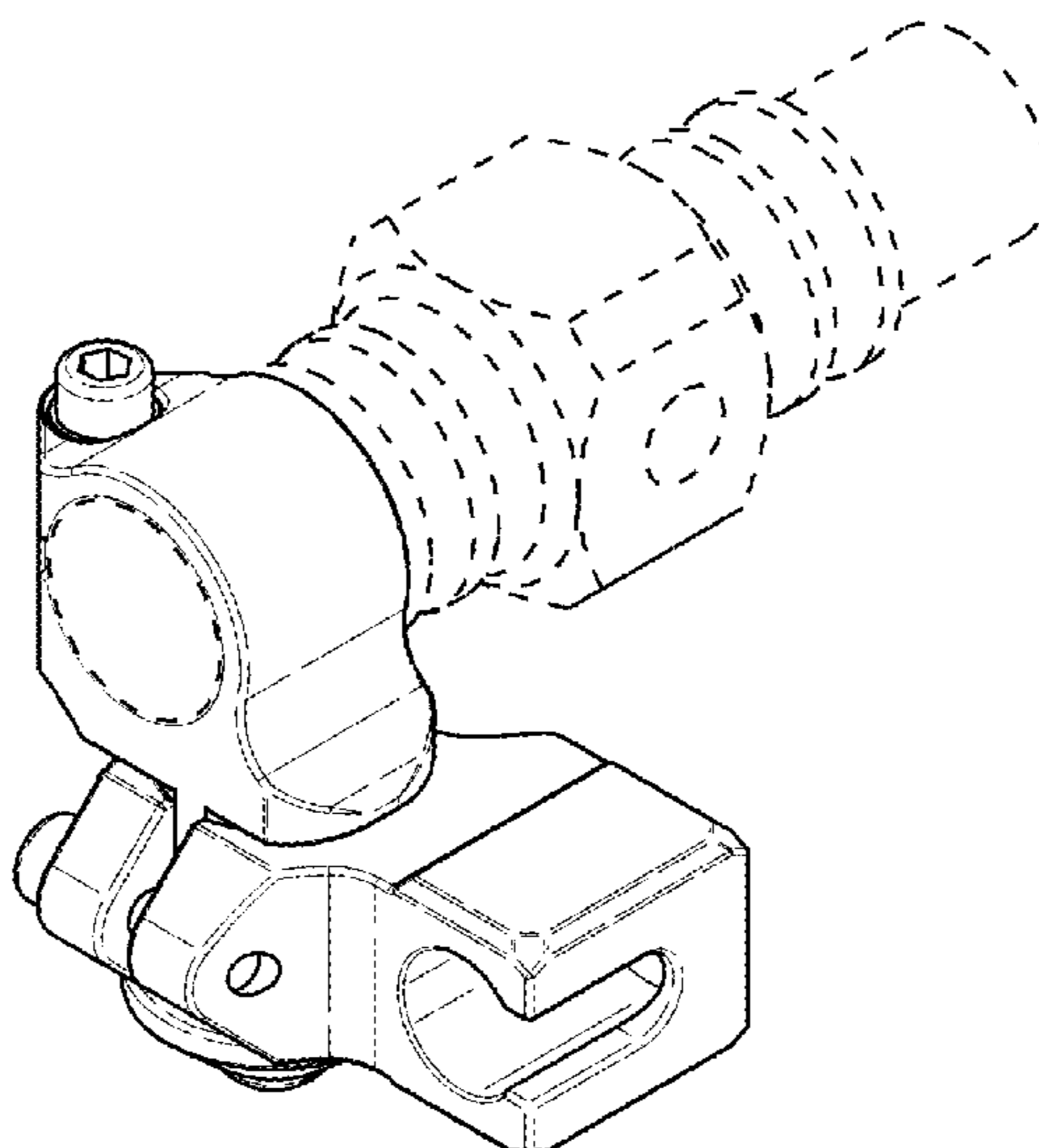

(56)

References Cited

U.S. PATENT DOCUMENTS

D412,829 S * 8/1999 Murakami D8/382
D413,842 S * 9/1999 Garven, Jr. D12/133
D417,141 S * 11/1999 Senninger D8/395
6,030,142 A * 2/2000 Malizia F16M 11/00
403/234
6,653,540 B2 * 11/2003 Izen G10D 13/026
84/327
D576,870 S * 9/2008 Eason D17/22
8,668,402 B2 * 3/2014 Mori F16B 2/10
403/170
8,776,328 B2 * 7/2014 Kodi E04C 5/163
24/339
2003/0080267 A1 * 5/2003 Eslick F16B 2/065
248/229.1

* cited by examiner

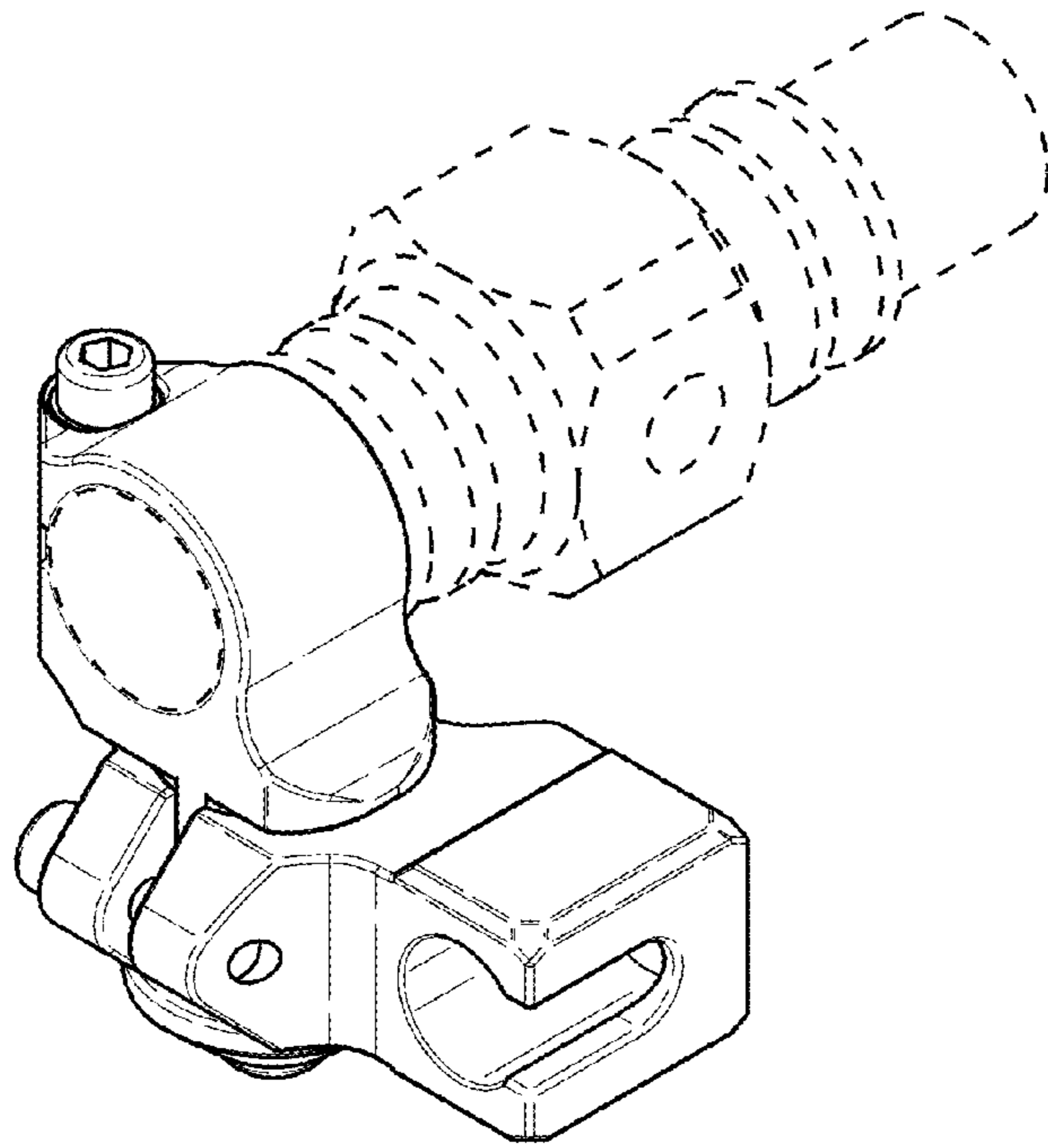

FIG. 1

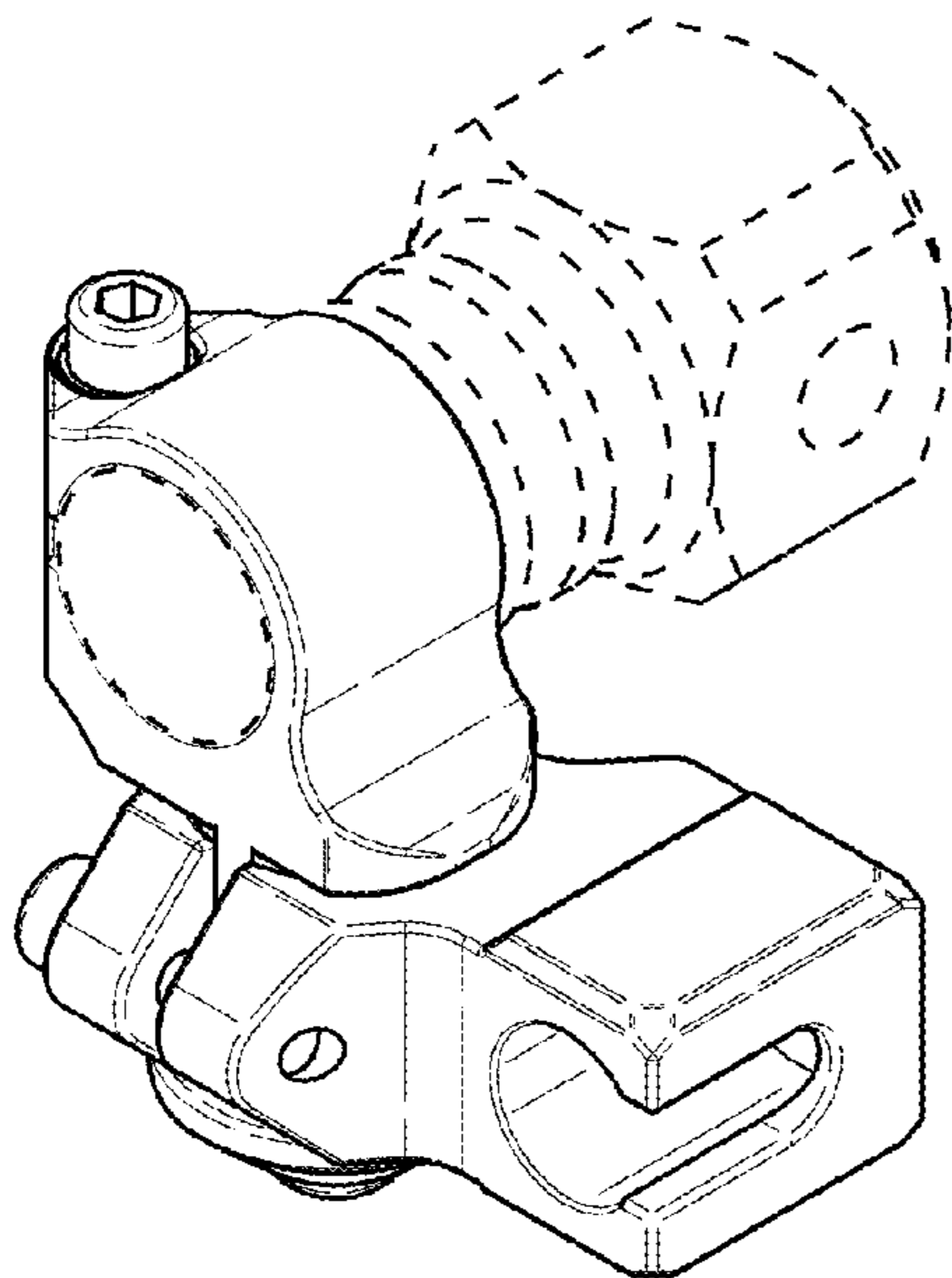

FIG. 2

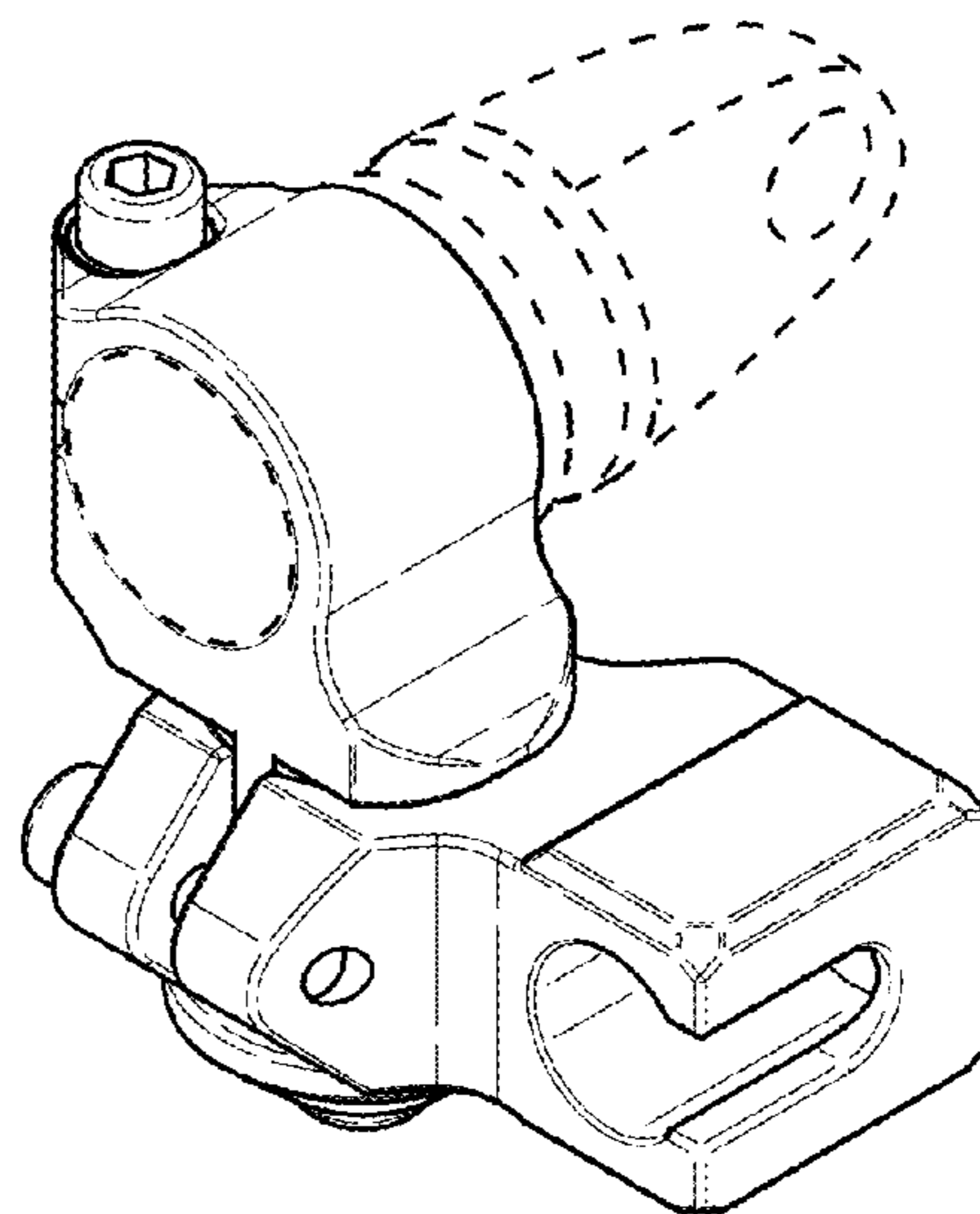

FIG. 3

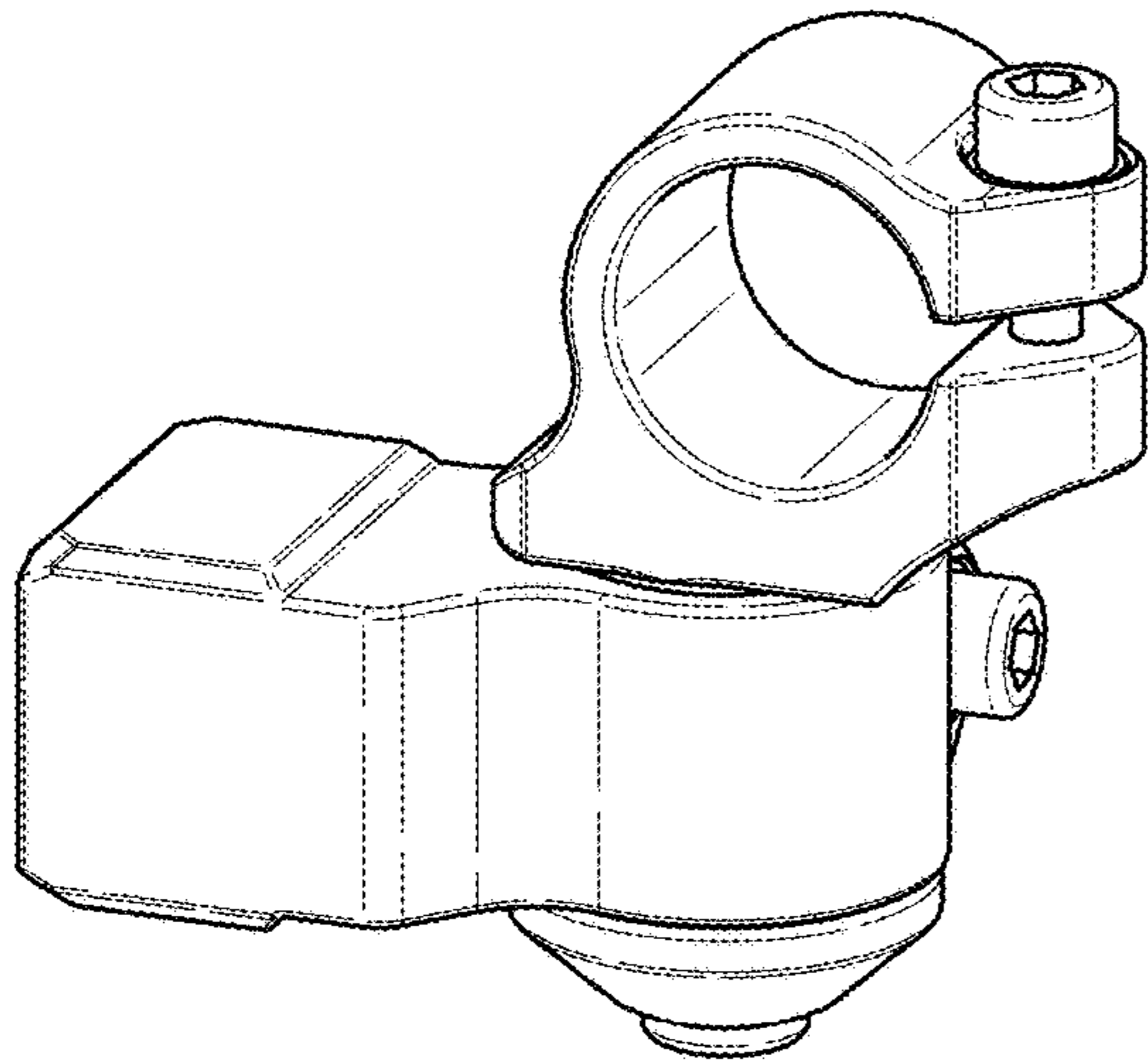

FIG. 4

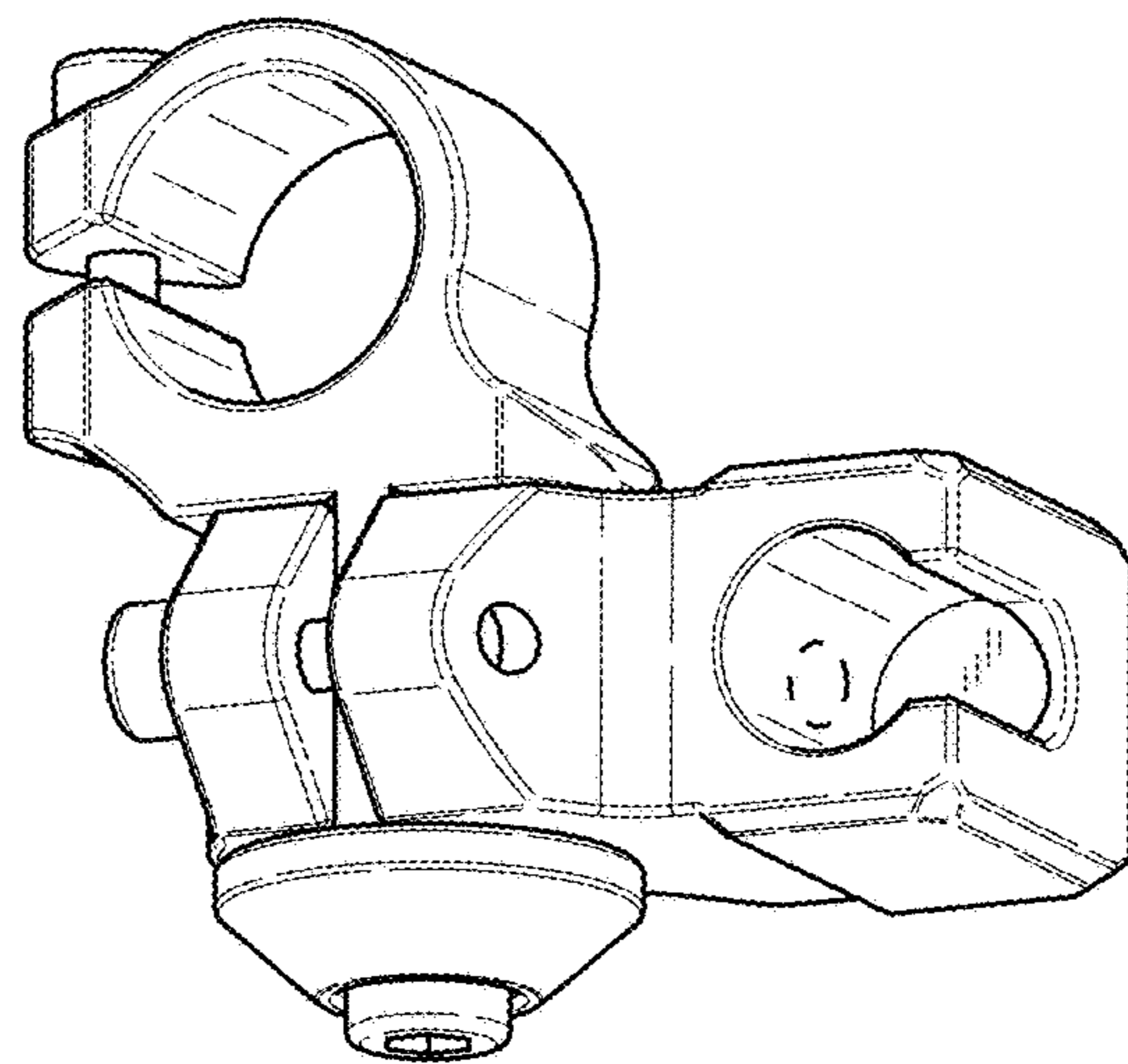

FIG. 5

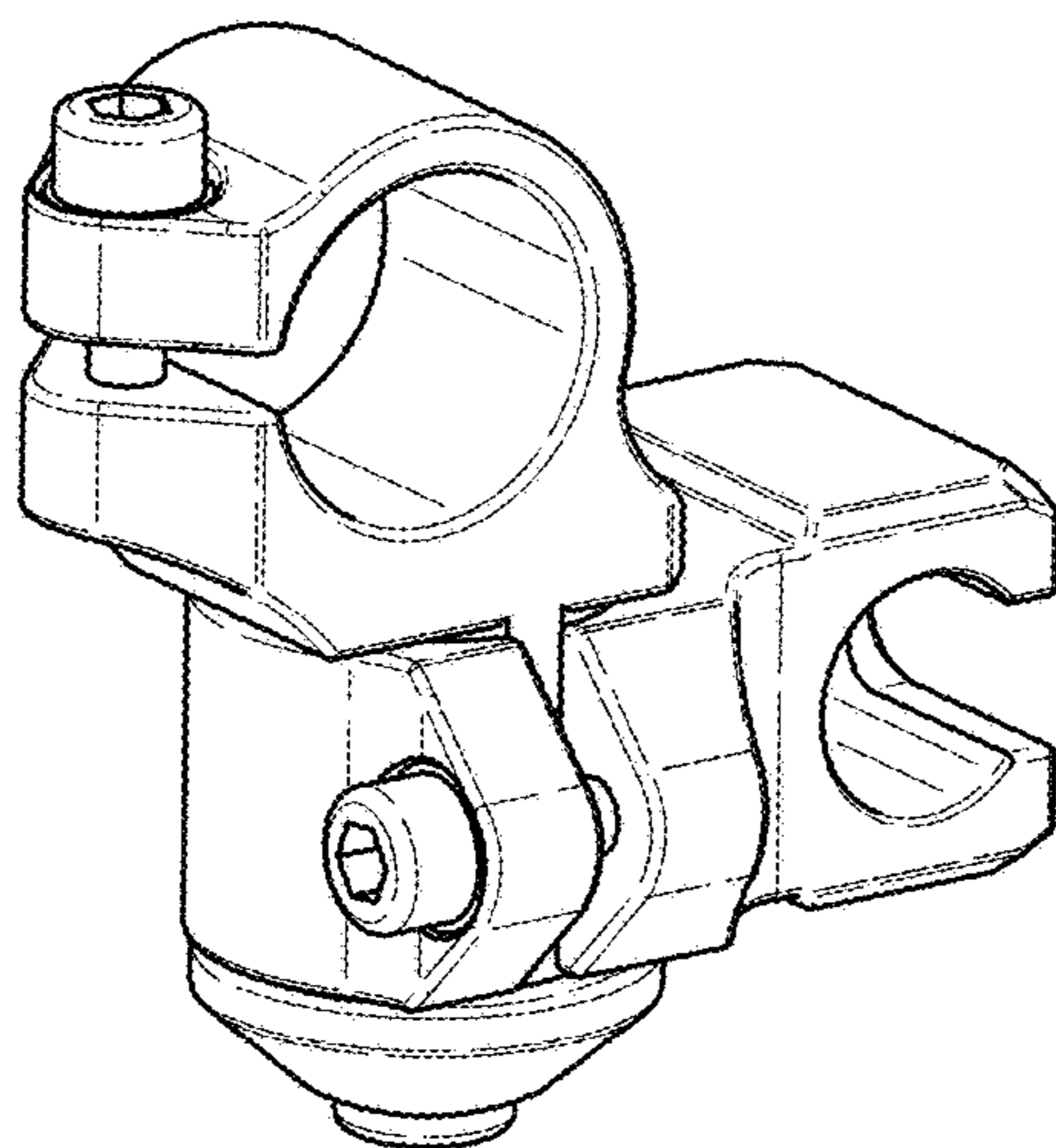

FIG. 6

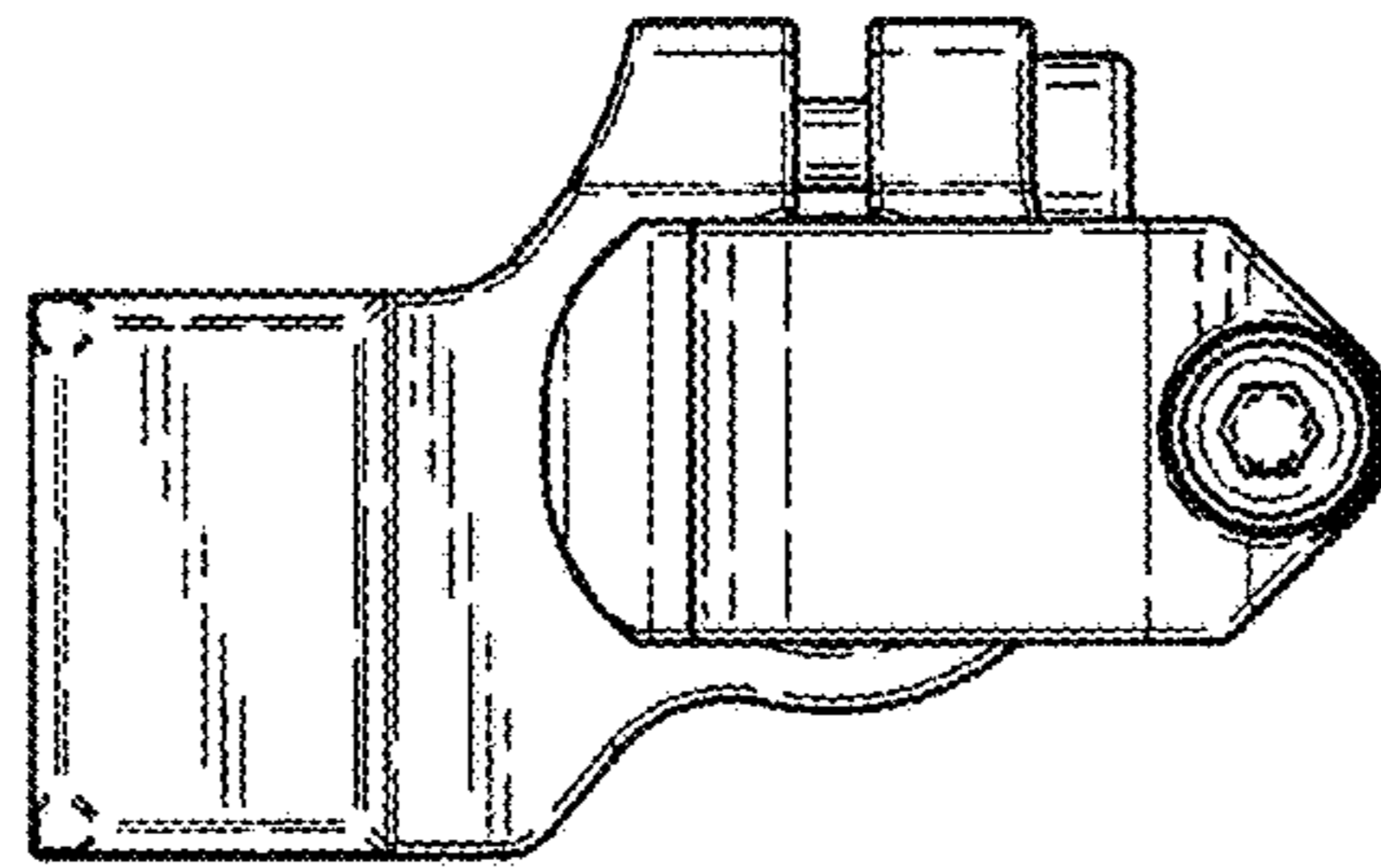

FIG. 10

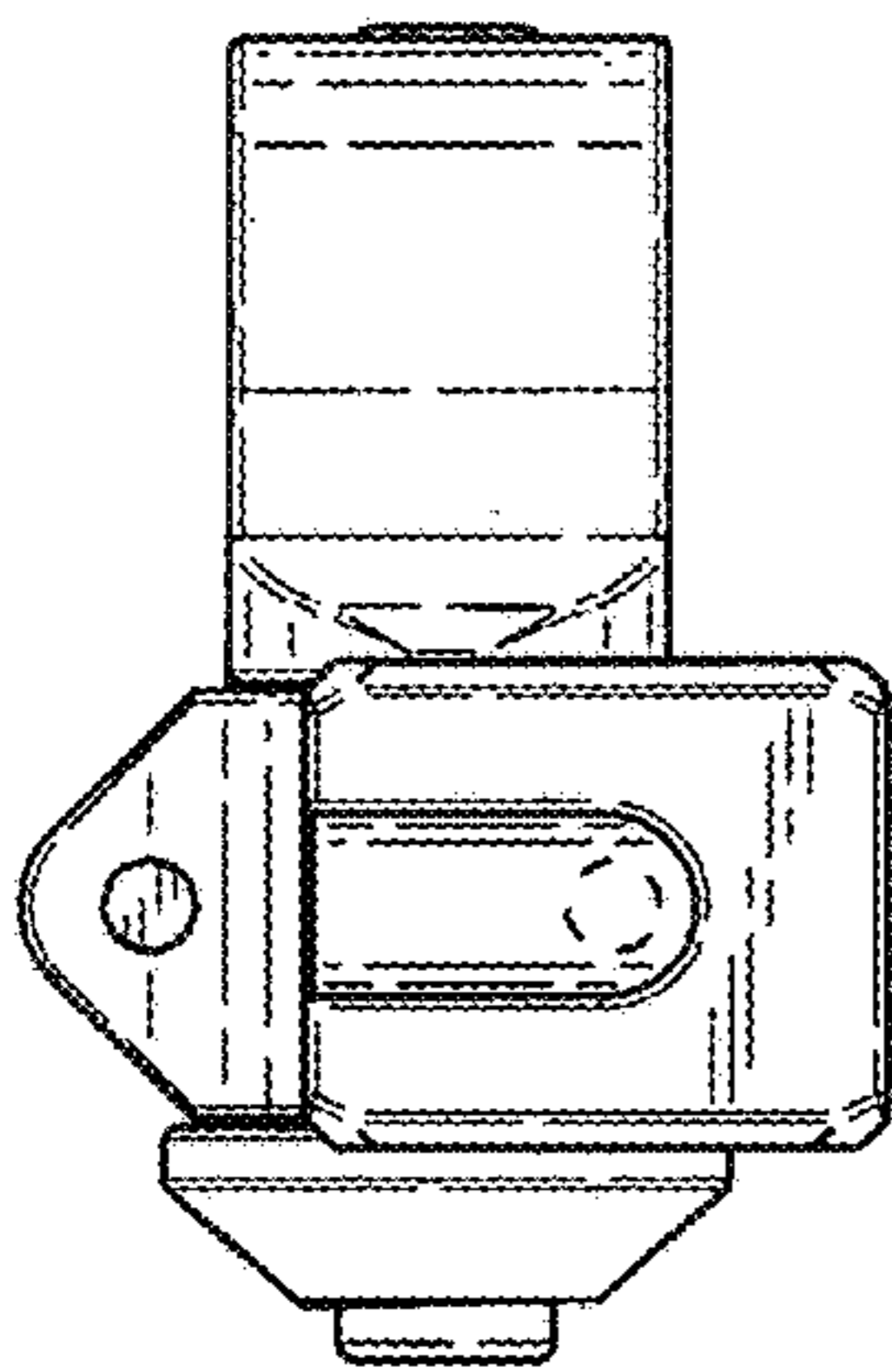

FIG. 8

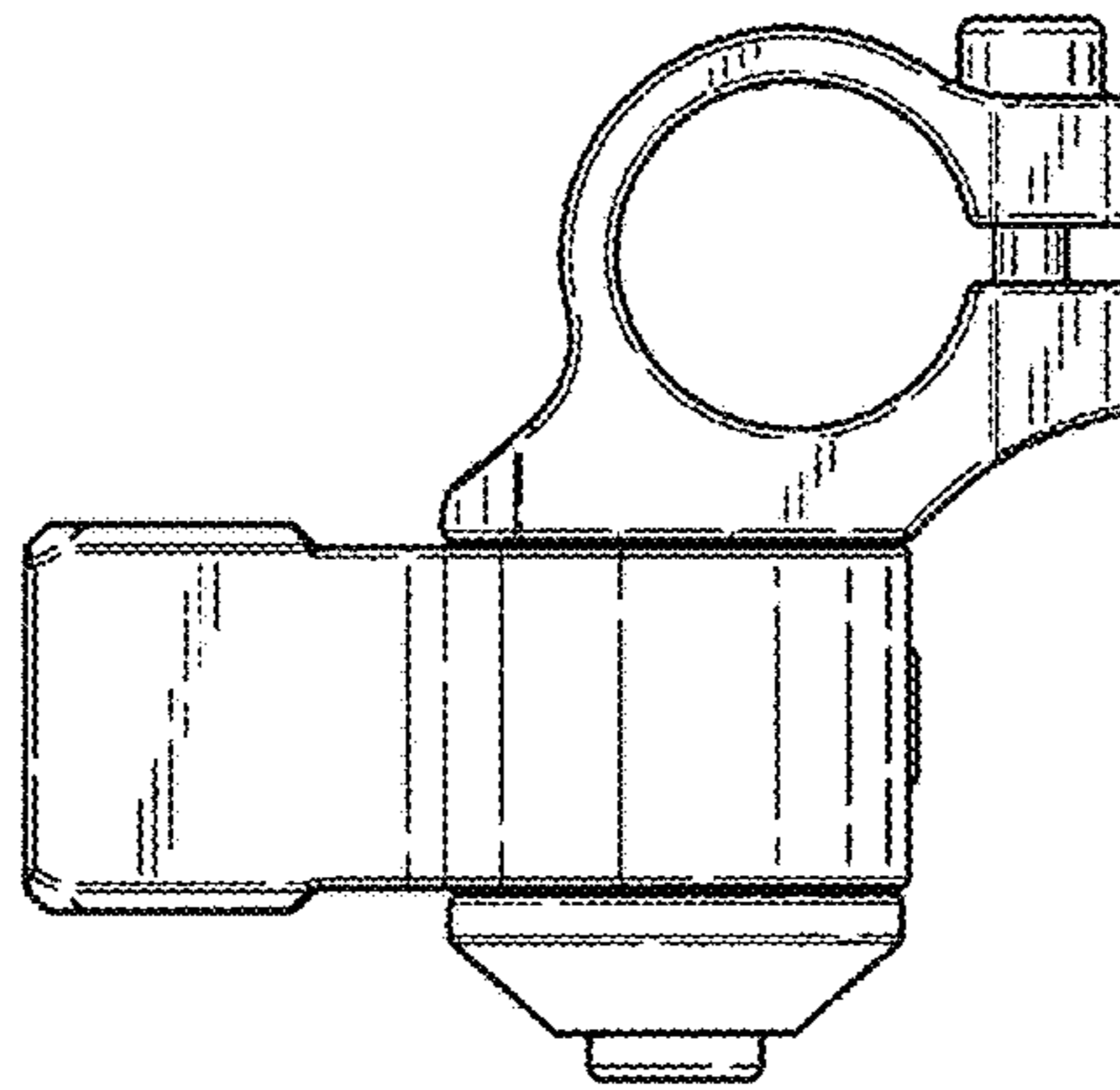

FIG. 7

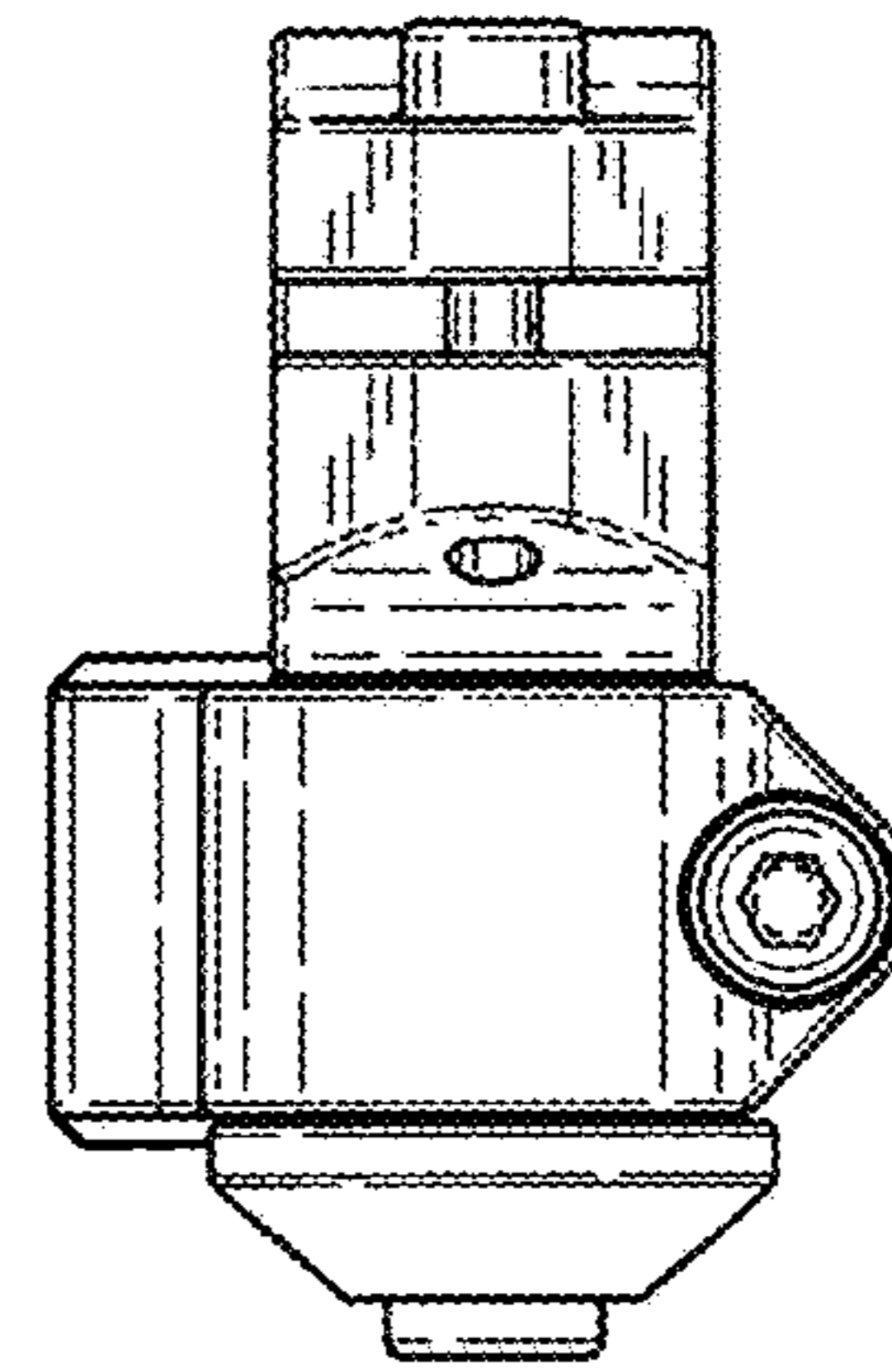

FIG. 9

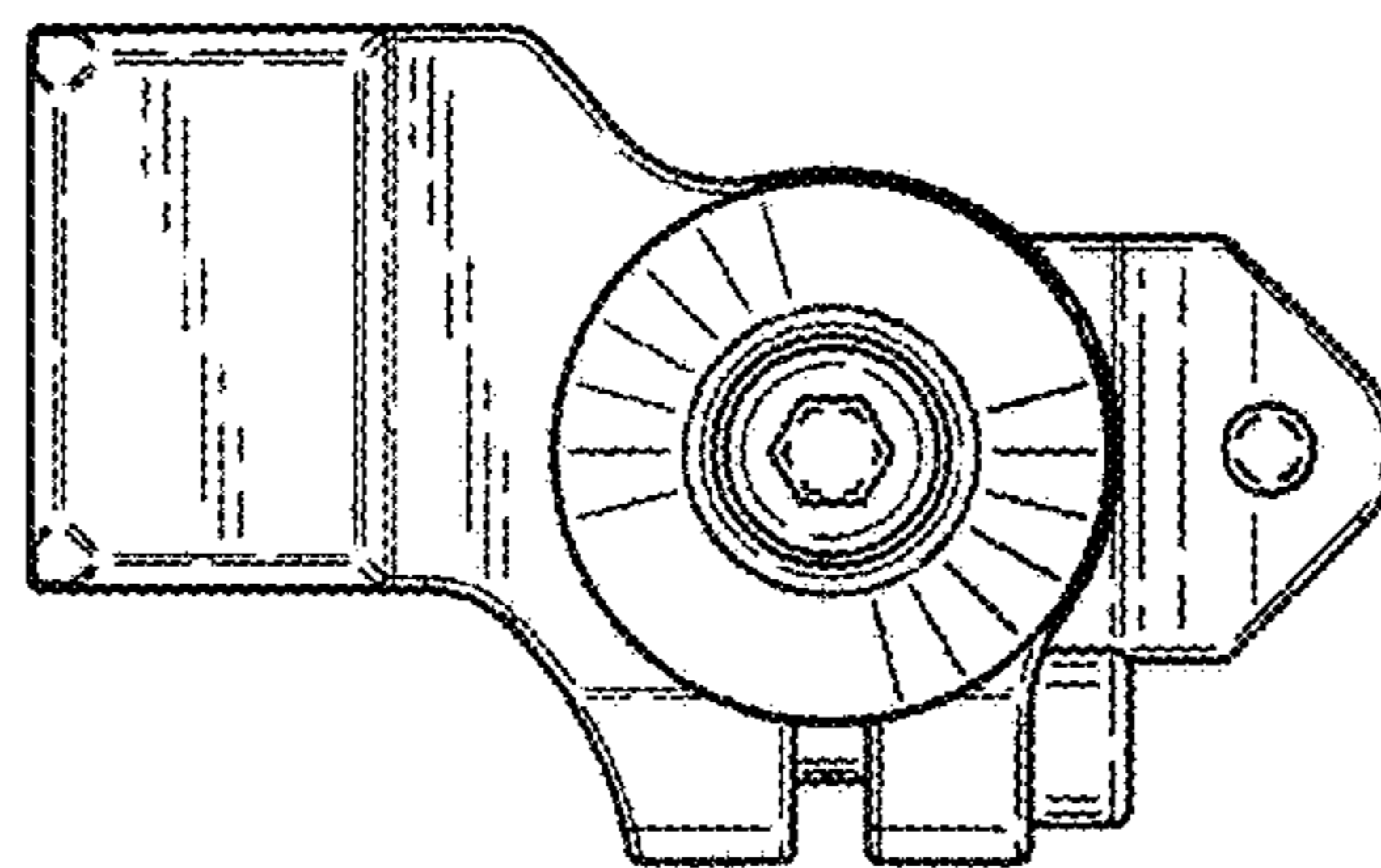

FIG. 11

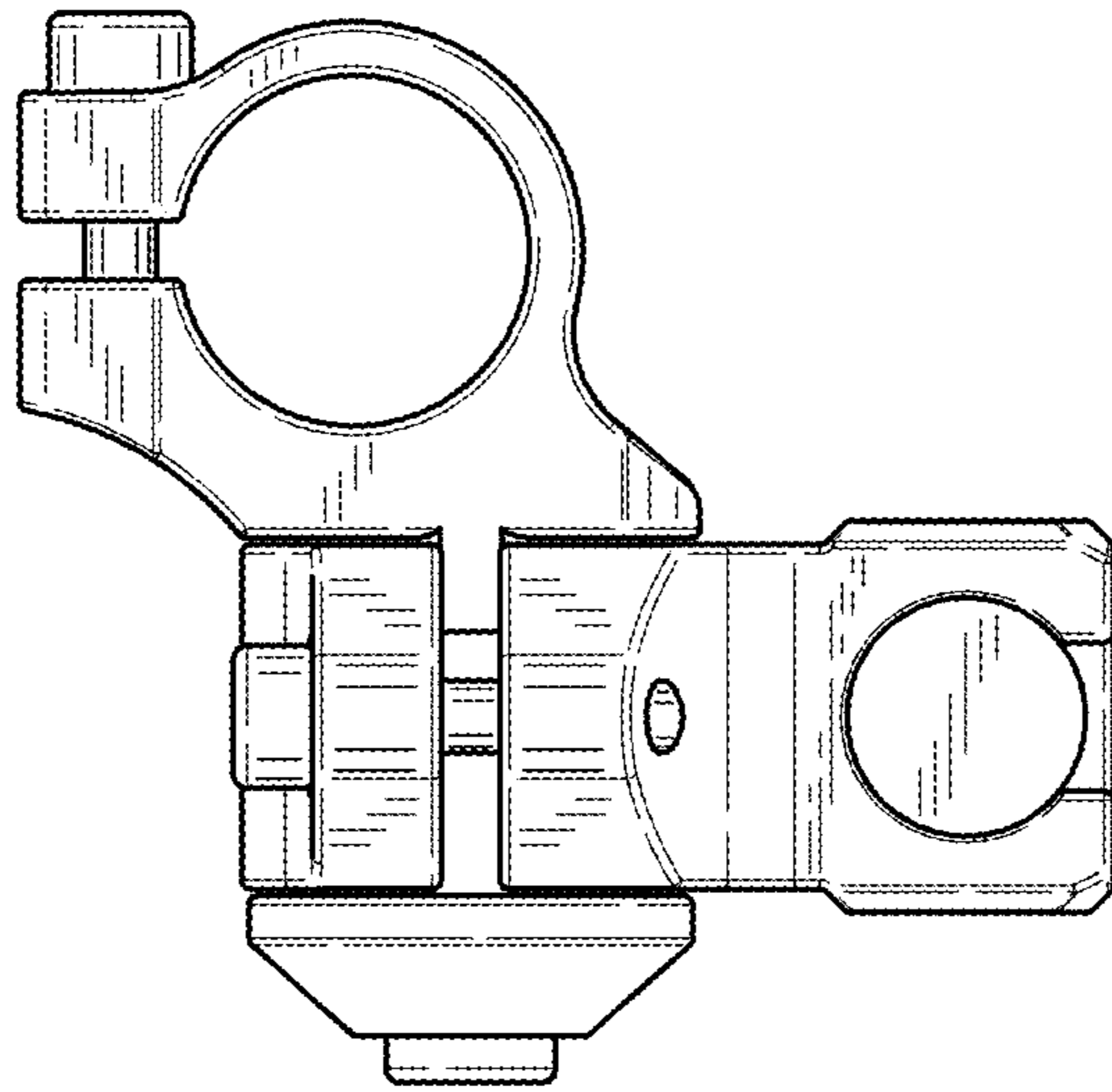

FIG. 12