



US00D782571S

(12) **United States Design Patent**
Liddy et al.

(10) **Patent No.:** **US D782,571 S**
(45) **Date of Patent:** **** Mar. 28, 2017**

(54) **COLORED METALLIC CREDIT CARD**

(71) Applicants: **Angela Liddy**, Lake Villa, IL (US);
Sheryl Yasger, Deerfield, IL (US)

(72) Inventors: **Angela Liddy**, Lake Villa, IL (US);
Sheryl Yasger, Deerfield, IL (US)

(73) Assignee: **Discover Financial Services**,
Riverwoods, IL (US)

(**) Term: **14 Years**

(21) Appl. No.: **29/525,096**

(22) Filed: **Apr. 27, 2015**

Related U.S. Application Data

(63) Continuation of application No. 29/421,618, filed on
Aug. 23, 2012, now Pat. No. Des. 728,017.

(51) **LOC (10) Cl.** **19-08**

(52) **U.S. Cl.**
USPC **D19/10**

(58) **Field of Classification Search**
USPC D19/1-12, 20-34, 100;
40/124.01-124.15, 672, 661, 726, 776,
40/617; 283/72, 74-75, 103, 105-117,
283/81-82, 70, 94, 904; 206/449, 815;
D21/385; D20/10, 22, 27, 40, 42, 11;
D14/435-437; D6/613, 583; 362/2;
235/380, 382, 487, 493, 488
CPC .. B42D 15/022; B42D 15/045; B42D 15/027;
B42D 15/042; B42D 25/29; B42D 25/00;
B42D 25/20; B42D 25/30; B42D 25/40;
B42D 25/23; B42D 25/26; B42D 25/285;
B42D 2033/00; B42D 2033/08; B42D
2033/10; B42D 2033/16; B42D 2033/20;
B42D 2033/30

See application file for complete search history.

(56) **References Cited**

U.S. PATENT DOCUMENTS

D523,472 S * 6/2006 Brink D19/9
D554,643 S * 11/2007 McCarty D14/436
D602,986 S * 10/2009 Skelding D19/9

(Continued)

OTHER PUBLICATIONS

U.S. Appl. No. 29/421,618, filed Aug. 23, 2012.

Primary Examiner — Abraham Bahta

(74) *Attorney, Agent, or Firm* — Leydig, Voit & Mayer,
Ltd.

(57) **CLAIM**

The ornamental design for a colored metallic credit card, as
shown and described.

DESCRIPTION

The patent or application file contains at least one drawing
executed in color. Copies of this patent or patent application
publication with color drawing(s) will be provided by the
Office upon request and payment of the necessary fee.

FIG. 1 is a perspective view of a colored metallic credit card;
FIG. 2 is a front view thereof;
FIG. 3 is a left side view thereof;
FIG. 4 is a right side view thereof;
FIG. 5 is a top view thereof;
FIG. 6 is a bottom view thereof;
FIG. 7 is a back view thereof; and,
FIG. 8 is a cross-section view of a metallic card, in accor-
dance with an embodiment of the invention.

The broken line drawings of text, numbers and other graphic
elements form no part of the claimed design.

1 Claim, 3 Drawing Sheets
(3 of 3 Drawing Sheet(s) Filed in Color)

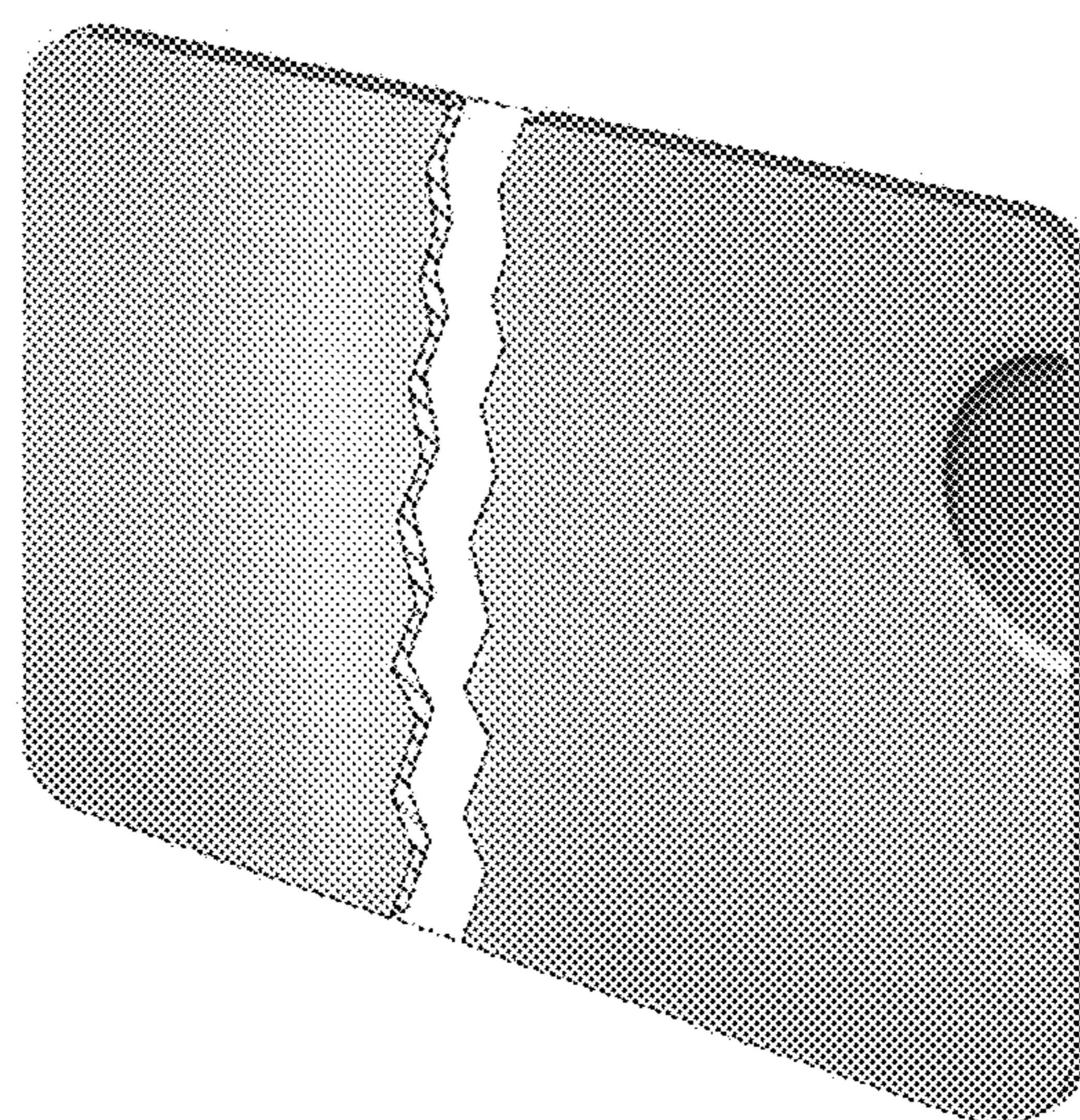
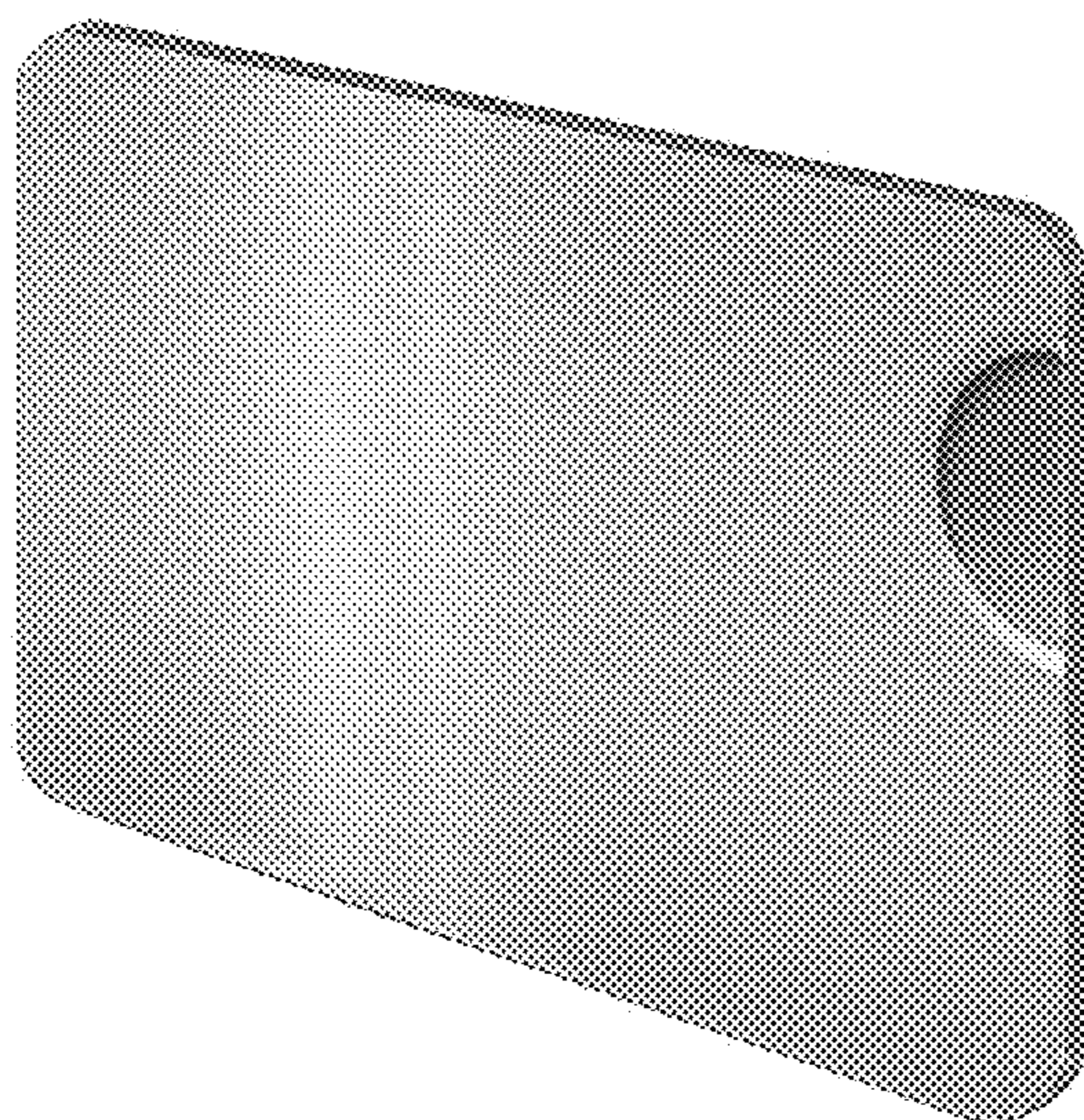

(56)

References Cited

U.S. PATENT DOCUMENTS

D635,186 S *	3/2011	Skelding	D19/9
D636,021 S *	4/2011	Antonio	D19/10
D643,062 S *	8/2011	Skelding	D19/9
D643,064 S *	8/2011	Skelding	D19/10
D672,807 S *	12/2012	Ahrabian	D19/9

* cited by examiner

FIG. 1

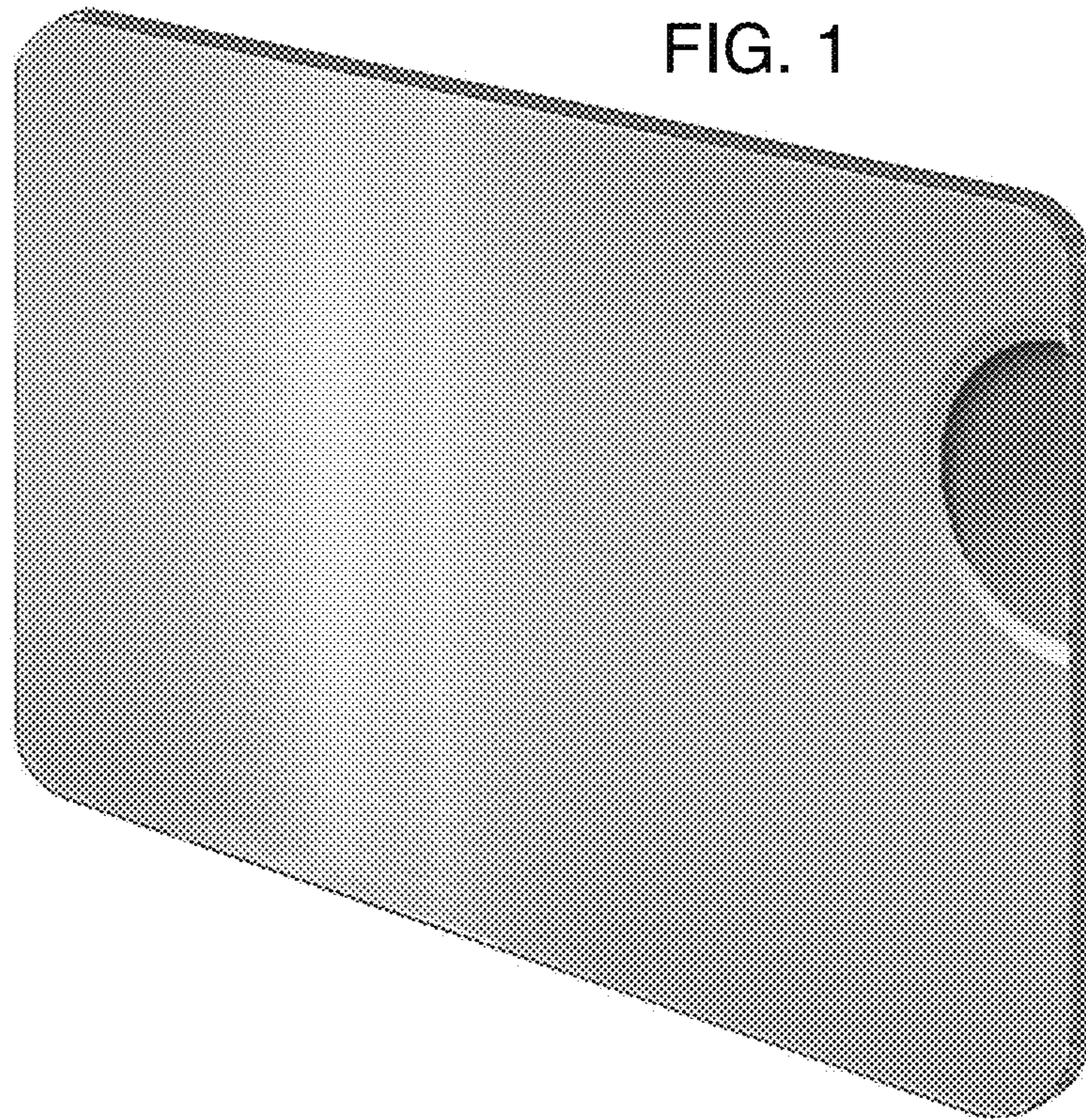

FIG. 5



FIG. 3



FIG. 2

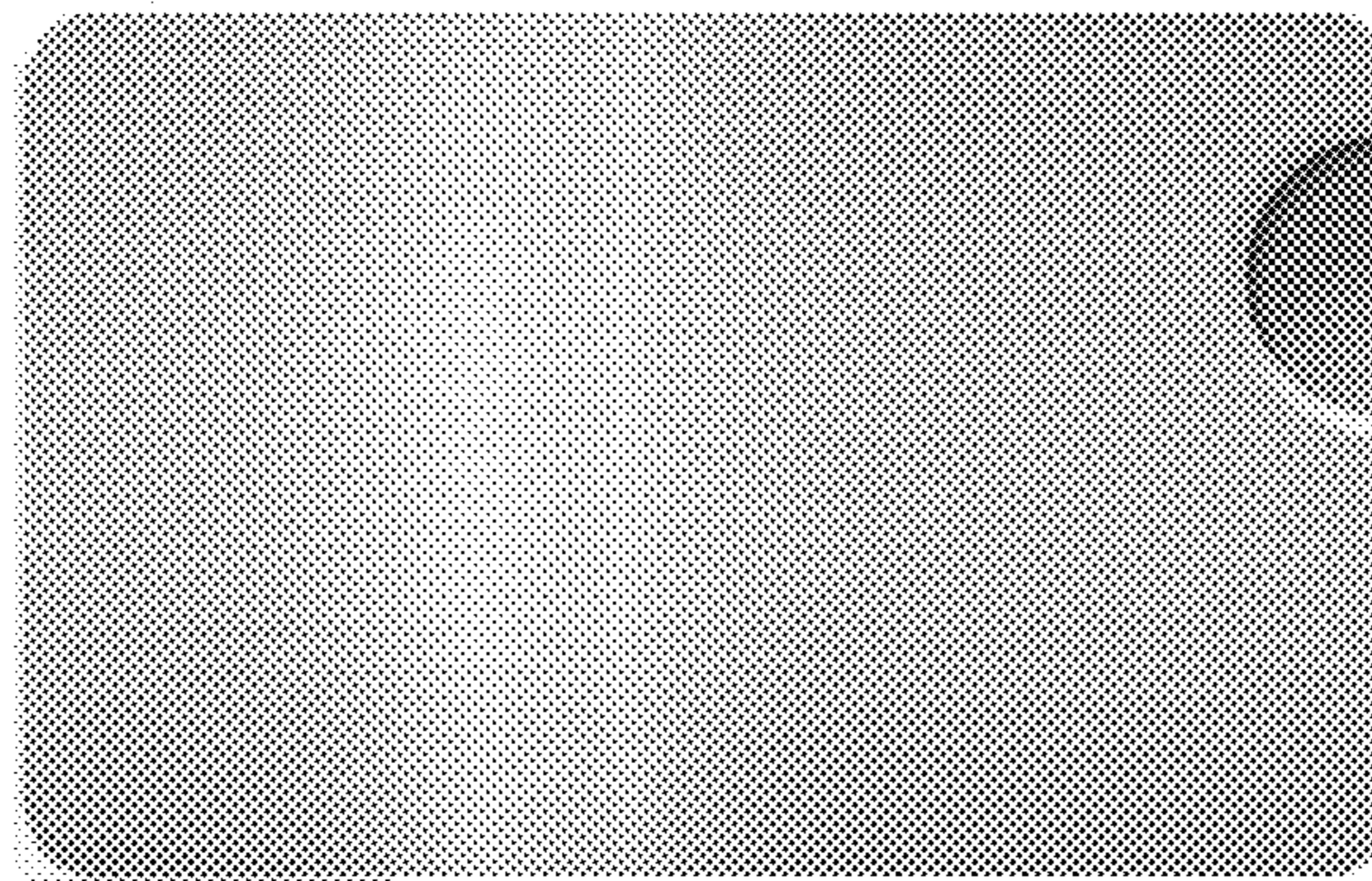

FIG. 4



FIG. 6



FIG. 7

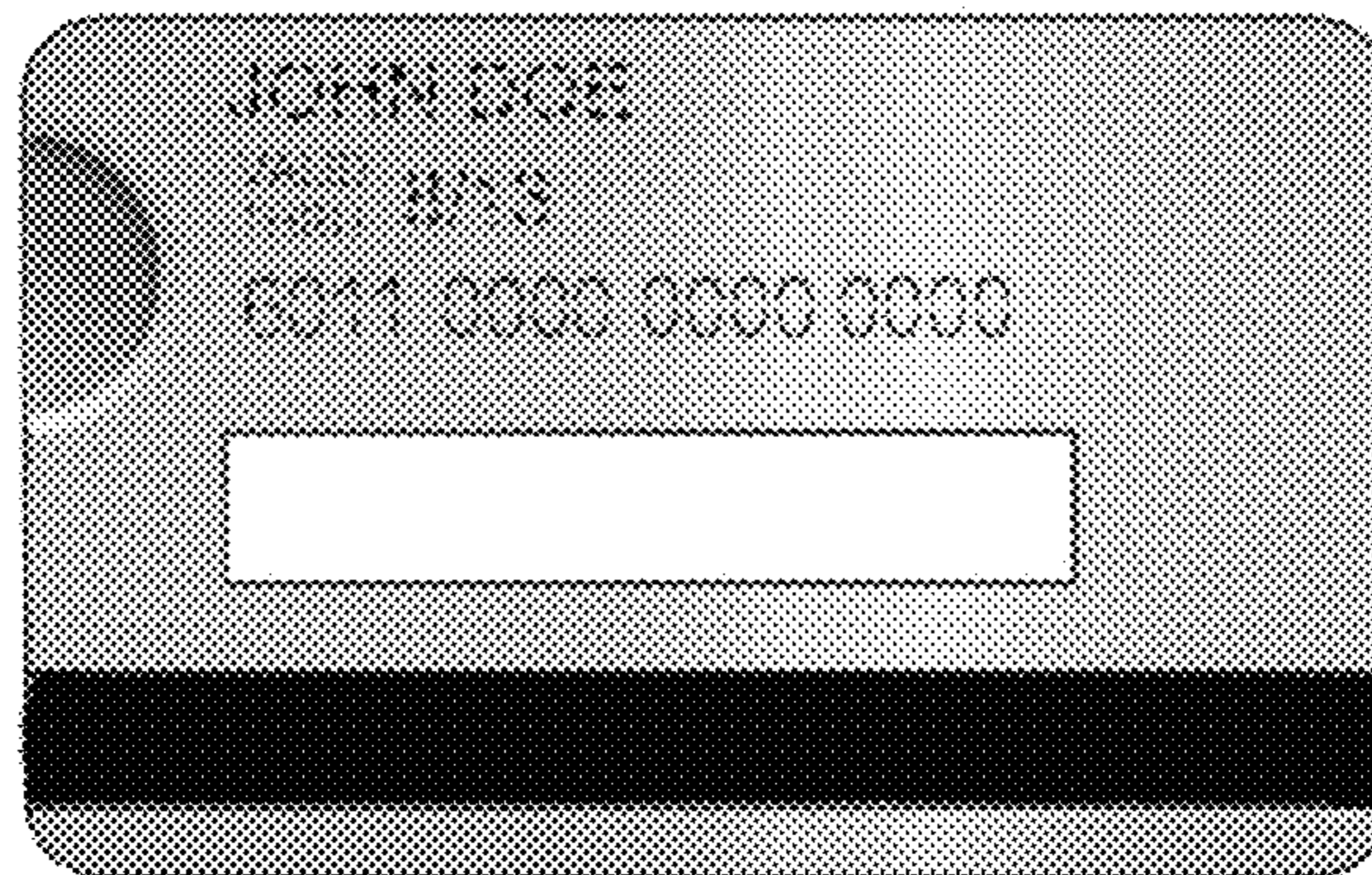

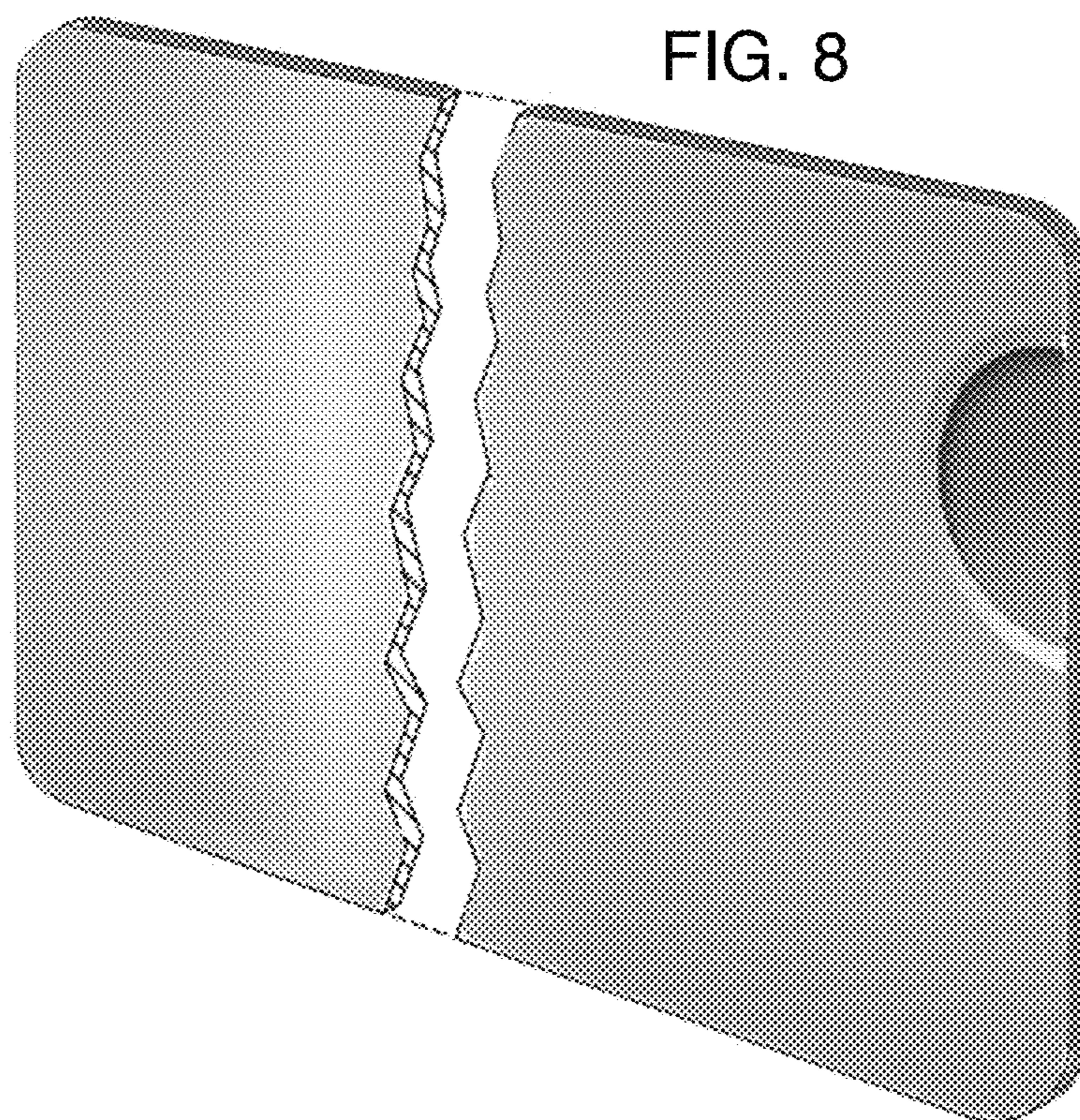

FIG. 8